

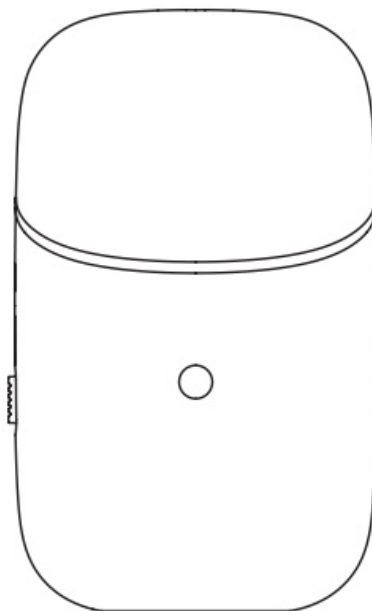

**OliveTech Plug In Diffuser  
User Manual**



**Contents** [ [hide](#) ]

- [1 Product Structure](#)
- [2 Operation Guide](#)
- [3 Cautions](#)
- [4 Specifications](#)
- [5 Attention](#)
- [6 Troubleshooting](#)
- [7 Documents / Resources](#)
  - [7.1 References](#)

**Product Structure**

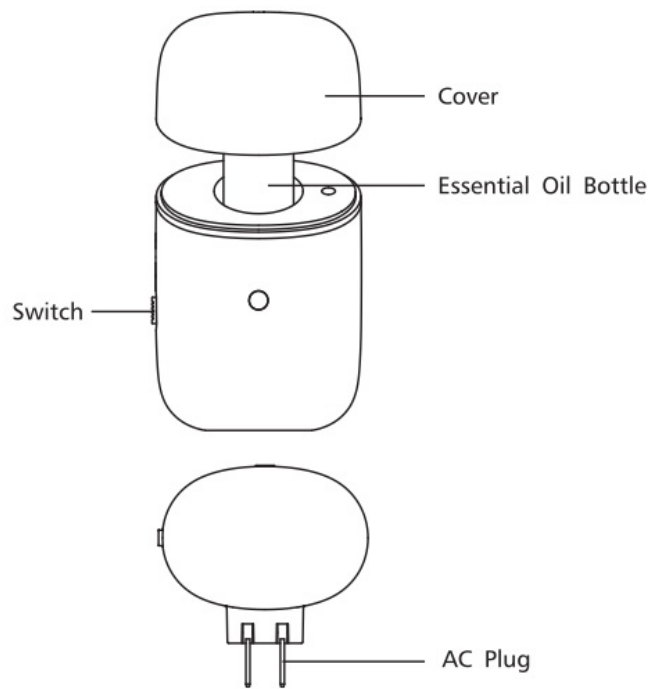

## Operation Guide

1. In the shutdown state, remove the top cover. (Fig1)
2. Rotate clockwise to remove the essential oil bottle connected to the top cover.(Fig.2)
3. Add essential oils to the bottle, then twist the bottle counterclockwise and tighten it onto the top cover. Not too tight to avoid damaging the sealing ring)
4. Install the top cover onto the machine body while it is turned off. (Fig. 3)
5. Operating the machine: (Fig. 4)
  - 1) Open the two pin plugs on the back of the machine and plug them into the power socket.
  - 2) Find the switch on the left side of the machine and you will notice three settings, When the switch is in the center, the machine will be set to “OFF” You can choose the “HIGH” or “LOW” settings. The ‘HIGH’ setting will run for 30 seconds and stop for 2 minutes, and the cycle will repeat for 12 hours before automatically closing and then resuming after 12 hours. The LOW setting will run for 30 seconds and stop for 4 minutes. The cycle will repeat for 12 hours, then automatically close and resume after 12 hours. Recommendation: Set on the low setting. 10ml of essential oil will last 9-10 days.)

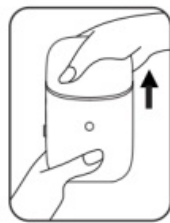

(Fig 1)

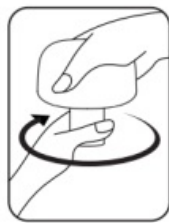

(Fig 2)



(Fig 3)

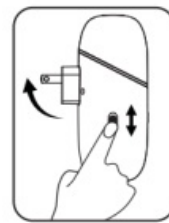

(Fig 4)

## Cautions

1. This scent diffuser is uniquely designed for fragrance oils without adding water.
2. To ensure safety, we advise keeping diffuser out of your pet's and child's reach.
3. Do not use the machine upside down, as it may cause leakage.
4. Do not place the diffuser in high temperature or humid environment.
5. Do not spill water or corrosive liquid on or inside the machine.
6. Do not modify, disassemble or repair the machine at will, in case of failure, please contact our customer service or technical support in time.
7. Do not fill with corrosive and high viscosity liquid in the bottle.
8. Do not mixing different essential oils.
9. Before changing the essential oil, it needs to wash the essential oil bottle and fill the bottle with purified water. Leave it on "high" for a period of time to clean the internal piping.
10. When the machine is not in use for a long time, please keep it clean and dry. Before use, make sure it is clean.

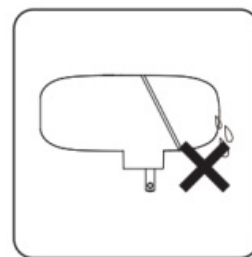
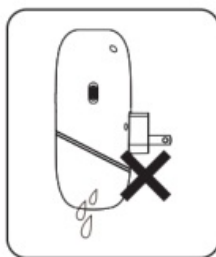
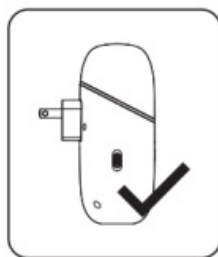

## Specifications

Dimensions: 3.1×2.6×5 inches

Power Input: AC100-240V 50/60Hz

Power: 5W

Materials: PP

Essential oil bottle capacity 10ml

Accessory: 2x10ml Essential Oil, 1x User Manual

**Attention:** How strong the scent is depends on the essential oils you use. purity and concentration of essential oils.

We spare no effort to provide the best customer service. If you have any questions, please feel free to contact us, so we can have the opportunity to improve your experience right away!

✉ Email: [olivetech-service@hotmail.com](mailto:olivetech-service@hotmail.com)

Or contact us directly via [Amazon.com](https://www.amazon.com). Please click-“Your Orders”, find the order for this product, click-“Contact seller”, click-“Select”-“Other”, then send us an email.

## Attention

1. How strong the scent is depends on the essential oils you use. purity and concentration of essential oils.
2. The longer spraying and the shorter the pause time, the stronger the fragrance will be.

## Troubleshooting

Before requesting repair service, please refer to the guide below to diagnose and resolve the issue.

Issue	Solution
No power	Check that the power cord is firmly plugged into the outlet.
No diffusion	Check mode settings, timer cycle, and reconnect or replace the air pump.
Weak diffusion	Clean or replace atomizer; check gasket and tube connection.
Abnormal noise	Retighten or replace the air pump.
No airflow/spray	Reinstall oil bottle; press and test nozzle, clean if blocked.





## [OliveTech W2203-C Plug In Diffuser \[pdf\]](#) User Manual

W2203-C, W2203-C Plug In Diffuser, Plug In Diffuser, Diffuser

## References

- [User Manual](#)

📎 diffuser, OliveTech, Plug-In Diffuser, W2203-C, W2203-C Plug In

📁 OliveTech   Diffuser

---

## Leave a comment

Your email address will not be published. Required fields are marked \*

Comment \*

Name

Email

Website

☐ Save my name, email, and website in this browser for the next time I comment.

**Post Comment**

**Search:**

e.g. whirlpool wrf535swhz

Search

[Manuals+](#) | [Upload](#) | [Deep Search](#) | [Privacy Policy](#) | [@manuals.plus](#) | [YouTube](#)

This website is an independent publication and is neither affiliated with nor endorsed by any of the trademark owners. The "Bluetooth®" word mark and logos are registered trademarks owned by Bluetooth SIG, Inc. The "Wi-Fi®" word mark and logos are registered trademarks owned by the Wi-Fi Alliance. Any use of these marks on this website does not imply any affiliation with or endorsement.