



# OLIMPIA SPLENDID NDM-15WT Convector Heater Instruction Manual

[Home](#) » [OLIMPIA SPLENDID](#) » OLIMPIA SPLENDID NDM-15WT Convector Heater Instruction Manual 



Please read and save these instructions

## Contents

- [1 Castor Installation & Removal](#)
- [2 Specifications](#)
- [3 SAFETY INSTRUCTIONS](#)
- [4 Mounting Guide](#)
- [5 Maintenance](#)
- [6 Warning](#)
- [7 Overview of the appliance](#)
- [8 Operation:](#)
- [9 Documents / Resources](#)

## Castor Installation & Removal

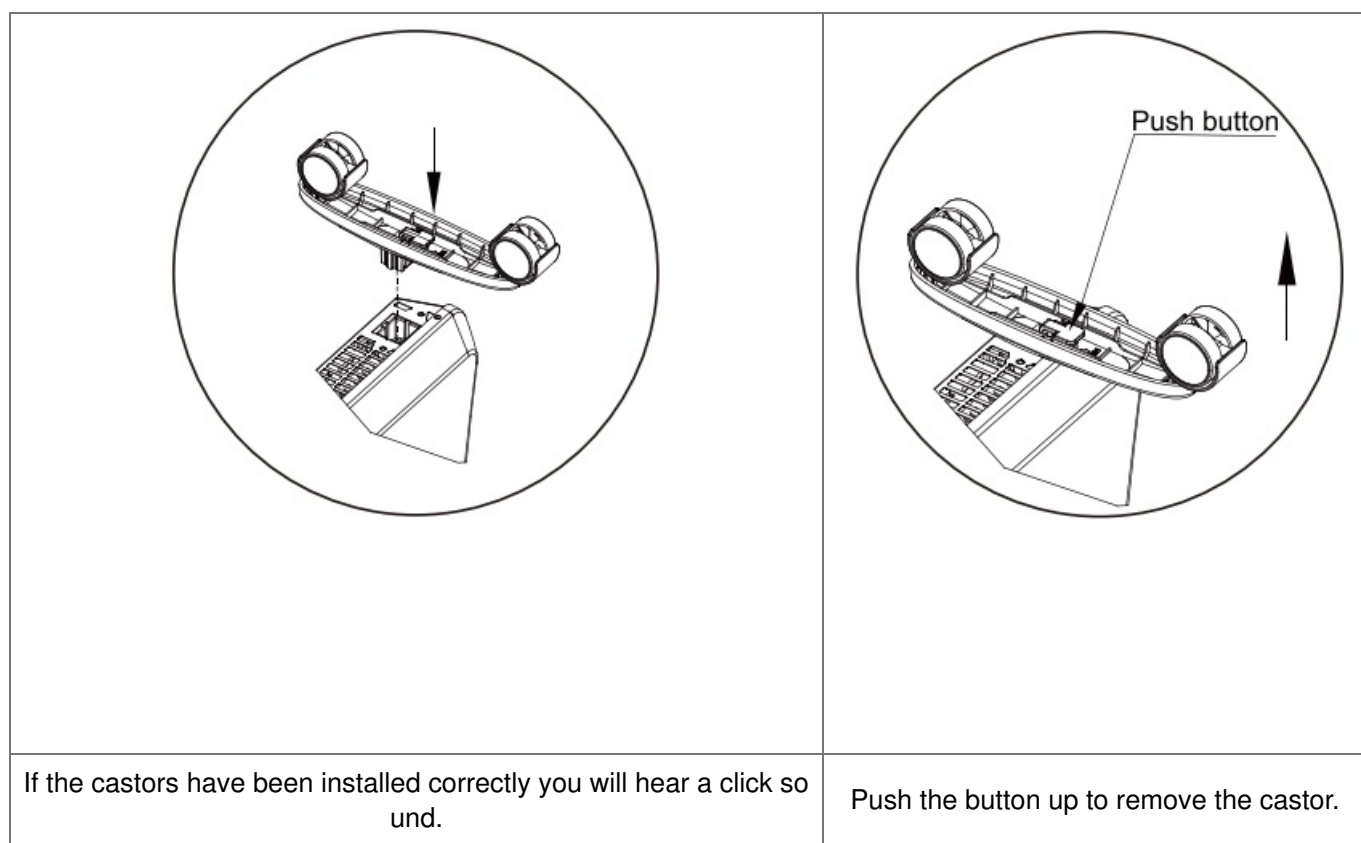

## Specifications

Model	Power (W)	L mm	H mm	L1 mm	H1 mm
NDM-15WT	1500/750	690	400	250	254
NDM-20VVT	2000/1000	830	400	250	254
NDM-24WT	2400/1200	950	400	250	254

## WARNING:

- Do not use this heater if it has been dropped.
- Do not use if there are visible signs of damage to the heater.
- Use this heater on a horizontal and stable surface, or fix it to the wall, as applicable.
- Do not use this heater in small rooms when they are occupied by persons not capable of leaving the room on their own, unless constant supervision is provided.
- To reduce the risk of fire, keep textiles, curtains, or any other flammable material to a minimum distance of 1m from the air outlet.

## SAFETY INSTRUCTIONS

### BEFORE FIRST USE

Read and follow all the instructions in this manual even if you feel you are familiar with the product and find a place to keep it handy for future reference.

**NOTE:** The rating of this product (as marked on the product rating label) is based on specific loading tests. Normal use or the use of other recommended attachments may draw significantly less power.

### IMPORTANT SAFEGUARDS

When using any electrically powered product, basic safety precautions should always be Followed.

PLEASE READ THE FOLLOWING INSTRUCTIONS CAREFULLY BEFORE USING THE PRODUCT.

**WARNING** — to reduce the risk of fire, electrical shock or injury to persons or property:

- Read all instructions before using this appliance and keep them for future reference
- Use only the voltage specified on the rating label of the heater.
- Do not cover or restrict airflow to the inlet or exhaust grilles in any manner as the appliance may overheat and become a fire risk
- Do not cover grilles, block entry or exhaust of airflow by placing appliance against any surface. Keep all object at least 1 meter from the front, side and rear of the appliance
- Do not place the appliance close to a radiant heat source.
- Do not operate in areas where gasoline, paint or other flammable liquids are used or stored.
- This appliance heats up when in use. To avoid burns, do not let bare skin touch hot surface.
- Switch off and leave to cool before moving
- Do not use the appliance to dry clothes.
- Do not insert or allow foreign object or metal utensils to enter any ventilation or exhaust opening, as this may cause an electric shock, fire or damage to the appliance.
- Do not immerse in liquid or allow liquid to run into the interior of the appliance, as this could create an electric shock hazard.
- Do not reach for an appliance that has fallen into water. Switch off at supply and unplug immediately.
- Do not operate any appliance with a damaged cord, plug or after the appliance malfunctions or has been dropped or damaged in any manner. Return to a qualified electrical person for examination, electrical or mechanical adjustment, service or repair.
- Do not operate appliance with wet hands.
- The most common cause of overheating is deposits of dust or fluff in the appliance. Ensure these deposits are removed regularly by unplugging the appliance and vacuum cleaning air vents and grilles.
- Do not use this appliance near a window as rain may cause electric shock.
- Do not use abrasive cleaning products on this appliance. Clean with a damp cloth (not wet) rinsed in hot soapy water only. Always remove plug from the mains supply before cleaning.
- Do not connect the appliance to the mains voltage until completely assembled and adjusted.
- This appliance is not intended for use in outdoor locations.
- Do not use this appliance in the immediate surrounds of a bath, a shower or a swimming pool or other liquids.
- Always operate upright.
- Do not operate with cord coiled up as a buildup of heat is likely, which could be sufficient to become a hazard.
- The use of an extension cord with this appliance is not recommended.
- Do not remove plug from power socket until the appliance has been switched off.
- Do not remove plug from power socket by pulling the supply cord-always grip plug.
- Always unplug appliance when not in use.
- **CAUTION:** This products NOT suitable to be used oblong pile carpets or Flokati rugs.
- Do not allow cord to come in contact with heated surface during operation.
- Do not run cord under carpeting, throw rugs or runners etc. Arrange cord away from traffic areas so that it will not be tripped over.
- Do not twist, kink or wrap the cord around the appliance, as this may cause the insulation to weaken and split. Always ensure that all cord has been removed from any cord storage area.
- Do not use outdoors or whilst standing on a damp floor.

- Do not store appliance while it is still hot.
- This appliance is not intended for use by young children or infirm persons without supervision.
- Young children should be supervised to ensure they do not play with the appliance.
- The appliance must not be located immediately below a socket-outlet.
- Do not use this appliance with another programmer, timer or any other device that switches the heater on automatically, since a fire risk exists if the appliance is covered or positioned incorrectly.
- All covers on this appliance are intended to prevent direct access to the heating elements and must be in place when the appliance is in use.
- **WARNING:** In order to avoid overloading, do not cover the heater.
- To reduce the risk of electric shock, do not immerse or expose the product or flexible cord to rain, moisture or any liquid other than those necessary for correct operation of the product.  
The fireguard does not give full protection for young children and for infirm persons. If the supply cord is damaged, it must be replaced by a qualified electrical person to avoid a hazard.
- Do not use this appliance outdoors or on wet surfaces avoid spilling liquid on the appliance.
- **CAUTION:** In order to avoid a hazard due to inadvertent resetting of the thermal cutout, this appliance must not be connected to an external switching device, such as a timer, or connected to a circuit that is regularly on and off by the utility.
- Use this appliance only as described in this manual.  
Any other use is not recommended by the manufacturer and may cause fire, electric shock or injury.
- This appliance is intended for domestic use.



**Warning:** Very hot surface



**Important:** Do not cover

### **Products are covered by a 5-year parts & labour warranty**

For more information please contact:

**AUSTRALIA:** email: [sales@limpiasplendid.com.au](mailto:sales@limpiasplendid.com.au), PH +61 (03) 9563 2778

**NEW ZEALAND:** email: [admin@keyserviceltd.co.nz](mailto:admin@keyserviceltd.co.nz), PH +64 (09) 916 0960

- DO NOT cover the heater when it is working.
- Always store the heater when not in use.
- Make sure the heater has cooled down before storing it away.
- **REPLACEMENT OF SUPPLY CORD**

The supply cord damaged must be replaced by a service agent or equivalent qualified person in order to prevent a hazard.

- **Storage**

If you do not plan to use the heater for extended periods of time, it is recommended that the heater is cleaned and then stored (preferably in its original packaging) in a cool dry place.

## **Mounting Guide**

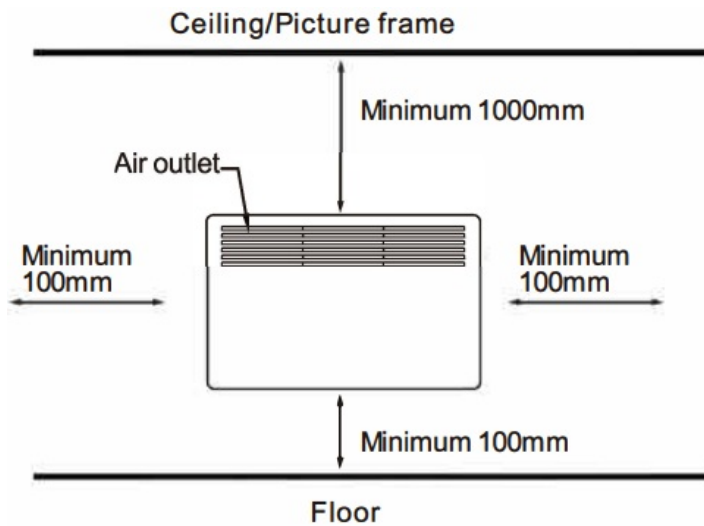

This heater **MUST** be installed to the **minimum** required distances at the **four sides** of the heater.

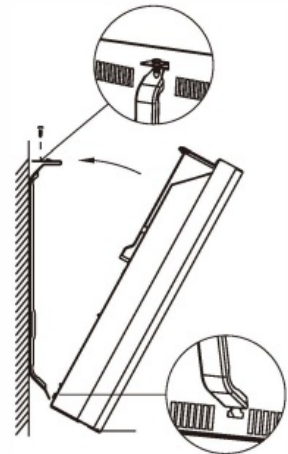
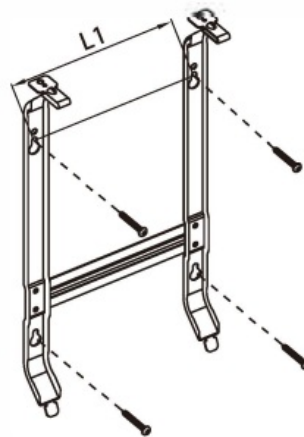
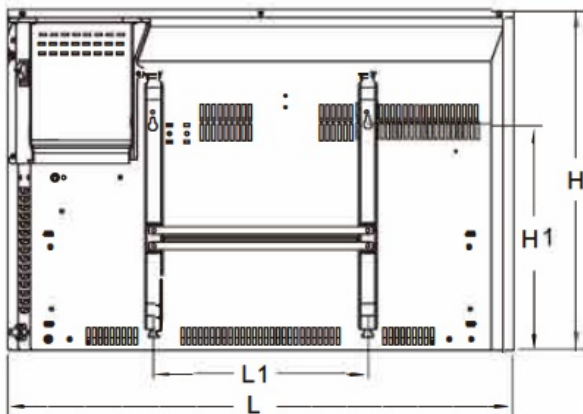

1. Insert the bracket(to the hole), turn it anticlockwise 90°, fasten it with screw;
2. Press the rubber pad (in the hole), fasten it with screw.

### Frost protection

The heater has a built-in frost protection mode which will not allow the temperature of its surroundings to drop below 5°C. This feature will operate regardless of any settings that have been selected on the heater. The only way to prevent this feature operating is to switch off the heater at the main switch (not standby).

### Maintenance

The heater should be inspected and cleaned periodically, attention should be given to the inlet grilles at the base of the unit and the outlet louvres at the front of the heater. Ensure they are cleared of dust or other debris that may cause a blockage and in turn reduce the airflow in and out of the heater, which if unchecked may lead to the unit running at hotter temperatures.

- Ensure the heater is isolated from the power supply and has fully cooled down before commencing any cleaning of the heater.
- Use a soft brush or vacuum cleaner to gently remove any debris from the inlet grilles and outlet louvres.
- Use a non-abrasive, damp cloth with soapy water to clean the main body of the heater. Take care not to use excessive amounts of water that could run into main body of the heater.

Sooty deposits can adhere to the louvres of the heater and the surrounding surfaces of the heater install. This can be caused by excess dust in and around the heater burning off the heating element after prolonged periods of use. This does not indicate an over-heat occurrence and the effects can be reduced with regular cleaning of the

heater.

## CLEANING INSTRUCTIONS

The heater requires regular cleaning to ensure trouble-free operation:

- Unplug the heater from the mains supply before cleaning.
- Ensure that the heater has been allowed to cool down completely before cleaning.
- Use a damp cloth (not wet) to wipe the exterior of the heater to remove dust and dirt.
- Use a vacuum cleaner to remove dust and fluff from around the grilles.
- Ensure the heater is dry before plugging back into the mains supply.

## Warning

1. Fix the heater correctly on the wall or place the heater in the correct position.
2. The heater should be installed so that the controls cannot be touched by a person using a bath or shower.
3. The heater should be installed so that it is not located directly under a socket outlet.
4. When the heater is free standing, please do not use it in close proximity of a bath, shower or swimming pool.
5. When the heater is wall mounted, please do not use it in close proximity of a bath, shower or swimming pool.
6. Consult a qualified electrician or service technician if the power cord is damaged.

## Overview of the appliance

Fig.1

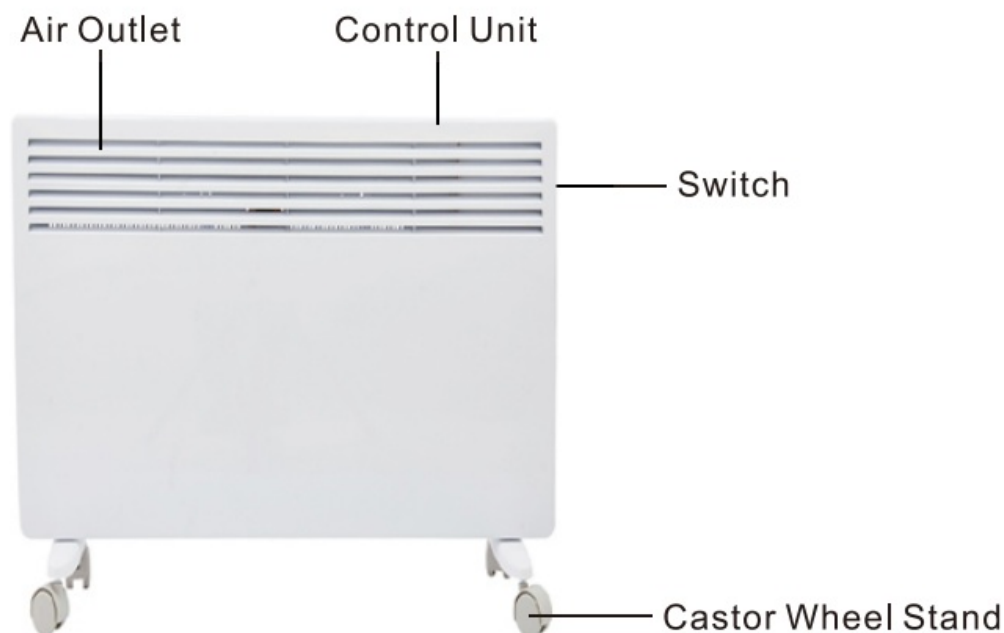

## Specifications

Model Number	NDM-15WT	NDM-20WT	NDM-24WT
Rated Power	750W/1500W	1000W/2000W	1200W/2400W
Rated Voltage	220V-240V-50Hz		
Dimensions(mm)	690 x 107 x 400	830 x 107 x 400 1950 x 107 x 400	

## 1. Circuit Diagram

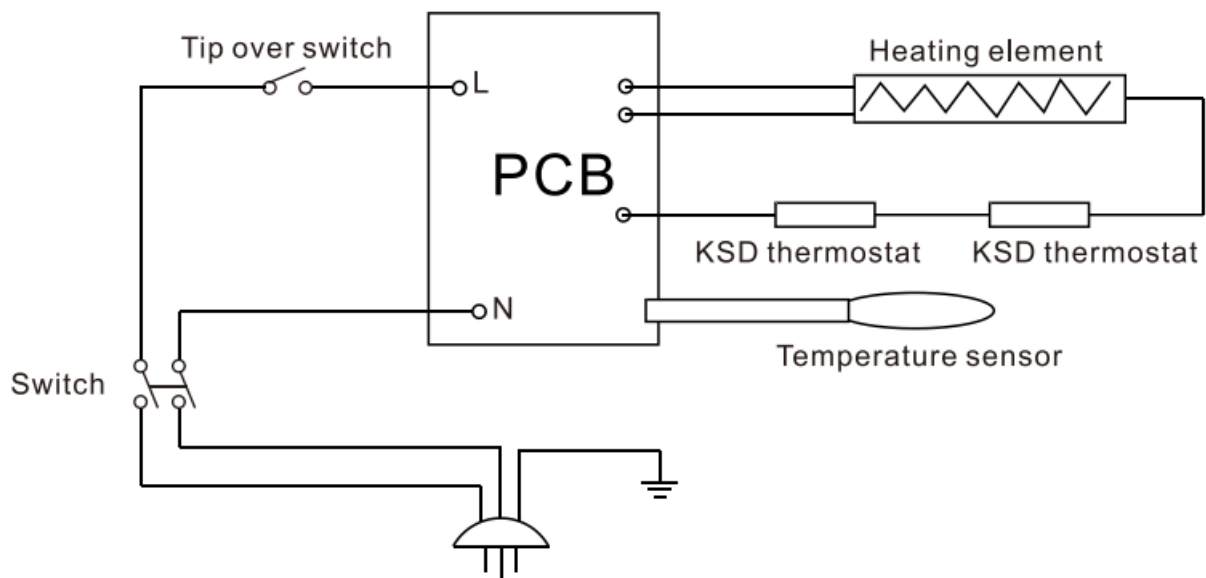

## 2. Operation



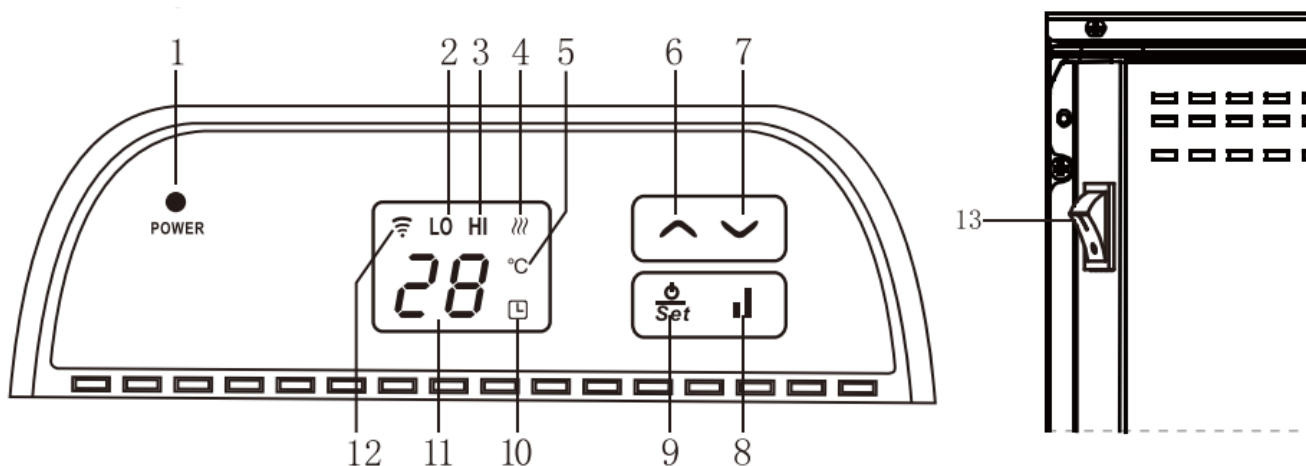









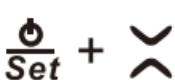

### Control panel overview

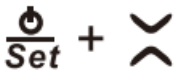

1. Power Light
2. Low Power Active
3. High Power Active
4. Heating Indicator
5. Temperature °C Indicator
6. Up Select
7. Down Select

8. Full/Half Power Select
9. Power & Setting Button
10. Timer Indicator
11. Time Display
12. Wi-Fi Display
13. Power Switch

## Operation:

Function	Control Panel overview	Interpretation
Turn on		Press to turn on the heater.
Turn off		Hold for 3 seconds to turn off the heater.
Full/Half power select		Press the full/half power select button to toggle between the settings. The current setting will be displayed by either the “LO” or “HI” icon on the display.
Target temperature setting		Press “  Set” firstly, then select “  ” or “  ” to set target temperature, the temperature setting range is 5 to 45°C.
Timer setting		Press “  Set” twice , then select “  ” or “  ” to set timer, the timer range is 0-24 hours.
Child lock		Press and hold “  ” and “  ” at the same time for 3 seconds to set or cancel the child lock function.
WIFI reset		Press and hold the Full/Half Power Select button to reset the Wi-Fi.

### Open Window Detection

When the heater is in operation it is automatically in open window detection mode and will shutdown if the ambient temperature rapidly falls below 3 degrees or more. If the heater has detected an open window the °C icon will flash, the heater will make a beeping sound and cease heating. You will then need to start the device up again to reactive heating.

### Troubleshooting

1. E1-Temperature sensor error, with 5 beeping sounds.
2. E3-Overheat event, with 5 beeping sounds

### 1. Download APP

Scan the QR code below for a simple download using your smart device.

Alternatively, search ‘Smart Life’ on your device application store to download.



<https://smartapp.tuya.com/smartlife>

### 2. Connect Heater

1. Enter the interface.
2. Click the + icon in the upper right-hand corner or alternatively press Add Device.



3. Go to Small Home Appliances and select Heater.
4. Enter the corresponding password to the chosen Wi-Fi network account.
5. Check that the Wi-Fi icon is blinking on the device and tick the 'Confirm indicator rapidly blinking' box. If the indicator is not blinking reset the Wi-Fi (see Operation Instructions).
6. Set the device information and press Done to enter the control interface where you will now be able to control the heater.

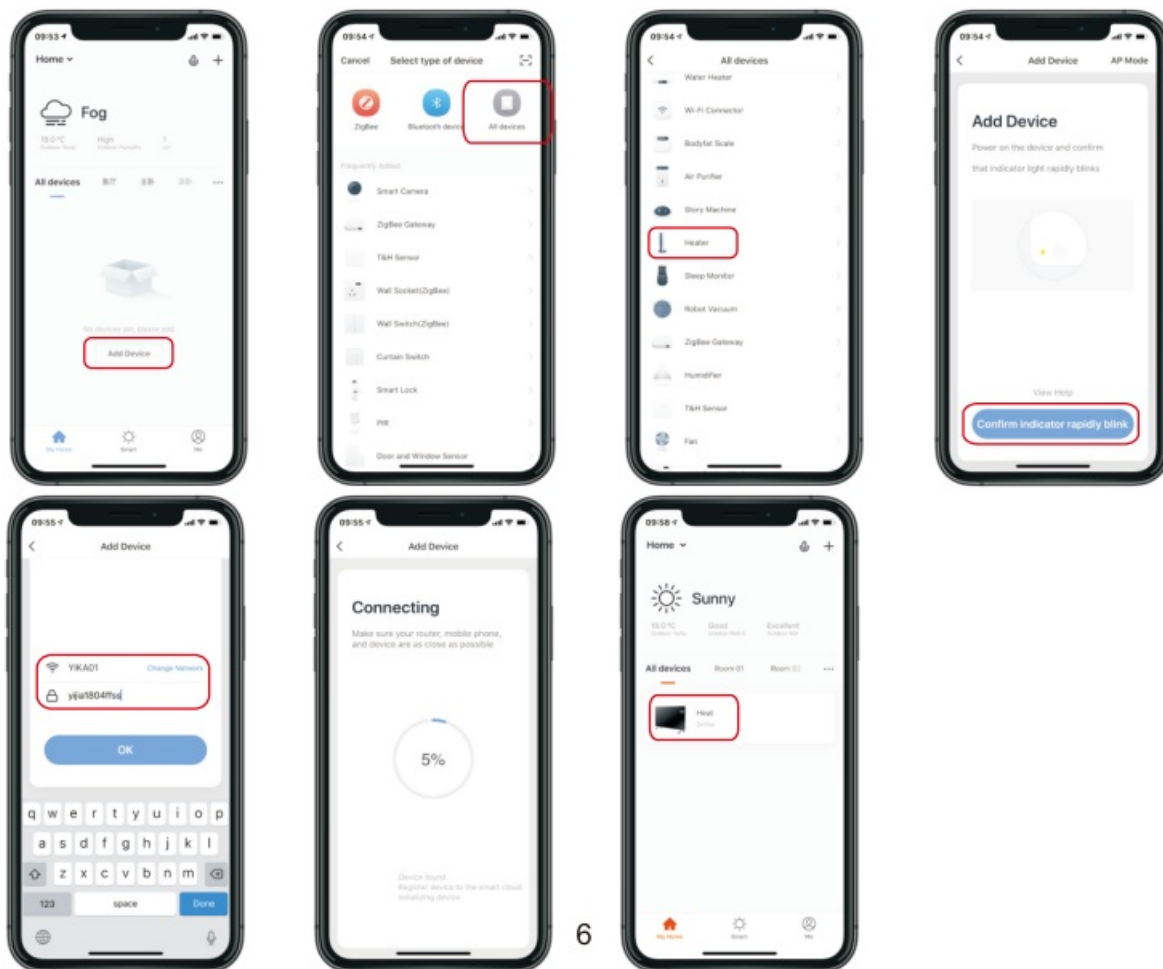

6



## Documents / Resources

	<a href="#">OLIMPIA SPLENDID NDM-15WT Convector Heater</a> [pdf] Instruction Manual NDM-15WT, NDM-20WT, NDM-24WT, NDM-15WT Convector Heater, NDM-15WT, Convector Heater, Heater
---	--