



OLIMPIA SPLENDID CALDORAD 9 Turbo Timer Suitable For Well Insulated Spaces or Occasional Instruction Manual

[Home](#) » [OLIMPIA SPLENDID](#) » OLIMPIA SPLENDID CALDORAD 9 Turbo Timer Suitable For Well Insulated Spaces or Occasional Instruction Manual 

Contents

- 1 OLIMPIA SPLENDID CALDORAD 9 Turbo Timer Suitable For Well Insulated Spaces or Occasional
- 2 Instructions for Use
- 3 WARNINGS
 - 3.1 General information
 - 3.2 SYMBOLS
 - 3.3 EDITORIAL PICTOGRAMS
 - 3.4 GENERAL WARNINGS
 - 3.5 PROPER USE
 - 3.6 UNINTENDED AND POTENTIALLY DANGEROUS USE
- 4 DESCRIPTION OF THE APPLIANCE AND OF THE COMMANDS
- 5 INSTALLATION
- 6 USE
- 7 OPERATION
 - 7.1 “FAN” MODE
 - 7.2 “TIMER” MODE
- 8 OVERHEAT PROTECTION
- 9 SAFETY CONTROL (TIP OVER SWITCH)
- 10 MAINTENANCE AND CLEANING
- 11 PRESERVATION OF THE APPLIANCE
- 12 TECHNICAL DATA
- 13 customer support
- 14 Documents / Resources
 - 14.1 References
- 15 Related Posts

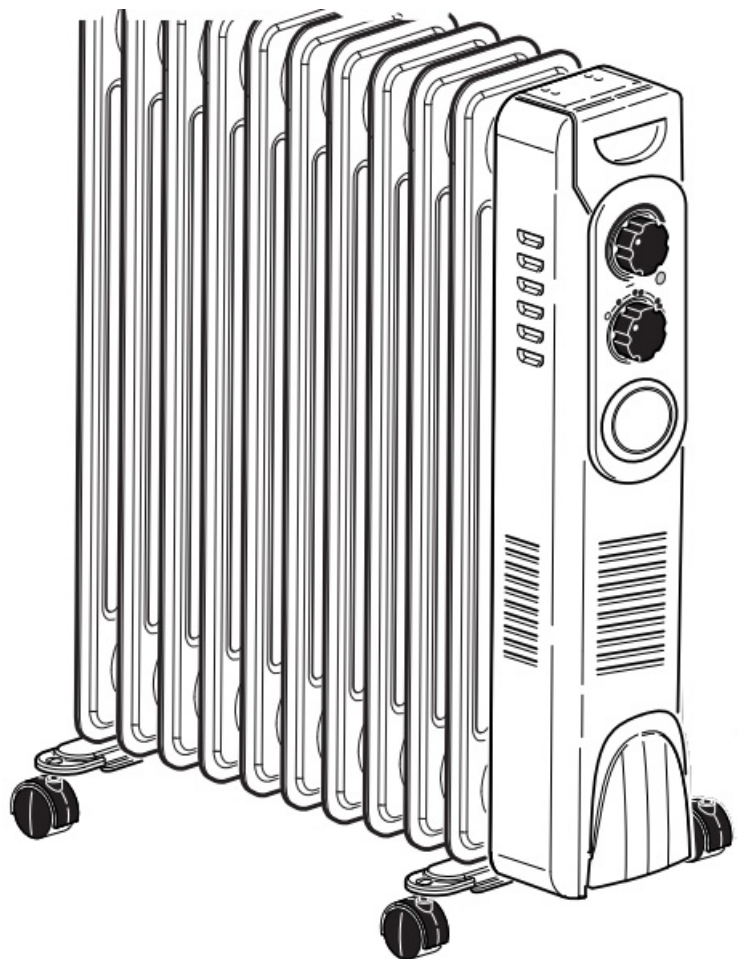

Instructions for Use

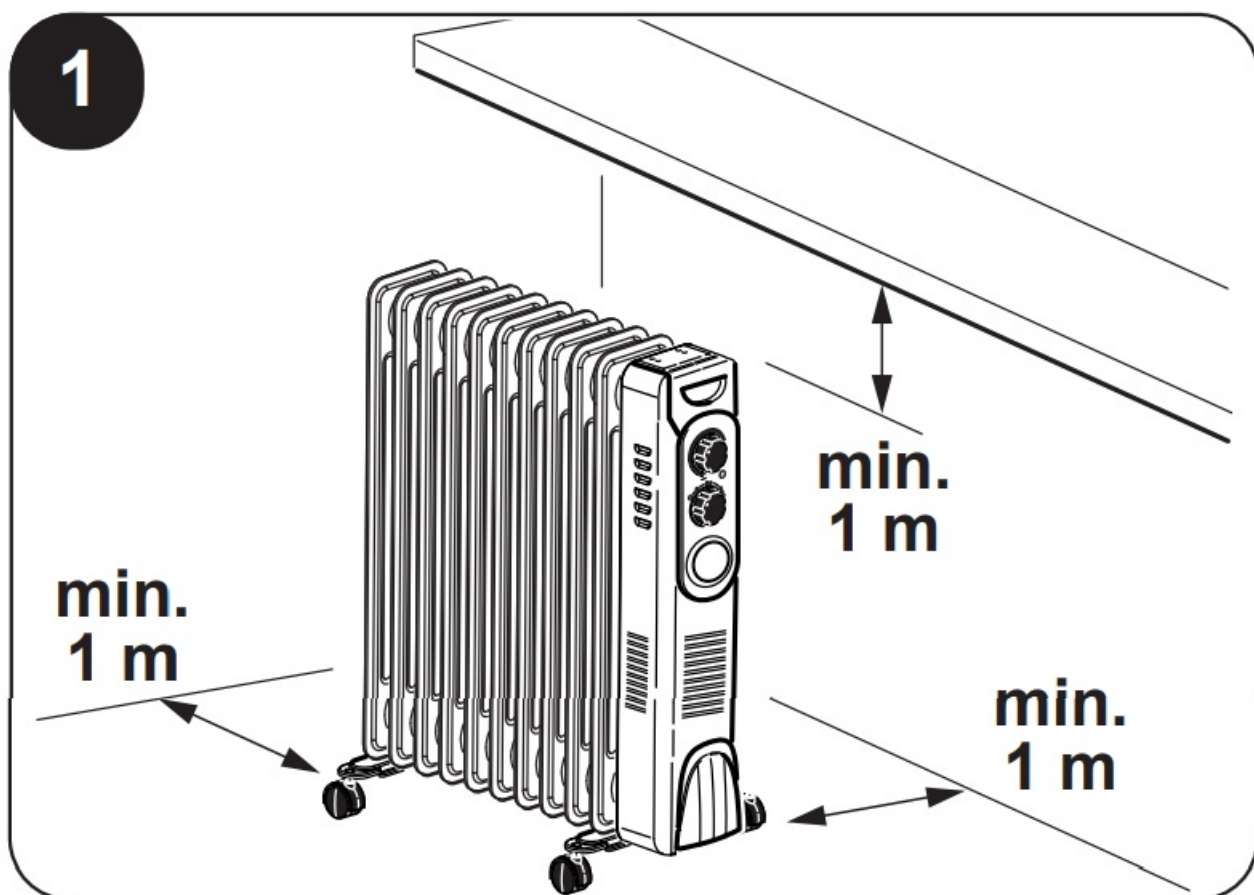

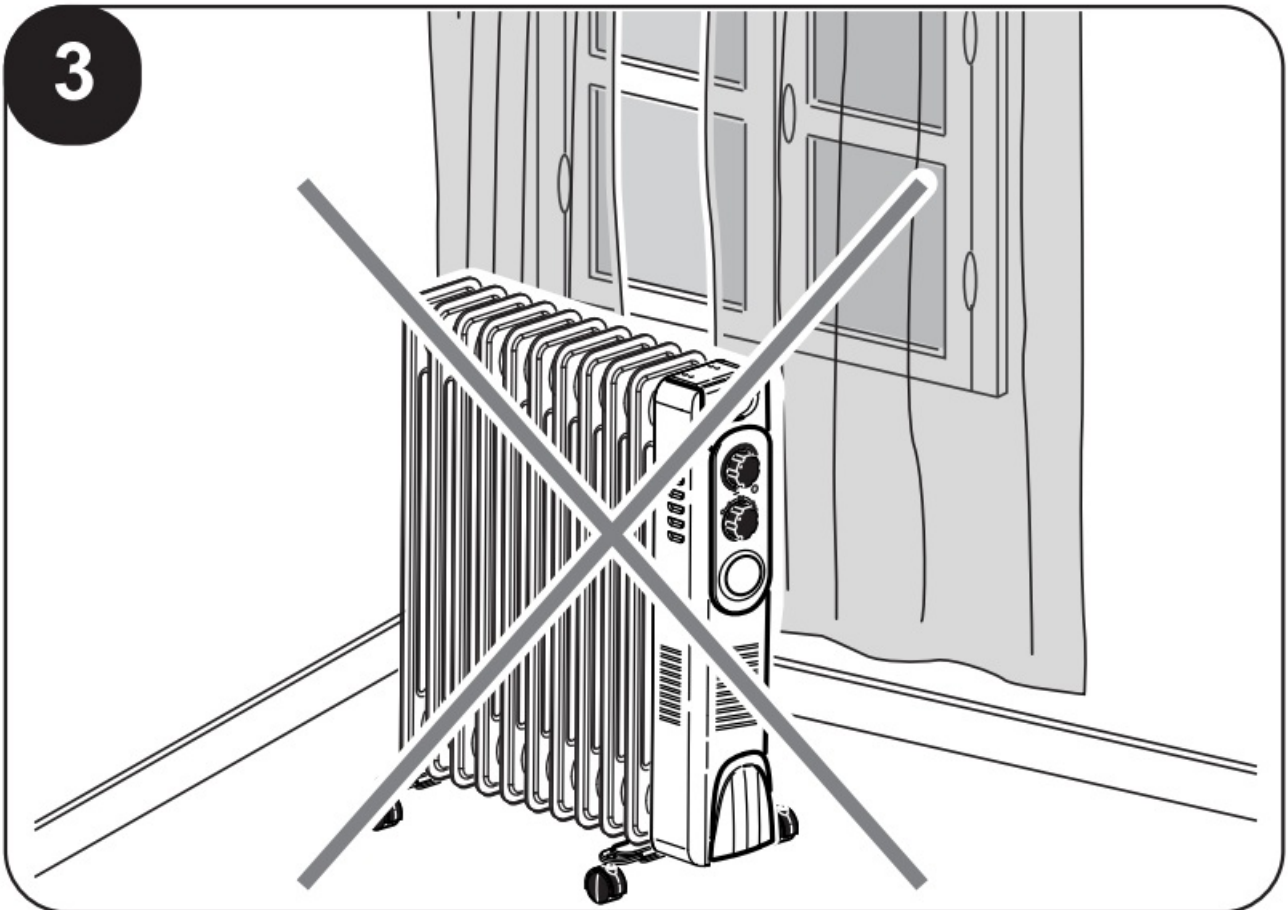
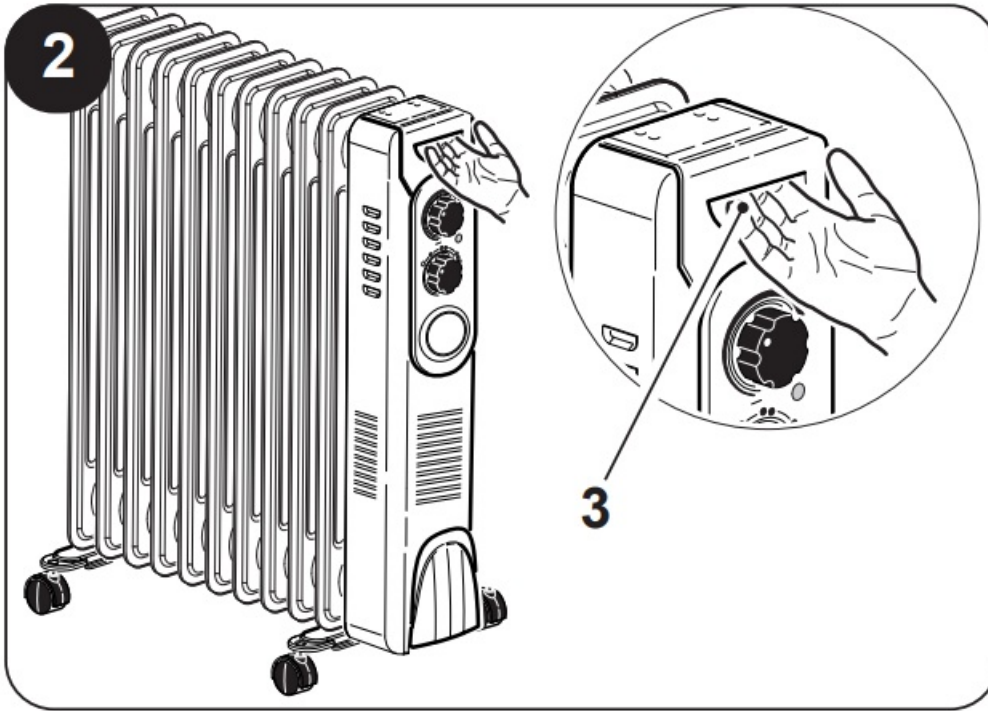

4

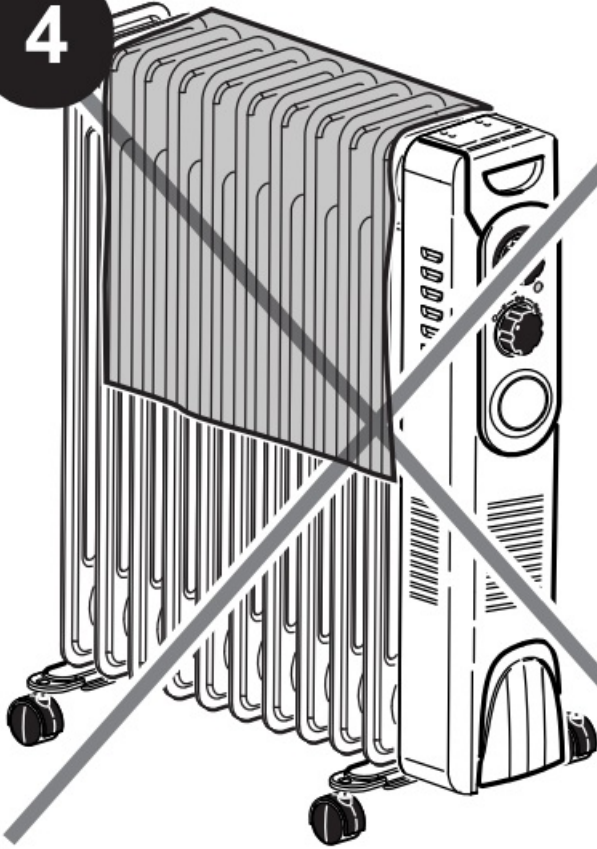

DO NOT COVER

5

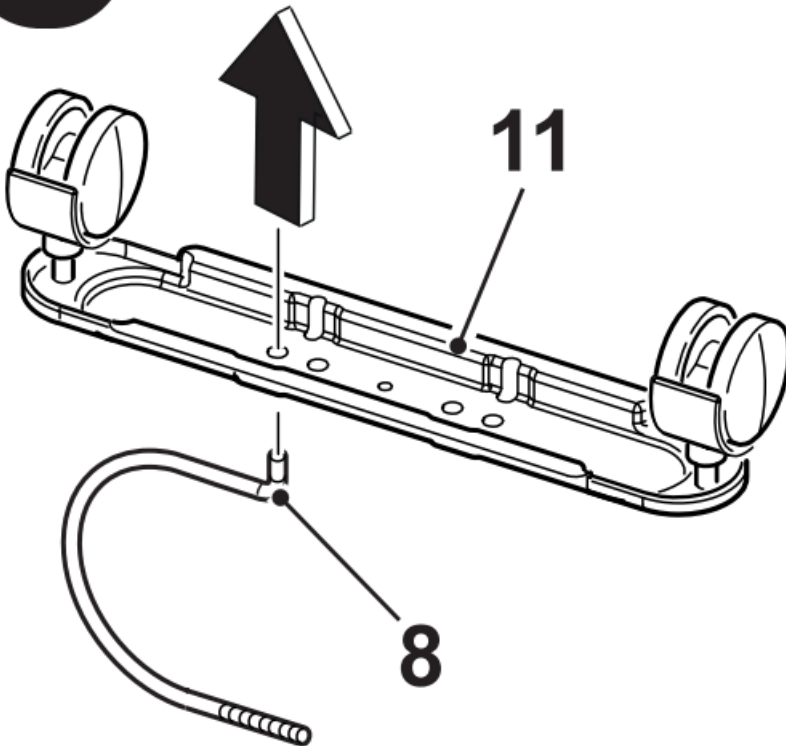

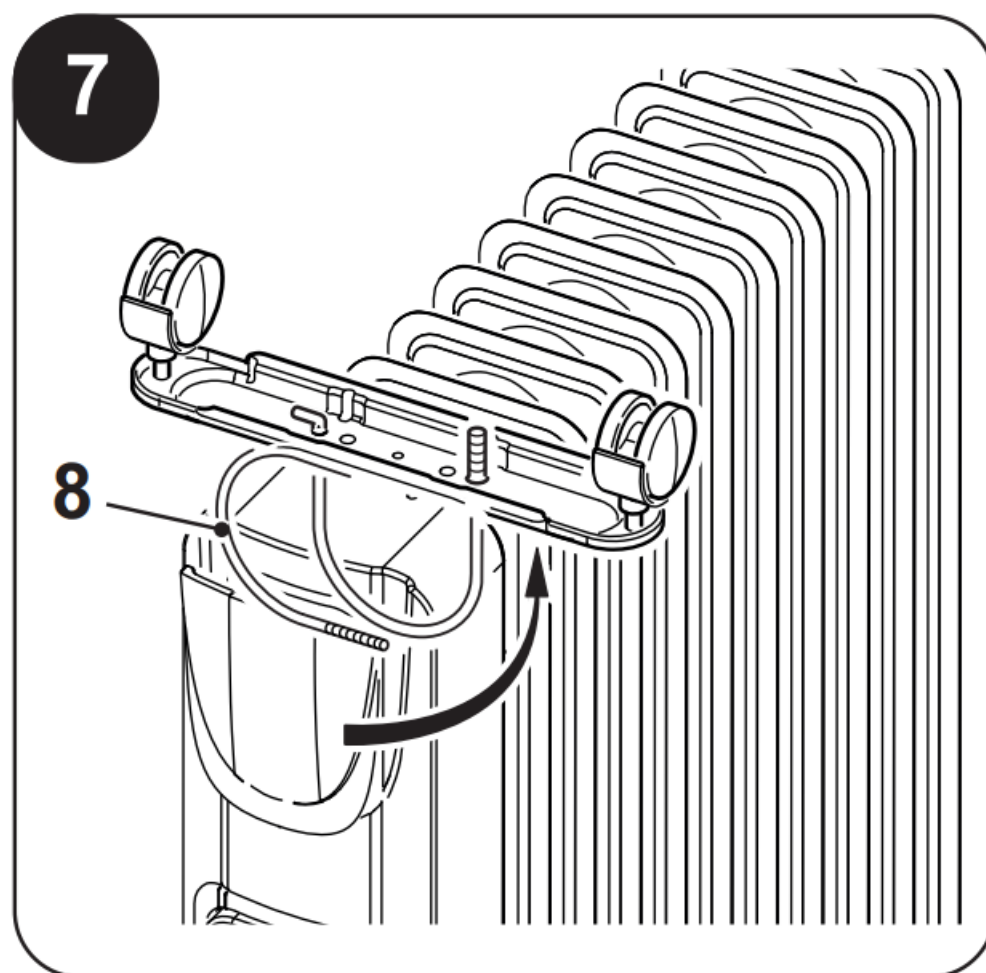
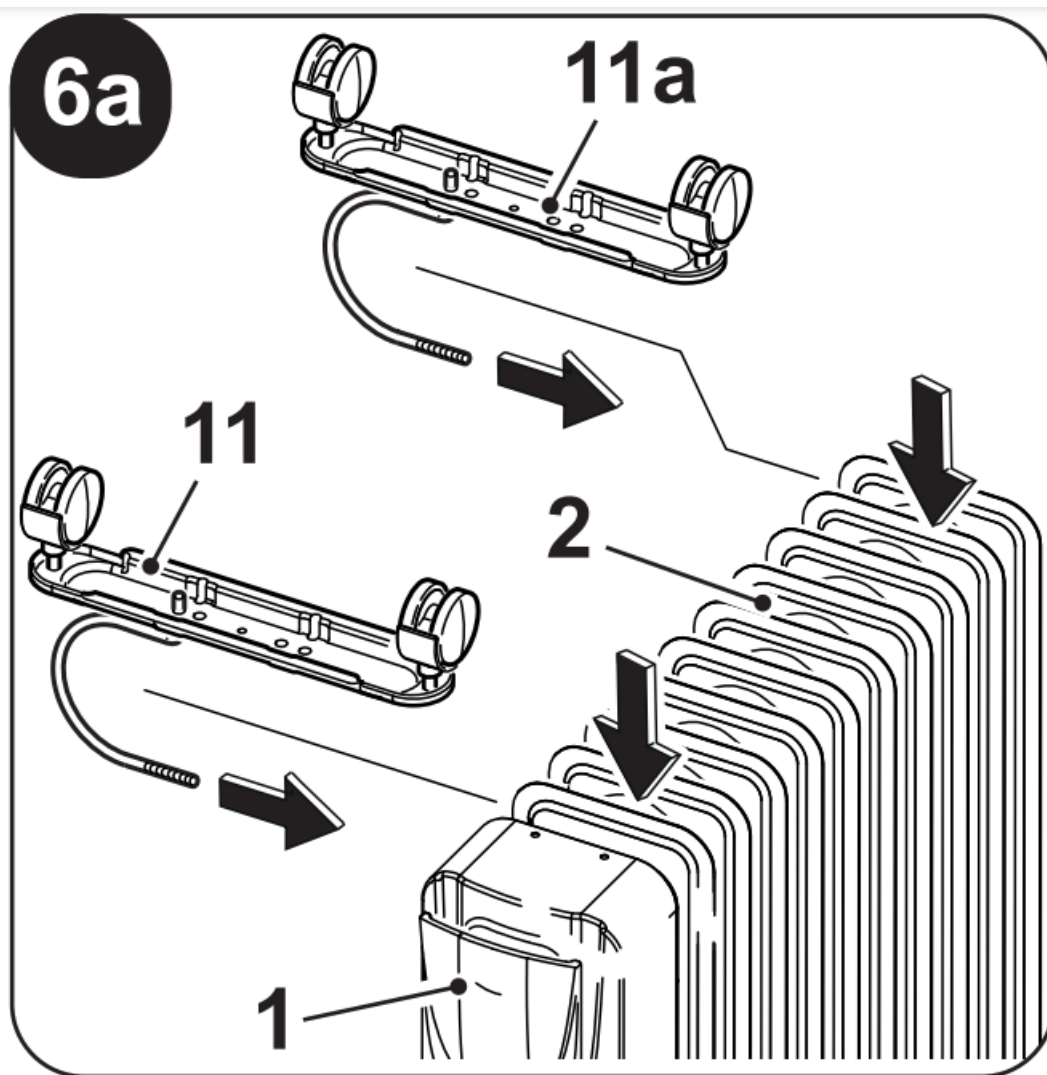

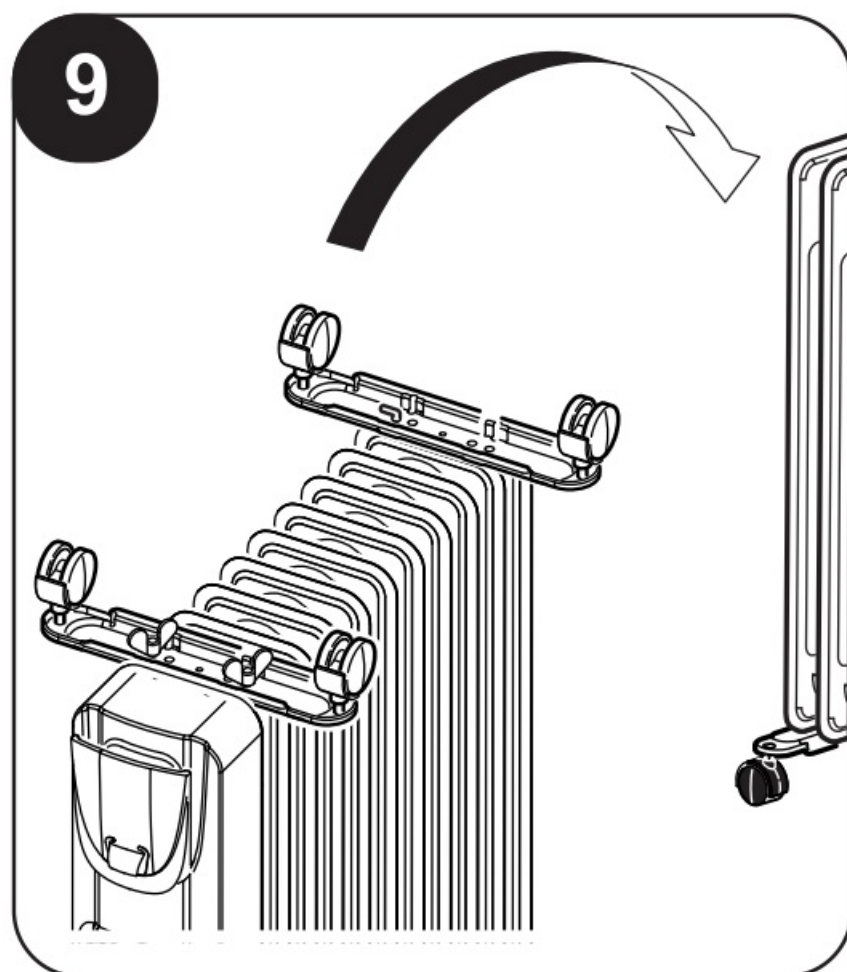
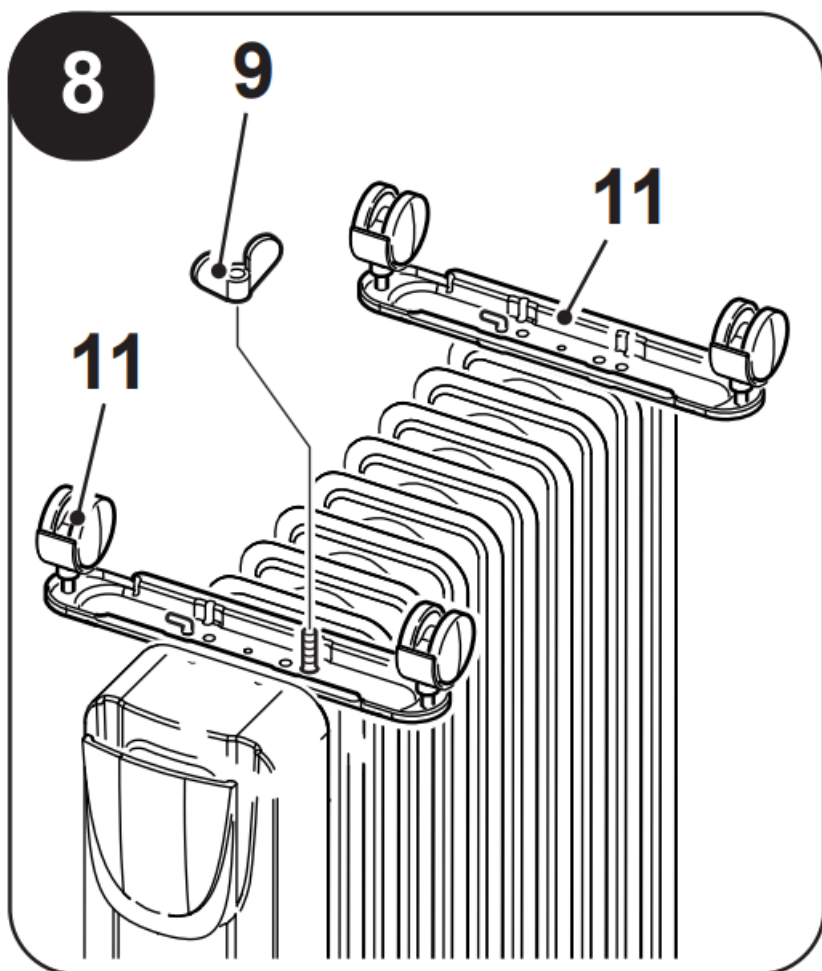



DISPOSAL

This symbol on the product or its packaging indicates that the appliance cannot be treated as normal domestic trash, but must be handed in at a collection point for recycling electric and electronic appliances.

Your contribution to the correct disposal of this product protects the environment and the health of your fellow men. Health and the environment are endangered by incorrect disposal. Further information about the recycling of this product can be obtained from your local town hall, your refuse collection service, or in the store at which you bought the product. This regulation is valid only in EU member states.

WARNINGS

General information

First of all, we would like to thank you for choosing our appliance.

SYMBOLS

The pictograms in the next chapter provide the necessary information for correct, safe use of the machine in a rapid, unmistakable way.

EDITORIAL PICTOGRAMS



Service

Refers to situations in which you should inform the SERVICE department in the company:

CUSTOMER TECHNICAL SERVICE.



Index

Paragraphs marked with this symbol contain very important information and recommendations, particularly as regards safety. Failure to comply with them may result in:

- danger of injury to the operators
- loss of the warranty
- refusal of liability by the manufacturer.



Raised hand

Refers to actions that absolutely must not be performed.



HAZARD

Indicates that the appliance uses inflammable refrigerant. If the refrigerant escapes and is exposed to a source of external ignition, there is a fire risk.



DANGER OF HIGH VOLTAGE

Signals to the personnel that the operation described could cause electrocution if not performed according to the safety rules.



GENERIC DANGER

It informs the personnel concerned that if the operation is not carried out in compliance with the safety regulations, it presents the risk of suffering physical damage.



DANGER DUE TO HEAT

It informs the personnel concerned that if the operation is not carried out in compliance with the safety regulations, it presents the risk of burns due to contact with components at very high temperatures.



DO NOT COVER

Indicates to the personnel concerned, that it is prohibited to cover the appliance, to prevent over-heating.



ATTENTION

- Indicates that this document must be read carefully before installing and/or using the appliance.
- Indicates that the assistance personnel must handle the appliance following the installation manual.



ATTENTION

- Indicates that there may be additional information in attached manuals.
- Indicates that information is available in the user manual or in the installation manual.



ATTENTION

Indicates that the assistance personnel must handle the appliance following the installation manual.

GENERAL WARNINGS

WHEN USING ELECTRICAL EQUIPMENT, BASIC SAFETY PRECAUTIONS MUST ALWAYS BE FOLLOWED IN ORDER TO REDUCE RISKS OF FIRE, ELECTRIC SHOCKS AND INJURY, INCLUDING THE FOLLOWING:

1.  This document is restricted in use to the terms of the law and may not be copied or transferred to third parties without the express authorization of the manufacturer, OLIMPIA SPLENDID.
Our appliances are subject to change and some parts may appear different from the ones shown here, without this affecting the text of the manual in any way.



2. Read this manual carefully before performing any operation (installation, maintenance, use) and follow the instructions contained in each chapter.
3. Keep the manual carefully for future reference.



4. After removing the packaging, check that the appliance is in perfect condition. The packaging materials must not be left within reach of children as they can be dangerous.
5. THE MANUFACTURER IS NOT RESPONSIBLE FOR DAMAGES TO PERSONS OR PROPERTY CAUSED BY FAILURE TO FOLLOW THE INSTRUCTIONS IN THIS MANUAL.

6. The manufacturer reserves the right to make any changes it deems advisable to its models, although the essential features described in this manual remain the same.



7. Before connecting, make sure that the plate data corresponds with the mains electrical supply. Connect the appliance to a single-phase power supply in AC at the voltage indicated on the nameplate located on the appliance.



8. Install it according to the manufacturer's instructions. An incorrect installation can cause damage to people, animals or property for which the manufacturer accepts no responsibility.

9. Use the appliance on a horizontal and stable surface or secure it to the wall, depending on the cases.

10. Always unreel the cable completely during use.

11. The appliance is equipped with a power cord with plug (Y-type connection). If the power cord is damaged, it must be replaced by the manufacturer, his technical service or a similarly qualified person in order to eliminate all possible risks.



12. Install it in such a way that the switches and other controls cannot be reached by persons using the bath or shower.

13. Do not use extensions, if not with particular care.

14. To avoid the risk of fire, keep the air outlets of the appliance at a distance of at least 1 m from any object, fabric or flammable materials (fig. 1).

15. Do not place appliance close to a radiant heat source.

16. Do not use the appliance to dry clothes.



17. Do not insert or allow foreign objects to enter any ventilation or exhaust opening, as this may cause an electric shock, fire or damage to the appliance.

18. Do not allow cord to come in contact with heated surfaces during operation.

19. Do not run cord under carpeting, throw rugs or runners etc. Arrange cord away from traffic areas so that it will not be tripped over.

20. Do not twist, kink or wrap the cord around the appliance, as this may cause the insulation to weaken and split.

21. Do not store appliance while it is still hot.



22. Do not use this appliance outdoors, or on wet surfaces. Avoid spilling liquid on the appliance.

23. The appliance must not be used in rooms whose floor area is lower than 5 m².

24. This heater is intended for floor use only. Do not mount on ceiling.

25. Do not operate the heater near curtains, as the material could be sucked into the air vents. (fig. 3).



26. It is forbidden to dispose of or leave in the reach of children the packaging materials which could become a source of danger.



27. It is forbidden for the appliance to be used by children or unassisted disabled persons.



28. The appliance may be used by children over 8 years of age and by persons with reduced physical, sensory or mental capacities, or without the required experience or knowledge, provided they are supervised or have been instructed in the safe use of the appliance and understand the hazards involved.



29. Children must not play with equipment. Children must not be allowed to clean the appliance or perform user maintenance without proper supervision.



30. Children of less than 3 years should be kept away unless continuously supervised.



31. Children aged from 3 years and less than 8 years shall only switch on/off the appliance provided that it has been placed or installed in its intended normal operating position and they have been given supervision or instruction concerning the use of the appliance in a safe way and understand the hazards involved.



32. Children aged from 3 years and less than 8 years shall not plug in, regulate and clean the appliance or perform user maintenance.



33. Do not use this heater in the immediate surroundings of a bath, a shower or a swimming pool.



34. Some parts of this product may become very hot and could cause burns. Be very careful when children or vulnerable adults are nearby.



35. **WARNING:** in order to avoid overheating, do not cover the heater (fig. 4).

36. For correct use of the appliance **NEVER:**

- a. Place it immediately underneath a mains wall socket.
- b. Pull the power cable or the appliance itself to remove the plug from the mains socket.
- c. Leave it expose to atmospheric agents (rain, sun, etc.).
- d. Leave it plugged in when not in use.
- e. Touch it with wet or damp hands.

37. Use this appliance only as described in this manual. Any other use is not recommended by the manufacturer and may cause fire, electric shock or injury.



38. The most common cause of overheating is deposits of dust or fluff in the appliance. Ensure these deposits are removed regularly by unplugging the appliance and vacuum cleaning air vents and grilles.

39. Do not use abrasive cleaning products on this appliance. Clean with a damp cloth (not wet) rinsed in hot soapy water only. Always remove plug from the mains supply before cleaning.

40. Do not connect the appliance to the mains voltage until completely assembled and adjusted.
41. Switch off and use handles where provided when moving (fig. 2).
42. Do not immerse the appliance in water or in other liquids. Short circuits or fires may occur.
43.  Do not let the appliance work in enclosed areas such as a cabinet since it could cause a fire.
44. If the appliance's plug is incompatible with the socket, have the socket replaced with a suitable one by a qualified technician, who must ascertain that the section of the socket cables is compatible with the power absorbed by the appliance. We do not recommend using adaptors and/or extension cables. If they cannot be avoided, however, they must comply with current safety regulations and their ampacity (A) must not be below the maximum ampacity of the appliance.
45. Do not use the appliance in case of malfunctioning or faults, if the cord or plug are damaged, or if it has been dropped or damaged in any manner. Turn the appliance off, disconnect the plug from the socket and let it be checked by professionally qualified personnel.
46. Disassembly, repair or reconversion performed by an unauthorized person could cause heavy damages and will cancel the manufacturer warranty.
47. Neither disassemble nor modify the appliance.
48. Repairing the appliance by yourself is extremely dangerous.
49. Do not use this appliance in small rooms occupied by persons which are not able to leave it autonomously unless constant supervision is supplied.
50. Do not remove plug from power socket until the appliance has been switched off.
51. After removing the packing, make sure that the appliance is complete, without visible damage that could have been caused during transport. In case of doubt, do not use the appliance and contact the authorised Technical Assistance centres.
52. When left unattended, always disconnect from the power supply.
53. If you no longer wish to use this appliance, it must be made inoperative by cutting the power supply cable after removing the plug from the power socket. Hazardous parts of the appliance must be rendered harmless, especially as there is a risk of children playing with it.
54. At first use and after a long period of inactivity of the appliance, a slight noise may be heard and a slight odour may be smelled. It is a normal phenomenon which will disappear after a few minutes of operation.
55. The appliance is filled with a precise quantity of special oil.
56. Repair requiring opening of the oil container are only to be made by the manufacturer or his service agent who should be contacted if there is an oil leakage.
57. Regulations concerning the disposal of oil when scrapping the appliance have to be followed.

PROPER USE

58. The appliance must be used exclusively as an electrical radiator with the only purpose of making the room where you are staying comfortable.
59. This appliance is only designed for domestic use or similar, not for commercial or industrial use.
60. An improper use of the appliance with possible damages caused to people, things or animals releases OLIMPIA SPLENDID from any responsibility.

UNINTENDED AND POTENTIALLY DANGEROUS USE

61. Do not use the appliance in areas in which are used or stored petrol, varnishes or other flammable liquids or in

environments with the presence of flammable or explosive gases.

62. Do not use the appliance if insecticide gas has just been sprayed in the room or in the presence of burning incenses, chemical vapours or oily residues.



This product must be used exclusively according to the specifications indicated in this manual. Use different to that specified, could cause serious injuries.

THE MANUFACTURER IS NOT LIABLE FOR INJURY/DAMAGE TO PERSONS/OBJECTS DERIVING FROM FAILURE TO COMPLY WITH THE REGULATIONS CONTAINED IN THIS MANUAL.

DESCRIPTION OF THE APPLIANCE AND OF THE COMMANDS

1. Appliance body
2. Radiator fin
3. Handle
4. Cable plate
5. Mode selection knob 5a. Mode switch
6. Power cord
7. Use and maintenance booklet
8. "U" bracket (2 pieces)
9. Wing nut (2 pieces)
10. Wheel (4 pieces)
11. Wheel support (2 pieces)
12. Indicator light for appliance operational
13. Room temperature adjustment knob
14. ON/OFF knob

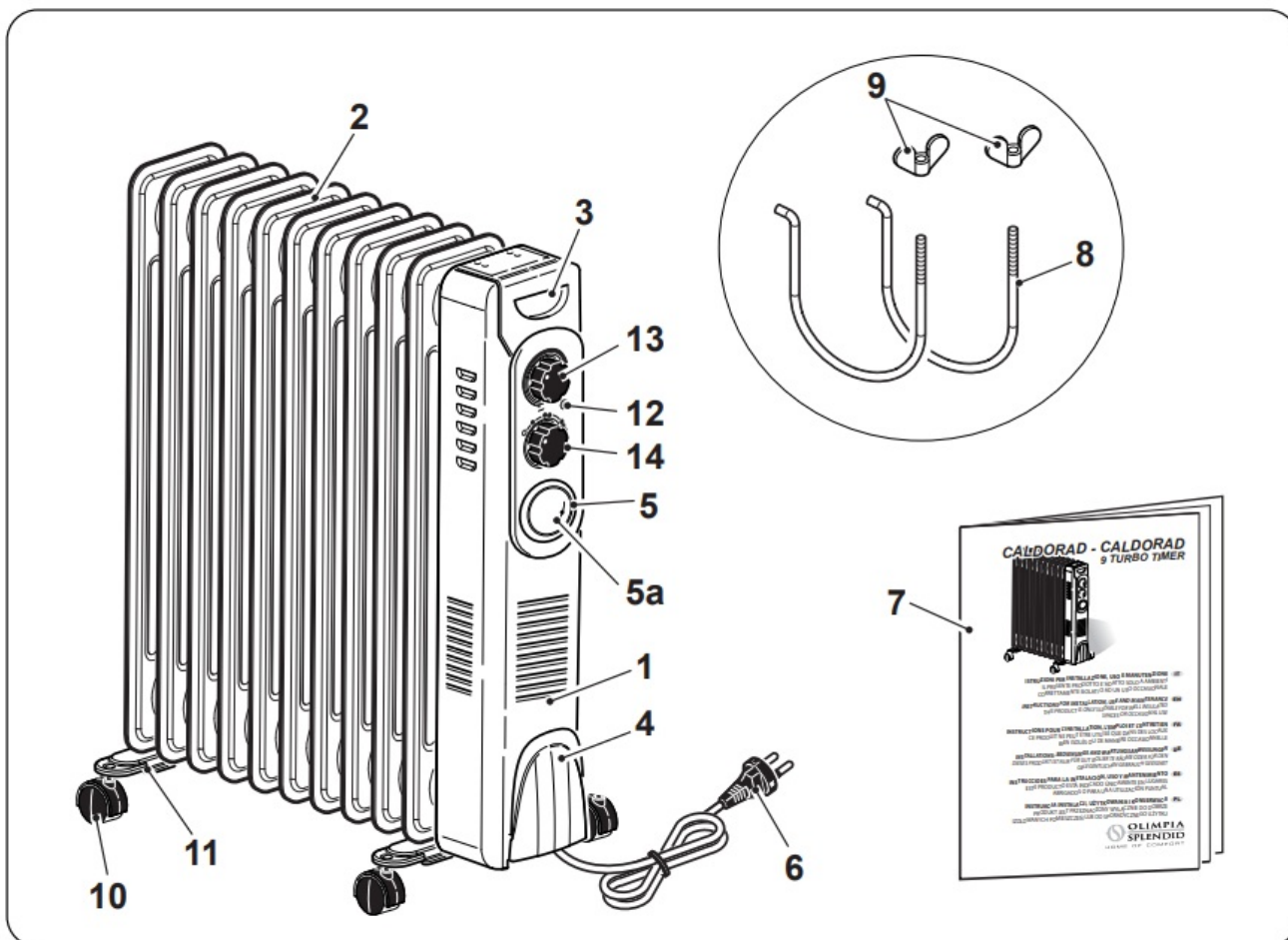

INSTALLATION

- After removing the packaging, check that the appliance is in perfect condition; in case of doubts do not use it and refer to professionally qualified personnel.
- Rotate the appliance upside down.



Place the appliance on a flat and stable surface, making sure it cannot be damaged or fall. Protect the support surface.

- Insert the brackets (8) in the supports (11) as shown in figure "5".
- Position the supports (11) and (11a) between the most external radiant wings (2) of the appliance (1) (fig. 6a).
- On model CALDORAD 7, lock the supports (11b) by screwing the screws (9b) (fig. 6b).
- Rotate the brackets (8) upwards (fig. 7).
- Lock the supports (11) by screwing the wing nuts (9) (fig. 8).
Do not tighten the wing nuts (9) excessively.
- Rotate the appliance to a vertical position (fig. 9).



- **Do not use the appliance without having mounted the supports and the wheels first.**
- **Only use the appliance in vertical position (handle "3" above); every other position may create a dangerous situation.**
- Entirely straighten the power cord.
- Place the appliance in an appropriate environment and on a stable and flat surface.

- Make sure that curtains or other objects do not obstruct the air flow (fig. 3).
- Leave at least 1 m of free space on the sides, behind the appliance and above it (fig. 1).



Make sure there is not any flammable or sensitive-to-heat object within 1 meter from the appliance.

- Make sure the knob (14) is set to “O” and the knob (13) is set to “MIN”.
- Connect the plug to the power socket.

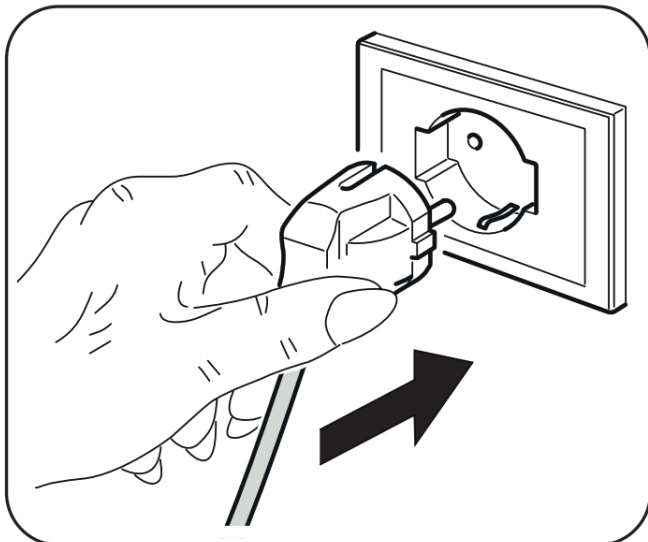

- Make sure the mains data correspond to what is described on the data plate of the appliance.
- Arrange cord away from traffic areas so that it will not be tripped over.

USE

Knob “14”

Knob set to “O” :	appliance OFF
“ECO-MODULATING” :	rotate the knob to “ ECO ” position
“MEDIUM POWER” :	rotate the knob to “ ● ” position.
“MAXIMUM POWER” :	rotate the knob to “ ● ● ” position.
“TURBO” :	rotate the knob to “ ● ● ✦ ” position.

Knob “13” – Thermostat

- Start the appliance by rotating the knob (14) to the desired power position; the indicator (12) lights up.
- To set the room temperature to a specific value (thermostation), rotate the knob “13” clockwise until it stops (position “MAX”).
- Once the desired temperature of the room has been reached, slowly rotate the knob “13” anticlockwise until the appliance switches off.
- At this point, the appliance will reactivate automatically when the room temperature lowers beyond the set limit and will switch off again once the room temperature reaches the set value.

Knob “5” – Mode

By means of the switch (5a) it is possible to select three different modes:

- Continuous mode “I”, it is possible to select the selected room temperature.
- Timer mode “⌚”, it is possible to set a timer for switching off of the appliance.
- Continuous mode “0”, it is possible to switch off the appliance.

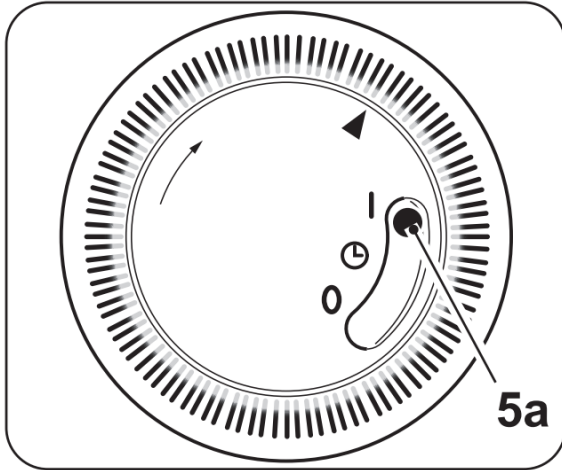

- To completely switch off the appliance:
- place the knob (14) to position “0”; the LED (12) switches off. Disconnect the plug from the power socket.

OPERATION

“FAN” MODE

- It is possible to select this mode by rotating the knob (14) up to symbol “”.

“TIMER” MODE

- This appliance is equipped with an interval timer (24h), the knob (5) is composed of 96 segments and each segment represents 15 minutes.
- Before proceeding with setting of the timer, current time MUST be set:
- Rotate the knob (5) clockwise by aligning the arrow with the current time.
- To set timer mode, proceed as described below:
- Push outwards the segments which represent the time in which the appliance must stay on.
- Push inwards the segments which represent the time in which the appliance must switch off.

Example:

To set the switching on at 5 a.m. and switching off at 6 a.m. push the 4 segments between 5 and 6 outwards.

- Set the switch (5a) to “⌚” to enable the timer.



If the switch (5a) is moved to the symbol “I”, the appliance starts to work continuous function deactivating

the “Timer” mode.



The settings of the “Timer” mode remain saved up to switching off of the appliance. If the plug is disconnected from the power socket, the current time does not update automatically. When the power plug is reconnected, current time **MUST** be set again as described above.

OVERHEAT PROTECTION

- This heater is protected with overheat protection that switches off the appliance automatically in case of severe overheating In this case:
- unplug the appliance;
- wait about 30 minutes for it to cool;
- remove any possible cause of overheating, eg. something covering the heater;
- check for damage to the appliance, the cord and the plug.

If there is no damage:

- plug the unit back in;
- switch it on as described above. If the heater still does not turn on, please contact Customer Service for assistance.

SAFETY CONTROL (TIP OVER SWITCH)

- If the product is fallen down or is installed upside down, due to the function of tip over switch, it will stop working automatically.

And when the product is put to the right upside position, it will start working as normal again.

MAINTENANCE AND CLEANING



Before performing any cleaning or maintenance intervention on the appliance, disconnect the plug from the power socket and wait for the fan to stop completely.

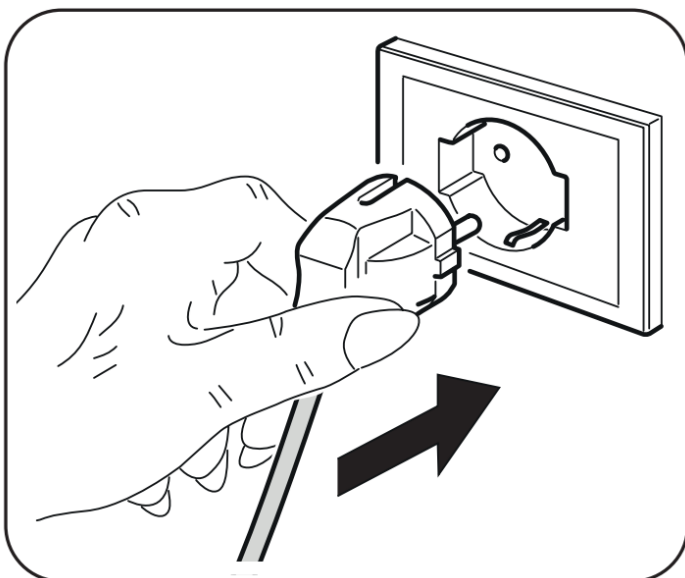

- Use a dry cloth to clean the appliance.
- If the appliance is very dirty, it is possible to use a cloth dampened with warm water (max 50°C) and a mild detergent to clean its external parts. Dry with a dry cloth.
- Use a brush or a vacuum cleaner to remove dust from the radiant wings (2).

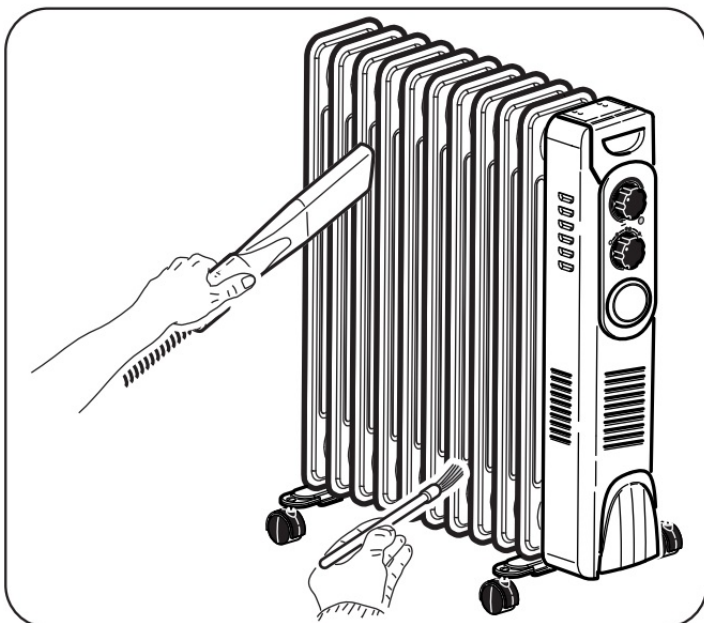

- **Make sure the appliance is completely dry before reconnecting the plug to the power socket.**
- **Do not use a chemically treated or antistatic cloth to clean the appliance.**
- **Do not use petrol, solvents, polishing pastes or similar. These products could break or deform the plastic surface.**
- **Do not use oils, chemical substances or abrasive products to clean the appliance.**
- **Neither wash nor immerse the appliance with/in water.**

In case of an appliance malfunction, do not try to disassemble it but instead refer to the retailer or to the technical assistance service.

PRESERVATION OF THE APPLIANCE

- If you do not intend to use the appliance for a particularly long period of time or if operations which could produce a lot of dust must be performed, it is advised to store the appliance as follows:
- **Switch the appliance off and disconnect the plug from the power socket.**
- Wrap the power cord (6) around the support (4).
- Store in a fresh and dry place away from humidity.

TECHNICAL DATA

For the technical features, please see the table in the next page.

CALDORAD TIMER	Item	Symbol	Value	Unit
Heat output				
Nominal heat output		P _{nom}	2,4	kW
Minimum heat output (indicative)		P _{min}	0,4	kW
Maximum continuous heat output		P _{max,c}	2,4	kW
Auxiliary electricity consumption				
At nominal heat output		e _{lmax}	–	kW
At minimum heat output		e _{lmin}	–	kW
In standby mode		e _{ISB}	0,00025	kW

Type of heat output/room temperature control		Yes	No
Single stage heat output and no room temperature control		<input type="checkbox"/>	✓
Two or more manual stages, no room temperature control		<input type="checkbox"/>	✓
With mechanic thermostat room temperature control			✓
With electronic room temperature control		<input type="checkbox"/>	✓
Electronic room temperature control plus day timer		<input type="checkbox"/>	✓
Electronic room temperature control plus week timer		<input type="checkbox"/>	✓
Other control options			
Room temperature control, with presence detection		<input type="checkbox"/>	✓
Room temperature control, with open window detection		<input type="checkbox"/>	✓
With distance control option		<input type="checkbox"/>	✓
With adaptive start control			✓
With working time limitation		<input type="checkbox"/>	✓
With black bulb sensor		<input type="checkbox"/>	✓
info@olimpiasplendid.it	Olimpia Splendid SpA		
	Via Industriale 1/3, 25060 Cellatica, Brescia, Italy		

CALDORAD 7/9/11	Item	Symbol	Value	Unit
Heat output				
Nominal heat output		P _{nom}	1,5/2,0/2,5	kW
Minimum heat output (indicative)		P _{min}	0,7/1,0/1,2	kW
Maximum continuous heat output		P _{max,c}	1,5/2,0/2,5	kW
Auxiliary electricity consumption				
At nominal heat output		e _{lmax}	–	kW
At minimum heat output		e _{lmin}	–	kW
In standby mode		e _{ISB}	0	kW

Type of heat output/room temperature control	Ye s	N o
Single stage heat output and no room temperature control	<input type="checkbox"/>	✓
Two or more manual stages, no room temperature control	<input type="checkbox"/>	✓
With mechanic thermostat room temperature control		
With electronic room temperature control	<input type="checkbox"/>	✓
Electronic room temperature control plus day timer	<input type="checkbox"/>	✓
Electronic room temperature control plus week timer	<input type="checkbox"/>	✓
Other control options		
Room temperature control, with presence detection	<input type="checkbox"/>	✓
Room temperature control, with open window detection	<input type="checkbox"/>	✓
With distance control option	<input type="checkbox"/>	✓
With adaptive start control	<input type="checkbox"/>	✓
With working time limitation	✓	<input type="checkbox"/>
With black bulb sensor	<input type="checkbox"/>	✓
info@olimpiasplendid.it	Olimpia Splendid SpA Via Industriale 1/3, 25060 Cellatica, Brescia, Italy	

customer support

OLIMPIA SPLENDID spa
via Industriale 1/3
25060 Cellatica (BS)
www.olimpiasplendid.it
info@olimpiasplendid.it

I dati tecnici e le caratteristiche estetiche dei prodotti possono subire cambiamenti. Olimpia Splendid si riserva di modificarli in ogni momento senza preavviso.



Documents / Resources



[OLIMPIA SPLENDID CALDORAD 9 Turbo Timer Suitable For Well Insulated Spaces or Occasional](#) [pdf] Instruction Manual

CALDORAD 9 Turbo Timer Suitable For Well Insulated Spaces or Occasional, CALDORAD 9, Turbo Timer Suitable For Well Insulated Spaces or Occasional, Suitable For Well Insulated Spaces or Occasional, Well Insulated Spaces or Occasional, Insulated Spaces or Occasional, Spaces or Occasional, Occasional

References

- User Manual