

OLIGHT PL-3R Max 1500 Lumens WML Built In 900mAh Lithium Polymer Battery



OLIGHT PL-3R Max 1500 Lumens WML Built In 900mAh Lithium Polymer Battery User Manual

[Home](#) » [OLIGHT](#) » OLIGHT PL-3R Max 1500 Lumens WML Built In 900mAh Lithium Polymer Battery User Manual



Contents

- 1 OLIGHT PL-3R Max 1500 Lumens WML Built In 900mAh Lithium Polymer Battery
- 2 Product Information
- 3 Product Usage Instructions
- 4 FAQs
- 5 IN THE BOX
- 6 INSTALLATION INSTRUCTION
- 7 WARRANTY
- 8 Documents / Resources
 - 8.1 References



OLIGHT PL-3R Max 1500 Lumens WML Built In 900mAh Lithium Polymer Battery



Product Information

- **Specifications:**

- **Model:** PL-3R VALKYRIE
- **Colour Temperature:** Cool White CCT 5700K
- **Max Brightness:** 1,500 lumens
- **Battery:** Built-in 900mAh Lithium Polymer
- **Beam Distance:** 205m
- **Water Resistance:** IPX6
- **Dimensions:** (L)81*(W)36.6*(H)32.5mm or (L)3.19*(W)1.44*(H)1.28in
- **Battery Type:** Rechargeable lithium polymer
- **Battery Capacity:** 3.3Wh (900mAh/3.7V)
- **Weight:** 107g/3.77oz

Product Usage Instructions

- **Charging the Light:**

- To charge the light, use the provided USB Magnetic charging cable.
- Connect the cable to the light's charging port and a power source.
- The indicator will turn red when charging and green when fully charged.

- **Operating Modes:**

- The light has multiple brightness levels including High 1, High 2, Low, and Strobe.
- Double-press the button to switch between the Low and High modes.
- Press both buttons or quickly press the button at least 10 times to activate Strobe mode.

- **Switching On/Off:**

- To turn the light on, press the power button. To turn it off, press and hold the button until the light powers down.

- **Adjusting Brightness:**

- You can adjust the brightness level by pressing the appropriate buttons for each mode. Refer to the provided tables for specific runtimes at each brightness setting.

FAQs

- **Q: How do I know when the light is fully charged?**
 - **A:** The indicator on the light will turn green when charging is completed.
- **Q: How do I switch between different brightness modes?**
 - **A:** Double-press the button to switch between the Low and High modes.

IN THE BOX

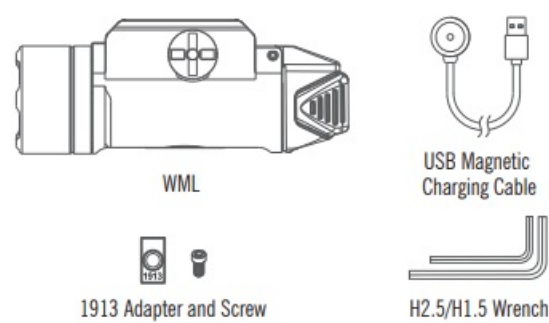

Table 1: WML

WML

COOL WHITE CCT: 5700K

HIGH 1

1,500 lumens

100%

2min

40%

36min

20%

8.5min

HIGH 2

1,000 lumens

100%

12min

60%

23min

30%

8.5min

LOW

300 lumens

100%

100min











10,200cd

205m

IPX6

1m

Working temperature
0~40°C







(L)81*(W)36.6*(H)32.5mm
(L)3.19*(W)1.44*(H)1.28in

3.3Wh(900mAh/3.7V)
Rechargeable lithium
polymer battery

107g/3.77oz

Table 2: USB Magnetic charging cable

Cable length	0.5m
Input	USB-A 5V 1A
Output	CC&CV 4.2V±0.05V 1A
Time to fully charge	About 80min

INSTALLATION INSTRUCTION

1. For product specification, see Table 1 and Table 2;
2. Operating instructions are as below

3. Charging, see Figure 1;
4. Screw off, see Figure 2-1;
5. Adjust the installation position of the light, see Figure 2-2;
6. Screw on, see Figure 2-3;
7. Lock/unlock, see Figure 3;
8. Turn the light on/off, see Figure 4;
9. Momentary on, see Figure 5;
10. Change brightness level, see Figure 6;
11. For direct access to high brightness, see Figure 7;
12. Change high brightness level, see Figure 8;
13. Strobe, see Figure 9;

Figure 1

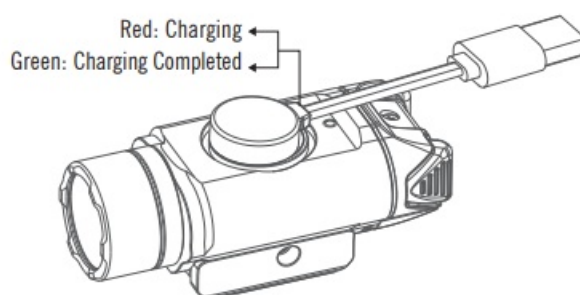

Figure 2-1

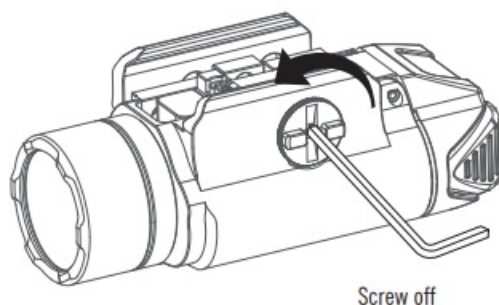

Figure 2-2

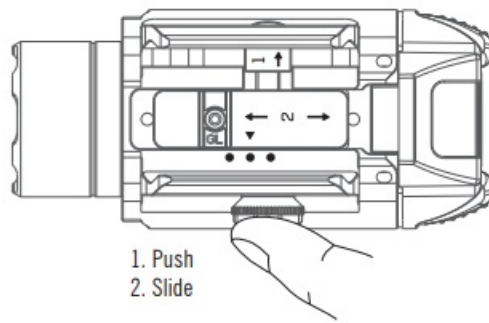

Figure 2-3

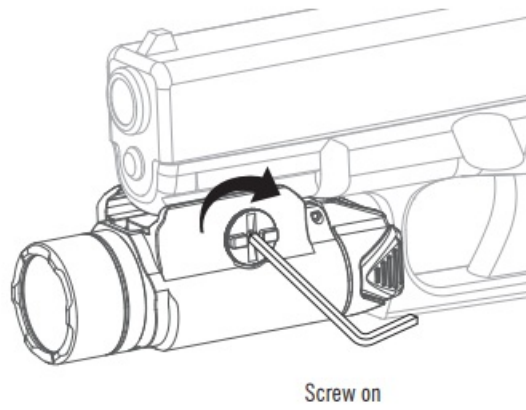

Figure 3

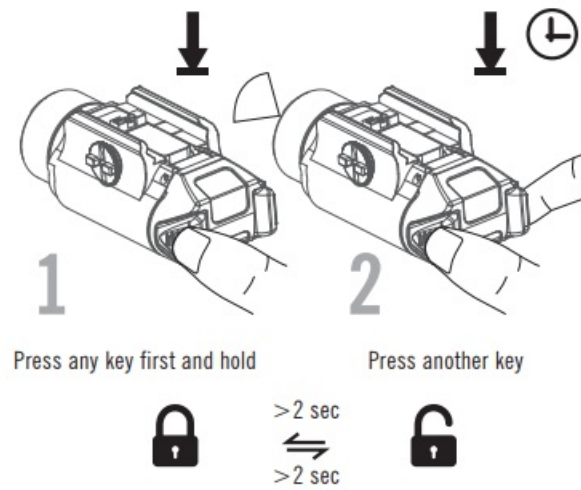

Figure 4

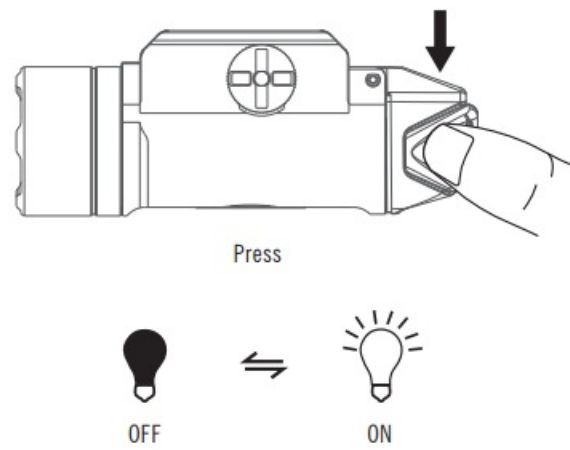

Figure 5

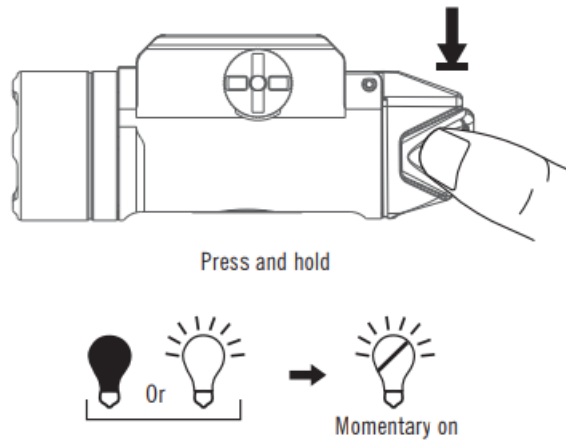

Figure 6

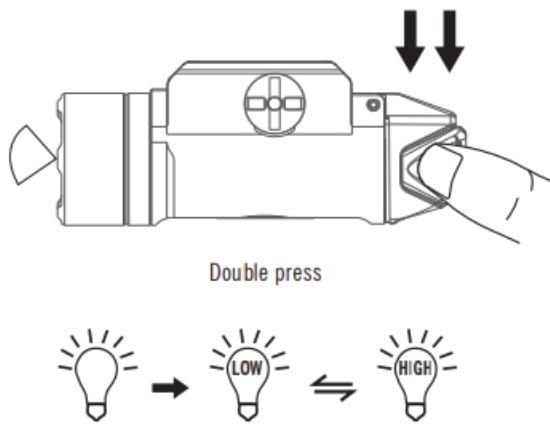

Figure 7

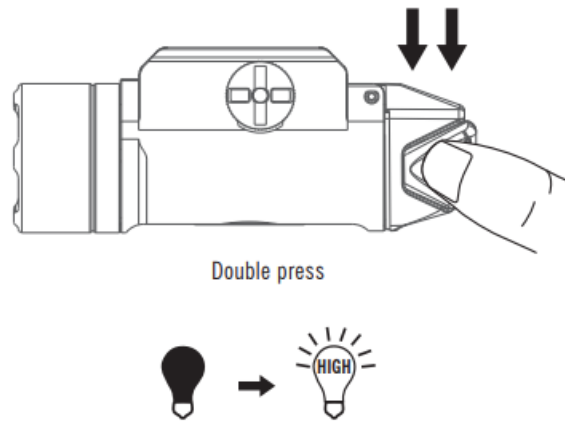

Figure 8

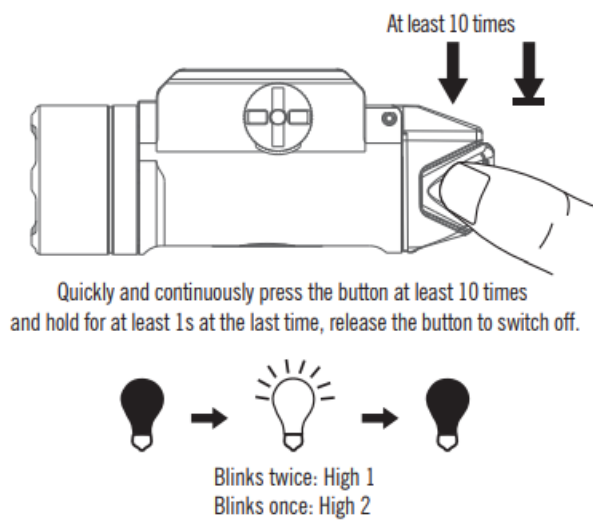
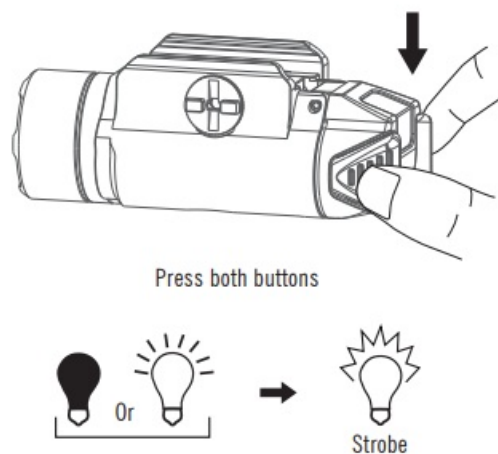

Figure 9



WARRANTY

- Within 30 days of purchase: Contact the original seller for repair or replacement.
- Within 2 years of purchase: Contact Olight for repair or replacement.
- USB magnetic charging cable: One year.

- This warranty does not cover normal wear and tear, modifications, misuse, disintegrations, negligence, accidents, improper maintenance, or repair by anyone other than an authorized retailer or Olight itself.

USA Customer Support

- cs@olightstore.com.
- Global Customer Support contact@olightworld.com.
- Visit www.olightworld.com to see our complete product line of portable illumination tools.
- Dongguan Olight E-Commerce Technology Co., Ltd.
- 4th Floor, Building 4, Kegou Industrial Park, No 6 Zhongnan Road,
- Changan Town, Dongguan City, Guangdong, China.
- Made in China
- CAN ICES-005(B) / NMB-005(B)
- 3.4000.0505 A. 01, 06, 2023
- PL-3R VALKYRIE
- Max 1,500 Lumens WML Built-in 900mAh Lithium Polymer Battery.

Documents / Resources

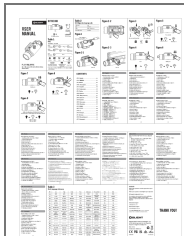

[OLIGHT PL-3R Max 1500 Lumens WML Built In 900mAh Lithium Polymer Battery](#) [pdf] User Manual

PL-3R Max 1500 Lumens WML Built In 900mAh Lithium Polymer Battery, PL-3R, Max 1500 Lumens WML Built In 900mAh Lithium Polymer Battery, Built In 900mAh Lithium Polymer Battery, Lithium Polymer Battery, Polymer Battery

References

- [Olight | Illuminate Your World.](#)
- [User Manual](#)

[Manuals+](#), [Privacy Policy](#)

This website is an independent publication and is neither affiliated with nor endorsed by any of the trademark owners. The "Bluetooth®" word mark and logos are registered trademarks owned by Bluetooth SIG, Inc. The "Wi-Fi®" word mark and logos are registered trademarks owned by the Wi-Fi Alliance. Any use of these marks on this website does not imply any affiliation with or endorsement.