

OLIGHT
Odin S
Powerful Rail
Mounted Light
With Remote
Switch



OLIGHT Odin S Powerful Rail Mounted Light With Remote Switch Instruction Manual

[Home](#) » [OLIGHT](#) » OLIGHT Odin S Powerful Rail Mounted Light With Remote Switch Instruction Manual 

Contents

- [1 OLIGHT Odin S Powerful Rail Mounted Light With Remote Switch](#)
- [2 IN THE BOX](#)
- [3 Specifications](#)
- [4 USB Magnetic charging cable](#)
- [5 INSTALLATION INSTRUCTION](#)
- [6 EU Declaration of Conformity](#)
- [7 WARRANTY](#)
- [8 Customer Support](#)
- [9 Documents / Resources](#)
 - [9.1 References](#)



OLIGHT Odin S Powerful Rail Mounted Light With Remote Switch



IN THE BOX

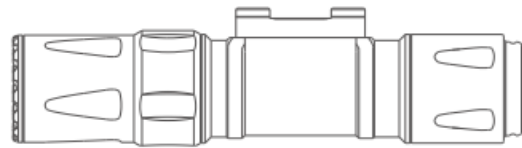

Odin S (with battery)



M-LOK Rail
Mount



USB Magnetic
Charging Cable



Magnetic
Remote Switch



Screws



Nuts



Battery Holder
(suitable for
CR123A battery)



H3.0/H2.5 Wrench

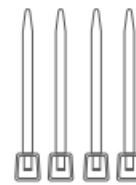

Self-Locking
Band

Specifications

Table 1: Specifications (18650 Battery)

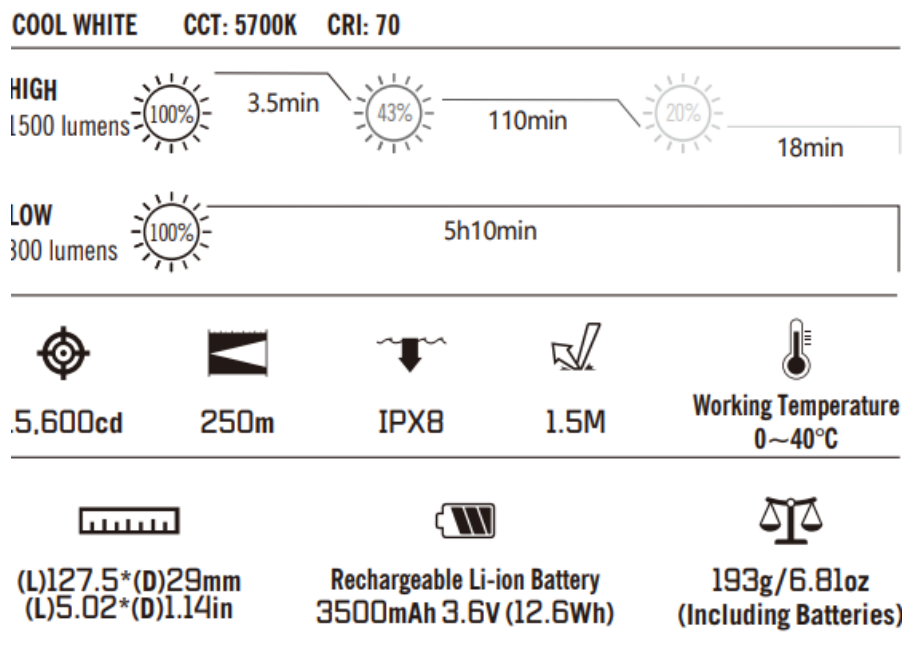

Above data are tested per ANSI/PLATO FL 1-2019 standard in Olight's labs for reference.

CR123A Battery (Optional Accessory)

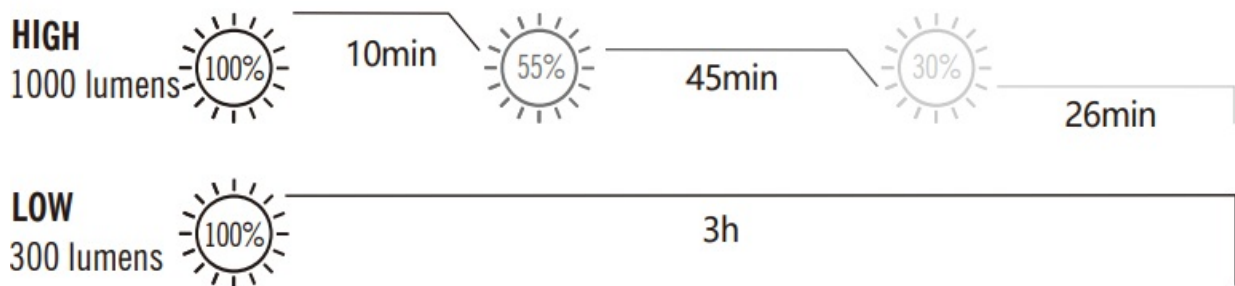

Above data are tested per ANSI/PLATO FL 1-2019 standard in Olight's labs for reference.

USB Magnetic charging cable

Table 2: USB Magnetic charging cable

- **Cable length:** 0.5m
- **Input** DC 5V, 2A
- **Output:** CC & CV, 4.2V, 1.5A
- **Charging time** About 3.5 hours

INSTALLATION INSTRUCTION

Multi-language dictionary, see Table 3.

1. For product specifications, see Table 1 and Table 2.
2. Remove the insulating film before use, **see Figure 1.**

Figure 1

Remove the insulating film before use

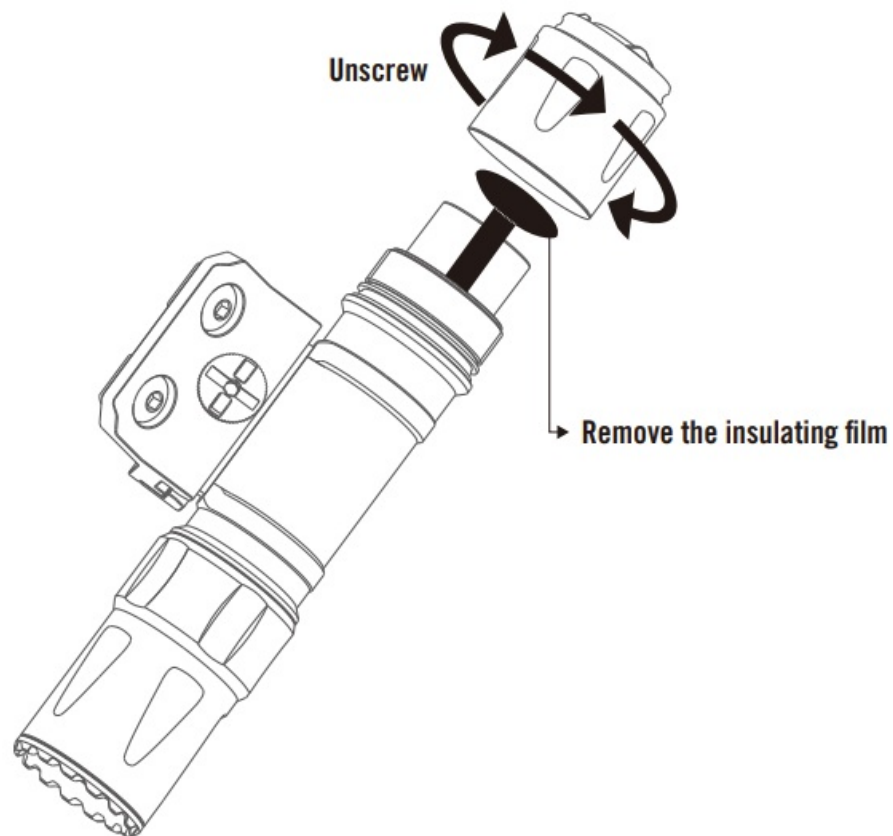

3. Charging, **see Figure 2.**

Figure 2

Charging

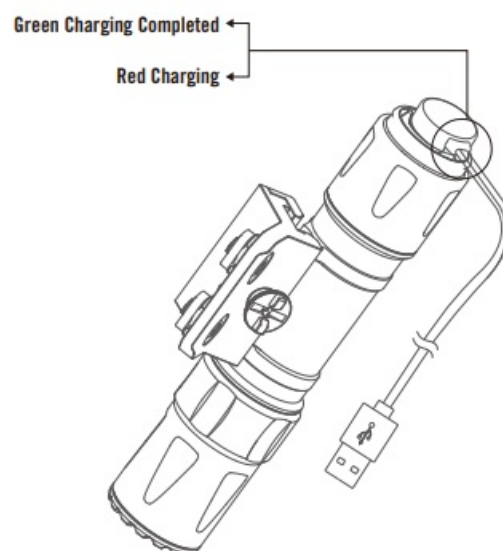

4. Use the battery holder, **see Figure 3.**

Figure 3
Use the battery holder

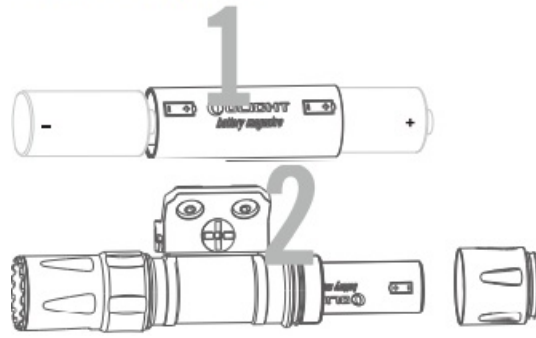

- Install two CR123A batteries into the battery holder.
- **Note:** Ensure that the batteries are installed with the correct polarity

5. **Product installation as below:**

- Rail mount installation, see Figure 4.

Figure 4
Rail mount installation

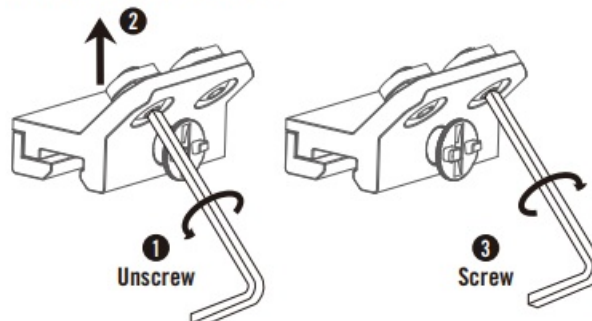

- Loosen the screws and install the rail mount in its desired position, then tighten the screws.
- Loosen the screws, install the rail mount in the desired position, and then tighten the screws.
- **Rail-mounted light installation, see Figure 5.**

Figure 5
Rail mounted light installation

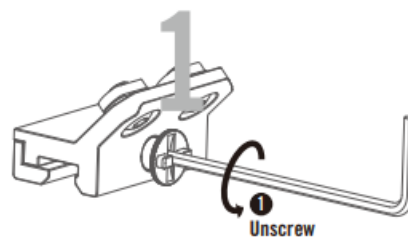

- Loosen the knob locking lever on the rail mount (counterclockwise) until it stops.
- Adjust the width of the rail mount opening by pushing the knob locking lever

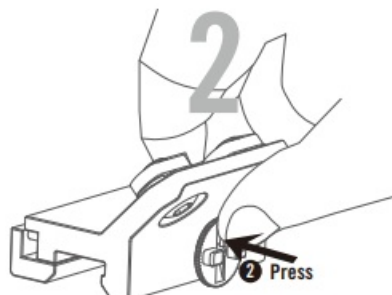

- **(Note:** Do not put your fingers against the movable rail mount on the opposite side of the knob locking lever).
- Place the T-mount on the product into the T-shape inside the rail mount. (The two screws on the rail

mount align with the slots on the product's T-mount).

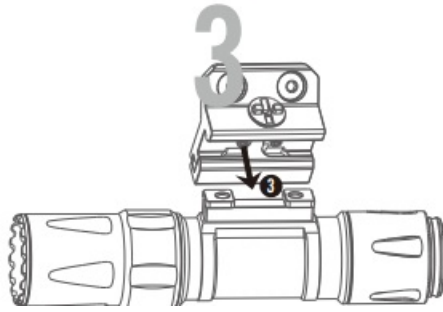

- Lastly, lock the knob locking lever on the rail mount with tools to make it ready for use (turning it clockwise).

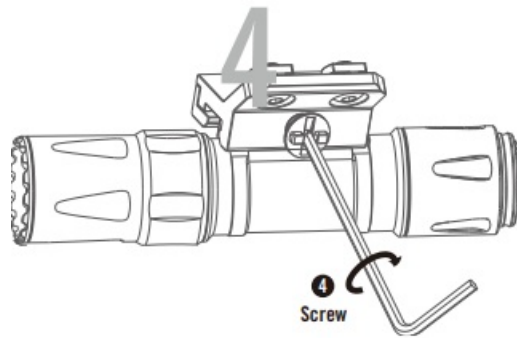

- Unscrew the knob locking lever on the rail and mount it counterclockwise until it stops. Push the knob locking lever to adjust the width of the rail mount opening.
- Place the T-mount on the product into the T-shape inside the rail mount, ensuring that the two screws on the rail holder align with the slots in the product's T-mount.
- Lastly, lock the knob locking lever on the rail mount by turning it clockwise using a tool.
- **For light removal, see Figure 6.**

Figure 6
Light removal

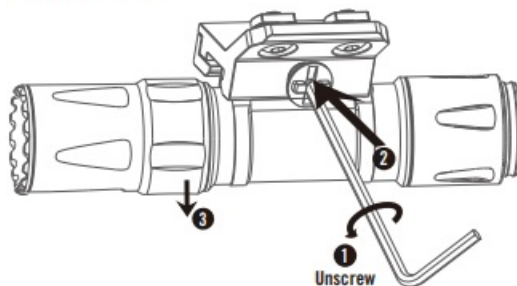

- To remove the product, loosen the knob locking lever on the rail mount and push it to adjust the width of the rail mount opening and remove the product.
- To remove the product, loosen the knob locking lever on the rail mount and push it to adjust the width of the rail mount opening.

6. Tail switch operating instructions as below:

- Constant On.
- **Low mode, see Figure 7.**

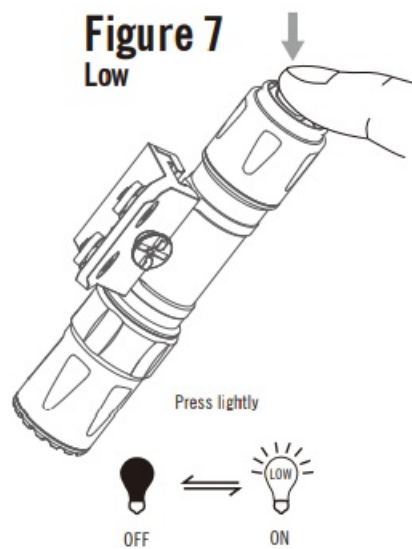

- Press lightly and quickly for Low mode, and press again to turn it off.
- **For high mode, see Figure 8.**

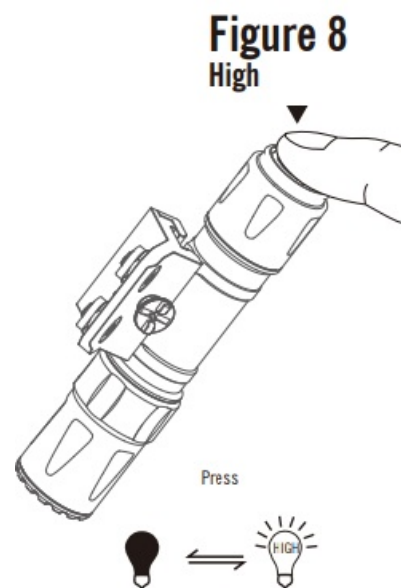

- Press hard and quickly for High mode, and press again to turn it off.
- **Momentary On:**
- **Low mode, see Figure 9.**

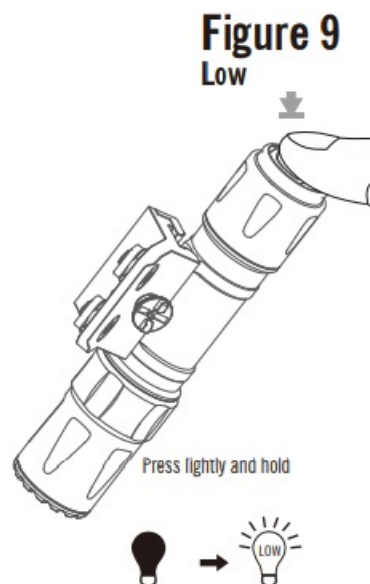

- Press lightly hold for Low mode, and release to turn it off.
- **For high mode, see Figure 10.**

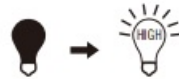
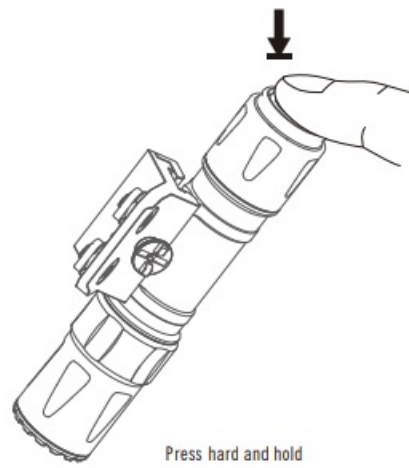

- Press hard hold for High mode, and release to turn it off.
- **Switch to High mode, see Figure 11.**

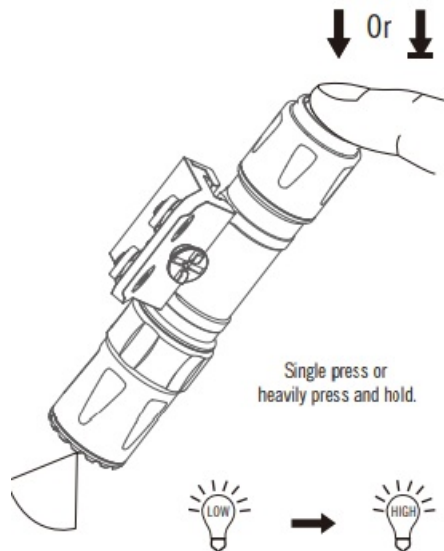

- In Low mode, single press or heavily press and hold the switch for High mode.
- **Enable/disable the Strobe function, see Figure 12.**

Figure 12

Enable/disable the Strobe function

At least 5 times ⌚

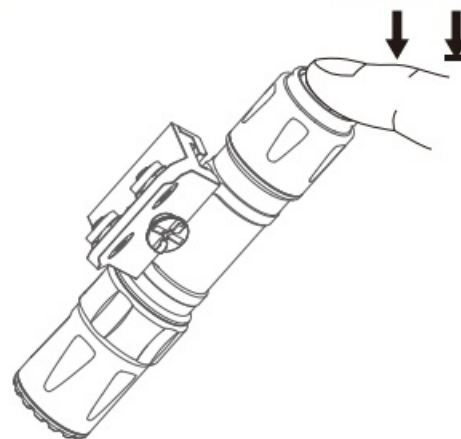

- When the light is off, press the button hard five times (or more) quickly, and hold it for more than 1 second at the last press, then the Strobe can be enabled or disabled.

7. **Turn on/off the Strobe, see Figure 13.**

Figure 13

Strobe (when Strobe function is activated)

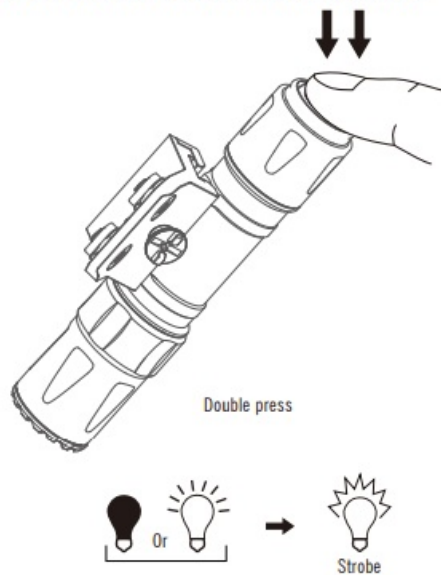

- Double (or more) press the button hard quickly to turn on the Strobe, and press once again to turn it off.

8. **Remote switch installation, see Figure 14.**

Figure 14
Remote switch installation

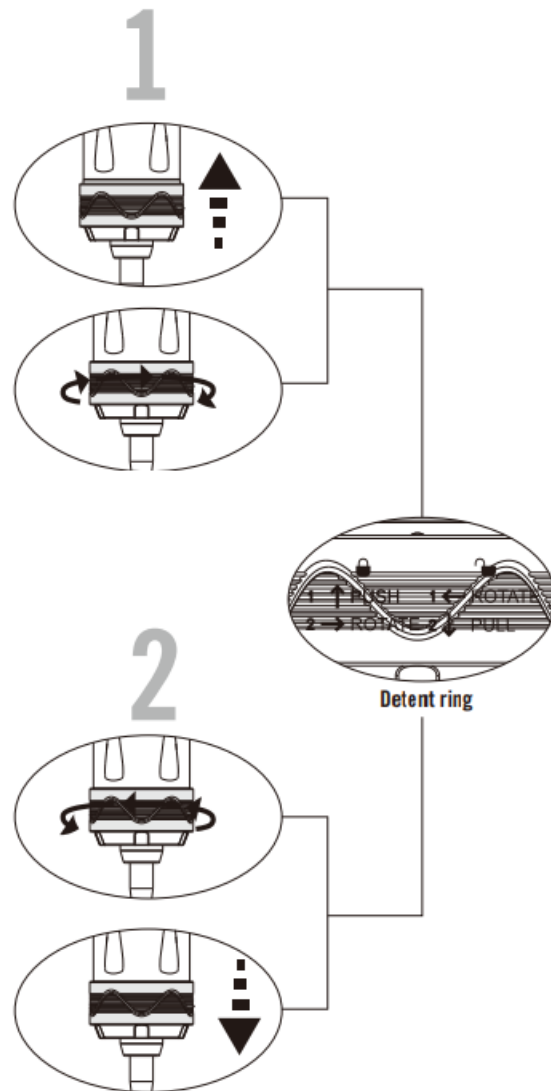

1. Attach the remote switch to the tail of the product, then push the ring and turn it clockwise to fix the remote switch.

2. Turn the ring counter-clockwise and then pull it until you hear a click to remove the remote switch.

- To install the remote switch, first, push the detent ring towards the tail of the light, and then screw the ring clockwise.
- To remove the remote switch, simply screw the detent ring counterclockwise until you hear a click.

9. Remote switch operating instructions are as below:

- **Constant On, see Figure 15.**

Figure 15
Constant On

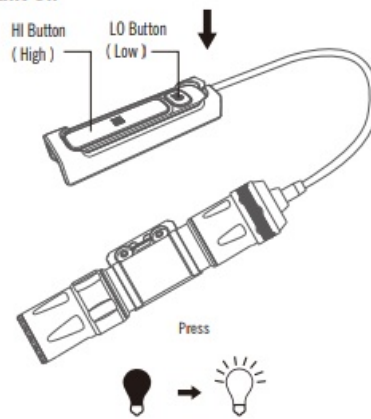

- Press the LO/HI button quickly for Low mode /High mode, and press again to turn it off.
- **Momentary On, see Figure 16.**

Figure 16
Momentary On

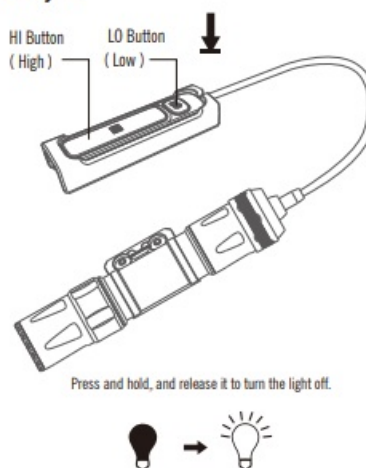

- Press and hold the LO/HI button for Low mode /High mode, and release it to turn the light off.
- **Enable/disable the Strobe function, see Figure 17.**

Figure 17
Enable/disable the Strobe function

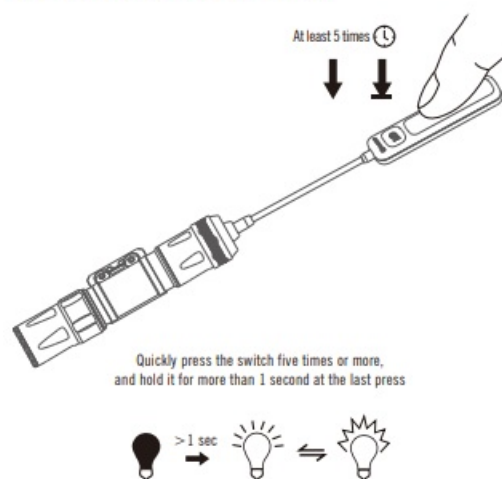

- When the light is off, press the HI button five times (or more) quickly, and hold it for more than 1 second at the last press, then the Strobe can be enabled or disabled.
- **Strobe (when Strobe function is activated), see Figure 18.**

Figure 18
Strobe (when Strobe function is activated)

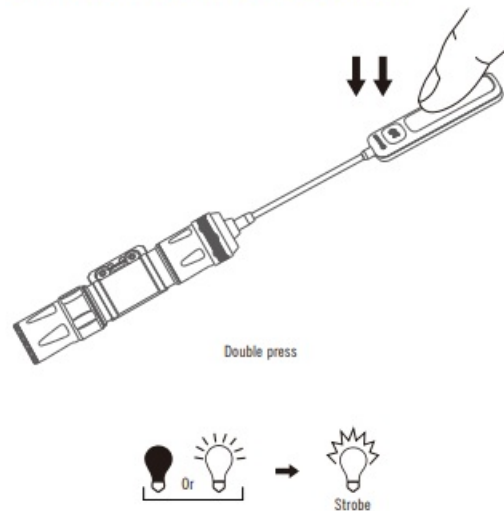

- Double (or more) press the HI button quickly to turn on the Strobe, and press once again to turn it off.

Table 3 Multi-language dictionary

- Low
- High
- Strobe
- Press lightly
- Press
- Press lightly and hold
- Press hard and hold
- Double press

WEEE Disposal and Recycling Information

All products bearing this symbol are waste electrical and electronic equipment (WEEE as in directive 2012/19/EU) which should not be mixed with unsorted household waste. Instead, to protect human health and the environment, you should dispose of your waste equipment at a designated collection point for the recycling of WEEE, appointed by the government or local authorities. Proper disposal and recycling will help prevent potential negative consequences to the environment and human health. Please contact the installer or local authorities for more information about the location as well as the terms and conditions of such collection points.

FCC Compliance Statement

This device complies with part 15 of the FCC Rules. Operation is subject to the following two conditions:

1. This device may not cause harmful interference, and
2. this device must accept any interference received, including interference that may cause undesired operation.

WARNING Any changes or modifications not expressly approved by the party responsible for compliance could void the user's authority to operate the equipment.

NOTE: This equipment has been tested and found to comply with the limits for a Class B digital device, according to part 15 of the FCC Rules. These limits are designed to provide reasonable protection against harmful interference in a residential installation. This equipment generates uses and can radiate radio frequency energy and, if not installed and used under the instructions, may cause harmful interference to radio communications.

However, there is no guarantee that interference will not occur in a particular installation. If this equipment does cause harmful interference to radio or television reception, which can be determined by turning the equipment off and on, the user is encouraged to try to correct the interference by one or more of the following measures:

- Reorient or relocate the receiving antenna.
- Increase the separation between the equipment and the receiver.
- Connect the equipment to an outlet on a circuit different from that to which the receiver is connected.
- Consult the dealer or an experienced radio/TV technician for help.

ISED Notice

This device complies with Industry Canada's license-exempt ICES standard(s). Operation is subject to the following two conditions:

1. This device may not cause interference,
2. this device must accept any interference, including interference that may cause undesired operation of the device.

This Class B digital apparatus complies with Canadian ICES-005.

EU Declaration of Conformity

- Dongguan Olight E-Commerce Technology Co, Ltd declares that the equipment [Odin S] complies with Directive 2014/30/EU and RoHS Directive 2011/65/EU & (EU) 2015/863.
- The full text of the EU Declaration of conformity is available at the following internet address:
<https://www.olight.com/download>

WARRANTY

- We are proud to offer a lifetime warranty in Australia, China, France, Germany, and the USA. We are also working hard to expand coverage to more countries, where we provide a 2 or 5-year warranty.
- The warranty covers defects in material and workmanship under normal use, excluding loss, theft, deliberate damage, or cosmetic damage.
- For complete warranty information, please visit Olight.com or your local Olight official website.

Customer Support

- **Australia Customer Support**
 - contact@olightstore.com.au
- **Austria Customer Support**
 - kontakt@olightstore.at
- **Canada Customer Support**
 - cs@olightstore.ca
- **China Customer Support Wechat: lights**
- **France Customer Support**

- cs@olightstore.fr
- Germany Customer Support
 - kontakt@olightstore.de
- Italy Customer Support
 - contatto@olightstore.it
- Japan Customer Support
 - cs@olightstore.jp
- Korea Customer Support
 - olightkorea@olight.com
- Spain Customer Support
 - contacto@olightstore.es
- Thailand Customer Support
 - cs@olightstore.co.th
- UK Customer Support
 - contact@olightstore.uk
- USA Customer Support
 - cs@olightstore.com
 - For other countries and regions, please contact Global Customer Support at contact@olight.com
- Dongguan Olight E-Commerce Technology Co., Ltd.
- 4th Floor, Building 4, Kegu Industrial Park, No 6 Zhongnan Road, Changan Town, Dongguan
- City, Guangdong, China.
- Made in China

Documents / Resources

	<p>OLIGHT Odin S Powerful Rail Mounted Light With Remote Switch [pdf] Instruction Manual Odin S Powerful Rail Mounted Light With Remote Switch, Odin S, Powerful Rail Mounted Light With Remote Switch, Mounted Light With Remote Switch, Light With Remote Switch, Remote Switch, Switch</p>
---	--

References

- [Olight | Illuminate Your World.](#)
- [Flashlights, Tactical Light, Outdoor Tools - Olight Official Store- Olight](#)
- [User Manual](#)

Manuals+, Privacy Policy

This website is an independent publication and is neither affiliated with nor endorsed by any of the trademark owners. The "Bluetooth®" word mark and logos are registered trademarks owned by Bluetooth SIG, Inc. The "Wi-Fi®" word mark and logos are registered trademarks owned by the Wi-Fi Alliance. Any use of these marks on this website does not imply any affiliation with or endorsement.