



OLIGHT JTURB02 Wireless Remote Switch Instruction Manual

July 5,
2025



Contents [[hide](#)]

1 Wireless Remote Switch

1.1 1. Pair the flashlight with a new switch

1.2 2. OPERATING INSTRUCTIONS FOR THE WIRELESS REMOTE SWITCH:

1.3 FCC Compliance Statement

1.4 WEEE Disposal and Recycling Information

1.5 SAR Warning

1.6 WARRANTY

2 Documents / Resources

2.1 References

Wireless Remote Switch

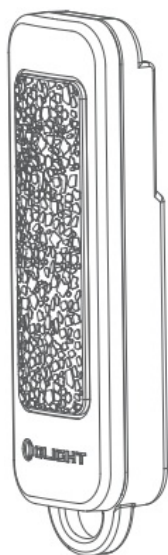

FEATURES	SPECIFICATIONS
Operation Frequency	2.4GHz: 2402MHz-2480MHz
Maximum Output Power	2.4GHz 10dBm
Control Distance	1 m
Dimensions	(L)65*(W)20*(H)11 mm (L)2.56*(W)0.79*(H)0.43 in
Weight	13.2 g / 0.47 oz
Battery	3.7 V 35 mAh (0.13 Wh)
Waterproof Level	IP66
Max impact resistance	1.5 m
Input	CC&CV DC 5 V / 30 mA
Working temperature	0-40°C

Pair the flashlight with a new Wireless Remote Switch

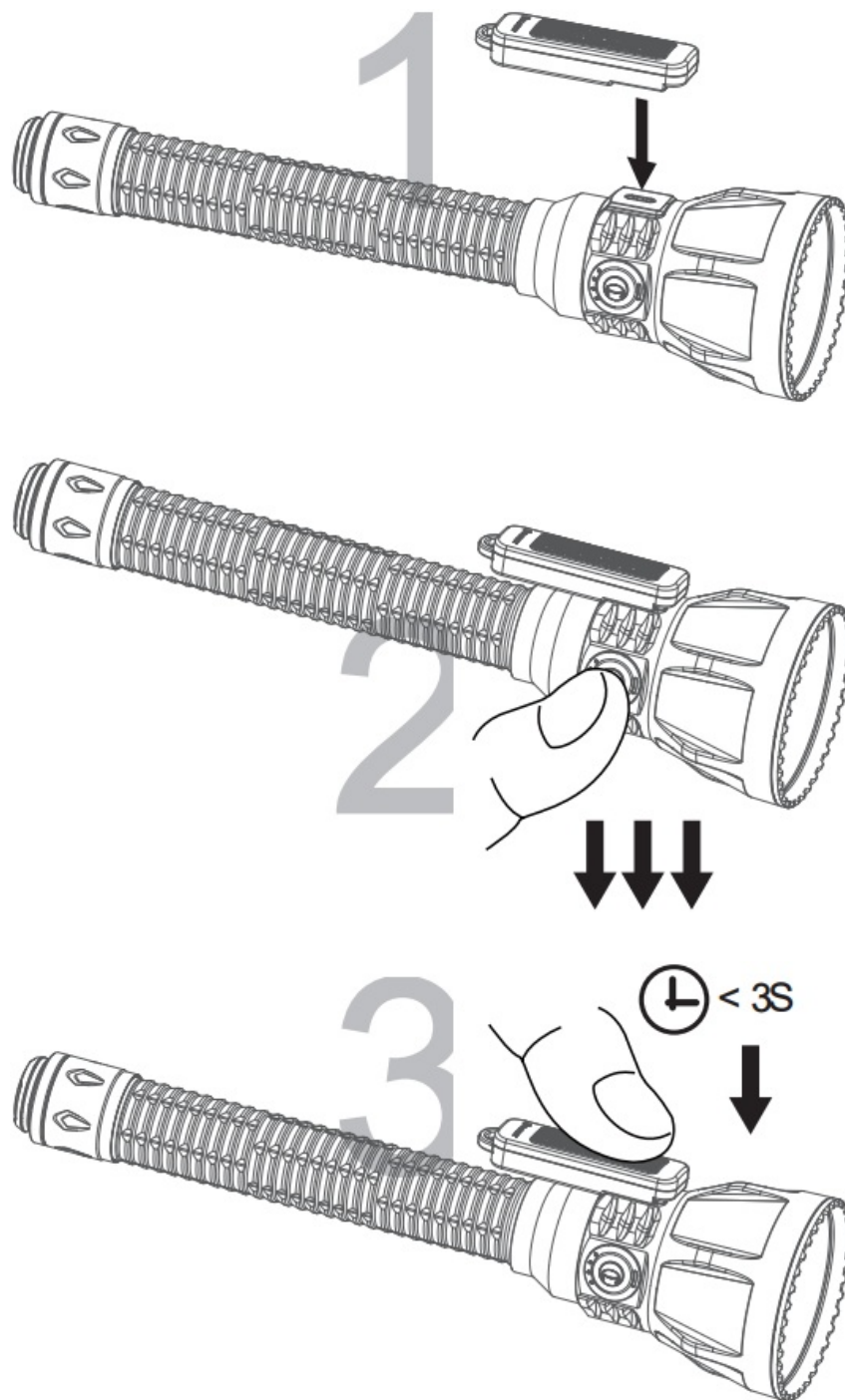

1. Pair the flashlight with a new switch

Place the wireless remote switch on the flashlight. Then, with the flashlight turned off, quickly triple-press (or more) the side switch for “pairing confirmation”, and single-press the wireless remote switch within 3 seconds.

Finally, the flashlight and the wireless remote switch enter pairing mode. In pairing mode, the indicators on both the flashlight and the wireless remote switch blink continuously and will turn off if paired successfully.

If the flashlight remains in “pairing confirmation” for more than 3 seconds, and you do not

press the wireless remote switch, it exits pairing mode;

During the “pairing confirmation” or pairing process, if the side button or the tail switch of the flashlight is pressed, or the wireless remote switch is removed from the flashlight, the flashlight exits pairing confirmation or pairing mode;

If the flashlight remains in pairing mode for 40 seconds continuously, it defaults to pairing timeout and exits pairing mode;

2. OPERATING INSTRUCTIONS FOR THE WIRELESS REMOTE SWITCH:

2.1 Power On/Off;

Remove the wireless remote switch from the flashlight. Press the switch to turn the flashlight on or off. When turned on, the flashlight will be on Turbo or the maximum brightness allowed by the current battery level.

2.2 Press and hold for momentary on;

2.3 Disable the switch;

When the flashlight is connected with the switch, remove the switch from the flashlight, and quickly press the side button on the flashlight five times within 30 seconds, or if the switch has been removed from the flashlight for more than 8 hours, the wireless connection will automatically disconnect (the flashlight’s wireless indicator will flash for 2 seconds and then turn off).

2.4 Enable the switch;

When the flashlight is disconnected from the switch, quickly press the side button on the flashlight five times or attach the switch to the magnetic mount on the flashlight to enable the wireless connection ((the flashlight’s wireless indicator will stay on for 5 seconds and then turn off, or the remote control’s indicator will stay on for 5 seconds and then turn off).



Danger / Warning

- Avoid immersion in seawater or corrosive liquids, as it may damage the product.
- Do not disassemble the product.
- Do not intentionally short-circuit the charging area of the wireless remote switch.
- Keep the charging area of the wireless remote switch clean, as dirt may affect charging functionality.

FCC Compliance Statement

This device complies with part 15 of the FCC Rules. Operation is subject to the following two conditions:

- (1) This device may not cause harmful interference, and
- (2) this device must accept any interference received, including interference that may cause undesired operation.

Any changes or modifications not expressly approved by the party responsible for compliance could void the user's authority to operate the equipment.

Note: This equipment has been tested and found to comply with the limits for a Class B digital device, pursuant to part 15 of the FCC Rules. These limits are designed to provide reasonable protection against harmful interference in a residential installation. This equipment generates uses and can radiate radio frequency energy and, if not installed and used in accordance with the instructions, may cause harmful interference to radio communications. However, there is no guarantee that interference will not occur in a particular installation. If this equipment does cause harmful interference to radio or television reception, which can be determined by turning the equipment off and on, the user is encouraged to try to correct the interference by one or more of the following measures:

- Reorient or relocate the receiving antenna.
- Increase the separation between the equipment and receiver.
- Connect the equipment into an outlet on a circuit different from that to which the receiver is connected.
- Consult the dealer or an experienced radio/TV technician for help.

This equipment complies with FCC radiation exposure limits set forth for an uncontrolled environment. This equipment can be used in portable exposure condition without restriction.

WEEE Disposal and Recycling Information

All products bearing this symbol are waste electrical and electronic equipment (WEEE as in directive 2012/19/EU) which should not be mixed with unsorted household waste. Instead, to protect human health and the environment, you should dispose of your waste equipment at a designated collection point for the recycling of WEEE, appointed by the government or local authorities. Proper disposal and recycling will help prevent potential negative consequences to the environment and human health. Please contact the installer or local authorities for more information about the location as well as terms and conditions of such collection points.

SAR Warning

In normal use, a separation distance of at least 0 cm between the antenna of the equipment and the body of the user should be maintained.

EU Declaration of Conformity

Hereby Dongguan Olight E-Commerce Technology Co,Ltd declares that the equipment [Wireless Remote Switch] is in compliance with Radio Equipment Directive 2014/53/EU and RoHS Directive 2011/65/EU & (EU) 2015/863. The full text of the EU declaration of conformity is available at the following internet address:

<https://www.olight.com/download>



- Do not ingest the battery, as there is a Chemical Burn Hazard.
- This product contains a coin/button cell battery.
- If the coin/button cell battery is swallowed, it can cause severe internal burns in just 2 hours and can lead to death.
- Keep new and used batteries away from children.

- If the battery compartment does not close securely, stop using the product and keep it away from children.
- If you think batteries might have been swallowed or placed inside any part of the body, seek immediate medical attention.
- Do not replace the battery with an incorrect type that can defeat a safeguard, such as certain types of lithium batteries.
- Do not dispose of the battery in fire, a hot oven, or by crushing or cutting it, as it may result in an explosion.
- Leaving a battery in an extremely high temperature surrounding environment can result in an explosion or the leakage of flammable liquid or gas.
- Battery subjected to extremely low air pressure may result in an explosion or the leakage of flammable liquid or gas.

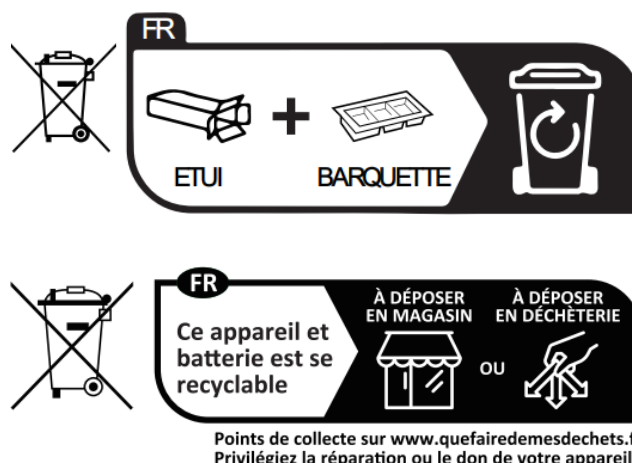

WARRANTY

We are proud to offer a lifetime warranty in Australia, China, France, Germany, and the USA. We are also working hard to expand coverage to more countries, where we provide a 2 or 5-year warranty. The warranty covers defects in material and workmanship under normal use, excluding loss, theft, deliberate damage, or cosmetic damage. For complete warranty information, please visit [Olight.com](https://www.Olight.com) or your local Olight official website.

Australia Customer Support

contact@olightstore.com.au

Austria Customer Support

kontakt@olightstore.at

Canada Customer Support

cs@olightstore.ca

China Customer Support

Wechat: olightcs

France Customer Support

cs@olightstore.fr

Germany Customer Support

kontakt@olightstore.de

Italy Customer Support

contatto@olightstore.it

Japan Customer Support

cs@olightstore.jp

Korea Customer Support

olightkorea@olight.com

Spain Customer Support

contacto@olightstore.es

Thailand Customer Support

cs@olightstore.co.th

UK Customer Support

contact@olightstore.uk

USA Customer Support

cs@olightstore.com

For other countries and regions, please contact Global Customer Support

contact@olight.com



Dongguan Olight E-Commerce Technology Co., Ltd
4th Floor, Building 4, Kegu Industrial Park, No. 6 Zhongnan Road,
Chang'an Town, Dongguan City, Guangdong, China.
Made in China



3.4000.1083

A. 11. 08. 2024

Documents / Resources

	OLIGHT JTURB02 Wireless Remote Switch [pdf] Instruction Manual JTURB02, JTURB02 Wireless Remote Switch, Wireless Remote Switch, Remote Switch, Switch
--	---

References

- [User Manual](#)

JTURB02, JTURB02 Wireless Remote Switch, OLIGHT, Remote Switch, switch, Wireless Remote

OLIGHT Switch

Leave a comment

Your email address will not be published. Required fields are marked *

Comment *

Name

Email

Website

☐ Save my name, email, and website in this browser for the next time I comment.

Post Comment

Search:

e.g. whirlpool wrf535swhz

Search

Manuals+ | Upload | Deep Search | Privacy Policy | @manuals.plus | YouTube

This website is an independent publication and is neither affiliated with nor endorsed by any of the trademark owners. The "Bluetooth®" word mark and logos are registered trademarks owned by Bluetooth SIG, Inc. The "Wi-Fi®" word mark and logos are registered trademarks owned by the Wi-Fi Alliance. Any use of these marks on this website does not imply any affiliation with or endorsement.