



OHNIYOU GLX020-DB Caged Ceiling Fans with Lights and Remote User Manual

[Home](#) » [OHNIYOU](#) » OHNIYOU GLX020-DB Caged Ceiling Fans with Lights and Remote User Manual 

OHNIYOU GLX020-DB Caged Ceiling Fans with Lights and Remote User Manual



Contents

1	SAFTY RULES
2	TOOLS REQUIRED
3	WARNING
4	Materials
5	Package Includes
6	INSTALL THE FAN
7	INSTALL THE MOUNTING BRACKET
8	INSTALL THE DOWNROD
9	MOUNTING
10	WIRING WITH REMOTE RECEIVER
11	INSTALL THE LIGHT BULB
12	INSTALL WALL SWITCHES (OPTIONAL)
13	Remote Control
14	Troubleshooting
15	Maintenance
16	Warranty
17	Documents / Resources
17.1	References

SAFTY RULES

1. To reduce the risk of electric shock, turn off the electricity to the fan at the main fuse box or circuit panel before beginning.
2. All wiring must be in accordance with the local electrical codes or National Electrical Code. Electrical installation should be performed by a qualified licensed electrician.
3. To avoid personal injury, the use of gloves may be necessary while handling fan parts with sharp-edged.
3. Make sure the installation site you choose allows clear space for the blades to rotate and at least 7feet(2.13meters) of clearance between the floor and the fan blade tips. The fan should be mounted so that the tips of the blades are at least 18 inches (45.72 centimeters) from walls or other upright structures.
4. **WARNING:** To reduce the risk of fire, electric shock, or personal injury, mount fan only to an outlet box marked acceptable for fan support and use mounting screws provided with the outlet box. Most outlet boxes commonly used for the support of lighting fixtures are not acceptable for fan support and may need to be replaced. Consult a qualified electrician if in doubt.
5. The outlet box and ceiling support structure must be securely mounted and capable of supporting at least 45KGs.
6. To avoid personal injury or damage to the fan and other items, be cautious when working rounder cleaning the fan.
7. Do not use water or detergents when cleaning the fan or fan blades. A dry dust cloth or lightly dampened cloth will be suitable for most cleaning.
8. After making electrical connections, spliced conductors should be turned upward and pushed carefully pinto the outlet box. The wires should be spread apart with the grounded conductor and the equipment- grounding conductor on one side of the outlet box.
9. Electrical diagrams are for reference only.
10. The fan is suitable for indoor and covered outdoor.

TOOLS REQUIRED

Phillips screwdriver

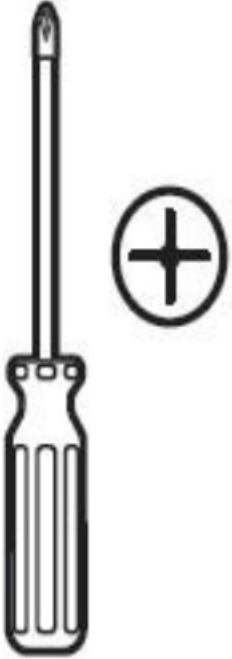

Flat blade screwdriver

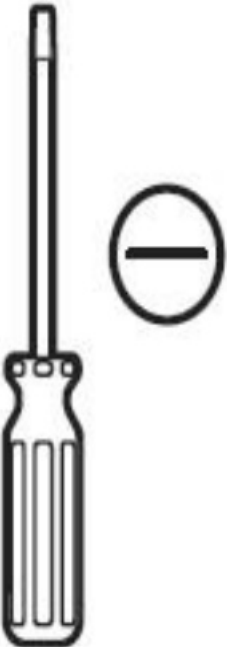

Step ladder



Wire stripper



Electrical tape



This manual is designed to make it as easy as possible for you to assemble, install, operate and maintain your ceiling fan

WARNING

Before assembling your ceiling fan, refer to section on proper method of wiring your fan (page 10). If you feel you do not have enough wiring knowledge or experience, have your fan installed by a licensed electrician.

Materials

Wiring outlet box and box connectors must be of type required by the local code. The minimum wire would be a 3-conductor(2-wire with ground) of the following size:

Installed Wire Length Wire Size A.W.G Up to 50 ft 14
50-100 ft 12

NOTE: Place the parts from the loose parts bags install container to keep them from being lost. If any parts are missing contact your local retailer.

Package Includes

Check to see that you have received the following parts:

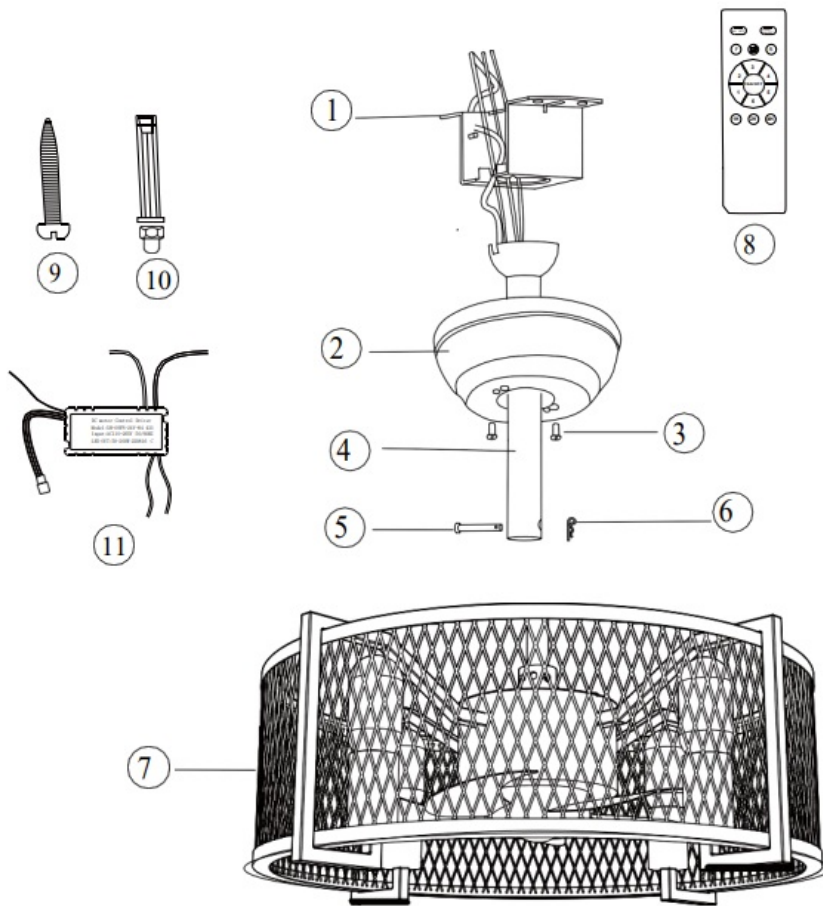

1. Mounting Bracket
2. Canopy
3. Canopy Screws
4. 4 & 8 inches Dowered
5. Cross Pin
6. Clamp Pin
7. Ceiling Fan Body
8. Hand-held Remote
9. Wood Screws
10. Expansion Screws
11. Receiver

INSTALL THE FAN

Tools Required: Phillips Screwdriver, Pair of Pliers, Straight slot screwdriver, Adjustable Wrench, Step Ladder and Wire Cutters.

INSTALL THE MOUNTING BRACKET

To prevent personal injury and damage, ensure that the hanging location allows the blade a clearance of 7 feet (2.13 meters) from the floor and 18 inches (45.72 centimeters) from any wall or obstruction.

If there isn't an existing CUL listed mounting box, then read the following instructions:

1. For the concrete ceiling: Mark the location for the ceiling fan first, then drill two holes in the ceiling to aid in securing ceiling bracket with two expansion screws provided, and secure the mounting bracket to the building structure with two expansion screws provided, tighten the screws. **(Fig. 1)**

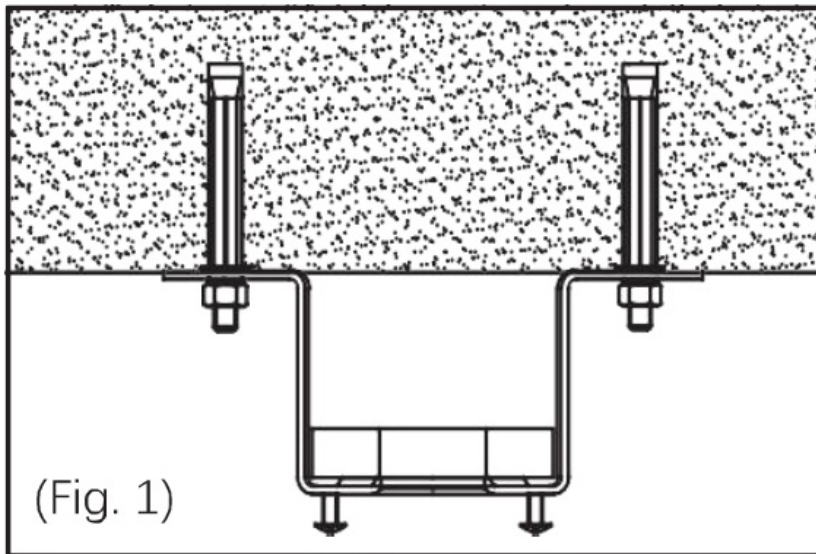

2. For the Wood Ceiling: Mark the location for the ceiling fan first, secure the mounting bracket to the building structure with four wood screws provided. **(Fig.2)**

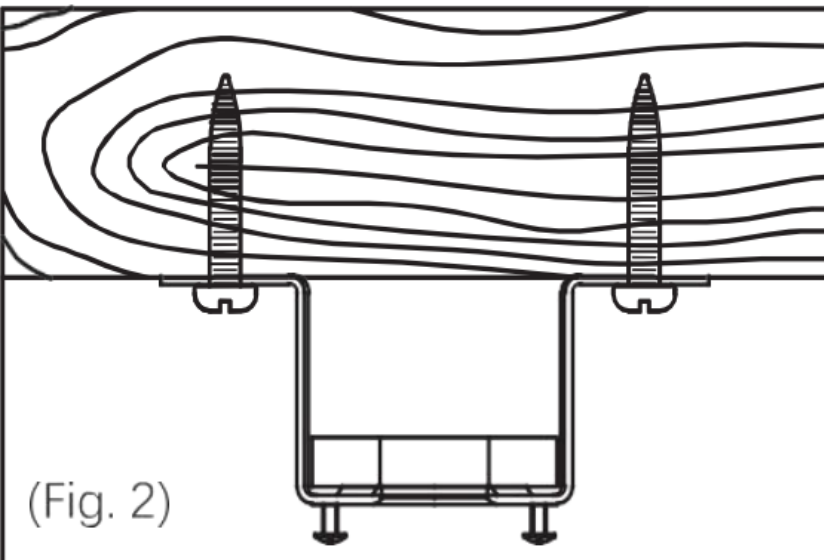

3. Refer to the **Fig 3** for mounting when the ceiling is angled max. 15 degree angle

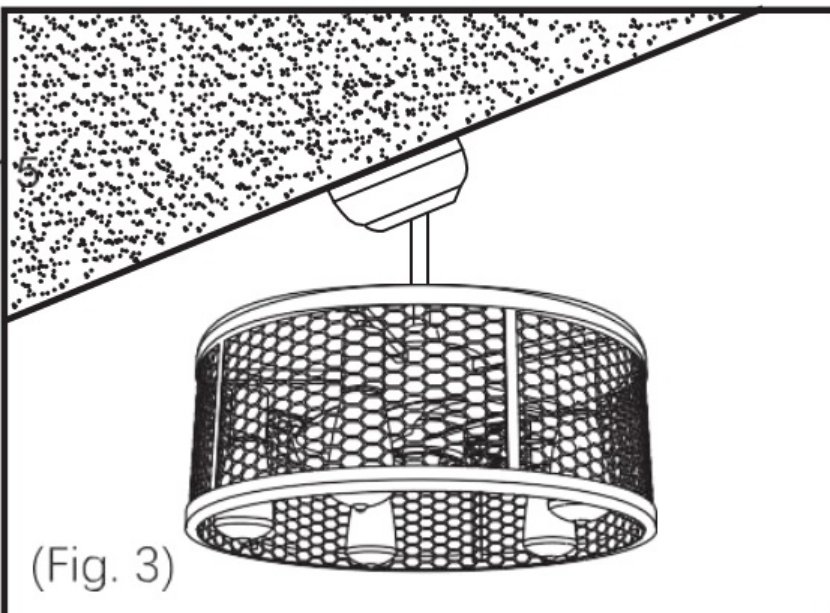

NOTE: Hanger after the installation must be able to withstand the weight of 45 kgs or more

INSTALL THE DOWNROD

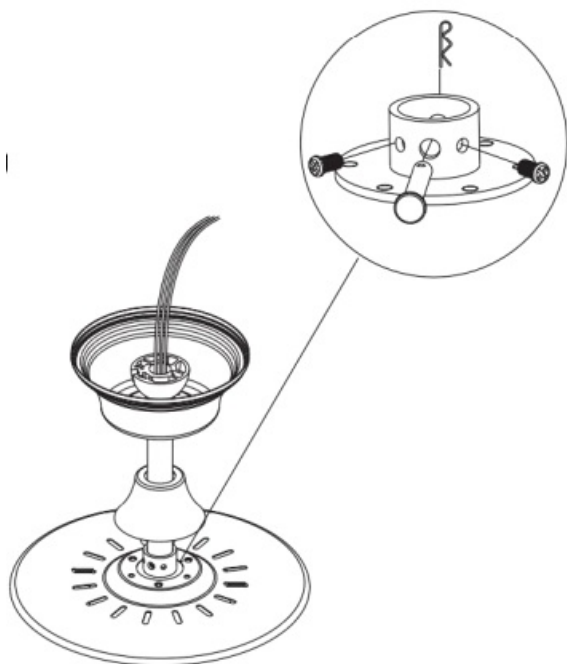

1. REMEMBER to turn off the power. Follow the steps below to hang your fan properly 1. Remove the lock pin and hitch pin from dowerd
2. Place dowerd assembly into canopy and coupling cover,
3. carefully feed motor wires through the downrod assembly Loosen the two set screws in downrod coupling
4. Insert downrod into downrod coupling. Install coupling lock pin through coupling and downrod. Insert hitch pin into cross pin until it snaps into place. Tighten set screws in coupling. Slide coupling cover over the dowered coupling.

CHANGE DOWNROD (OPT)

The Bella Depot Ceiling Fan comes with one 8 inches standard.

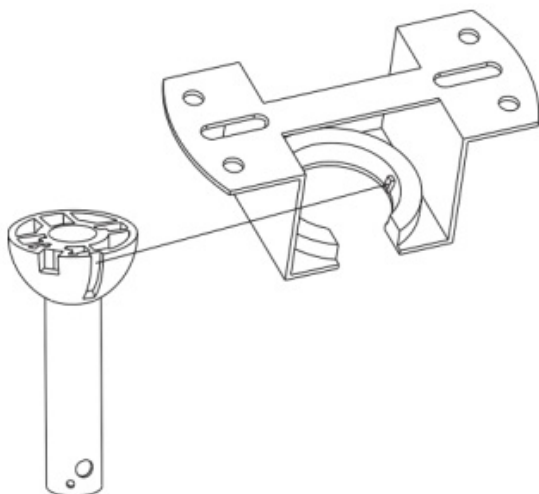

downrod which is preassembled and attached to the hanger ball, one longer 16 inches downrod is also included

for higher ceilings. If you need a different downrod length, please follow these steps:

1. Loosen the downrod by removing set screw.
2. Slide downrod off and remove pin
3. Re-install pin into extended downrod, and fixed downrod to the hanging bracket
4. Re-install set screw to secure ball to downrod

MOUNTING

1. Carefully lift motor assembly and place downrod onto the ball. Install pin into the downrod, and two fixed screw.
2. Adjust the length of the safety cable attach the safety cable from fan unit to hook, secure by looping zip tie through safety cable and hook. Tighten zip tie securely.

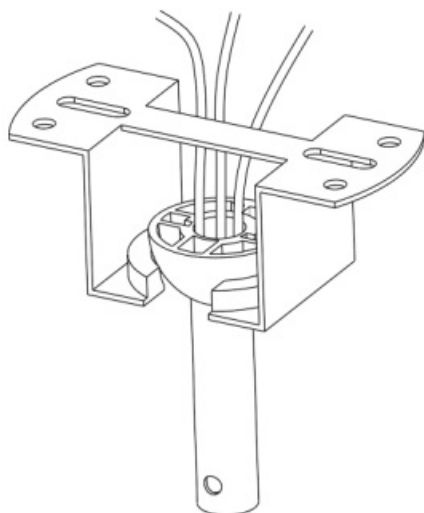

WIRING WITH REMOTE RECEIVER

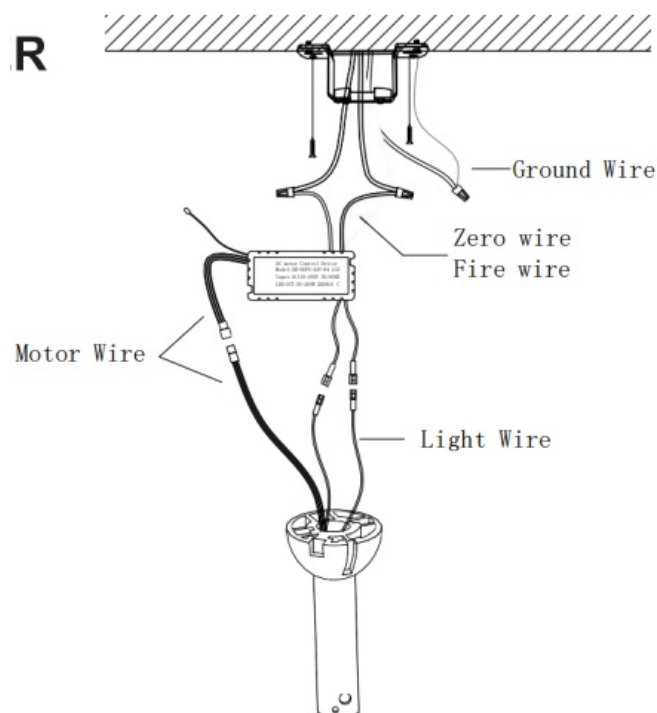

Plug the wires of the controller with the corresponding color of the fan, and then connect the other section of the controller to the zero wire and the fire wire, and then connect the ground wire.

SECURE THE CANOPY

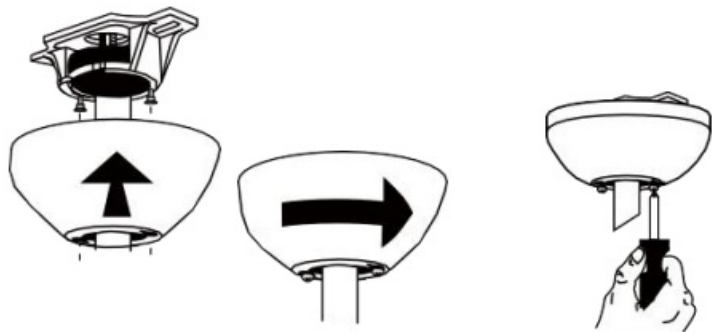

Raise the canopy up and align the keyholes on the bottom of the canopy with the 2 screws on the bottom of mounting bracket. Rotate the canopy until both screws from the mounting bracket drop into the slot recesses. Tighten screws securely.

INSTALL THE LIGHT BULB

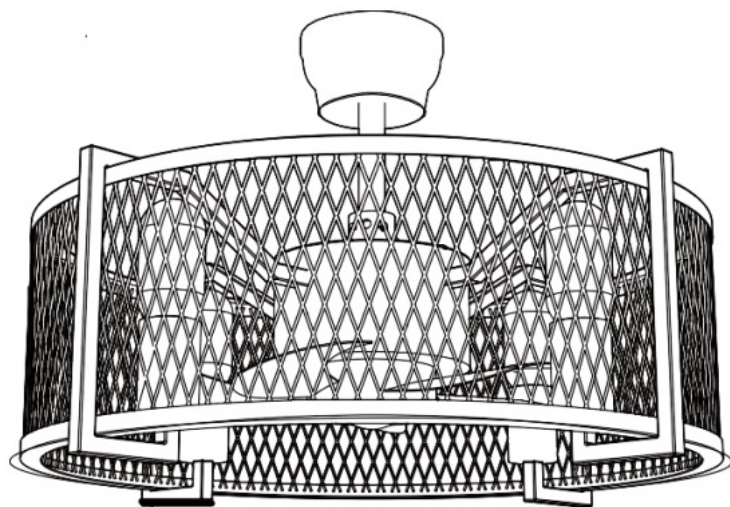

1. Make wiring connections, please refer to the figure right. for the electrician between fan motor and light bulb.
2. Rotate the 5 E26 bulb into the lamp slot.

INSTALL WALL SWITCHES (OPTIONAL)

BEFORE:

1. This is LED ceiling fan, it can't be gradually dimmed, DO NOT use any Dimmer Switch for this,
2. Install & Control the ceiling fan via remote OR wall switch, Please DO NOT install both of them since the wiring is complex depend on the different switch you use, and it may interfere with the remote/receiver signal and the fan/light fixture will not work properly.



Connections:

Black supply on the fan is connected to the Switched Live Supply No. 1. Blue supply is connected to the Switched Live supply no. 2

Note: This type of installation requires two switched lines so a three core + earth' cable is required. White supply is connected to the Neutral supply. Green/yellow earth lead is connected to the Earth supply (Green/Yellow)

Operations:

The light and fan are controlled by the wall switch. Two switches are used here. Donot connect the motor supply.

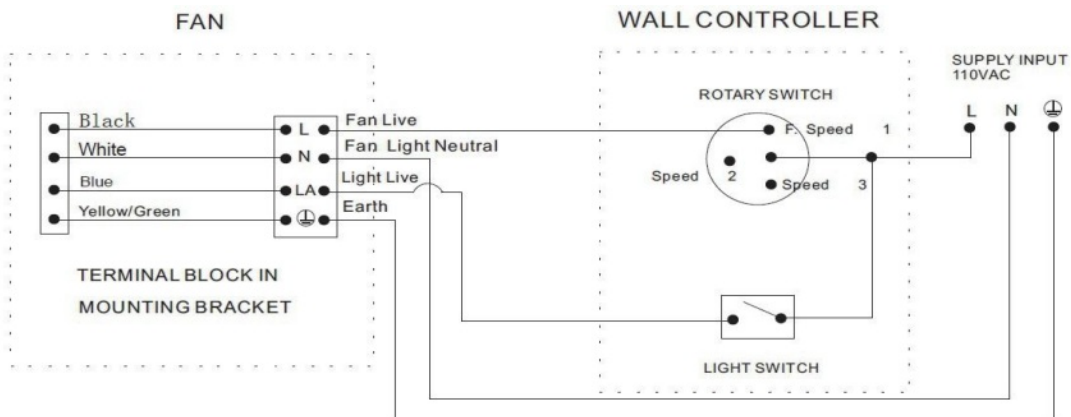

Remote Control

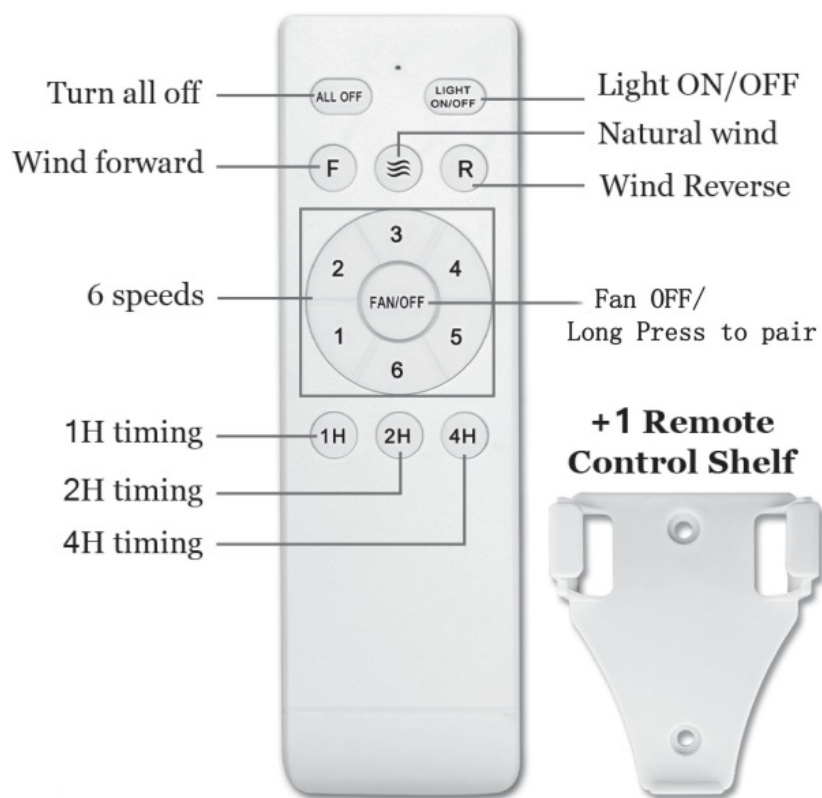

WARNING

For your own safety turn off power at fuse box or circuit breaker before trouble shooting.

Troubleshooting

Trouble	Probable Cause	Suggested Remedy
1. FAN WILL NOT START	1. Fuse or circuit breaker blown.2. Loose power line connections to the fan, or loose switch wire connections in the switch housing.3. Dead battery in remote control.4. Reversing switch in neutral position.	1. Check main and branch circuit fuses or circuit breakers.2. Check line wire connections to fan and switch wire connections in the switch housings. CAUTION: Make sure main power is turned off !3. Replace with new battery.4. Make sure reversing switch position is all the way to one side.
2. FAN SOUNDS NOISY	1. Loose screws in motor housing .2. Wire connectors inside housing rattling.3. Motor noise caused by solid state variable speed control.	1. Check to make sure all screws in motor housing are snug (do not over-tighten).2. Check to make sure wire connectors in switch housing are not rattling against each other or against the interior wall of the switch housing. CAUTION: Make sure main power is turned off!3. Some fan motors are sensitive to signals from solid-state variable speed controls. Solid-state control are not recommended, choose an alternative control method.
3. FAN WOBBLER EXCESSIVELY	1. Setscrew in downrod support is loose.2. Setscrew in downrod/hanger ball assembly is loose.3. Hanger bracket and/or ceiling outlet box is not securely fastened.	1. Tighten both setscrews securely in downrod support.2. Tighten the setscrew in the downrod/hanger ball assembly.3. Tighten the hanger bracket screws to the outlet box, and secure outlet box.

Maintenance

Periodic cleaning of your new ceiling fan is the only maintenance that is needed. When cleaning use only a soft brush or lint free cloth to avoid scratching the finish. Abrasive cleaning agents are not required and should be avoided to prevent damage to finish.

CAUTION

Do not use water to cleaning your ceiling fan. It could damage the motor or the finish and create the possibility of electrical shock.

Warranty

Dear Customer:

OHNIYOU warrants that this product is free from defects in materials and workmanship for a period of 1 years from the day of purchase. If the product has been misused, damaged by accident or in any other way of improper use, this warranty becomes void.

Please feel free to contact us: ohniyou@ledphy.com

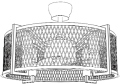

Documents / Resources

 Ceiling Fan With Light User Manual 020 	OHNIYOU GLX020-DB Caged Ceiling Fans with Lights and Remote [pdf] User Manual GLX020-DB Caged Ceiling Fans with Lights and Remote, GLX020-DB, Caged Ceiling Fans with Lights and Remote, Ceiling Fans with Lights and Remote, Fans with Lights and Remote, Lights and Remote, Remote
--	---

References

- [User Manual](#)

Pages: 1 [2](#)

[Manuals+](#), [Privacy Policy](#)

This website is an independent publication and is neither affiliated with nor endorsed by any of the trademark owners. The "Bluetooth®" word mark and logos are registered trademarks owned by Bluetooth SIG, Inc. The "Wi-Fi®" word mark and logos are registered trademarks owned by the Wi-Fi Alliance. Any use of these marks on this website does not imply any affiliation with or endorsement.