



# Ogena Solutions Q60750C OgenaShield Air and Surface Purifier User Guide

[Home](#) » [Ogena Solutions](#) » Ogena Solutions Q60750C OgenaShield Air and Surface Purifier User Guide 

## Contents

- [1 Ogena Solutions Q60750C OgenaShield Air and Surface Purifier](#)
- [2 Important Safety Instructions](#)
- [3 In The Box](#)
- [4 Operation and Placement](#)
- [5 DISPLAY ICONS](#)
- [6 Installation Instructions](#)
- [7 Maintenance Instructions](#)
- [8 Troubleshooting](#)
- [9 Documents / Resources](#)
  - [9.1 References](#)
- [10 Related Posts](#)



**Ogena Solutions Q60750C OgenaShield Air and Surface Purifier**



### **QUESTIONS OR FOR MORE INFORMATION**

Please visit [www.ogenasolutions.com/support](http://www.ogenasolutions.com/support) for instructions, tips, and more. Call our Product Support Line at 855-900-8822 or email us at [support@ogenasolutions.com](mailto:support@ogenasolutions.com)

### **READ AND SAVE THESE INSTRUCTIONS**

#### **Important Safety Instructions**

BEFORE USING THIS MACHINE READ ALL INSTRUCTIONS AND CAUTIONARY MARKINGS IN THIS USER GUIDE AND ON THE MACHINE.

When using an electrical machine, basic precautions should always be followed including the following:

#### **WARNING**

These warnings apply to the machine, and also where applicable, to all accessories, lamps, filters or mains adapters.

#### **TO REDUCE THE RISK OF FIRE, ELECTRICAL SHOCK, OR INJURY**

1. This machine is not intended for use by persons (including children) with reduced physical, sensory or reasoning capabilities, or lack of experience and knowledge, unless they have been given supervision or instruction concerning use of the machine by a person responsible for their safety.
2. Ensure machine is fully assembled in line with the instructions before use. Do not dismantle the machine.

3. Do not allow to be used as a toy. Close attention is necessary when used by or near children. Children should be supervised to ensure that they do not play with the machine.
4. Use only as described in this User Guide. Do not carry out any maintenance other than that shown in this manual,  
Or advised by Ogena Solutions Product Support.
5. Suitable for dry location ONLY. Do not use outdoors and do not expose to water or rain.
6. Do not handle any part of the plug or machine with wet hands.
7. Do not operate any machine with a damaged cord or plug. Discard the machine or return to an authorized service facility for examination and/or repair. If the supply cord is damaged it must be replaced by Ogena Solutions its service agent or similarly qualified person in order to avoid a hazard.
8. If the machine is not working as it should, has received a sharp blow, has been dropped, damaged, left outdoors, dropped into water, do not use and contact the Ogena Solutions Helpline at 855-900-8822.
9. Do not stretch the cord or place the cord under strain. Keep cord away from heated surfaces.
10. Do not run cord under carpeting. Do not cover cord with throw rugs, runners or similar coverings. Do not route cord under furniture or appliances. Arrange cord away from traffic area and where will not be tripped over.
11. Do not unplug by pulling on the cord. To unplug, grasp the plug, not the cord. The use of an extension cord is not recommended.
12. Do not put any object into openings or the inlet grill. Do not use with any opening blocked; keep free of dust, lint, hair, and anything that may reduce airflow.
13. Clean the machine with a wet cloth only. Do not use any cleaning agents or lubricants on this machine. Unplug before cleaning or carrying out any maintenance.
14. Always carry the machine by the base, do not carry it by the top cover handle.
15. Unplug from outlet when not in use for extended periods. To avoid a tripping hazard, safely coil the cord.
16. Do not use near furnaces, fireplaces, stoves or other high-temperature heat sources.
17. Do not use in conjunction with or directly next to an air freshener or similar products. Keep essential oils and chemicals away from the appliance.

### **CAUTION**

Changes or modifications not expressly approved in writing by Ogena Solutions will void the user's authority to operate the equipment.

### **WARNING**

To reduce the risk of fire or electric shock, do not use this fan with any solid-state speed control device.

### **THIS MACHINE IS INTENDED FOR INDOOR USE ONLY**

### **NOTE**

This equipment has been tested and found to comply with the limits for a Class B digital device, pursuant to Part 15 of the FCC Rules. These limits are designed to provide reasonable protection against harmful interference in a residential installation. This equipment generates, uses and can radiate radio frequency energy and, if not installed and used in accordance with the instructions, may cause harmful interference to radio communications. However, there is no guarantee that interference will not occur in a particular installation. If this equipment does cause harmful interference to radio or television reception, which can be determined by turning the equipment off and on, the user is encouraged to try to correct the interference by one or more of the following measures:

- Reorient or relocate the receiving antenna.
- Increase the separation between the equipment and the receiver.

- Connect the equipment into an outlet on a circuit different from that to which the receiver is connected.
- Consult the dealer or an experienced radio/TV technician for help.

This device complies with Part 15 of the FCC Rules. Operation is subject to the following two conditions: (1) this device may not cause harmful interference, and (2) this device must accept any interference received, including interference that may cause undesired operation. This product complies with the maximum allowable concentration of ozone of 0.050 parts per million by volume (ppvm) in a 24-h period.

## In The Box

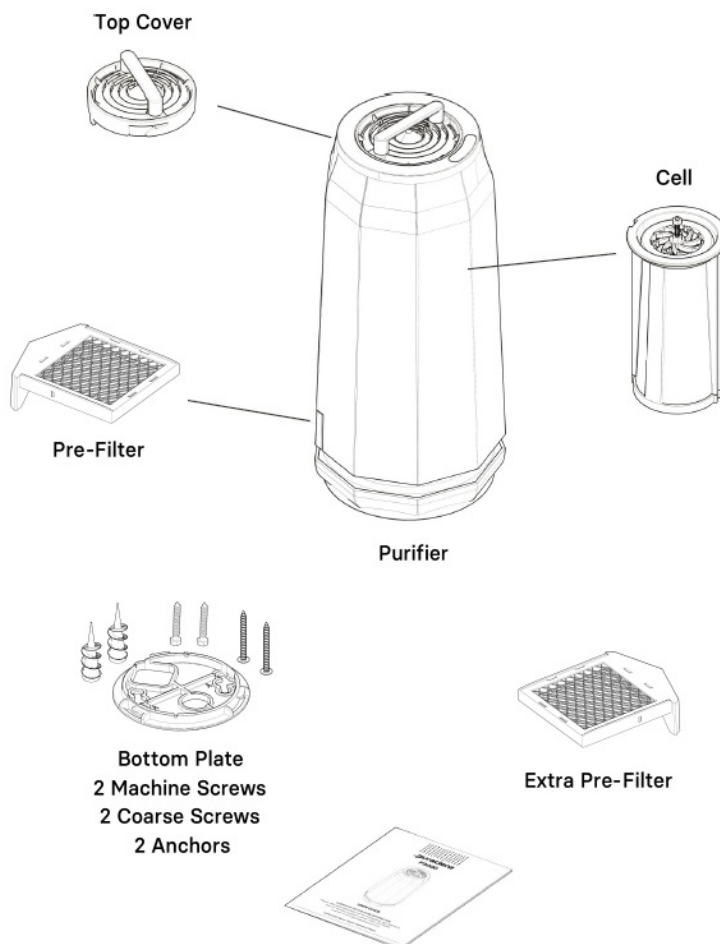

## Operation and Placement

SCAN for  
Installation Guide











## For best results

1. To assist you in placing your Purifier unit, please scan the QR code to view the Installation Guide that provides instructions, tips and more.
2. The Purifier unit should be placed in a central location and always stay connected to electric power. Do not connect power cord to a switched outlet or automatic timer that can stop continuous use.
3. The Purifier unit is designed to operate 24/7 for continuous coverage. During normal operation, you will hear

the fan running and green light will be on.

- Set room temperature thermostat to 72°F (22°C) or higher. If possible, maintain 40- 70% relative humidity. Keep windows closed for best results.
- Ions can travel long distances, but cannot move through walls and move very slowly through cracks under closed doors. Choose a central location.
- In spaces with ceilings over 12 feet, place your Purifier unit no higher than 10 feet off the floor.

## DISPLAY ICONS

 <i>Green Power On</i>	<b>Normal Operation</b>	 <i>Green Power &amp; Red Cell On</i>	<b>Reduced Operation and Order Cell</b>
 <i>Red Cell On</i>	<b>Replace Cell Unit Not Working</b>	 <i>Red Cell Flashing</i>	<b>Top Cover Open Unit Not Working</b>
 <i>Green Power &amp; Red Pre-Filter On</i>	<b>Normal Operation and Order Pre-Filter</b>	 <i>Red Pre-Filter Flashing</i>	<b>Pre-Filter Open Unit Not Working</b>
 <i>Red Pre-Filter On</i>	<b>Change Pre-Filter Unit Not Working</b>	 <i>Red Service On</i>	<b>Call for Service Unit Not Working</b>
 <i>All Lights Off</i>	<b>No Power</b>		

## Installation Instructions

### For ceiling or wall installations

- Secure the mounting bracket to the wall or ceiling using the screws positioned in the small ends of the keyholes before tightening the screws (A). See Diagram 1.
- Pull the power cord plug through the rectangular hole in the mounting bracket (A). Install the Purifier unit on the mounting bracket (B) and rotate the Purifier unit in the counterclockwise direction (C) until you hear an audible click sound. See Diagram 2.
- If an electrical outlet is not available or cannot be used, then have a certified electrician perform the connection.
- For drop ceiling installation: Always have a certified electrician perform the installation by securely attaching the mounting bracket to the drop-tile ceiling rail.

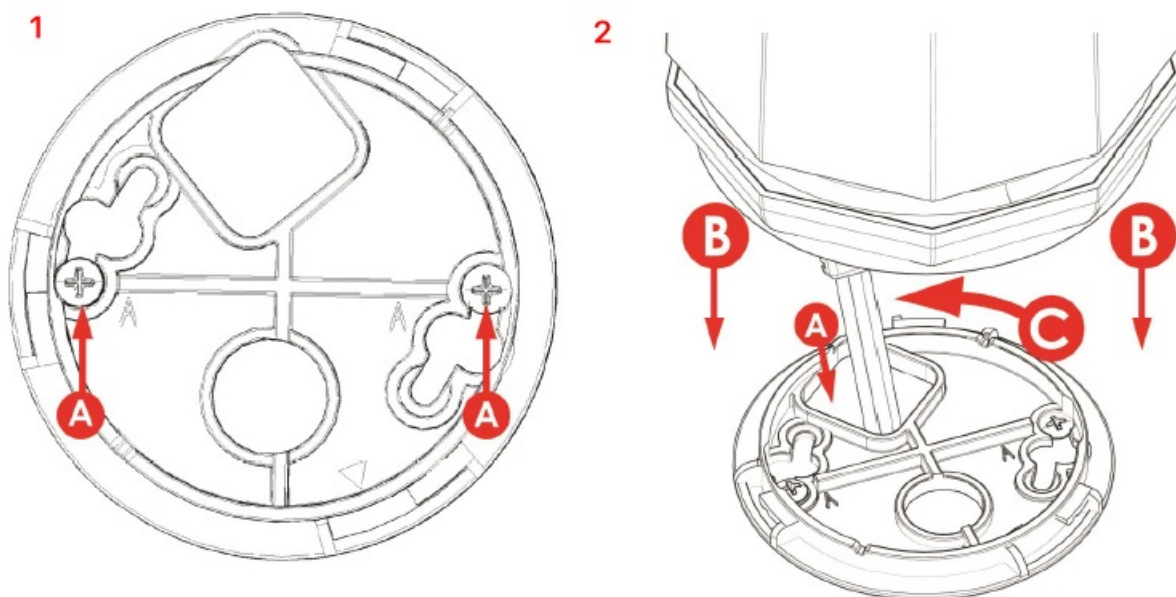

### For tabletop installations

1. Place the Purifier unit in the desired installation location.
2. Plug into an electrical outlet and the Purifier unit will automatically start purifying.

### Maintenance Instructions

SCAN for  
Change Pre-Filter  
Video Instructions



### Change Pre-Filter

1. Slide out the old filter and discard it. See Diagram 1.
2. Slide in new Pre-Filter Model#R0001 to automatically resume normal operation. See Diagram 2.

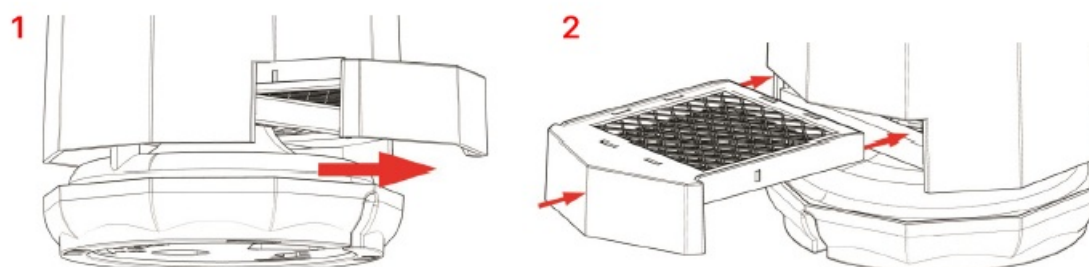

## Wash Pre-Filter

For best results, it is recommended to always to use a brand-new Pre-Filter.

1. Slide out the dirty filter and set aside. See Diagram 1.
2. Slide in new or clean Pre-Filter Model#R0001 to automatically resume normal operation. See Diagram 2.
3. Spray water into dirty Pre-Filter to clean off all debris. See Diagram 3.
4. Shake excess water off Pre-Filter and let it dry overnight. Never install a wet Pre-Filter into the Purifier unit. See Diagram 4.

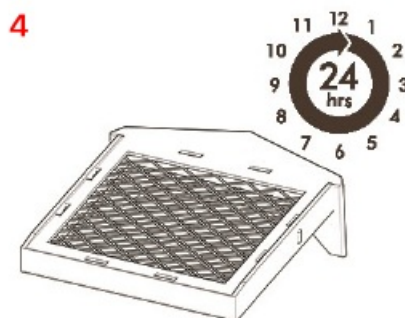
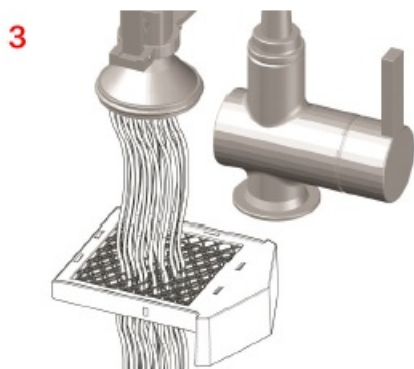

## Replacing Cell

SCAN for  
Change Pre-Filter  
Video Instructions



Disconnect power before doing any work to your Purifier unit.

1. Turn Top Cover counterclockwise (A) and remove (B).  
**Note:** if your Purifier unit is ceiling or wall-mounted, be careful not to allow the Cell to fall out when removing the Top Cover.
2. Use your fingers or pliers to slide out old Cell from the Purifier unit and discard it.
3. Remove Red Cap from the new Cell (Model#R0002).
4. Slide in new Cell into the Purifier unit by aligning keyholes.
5. Align the Top Cover with the Puraclenz® logo 30° counterclockwise to the front of the Purifier unit as highlighted in Diagram Then place the Top Cover into Purifier as highlighted in Diagram
6. (A). Twist the Top Cover clockwise (B) until you hear an audible click from the safety latch (highlighted) to automatically resume operation.

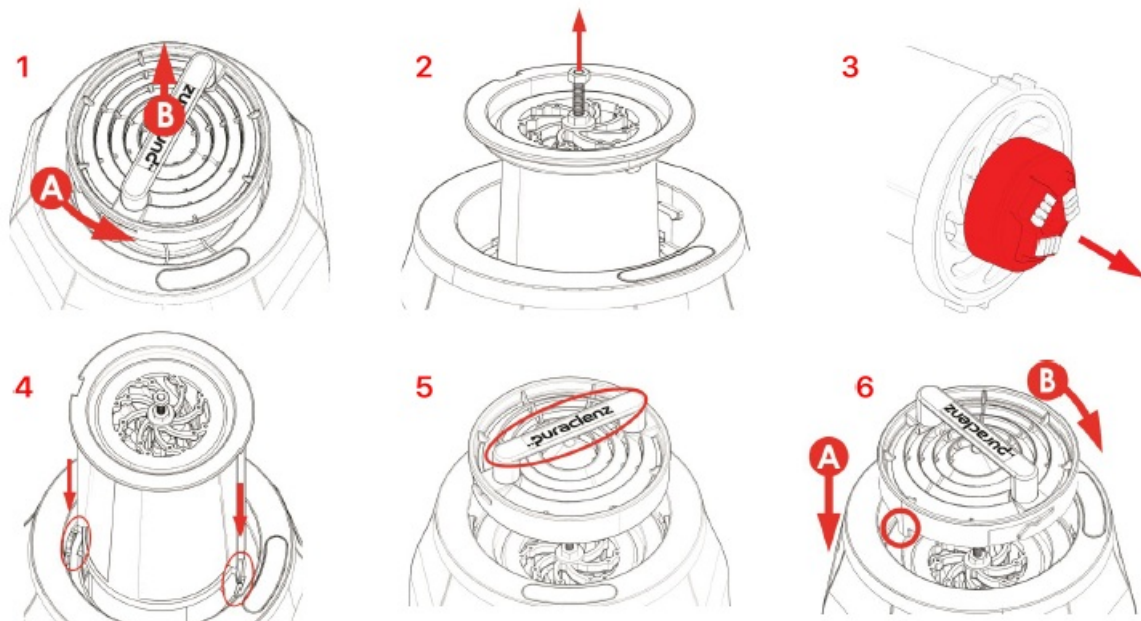

**WARNING:**

Skin or eye damage may result from directly viewing the light produced by the lamps in the Cell apparatus. Always disconnect the power before relamping or servicing. Replace Cell with Puraclenz® Model#R0002.

**IMPORTANT:**

To prevent injury or damage for all ceiling and wall installations, when removing Top Cover take care not to allow Cell to fall out.



## Troubleshooting

### Normal Operation

This shows your Purifier unit is working correctly.



Green Power On

### No Power

1. Verify there is power provided to the electrical outlet.
2. Ensure Power Cord is connected properly to electrical outlet.



All Lights Off

### Replace Cell

This indicates that your Purifier unit has operated for enough hours that the Cell must be replaced. Follow Replace Cell instructions on page 7.



Red Cell On

### Top Cover Open

Twist your Top Cover firmly in the clockwise direction until you hear an audible click sound. See diagram 5 on page 7.



Red Cell Flashing

### Order Cell

This indicates your Purifier unit has reduced operation and you need to replace your Cell. Order a new model #R0002 Cell. If your Cell is still under warranty, contact Ogena Solutions support at 855-900-8822 or support@ogenasolutions.com.

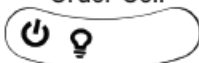

Green Power & Red Cell On

### Order Pre-Filter

This indicates your Purifier unit is in good, working order, but your Pre-Filter is nearing the end of its operating lifespan. Order a new model #R0001 Pre-Filter.



Green Power & Red Pre-Filter On

### Pre-Filter Open

1. Press Pre-Filter firmly inside Purifier unit for correct fit until you hear an audible click sound.
2. Check the Pre-Filter is installed correctly as shown by diagram 2 on page 6.



Red Pre-Filter Flashing

### Change Pre-Filter

Either change or wash Pre-Filter following instructions on page 6.



Red Pre-Filter On

### Call for Service

If the service light is on, contact Ogena Solutions support for assistance at 855-900-8822 or support@ogenasolutions.com.



Red Service On

Ogena Solutions Canada Corp., 442 Millen Rd, Unit 6, Stoney Creek ON, Canada L8E 6H2 PURACLENZ is a registered trademark of Puraclenz LLC. All rights reserved. ©2022 Puraclenz LLC.

## Documents / Resources

 <p><b>USER GUIDE</b></p> <p>QUICKSTART AND USER INSTRUCTIONS Please read these instructions carefully before using the unit. Call our Product Support Line at 855-900-8822 or email us at support@ogenasolutions.com READ AND SAVE THESE INSTRUCTIONS</p>	<p><a href="#">Ogena Solutions Q60750C OgenaShield Air and Surface Purifier</a> [pdf] User Guide Q60750C, Q61500C, Q63000C, Q60750C OgenaShield Air and Surface Purifier, OgenaShield Air and Surface Purifier, Air and Surface Purifier, Surface Purifier, Purifier</p>
---	--

## References

- [Support - Ogena Solutions](#)