



## Odaro Q30 Label Maker Machine with Tape Instruction Manual

[Home](#) » [Odaro](#) » Odaro Q30 Label Maker Machine with Tape Instruction Manual 

# Odaro

Instruction Manual

Q30

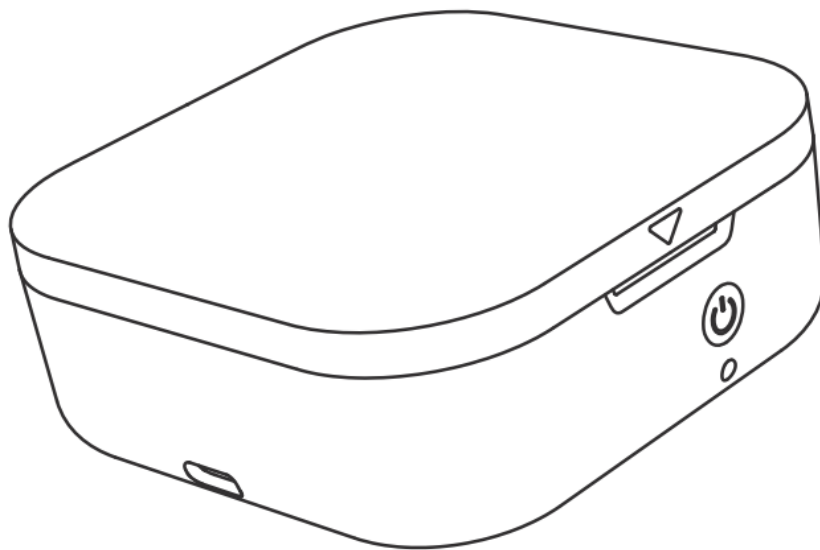

Please read the instructional manual carefully before using the product.

## Contents

- 1 Packing List
- 2 Product Specifications
- 3 Parts Description
- 4 Guidelines for Use
- 5 Boot Guide
- 6 App Download Method
- 7 Printer Connection
- 8 Confirm the Label Size
- 9 FCC Caution
- 10 IC Caution
- 11 Documents / Resources
  - 11.1 References

## Packing List

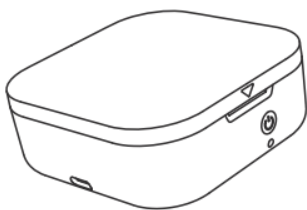

Printer\*1



Product instruction\*1

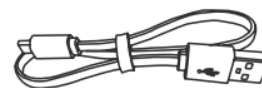

Charging line\*1



The number of paper rolls in the list is subject to the actual shipment.

## Product Specifications

Product name	Smart Mini Label Maker
Product model	Q30
Printing technology	Thermal printing
Consumable width	12-15mm
Effective printing width	12 mm
Supported consumables	Pre-cut paper. black mark paper. continuous paper
Printing density	Lightstandarthdark
Printing resolution	203 dpi
Print head service life	50 KM
Communication interface	Bluetooth
Product size	82'82'32.5 mm (3.23'3.23'1.28 inch)
Power input	5V — 2A
Power supply method	4 Alkaline MA battery / Data wire
Supported operating system	Android/iOS

Parts Description

Appearance Introduction

01 Label Maker display

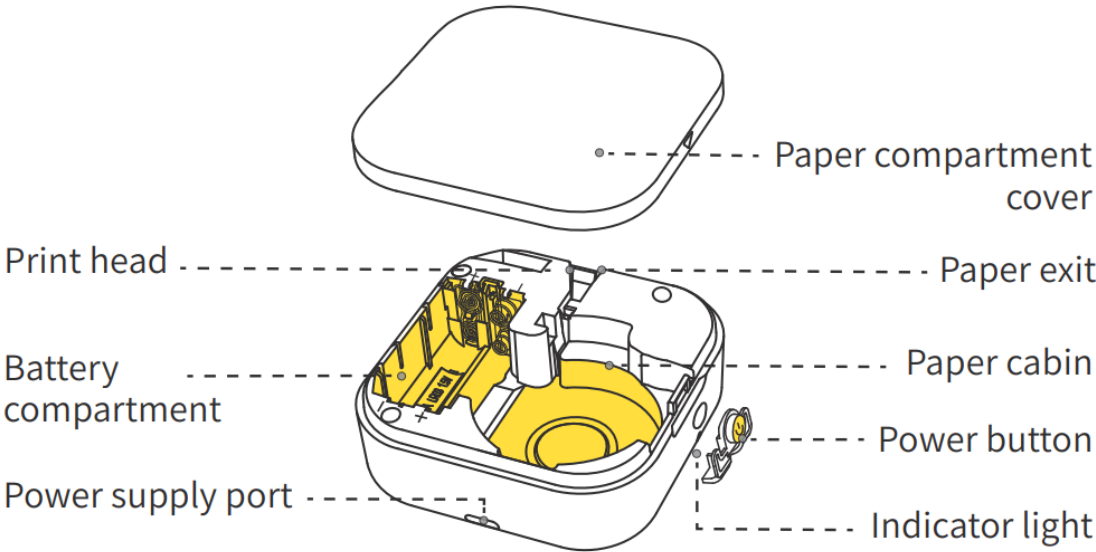

02 Label paper display

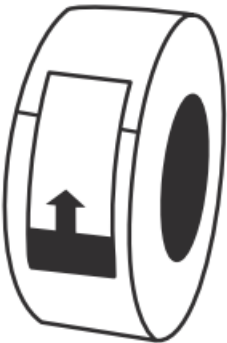

Various labels available for purchase



Pre-cut paper display

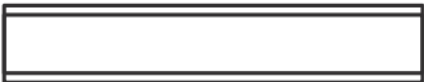

Continuous paper display

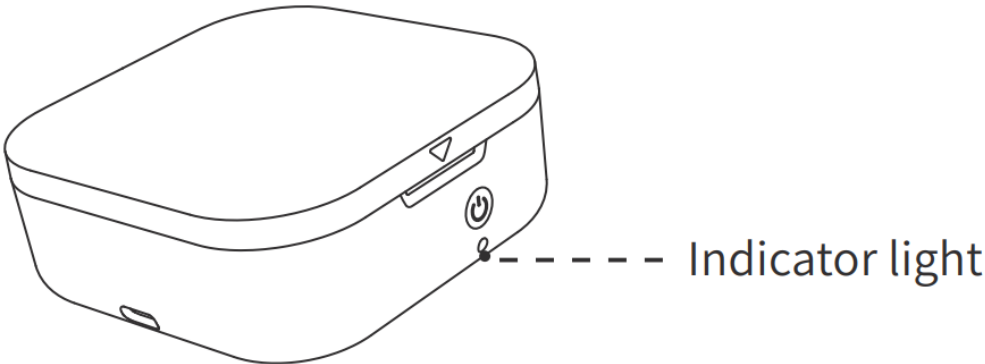

Power Button and Indicator Light



Power button description

Button	Operation method	Functions
Power button	Press and hold 3s	Turn on/off
	Click	Print out the paper
	Double click	Print the content of the self-test paper

### Power indicator status

 Green light keeps on	Normal status
 Red light keeps on	Error (lack of paper, cover opened, high temperature)
 Red light flashes quickly	Low power supply, printer off

### Guidelines for Use

Guidance on switching on the power supply

#### Method I:

The charging line can be connected, and switch on the power supply (if the battery is used for the power on, this step can be ignored).

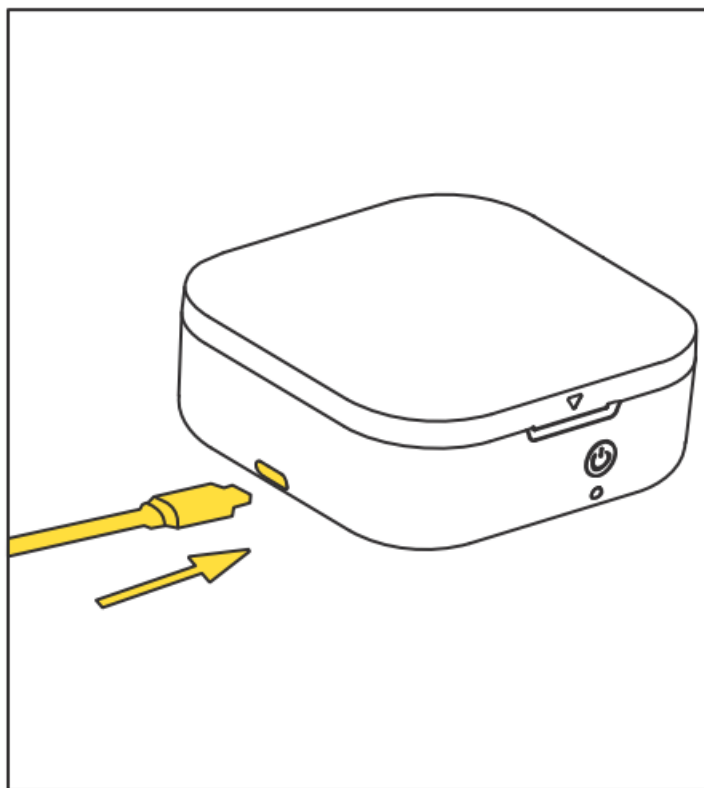

#### Method II:

4 Alkaline AAA battery can be installed, and ensure that the positive and negative direction of the battery is correct (if the charging line is used, this step can be ignored).

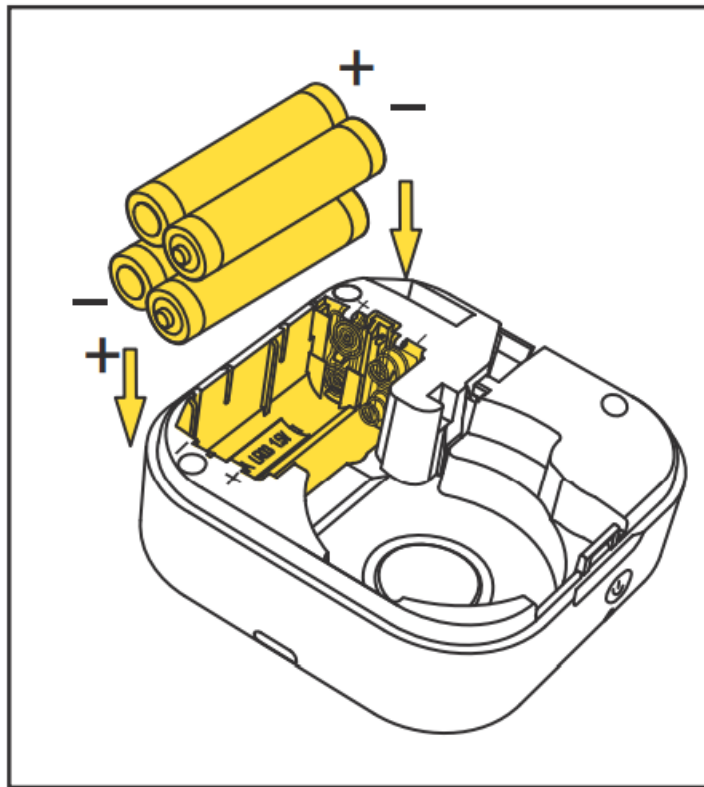

**NOTE** This product supports plug-in/dry battery use, but it does not support charging. The product needs to use alkaline batteries, do not use carbon batteries.

1. Open the paper compartment cover of the machine.

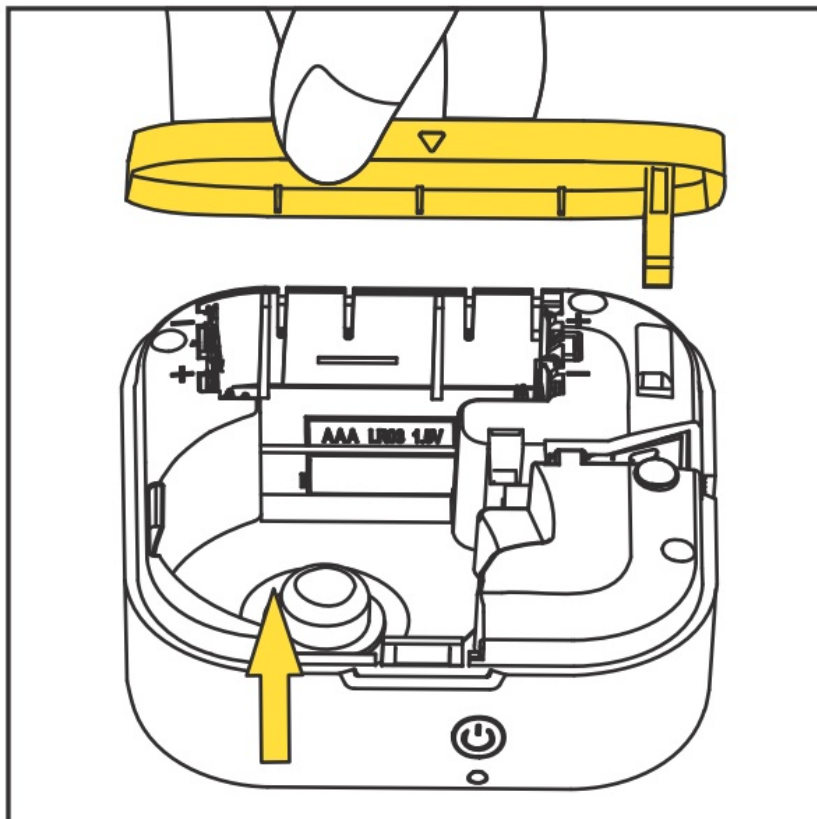

2. Take out the label paper, tear off the anti-loosening sticker.

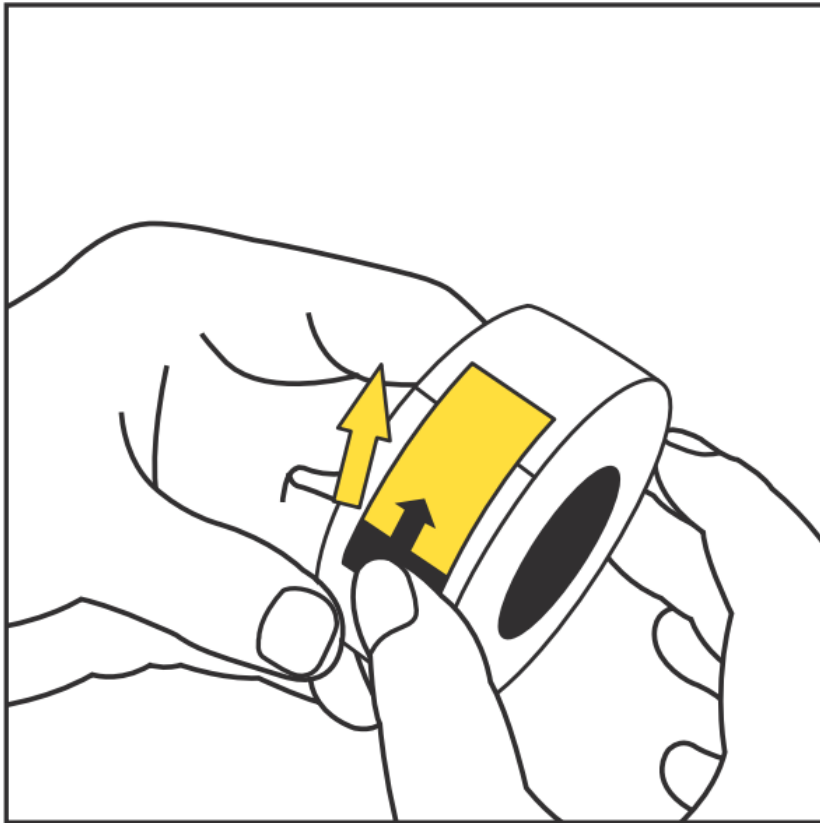

3. Put the print face in the paper hatch toward the battery.

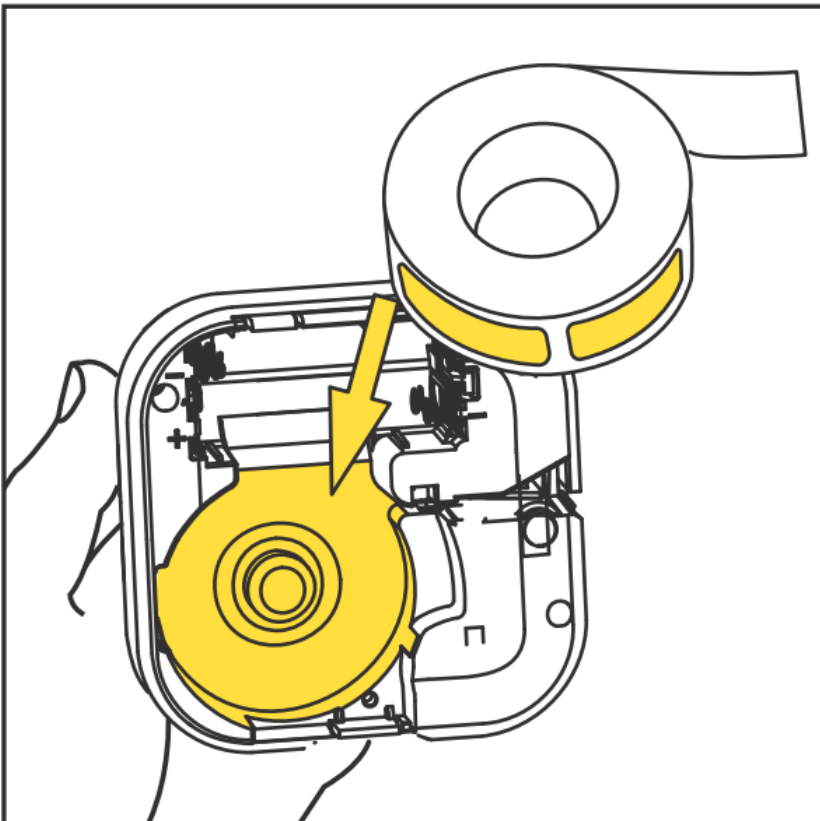

4. Pull out the label paper out of the Paper exit by 5 mm in length for normal printing.

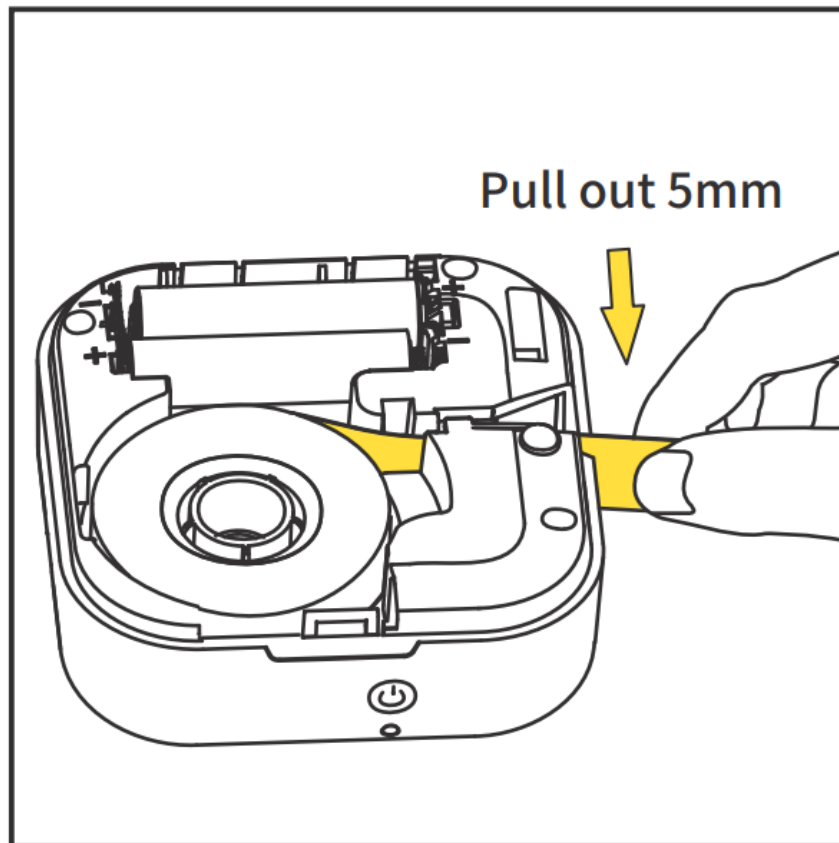

5. Closing the cover after alignment the cover open position.

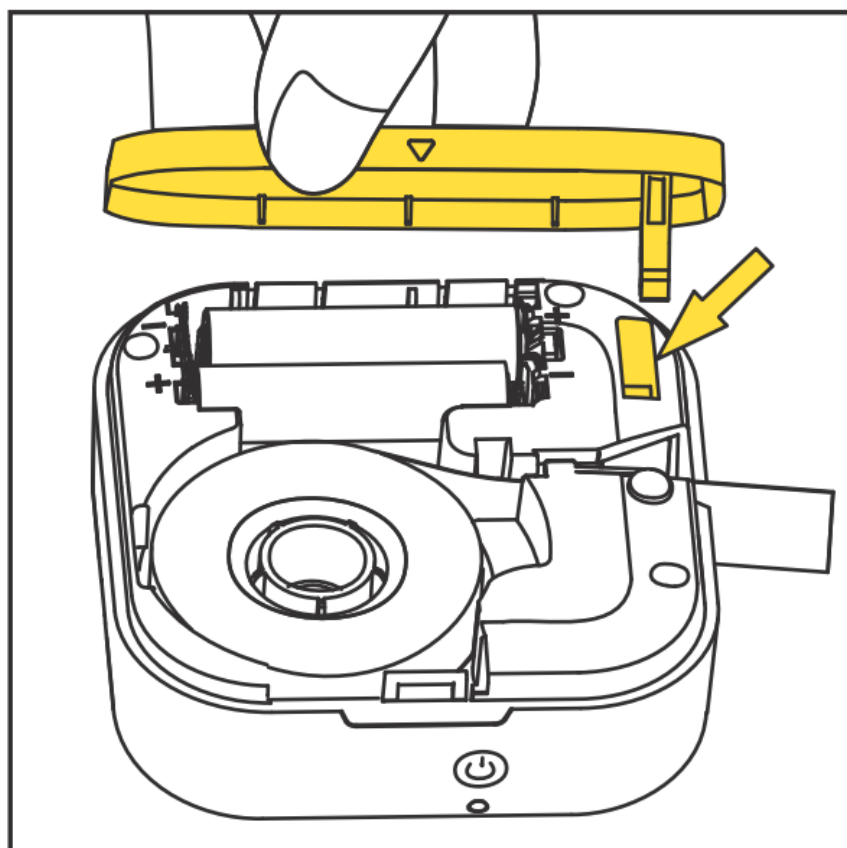

## Boot Guide

1. After turning on the power, press and hold for 3 seconds, and click the power button to identify the label position.

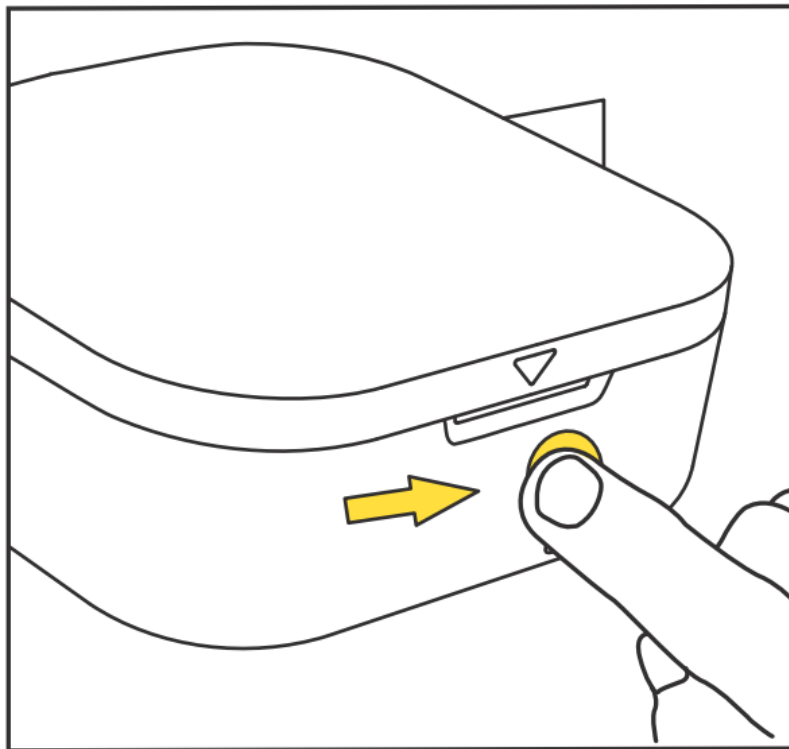

2. Come out a piece of paper positioning completed.

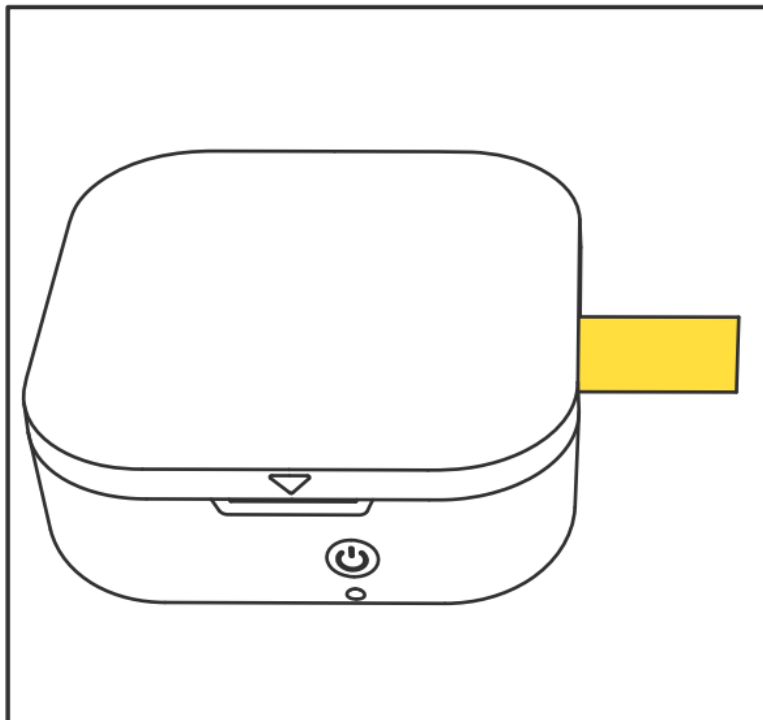

**NOTE** When installing or replacing the label roll for the first time, the label position identification is required. Step 01

If the label position identification is not carried out Step 01 , failures may occur such as first printing missing, not centered, etc.

## App Download Method





**NOTE** This product needs to be connected to the Label Maker in the App.

Due to the requirements of mobile phone system, the Android mobile phone will use the user's geographic location when connecting, so that the user needs to turn on the GPS and confirm the authorization.

**Method I:**

Please use your mobile phone to scan the QR code to download the App.



<https://downloadapp.qu-in.top/M110-Print-master/>

**Method II:**

Search "Print Master" to download App.



## Printer Connection

1. Turn on GPS.(Android mobile phone only.)

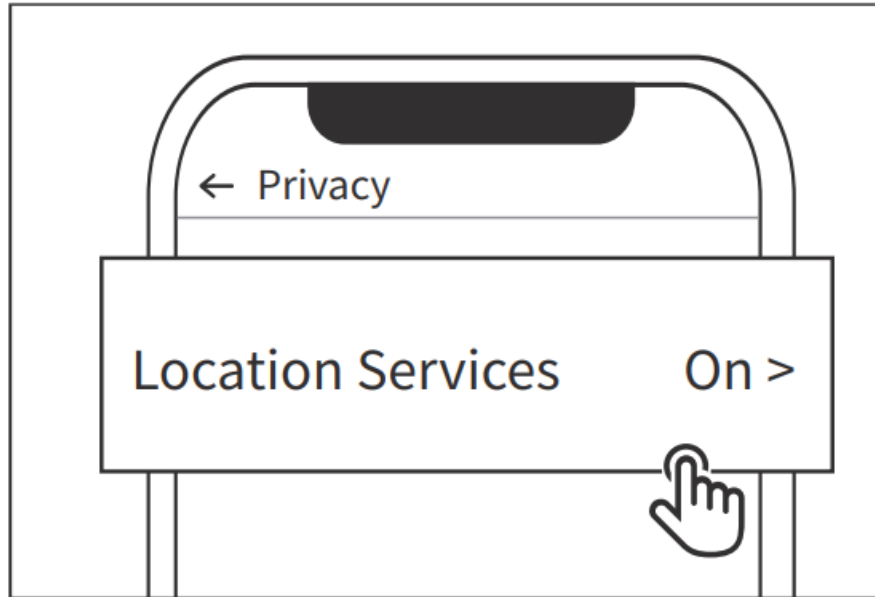

2. Open the App.

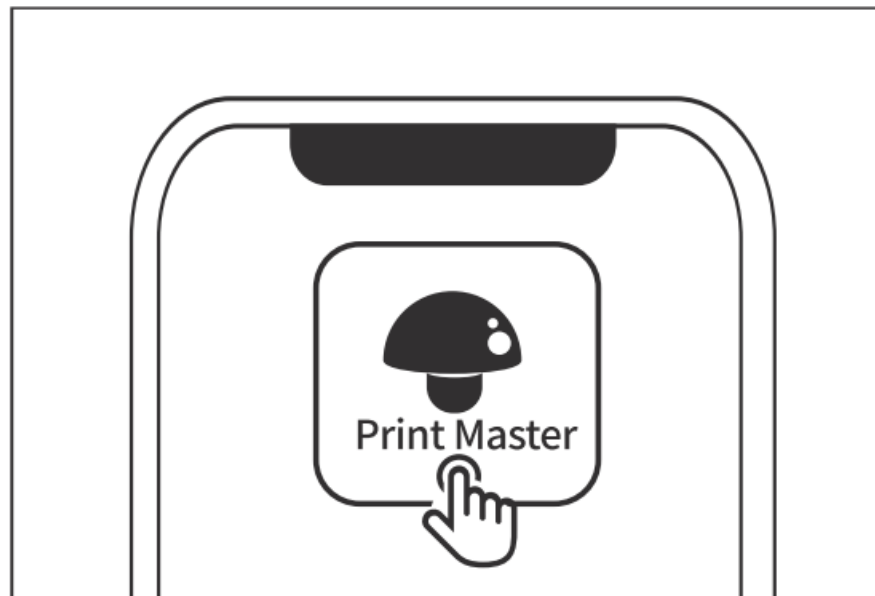

3. Click to search connect now for the device.

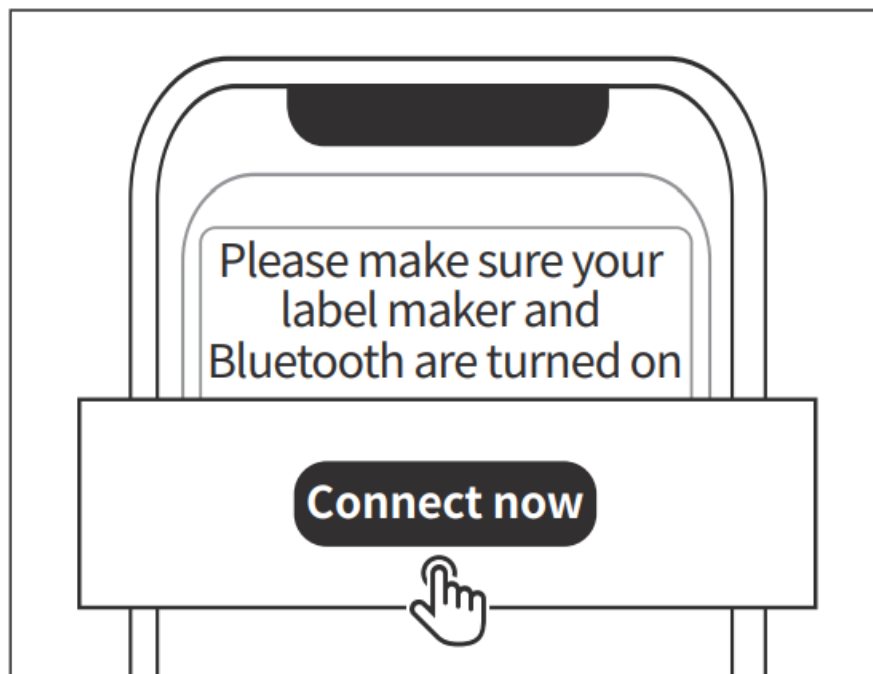

4. Connect immediately.

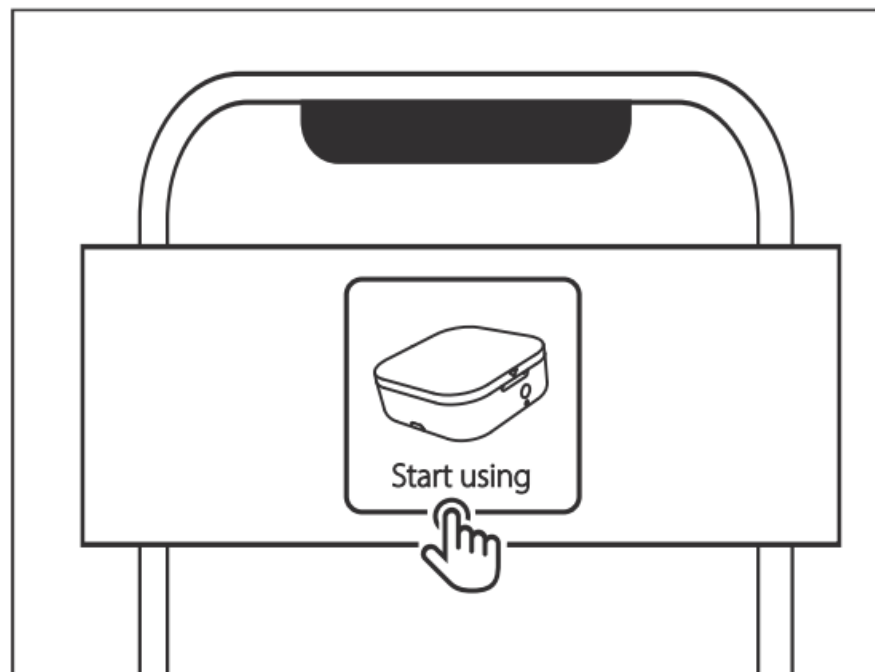

- This product needs to be connected to the printer in the App after the Bluetooth is turned on.
- According to the official requirements of Google, Android mobile phones need to open the GPS permission before they can use the Bluetooth function.
- When connecting the App, please make sure that the printer is turned on and the Bluetooth of the mobile phone is turned on.

## Confirm the Label Size

### Method I:

Check the label paper packaging.

Please refer to the actual size used.

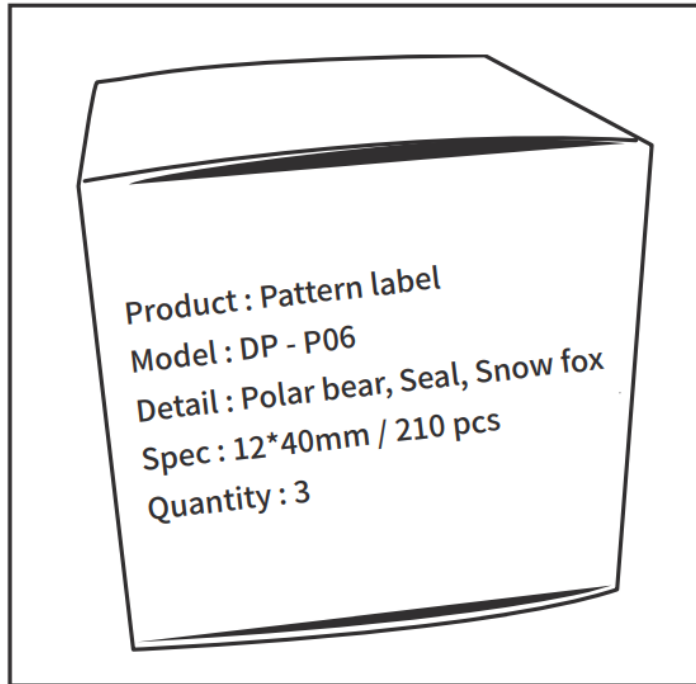

**Method II:**

Check the label paper pads.

The old and new versions of label paper are being replaced, please refer to the actual shipment.



**FCC Caution**

This device complies with part 15 of the FCC Rules. Operation is subject to the following two conditions:

1. his device may not cause harmful interference, and
2. this device must accept any interference received, including interference that may cause undesired operation.

Any Changes or modifications not expressly approved by the party responsible for compliance could void the user's authority to operate the equipment.

**Note:** This equipment has been tested and found to comply with the limits for a Class B digital device, pursuant to part 15 of the FCC Rules. These limits are designed to provide reasonable protection against harmful interference

in a residential installation. This equipment generates uses and can radiate radio frequency energy and, if not installed and used in accordance with the instructions, may cause harmful interference to radio communications. However, there is no guarantee that interference will not occur in a particular installation. If this equipment does cause harmful interference to radio or television reception, which can be determined by turning the equipment off and on, the user is encouraged to try to correct the interference by one or more of the following measures:

- Reorient or relocate the receiving antenna.
- Increase the separation between the equipment and receiver.
- Connect the equipment into an outlet on a circuit different from that to which the receiver is connected.
- Consult the dealer or an experienced radio/TV technician for help.

\*RF warning for Portable device: The device has been evaluated to meet general RF exposure requirement. The device can be used in portable exposure condition without restriction.

## IC Caution

Radio Standards Specification RSS-Gen, issue 5- English:

This device contains licence-exempt transmitter(s)/receiver(s) that comply with Innovation, Science and Economic Development Canada's licence-exempt RSS(s). Operation is subject to the following two conditions:

This device may not cause interference.

This device must accept any interference, including interference that may cause undesired operation of the device.

### RF exposure statement:

The device has been evaluated to meet general RF exposure requirement. The device can be used in portable exposure condition without restriction.



---

## Documents / Resources

 The image shows the front cover of the instruction manual for the Odaro Q30. It features a white background with a small image of the label maker machine. The text "Instruction Manual" and "Q30" are visible at the top, and "English" is at the bottom.	<p><a href="#">Odaro Q30 Label Maker Machine with Tape</a> [pdf] Instruction Manual</p> <p>Q30, Q30 Label Maker Machine with Tape, Label Maker Machine with Tape, Maker Machine with Tape, Machine with Tape</p>
--	--

## References

- [User Manual](#)

### [Manuals+](#), [Privacy Policy](#)

This website is an independent publication and is neither affiliated with nor endorsed by any of the trademark owners. The "Bluetooth®" word mark and logos are registered trademarks owned by Bluetooth SIG, Inc. The "Wi-Fi®" word mark and logos are registered trademarks owned by the Wi-Fi Alliance. Any use of these marks on this website does not imply any affiliation with or endorsement.