



# OCTOPUS OCTAF1012 Hydraulic Reversing Pumps Instruction Manual

[Home](#) » [OCTOPUS](#) » OCTOPUS OCTAF1012 Hydraulic Reversing Pumps Instruction Manual 



**Autopilot Drive Solutions  
Instruction Manual**



## Contents

- 1 OCTAF1012 Hydraulic Reversing Pumps
- 2 HYDRAULIC REVERSING PUMPS
- 3 HYDRAULIC CONSTANT RUNNING PUMPS
- 4 HYDRAULIC LINEAR DRIVES
- 5 TYPE RS SAILBOAT DRIVE – INBOARD SYSTEMS
- 6 TYPE R MECHANICAL REMOTE DRIVE – STERNDRIVE SYSTEMS
- 7 TYPE S/T DASHBOARD DRIVES
- 8 ACCESSORIES & MORE
- 9 Documents / Resources
  - 9.1 References
- 10 Related Posts

## OCTAF1012 Hydraulic Reversing Pumps

From fishing boats and sailboats to yachts of all sizes and commercial vessels, Octopus has the right drive for you.

[CMPI](#)

[CMP Group Ltd.](#)

[sales@cmpgroup.net](mailto:sales@cmpgroup.net) | [cmpgroup.net](http://cmpgroup.net)

## HYDRAULIC REVERSING PUMPS

The benefits of Octopus reversing pumps:

- RELIABLE – Patented piston pump technology with only three moving parts
- TWICE THE POWER – Delivers over twice the hydraulic output per watt of input
- ADJUSTABLE FLOW RATE – Configure performance to suit your vessel
- EASY SERVICING – Shut off valves allow removal without draining steering system

## PISTON PUMP

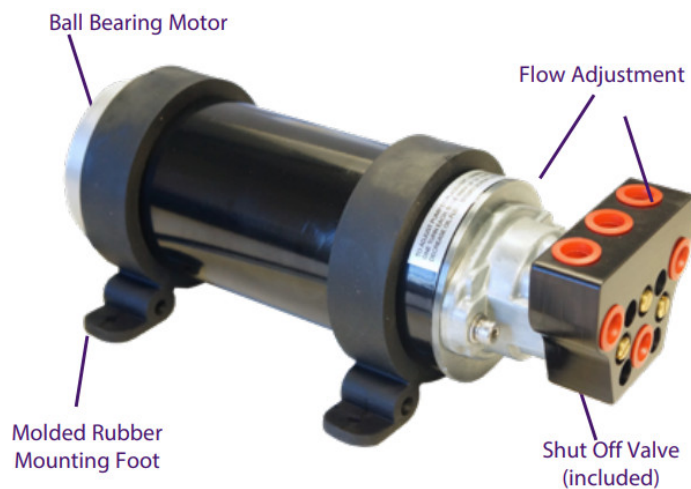

- Available in 12 Volts or 24 Volts

SELECTION GUIDE		
PID	Flow Rate (Adjustable)	Cylinder Range
OCTAF1012	600cc – 1L/min	6-15in <sup>3</sup>
OCTAF1024	600cc-1L/min	6-15in <sup>3</sup>
OCTAF1212	800cc – 1.2L/min	10-20in <sup>3</sup>
OCTAF1224	800cc – 1.2L	10-20in <sup>3</sup>
OCTAF2012	1.2 – 2.L/min	245-500cc (15-30in <sup>3</sup> )
OCTAF2024	1.2 – 2L/min	245-500cc (15-30in <sup>3</sup> )

**GEAR PUMP**



- **HIGH EFFICIENCY** – Industry leading efficiency minimizes power consumption.
- **LOW NOISE** – New design offers significantly quieter operation.
- **LIGHTWEIGHT & COMPACT** – Small footprint offers greater installation flexibility.
- **WIDE RANGE OF PRODUCTS** – From 600 to 3000cc/minute, 12v and 24v options.

SELECTION GUIDE		
PID	Flow Rate	Cylinder Range
<b>OCTAFG0612</b>	600cc/min	6-9 ci CYLINDER
<b>OCTAFG0624</b>	600cc/min	6-9 ci CYLINDER
<b>OCTAFG1012</b>	1000cc	10-15 ci CYLINDER
<b>OCTAFG1024</b>	1000cc	10-15 ci CYLINDER
<b>OCTAFG1612</b>	1600cc	16-24 ci CYLINDER
<b>OCTAFG1624</b>	1600cc	16-24 ci CYLINDER
<b>OCTAFG2012</b>	2L	24-30 ci
<b>OCTAFG2024</b>	2L	24-30 ci
<b>OCTAFG3012</b>	3L	30-40 ci
<b>OCTAFG3024</b>	3L	30-40 ci

## HYDRAULIC CONSTANT RUNNING PUMPS

**Suitable for commercial vessels and larger yachts**

- **POWERFUL** – Suitable for steering cylinders up to 200cu in (3500cc)
- **ECONOMICAL** – High performance, low power consumption, compact design
- **FULLY INTEGRATED DESIGN** – No complicated external pipes or fittings to break or leak

## CRA PUMPSETS

- For steering cylinders up to 65cu in (1000cc)
- Available in 12 Volts or 24 Volts



## CRB PUMPSETS

- For steering cylinders up to 200cu in (3500cc)
- DC models: 12v, 24v
- AC models: 110v or 220v single phase



## HYDRAULIC LINEAR DRIVES

**Powerful, efficient drives for sailboats**

- **RELIABLE** – Only three moving parts, increasing reliability
- **EFFICIENT** – Three times more efficient, half the battery consumption
- **ADJUSTABLE FLOW RATE** – Configure performance to suit your vessel



**LAM MOUNTED STYLE**



**LAR REMOTE STYLE**

SELECTION GUIDE										
PID	AVERAGE / MAX CURRENT (Piston pump efficiency will reduce actual consumption)	Features				Performance			Yacht Selection	
		V	Cylinder Bore	Variable Flow Rate	Stroke	Hardover Time (Suggested)	Max Rudder Torque	Peak Thrust	Max Boat Length	Max Laden Displacement
<b>OCTAF1012LAM7 OCTAF1012LAR7</b>	4 – 6A / 19 A	12 v	38mm	500cc – 1 litre/min	178mm (7in)	12-14sec	750Nm 6,630lbin	400kg 882lbs	14m 45ft	11,000kg 24,200lbs
<b>OCTAF1024LAM7 OCTAF1024LAR7</b>	2 – 3A / 10 A	24 v	38mm	500cc – 1 litre/min	178mm (7in)	12-14sec	750Nm 6,630lbin	400kg 882lbs	14m 45ft	11,000kg 24,200lbs
<b>OCTAF1212LAM12 OCTAF1212LAR12</b>	4 – 6A / 19 A	12 v	38mm	500cc – 1 litre/min	305mm (12in)	14-16sec	1,200Nm 10,600lbin	400kg 882lbs	18m 60ft	15,000kg 33,000lbs
<b>OCTAF1224LAM12 OCTAF1224LAR12</b>	2 – 3A / 10 A	24 v	38mm	600cc – 1.2 litre/min Reversing	305mm (12in)	14-16sec	1,200Nm 10,600lbin	400kg 882lbs	18m 60ft	15,000kg 33,000lbs
<b>OCTAF2012LAR9</b>	6 – 8 / 22A	12 v	45mm	1-2 litres/min Reversing	228.6mm (9in)	14-16sec	1,200Nm 10,600lbin	600kg 1,322lbs	22m 70ft	17,000kg 37,500lbs
<b>OCTAF2024LAR9</b>	3 – 4A / 11 A	24 v	45mm	1-2 litres/min Reversing	228.6mm (9in)	14-16sec	1,200Nm 10,600lbin	600kg 1,322lbs	22m 70ft	17,000kg 37,500lbs

## TYPE RS SAILBOAT DRIVE – INBOARD SYSTEMS

### Compact and convenient solution

- **DISCREET INSTALLATION** – All components mounted out of sight
- **EASY TO FIT** – Can be located in very small spaces

- **PERFORMANCE** – Responsive drive, little feedback resistance in Standby Mode
- **Ideal for inboard engined Boats up to 38 ft or 15400 Lbs**

**OCTAFMDRSSYS12:** Sailboat Drive-Inboard System – long stroke (12") (up to 38 feet or up to 15400lbs)

**OCTAFMDRSSYS:** Sailboat Drive-Inboard System – short stroke (9") (up to 38 feet or up to 15400lbs)



## **TYPE R MECHANICAL REMOTE DRIVE – STERNDRIVE SYSTEMS**

**Unique pilot drive for sterndrive applications**

- **LOW COST SOLUTION** – No need to change to hydraulic steering
- **EASY TO FIT** – Simple to install kits
- **TIME SAVING** – Rudder feedback option mounts directly on drive
- **SAFE** – Manual override without disengaging the autopilot
- **COMPATIBLE WITH ALL MAJOR AUTOPILOT BRAND ELECTRONICS**

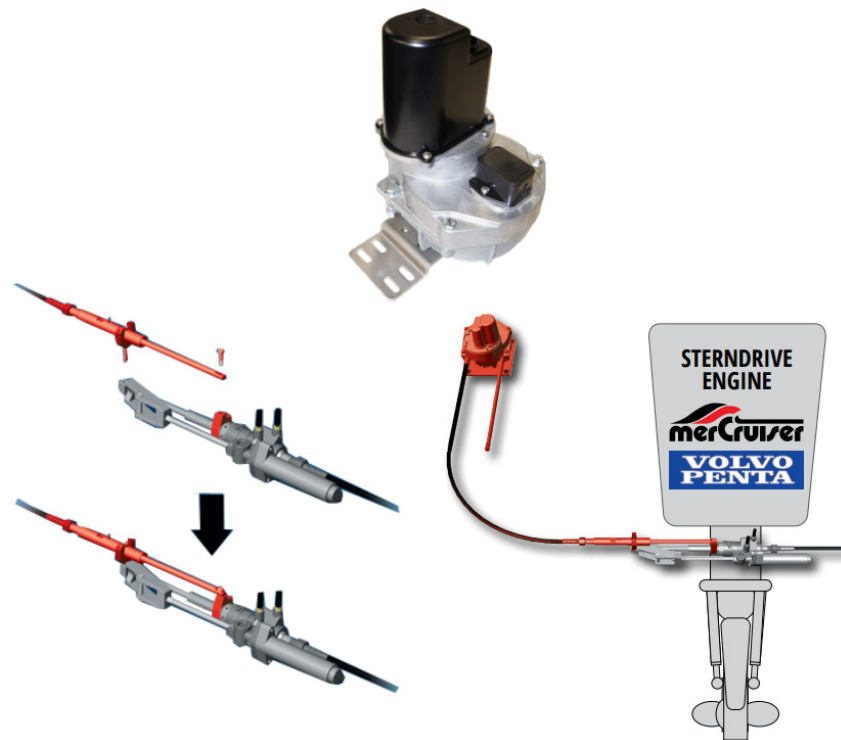

### **Straightforward installation**

The Type R Remote Drive System makes sterndrive installations easy for both single or dual engine systems. The installation kit simply clamps to the steering cylinder with no drilling or cutting required. Two packs are available to suit the most common Mercruiser and Volvo-Penta sterndrive systems.

- **OCTAFMDRESYSA:** Sterndrive System-Mercruiser from 1994, North American Volvo from 1997
- **OCTAFMDRESYSB :** Sterndrive System-Mercruiser from 1983-93, European Volvo Diesel from 1994

Kits come standard with 6Ft steering cable with optional 9Ft steering cable for the SYSA.

### **TYPE S/T DASHBOARD DRIVES**

#### **Unique autopilot drives for cable steered boats:**

- **PROFESSIONAL, LOW-COST SOLUTION** – Replaces manual helm with a manual helm/autopilot drive combination. No need to change to hydraulic steering
- **EASY TO FIT** – Simple to install kits
- **TIME SAVING** – Rudder feedback option mounts directly on drive

TYPE S BEHIND	TYPE T TILT BEHIND
DASH DRIVE	DASH DRIVE



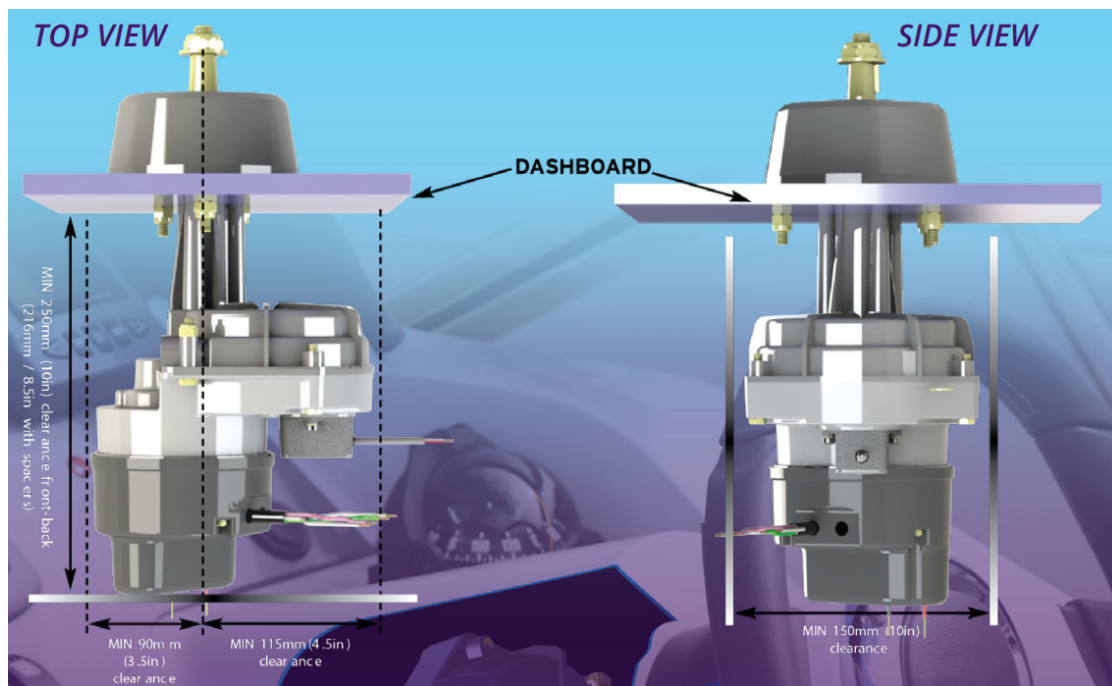

**PID: OCTAFMDMSW**

The Straight shaft drive unit replaces the manual drive used on cable steered boats and is mounted directly behind the dash.

**PID: OCTAFMDTPW**

Uses Teleflex Tilt assembly SH91800 (not supplied)

## ACCESSORIES & MORE

### Hose and fitting kit



- Makes Autopilot Installation a breeze
- Essential option for any Pilot installation, includes NPT and ORB fittings to work with 2014 or newer Seastar Helms PID OC17SUK42: 30" Hose and Fitting Kit, including ORB and NPT Helm Fittings

### Hydraulic steering fluid



Engineered for use in all Hydraulic steering systems

- ISO 15 low temp mineral hydraulic fluid
- Corrosion inhibited
- Oxidation resistant
- Excellent anti wear performance

PID 1 Gallon (4/case): **OCTOIL1USG**

PID 1USQ (12/case): **OCTOIL1USQ**



#### **Mechanical drive accessories**

	90 degree Bezel Mounting Kit for Type S Straight Shaft Drive PID: OC15SUK10
	Steering Cable Adapter Kit for TFX SSC72, Uflex M47, Morse 304415 PID: <b>OC15SUK07</b>
	Steering Cable Adapter Kit for TFX SSC62, Uflex M66 PID: <b>OC15SUK08</b>
	Spacer Kit x 19mm for 90° Bezel Kit, PID: <b>OC15SUK16</b> Spacer Kit x 13mm for TFX Performance Tilt Mechanism (Type T), PID: <b>OC15SUK18</b>

#### **OPTIONAL RUDDER FEEDBACK UNIT**

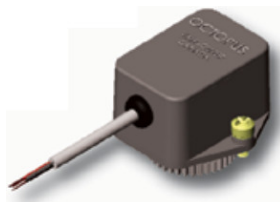
One of the most complex and time-consuming aspects of autopilot installation is fitting the rudder feedback unit, ensuring that the geometry matches the full range of rudder movement. The Octopus rudder feedback unit solves these problems as it mounts directly to the drive unit itself.



	<p><b>OC15SUK27A:</b> For Comnav &amp; Sitex Autopilots  <b>OC15SUK27B:</b> For Raymarine Autopilots  <b>OC15SUK27D:</b> Rudder Feed Back  Potentiometer Module – Coursemaster  <b>OC15SUK27E:</b> Rudder Feed Back  Potentiometer Module – Garmin, Furuno, TMQ and Simrad</p>
	<p><b>OC15SUK83:</b> Simrad Resistance to Frequency Conversion Kit – Required for Simrad NA C3, AC12 and AC42</p>

<p>©2021 CMP Group Ltd.  <b>OCTOPUS PRODUCTS</b>  7733 Progress Way  Delta, BC, Canada V4G 1A3  Phone: 1-604-940-2010  Fax: 1-604-952-2650  Email: <a href="mailto:sales@octopusdrives.com">sales@octopusdrives.com</a>  Website : <a href="http://www.octopusdrives.com">www.octopusdrives.com</a></p>	<p><b>OCTOPUS EUROPE CB</b>  PG13 222 La Murta  Alzira 46600, Valencia, Spain  Phone: 00 34 962 120 052  Email: <a href="mailto:sales@octopuseurope.com">sales@octopuseurope.com</a>  Website : <a href="http://www.octopuseurope.com">www.octopuseurope.com</a></p>
---	--



CMOCTBRO21 V1  
July 2021 8.5×11"

## Documents / Resources

	<p><b><a href="#">OCTOPUS OCTAF1012 Hydraulic Reversing Pumps</a></b> [pdf] Instruction Manual  OCTAF1012 Hydraulic Reversing Pumps, OCTAF1012, Hydraulic Reversing Pumps, Reversing Pumps, Pumps</p>
---	---

## References

-  [Home - CMP Group](#)
-  [Home - Octopus Drives](#)
-  [Home - Octopus Drives](#)
-  [Home | Octopus Europe](#)