



OBO 6121004 Channel Socket Signa In Instructions

[Home](#) » [OBO](#) » OBO 6121004 Channel Socket Signa In Instructions 



BETTERMANN
Building Connections
BRK 1/2/3 STD
Signa In trunking socket
Mounting instructions

Contents

- [1 6121004 Channel Socket Signa In](#)
- [2 Product description](#)
- [3 Mounting the Signa In trunking socket](#)
- [4 Mounting the labelling panel](#)
- [5 Exchanging the colour rings](#)
- [6 Disposing of the Signa In socket](#)
- [7 Technical data](#)
- [8 Documents / Resources](#)
 - [8.1 References](#)

6121004 Channel Socket Signa In

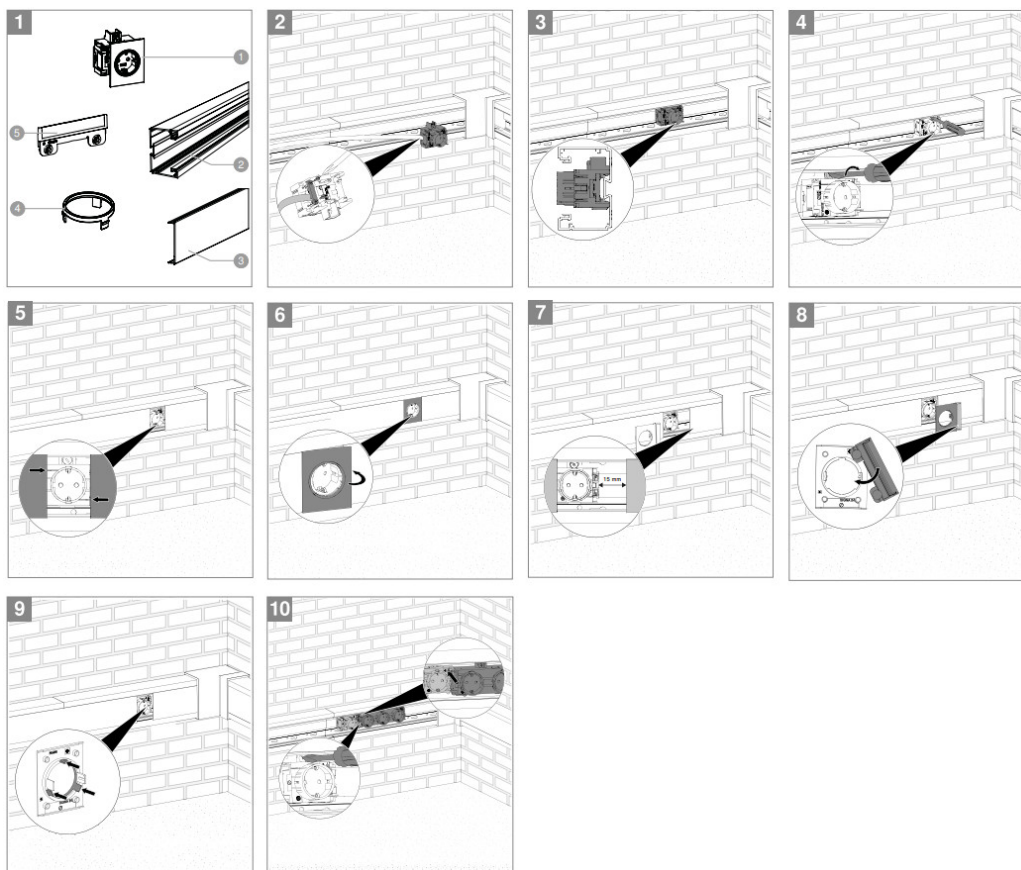

Signa In trunking socket

(item no. 6121004, 6121002, 6121016, 6121014, 6121012, 6121020, 6121018, 6121112, 6121032, 6121026, 6121036, 6121034, 6121114, 6121039)

Product description

Signa In trunking socket (single to triple) with in creased touch protection incl. panel.

A maximum of 4 trunking sockets can be connected through plug combinations. (16 A/250 V~)

1. Signa In trunking socket
2. Signa Base/Signa Style device installation trunking
3. Trunking cover
4. Colourring
5. Labelling panel

Mounting the Signa In trunking socket

Note! Mounting is identical for the single, double and triple trunking socket.

1. Strip the cable.



WARNING Risk to life through electric shock!

Energised components! Electrical installation work may only be carried out by an electrical engineer.

2. Insert cables in the Signa In trunking socket and relieve them with the strain relief.

Snap the connected Signa In trunking socket 1 onto the DIN rail on the trunking base. In so doing, ensure that no conductor is trapped between the trunking socket unit and the trunking.

1. Push the Signa In trunking socket 1 against the DIN rail in the Signa In trunking socket 2 and, using a slotted screwdriver, turn the eccentric bolt in a clockwise direction towards the "CLOSED" symbol.
2. Check that the Signa In trunking socket 1 has a stable, safe seat (it should not be possible to release the connected trunking socket unit from the trunking base by hand).

Place the trunking covers 3 flush against the stop brackets on the left and right.

Note! It is only possible to mount the trunking covers without a labelling panel in this way.

Engage the cover frame to the side of the Signa In trunking socket 1.

Mounting the labelling panel

1. Open the labelling panel window with a slotted screwdriver, write on the label and close the cover again.
2. Push away or shorten the trunking cover 3 on the side of the labelling panel 5 from the stop bracket by approx. 15 mm.
3. Engage the device frame with labelling panel 5 to the side of the trunking socket unit.

Note! does not matter to which side of the device frame the labelling panel is attached.

Attach the labelling panel 5 to the rear side of the device frame.

Exchanging the colour rings

1. Turn the device frame onto its back.
2. Lightly push the three locking elements of the colour ring 4 to the centre and push the colour ring 4 forward.

Expanding the Signa In trunking socket to a multiple socket



WARNING Risk to life through electric shock!

When expanding the Signa In trunking socket:

Always de-energise the system before starting work. Comply with the valid safety regulations and accident prevention regulations.



WARNING Risk to life through electric shock!

When expanding a Signa In trunking socket, which is already connected to a cable carrying power, never engage an additional Signa In trunking socket directly using the plug connection which is itself connected to a separate power circuit.



WARNING Risk to life through electric shock!

The cover must be removed when connecting the Signa In trunking socket. When the Signa In trunking socket is disconnected, the cover must be placed on the electrical contacts again.



WARNING Maximum cascading!

Connect a maximum of 3 Signa In trunking sockets.

Exception: If only single Signa In trunking sockets are used, then a maximum of 4 trunking sockets can be connected.

1. Release the cover frame with a slotted screwdriver and remove the trunking cover 3.
2. Attach the additional Signa In trunking socket 1 (single, double or triple trunking socket) to the already mounted trunking socket.
3. Push the additionally docked Signa In trunking socket 1 against the DIN rail. Then, with a slotted screwdriver, turn the eccentric bolt in a clockwise direction towards the "CLOSED" symbol.
4. Check for a stable, safe seat.

Disposing of the Signa In socket

Observe the local waste disposal regulations:

- Plastic parts as domestic waste.
- Metallic parts as scrap metal.

Technical data

BRK GD device installation socket	
Colour	pure white RAL 9010
Material	Polyamide



Installation electrotechnical expertise
OBO Bettermann Holding GmbH & Co. KG

P. O. Box 1120 58694 Menden
GERMANY

Customer Service

Tel.: +49 2373 89 – 13 00

toi@obo.de

www.obo-bettermann.com



BETTERMANN

OBORD 220350 HAFA 49800453 Stand 08/2022

Documents / Resources

	OBO 6121004 Channel Socket Signa In [pdf] Instructions 6121004 Channel Socket Signa In, 6121004, Channel Socket Signa In, Socket Signa In, Signa I n
--	--

References

- [OBO Group](#) | [OBO](#)
- [User Manual](#)

Manuals+, Privacy Policy

This website is an independent publication and is neither affiliated with nor endorsed by any of the trademark owners. The "Bluetooth®" word mark and logos are registered trademarks owned by Bluetooth SIG, Inc. The "Wi-Fi®" word mark and logos are registered trademarks owned by the Wi-Fi Alliance. Any use of these marks on this website does not imply any affiliation with or endorsement.