



## NYKO 87272 DUALIES Motion Controller Set User Manual

[Home](#) » [NYKO](#) » NYKO 87272 DUALIES Motion Controller Set User Manual 

# NYKO®

DUALIES™

Motion Controller Set • JoyCon™ Alternative for  
SWITCH USER MANUAL  
Item# 87268,87269,87272

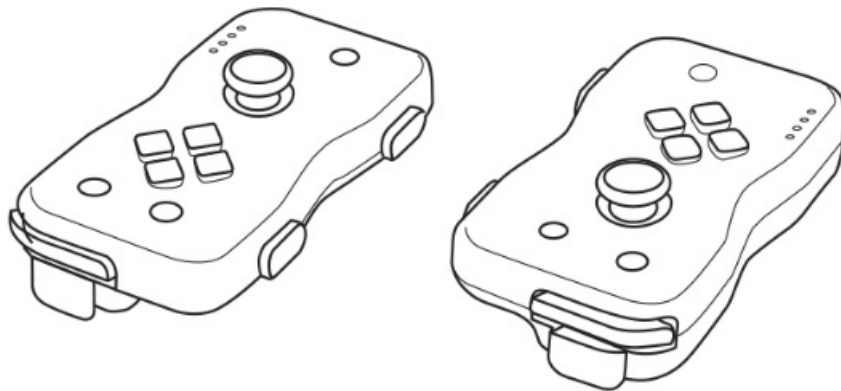

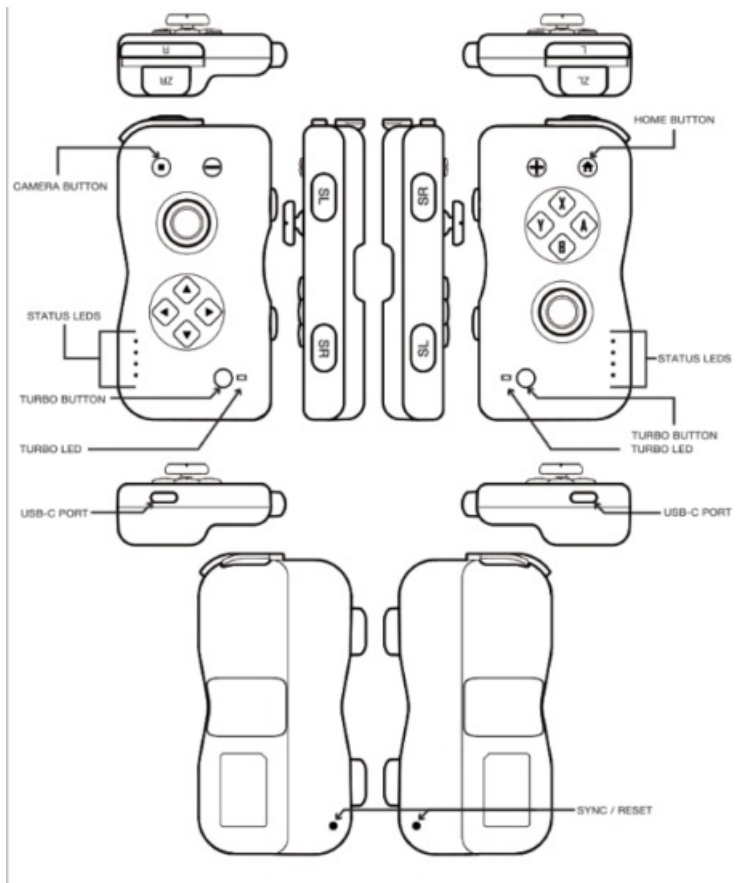

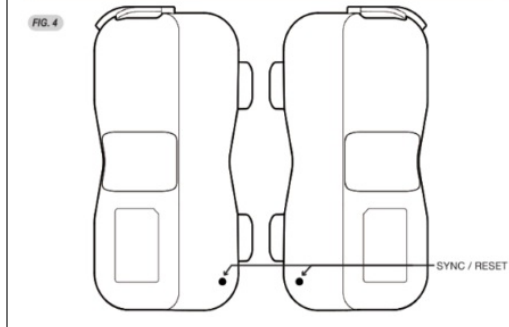
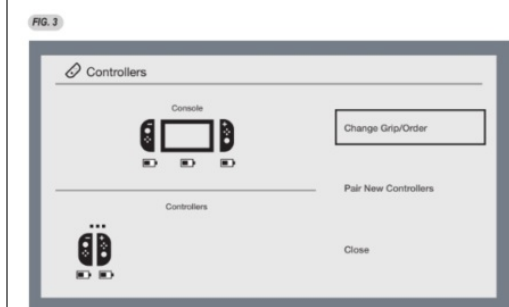
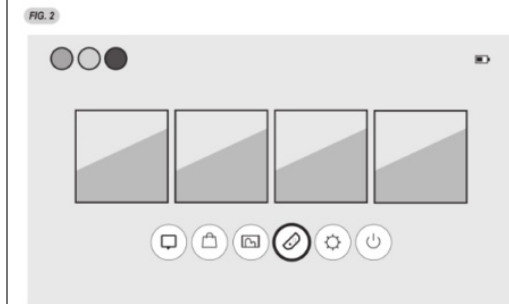
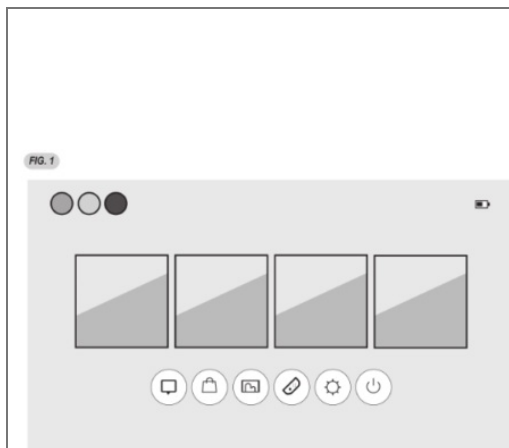

**FIG. 5**



**FIG. 6**



**FIG. 7**

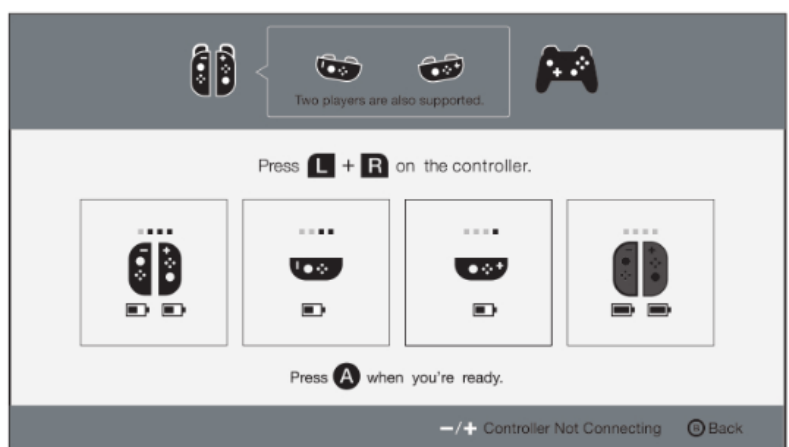

## 87268/87269/87272 DUALIES™

Thank you for purchasing Dualies™, wireless controllers for Nintendo Switch™. Please read this manual to familiarize yourself with the installation and operation of these devices.

## Contents

- 1 WHAT'S IN THE BOX
- 2 HOW TO SYNC TO CONSOLE
- 3 HOW TO WAKE UP DUALIES
- 4 HOW TO SET UP TURBO FIRE
- 5 HOW TO DISABLE A TURBO FIRE SETTING
- 6 CHARGING DUALIES
- 7 TROUBLESHOOTING:
- 8 TECHNICAL SUPPORT
- 9 Documents / Resources
- 10 Related Posts

## WHAT'S IN THE BOX

- (1) Left Controller
- (1) Right Controller
- (1) USB Type-C
- (1) User Manual cable

## HOW TO SYNC TO CONSOLE

1. Go to the Home Screen <fig.1>
2. Click "Controllers" icon. <fig.2>
3. Select "Change Grip/Order" <fig.3>
4. Locate the sync button on the back side of each controller. <fig.4>
5. PRESS & HOLD the SYNC Button for approx. 3 seconds until the 4 LEDs begin blinking.
6. Once the LEDs are blinking, release the SYNC button.
7. The LEDs will blink rapidly while syncing with the console.
8. When the desired controller is synced with the console, the controller icon will appear.
9. PRESS 1 + Fr or "SL + SR" depending on the desired configuration.
10. When the controllers are connected as desired, PRESS "K" to exit "Change Grip/Order" menu <fig.7>

## HOW TO WAKE UP DUALIES

For LEFT Controller PRESS & HOLD any of the following buttons 1 ► ◆◆ (L) or (ZL) for approx. 2 seconds to wake up the LEFT Dualie.

For RIGHT Controller PRESS & HOLD any of the following buttons (A), (B), (X), (Y), (R) or (ZR) for approx. 2 seconds to wake up the RIGHT Dualie.

## HOW TO SET UP TURBO FIRE

1. PRESS & HOLD the Turbo Button
2. While holding the Turbo Button, press a desired button to activate Turbo Fire. An LED will illuminate next to the Turbo button, indicating Turbo is active.
3. The LED will illuminate when the button with Turbo Fire is pressed.

**Please Note:** Turbo Fire can be configured onto multiple buttons simultaneously.

1. To add Turbo Fire to another button, follow the same steps above.
2. PRESS & HOLD the Turbo Button while pressing once the desired button to activate.

## HOW TO DISABLE A TURBO FIRE SETTING

1. PRESS & HOLD the Turbo Button
2. While holding the Turbo Button, press the desired button to deactivate Turbo Fire. The LED will not illuminate.
3. To confirm the setting has been cleared press the button that was deactivated. If the LED does not illuminate, Turbo deactivation was successful.

## CHARGING DUALIES

1. Connect the USB C end of the charging cable to the charge port on the controller.
2. Connect the USB-A end to an available AC Adapter (not included), an available USB port on the dock, or an available USB charge port connected to a power source.

## TROUBLESHOOTING:

### **Q: Can I use Amiibo®?**

A: No, NFC and Amiibo® is not supported in Dualies™.

### **Q: Can I use the IR Camera?**

A: No, Dualies™-does not-support this feature.

### **Q: Can I use Dualies™ in Handheld Mode?**

A: No, Dualies™ cannot connect to the rails of the console. We recommend playing in Tabletop Mode or TV Mode.

### **Q: Are Dualies compatible with a Joy-Con™ grip?**

A: No.

## TECHNICAL SUPPORT

We appreciate your support of Nyko products, and endeavor to guarantee your satisfaction with this purchase. If you are experiencing difficulties, please contact us:

Online: [www.nyko.com](http://www.nyko.com)

Email: [customersupport@nyko.com](mailto:customersupport@nyko.com)

Phone: +1-888-400-6956

### **Nyko Product Limited Warranty**

This Nyko product is warranted to the original purchaser for the product's normal intended use for a period of ninety (90) days from the date of purchase. If a defect covered under this warranty occurs, Nyko will replace or repair the product or its defective parts, at Nyko's option, at no charge. This warranty does not apply to defects resulting from misuse or modification of the product. The product should be returned with proof of purchase, a brief statement of the claimed defect, and the purchaser's contact information, to: Nyko Technologies, Inc., 1642 Westwood Blvd., Suite 300 Los Angeles, CA 90024, with freight charges prepaid. Please allow 3-4 weeks for processing.

### **IN-HOUSE CUSTOMER SUPPORT:**

Email: [customersupport@nyko.com](mailto:customersupport@nyko.com)

Phone: +1-888-400-6956

Visit us online:

Visitateci online: Bezoek ons online: Visite-Nos online em:

[www.nyko.com](http://www.nyko.com)

Nyko and Dualies are trademarks of Nyko Technologies,



Inc. Nintendo® and Nintendo Switch™ are either registered trademarks or trademarks of Nintendo® Corporation in the United States and/or other countries. This is a Nyko product and is not endorsed, manufactured or distributed by Nintendo® Corporation. ©2020 Nyko Technologies, Inc. All Rights Reserved

## Documents / Resources



[NYKO 87272 DUALIES Motion Controller Set](#) [pdf] User Manual

87268, 87269, 87272, 87272 DUALIES Motion Controller Set, DUALIES Motion Controller Set, DUALIES Motion Controller Set

[Manuals+.](#)