



# nVent PTWPSS Quarter Turn Latches Instruction Manual

[Home](#) » [nVent](#) » nVent PTWPSS Quarter Turn Latches Instruction Manual 

## Contents

- [1 nVent PTWPSS Quarter Turn Latches](#)
- [2 Product Information](#)
- [3 Product Usage Instructions](#)
- [4 Installation](#)
- [5 Parts](#)
- [6 Instructions](#)
- [7 Documents / Resources](#)
  - [7.1 References](#)
- [8 Related Posts](#)



**nVent PTWPSS Quarter Turn Latches**



## Product Information

The product is a set of Quarter-Turn Latches, also known as Loquets. It is used for securing various types of enclosures and cabinets. The product comes with a user manual (Rev. E) and has the part number 87796708. It is important to note that Item 4, which is required for installation, is not included in the kit. Instead, the cam from the original latch should be used.

## Product Usage Instructions

To change the combination of the lock, follow these steps:

1. Turn each wheel combination to show 0.
2. Once the wheels are showing a combination of 000 or 0000, use a sharp pointed device (such as a small screwdriver or nail) to press the small round hole located above the combination wheels. This will cause the hole to move inward.
3. While maintaining pressure on the round hole, turn the combination wheels to the desired numbers.
4. Release the pressure on the round hole. The combination has now been changed.

It is important to record the new combination on paper and store it in a secure location. The combination must be known in order to access or change it in the future.

If you need to reset the combination, follow the same steps outlined above, but use the current combination instead of the factory set combination of 000 or 0000. Always remember to record (electronically or on paper) the combination and store it in an accessible secure location. This information will be needed for access and for any future combination changes.

## Installation

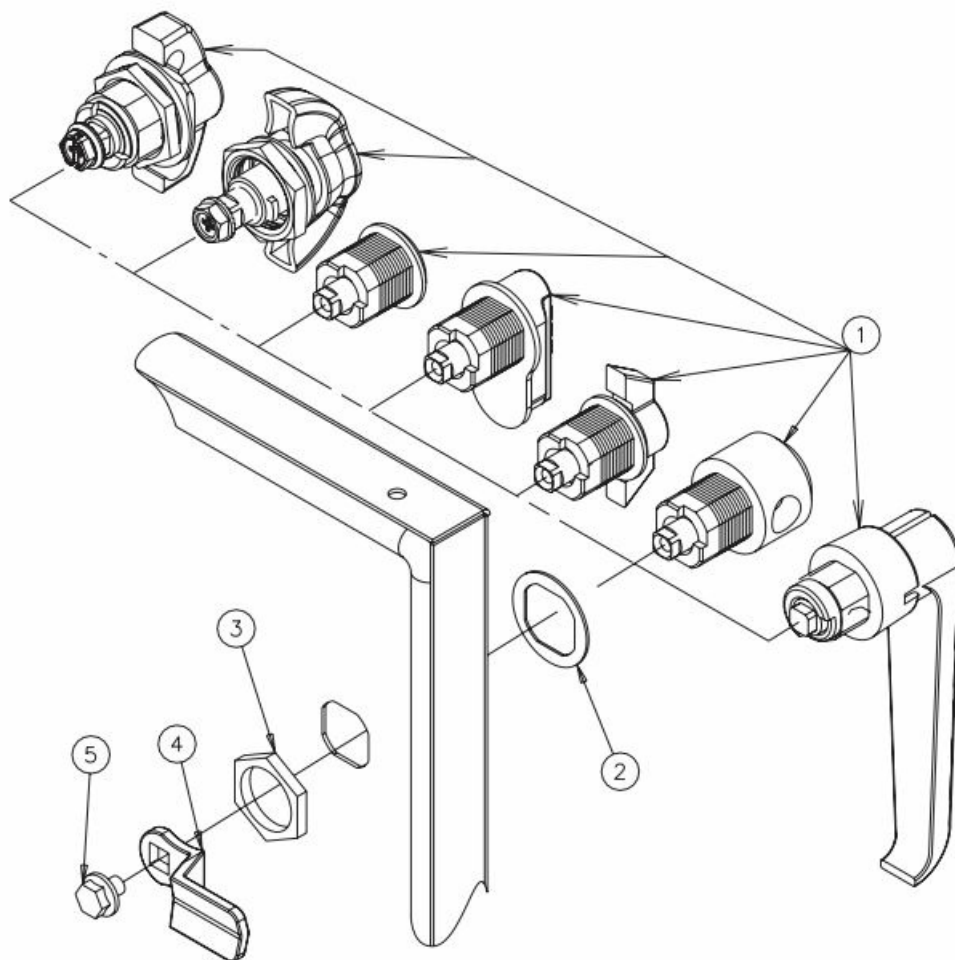

## Parts

<p>1</p> <p>**</p> <p>(1X)</p>	<p>2</p> <p>(0X) (1X)</p>	<p>3</p> <p>(1X)</p>
<p>4*</p> <p>(0X)</p>	<p>5</p> <p>(1X)</p>	

**NOTE:** Item 4 is not included with the kit. Please use the cam from the original latch.

## Instructions

The factory combination is set to “000” or “0000” and can be changed by following these steps:

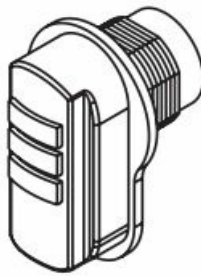

1. Turn each wheel combination to show “0”.
2. After wheels are showing a combination of “000” or “0000”, use a sharp pointed device (small screwdriver, nail or other device) to press the small round hole located above the combination wheels. Upon insertion, the round hole will move inward.
3. While maintaining pressure on the round hole, turn the combination wheels to the desired numbers. Release pressure of the sharp pointed device. The combination has now been changed.
4. Record the new combination on paper and store in a secure location. To access or to change the combination, it must be known.

### Resetting the combination

- Use the same steps outlined above, but use the current combination instead of the factory set combination of “000” or “0000”.

**Note:** Always record (electronically or on paper) the combination and store in an accessible secure location. It will be needed for access and for any future combination changes.

© 2018 Hoffman Enclosures Inc.

[nVent.com/HOFFMAN](http://nVent.com/HOFFMAN)

## Documents / Resources

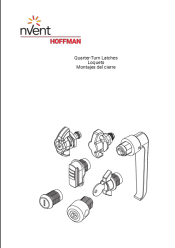
	<p><a href="#">nVent PTWPSS Quarter Turn Latches</a> [pdf] Instruction Manual PTWPSS Quarter Turn Latches, PTWPSS, Quarter Turn Latches, Turn Latches, Latches</p>
---	--

## References

-  [We connect and protect | nVent](#)

