



nVent A9036SOF19 Swing Out Rack Mounting Frame Instructions

[Home](#) » [nVent](#) » nVent A9036SOF19 Swing Out Rack Mounting Frame Instructions 

Contents

- [1 nVent A9036SOF19 Swing Out Rack Mounting Frame](#)
- [2 Swing-Out Rack Mounting Frame](#)
- [3 Documents / Resources](#)
 - [3.1 References](#)



nVent A9036SOF19 Swing Out Rack Mounting Frame



Swing-Out Rack Mounting Frame

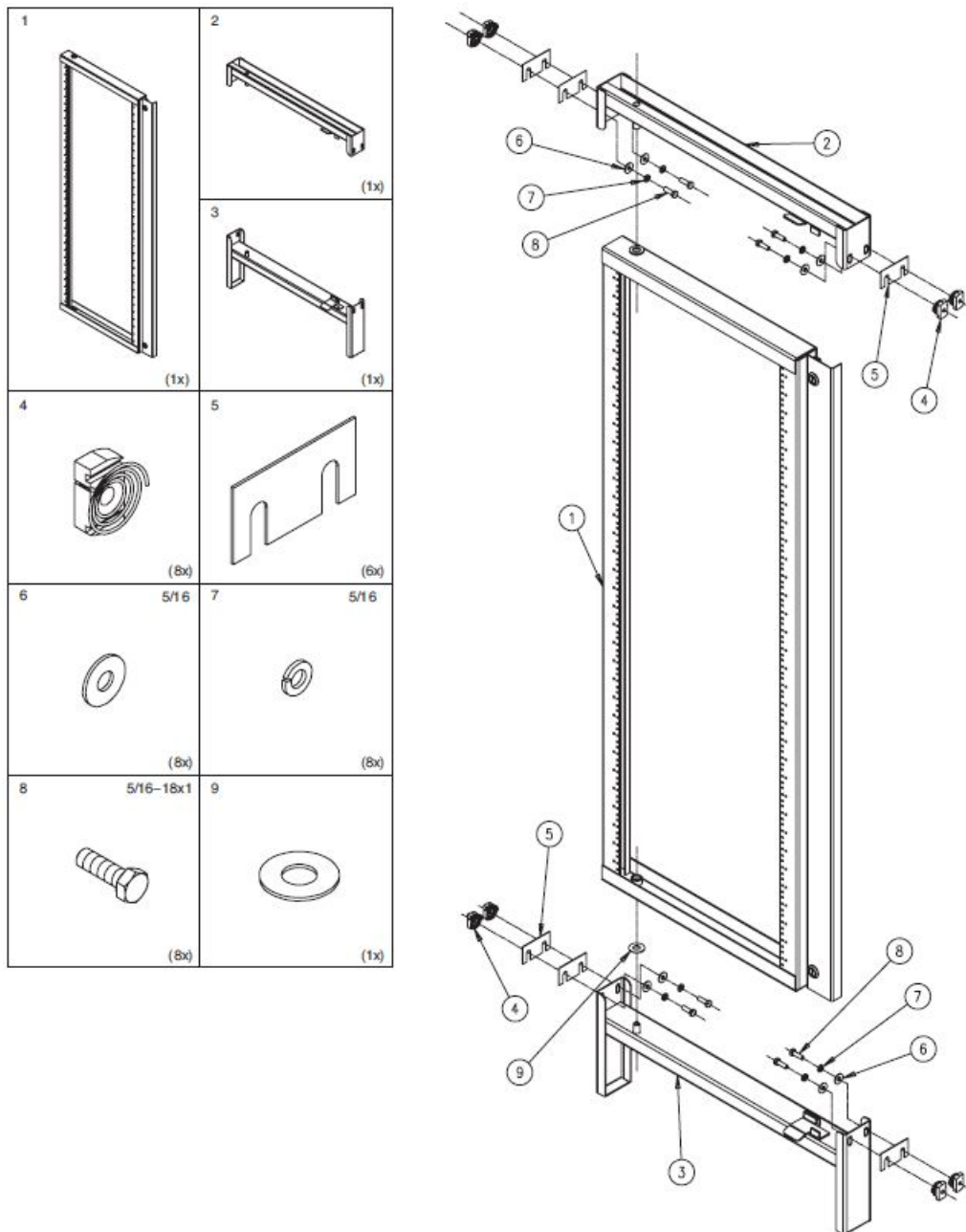

1. Install the bottom support assembly (item 3) into the enclosure. Insert clamping nuts (item 4) into the bottom channel, and attach using 5/16–18×1 hex head screws, lock washers, and flat washers (items 6,7, and 8) with spacers (item 5) between mounts and bottom mounting channels. Spacers can be moved from side to side to align the swing frame; all spacers may not be required.
2. Place the plastic washer (item 9) over the pin on the bottom support. Position the swing frame (item 1) onto the pin, and place the top support (item 2) onto the swing frame. Attach top support to top mounting channels using clamping nuts, spacers, 5/16 screws, lock washers, and flat washers (items 4,5,6,7, and 8). Adjust the frame to the desired depth in the enclosure.

NOTE: If the swing frame is to be heavily loaded, all spacers should be put on the pivot side at the bottom and the latch side at the top.

Documents / Resources

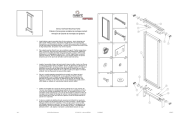
	<p>nVent A9036SOF19 Swing Out Rack Mounting Frame [pdf] Instructions A9036SOF19 Swing Out Rack Mounting Frame, A9036SOF19, Swing Out Rack Mounting Fra me, Rack Mounting Frame, Mounting Frame, Frame</p>
---	---

References

-  [We connect and protect | nVent](#)