



nVent A12 CPP Tapered Plastic Screw In Plug Owner's Manual

[Home](#) » [nVent](#) » nVent A12 CPP Tapered Plastic Screw In Plug Owner's Manual 



LENTON

CPP TAPERED PLASTIC SCREW-IN PLUG FOR A12, A22 AND A32K, 14 MM

CATALOG NUMBER

EL14CPP

Owner's Manual



Contents

[1 FEATURES](#)

[2 PRODUCT
ATTRIBUTES](#)

[3 DIAGRAMS](#)

[4 Documents / Resources](#)

[4.1 References](#)

FEATURES

Designed for use with the A12, A22 and A32K coupler families

Designed to keep dirt, water and concrete slurry out of the coupler during the concrete pour Color coded for the appropriate coupler size

PRODUCT ATTRIBUTES

Article Number: 153080

Material: Högdensitetspolyeten (HDPE)

Rebar Size, Metric: 14 mm

Diameter: 22 mm

Height: 13 mm

Color: Grön

DIAGRAMS

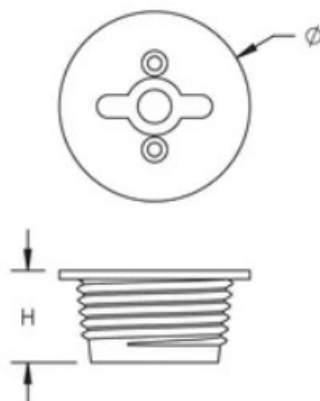

WARNING

nVent products must be installed and used only as specified in nVent's user manual and training materials. Instructions for use are available at www.nvent.com and from your nVent customer service representative. Improper installation, misuse, misapplication or other failure to fully follow nVent's instructions and warnings may cause the product to fail, property damage, serious bodily injury and death and/or void your warranty.

Nordamerika +1.800.753.9221 Option 1 – Customer Care Option 2 – Technical Support	Europa Netherlands: +31 800-0200135 France: +33 800 901 793
Europa Germany: 800 1890272 Other Countries: +31 13 5835404	APAC Shanghai: + 86 21 2412 1618/19 Sydney: +61 2 9751 8500



Our powerful portfolio of brands:

CADDY ERICO HOFFMAN RAYCHEM SCHROFF

© 2023 nVent. All nVent marks and logos are owned or licensed by nVent Services GmbH or its affiliates.

All other trademarks are the property of
their respective owners.

nVent reserves the right to change specifications without notice.

Documents / Resources

	<p>nVent A12 CPP Tapered Plastic Screw In Plug [pdf] Owner's Manual A12 CPP Tapered Plastic Screw In Plug, A12, CPP Tapered Plastic Screw In Plug, Tapered Plastic Screw In Plug, Plastic Screw In Plug, In Plug</p>
---	--

References

- [🌟 Building a more Sustainable and Electrified World | nVent](#)
- [🌟 Building a more Sustainable and Electrified World | nVent](#)
- [User Manual](#)