



nVent RAYCHEM FTC-P Power Connection and End Seal Kit Instruction Manual

[Home](#) » [nVent RAYCHEM](#) » nVent RAYCHEM FTC-P Power Connection and End Seal Kit Instruction Manual 



FTC-P

XL-Trace Edge, RaySol, and IceStop Power Connection Kit with End Seal Installation Instructions

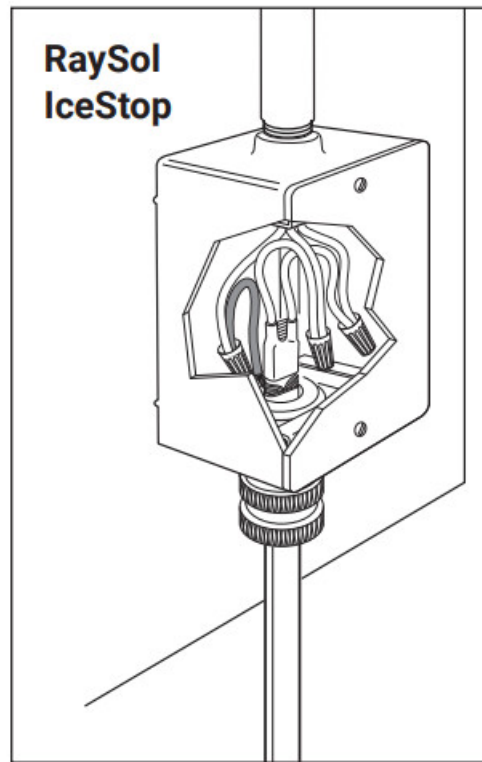
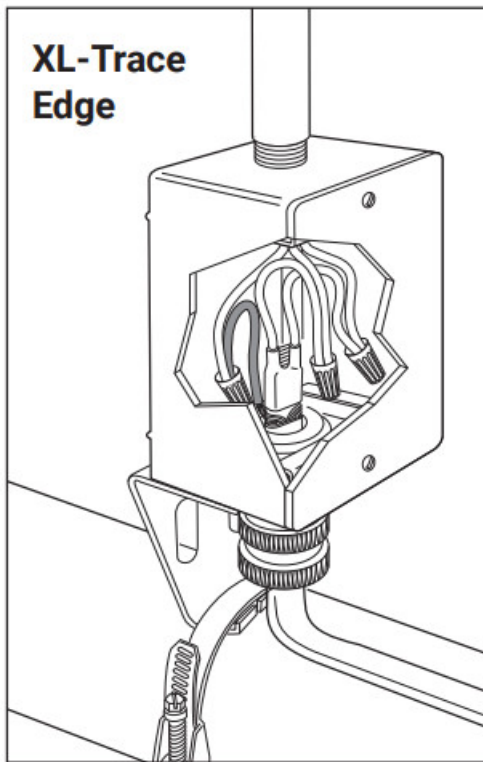

Contents

[1 DESCRIPTION](#)

[2 KIT CONTENTS](#)

[3 POWER CONNECTION INSTALLATION](#)

[4 Documents / Resources](#)

[4.1 References](#)

[5 Related Posts](#)

DESCRIPTION

The nVent RAYCHEM FTC-P Power Connection and End Seal Kit is for use with nVent RAYCHEM XL-Trace Edge, RaySol and IceStop heating cables. Materials for one power connection and one end seal are included in this kit. These installation instructions should be used in conjunction with the XL-Trace Edge, RaySol and IceStop System Installation and Operation Manuals. For technical support contact your nVent representative or call nVent at 800-545-6258.





TOOLS REQUIRED

• Screw driver	• Pen
• Needle-nose pliers	• Diagonal cutters
• Utility knife	• Heat gun or propane torch

ADDITIONAL MATERIALS REQUIRED (NOT PROVIDED IN THIS KIT)

- UL Listed or CSA Certified junction box suitable for the location, with a clearance hole or threaded hub for 1/2 inch NPT. For RaySol applications, the power connection and end seal may be terminated in the same box.

APPROVALS

	With XL-Trace Edge
	With IceStop and Raysol
	With IceStop and RaySol
	With IceStop heating cable only For Class I, Div. 2, Groups A, B, C, D Hazardous Locations: GM-1XT and GM-2XT only

WARNING:

This component is an electrical device that must be installed correctly to ensure proper operation and to prevent shock or fire. Read these important warnings and carefully follow all the installation instructions.

- To minimize the danger of fire from sustained electrical arcing if the heating cable is damaged or improperly installed, and to comply with the requirements of nVent, agency certifications, and national electrical codes, ground fault equipment protection must be used. Arcing may not be stopped by conventional circuit breakers.
- Bus wires will short if they contact each other.
Keep bus wires separated.
- Keep components and heating cable ends dry before and during installation.
- The black heating cable core is conductive and can short. It must be properly insulated and kept dry.
- Component approvals and performance are based on the use of nVent– specified parts only. Do not use substitute parts or vinyl electrical tape.
- Leave these instructions with end user for reference and future use.



CAUTION:

HEALTH HAZARD: Overheating heatshrinkable tubes will produce fumes that may cause irritation. Use adequate ventilation and avoid charring or burning. Consult MSDS RAY3122 for further information.

CHEMTREC 24-hour emergency telephone: (800) 424-9300

Non-emergency health and safety information: (800) 545-6258.

KIT CONTENTS

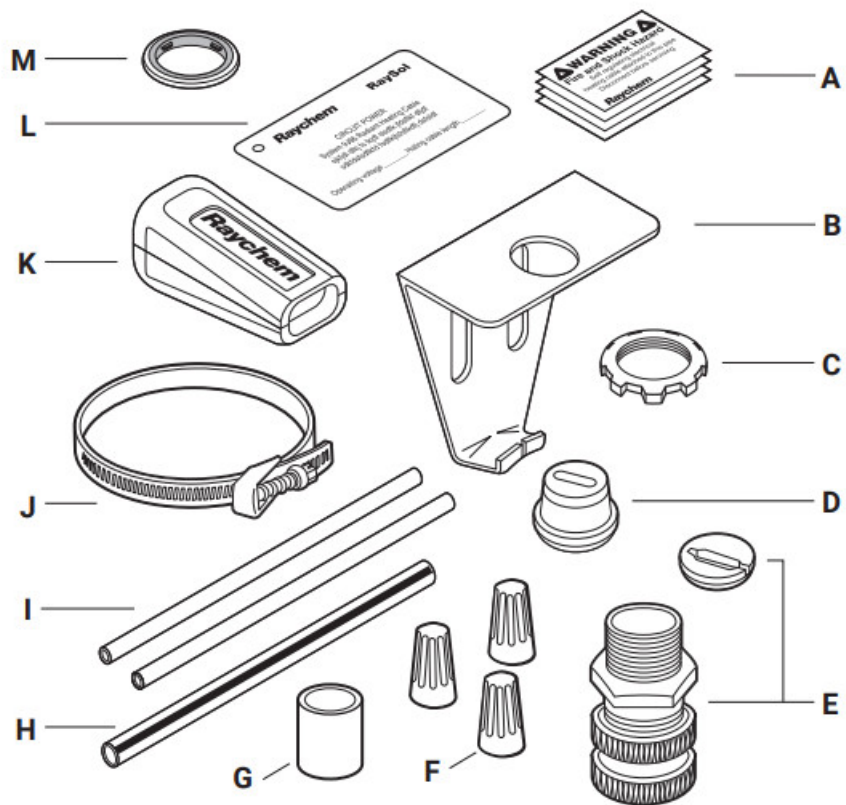

Item	Qty	Description
A	4	Warning labels
B	1	Pipe mounting bracket
C	1	Lock nut
D	1	Blue grommet
E	1	Sealing fitting
F	3	Wire nuts
G	1	Black heat-shrinkable tube (1/2 in x 1 1/2 in)
H	1	Green/yellow heat-shrinkable tube (1/4 in x 5 1/2 in)
I	2	Black heat-shrinkable tubes (1/8 in x 5 1/2 in)
J	1	#3 pipe strap
K	1	Gel-filled end seal (FTC-E)
L	1	RaySol circuit tag
M	1	Sealing gasket

POWER CONNECTION INSTALLATION

XL-Trace Edge-CR and -CT, RaySol, and IceStop

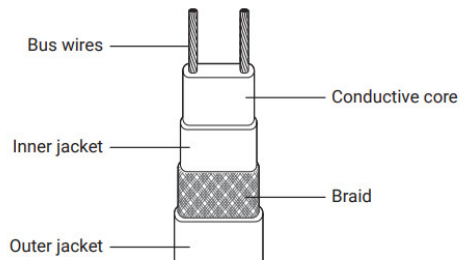

1

- Discard black grommet and use blue grommet.

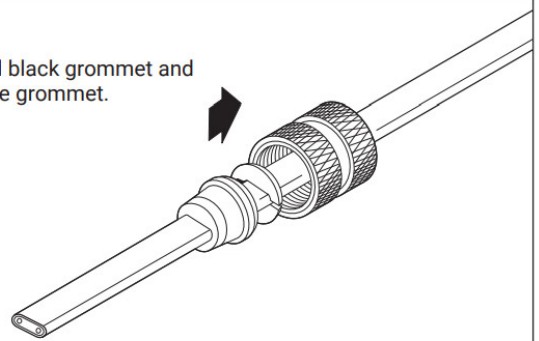

2

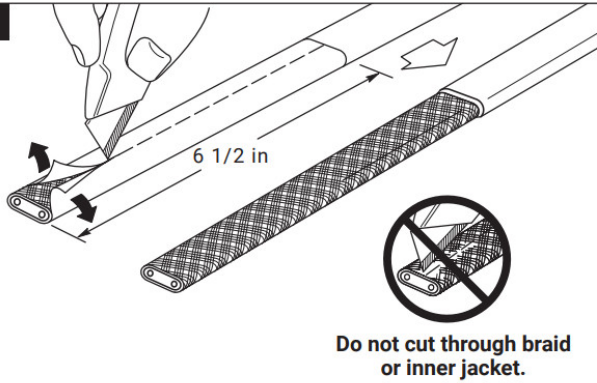

3

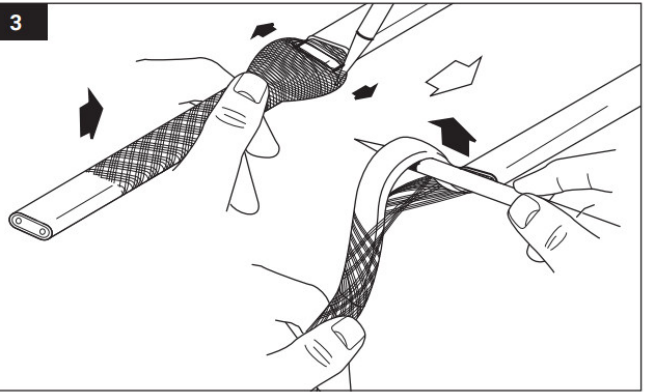

4

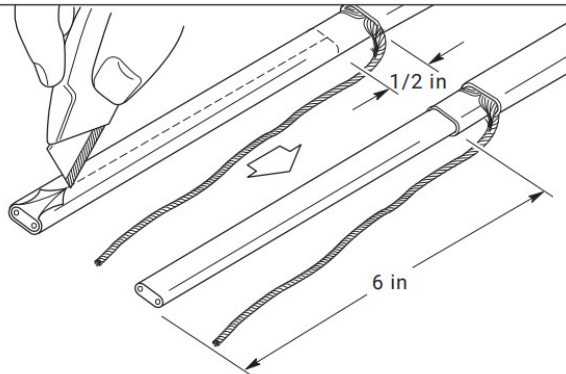

5

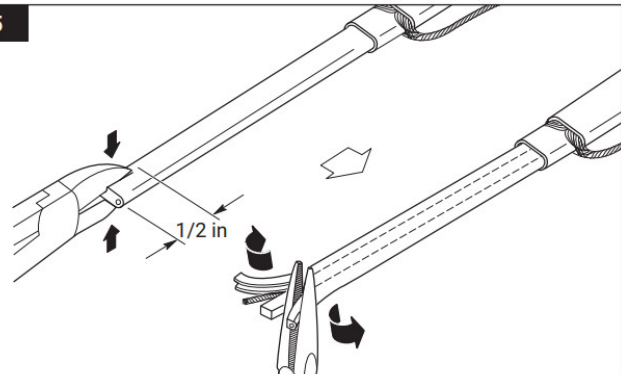

6

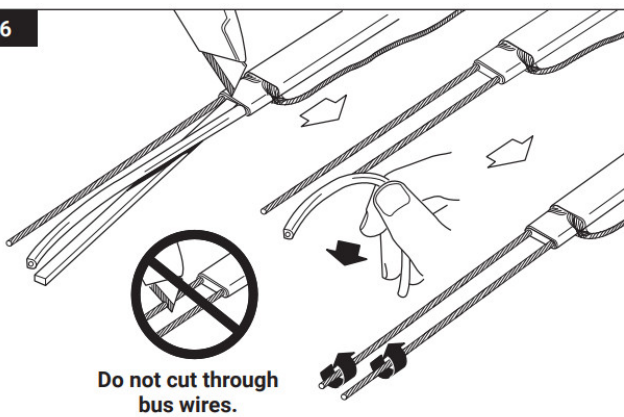

7

- Slide heat-shrinkable tubes over end of cable.
- Starting from the center of the tube, move the heat source continuously from side to side.

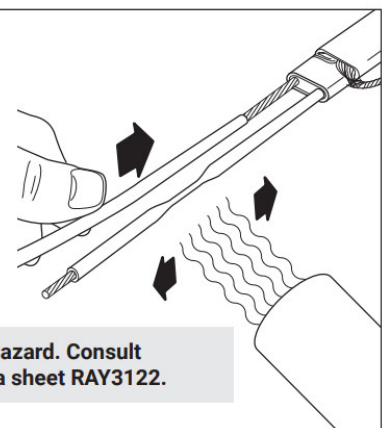

CAUTION: Health Hazard. Consult material safety data sheet RAY3122.

8

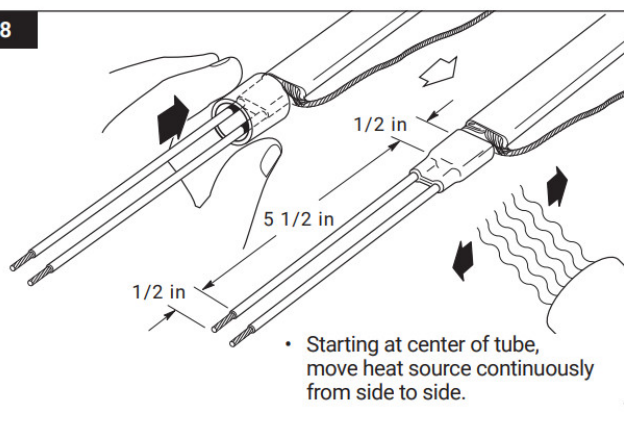

9

- While tube is still hot, pinch with pliers between bus wires to seal; hold for 10 seconds.

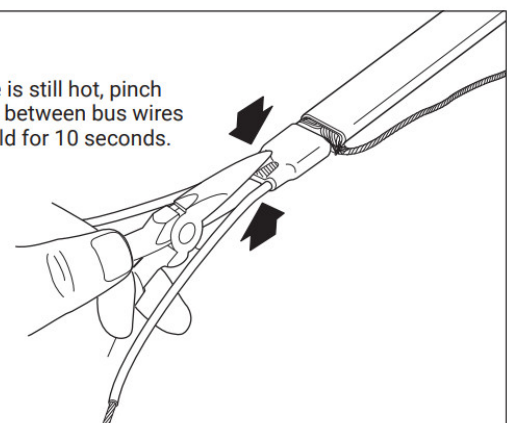

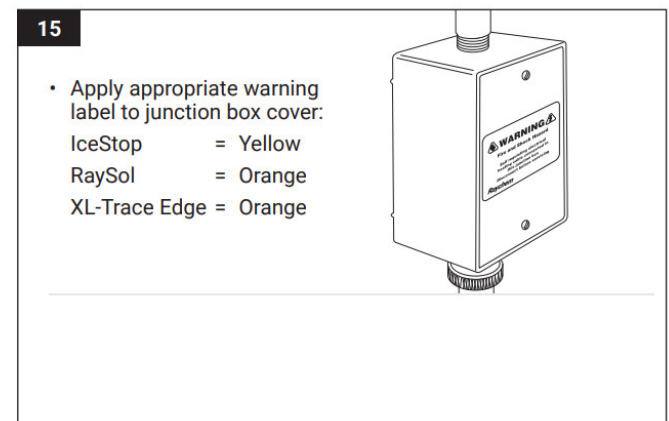
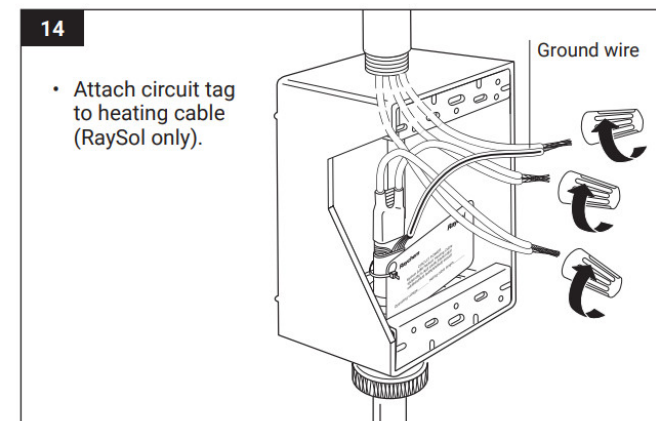
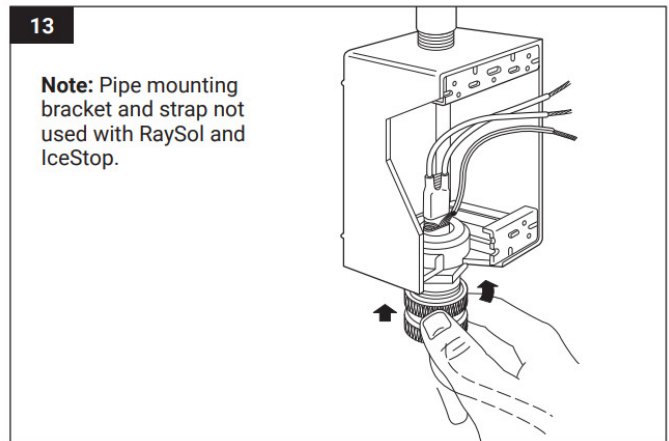
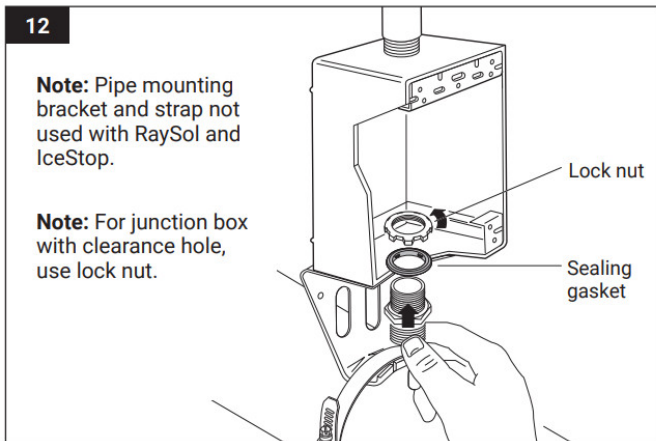
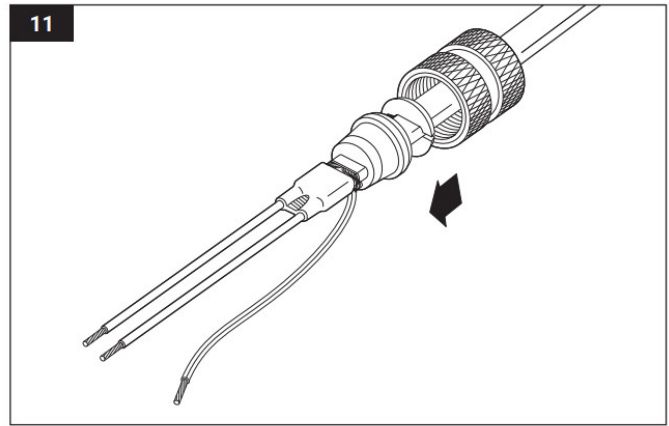
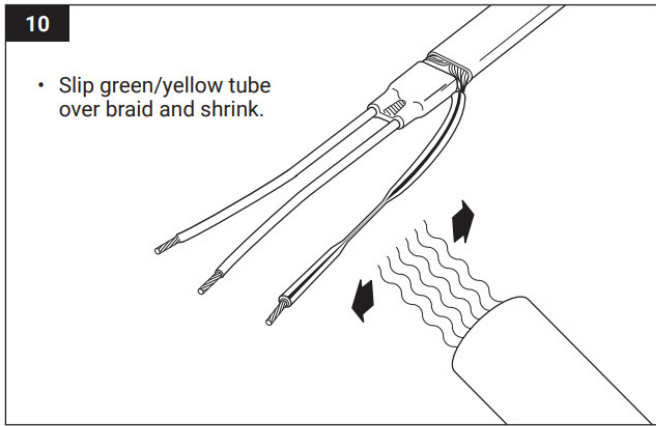

END SEAL INSTALLATION FOR XL-TRACE EDGE-CR AND -CT, RAYSOL, AND ICESTOP HEATING CABLES

- Score down and around outer jacket 1 inch from the end.
- Remove the outer jacket.
- Do not cut or damage inner jacket. If damaged, remove damaged section and repeat step 1.

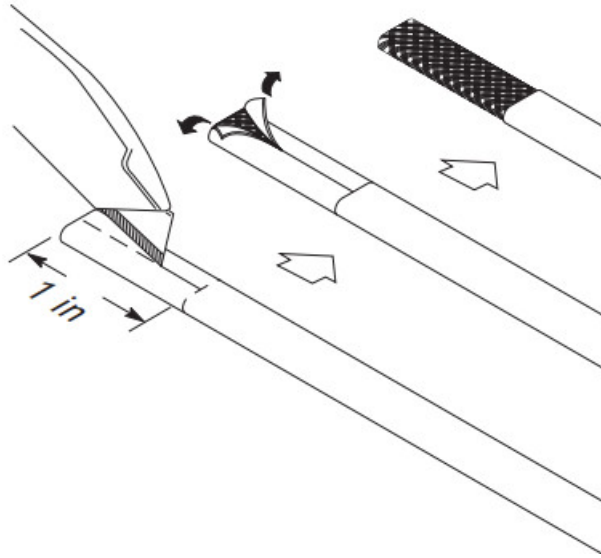

- Remove exposed braid.

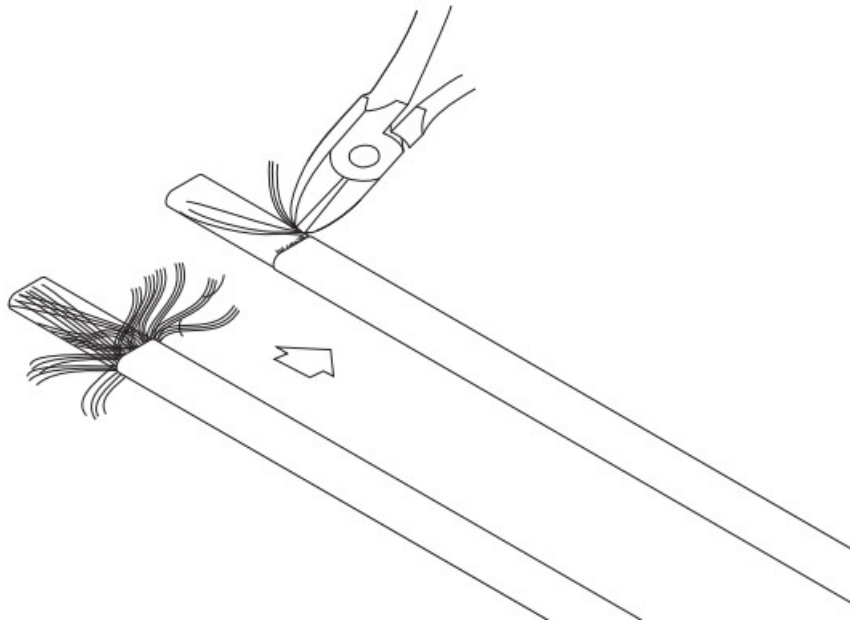

- Push end seal completely onto heating cable.

Note: The end seal is designed to be installed only once; it cannot be removed from the heating cable once installed. Do not use until ready for final installation.

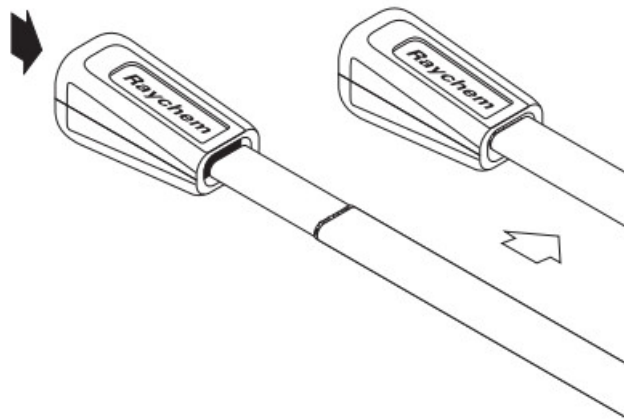

North America Tel +1.800.545.6258 Fax +1.800.527.5703 thermal.info@nVent.com	Europe, Middle East, Africa Tel +32.16.213.511 Fax +32.16.213.604 thermal.info@nVent.com
Asia Pacific Tel +86.21.2412.1688 Fax +86.21.5426.3167 cn.thermal.info@nVent.com	Latin America Tel +1.713.868.4800 Fax +1.713.868.2333 thermal.info@nVent.com



©2021 nVent. All nVent marks and logos are owned or licensed by nVent Services GmbH or its affiliates. All other trademarks are the property of their respective owners.
nVent reserves the right to change specifications without notice.
RAYCHEM-IM-H53514-FTCP-EN-2111
nVent.com/RAYCHEM

Documents / Resources

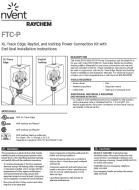
	nVent RAYCHEM FTC-P Power Connection and End Seal Kit [pdf] Instruction Manual FTC-P Power Connection and End Seal Kit, FTC-P, Power Connection and End Seal Kit, Connection and End Seal Kit, End Seal Kit, Seal Kit
---	---

References

- [🔥 Electrical Heat Tracing | Heat Tracing | nVent RAYCHEM](#)