



nVent RAYCHEM FTC-P FTC Pipe Stand and Power Connection Kit Instruction Manual

[Home](#) » [nVent RAYCHEM](#) » nVent RAYCHEM FTC-P FTC Pipe Stand and Power Connection Kit Instruction Manual 

Contents

- [1 nVent RAYCHEM FTC-P FTC Pipe Stand and Power Connection Kit](#)
- [2 Product Information](#)
- [3 Product Usage Instructions](#)
- [4 DESCRIPTION](#)
- [5 TOOLS REQUIRED](#)
- [6 KIT CONTENTS](#)
- [7 POWER CONNECTION INSTALLATION](#)
- [8 Documents / Resources](#)
 - [8.1 References](#)
- [9 Related Posts](#)



nVent RAYCHEM FTC-P FTC Pipe Stand and Power Connection Kit



Product Information

Product Name	FTC-P XL-Trace Edge, Ray Sol , and Ice Stop Power Connection Kit with End Seal
Approvals	<ul style="list-style-type: none"> • With XL-Trace Edge • With Ice Stop and Ray Sol • With Ice Stop and Ray Sol (Ice Stop heating cable only) • For Class I, Div. 2, Groups A, B, C, D Hazardous Locations: GM-1XT and GM-2XT only
Description	The invent RAYCHEM FTC-P Power Connection and End Seal Kit is designed for use with invent RAYCHEM XL-Trace Edge, Ray Sol , and Ice Stop heating cables. This kit includes materials for one power connection and one end seal. It is important to use these installation instructions in conjunction with the XL-Trace Edge, Ray Sol , and Ice Stop System Installation and Operation Manuals. For technical support, please contact your invent representative or call invent at 800-545-6258.
Additional Materials Required	(NOT PROVIDED IN THIS KIT)

Product Usage Instructions

Power Connection Installation for XL-Trace Edge-CR and -CT, Ray Sol, and Ice Stop

1. Ensure that you do not cut through the braid or inner jacket of the heating cable.
2. Using pliers, cut a 6 1/2 inch section of the outer jacket of the heating cable.
3. Using pliers, cut a 5 1/2 inch section of the conductive core of the heating cable.
4. Insert the blue grommet into the sealing fitting.
5. Insert the sealing fitting into the outer jacket of the heating cable.
6. Slide the black heat-shrinkable tube (1/2 in x 1 1/2 in) onto the outer jacket of the heating cable.
7. Slide the green/yellow heat-shrinkable tube (1/4 in x 5 1/2 in) onto the outer jacket of the heating cable.

8. Slide the two black heat-shrinkable tubes (1/8 in x 5 1/2 in) onto the outer jacket of the heating cable.
9. Connect the bus wires of the heating cable to the power source using wire nuts.
10. Apply heat to the heat-shrinkable tubes with a heat gun to seal them. Hold the heat gun for 10 seconds.
11. For junction boxes with a clearance hole, use the lock nut to secure the sealing fitting.
12. Attach the grounding wire to the grounding system.

End Seal Installation for XL-Trace Edge-CR and -CT, Ray Sol, and Ice Stop Heating Cables

1. Ensure that the heating cable is undamaged.
2. Cut a 1-inch section of the outer jacket of the heating cable.
3. Insert the end seal into the cut section of the outer jacket.

For more information or assistance, please visit nVent.com/RAYCHEM or contact invent at 800-545-6258.

Note: This is a simplified version of the product information and usage instructions. Please refer to the complete user manual for detailed instructions and safety precautions.

FTC-P

XL-Trace Edge, Ray Sol , and Ice Stop Power Connection Kit with End Seal Installation Instructions

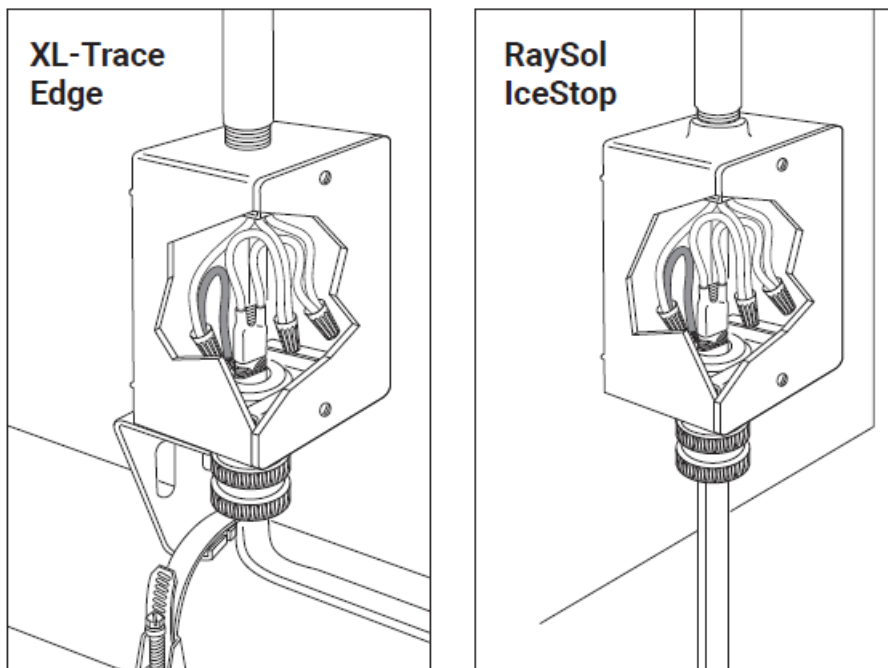

DESCRIPTION

The invent RAYCHEM FTC-P Power Connection and End Seal Kit is for use with invent RAYCHEM XL-Trace Edge, Ray Sol and Ice Stop heating cables. Materials for one power connection and one end seal are included in this kit. These installation instructions should be used in conjunction with the XL-Trace Edge, Ray Sol and Ice Stop System Installation and Operation Manuals. For technical support contact your invent representative or call invent at 800-545-6258.

TOOLS REQUIRED

- Screw driver

- Pen
- Needle-nose pliers
- Diagonal cutters
- Utility knife
- Heat gun or propane torch

ADDITIONAL MATERIALS REQUIRED (NOT PROVIDED IN THIS KIT)

- UL Listed or CSA Certified junction box suitable for the location, with a clearance hole or threaded hub for 1/2 inch NPT. For Ray Sol applications, the power connection and end seal may be terminated in the same box.

APPROVALS



- With XL-Trace Edge



- With IceStop and Raysol



- With IceStop and RaySol



- With IceStop heating cable only

- For Class I, Div. 2, Groups A, B, C, D Hazardous Locations: GM-1XT and GM-2XT only

WARNING:

This component is an electrical device that must be installed correctly to ensure proper operation and to prevent shock or fire. Read these important warnings and carefully follow all the installation instruction

- To minimize the danger of fire from sustained electrical arcing if the heating cable is damaged or improperly installed, and to comply with the requirements of invent, agency certifications, and national electrical codes, ground fault equipment protection must be used. Arcing may not be stopped by conventional circuit breakers.
- Bus wires will short if they contact each other. Keep bus wires
- Keep components and heating cable ends dry before and during installation.
- The black heating cable core is conductive and can short. It must be properly insulated and kept dry.
- Component approvals and performance are based on the use of invent – specified parts only. Do not use substitute parts or vinyl electrical tape.
- Leave these instructions with end

CAUTION

HEALTH HAZARD

Overheating heat-shrinkable tubes will produce fumes that may cause irritation. Use adequate ventilation and avoid charring or burning. Consult MSDS RAY3122 for further information.

CHEMTREC 24-hour emergency telephone(800) 424-9300Non-emergency health and safety information(800) 545-6258.

KIT CONTENTS

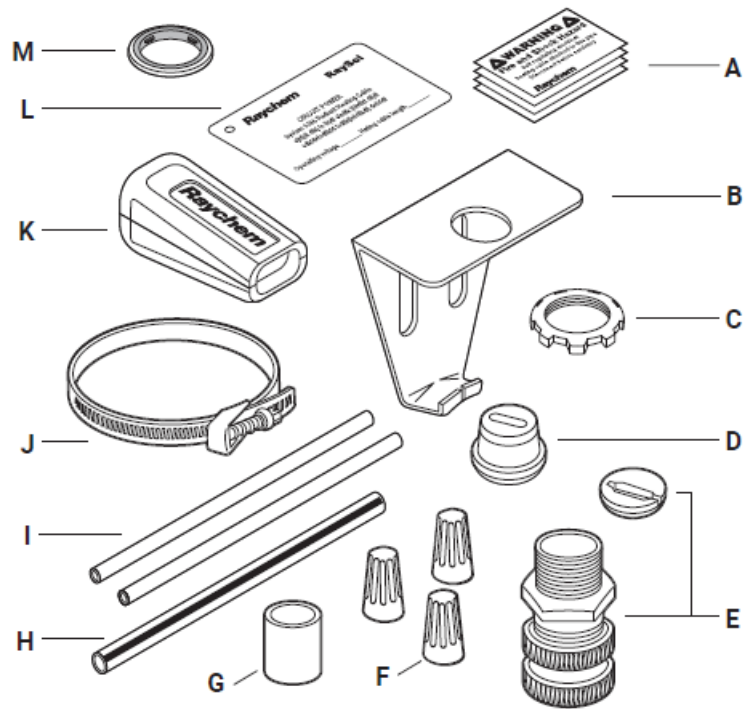

Item	Qty	Description
A	4	Warning labels
B	1	Pipe mounting bracket
C	1	Lock nut
D	1	Blue grommet
E	1	Sealing fitting
F	3	Wire nuts
G	1	Black heat-shrinkable tube (1/2 in x 1 1/2 in)
H	1	Green/yellow heat-shrinkable tube (1/4 in x 5 1/2 in)
I	2	Black heat-shrinkable tubes (1/8 in x 5 1/2 in)
J	1	#3 pipe strap
K	1	Gel-filled end seal (FTC-E)
L	1	Ray Sol circuit tag
M	1	Sealing gasket

POWER CONNECTION INSTALLATION

XL-Trace Edge-CR and -CT, RaySol, and IceStop

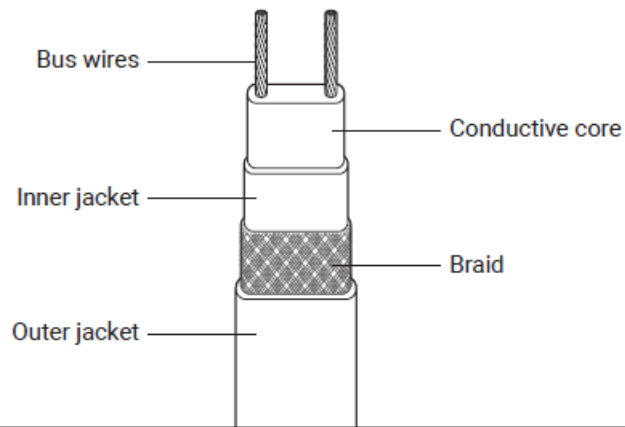

- Discard black grommet and use blue grommet

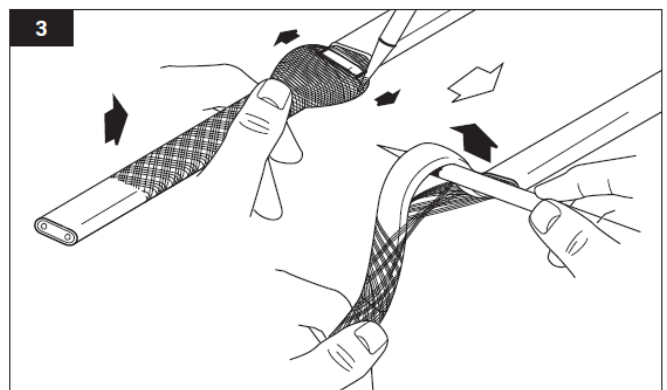
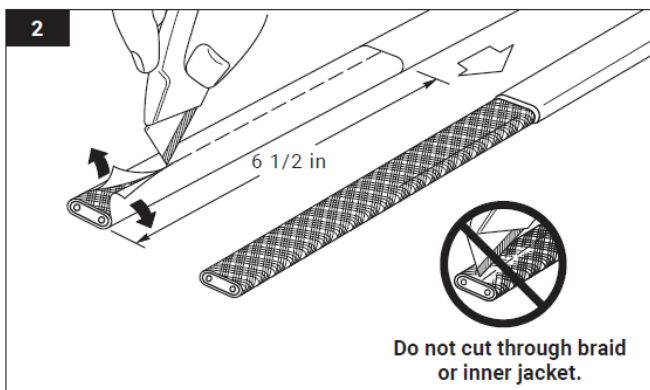
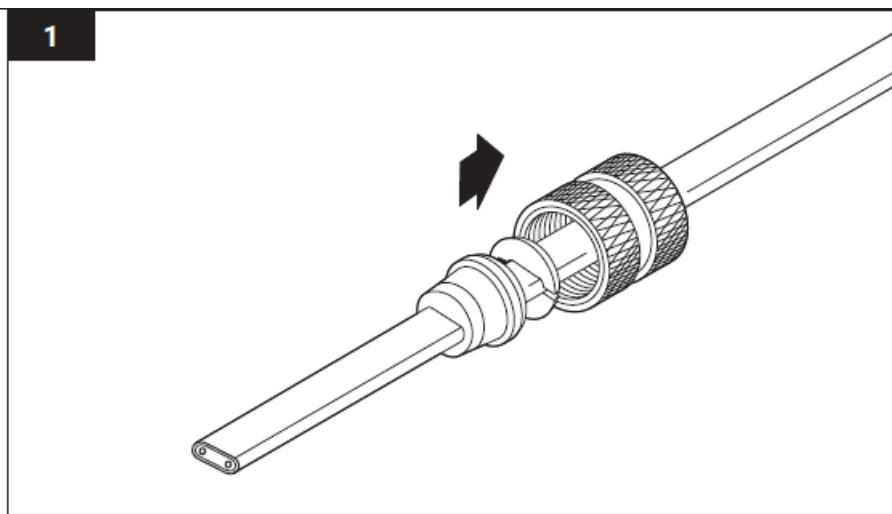

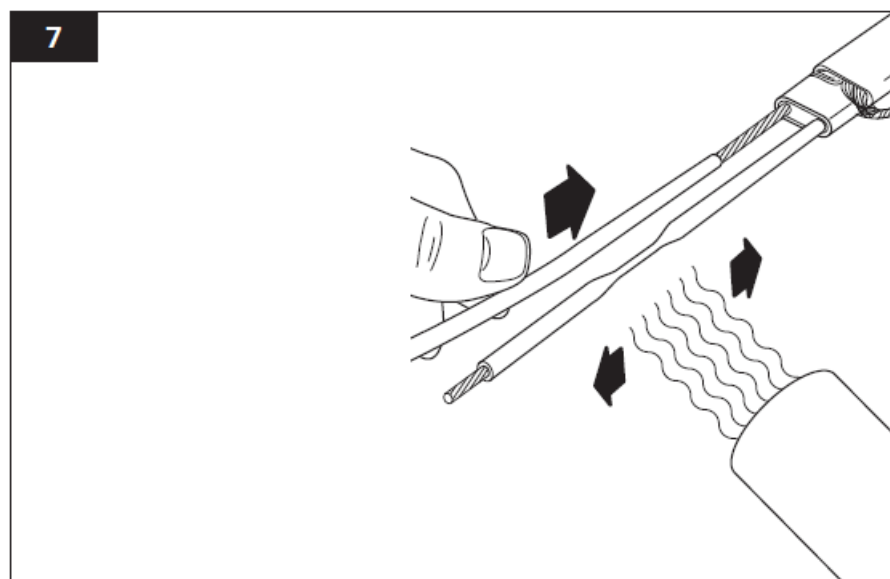
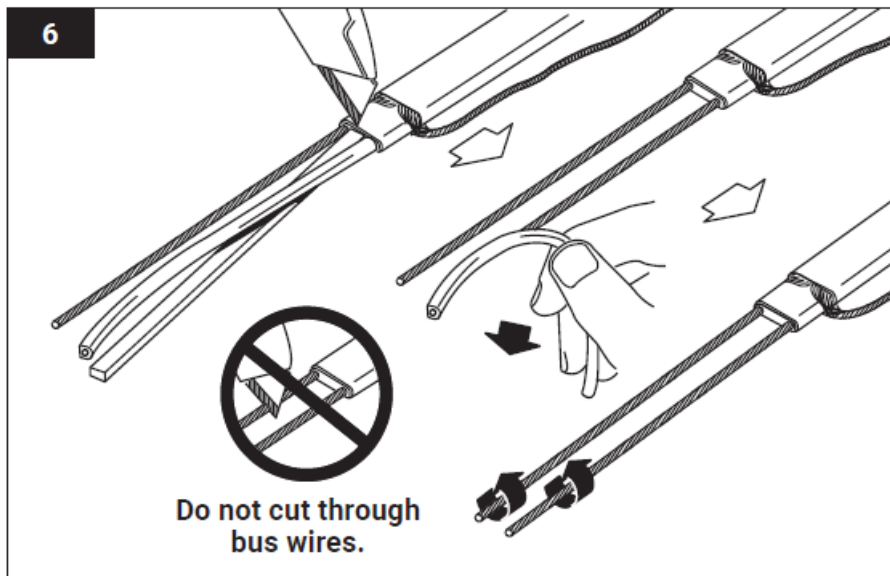

- Slide heat-shrinkable tubes over end of cable.
- Starting from the center of the tube, move the heat source continuously from side to side.

CAUTION: Health Hazard. Consult material safety data sheet RAY3.

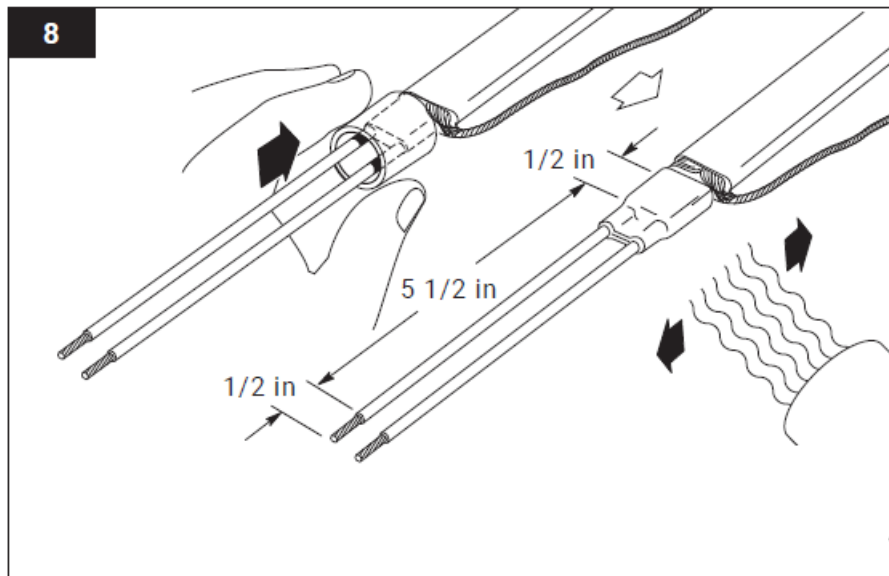

- Starting at center of tube, move heat source continuously from side to side.

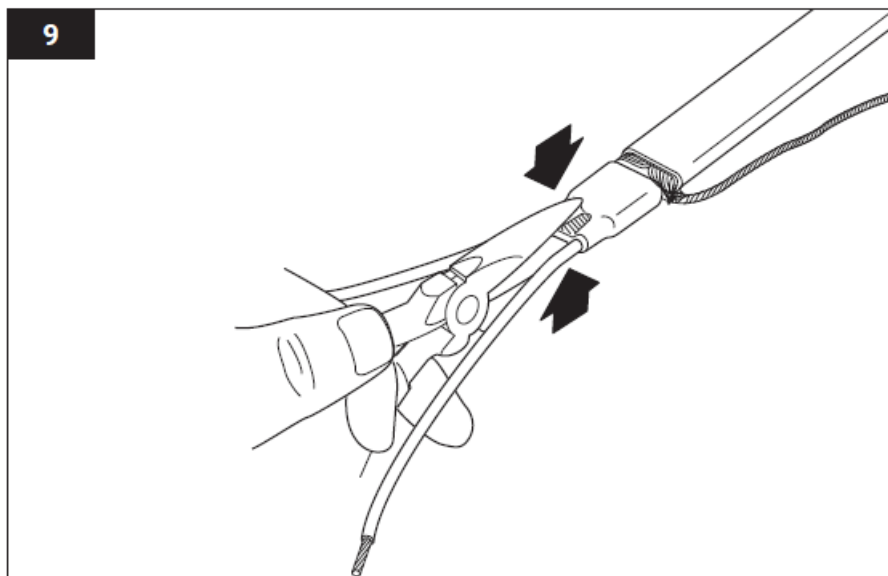

- While tube is still hot, pinch with pliers between bus wires to seal; hold for 10 seconds.

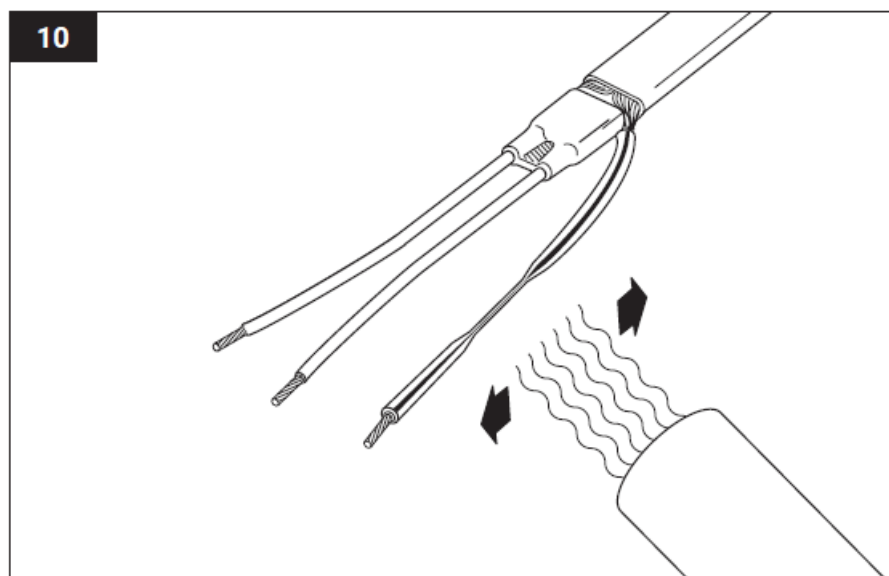

Slip green/yellow tube over braid and shrink.

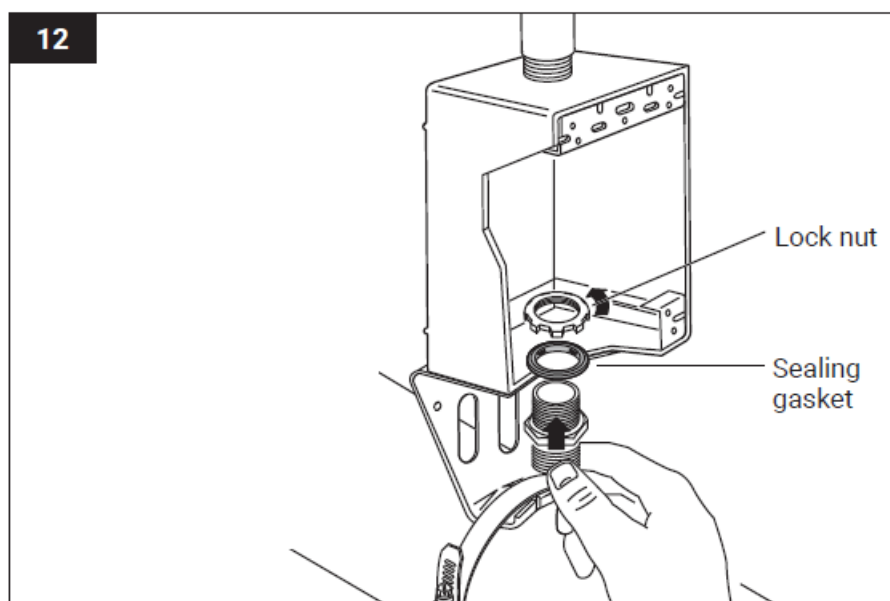
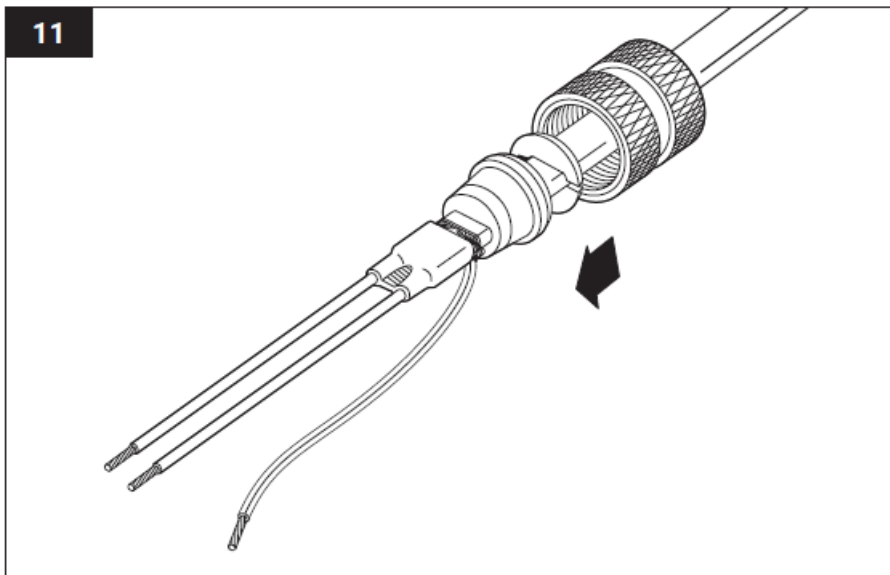

- **Note:** Pipe mounting bracket and strap not used with RaySol and IceStop.
- Note:** For junction box with clearance hole, use lock nut.

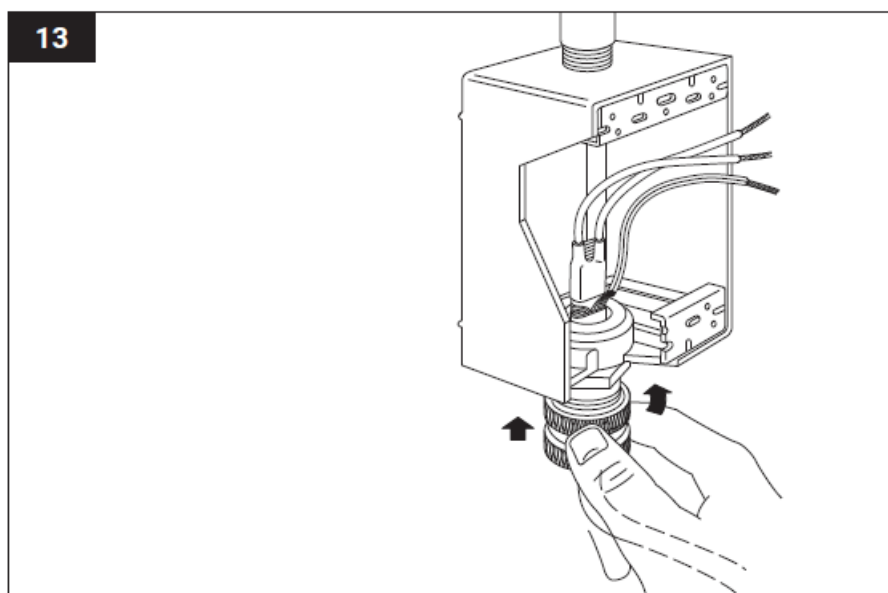

- **Note**

Pipe mounting bracket and strap not used with RaySol and IceStop.

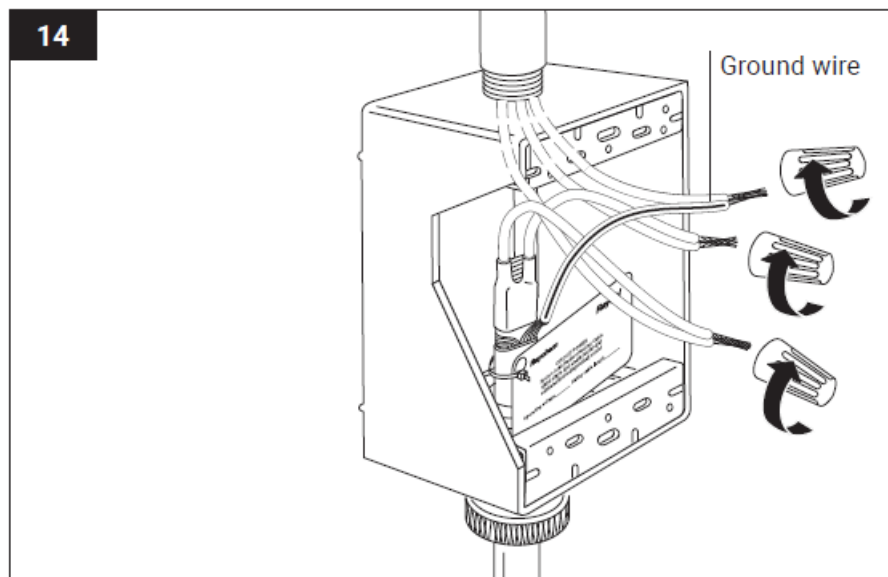

- Attach circuit tag to heating cable (Ray Sol only).

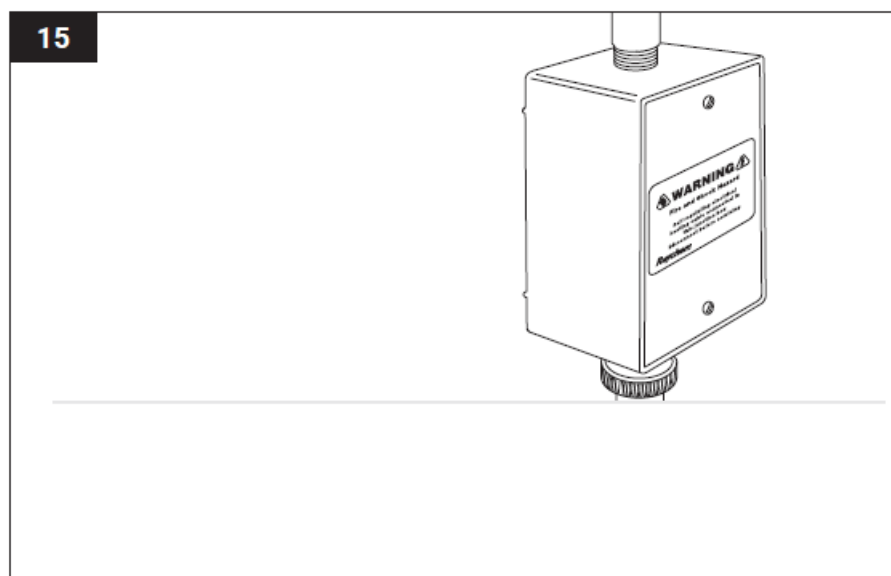

- Apply appropriate warning label to junction box cover:
 - Ice Stop Yellow
 - Ray Sol Orange
 - XL-Trace Edge Orange

END SEAL INSTALLATION FOR XL-TRACE EDGE-CR AND -CT, RAYSOL, AND ICESTOP HEATING CABLES

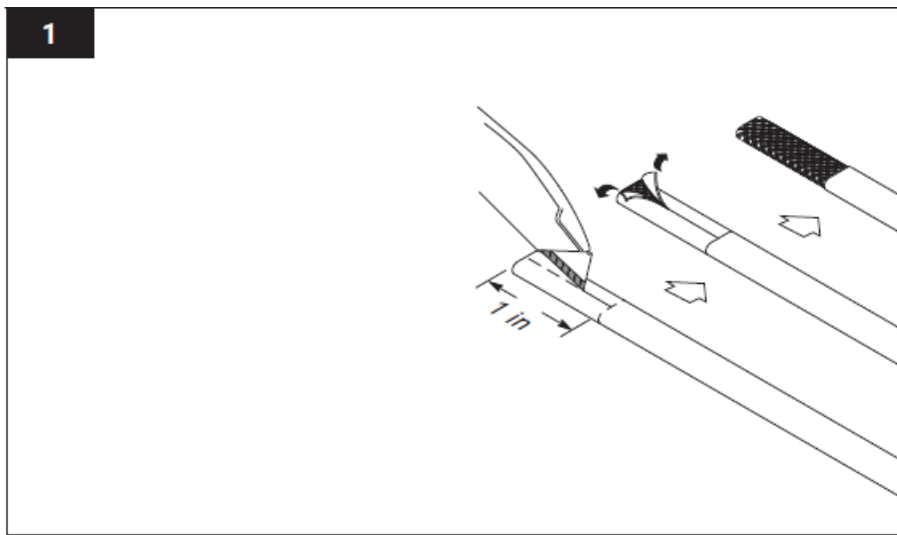

- Score down and around outer jacket 1 inch from the end.
- Remove the outer jacket.
- Do not cut or damage inner jacket. If damaged, remove damaged section and repeat step 1.
-

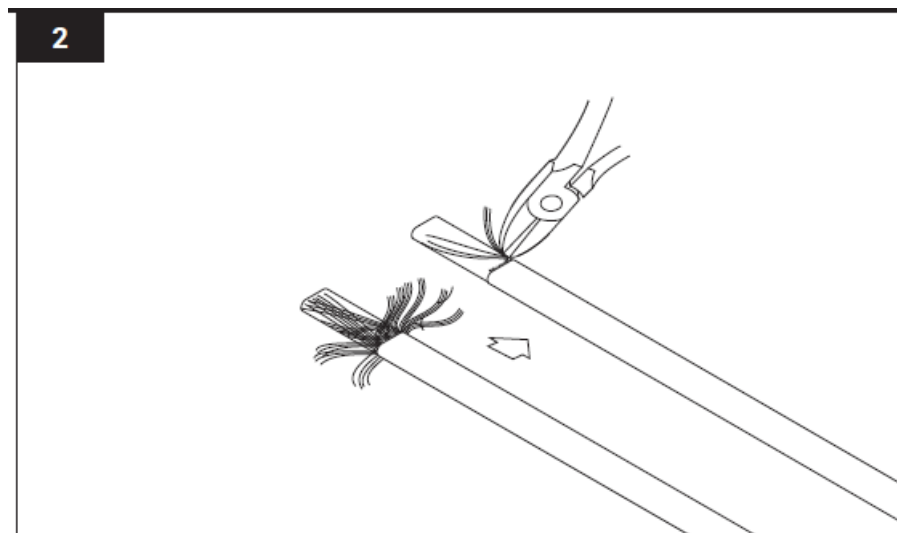

Remove exposed braid.

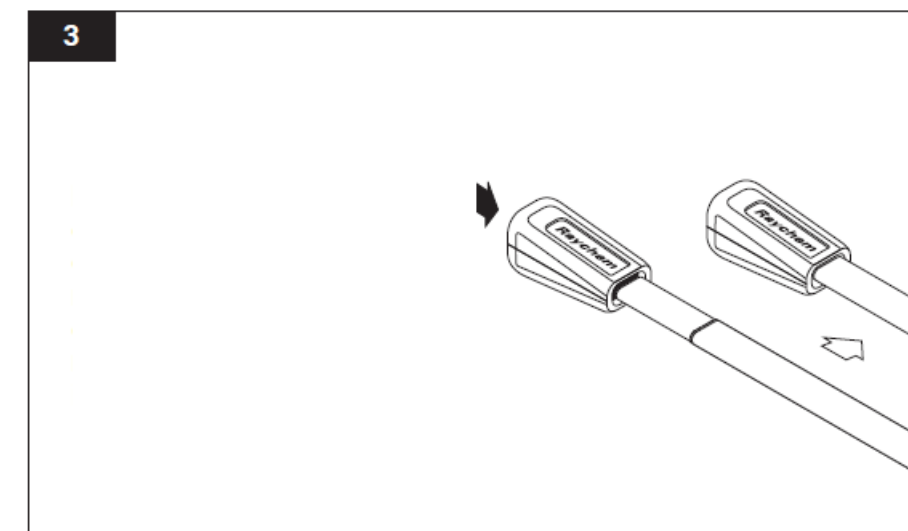

- Push end seal completely onto heating cable

Note

The end seal is designed to be installed only once; it cannot be removed from the heating cable once installed. Do

not use until ready for use until ready for final installation.

North America

Tel +1.800.545.6258

Fax +1.800.527.5703

thermal.info@nVent.com

Europe, Middle East, Africa

Tel +32.16.213.511

Fax +32.16.213.604

thermal.info@nVent.com

Asia Pacific

Tel +86.21.2412.1688

Fax +86.21.5426.3167

cn.thermal.info@nVent.com

Latin America

Tel +1.713.868.4800

Fax +1.713.868.2333

thermal.info@nVent.com

©2021 nVent. All nVent marks and logos are owned or licensed by nVent Services GmbH or its affiliates. All other trademarks are the property of their respective owners.

nVent reserves the right to change specifications without notice.

RAYCHEM-IM-H53514-FTCP-EN-2111

nVent.com/RAYCHEM

Documents / Resources

	<p>nvent RAYCHEM FTC-P FTC Pipe Stand and Power Connection Kit [pdf] Instruction Manual FTC-P FTC Pipe Stand and Power Connection Kit., FTC-P, FTC Pipe Stand and Power Connection Kit, Stand and Power Connection Kit, Power Connection Kit, Connection Kit</p>
---	--

References

- [🔥 Electrical Heat Tracing | Heat Tracing | nVent RAYCHEM](#)