



[Home](#) » [nVent LENTON](#) » **nVent LENTON RBWS2222F 64 mm Angular Pouring Basin**

Instructions 

Contents [[hide](#)]

- [1 nVent LENTON RBWS2222F 64 mm Angular Pouring Basin](#)
- [2 Product Specifications](#)
- [3 Product Usage Instructions](#)
- [4 PRODUCT ATTRIBUTES](#)
- [5 FAQs](#)
- [6 Documents / Resources](#)
 - [6.1 References](#)



nVent LENTON RBWS2222F 64 mm Angular Pouring Basin



Product Specifications

- **Catalog Number:** RBWS2222F
- **Material:** Heat-resistant graphite
- **Compatibility:** T-Series and B-Series horizontal top fill sleeves
- **Additional Requirement:** RBWS2222 pouring basins require RBW167 pouring basin frame (sold separately)

Product Usage Instructions

Installation Guidelines

Ensure that the clearances of the structure allow for angular installations. Follow these steps for proper installation:

1. Place the RBWS2222 pouring basin on a flat, stable surface.
2. Attach the RBW167 pouring basin frame securely to the pouring basin.
3. Position the assembly in the designated location for pouring filler material.

Safety Precautions

Before installation, carefully review all instructions and safety notices provided in the nVent LENTON Cadweld Rebar Splicing System Instruction Manual to prevent accidents and ensure safe usage.

Product Care

After each use, clean the pouring basin with a mild detergent and water to maintain its longevity and performance.

Top fill pouring basins should be used on angular installations whenever the clearances of the structure allow. The compact size of the top fill pouring basins help ensure the best possible flow of filler material.

FEATURES

- Made from heat-resistant graphite
- Durable, re-usable and long lasting
- Designed for use with T-Series and B-Series horizontal top fill sleeves

PRODUCT ATTRIBUTES

- Material: Graphite
- Diameter (Ø): 64 mm
- Length (L): 89mm
- Width (W): 89 mm
- Height (H): 133 mm
- Angle (a): 15 °

ADDITIONAL PRODUCT DETAILS

- RBWS2222 pouring basins require one RBW167 pouring basin frame (sold separately).
- Prior to installation, please read and understand all of the detailed instructions and safety notices provided in the nVent LENTON Cadweld Rebar Splicing System Instruction Manual.
- Sizes not shown may be available by special order. Contact your nVent LENTON representative for more information.

DIAGRAMS

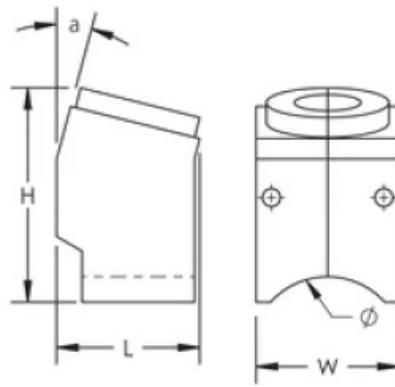

WARNING

nVent products shall be installed and used only as indicated in nVent's product instruction sheets and training materials. Instruction sheets are available at www.nvent.com and from your nVent customer service representative. Improper installation, misuse, misapplication or other failure to completely follow nVent's instructions and warnings may cause product malfunction, property damage, serious bodily injury and death and/or void your warranty.

contacts

- +1.800.753.9221
- Option 1 – Customer Care
- Option 2 – Technical
- Support

Netherlands

- +31 800-0200135

France

- +33 800 901 793

Germany

- 800 1890272

Other Countries:

- +31 13 5835404

Shanghai:

- + 86 21 2412 1618/19

Sydney

- +61 2 9751 8500

©2025 nVent. All nVent marks and logos are owned or licensed by nVent Services GmbH or its affiliates. All other trademarks are the property of their respective owners. nVent reserves the right to change specifications without notice.

nVent.com/LENTON

FAQs

Can I use the RBWS2222F pouring basin with other types of fill sleeves?

The RBWS2222F pouring basin is specifically designed for use with T-Series and B-Series horizontal top fill sleeves for optimal performance.

Are custom sizes available for the RBWS2222F pouring basin?

Special order sizes may be available upon request. Please contact your nVent LENTON representative for more information regarding custom sizes.

Documents / Resources



[nVent LENTON RBWS2222F 64 mm Angular Pouring Basin \[pdf\]](#) Instructions

RBWS2222F 64 mm Angular Pouring Basin, RBWS2222F, 64 mm Angular Pouring Basin, Angular Pouring Basin, Pouring Basin

References

- [User Manual](#)

■ nVent LENTON

🔑 64 mm Angular Pouring Basin, Angular Pouring Basin, nVent LENTON, Pouring Basin, RBWS2222F, RBWS2222F 64 mm Angular Pouring Basin

Leave a comment

Your email address will not be published. Required fields are marked *

Comment *

Name

Email

Website

☐ Save my name, email, and website in this browser for the next time I comment.

Post Comment

Search:

e.g. whirlpool wrf535swhz

Search

[Manuals+](#) | [Upload](#) | [Deep Search](#) | [Privacy Policy](#) | [@manuals.plus](#) | [YouTube](#)

This website is an independent publication and is neither affiliated with nor endorsed by any of the trademark owners. The "Bluetooth®" word mark and logos are registered trademarks owned by Bluetooth SIG, Inc. The "Wi-Fi®" word mark and logos are registered trademarks owned by the Wi-Fi Alliance. Any use of these marks on this website does not imply any affiliation with or endorsement.