

nVent HOFFMAN EGVM2 Comline Vertical Mount Cabinet Instruction Manual

[Home](#) » [nVent HOFFMAN](#) » nVent HOFFMAN EGVM2 Comline Vertical Mount Cabinet Instruction Manual 

Contents

- [1 nVent HOFFMAN EGVM2 Comline Vertical Mount Cabinet](#)
- [2 Product Information](#)
- [3 Product Usage Instructions](#)
- [4 PARTS](#)
- [5 INSTALLATION](#)
- [6 Documents / Resources](#)
 - [6.1 References](#)
- [7 Related Posts](#)



nVent HOFFMAN EGVM2 Comline Vertical Mount Cabinet

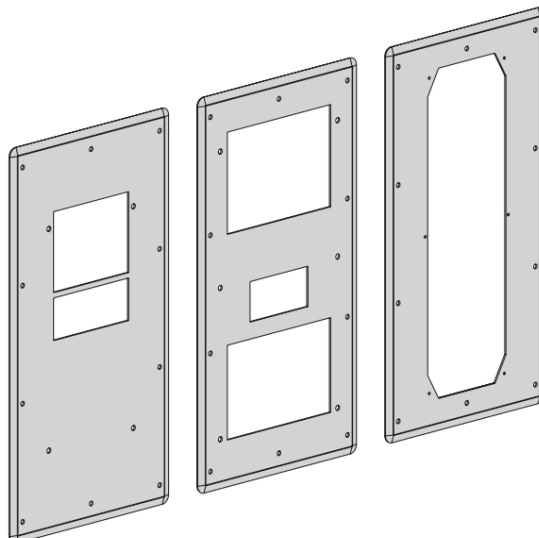



Product Information

- **Product Revision:** B
- **Model Number:** 89070510

Product Usage Instructions

1. Ensure that the product is connected to a power source.
2. Press the power button to turn on the product.
3. Wait for the product to initialize. This may take a few seconds.
4. Once initialized, the product is ready to use.
5. To turn off the product, press and hold the power button until the device powers down.
6. For troubleshooting or further assistance, refer to the user manual or contact our customer support.

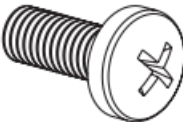
PARTS

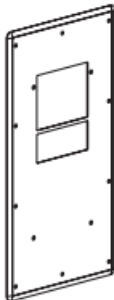
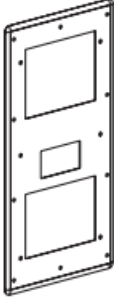
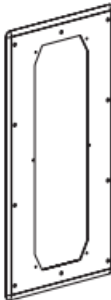
1	M6x1x16	2	M6
			
(0x)		(0x)	
3		4	
			
(1x)		(1x)	
		5	
			
		(1x)	

INSTALLATION

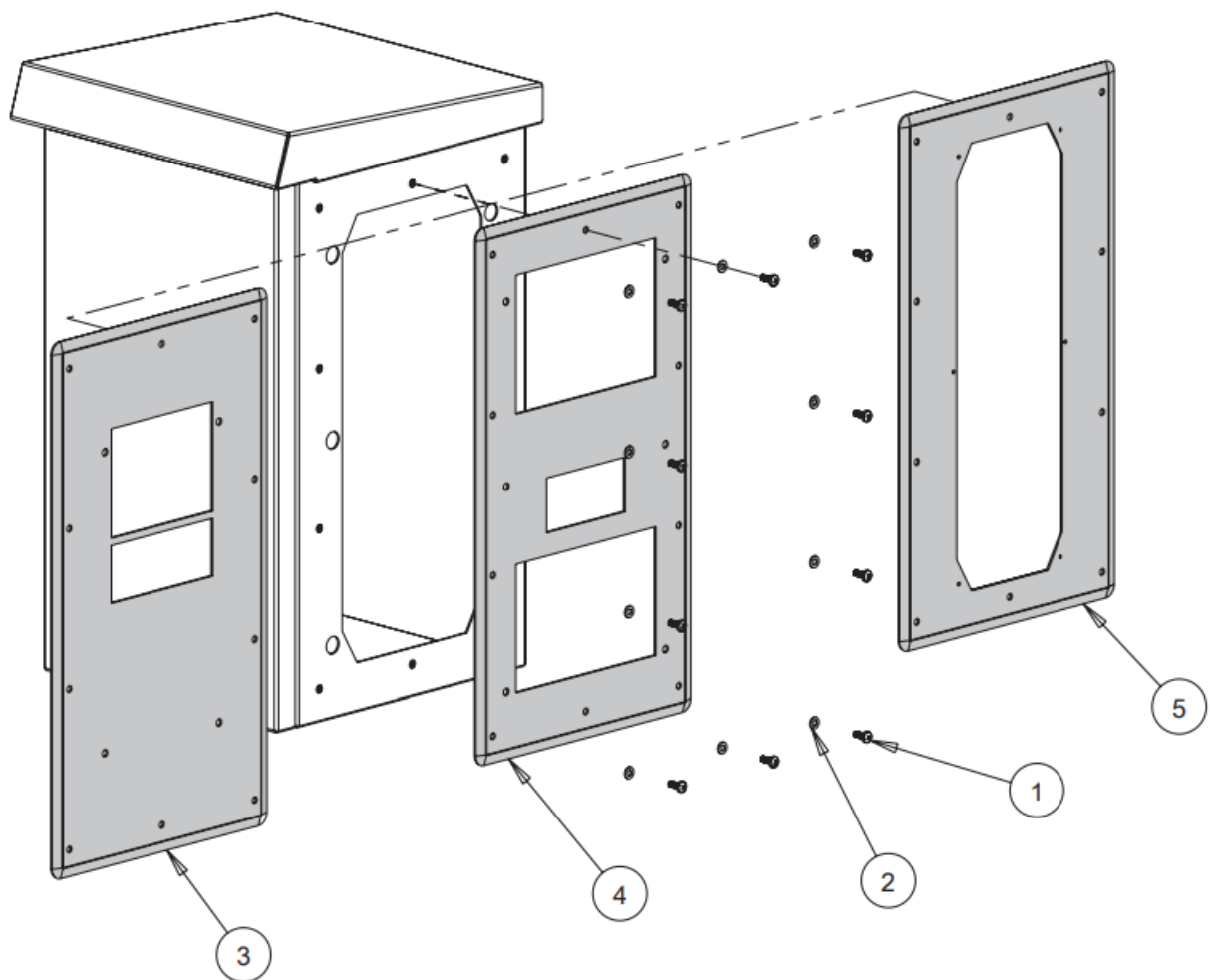
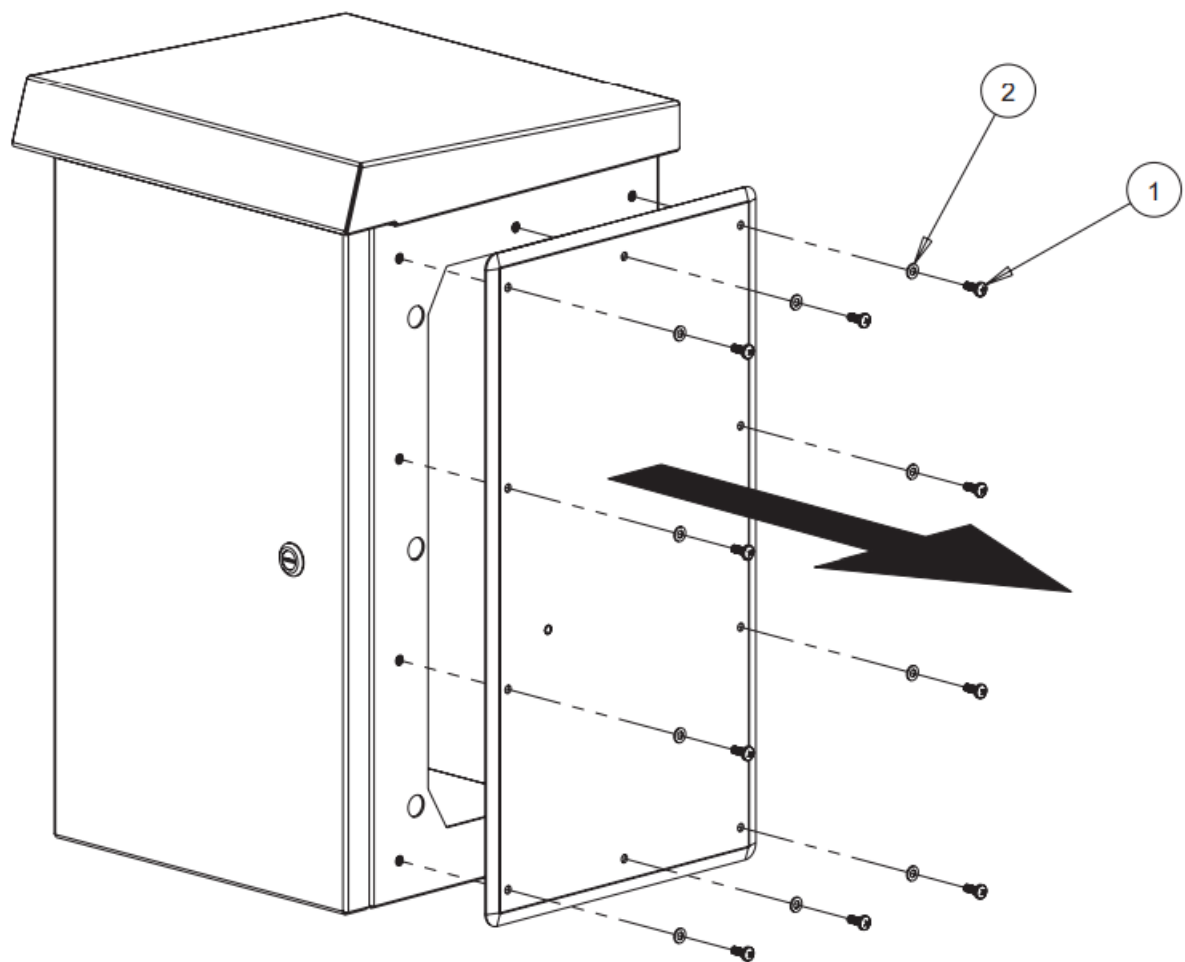

Documents / Resources

	<p>nVent HOFFMAN EGVM2 Comline Vertical Mount Cabinet [pdf] Instruction Manual 89070510, EGVM2, EGVM2 Comline Vertical Mount Cabinet, Comline Vertical Mount Cabinet, Vertical Mount Cabinet, Mount Cabinet, Cabinet</p>
---	--

References

-  [We connect and protect | nVent](#)