



nVent CADDY SLADS Air Duct Support Attachment Owner's Manual

[Home](#) » [nVent Caddy](#) » nVent CADDY SLADS Air Duct Support Attachment Owner's Manual 

Contents

- [1 nVent CADDY SLADS Air Duct Support Attachment](#)
- [2 Product Usage Instructions](#)
- [3 FEATURES](#)
- [4 PRODUCT ATTRIBUTES](#)
- [5 Documents / Resources](#)
 - [5.1 References](#)
- [6 Related Posts](#)



nVent CADDY SLADS Air Duct Support Attachment



Specifications

- **Catalog Number:** SALADS
- **Material:** Steel
- **Finish:** Electrogalvanized
- **Hole Size 1 (HS1):** 8 mm
- **Hole Size 2 (HS2):** 4.2 mm
- **A:** 20 mm
- **B:** 10 mm
- **Thickness (T):** 1.5 mm

Product Features

The Air Duct Support Attachment is an angled bracket designed for installation onto round or square ducts. It is specifically crafted to accept nVent CADDY Speed Link wire rope or hook for secure mounting.

Product Usage Instructions

1. Identify the type of duct (round or square) onto which the support attachment will be installed.
2. Ensure that the dimensions of the duct align with the specifications of the attachment.
3. Using appropriate tools, attach the bracket securely to the duct using the provided holes.
4. Insert the nVent CADDY Speed Link wire rope or hook into the designated slot on the support attachment.
5. Verify that the attachment is firmly in place before proceeding with any additional installation steps.

FAQ

Q: Can this attachment be used on both round and square ducts?

A: Yes, the angled bracket design allows for installation on both round and square ducts.

AIR DUCT SUPPORT ATTACHMENT

CATALOG NUMBER
SLADS



FEATURES

Angled bracket for installation on to round or square duct
Designed to accept nVent CADDY Speed Link wire rope or hook

PRODUCT ATTRIBUTES

- Material: Steel
- Finish: Electrogalvanized
- Hole Size 1 (HS1): 8 mm
- Hole Size 2 (HS2): 4.2 mm
- A: 20 mm
- B: 10 mm
- Thickness (T): 1.5 mm

DIAGRAMS

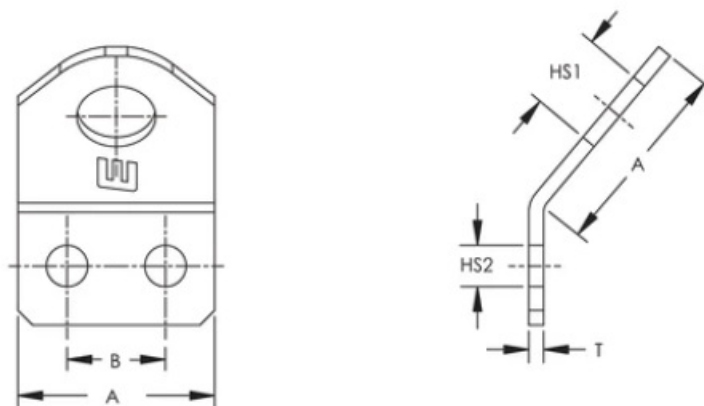

WARNING

nVent products shall be installed and used only as indicated in nVent's product instruction sheets and training materials. Instruction sheets are available at www.nvent.com and from your nVent customer service representative. Improper installation, misuse, misapplication or other failure to completely follow nVent's instructions and warnings may cause product malfunction, property damage, serious bodily injury and death and/or void your warranty.

North America

+1.800.753.9221

Option 1 – Customer Care

Option 2 – Technical Support

Europe Netherlands

+31 800-0200135

France:

+33 800 901 793

Europe Germany

800 1890272

Other Countries:

+31 13 5835404

APAC Shanghai:

+ 86 21 2412 1618/19

Sydney:

+61 2 9751 8500

nVent.com

© 2024 nVent. All nVent marks and logos are owned or licensed by nVent Services GmbH or its affiliates. All other trademarks are the property of their respective owners.

nVent reserves the right to change specifications without notice.

Documents / Resources

	<p>nVent CADDY SLADS Air Duct Support Attachment [pdf] Owner's Manual SLADS Air Duct Support Attachment, SLADS, Air Duct Support Attachment, Duct Support Attachment, Support Attachment</p>
---	--

References

- [🌟 Building a more Sustainable and Electrified World | nVent](#)
- [🌟 Building a more Sustainable and Electrified World | nVent](#)
- [User Manual](#)

[Manuals+](#), [Privacy Policy](#)

This website is an independent publication and is neither affiliated with nor endorsed by any of the trademark owners. The "Bluetooth®" word mark and logos are registered trademarks owned by Bluetooth SIG, Inc. The "Wi-Fi®" word mark and logos are registered trademarks owned by the Wi-Fi Alliance. Any use of these marks on this website does not imply any affiliation with or endorsement.