

nVent CADDY PT16 Twist Clip for Wall Partition Owner's Manual

[Home](#) » [nVent Caddy](#) » nVent CADDY PT16 Twist Clip for Wall Partition Owner's Manual 

nVent CADDY PT16 Twist Clip for Wall Partition Owner's Manual

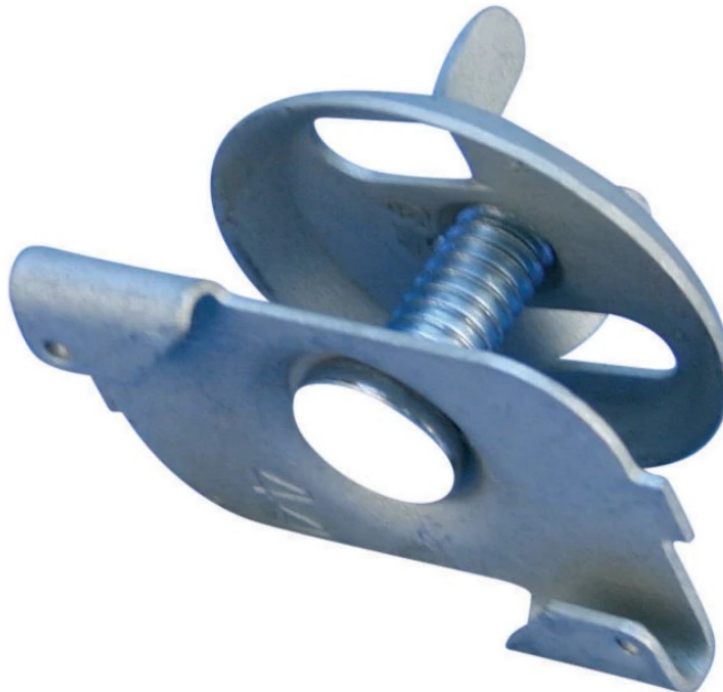

Contents

1 FEATURES

2 PRODUCT

ATTRIBUTES

3 Documents / Resources

3.1 References

4 Related Posts

FEATURES

Fast, easy and secure twist-on installation
No special tools required
Designed to reduce scratching of T-grid

PRODUCT ATTRIBUTES

Material: Spring **Steel;** Steel

Finish: nVent CADDY Armour

T-Grid Size: 15/16"

Screw Diameter: 1/4"

Screw Length: 3/4"

Static Load: 50 lb

WARNING

nVent products shall be installed and used only as indicated in nVent's product instruction sheets and training materials.

Instruction sheets are available at www.nvent.com and from your nVent customer service representative.

Improper installation, misuse, misapplication or other failure to completely follow nVent's instructions and warnings may cause product malfunction, property damage, serious bodily injury and death and/or void your warranty.

North America

+1.800.753.9221

Option 1 – Customer Care

Option 2 – Technical Support

Europe

Netherlands:

+31 800-0200135

France:

+33 800 901 793

Europe

Germany:

800 1890272

Other Countries:

+31 13 5835404

APAC

Shanghai:

+ 86 21 2412 1618/19

Sydney:

+61 2 9751 8500

Our powerful portfolio of brands:

© 2023 nVent. All nVent marks and logos are owned or licensed by nVent Services GmbH or its affiliates. All other trademarks are the property of their respective owners.
nVent reserves the right to change specifications without notice.



Documents / Resources

	<p>nVent CADDY PT16 Twist Clip for Wall Partition [pdf] Owner's Manual PT16 Twist Clip for Wall Partition, PT16, Twist Clip for Wall Partition, Clip for Wall Partition, Wall Partition, Partition</p>
--	--

References

- [🌟 Building a more Sustainable and Electrified World | nVent](#)
- [🌟 Building a more Sustainable and Electrified World | nVent](#)
- [User Manual](#)