



# NUX NDR-5 Atlantic Delay and Reverb Pedal Owner's Manual

[Home](#) » [NUX](#) » NUX NDR-5 Atlantic Delay and Reverb Pedal Owner's Manual

## Contents [ [hide](#) ]

- [1 NUX NDR-5 Atlantic Delay and Reverb Pedal](#)
- [2 Overview](#)
  - [2.1 Features](#)
- [3 Control Panel](#)
  - [3.1 Delay toggle switch](#)
  - [3.2 LEVEL \(DELAY\) knob](#)
  - [3.3 TIME JOB](#)
  - [3.4 DELAY LED indicator](#)
  - [3.5 Delay footswitch](#)
  - [3.6 TAP TEMPO](#)
  - [3.7 Delay Pattern](#)
  - [3.8 TAP Values](#)
  - [3.9 Reverb toggle switch](#)
- [4 1/0 Jacks](#)
- [5 Connection Method](#)
- [6 Inside Routing](#)
- [7 Specification](#)
- [8 Documents / Resources](#)
- [9 Related Posts](#)



**NUX NDR-5 Atlantic Delay and Reverb Pedal**



### **Copyright**

Copyright 2017 Cherub Technology Co. All rights reserved. NUX and Atlantic Delay & Reverb are trademarks of Cherub Technology Co. Other product names modeled in this product are trademarks of their respective companies that do not endorse and are not associated or affiliated with Cherub Technology Co.

### **Accuracy**

Whilst every effort has been made to ensure the accuracy and content of this manual, Cherub Technology Co. makes no representations or warranties regarding the contents.

### **WARNING**

IMPORTANT SAFETY INSTRUCTIONS BEFORE CONNECTING, READ INSTRUCTIONS

### **WARNING**

To reduce the risk of fire or electric shock, do not expose this appliance to rain or misère.

### **CAUTION**

To reduce the risk of fire or electric shock, do not remove screws. No user-serviceable parts inside. Refer servicing to Qualified service personnel.

### **CAUTION**

This equipment has been tested and found to comply with the limits for a Class B digital device pursuant to Part 15 of FCC

Rules. Operation is subject to the following two conditions:

1. This device may not cause harmful interference, and
2. This device must accept any interference received, including interference that may cause undesired operation.

The lightning symbol within a triangle means “electrical caution!” It indicates the presence of information about operating voltage and potential risks of electrical shock. The exclamation point within a triangle means “caution!” ~lease read the information next to all caution signs.

1. Use only the supplied power supply or power cord. If you are not sure of the type of power available, consult your dealer.
2. Do not place near heat sources, such as radiators, heat registers, or appliances which produce heat.
3. Guard against objects or liquids entering the enclosure.
4. Do not attempt to service this product yourself, as opening or removing covers may expose you to dangerous voltage points or other risks. Refer all servicing to qualified service personnel.

5. Servicing is required when the apparatus has been damaged in any way, such as when the power supply cord or plug is damaged, liquid has been spilled or objects have fallen into the apparatus, the apparatus has been exposed to rain or moisture, does not operate normally or has been dropped.
6. The power supply cord should be unplugged when the unit is to be unused for long periods of time.
7. Protect the power cord from being walked on or pinched particularly at plugs, convenience receptacles and at the point where they exit from the apparatus.
8. Prolonged listening at high volume levels may cause irreparable hearing loss and/or damage. Always be sure to practice "safe listening".

Follow all instructions and heed all warnings KEEP THESE INSTRUCTIONS!

## Overview

One of the best Delay and Reverb algorithms in a stomp box. NUX Atlantic Delay & Reverb pedal has special-selected 3 Delay & 3 Reverb effects with an additional dreamy Shimmer effect. And now with the NUX's latest Core Image technology, Verdugo series are offering one of the best sound enhancements. We are choosing the best ideas to make it real for musicians.

NUX Atlantic Delay & Reverb pedal also has inside routing control between the effects, you can choose which effect comes firstly. On serial mode you can create a deep reflection reverb with wet or dry repeats, or you can split your guitar signal and add both effects in parallel chain. Each effect will be mixed with separated dry signals. It has 6.35 mm mono jack input and 2 outputs you can also connect stereo for the real Delay & Reverb experience. It has an Input Level toggle switch, you can optimize the input signal with your signal level.

## Features

- 3 Delay Effects 70's Analog, 60's Tape and 80's Digital
- NUX SMART TAP with Tap Subdivision Options
- 3 Reverb Effects Spring, Plate and Hall
- Place Reverbs with Shimmer
- MS Input unsort Connection
- Input Level Switch (-10dB / 0dB / +4dB)
- Parallel or Serial Routing
- Stereo Output
- USB Port for firmware updates

## Control Panel



70'S

60'S

80'S



Delay toggle switch

### 70's (40ms – 400ms)

Retro-delay meets modern technology, without losing the realistic BBD-effected repeats, so essential for capturing the 70's retro feel.

### &O's (55ms – 550ms)

A warm & dusty tape-echo machine effect, packed with an array of analogue-only goodies. Saturated colors that turn any sound into vintage. Tweak the Repeat knob to the max and use the Time knob to get an experience, just like the real Tape-Echo Machine.

### BO'S (80ms – BOOms)

A digital era invention, crystal clear repeats. Digitally-copied clean repeats carries your signal without absolutely zero color particles. This is the best option if you don't want to mix your favorite chorus with another colorization effect—or your favorite modulation effect.

### LEVEL (DELAY) knob



LEVEL

Controls the wet/dry balance. Adjusts the volume for your repeats.

## REPEAT knob



Varies the numbers of repeats. When set to the MAX sustained runaway will start. You can create an infinite sustained runaway on 60's Delay mode.

## TIME JOB



Controls the delay time. Turning the Time knob while repeating can produce interesting pitch effects. Time knob also changes the TAP subdivision on TAP TEMPO mode. (See TAP TEMPO).

## DELAY LED indicator

## REVERB



11 also shows the TAP TEMPO.

## Delay footswitch



Engages and disengages the Delay effect. And activates TAP TEMPO.



## TAP TEMPO

Instantly synch-up your delays with the tempo you want to accompany. Simply tap the tempo with your foot. TAP TEMPO Speed range is 125 ms 1500 ms for all delay types.

## Delay Pattern

Before you set the TAP TEMPO, use the Time Knob and choose any desired time signature to change the delay pattern. When TAP TEMPO is engaged, your repeats will create a delay pattern according to selected time signature.

## TAP Values

1/8, 1/6, 1/4, 1/3, 1/2, 3/4 and 1.

## Reverb toggle switch

70'S

60'S

80'S



## Spring Reverb

Creates a polyphonic atmosphere filter that catches the sound reflections from deep down spring reverb tank. You can adjust the tank size with the level knob and set the reflection distance with the decay knob.

## Plate Reverb & Shimmer

Straight and clean reflections inside a flat walled room. You can control the room-size with the Level knob and then tweak the Delay bounce point with the Decay knob. If you hold down the Reverb switch, straight reflections will be heated and swirled throughout the inside of the room creating a Shimmer effect.

## Hall Reverb

The sound of a well-designed hall. Whether the hall size is big or small, the reflections will be emitted by wall furniture. You can adjust the interior hall-size, from a small garage to a huge structure with the Level knob and increase or decrease the number of objects on the walls with the Decay knob. Less decay means more objects and faster reflection fading.

## LEVEL(REVERB)knob



DECAY

Controls the balance of wet signal and dry signal. Adjust the Reverb level and size of the area.

## DECAY knob



DECAY

Controls the decay time of the wet signal Range can depends on selected reverb type.

## Reverb LED indicator

REVERB



## Reverb footswitch



### Hold For Shimmer

Engages and disengages the Reverb effect And controls the Shimmer effect.

**Shimmer:** Choose Plate Reverb. Then hold the Reverb foot-switch (as long as you want) until your effect takes flight. The effect will fade-out when you release the foot-switch.

## 1/0 Jacks

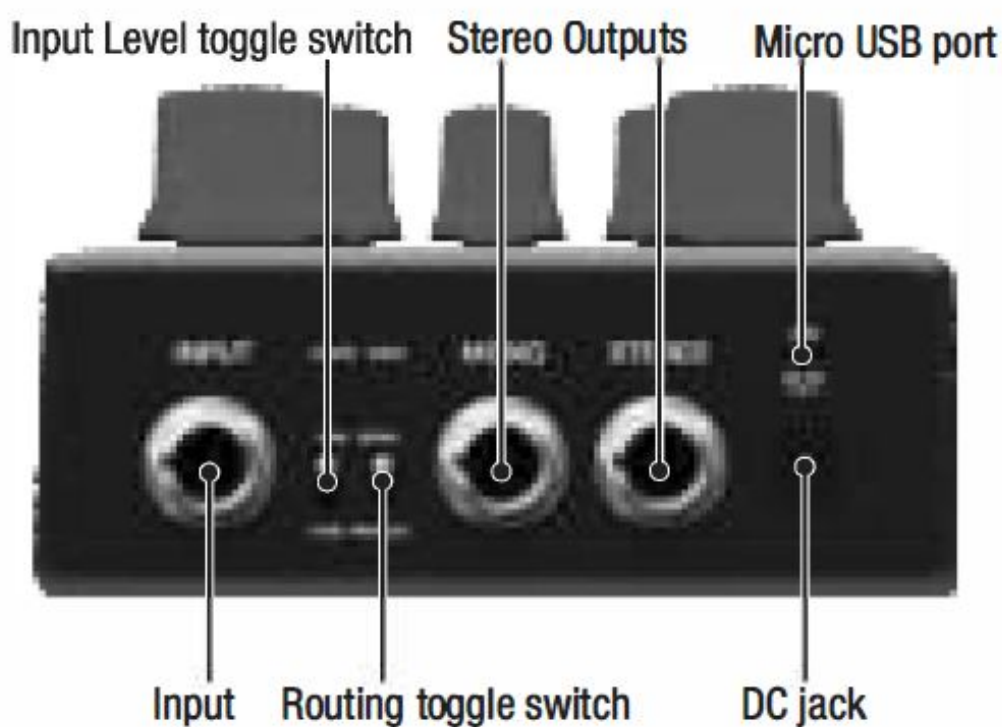

## Input



6.35 mm Insert jack.

## Input Level toggle switch

Adjusts the input headroom. If the input signal is too strong, switch to +4 dB to increase the headroom.

## Routing toggle switch

You can use the Delay and Reverb effect with parallel or serial connection. In serial mode, you can change the signal routing. Before plug-in the power cable, hold one of the effect footswitch which you want to come firstly, then plug-in the power cable.

## Stereo Outputs

D&R

SERIAL



PARALLEL

Use the right output for mono connection.

## Micro USB port

USB



Connect to PC for firmware update.

## DCjack



9V DC ⊕ ⊖

## Connection Method

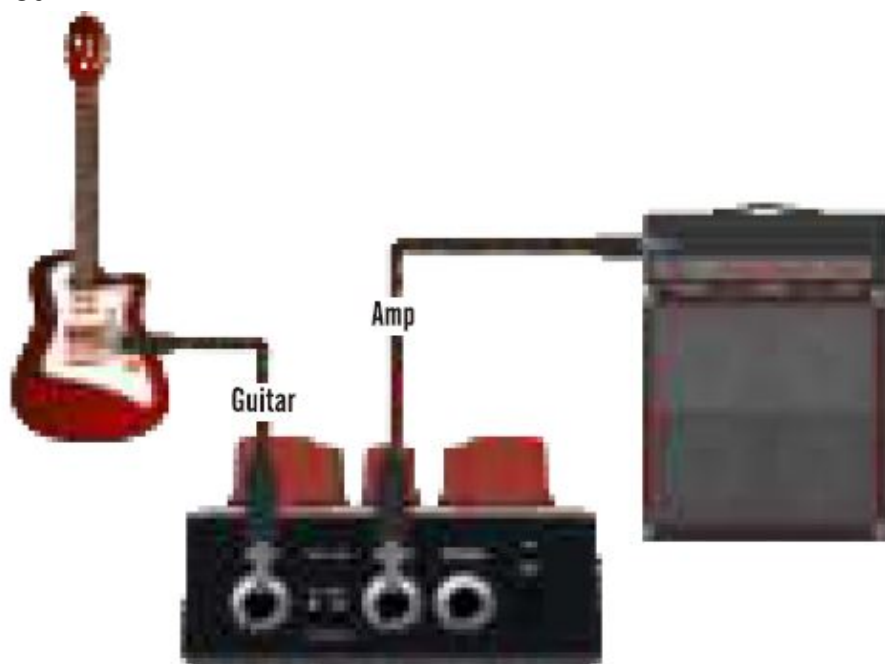

Atlantic's input jack can support stereo cable as insert (send/ return) method. Please see the blow two drawings:

## Using "Y" cable connection



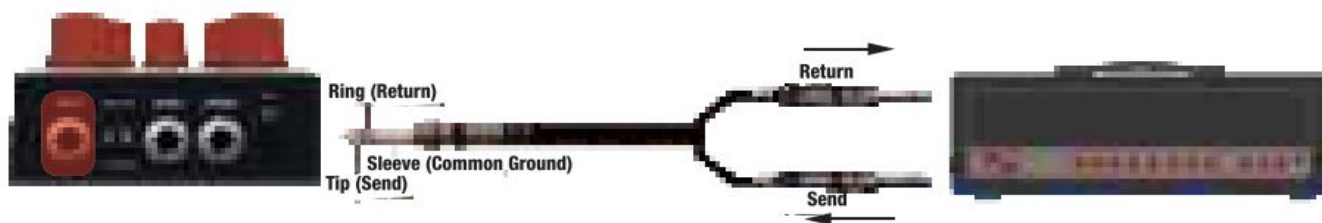

Using insert cable connection



Inside Routing

DEIAY first

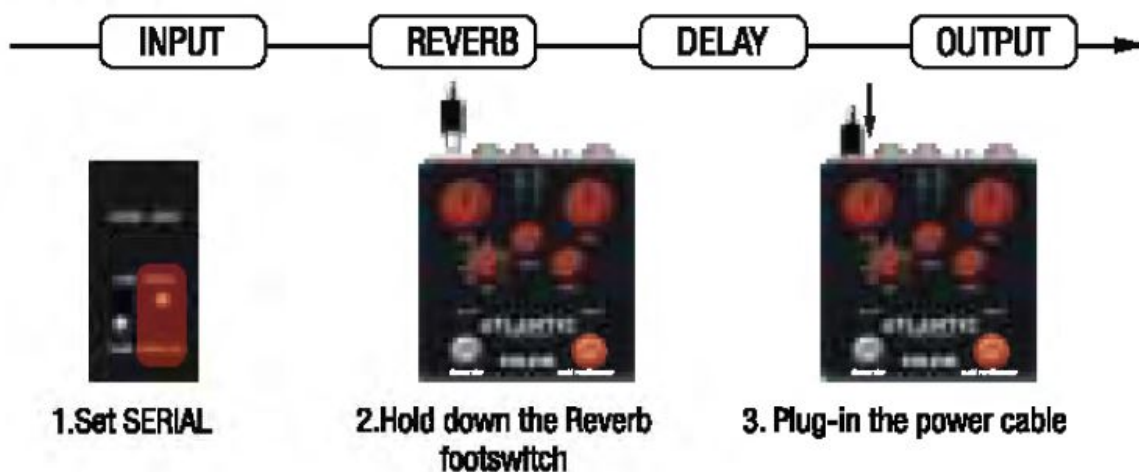

REVERB first

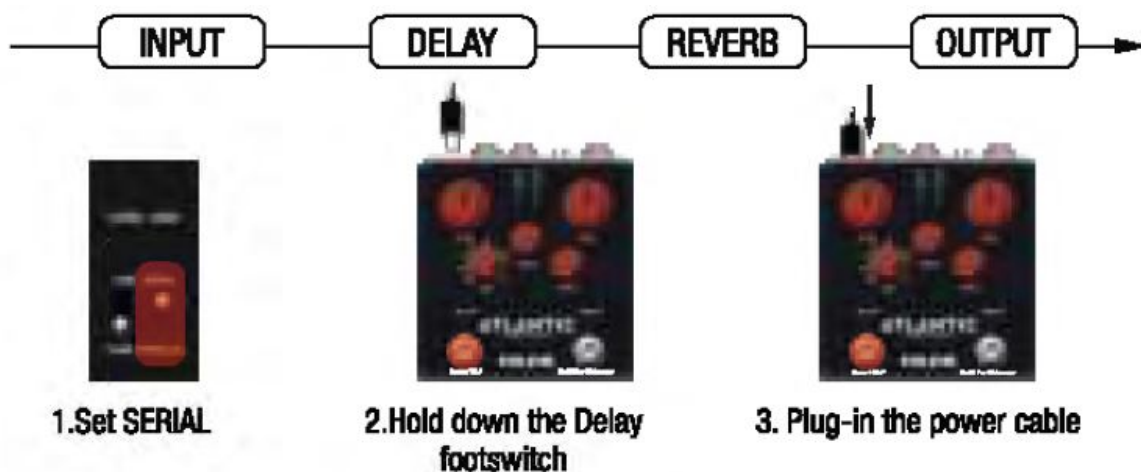

## Parallel Routing

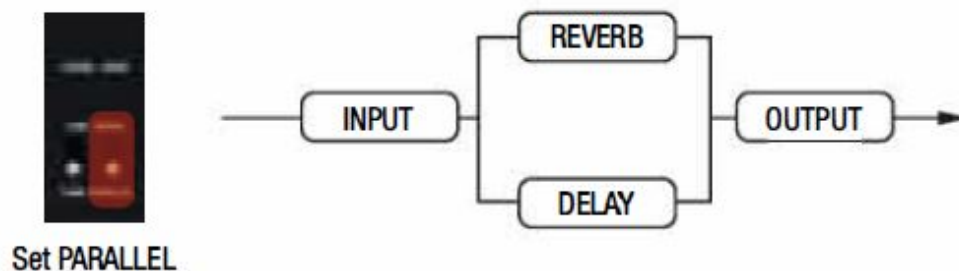

## Specification

- Sampling rate: 44.1 kHz
- A/D Converter: 32bit
- Signal Processing: 32bit
- Frequency Response: 20Hz-20kHz
- THD+N: -1 ODBC (A- Weighting)
- Dynamic Range: 102dB
- Input Impedance: 1 MO
- Output Impedance: 1 k
- Power: 9V DC (Negative tip, Optional ACD-006A adapter)
- Dimensions: 105mm(L) x 115mm(W) x 57mm(H)
- Weight: 420g

## Accessories

User manual, Warranty card

Specifications and features are subject to change without notice



[www.nuxefx.com](http://www.nuxefx.com)

Made in China

## Documents / Resources

	<a href="#">NUX NDR-5 Atlantic Delay and Reverb Pedal</a> [pdf] Owner's Manual NDR-5, Atlantic Delay and Reverb Pedal, NDR-5 Atlantic Delay and Reverb Pedal, Delay and Reverb Pedal, Reverb Pedal
--	---