

[Skip to content](#)

Manuals+

User Manuals Simplified.

NUX B-5RC Wireless System Instruction Manual

[Home](#) » [NUX](#) » NUX B-5RC Wireless System
Instruction Manual



WARNING

To reduce the risk of fire or electric shock, do not expose this appliance to rain or moisture.

CAUTION

This device complies with part 15 of the FCC Rules. Operation is subject to the following two conditions: (1) this device may not cause harmful interference, and (2) this device must accept any interference received, including interference that may cause undesired operation. Any changes or modifications not expressly approved by the party responsible for compliance could void the user's authority to operate the equipment.

NOTE: This equipment has been tested and found to comply with the limits for a Class B digital device, pursuant to Part 15 of the FCC Rules. These limits are designed to provide reasonable protection against harmful interference in a residential installation. This equipment generates, uses and can radiate radio frequency energy and, if not installed and used in accordance with the instructions, may cause harmful interference to radio communications. However, there is no guarantee that interference will not occur in a particular installation.

If this equipment does cause harmful interference to radio or television reception, which can be determined by turning the equipment off and on, the user is encouraged to try to correct the interference by one or more of the following measures:

- Reorient or relocate the receiving antenna.
- Increase the separation between the equipment and receiver.
- Connect the equipment into an outlet on a circuit different from that to which the receiver is connected.

-Consult the dealer or an experienced radio/TV technician for help.

To maintain compliance with FCC's RF exposure guidelines, this equipment should be installed and operated with a minimum distance between 20cm the radiator of your body: Use only the supplied antenna.



The lightning symbol within a triangle means, "Electrical caution!" It indicates the presence of information about operating voltage and potential risks of electrical shock.



The exclamation point within a triangle means, "Caution!" Please read the information next to all caution signs.

Contents [hide](#)

[1 System Overview](#)

[2 How to Operate](#)

[3 Function Introduction](#)

[4 Specifications](#)

[5 Documents / Resources](#)

[6 Related Posts](#)

System Overview

NUX B-5RC guitar wireless system with automatic setup, 2.4 GHz interference-free broadcasting frequency, and 24-bit 44.1 kHz high-quality audio transmitting. The signal latency is super low and less than 5ms. The operation range is 30 meters (90-feet). It's a super lightweight wireless, mini-compact design that fits all types* of electric guitar, electric-acoustic guitar, bass guitar, and ukulele.

Tested on 25 varieties of different instruments, body types, and brands. The user-friendly matching system makes it easier to use, just turn ON both wireless units and it will be paired within a couple of seconds. Each wireless set has a unique pairing algorithm, it automatically detects each other and configures their own IDs. The signal never interferes with any other wireless including the WIFI signal.

*Recommended: Please stay 2 meters (6 feet) away from the WIFI router for the best performance.

NUX B-5RC comes with a powerful case to keep the wireless units charged. When the power case is fully charged, it can re-charge the wireless units' battery 2-3 times.

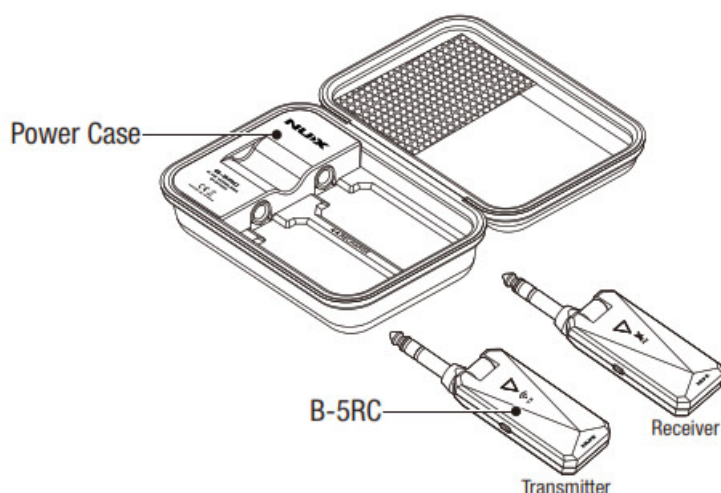

How to Operate

Matching a set of B-5RC is very easy as it is pre-paired from the factory. Just turn on the transmitter and the receiver; they should detect each other rapidly and automatically choose the best channel to establish a stable connection.

- Push and hold the power button to turn on the transmitter and the receiver.
- Before the connection is established, the LED indicator indicates the battery level. Refer to the chart below for details.
- Green – Battery 100%≥Battery≥75%

- Yellow – Battery 75% Battery $\geq 50\%$
- Red – Battery 50% Battery $\geq 25\%$
- Red blinking for 10 times – Battery $< 25\%$ and the unit will turn off automatically to protect battery life.

▼ LED  (100% \geq Battery $\geq 75\%$)

▼ LED  (75% $>$ Battery $\geq 50\%$)

▼ LED  (50% $>$ Battery $\geq 25\%$)

▼ LED  Battery ($< 25\%$)

A set of fully charged B-5RC can work for 4 hours. It requires 2.5 hours to get the batteries fully charged. The LED indicator lights in red during charging and the LED Indicator turns off when fully charged.

Once the connection is established, the LED indicator on both the transmitter and the receiver lights in green. In case of a failed connection, both LEDs flash in red, and you will need to establish the connection manually. (Ref to Re-match ID & Pairing Manually for details.)

Connect the transmitter to the output of your instrument, and connect the receiver to the input of the next device in your signal flow or an output device, i.e. amplifier, guitar pedal, or mixer.

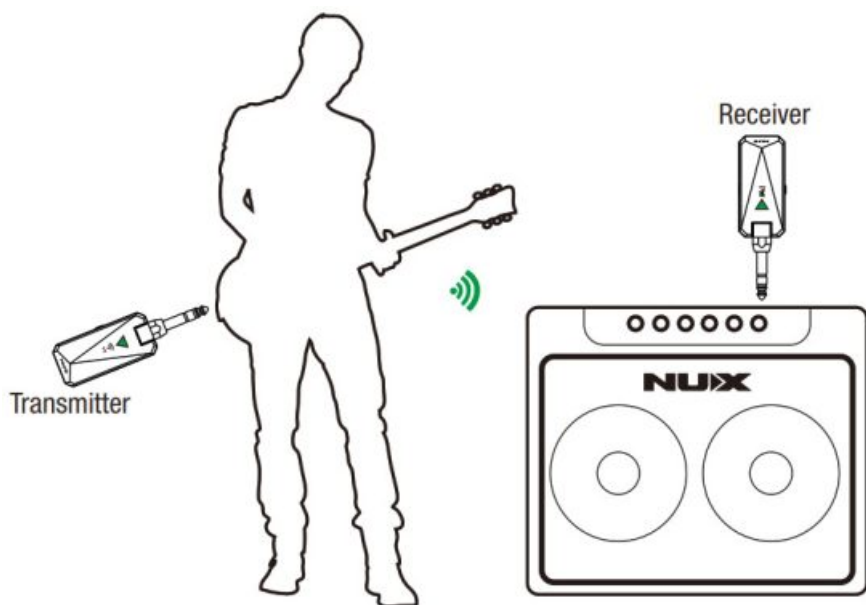

Plug the wireless system back into the power case for storage or recharge by the power case. Do remember to press the charging button on the power case to activate the charging function. The status LEDs on the power case indicates the battery level of the case. A fully charged power case can recharge the wireless system 2-3 times.

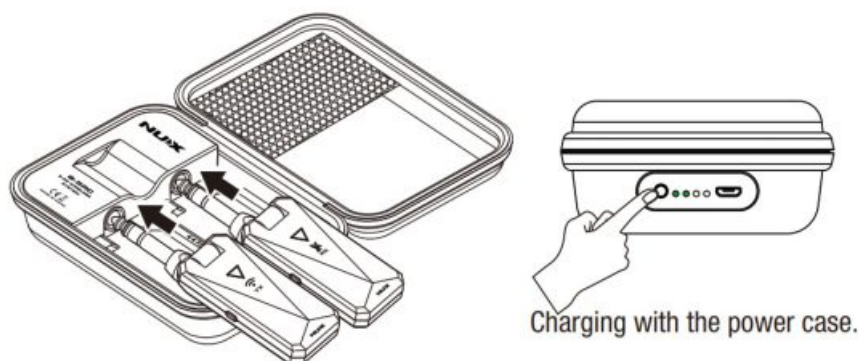

To recharge the power case, please make sure that your power adaptor has an output of 5V and 1A(or above)

You can also charge the wireless system using the included micro-b USB Y cable. Please note that B-5RC can not work during the charging process.

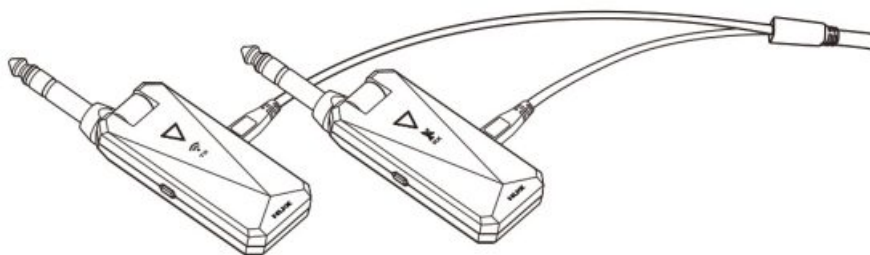

WARNING

The B-5RC power case can ONLY charge the NUX B-5RC. DO NOT plug in any other wireless systems to the power case.

Re-Match ID & Pairing Manually

The IDs of the transmitter and the receiver of each B-5RC set have been matched in the factory. For any reason you want to re-match IDs or pair a receiver with a transmitter from different sets, follow these steps:

- Turn off the transmitter and the receiver.
- Press and hold their power buttons simultaneously for 8 seconds to enter ID match status.
- If it succeeds, the LEDs on both sides turn Green.

NUX offers various of 2.4GHz wireless systems, you can use up to 6 systems simultaneously in one space. Please avoid using other wireless systems together with NUX one, or there may be noise or interference issues.

Mute function

Under working status, press the power button of the transmitter to mute the sound, and the receiver LED will turn RED. Press again to have sound again.

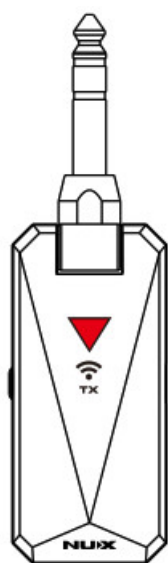

Mute

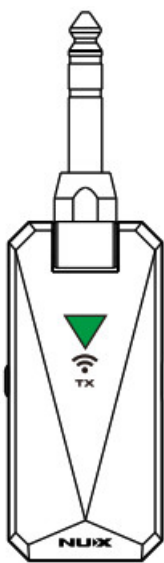

Working

Function Introduction

Cable tone function

Under working status, press the power button of the receiver to activate the Cabletone function, and the LED of the receiver will turn Orange. The Cabletone function simulates the capacitor effect of a 6.4m (21 feet) cable.

Audio Precision

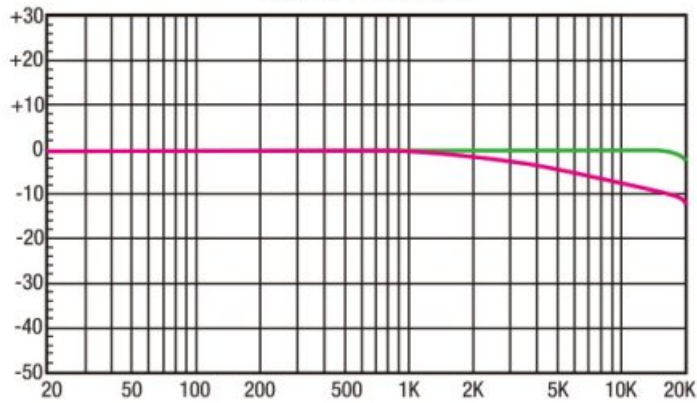

Sweep	Trace	Color	Line Style	Thick	Data	Axis	Comment
3	1	Green	Solid	3	Anlr.Ampl	Left	Regular
4	1	Magents	Solid	3	Anlr.Ampl	Left	Cabletone

Auto-Off function

If there is no signal for 10 minutes, the transmitter will turn off automatically to save battery power. Since the transmitter is turned off, the receiver will turn off after 10 more minutes.

Tips for Active Pickups

- If you are using active pickups, in order to reduce noise, it is suggested to keep more is the distance between

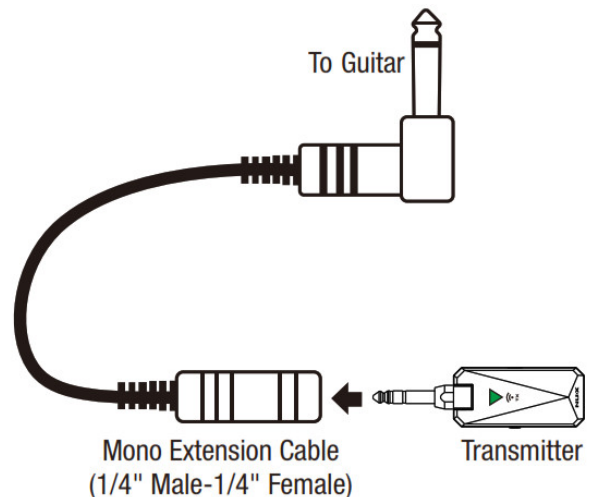

the transmitter and the internal circuits of your guitar or bass.

- Active circuits generally use TRS output jacks, but different guitars can have different wirings to the ring and sleeve. Therefore, some guitars loaded with active pickups may not work with this type of transmitter. If this problem occurs, try to use a female to the male adaptor to convert the stereo plug of the transmitter to a mono plug, and then plug it into the guitar. See the picture below:

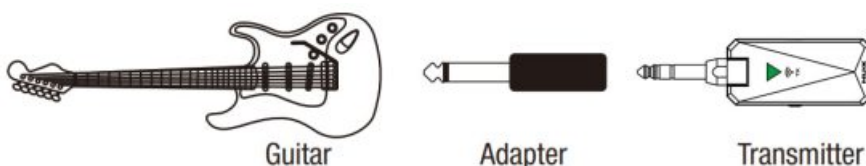

Specifications

- 2.4GHz operating frequency
- 24bit 44.1kHz
- Latency: <5ms
- Frequency response: 20Hz – 20kHz
- THD+ Noise < 0.05% @1kHz
- TX/RX Battery Capacity: 500mAh / 3.7V

- TX/RX Battery run time: 4hrs
- Power Case Battery Capacity: 4000mAh / 3.7V
- Dimensions
 - Power Case: 132mm(L)x93mm(W)x50mm(H)
 - Transmitter/Receiver: 108mm(L)x30mm(W)x21mm(H)
- Weight
 - Power Case: 196g
 - Transmitter/Receiver: 34g each

Accessories

- Micro-USB Y-cable x 1 Manual

*Specifications and appearance are subject to change without notice.



FCC ID:2A0AA-B-5RC © 2019 Cherub Technology-All rights reserved. No part of this publication may be reproduced in any form without prior written permission of Cherub Technology.

www.nuxefx.com

Made in China

Documents / Resources



[NUX B-5RC Wireless System](#) [pdf] Instruction Manual
B-5RC Wireless System, B-5RC, Wireless System

[Manuals+](#),

- [home](#)
- [privacy](#)