



NUVVE FleetBox App User Manual

[Home](#) » [NUVVE](#) » NUVVE FleetBox App User Manual 



Nuvve FleetBox App
Intelligent Electric Vehicle Monitoring and Control

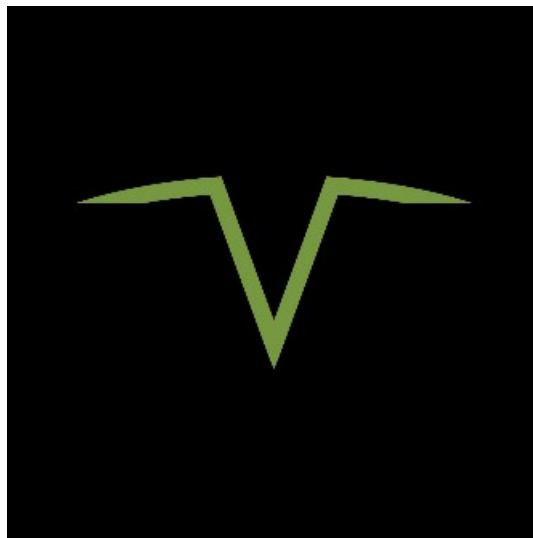

Contents

- 1 FleetBox App
- 2 Download
- 3 User Account Sign Up
- 4 Login
- 5 Password Recovery.
- 6 Demo Mode
- 7 Home Screen
- 8 Trip Scheduling
- 9 Upcoming Trip Schedule
- 10 Emergency Charge
- 11 Settings
- 12 Support
- 13 Documents / Resources
 - 13.1 References
- 14 Related Posts

FleetBox App

Remotely monitor and manage your electric vehicle (EV) fleets in real-time with the Nuvve FleetBox App. Users can be assigned one of two types of roles, Fleet Manager or EV Driver, for role-based access that will improve the operational efficiency of your fleet. Users can view connectivity status, battery charge level, and available range for their EVs. Trip scheduling and emergency charging features provide users with peace of mind by ensuring their EVs get charged to their preferred level at the required times.

Note: The Nuvve FleetBox App is only accessible for customers under a Nuvve service contract and cannot be used independently.

About Nuvve Holding Corp.:

Nuvve Holding Corp. (Nasdaq: NVVE) is leading the electrification of the planet, beginning with transportation, through its intelligent energy platform. Combining the world's most advanced vehicle-to-grid (V2G) technology and an ecosystem of electrification partners, Nuvve dynamically manages power among electric vehicle (EV) batteries and the grid to deliver new value to EV owners, accelerate the adoption of EVs, and support the world's transition to clean energy. By transforming EVs into mobile energy storage assets and networking battery capacity to support shifting energy needs, Nuvve is making the grid more resilient, enhancing sustainable transportation, and supporting energy equity in an electrified world. Since its founding in 2010, Nuvve has successfully deployed V2G on five continents and offers turnkey electrification solutions for fleets of all types. Nuvve is headquartered in San Diego, California, and can be found online at nuvve.com.

Download

- Android users can download the app by searching for Nuvve FleetBox on the Google Play Store.
- Apple iOS users can download the app by searching for Nuvve FleetBox on the App Store.

User Account Sign Up

Refer to the following instructions to sign-up for your Nuvve FleetBox App account.

1. Nuvve will contact you to collect your basic information, including your email address.
2. You will receive an email with instructions to create an account with a temporary password. This will be sent to the email address you provided in Step 1.

3. Use the temporary password the first time you log in.
4. Open the downloaded Nuvve FleetBox App and follow the login instructions in the next section.

Login

Log in to your Nuvve FleetBox App using the following steps.

1. Your username will be the email address you provided to Nuvve.
2. First-time users must enter the temporary password.
3. Once you have entered your credentials, select the login button.
4. First-time users will be required to create a new password.
5. Create a new password of your choice. Password must have at least eight characters and contain one uppercase, one lowercase, one number, and one special character.
6. Select Change Password.
7. Please use your new password for subsequent logins.

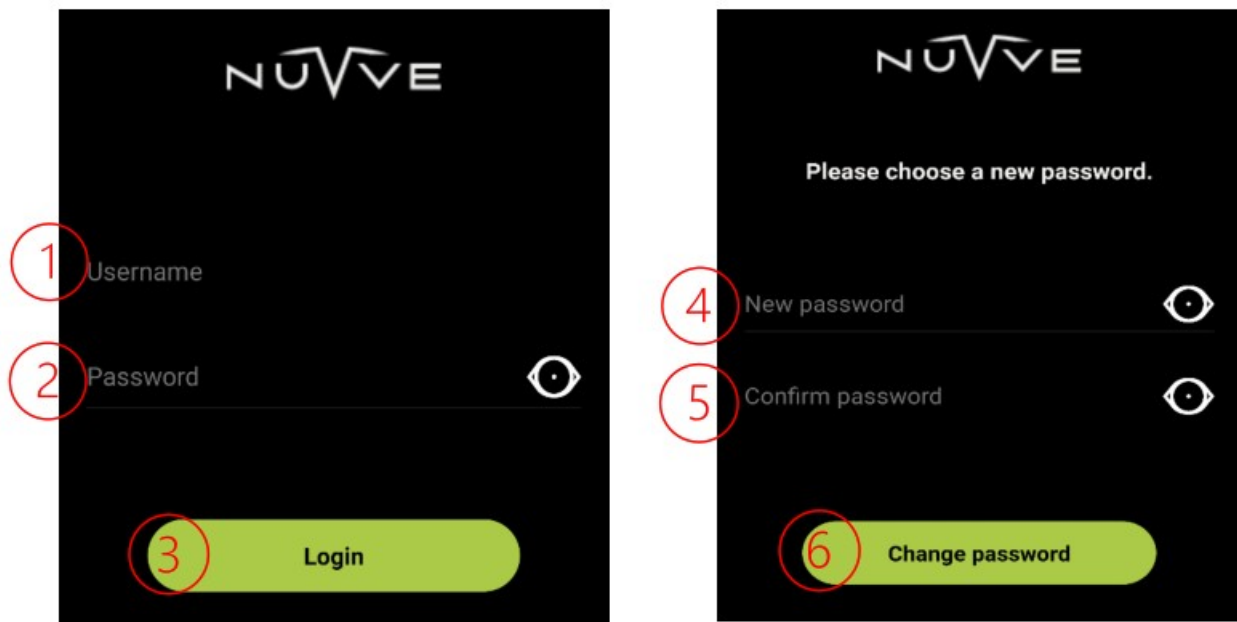

Password Recovery.

Refer to the following instructions to reset your password if needed.

1. Select the Forgot Password button on the login screen.
2. Enter the email address which you provided to Nuvve to create your account.
3. Select Recover password.
4. You will receive a verification code to your email address. Check your spam folder if you don't receive the verification code. If the issue persists, kindly contact Nuvve support (support@nuvve.com) with the FleetBox App Password Reset as the subject line.
5. Enter the verification code.
6. Enter a new password.
7. Select Change password.

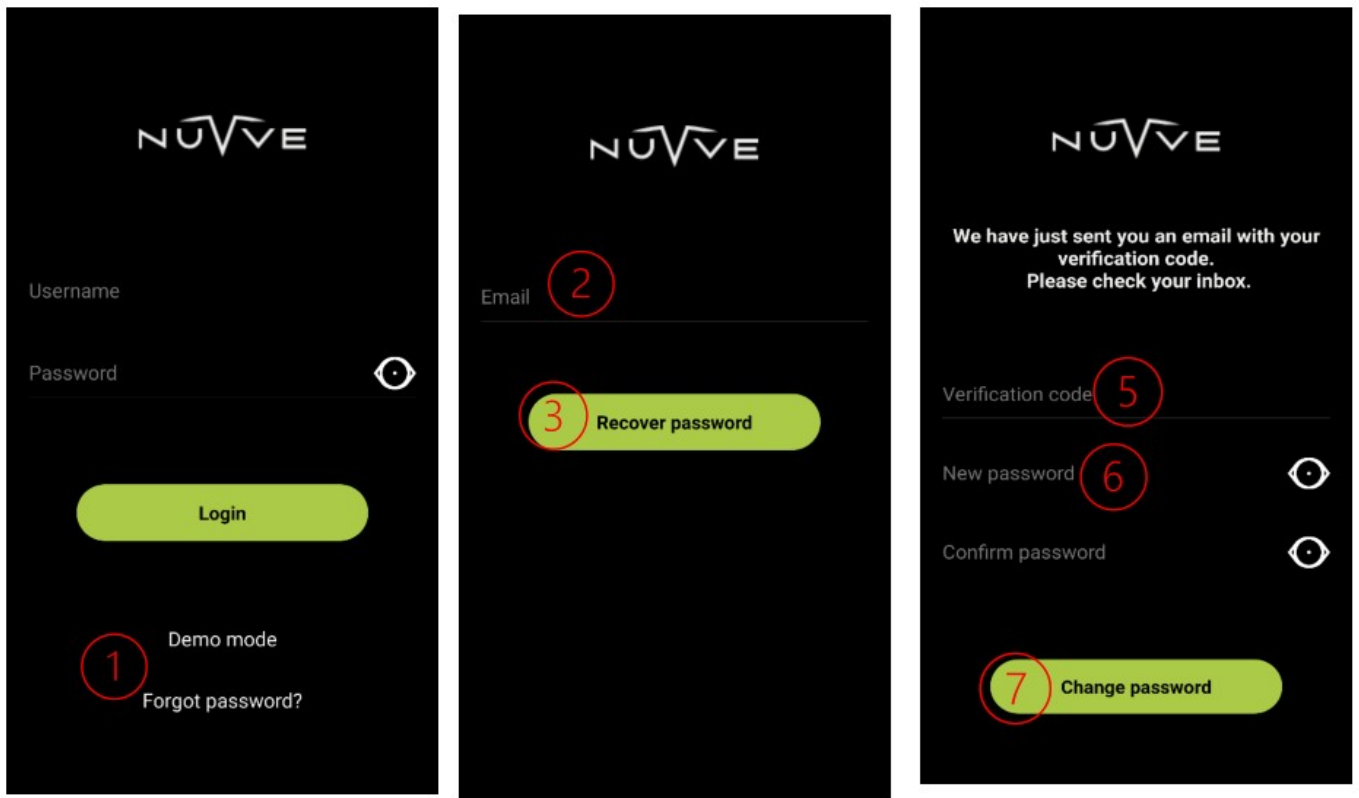

Demo Mode

The Nuvve FleetBox App offers a demo mode so you can familiarize yourself with the mobile app's functionality. The actions in demo mode will not impact the original account information and EV functions.

Refer to the following instructions to enter demo mode.

1. Select Demo mode from the Login screen.
2. A warning message prompt will appear to confirm your selection.
3. Select Ok if you want to continue.
4. You can view the dummy data and get acquainted with the app functionalities.

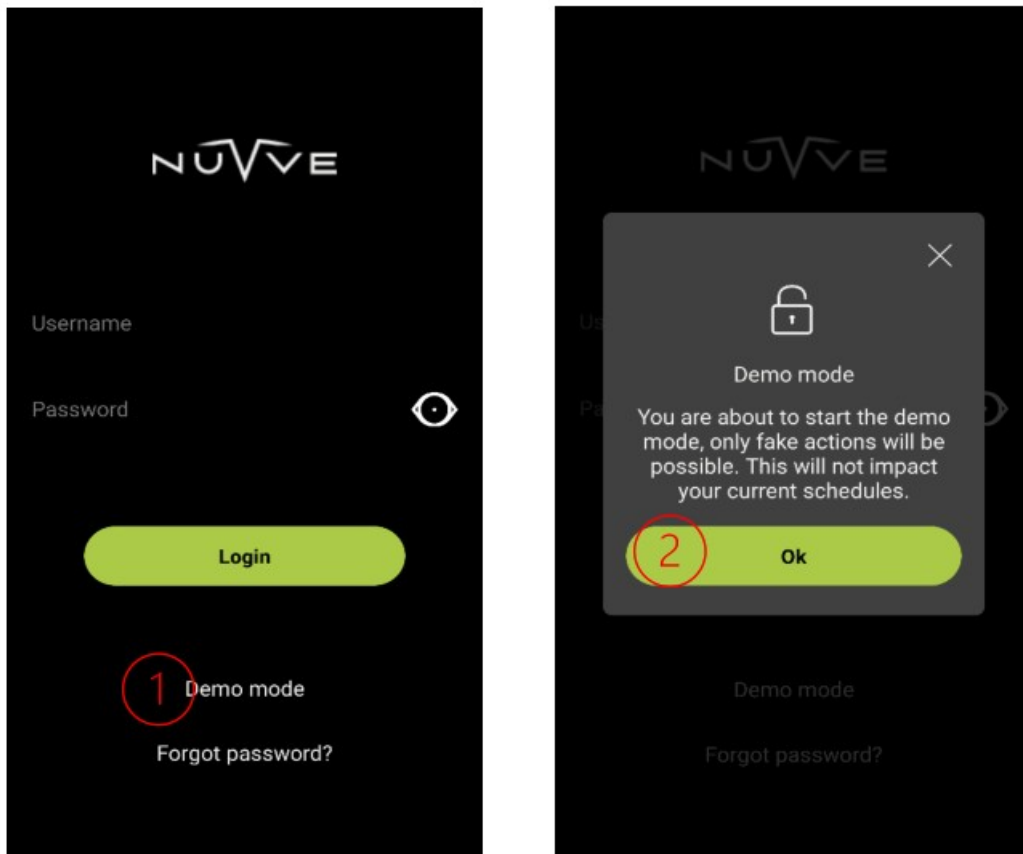

Home Screen

Fleet managers can view their EV fleet information on the home screen. Refer to the following instructions for navigating within the home screen.

1. You can easily identify your EV based on the Nuvve-assigned vehicle names. The Nuvve team will capture your preference for EV names during the initial information gathering process.
2. The battery icon will show you the connectivity status of your EV.
3. If the EV is not connected, you will see the status as Unplugged.
4. If the EV is connected, you can see the battery charge level along with the approximate available range.
5. If the battery reaches it's fully charged state, the battery icon will turn green.

Note: Pull-to-refresh from top of the home screen to get the most updated information.

6. You must select an EV to perform trip scheduling and emergency charge functions. Select by clicking on the vehicle of interest.
7. Select the Settings button (top right) to change range measurement units, view the privacy policy and tutorials, and to sign out of the application.

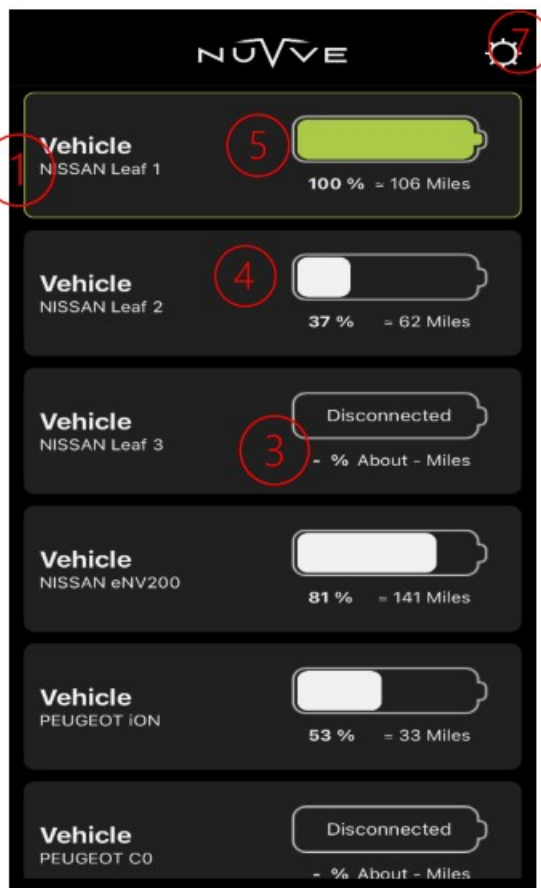

Trip Scheduling

The trip scheduling feature ensures that your EV has sufficient charge to meet your trip requirements when needed. You can create a new schedule using the following steps.

Note: Access to the trip scheduling feature requires special permission. Permissions are granted based on your company policies. Kindly contact Nuvve support (support@nuvve.com) if you have further questions.

1. Select the EV for which you want to create a trip schedule by clicking on EV name.
2. Select New schedule.
3. You can create a one-time or a recurring trip schedule.

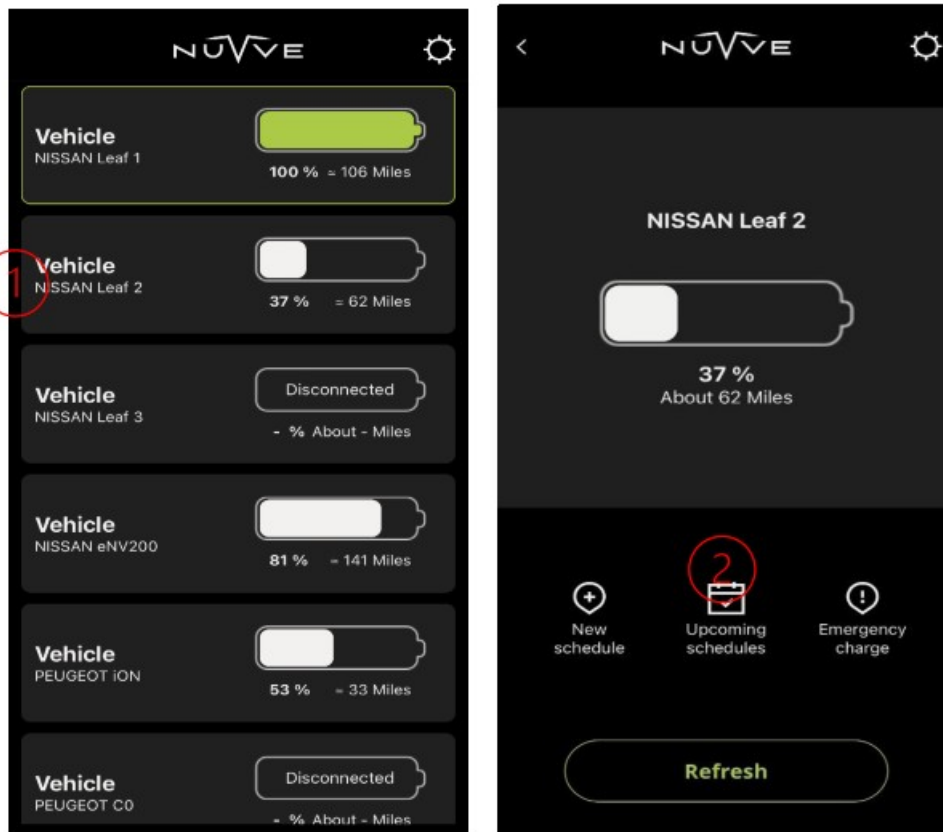

Follow the instructions below to create a one-time schedule.

1. To create a one-time schedule, slide the One-time / Recurring toggle button to the left.
2. Enter the trip start date and time by clicking on the Select a date text under From.
3. Enter the trip end date and time by clicking on the Select a date text under Until.

Note: One-time trip end date and time is a requirement.

4. Enter the expected minimum state of charge by using the slider under Expected minimum state of charge.

Note: The EV will not charge until the actual battery charge level is less than the expected minimum state of charge set by you.

5. Save the trip.

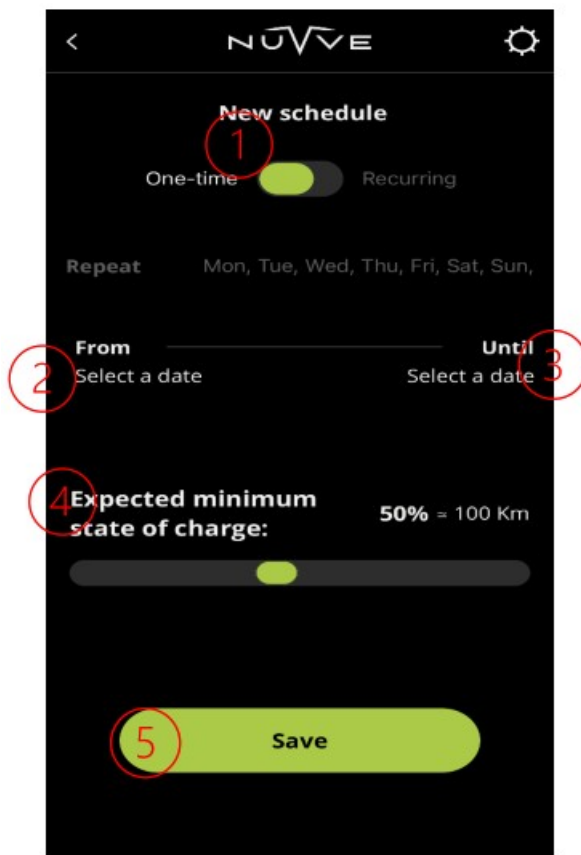

Follow the instructions below to create a recurring schedule.

1. To create a recurring schedule, slide the One-time / Recurring toggle button to the right.
2. Select repeat to enter days of the week.
3. Enter days of the week.
4. Enter the trip start time by clicking on the Select an hour text under From.
5. Enter the trip end time by clicking on the Select an hour text under Until.

Note: Recurring trip end time is a requirement.

6. Enter the expected minimum state of charge by using the slider under Expected minimum state of charge.

Note: The EV will not charge until the actual battery charge level is less than the set expected minimum state of charge set by you.

7. Save the trip.

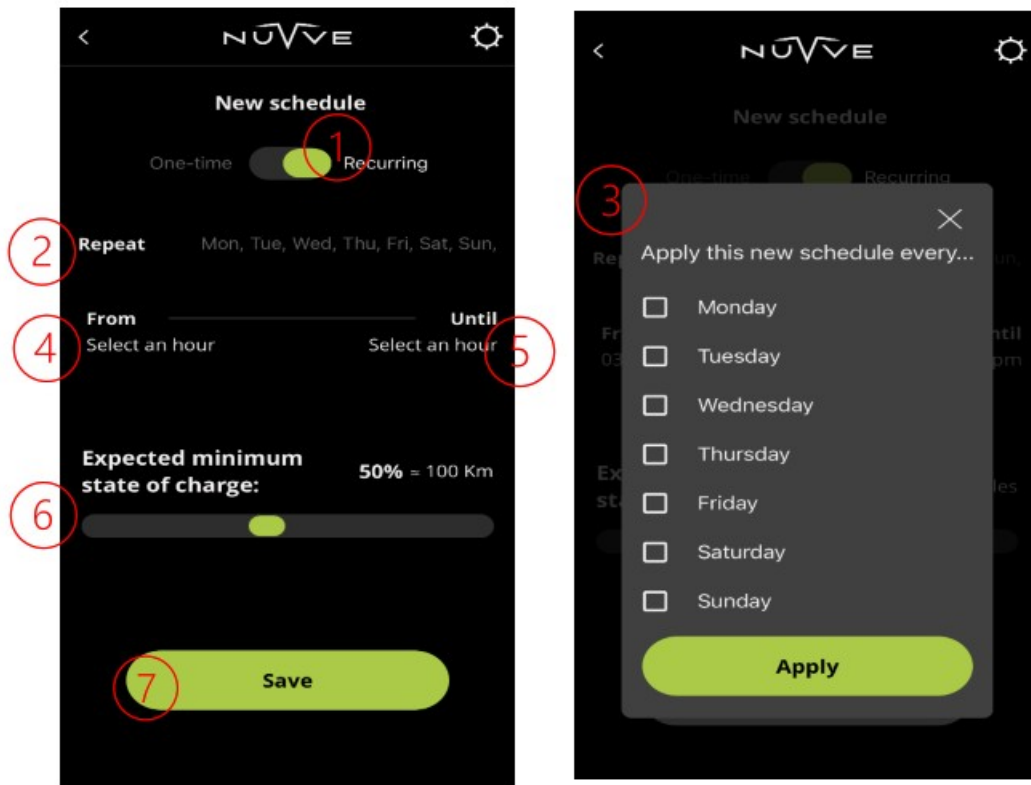

If you have multiple EVs in your fleet, you can duplicate a schedule and apply it to other vehicles in the fleet. Follow the instructions below for copying a one-time or recurring schedule.

1. Create a new one-time or recurring schedule.
2. A list of all other EV will show up once you hit save.
3. Apply the created schedule to other EV in the fleet clicking on the check-box next to the EVs and selecting Apply.

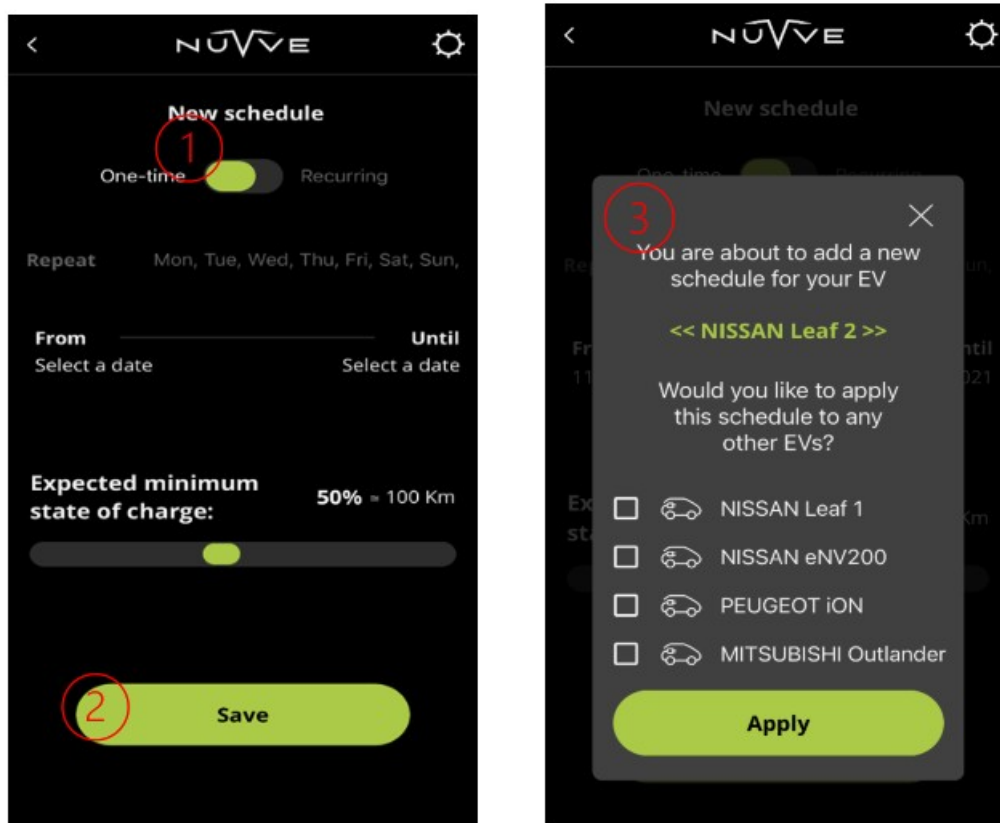

Upcoming Trip Schedule

You can view your scheduled trips using the upcoming trip schedule feature. Follow the instructions below.

1. Select the EV for which you want to view the schedule.
2. Select Upcoming schedules.
3. You can view one-time or recurring schedules created for the selected EV.

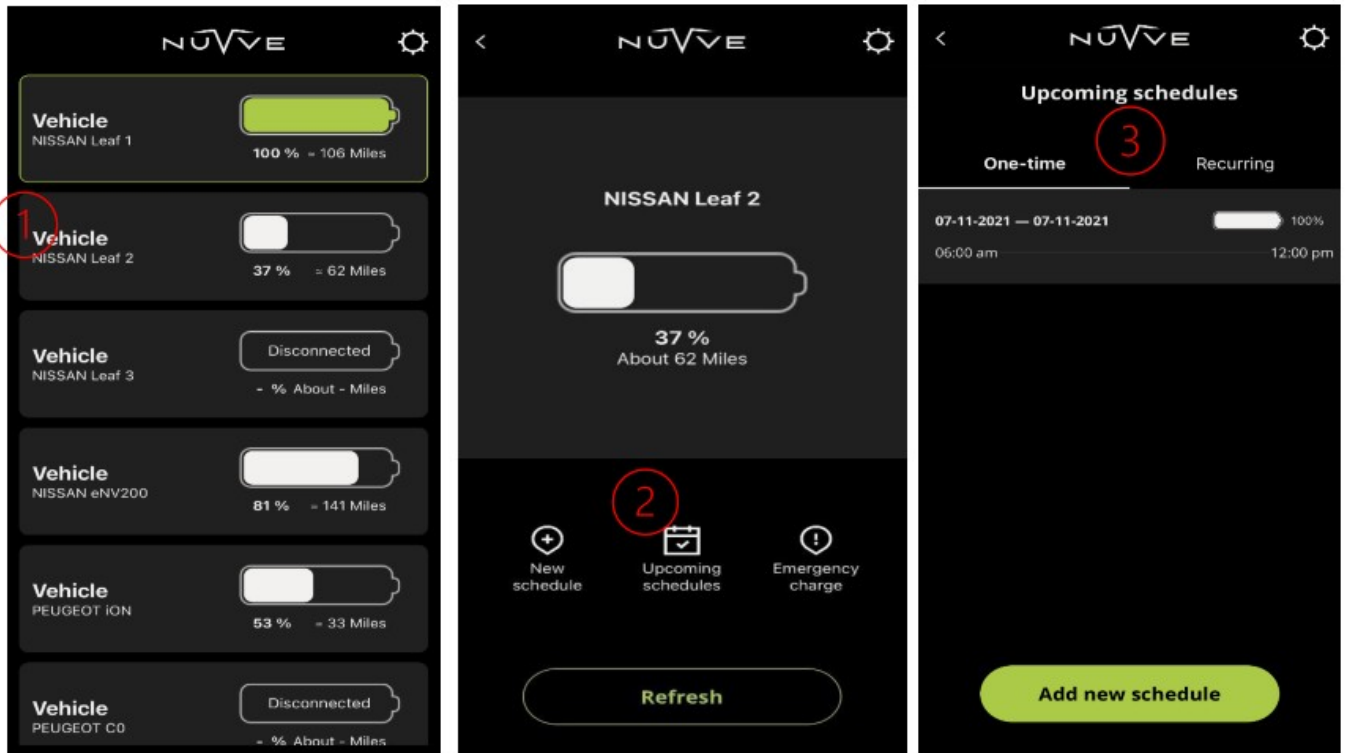

You can also directly add a new one-time or recurring schedule from the upcoming schedules screen by following the instructions below.

1. In the upcoming schedule feature, select the type of trip schedule (One-time or Recurring) that you want to add.
2. Select Add new schedule.
3. Follow the trip schedule creation process defined for one-time and recurring schedules in the previous trip scheduling section.

Note: Access to the trip scheduling feature requires special permission. Permissions are granted based on your company policies. Kindly contact Nuvve support (support@nuvve.com) if you have further questions.

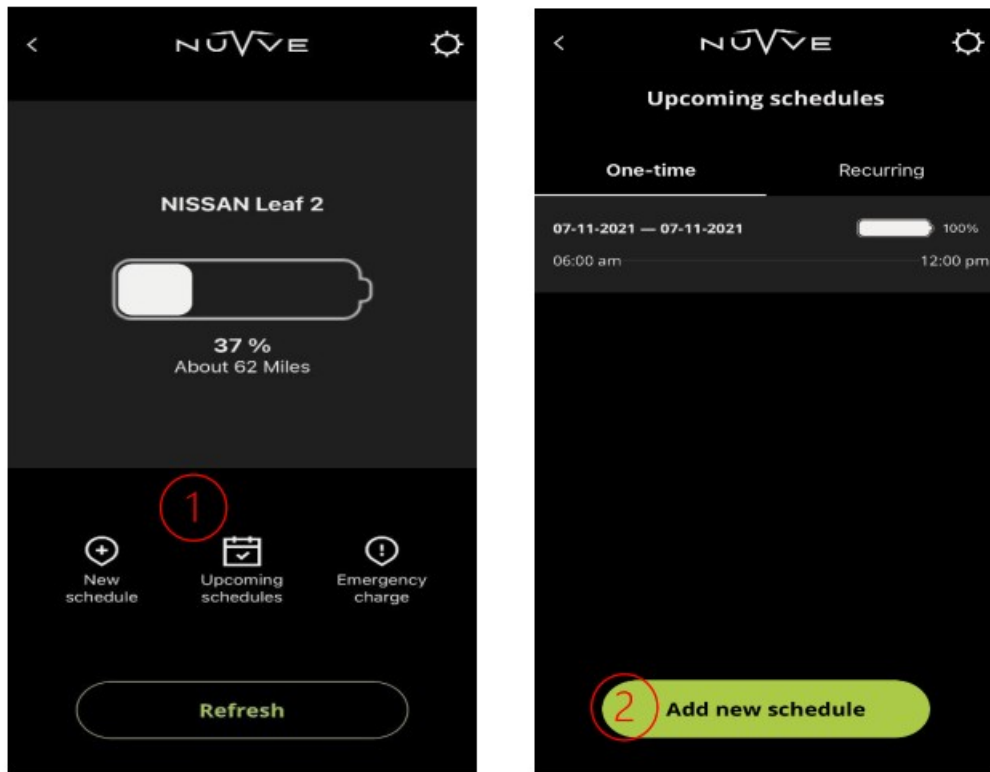

Emergency Charge

The Emergency Charge feature will charge your EV at the maximum allowed power level, ensuring the EV will be charged with sufficient energy in time for the trip. Emergency charging will continue until the battery is fully charged unless you manually disable the feature.

Note: Access to the emergency charging feature requires special permission. Permissions are granted based on your company's policy. Please contact Nuvve support (support@nuvve.com) if you have further questions.

Follow the instructions below to enable/disable emergency charging from the home screen.

1. On the home screen, swipe from right-to-left on any connected EV.
2. Select Emergency charge.
3. The Battery bar will turn red, and the status will turn to Emergency charging.
4. To disable emergency charge, swipe from right-to-left on the EV.
5. Select Stop emergency charge.

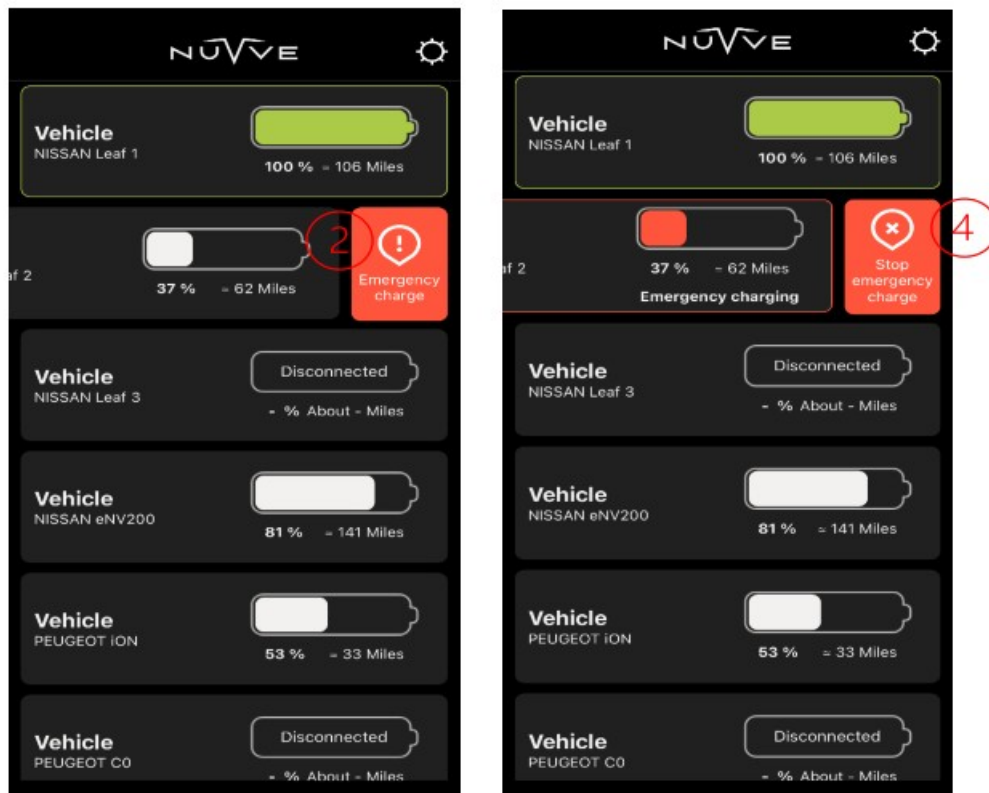

You can enable/disable emergency charge from the EV screen. Follow the instructions below.

1. Select the EV for which you want to enable/disable the emergency charge.
2. Select Emergency charge.
3. The Battery bar will turn red, and the status will turn to Emergency charging.
4. To disable emergency charge, select Stop emergency charge.

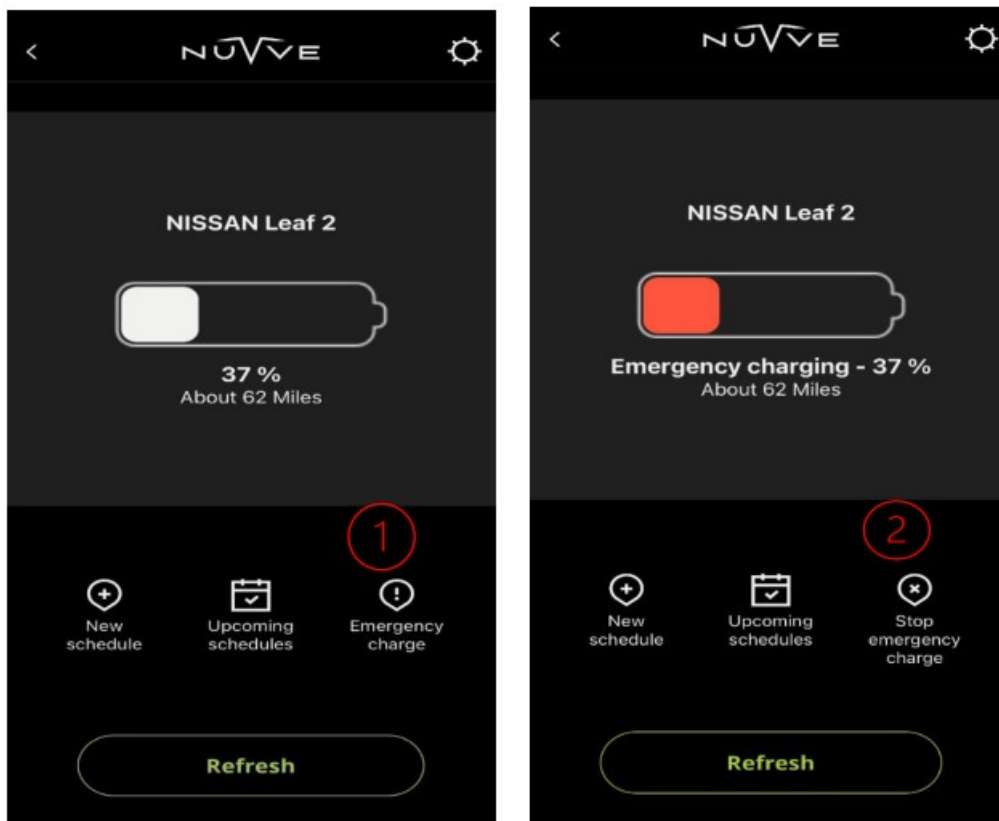

Settings

Users can set their preferred range measurement unit, view privacy policy, and view tutorials in the settings section.

Follow the instructions below to navigate within the settings screen.

1. Select the settings button from the upper right corner on the home screen.
2. Select your preferred range measurement unit by clicking the Units feature.
3. Click on Privacy policy to view the Nuvve privacy policy.
4. Click on Overview to view a tutorial on this app.
5. Click on Adding schedules to view tutorial on adding new schedules.
6. Click on Log out to Sign out of the app.

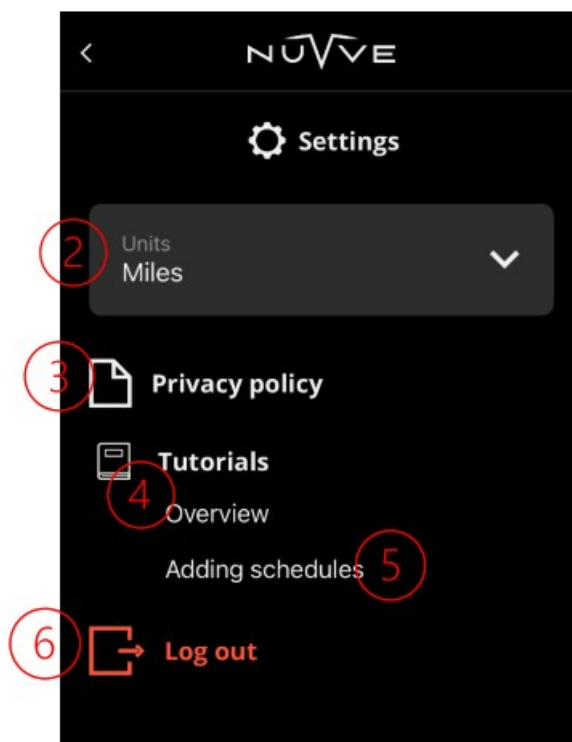

Support



We want to hear from you! Refer to the link below to request support or suggest improvements.

<https://nuvveco.atlassian.net/servicedesk/customer/portal/11>

You can also reach out to us at support@nuvve.com.

v1.0 | Proprietary & Confidential

Documents / Resources

	<p>NUVVE FleetBox App [pdf] User Manual FleetBox App, FleetBox, App</p>
--	--

References

- [🏠 Home - NUVVE Holding Corp](#)
- [🏠 Home - NUVVE Holding Corp](#)
- [🏠 Home - NUVVE Holding Corp](#)
- [🌐 Jira Service Management](#)