



nutriChef NCFPBLU Multifunction Food Processor User Manual

[Home](#) » [nutriChef](#) » nutriChef NCFPBLU Multifunction Food Processor User Manual 



**NCFPBLU
Multifunction Food Processor
Ultra Quiet Powerful Motor,
Includes 6 Attachment Blades,
Up to 2L Capacity (Blue)
User Manual**



Read This Instruction Manual Carefully Before Using This Equipment.
FOR HOUSEHOLD USE ONLY!

Contents

- [1 IMPORTANT SAFEGUARDS](#)
- [2 PRODUCT CONFIGURATION](#)
- [3 FOR MASHER & SLICER & SHREDDER](#)
- [4 FOR CHOPPER, FLOUR & EMULSION](#)
- [5 FOR CITRUS JUICER](#)
- [6 CAUTION](#)
- [7 TROUBLESHOOTING](#)
- [8 ENVIRONMENT](#)
- [9 Documents / Resources](#)
 - [9.1 References](#)
- [10 Related Posts](#)

IMPORTANT SAFEGUARDS

1. This appliance is not intended for use by persons with reduced physical sensory or mental capabilities, or lack of experience and knowledge unless they have been given supervision or instructions concerning use of the appliance in a safe way and understand the hazards involved.
2. Blades are sharp. Care should be taken when handling the sharp cutting blades, emptying the bowl and during cleaning.
3. Unplug from the outlet when not in use, before putting on or taking off parts, and before cleaning.

4. Do not operate any appliance with a damaged cord or plug, or after the appliance has been dropped or damaged in any way. Return the appliance to the nearest authorized service facility for examination, repair, or electrical or mechanical adjustment.
5. To protect against the risk of electrical shock, do not put a cord, plug, base, or motor in water or other liquid.
6. Make sure the motor has completely stopped before removing the cover.
7. Make sure that the cover and feed tube are securely locked in a place before operating the food processor.
8. The unauthorized use may cause fire, electrical shock or damage to your food processor.
9. Indoor use only, do not expose to rain, snow or other bad environments.
10. Please put it beyond the reach of children.
11. If the supply cord is damaged, it must be replaced by the manufacturer, its service agent or similarly qualified persons in order to avoid a hazard.
12. Do not use the machine continuously for more than 1 minute.
13. If the motor stop when in normal use, it means the motor protection has worked, please turn off the switch and wait about 20-30minutes, then to use it again.
14. Always unplug from outlet when not in use, before removing food, and before cleaning.
15. Care shall be taken when handling the sharp cutting blades, emptying the bowl, and during the test.

PRODUCT CONFIGURATION



OPERATING GUIDE

Function	Food	Time	Processing produce
Masher	Nuts	1 min	Cut the nuts into small pieces
Slicer & Shredder	Vegetables or any fresh fruits	1 min	Choose the correct disc blades
Chopper	Meat (350g)	30 seconds	Cut the meat into small cubes
Flour	300g Flour with water	1min	Make sure there's enough water
Emulsion	Egg or any cream	30 seconds	Pour some water
Citrus Juicer	Citrus and orange	min	Cut the round one into half

FOR MASHER & SLICER & SHREDDER

These accessories are used for mashing nuts, slicing and shredding carrots, potatoes, tomatoes, and any vegetables and fruit.

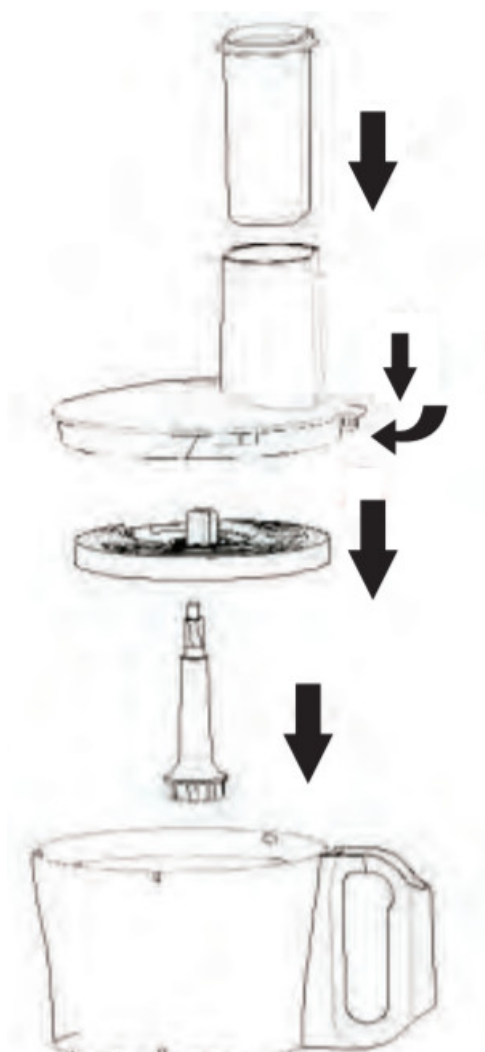

1. Put the spindle into a bowl
2. Put the blade disc in the spindle in a bowl and fix it well
3. Cover it in space and turn it until locked and in the same level.
4. Install the bowl to the unit base, turn it by clockwise and lock it.
5. Plug-in power, turn on the switch and put the food into the feed hole. Use the food pusher to press into.

Please cut the food into small pieces if it is very big 6. When work is finished, turn off the switch and take off the plug. Open the cover and take out the blade disc, then you can get the food.

6. Masher, Slicer, shredder have the same operation.

Note: Slicer and Shredder use the same blade disc: one side for the slicer, opposite side for the shredder.

FOR CHOPPER, FLOUR & EMULSION

1. Fix the chopper blade into bowl.

Note: Sharp blade, do not touch the edge of the blade.

2. Cut the meat into suitable pieces and put into the bowl, and cover it.

Note: Please take off the bone from the meat.

3. Install the bowl on the unit base, turn on by clockwise and lock it.

4. Plug-in power and turn on the switch.

Note: If the food makes the machine shake, please stop the machine and open the cover, and separate the food equality. This bowl is not used for liquid food.

5. When work is finished, turn off the switch, and take off the plug, then take out the bowl from the base, open the cover and take out the blade. You can get the meat soon.

6. Chopper, Flour, Emulsor have the same operation.

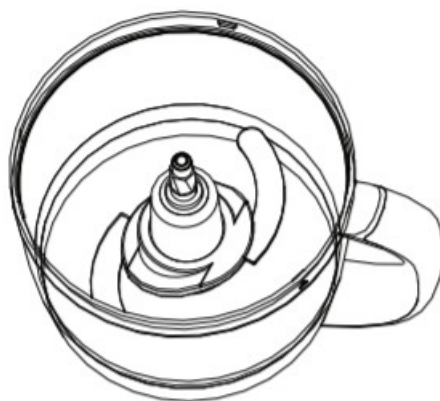

FOR CITRUS JUICER

Note: Align and lock it one by one as illustrated

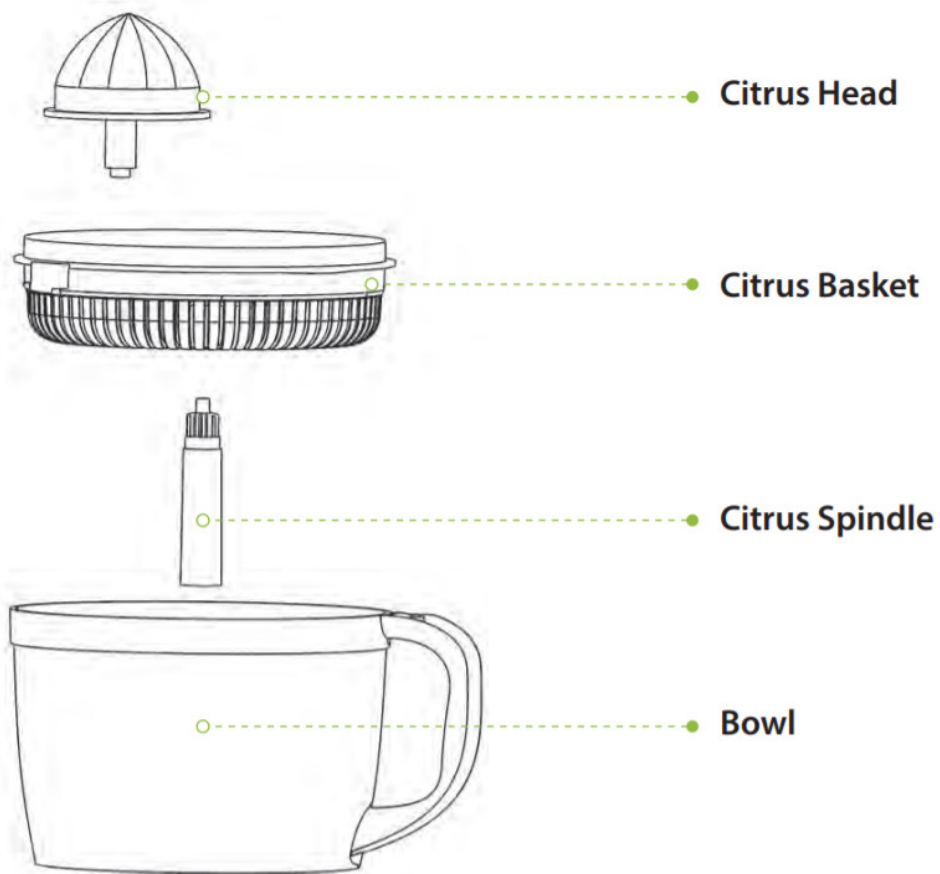

CAUTION

1. DO NOT use the machine continuously for more than 1 minute.
Always take a 1-minute rest.
2. Take off the bone from the meat.
3. DO NOT put a large quantity of meat and four into a bowl.

MAINTENANCE/CLEANING METHOD

1. You should always take off the plug when not in use.
2. Unplug the appliance from the electrical outlet when not in use for a long time.
Store the unit in a cool dry place.
3. Clean the accessories in water except the motor base.
4. Always unplug the appliance before you remove accessories or clean the motor unit. Wipe the motor base, always use the dry cloth to clean, never flush or dip in the water.

TROUBLESHOOTING

Malfunction	Analysis	Solution
Motor not working	1. Power plug is not plugged in properly 2. Bowl or cover is not properly aligned and locked 3. Motor protector is working.	1. Check to make sure the Food Processor is plugged in. 2. Make sure the cup and cover are Properly aligned and locked in place 3. Wait for about 20-30 minutes and use again.
The safety switch is not working	Jammed Switch	Do not repair by yourself and contact a qualified professional repair service
Food jam	Too much food	Turn off the machine, reduce the food
The abnormal smell from the motor base	Overheat	Do not operate for more than 1 minute
Leakage under the blade seat	Blade seal is broken for blender cup. Too much water in the bowl	Turn off the machine and take out the food, check the screw, seal and install again.

ENVIRONMENT



Do not dispose of electrical appliances as unsorted municipal waste, use separate collection facilities.

Contact your local government for information regarding the collection systems available. If electrical appliances are disposed of in landfills or dumps, hazardous substances can leak into the groundwater and get into the food chain, damaging your health and well-being.

When replacing old appliances with new ones, the retailer is legally obligated to take back your old appliance for disposals at least free of charge.

Features:

- Ultra Quiet Powerful Motor
- Includes 6 Attachment Blades: Slicer/Shredder Blade Disc, Masher Blade Disc, Chopper Blade, Knead Dough Blade, Emulsifying Blade, and Citrus Juicer
- Quick to Put Together
- Silent Strength, Ultra-Quiet
- Energy Efficient with Low Power Consumption
- Pre-set Speed Function
- Compact Design
- Easy to Store and Clean
- Electronic Overload Protection
- Every Part (except the base with the motor, cup & gearbox) is Dishwasher Safe
- Silicone rubber bottom suctions in order to hold strong on countertops while in use

What's in the Box:

- (1) Shredding/Slicing
- (1) Masher Blade Disc

- (1) Top-rated S blade
- (1) Emulsifying
- (1) Kneading
- (1) Citrus juicer attachment
- Power Cable

Technical Specs:

- Construction Material: ABS Housing, AS Cup
- Voltage: AC120V, 60Hz.
- Power Output: 600W
- Load Capacity: 12 Cups for Dry Ingredients, 9 Cups for Liquid Ingredients
- Continuous Use: ≤1min
- Power Cable Length: 3.28' ft.
- Product Dimension (L x H): 13.78" x 7.48" x 13.58" -inches

Questions? Issues?
 We are here to help!
 Phone: (1) 718-535-1800
 Email: support@pyleusa.com

Documents / Resources

 <p>NutriChef NCFPBLU Multifunction Food Processor Ultra Quiet Powerful Motor, Includes 4 Attachment Blades, Up to 12 Capacity (Blat) User Manual</p>	<p>nutrichef NCFPBLU Multifunction Food Processor [pdf] User Manual NCFPBLU, Multifunction Food Processor, Ultra Quiet Powerful Motor, Multifunction Food Processor Ultra Quiet Powerful Motor</p>
---	---

References

-  [NutriChef Kitchen | Vacuum Sealers, Air Fryers, Blenders & More!](#)