

nutribullet.
ultra
Deluxe Single
Serve Blender



nutribullet Ultra Deluxe Single Serve Blender User Guide

[Home](#) » [nutribullet](#) » **nutribullet Ultra Deluxe Single Serve Blender User Guide** 

Contents

- [1 Nutri Bullet Ultra Deluxe Single Serve Blender](#)
- [2 GENERAL USE AND SAFETY](#)
- [3 What's included?](#)
- [4 Assembly guide.](#)
- [5 Control panel.](#)
- [6 Troubleshooting.](#)
- [7 Care & maintenance.](#)
- [8 nutribullet® Ultra one-year limited warranty.](#)
- [9 Product registration.](#)
- [10 Documents / Resources](#)
 - [10.1 References](#)
- [11 Related Posts](#)

nutribullet.
ultra

Nutri Bullet Ultra Deluxe Single Serve Blender



WARNING! To reduce the risk of serious injury, read the User guide before operating your nutribullet® Ultra. Save these instructions. Be sure anyone who uses the nutribullet® knows how to do so safely.

Important safeguards.

- When operating your nutribullet® Ultra, remember: SAFETY COMES FIRST.
- **WARNING!** To avoid the risk of serious injury, death, property damage or damage to your device carefully read all instructions before operating your nutribullet® Ultra. When using any electrical appliance, basic safety precautions should always be observed, including the following important information.

READ CAREFULLY AND THOROUGHLY BEFORE OPERATING.

If you let anyone else use your nutribullet® Ultra, make sure that they understand the health and safety information in this User Guide, as well as any additional safety or usage instructions provided. Each person using a device should completely read the User Guide and become familiar with the safe operation of the unit.

Save these instructions!

FOR HOUSEHOLD USE ONLY

AVOID HEATING AND OVER-PRESSURIZING CUP:

- NEVER blend hot, warm, or carbonated ingredients or liquid in the nutribullet® Cup! Such use may over-pressurize the nutribullet® Cup, causing the Cup to separate violently when removed from the Motor Base or opened, which may result in bodily injury from the hot contents or exposed blades.
- Starting with hot or warm ingredients allows more heat and pressure to build inside the Cup when blending. This may cause the Cup to separate, expelling hot contents or exposing the blade, both of which may cause injury.
- Only blend room temperature or refrigerated ingredients (21°C/70°F or cooler).
- DO NOT blend hot or warm ingredients.
- DO NOT blend for more than one minute.
- Blending causes ingredients to heat up, which builds pressure in the Cup over time. Continuous blending for more than one minute may cause the Cup to separate, exposing the blade, or expelling heated contents, causing injury.
- DO NOT run for more than 6 consecutive 30-second intervals to prevent the contents from overheating and pressurizing. Allow contents to settle at least 10 to 15 minutes after running multiple consecutive extraction cycles. DO NOT attempt to open the Cup if it feels hot or warm to the touch. See the Cup Caution section for details.

DO NOT blend anything carbonated or effervescent— no bubbles.

- Carbonated and effervescent ingredients (e.g., soda, baking powder, baking soda, yeast, some batters, cake mix, dry ice, or other things that become bubbly) release gasses that increase pressure. Pressure from released gases can cause a sealed nutribullet® Cup to burst, resulting in possible injury and/or property damage.

Note: Some protein powders include effervescent ingredients. Always check the ingredients of all supplements before adding them.

DO NOT overfill.

- Filling above the MAX line can result in leakage. The cyclonic action of the nutribullet® requires space to extract effectively. Exceeding the MAX line can result in leakage and may create a dangerous pressurization which can cause the Cup and Rapid Extractor Blade assembly to separate.
- DO NOT leave blended foods inside a sealed Cup.
- Blended mixtures can spoil and ferment, increasing pressure when left inside the Cup.
- Use the To-Go Lid or transfer to another container for storage after blending.

CUP CAUTION

NEVER attempt to open a sealed nutribullet® Cup if it feels hot or warm to the touch. The contents may be heated and pressurized, which can cause the Cup to violently separate when opened, potentially resulting in bodily injury. If the Cup feels Hot or warm, take the following steps:

LEAVE ALONE, DO NOT OPEN

1. . Leave the Cup where it is and do not touch it or allow another individual to touch it. DO NOT attempt to disengage the Cup from the Motor Base or separate the Cup from the Rapid Extractor Blade by applying heat, force, or prying apart the components, which may crack or shatter the Cup and result in bodily injury.
2. Do not continue to blend.
3. Allow the Cup to cool for at least 30 minutes.
4. After 30 minutes, check if the Cup is completely cooled. If still warm, allow it to cool more.
5. If cool to the touch, slowly disengage the Cup from the Motor Base.
6. With the Cup pointed away from your face and body, use a towel to slowly untwist the Cup from the Rapid Extractor Blade and gently release any residual pressure.

If you are still unable to remove the Cup from the Rapid Extractor Blade, contact Customer Service. If you are unable to untwist the Cup from the Rapid Extractor Blade, NEVER leave the sealed contents out for a prolonged period. The contents may ferment causing the Cup to violently separate, which can result in in bodily injury or property damage. Dispose of the Cup and contents properly so you or others will not be injured if fermentation causes the Cup to separate.

CUP SAFETY

- Always make sure the Cup is securely locked on the Motor Base before blending. The motor will not turn on unless the Cup is set in the locked position.
- Do not exceed the MAX line. Exceeding the MAX line can result in leakage.
- Do not remove the Cup while the unit is in operation.
- Periodically inspect your nutribullet® Ultra blender components for damage or wear that may impair proper function or create a safety hazard.
- NEVER operate your nutribullet® Ultra if the Cup is empty.
- Do not overfill the Cup with ice.
- Always use sufficient liquid ingredients when blending.
- Do not place them on the bottom rack or use the heat/sanitize cycle of your dishwasher to wash the Cup or To-Go Lids.
- Cups and To-Go Lids are NOT microwave-safe.
- Do not use the Cup if you detect cracking, cloudiness, or other damage. You may purchase new Cups at [nutribullet.com](https://www.nutribullet.com) or by contacting Customer Service.
- Do not use the Rapid Extractor Blade as a storage lid as the blended mixture can ferment, increasing pressure within the Cup that may cause the Cup and blade to separate, potentially resulting in bodily injury and property damage. Use the To-Go Lid or transfer to a vented container for storage after blending.
- Do not use after-market replacement parts for your nutribullet® Ultra. Use of after-market replacement parts may result in damage to your nutribullet® or create safety hazards resulting in bodily injury or damage. Only order replacement parts from [nutribullet.com](https://www.nutribullet.com) or by contacting Customer Service at 1 [800-523-5993](tel:800-523-5993), please specify the model for parts that are compatible with your unit.

RAPID EXTRACTOR BLADE SAFETY

- BTHE LADES ARE SHARP! HANDLE WITH CARE TO AVOID BODILY INJURY. Non-food items or hard ingredients may damage the blades. Routinely inspect the blades and discontinue use if damaged. Continued use with a damaged blade or use inconsistent with these instructions may result in bodily injury, property

damage, or damage to your unit.

- Do not touch the sharp edges of the blades. To avoid laceration injury, do not handle or touch any blade edge.
- NEVER store any exposed Rapid Extractor Blade in the Motor Base unattached to a nutribullet® Cup. An exposed blade can present a laceration hazard.
- ALWAYS securely tighten the Rapid Extractor Blade to the Cup to prevent leakage.
- Do not attempt to disengage the Cup from the Motor Base if the Cup starts to leak during blending. Allow the motor to come to a complete stop before removing the Cup.
- Do not crush ice. Your nutribullet® Ultra is not intended to be used as an ice crusher.
- Do not leave any non-food items in the Cup when blending. Remove all utensils from the Cup.
- Do not blend stone fruit in this appliance unless pits/seeds have been removed. Fruit pits may damage the Cup, potentially resulting in shattering and personal injury. In addition, apple seeds and the pits of cherries, plums, peaches, and apricots contain a chemical known to release cyanide into the body when ingested.
- DO NOT USE the Rapid Extractor Blade for grinding dry ingredients such as grains, cereal, or coffee, as this may damage the motor and/or the blade.
- Do not remove the Cup until the blades have come to a complete stop. Removing before the blades come to a complete stop can cause damage to the Rapid Extractor Blade coupling or motor gear.
- Always POWER OFF and UNPLUG the unit when assembling, disassembling, changing accessories, or cleaning.
- Do not overload the Cup by exceeding the MAX line. The blades may stop turning if the Cup is overloaded. If this occurs, turn off the unit, empty contents down to the Max line, reattach the Cup, and resume blending.

AVOID CONTACT WITH MOVING PARTS!

- Keep hands and utensils out of and away from the blade while blending to reduce the risk of severe personal injury or damage to the unit.
- NEVER place the Rapid Extractor Blade on the bottom rack or use the heat/sanitize cycle of your dishwasher when cleaning.
- Periodically inspect the blades for damage. DO NOT use the Rapid Extractor Blade if the blades do not rotate freely or if the gasket is missing or damaged.
- The Rapid Extractor Blade is designed for longevity and comes with a 5-year warranty.
- We recommend replacing it at least every 5 years.

GENERAL USE AND SAFETY

- Failure to follow all instructions regarding the use of your nutribullet® Ultra may result in serious personal injury, death, or property damage. Be aware of possible hazards when using or storing your nutribullet® Ultra.
- NEVER blend hot, warm, or carbonated beverages. This may pressurize contents, causing them to erupt upon opening, which can result in serious bodily injury or property damage.
- Do not use this blender for anything other than its intended use
- Close supervision is necessary when any appliance is used by or near children to ensure they do not play with the appliance. Keep cord out of reach of children.
- This appliance is not intended for use by persons (including children) with reduced physical, sensory, or mental capabilities, or lack of experience and knowledge unless they are closely supervised and instructed concerning the use of the appliance by a person responsible for their safety.

NEVER LEAVE THE NUTRIBULLET® UNATTENDED WHILE IT IS IN USE .

- Do not place your nutribullet® blender on uneven or unstable surfaces.
- Do not operate if the Motor Base, Cup, or blade are damaged in any manner. Contact Customer Service for assistance at 1 [800-523-5993](tel:800-523-5993).
- Use only genuine nutribullet® attachments/accessories specifically designed for your nutribullet® Ultra blender. Aftermarket parts are not made to nutribullet® specifications and may damage your unit or cause serious injury.
- The risk of fire, shock, or damage to nutribullet® Ultra during cleaning can be reduced by taking the following precautions:
 - Unplug and turn your device off before cleaning.
 - Only clean the exterior of your device.
 - Clean your device with a dry cloth.
 - Do not attempt to clean by immersing in water or other cleaning liquids. Only gently wipe and dry with a clean cloth.
 - Do not place any of the nutribullet® Ultra parts in a microwave, conventional oven, air fryer, or stovetop pot, or immerse in boiling water, as this will damage the part.
 - NEVER use the sanitizer or heat cycle on any nutribullet® part or accessory. This may cause warping and possibly hazardous conditions.
 - NEVER place a nutribullet® Cup in the freezer or use the Cup as a storage container in the freezer.
 - Make sure your nutribullet® Ultra is powered off and the motor and blades are completely stopped before removing or cleaning the g unit.
 - DO NOT USE OUTDOORS.
 - ALWAYS UNPLUG THE NUTRIBULLET® WHEN NOT IN USE

ELECTRICAL SAFETY

- Modification, improper use, and failure to follow the instructions for proper setup, use, and care of your nutribullet® Ultra blender can increase the risk of serious personal injury, death, or property damage.
- Do not use the unit in locations with different electrical specifications or plug types.
- Do not use the unit with a voltage converter device as it may cause electrical shorting, fire, or electric shock, resulting in personal injury or product damage.
- Do not use the unit in an area that is wet or anywhere it could become wet.
- Do not attempt to plug the unit into an electrical outlet with wet hands.
- Do not use if the cord, plug, or Motor Base is immersed in water or other liquids.
- Do not modify the electrical cord in any way.
- Do not operate with a damaged electrical cord or plug. The electrical cord and plug are not suitable for replacement. If damaged, the appliance should be replaced. Contact Customer Service for assistance at [800-523-5993](tel:800-523-5993).
- Do not allow or place the electrical cord near or touching any hot surfaces, heat source, or flame, including the stove.
- Do not allow the electrical cord to hang over the edge of the table or counter.
- Do not pull, twist, or damage the power cord.
- Overloading the Cup with ice or other hard ingredients, or use without sufficient liquids may overheat the motor and engage the thermal breaker. If the internal thermal breaker shuts off the motor, unplug the Motor Base and

let it cool for an hour before attempting to use it again. The

- The thermal breaker will reset when the unit is unplugged and the thermal breaker cools down.
- Always UNPLUG the nutribullet® Ultra when it is not in use, and when assembling, disassembling, changing accessories, or cleaning.
- Use of incompatible parts or aftermarket parts may result in damage to your nutribullet® Ultra or create safety hazards that may cause personal injury or damage. When ordering replacement parts always use genuine nutribullet® parts and accessories from [nutribullet.com](https://www.nutribullet.com) or contact.
- Customer Service at 1 [800-523-5993](tel:800-523-5993).

VENTILATION

- NEVER obstruct the ventilation openings on the bottom of the Motor area of your nutribullet® Ultra. Openings on the bottom of the Motor Base should be free of dust or lint and never obstructed. Obstructing the ventilation openings may overheat the motor and result in a fire,
- increasing the risk of serious personal injury, death, or property damage.
- ALWAYS operate the nutribullet® on a level surface, leaving unobstructed space beneath and around the Motor Base to permit proper air circulation. Slots on the bottom of the Motor Base are provided for ventilation to ensure reliable operation and to prevent motor overheating.
- NEVER place your nutribullet® Ultra on top of flammable materials such as newspapers, tablecloths, napkins, dishtowels, placemats, or other similar types of materials.

MEDICAL SAFETY:

- Always consult your physician regarding health and nutrition concerns and advice. The information contained in this User Guide accompanied by Recipe Guide, and/or online recipes general

MEDICATION INTERACTIONS

- If you are taking any medication, especially cholesterol-lowering medication, blood thinners, blood pressure drugs, tranquilizers, or antidepressants, please check with your physician before trying any of the smoothie recipes contained in the Recipe Guide or online recipes.
- Periodically inspect your nutribullet® Ultra components for damage or wear that may impair proper function or present a danger or safety hazard. Discontinue use if you detect cracking, cloudiness, or damage to the Cups or other parts. Ensure that the blades to the Rapid Extractor Blade rotate freely and that the gasket is not missing or damaged. Make sure that the motor base is unobstructed and clean. Follow maintenance instructions in this user guide on pages 20-24. Never operate your nutribullet® Ultra with damaged parts or components. If your nutribullet® Ultra malfunctions or is damaged or compromised in any way, immediately discontinue use and contact customer service at 1 [800-523-5993](tel:800-523-5993) with any comments, questions, or concerns.

What's included?



motor base



24oz cup



**24oz
handled cup**

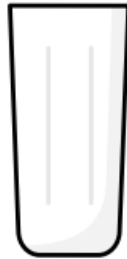

32oz cup



**rapid extractor
blade**



2 to-go lids

Assembly guide.

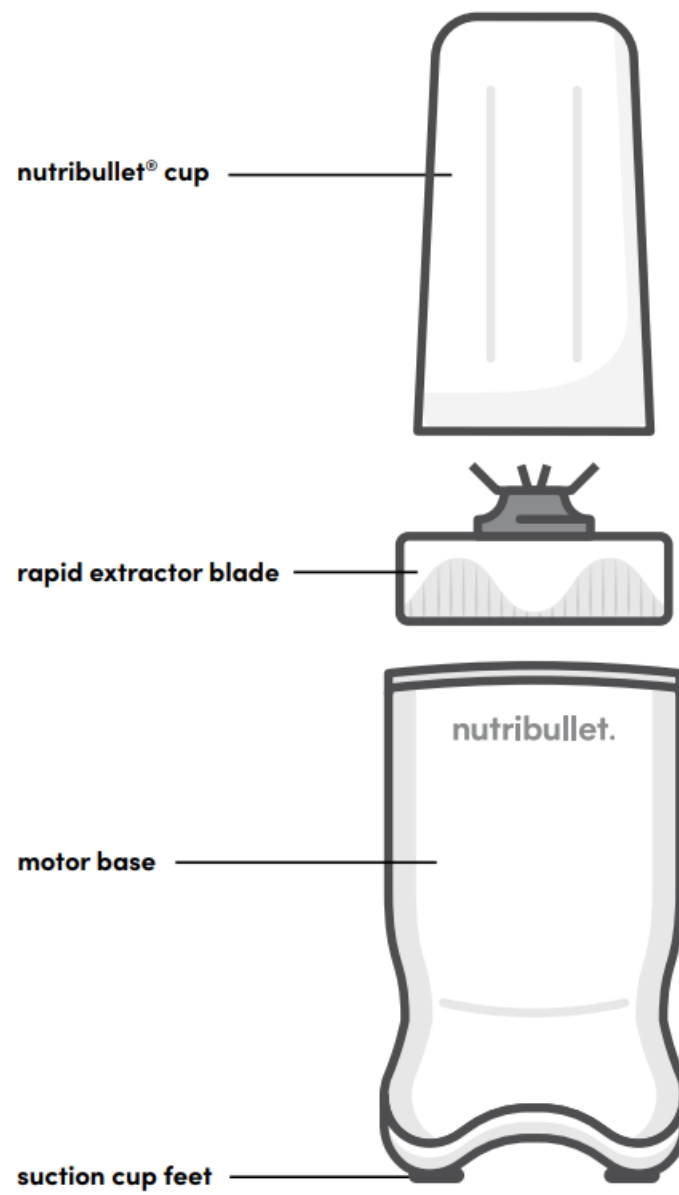

Control panel.



OFF

The Control Panel is not illuminated.

BLEND

After twisting the Blade/Cup assembly onto the Motor Base, the Control Panel will appear. Touch the illuminated Solid Circle icon on the Control Panel to activate the automatic 30-second blending program.

PULSE

After twisting the Blade/Cup assembly onto the Motor Base, the Control Panel will appear. Press and hold the Dashed Circle on the Control Panel to activate the pulse feature. For short, intermittent pulses, tap the Pulse icon. For longer pulses, tap and hold the Pulse icon until your desired consistency is reached.

Using your nutribullet® Ultra.

PLEASE KEEP THESE IMPORTANT SAFEGUARDS IN MIND WHEN USING THE NUTRIBULLET®:

- Creating too much pressure in the nutribullet® Cup can result in injury from hot contents, flying components, or blade exposure.
- DO NOT blend hot or warm ingredients, carbonated liquids, or effervescent ingredients.
- Do not overfill the Cup.

- DO NOT blend ingredients for more than one minute.
- Do not store blended foods in sealed Cups.
- See Avoid Heating and Over-Pressurizing Cup (pg. 2) for details.
- DO NOT attempt to open a sealed nutribullet® Cup if it feels hot or warm to the touch. The contents may be heated and pressurized, causing the Cup to violently separate when opened, and potentially resulting in bodily injury. See Cup Caution (pg. 3) for details. The blades are sharp! Handle with care to avoid bodily injury. NEVER store any exposed Rapid Extractor Blade in the Motor Base unattached to a nutribullet® Cup.

1. Review all warning and caution statements in the Important Safeguards section (pg. 2-10) and on the previous page before proceeding to Step 2.
2. Place the Motor Base on a clean, dry, level surface such as a counter or table.



3. Add ingredients and liquid to the nutribullet® Cup.

WARNING! To avoid leakage and over-pressurizing, do not overfill beyond the MAX line.

4. Twist the Rapid Extractor Blade onto the nutribullet® Cup until it's tightly sealed. WARNING! Rapid Extractor Blade is sharp. Handle with care.



5. Plug the Motor Base's Power Cord into an electrical outlet.
6. Flip the Cup downward and set it onto the Motor Base.



7. Twist the Cup clockwise onto the Motor Base to lock it into place. (A "click" signals that the Cup is locked.) This will illuminate the Control Panel.
8. Pressing the Solid Circle will start an automated blending cycle. When the blending cycle is activated, it will automatically stop after 30 seconds. Pressing and holding the Dashed Circle will pulse blend your ingredients. Release the Dashed Circle to stop blending.

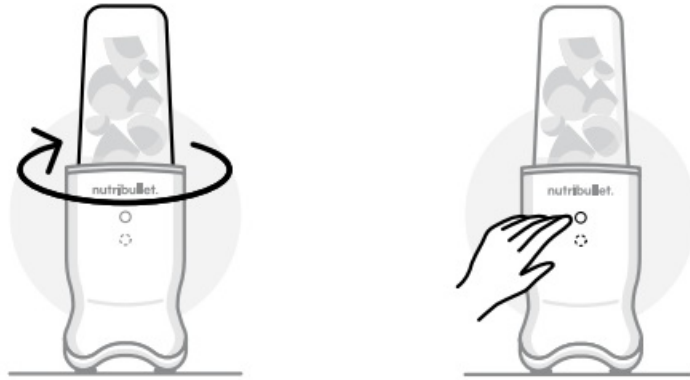

9. Twist the Cup counterclockwise to unlock and remove it from the Motor Base. You will hear a “click” when the Cup unlocks. Enjoy!



- **WARNING! NEVER** blend hot, warm, or carbonated ingredients or liquid in the nutribullet® Cup! Such use may over-pressurize the nutribullet® Cup, causing the Cup to separate violently when removed from the Motor Base or opened, which may result in bodily injury from the hot contents or exposed blades.
- **NEVER** apply heat or force, or attempt to pry apart the Cup from the Rapid Extractor Blade. Doing so may crack or shatter the Cup resulting in severe bodily injury. Allow the contents of the Cup to settle down for at least 30 minutes before attempting to open again. If still unable to open, contact Customer Service.

Troubleshooting.

PROBLEM:

The unit does not power on OR the Control Panel does not appear.

SOLUTIONS:

- Make sure the Power Cord is plugged into an electrical outlet, and that outlet has power.
- Make sure that the Cup/Blade assembly is securely attached to the Motor Base. You will hear a ‘Click’ when they are securely attached.

PROBLEM:

- The Control Panel flashes continuously.

SOLUTIONS:

- You have exceeded 6 consecutive blend cycles in a 6-minute time frame, OR the unit has overheated. If this

has occurred, unplug the unit and allow it to cool down for at least 15 minutes before attempting to use it again.

PROBLEM:

- The unit has become very loud during the blending cycle.

SOLUTIONS:

- Check that you have not exceeded the MAX fill line on the Cup when filling with ingredients. Overfilled Cups can cause strain on the motor which will result in an increased noise level.

PROBLEM:

- There is an odor coming from the Motor Base when it is in use.

SOLUTIONS:

- During the first few uses of the unit, there may be a smell emitted from the Motor Base, but this is normal with the first use of the product and should not cause alarm.
- If you notice a smell after using the product several times, check to ensure that you have not exceeded the MAX fill line on the Cup with ingredients. Overfilled Cups can cause strain on the motor which can result in an odor.

Care & maintenance.

PLEASE KEEP THESE IMPORTANT SAFEGUARDS IN MIND WHEN USING THE NUTRIBULLET®:

- Always power off and unplug your nutribullet® Ultra when not in use or when assembling, disassembling, changing accessories, or cleaning.
- Always wait until the motor comes to a complete stop before removing the Cup or handling the unit.
- Do not place Cups and To-Go Lids in the microwave, they are not microwave-safe.
- Do not store an exposed Rapid Extractor Blade on the Motor Base without attaching a Cup.
- NEVER place the Rapid Extractor Blade, Cups, or To-Go Lids on the bottom rack or use the heat/sanitize cycle of your dishwasher when cleaning. It may cause warping and possible safety hazards.
- Do not attempt to clean the Motor Base by immersing it in water or other cleaning liquids. Gently wipe and dry with a clean cloth.
- Do not place any parts or accessories in a microwave, conventional oven, air fryer, or stovetop pot, or immerse in boiling water to clean or sanitize, as this will damage the part.
- Make sure that the Motor Base ventilation areas are unobstructed and clean.
- Periodically inspect your nutribullet® Ultra components for damage or wear that may impair proper function or present a danger or safety hazard. Never operate your nutribullet® Ultra with damaged parts or components:
- Discontinue use if you detect cracking, cloudiness, warping, or damage to the Cups.
- Discontinue use if the Rapid Extractor Blade does not rotate freely, or if the gasket is missing or damaged. Continued use with a damaged blade, or use inconsistent with these instructions may result in bodily injury, property damage, or damage to your unit.

- NEVER attempt to use your nutribullet® Ultra if it malfunctions or is damaged or compromised in any way. Immediately contact customer service at 1 [800-523-5993](tel:800-523-5993).
 - Depending on use, it is recommended that the Rapid Extractor Blade be replaced at least every 5 years.
 - NEVER use after-market replacement parts for your nutribullet® Ultra. Aftermarket parts are not made to nutribullet® specifications and may damage your unit or cause serious injury. Use only genuine nutribullet® attachments/accessories specifically designed for your nutribullet® Ultra blender by calling Customer.
 - Service at: 1 [800-523-5993](tel:800-523-5993).
1. Once blending is complete, make sure your nutribullet® Ultra Motor Base is powered off and unplugged from its outlet.



2. Detach the nutribullet® Cup and Rapid Extractor Blade from the Motor Base.



3. Clean the individual components as follows

EXTRACTOR BLADES:

- Rinse the Rapid
 - Extractor Blade with warm, soapy water.
 - Use a small brush or sponge dampened in soapy water to remove any residue on the Rapid Extractor Blade.
- NOTE: It's best to clean the Rapid Extractor Blade immediately after use to avoid the buildup of residue.

MOTOR BASE:

- Use a sponge or dishcloth dampened with soapy water to clean the surface of the Motor Base.
- Use a small brush to scrub the actuator system of the Motor Base.

CUPS & TO-GO LIDS:

- Cups and To-Go Lids are dishwasher-safe. Rinse or scrub beforehand to remove any debris.
- WARNING! NEVER place the Rapid Extractor Blade, Cups, or To-Go Lids on the bottom rack or use the heat/sanitize cycle of your dishwasher when cleaning, as this may cause warping and possible safety hazards.

STUCK INGREDIENTS:

- For stuck ingredients on Cups or Rapid Extractor Blades, fill with room temperature water to the MAX line and add 1-2 drops of dish soap.
- Twist on the Rapid Extractor Blade and blend for 20-30 seconds to loosen debris enough to scrub away with soap and water.

STORAGE:

- Always store your nutribullet® Ultra upright without any objects placed on top of it. Store accessories in a safe place until use.

For replacement parts.

- Visit nutribullet.com/shop/accessories or call customer service at 1 [800-523-5993](tel:800-523-5993).

nutribullet® Ultra one-year limited warranty.

LIMITED WARRANTY FOR NUTRIBULLET®

nutribullet's limited warranty obligations are confined to the terms set forth below:

- nutribullet, LLC ("nutribullet") warrants this nutribullet® against defects in materials and workmanship for one year from the date of original retail purchase or date of delivery of the product. This limited warranty is valid only in the country in which the product is purchased. Andd comes with the product at no extra charge, however, shipping and processing fees will be incurred for returns, replacements, and or refunds.
- If a defect exists, and this limited warranty is valid, at its option nutribullet®
 1. repair the product at no charge, using new or refurbished replacement parts,
 2. exchange the product with a product that is new or that has been manufactured from new or serviceable used parts and is at least functionally equivalent to the original product, or (3) refund the purchase price of the product. A replacement product assumes the remaining warranty of the original product. A repaired product has a one-year warranty from the date of delivery of the product to the consumer. When a product or part is exchanged, any replacement item becomes your property, and the replaced item becomesNutribullet's property. When a refund is given, your product becomes Nutribullet's property.

OBTAINING WARRANTY SERVICE

For limited warranty service, simply call our customer service department at 1 [800-523-5993](tel:800-523-5993) or contact us via email from our website at nutribullet.com, simply click the Contact Us link, fill it out, and submit the customer contact form and we will glad to help you. When you contact our customer service department you will be asked for your name, address, and telephone number and to provide proof of the original purchase (receipt) containing a description of the product(s), purchase date or date of delivery, and the appropriate nutribullet® serial number(s). Before you send your product for limited warranty service please make sure to keep a copy of all relevant documents for your files (receipt, etc.). It is

always recommended to purchase product insurance and tracking services when sending your product for service. Remember, shipping and processing fees will be incurred and are not covered by the one-year limited warranty.

EXCLUSIONS & LIMITATIONS

This nutribullet® One-Year Limited Warranty applies only to nutribullet® products distributed by or for nutribullet® that can be identified by the “nutribullet” trademark, trade name, logo, and bar code. nutribullet’s One-Year Limited Warranty does not apply to any other products that may appear to be authentic but were not distributed/sold by Nutribullet, LLC. Normal wear and tear is not covered by this limited warranty. This limited warranty applies to consumer use only and is void when the product is used in a commercial or institutional setting. This limited warranty extends only to the original consumer purchaser and is not transferable. In addition, proof of purchase must be demonstrated. Repair or replacement of the product (or, if repair or replacement is not feasible, a refund of the purchase price) is the exclusive remedy of the consumer under this limited warranty. nuNutri bulletLLC shall not be liable for any incidental or consequential damages for breach of this limited warranty or any implied warranty on this product.

This limited warranty gives you specific legal rights, and you may also have other rights that vary from state to state. nutribullet® is not liable for any damage to products not covered by this warranty (e.g., cups, books, User Guide). This limited warranty does not apply:

- to damage caused by accident, abuse, misuse, or misapplication
- to damage caused by improper maintenance (including unauthorized parts service)
- to a product or a part that has been modified in any way;
- if any nutribullet® serial number or trademark has been removed or defaced; and or
- if the product has been used with an adapter/converter.

THIS LIMITED WARRANTY

THE REMEDIES SET FORTH ABOVE ARE EXCLUSIVE AND INSTEAD OF ALL OTHER WARRANTIES, REMEDIES, AND CONDITIONS, WHETHER ORAL OR WRITTEN, EXPRESS OR IMPLIED. NUTRIBULLET® SPECIFICALLY DISCLAIMS ANY AND ALL IMPLIED WARRANTIES, INCLUDING, WITHOUT LIMITATION, WARRANTIES OF MERCHANTABILITY AND FITNESS FOR A PARTICULAR PURPOSE. IF NUTRIBULLET® CANNOT LAWFULLY DISCLAIM IMPLIED WARRANTIES UNDER THIS LIMITED WARRANTY, ALL SUCH WARRANTIES, INCLUDING WARRANTIES OF MERCHANTABILITY AND FITNESS FOR A PARTICULAR PURPOSE ARE LIMITED IN DURATION TO THE DURATION OF THIS LIMITED WARRANTY. No nutribullet® reseller, agent, or employee is authorized to make any modification to this warranty. NUTRIBULLET® IS NOT RESPONSIBLE FOR DIRECT, SPECIAL, INCIDENTAL, L, OR CONSEQUENTIAL DAMAGES RESULTING FROM ANY BREACH OF WARRANTY OR CONDITION, OR UNDER ANY OTHER LEGAL THEORY, INCLUDING BUT NOT LIMITED TO LOST PROFITS, DOWNTIME, GOODWILL, DAMAGE TO OR REPLACEMENT OF EQUIPMENT AND PROPERTY. NUTRIBULLET® SPECIFICALLY DOES NOT REPRESENT THAT IT WILL BE ABLE TO REPAIR ANY PRODUCT UNDER THIS LIMITED WARRANTY.

Some states and provinces do not allow the exclusion or limitation of incidental or consequential damages or exclusions or limitations on the duration of implied warranties or conditions, so the above limitations or exclusions may not apply to you. This warranty gives you specific legal rights, and you may also have other rights that vary by state or province.

nutribullet® Ultra Rapid Extractor Blade 5-year limited warranty.

The Ultra Rapid Extractor Blade that comes with your nutribullet® Ultra or that is purchased separately, is covered by a five (5) year limited warranty that applies to purchases made from authorized retailers of the nutribullet® products. nutribullet® warrants, subject to the conditions and exclusions described herein, that the Ultra Rapid Extractor Blade shall be free from defects in material and workmanship for five (5) years from the date of delivery

of the product to the consumer when it is used under normal household conditions and is maintained according to the requirements discussed in the Owner's Guide. What is covered by the

Ultra Rapid Extractor Blade limited warranty?

Your Nutribullet® Ultra Rapid Extractor Blade will be replaced within five (5) years from the date of delivery of the product to the consumer under the terms of this limited warranty if:

- The blade breaks due to a manufacturing defect.
- There is a bearing failure.
- There is a grinding sound from the blade assembly when running.
- The blade gasket leaks or becomes damaged.
- The blade stops rotating.
- The blade threading for the mixing cup becomes damaged when used according to the User Guide.
- The drive coupling loosens or becomes damaged.
- The plastic blade housing cracks or breaks when used according to the User Guide.
- The blade to base engagement and recognition system becomes damaged.

Is there a replacement blade warranty?

In the event a replacement Ultra Rapid Extractor Blade is issued, the warranty coverage ends upon the later of six (6) months following the receipt date of the replacement Ultra Rapid Extractor Blade OR the remainder of the existing 5-year limited warranty.

What is not covered by this warranty?

- Normal wear and tear of the Ultra Rapid Extractor Blade.
- Any Ultra Rapid Extractor Blade that has been tampered with or used for commercial purposes.
- Any Ultra Rapid Extractor Blade that has been modified.
- Damage caused by misuse, abuse, negligent handling, failure to perform required maintenance, or damage due to any mishandling.
- Damage caused by a failure to follow the operating instructions in the User Guide.
- Consequential and incidental damages.
- Defects caused by repair persons not authorized by Nutribullet, including without limitation, defects include damages caused in the process of shipping, altering, or repairing the Ultra Rapid Extractor Blade when the repair is performed by a repair person not authorized by Nutribullet®.
- Products purchased, used, or operated outside of North America.
- Shipping and handling fees associated with replacing your Ultra Rapid Extractor Blade under the terms of this limited warranty.
- Any Ultra Rapid Extractor Blades with a date code that is over 6 years old.
- Cosmetic changes to the color of the plastic blade housing that do not affect performance, such as discoloration.

How to initiate a warranty claim for your Ultra Rapid Extractor Blade.

- You must call 1 [800-523-5993](tel:800-523-5993) to initiate a warranty claim. You will need the receipt as proof of purchase. We

also ask to have the nutribullet® Ultra base on hand when you call, so we may better assist you. A Customer Service Specialist will review your Ultra Rapid Extractor Blade issue with you and provide you with further guidance.

How state law applies.

This warranty gives you specific legal rights, and you also may have other rights that vary from state to state. Some states do not permit the exclusion or limitation of incidental or consequential damages, so the above may not apply to you.®.

Product registration.



*** How to find serial number under the Motor Base.**

Please visit nutribullet.com/register or call 1 [800-523-5993](tel:800-523-5993) to register your new nutribullet® Ultra blender. You will be asked to enter the Serial Number* of your product, along with the purchase date and place of purchase. The information you submit is for product registration. Failure to complete product registration does not diminish your warranty rights. The registration will enable us to contact you in the unlikely event of a product safety notification. By registering your product, you acknowledge that you have read and understood the instructions for use, and warnings outlined in the accompanying instructions.

Capital Brands Distribution, LLC | nutribullet.com | All rights reserved. nutribullet® and the nutribullet® logo are trademarks of CapBrn Holdings, LLC registered in the U.S.A. and worldwide. Illustrations may differ from the actual product. We are constantly striving to improve our products, therefore the specifications contained herein are subject to change without notice. NB50500_230516

Documents / Resources

 <p>User guide.</p> <small>© 2018 Nutribullet. All rights reserved. Nutribullet, the Nutribullet logo, and the Ultra logo are trademarks of CapBrn Holdings, LLC. All other trademarks are the property of their respective owners. The information contained herein is for informational purposes only and does not constitute an offer of insurance or any other financial product. Please consult your agent for more information.</small>	<p>nutribullet Ultra Deluxe Single Serve Blender [pdf] User Guide</p> <p>Ultra Deluxe Single Serve Blender, Ultra, Deluxe Single Serve Blender, Single Serve Blender, S erve Blender</p>
---	--

References

- [User Manual](#)

[Manuals+](#), [Privacy Policy](#)

This website is an independent publication and is neither affiliated with nor endorsed by any of the trademark owners. The "Bluetooth®" word mark and logos are registered trademarks owned by Bluetooth SIG, Inc. The "Wi-Fi®" word mark and logos are registered trademarks owned by the Wi-Fi Alliance. Any use of these marks on this website does not imply any affiliation with or endorsement.