



## nutribullet NBF500MB-266906 Blender Combo User Guide

[Home](#) » [nutribullet](#) » nutribullet NBF500MB-266906 Blender Combo User Guide 

### Contents

- [1 NBF500MB-266906 Blender Combo](#)
- [2 Product Information: Blender Combo](#)
- [3 Important Safeguards](#)
- [4 Product Usage Instructions](#)
- [5 GENERAL SAFETY INFORMATION](#)
- [6 What's included](#)
- [7 Getting started](#)
- [8 Pitcher assembly & use](#)
- [9 nutribullet® cup assembly & use](#)
- [10 Blending control panel](#)
- [11 How to use the blending control panel](#)
- [12 Care & maintenance](#)
- [13 Documents / Resources](#)
  - [13.1 References](#)
- [14 Related Posts](#)

# nutribullet®

**NBF500MB-266906 Blender Combo**

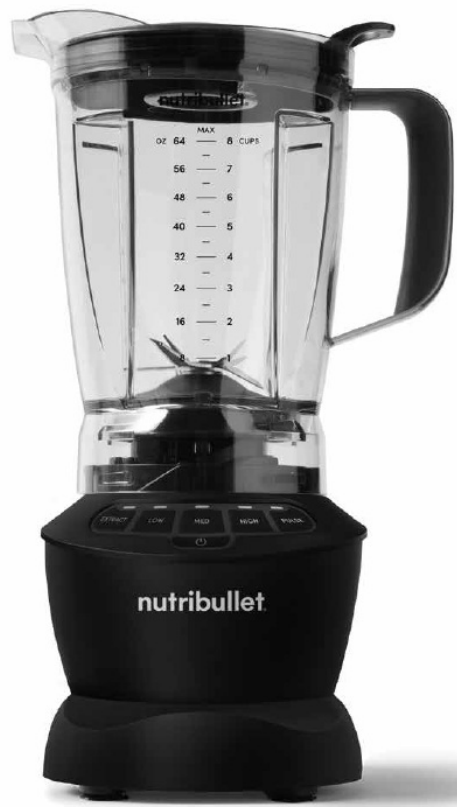

## Product Information: Blender Combo

The Blender Combo is a household appliance that can be used to blend various ingredients and make smoothies or blended mixtures. It comes with a pitcher and an easy-twist extractor blade attached to a motor base. The product has several safety features to prevent personal injury, property damage, or product damage.

## Important Safeguards

- Save the instructions for future reference.
- The Blender Combo is for household use only.
- Never blend hot ingredients or liquid in the cup to avoid personal injury.
- Do not continuously operate the blender for longer than necessary to create your recipe – generally less than one minute.
- Avoid blending carbonated liquids or effervescing ingredients that can cause pressure buildup and result in possible injury and/or property damage.
- Use extra caution when blending hot liquids in the pitcher and always use the vented lid cap inserted and locked into the pitcher lid.
- Never store the easy-twist extractor blade unattached to the motor base as it can present a laceration hazard.
- Always use the Blender Combo with added liquid to prevent damage to the blades.
- Do not use the product in locations with different electrical specifications or plug types, and do not operate with any type of plug adapter or voltage converter device.
- Always unplug the product and wait for it to cool down before cleaning or handling.

## Product Usage Instructions

1. When blending hot liquids, add liquid and solid ingredients to the pitcher below their respective MAX lines.

2. Attach the pitcher lid with the vented lid cap inserted and locked.
3. Press POWER and begin blending on the LOW setting. Once ingredients are integrated, increase speed as needed.
4. If you need to blend for longer than one minute, blend for 1-minute intervals. After each 1-minute interval, allow the motor base to shut off completely and wait at least one minute before starting the next cycle. Do not run for more than 3 consecutive 1-minute intervals to prevent the contents from overheating. Allow contents to settle for 2-3 minutes after the third blending cycle to prevent overheating and buildup of pressure.
5. Handle blades carefully and avoid contact with moving parts while blending food to reduce the risk of severe personal injury.
6. Use extra caution when blending hot liquids or ingredients in the pitcher and keep utensils away from the blade to prevent damage to the machine or possible injury.
7. Always unplug the product and wait for it to cool down before cleaning or handling.

### **Important safeguards**

Warning! To avoid the risk of serious injury, carefully read all instructions before operating your nutribullet®. When using any electrical appliance, basic safety precautions should always be observed, including the following important information.

### **Save these instructions!**

FOR HOUSEHOLD USE ONLY

## **GENERAL SAFETY INFORMATION**

- This appliance shall not be used by children. Keep the appliance and its cord out of reach of children.
- Children shall not play with the appliance. Appliances can be used by persons with reduced physical, sensory or mental capabilities or lack of experience and knowledge if they have been given supervision or instruction concerning use of the appliance in a safe way and if they understand the hazards involved.
- Do not use outdoors.
- NEVER LEAVE THE NUTRIBULLET® UNATTENDED WHILE IT IS IN USE.
- ALWAYS TURN THE NUTRIBULLET® OFF WHEN NOT IN USE.
- DO NOT USE THIS APPLIANCE FOR ANYTHING BUT ITS INTENDED USE. MISUSE MAY RESULT IN PERSONAL INJURY.

## **HEAT & PRESSURE SAFETY**

- Always use extreme care and attention when using hot ingredients in any blending product, as the friction from the rotating blades (during the blending process) combined with the thermal energy of the heated ingredients can create a dangerous situation if not properly controlled.
- Caution must be observed if hot liquid is poured into the blender as it can be ejected out of the appliance due to sudden steaming.

### **BLENDING WITH NUTRIBULLET® CUPS:**

To avoid personal injury, never blend hot ingredients or liquid in any sealed nutribullet® cup!

**WARNING!**

- Heated ingredients can pressurize sealed containers when agitated and cause cup and blade separation or violently expel hot contents upon opening. Always start the blending process with room temperature or refrigerated ingredients and liquids (21°C/70°F or cooler).
- Never continuously operate for longer than necessary to create your recipe — generally less than one minute. Friction from prolonged operation can heat ingredients and generate internal pressure in the sealed container. This pressure can cause the cup and blade to separate or blended contents to erupt from the container, resulting in possible personal injury and/or property damage. If the sealed nutribullet® cups are warm to the touch, power off your machine and allow the vessel to cool for fifteen minutes or more. Allow contents to settle before slowly releasing the cup from the motor base. With the nutribullet® cup, pointed away from your face and body, slowly unscrew the easy-twist extractor blade to gently release any residual pressure.
- If you need to blend for longer than one minute, blend for 1-minute intervals. After each 1-minute interval, allow the motor base to shut off completely and wait at least one minute before starting the next cycle. Do not run for more than 3 consecutive 1-minute intervals to prevent the contents from overheating. Allow contents to settle for 2-3 minutes after the third blending cycle to prevent overheating and buildup of pressure.
- Sugar in fruits and vegetables can ferment over time, releasing gases that cause pressure to build up in a sealed nutribullet® cup. Do not store any smoothies or blended mixtures in vessels sealed with the easy-twist extractor blade. If you will not consume your smoothie immediately, remove the easy-twist extractor blade and cover your nutribullet® cup with plastic wrap before refrigerating. If your smoothie or blended mixture was made in the pitcher, transfer to another storage container before refrigerating. Never store any blended mixture in a sealed cup unrefrigerated, or for any prolonged period of time; contents will spoil and ferment, producing gases that might cause eruption.
- Never blend carbonated liquids or effervescing ingredients (e.g., baking soda, baking powder, yeast, etc.). Pressure from released gases can cause a sealed blending container to burst, resulting in possible injury and/or property damage.

#### **BLENDING WITH THE PITCHER:**

Use extra caution when blending hot liquids in the pitcher.

Never turn the power on while using the pitcher without the vented lid cap inserted and locked into the pitcher lid, as ingredients can splash, and if hot or warm, could potentially cause thermal injury and/or property damage.

#### **WARNING!**

- Steam and splattering ingredients can escape through the pitcher lid, potentially scalding and/or burning the user. NEVER blend hot liquids in your pitcher without the pitcher lid and vented lid cap locked and attached. The vented lid cap allows steam and pressure to escape, while guarding against excess splashing. NEVER blend hot liquids in your nutribullet® cups or any other sealed vessel.
- When blending hot liquids, add liquid and solid ingredients to your pitcher below their respective MAX lines. Attach the pitcher lid with the vented lid cap inserted and locked. Press POWER and begin blending on the LOW setting. Once ingredients are integrated, increase speed as needed.
- If the nutribullet® blends for longer than one minute, friction from the blades can cause ingredients to heat and generate internal pressure inside the vessel. If a blending vessel becomes warm to the touch, turn off the machine and allow the vessel to cool completely before carefully opening, pointed away from your body to

avoid injury.

## **BLADE SAFETY**

Never store any easy-twist extractor blade in the motor base unattached to a nutribullet® cup. An exposed blade can present a laceration hazard.

- Blades are sharp! Handle carefully. Use care when handling any blade. To avoid laceration injury, do not handle or touch any blade edge.  
AVOID CONTACT WITH MOVING PARTS! Keep hands and utensils out of and away from blades while blending food to reduce the risk of severe personal injury.
- TO REDUCE THE RISK OF PERSONAL INJURY OR PROPERTY DAMAGE, never place the easy-twist extractor blade on the motor base without the cup properly attached. Make sure the easy-twist extractor blade is securely twisted (hand-tightened) onto the nutribullet® cup before placing it on the motor base and operating the nutribullet® Blender Combo. Check to make sure the easy-twist extractor blade is aligned properly before placing it on the motor base and operating your nutribullet® Blender Combo.
- After blending, turn the power button off. Wait to remove the nutribullet® cup/easy-twist extractor blade assembly from the motor base until the motor comes to a full stop and the unit powers down completely. Taking the blending vessel off the unit prior to complete power down can cause damage to the easy-twist extractor blade coupling or motor gear.

Never use the nutribullet® Blender Combo without adding liquid, as doing so may damage the blades.

- The cyclonic action® of your nutribullet® Blender Combo requires the use of liquids to make smoothies and other nutritious items. The nutribullet® Blender Combo is not intended to be used without liquids, or as an ice crusher. ALWAYS ADD LIQUID to your recipe.  
DO NOT USE the easy-twist extractor blade for grinding dry ingredients such as grains, cereal, or coffee, as this may damage the motor and/or the easy-twist extractor blade.
- We recommend replacing your easy-twist extractor blade every 6 months (depending on use) or as needed for optimal performance.

## **PITCHER SAFETY**

- Always operate the pitcher with the pitcher lid securely in place.
- With recipes that require certain ingredients to be incorporated during blending, first add the base ingredients, seal the pitcher lid with vented lid cap attached, and begin blending. Then, once the ingredients are well mixed, twist open the vented lid cap and carefully pour or drop ingredients into the mixture.
- If you need to push ingredients closer to the blade, ONLY USE THE TAMPER PROVIDED with the nutribullet® Blender Combo. DO NOT use any apparatus other than the tamper to push ingredients toward the blade. The tamper is specifically designed not to come in contact with the blade. Spatulas, spoons and other tools can make contact with the blade, which may result in damage to the machine, damage to property, and/or possible injury.
- NEVER USE YOUR FINGERS OR ANY PART OF YOUR HAND TO PUSH INGREDIENTS DOWN TOWARD THE BLADE. Only use the provided tamper.

Remember to use extra caution when blending hot liquids or ingredients in the pitcher.

- Spray or escaping steam may cause burns and/or property damage.
- Do not fill container above the maximum capacity lines indicated for liquids and solid ingredients.
- Always begin blending hot ingredients on the LOW setting.
- Keep hands and other exposed skin away from lid opening to prevent possible burns.

## **ELECTRICAL SAFETY**

### • **WARNING!**

Do not use this product in locations with different electrical specifications or plug types. Do not operate with any type of plug adapter or voltage converter device, as these may cause electrical shorting, fire, electric shock, personal injury, or product damage.

- **CAUTION:** In order to avoid a hazard due to inadvertent resetting of the thermal cut-out, this appliance must not be supplied through an external switching device, such as a timer, or connected to a circuit that is regularly switched on and off by the utility.
- If the supply cord is damaged, it must be replaced by the manufacturer, its service agent or similarly qualified persons in order to avoid a hazard.
- The use of attachments, including canning jars, is not recommended and may cause fire, electric shock, personal injury, or product damage and will void the product's warranty.
- To avoid the risk of electric shock, never immerse the cord, plug, or motor base of the nutribullet® Blender Combo in water or other liquids. Discontinue use if the cord, plug, or motor base is damaged.
- Always disconnect the appliance from the power supply if it is left unattended and before assembling, disassembling or cleaning. Do not attempt to handle the nutribullet® Blender Combo until all parts have stopped moving.
- Do not allow the cord to hang over the edge of the table or counter. Do not pull, twist, or damage the power cord. Do not allow the cord to touch hot surfaces, including the stove.
- If the motor stops working, unplug the motor base and let it cool for at least 15 minutes before attempting to use it again. Your nutribullet® has an internal thermal breaker that shuts off the motor when it overheats. The thermal breaker will reset when the unit is unplugged, and the thermal breaker cools down sufficiently.

## **STOVE-TOP HEATING SAFETY**

Do not blend hot ingredients in any sealed nutribullet® cup!

- To heat items that have been blended at room temperature or cooler (21°C/70°F or less), transfer mixture to a stovetop pot to heat. Always use a thermometer to test the internal temperature of cooked ingredients; they may feel cool to the touch, yet still be hot inside.
- The nutribullet® Blender Combo is not intended for use on the stove top. Do not place the motor base or any nutribullet® accessory on the stove or microwave or immerse in boiling water.  
This may result in damage to the accessory.

## **VENTILATION WARNINGS**

### • **WARNING!**

To prevent a fire hazard, power base openings (underneath the motor base) should be free of dust and lint and never obstructed with flammable materials such as newspapers, tablecloths, napkins, dishtowels, place mats or other similar type materials.

- **CAUTION!** Always operate the nutribullet® Blender Combo on a level surface, leaving unobstructed space beneath and around the motor base to permit proper air circulation. Vents on the bottom of the product are provided for ventilation to ensure reliable motor operation and to prevent overheating.

## **MEDICAL SAFETY**

- The information contained in this User Guide or Recipe Guide is not meant to replace the advice of your physician. Always consult your physician regarding health and nutrition concerns.

## **MEDICATION INTERACTIONS:**

- If you are taking any medication, especially cholesterol-lowering medication, blood thinners, blood pressure drugs, tranquilizers, or antidepressants, please check with your physician before trying any of the recipes contained in this guide or the recipe guide.
- Avoid blending the following seeds and pits in the nutribullet® Blender Combo, as they contain a chemical known to release cyanide into the body when ingested: apple seeds, cherry pits, plum pits, peach pits, and apricot pits. Fruit pits may also cause damage to the pitcher.

## **ADDITIONAL INSTRUCTIONS FOR PROPER USAGE**

- Do not place any of the nutribullet® Blender Combo parts in a microwave, oven, or in a stovetop pot, or immerse in boiling water, as this may result in damage to the part.
- **TO AVOID LEAKAGE, DO NOT OVERFILL THE BLENDING VESSELS!** The pitcher is marked with two MAX lines: one for solid ingredients (higher line) and one for liquid ingredients (lower line). Your nutribullet® cups are also marked with a MAX line. When filling the blending vessels, make sure your ingredients do not exceed their respective MAX lines. Exceeding the indicated MAX lines can result in leakage, and may lead to dangerous pressurization.
- Blending vessels and easy-twist extractor blades are specific to the exact model of nutribullet® Blender Combo you possess. Use of incompatible parts (parts from other models) may result in damage to your nutribullet® Blender Combo or create safety hazards. When ordering replacement parts (nutribullet® cups, pitcher, easy-twist extractor blades) on [nutribullet.com](http://nutribullet.com) or via customer service, please specify the machine model to ensure you receive parts that are compatible with your unit.
- Periodically inspect all nutribullet® Blender Combo components for damage or wear that may impair proper function or present an electrical hazard. Make sure that the power cord and plug are undamaged. Discontinue use and replace blending vessels if you detect cracking, cloudiness, or damage to the plastic. Ensure that the blades rotate freely and that the structure is undamaged. Make sure that the motor base is unobstructed and clean. Follow maintenance recommended in the User Guide and never operate your nutribullet® Blender Combo with damaged components. If your nutribullet® Blender Combo malfunctions in any way, immediately discontinue use and contact customer service. You may purchase new nutribullet® cups, pitchers, and easy-twist extractor blades at [nutribullet.com](http://nutribullet.com) or by contacting customer service.

## Save these instructions!

If you have any comments, questions, or concerns, please go to [nutribullet.com](https://www.nutribullet.com).

## What's included



1 900 ml  
cup



1 700 ml  
handled cup



2 to-go lids



1 pitcher with  
integrated blade



1 pitcher lid  
with vented  
lid cap



1 easy-twist  
extractor blade



1 motor base



1 tamper

## Assembly guide



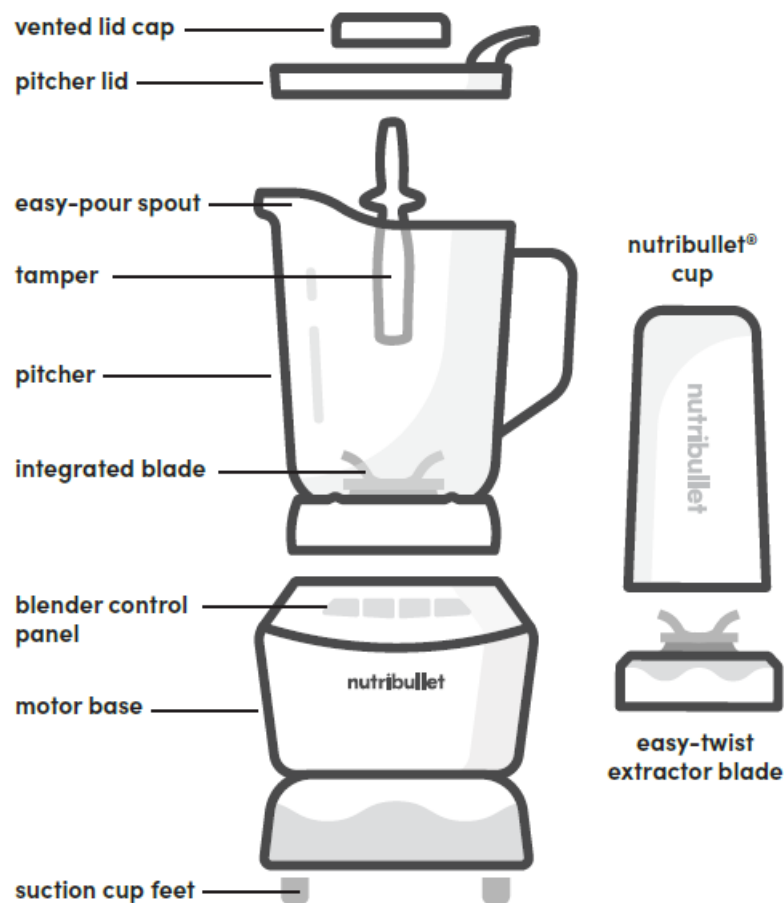

## Getting started

### PLEASE KEEP THESE IMPORTANT SAFEGUARDS IN MIND WHEN USING THE APPLIANCE:

- Make sure the base is plugged in for use.
- DO NOT attempt to operate the pitcher on the appliance without attaching the pitcher lid and vented lid cap.
- Never run the appliance while empty.
- Appliance accessories are not intended to be used in the microwave as it may damage the accessories.
- Never leave the appliance unattended while in use.

Never blend hot liquids when using any sealed nutribullet® cups.

#### **WARNING!**

Heated ingredients can pressurize sealed containers when agitated and violently expel hot contents upon opening. Always start the blending process with room temperature or refrigerated ingredients and liquids (21°C/70°F or cooler).

Use extra caution when blending hot liquids in the pitcher.

#### **WARNING!**

Steam and splatters can escape through the vented lid, potentially causing scalding and/or burns. NEVER blend hot liquids in your pitcher without the pitcher lid and vented lid cap attached. The vented lid cap is ventilated to allow steam and pressure to release, while guarding against excess splashing. NEVER blend hot liquids in your nutribullet® cups or any other sealed vessel.

When blending hot liquids, add liquid and solid ingredients to your pitcher below their respective MAX lines. Attach the pitcher lid with the vented lid cap inserted. Press the POWER icon, then begin blending on the LOW setting. Once ingredients are integrated and the mixture is level (no splashing), increase speed as needed.

## Pitcher assembly & use

1. Review all warning and caution statements in the Important Safeguards section (pg 2-10) and on the previous page before proceeding to Step 2.



2. Place the motor base on a clean, dry, level surface such as a counter or table.



3. Place the pitcher on a clean, dry, level surface. Add the ingredients to the pitcher, making sure they do not exceed the MAX line.

**NOTE:** The blending pitcher is marked with two MAX lines: one for solid ingredients (higher line) and one for liquids (lower line). When filling the blender, make sure your ingredients do not exceed their respective MAX lines.



4. Place the pitcher lid with vented lid cap attached on the pitcher, making sure it's aligned to the handle.

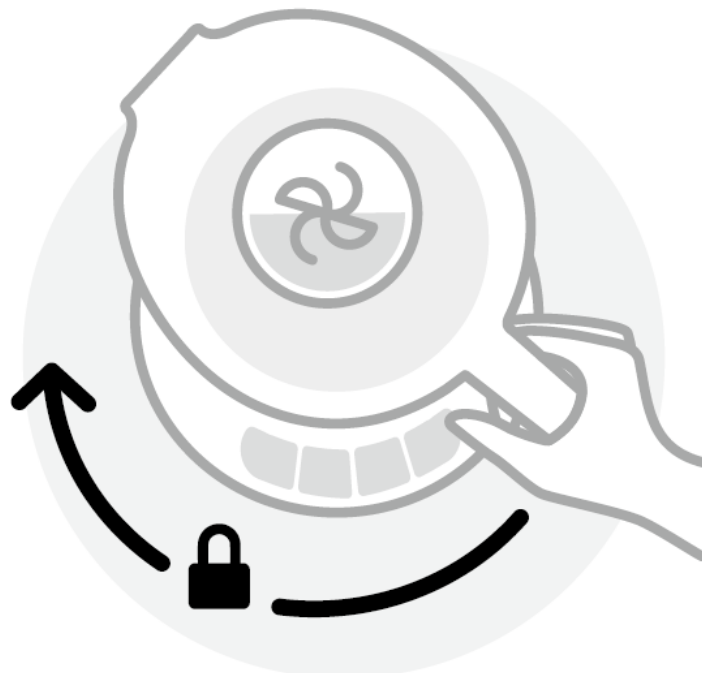

5. Place the pitcher onto the motor base — handle facing to the right of the blending control panel, never towards the back — and gently twist clockwise so it locks in place. When you hear the click, it's locked and ready to blend.

**NOTE:** If you are left-handed, place the handle facing towards the center of the blending control panel and twist clockwise.



6. Plug the power cord into an electrical outlet and press POWER to turn on the blender.



7. To start blending, select a speed or the EXTRACT program on the blending control panel. This program will turn off automatically. Buttons will illuminate while in use.

**NOTE:** Proceed to the blending control panel chart on page 21 for speed definitions.

**NOTE:** If you need to add additional ingredients while blending, switch the setting to LOW and remove the vented lid cap from your pitcher lid, leaving the lid attached. Add ingredients through the hole in the top of the lid, followed by the tamper if necessary. Replace the vented lid cap, then increase to your desired speed. DO NOT attempt to add items through the vent hole when blending hot ingredients.



**CAUTION:** Do not use any apparatus other than the tamper to push ingredients toward the blade. The tamper is specifically designed not to come in contact with the blade. Spatulas, spoons and other tools are long enough to reach the blade, which may result in damage to the machine, damage to property, and possible injury.



8. If the ingredients stick to the side of the pitcher, stop the appliance by pressing POWER and wait for the blade to stop turning. Then remove the pitcher lid and use the tamper to dislodge the ingredients. When finished, replace the lid and continue blending. If the ingredients continue to stick, consider adding a little more liquid.
- 9.



When you have reached your desired consistency, pause/stop the appliance by pressing POWER or the speed you selected and wait for the blades to stop turning. The unit will enter idle-mode. The POWER button will remain illuminated.

**WARNING:** Blades are sharp. Never insert your hands into the pitcher.

10. Press POWER to turn off the unit completely.



11. Twist pitcher counterclockwise and lift off the motor base. Pour and enjoy!

### **nutribullet® cup assembly & use**

1. Review all warning and caution statements in the Important Safeguards section (pg 2-10) before proceeding to Step 2.
2. Place the motor base on a clean, dry, level surface such as a counter or table.



3. Add ingredients to the nutribullet® cup.

**NOTE:** Do not overfill! To avoid leakage, do not add ingredients beyond the MAX line.



4. Twist the easy-twist extractor blade onto the cup until tightly sealed.

**WARNING!**

Handle the easy-twist extractor blade assembly with care, as the blades are sharp.

Never leave the appliance unattended while in use.

**NEVER BLEND HOT LIQUIDS**, as doing so may cause excessive pressure buildup, resulting in risk of personal injury and or property damage.



5. Plug the power cord into an electrical outlet and press POWER to turn on the blender.





6. Turn the cup upside down and place it onto the motor base, gently turning the cup clockwise to lock into the motor base.



7. To start blending, select a speed or the EXTRACT program on the blending control panel. This program will turn off automatically. Buttons will illuminate while in use.

**NOTE:** Proceed to the blending control panel chart on page 21 for speed definitions.



8. When you have reached your desired consistency, pause/stop the appliance by pressing POWER or the speed you selected and wait for the blades to stop turning. The unit will enter idle-mode. The POWER button will

remain illuminated.

**NOTE:** speeds will automatically shut off after 60 seconds.

9. Press POWER to turn off the unit completely.



10. Unlock the assembly by gently twisting the cup counterclockwise. You will hear a click. Enjoy!

**NOTE:** Blending should never take longer than one minute to yield smooth and creamy results.

#### **CAUTION**

Do not remove the easy-twist extractor blade from the nutribullet® cup until blending has completely ceased. Do not use the easy-twist extractor blade as a storage lid for your cup. Some foods may contain active ingredients or release gases that will expand if left in a sealed container, resulting in excessive pressure buildup that can pose a risk of injury. When storing contents in the cup, use plastic wrap or foil to seal your container. Always point contents away from your body when unsealing.

#### **Blending control panel**

##### TURNING ON/OFF

The power button actuates the master power of the appliance. When pressed, this button lights up to indicate the motor is powered on, and the other functions can be used. Always turn the master power off and unplug the unit when the machine is not in use.

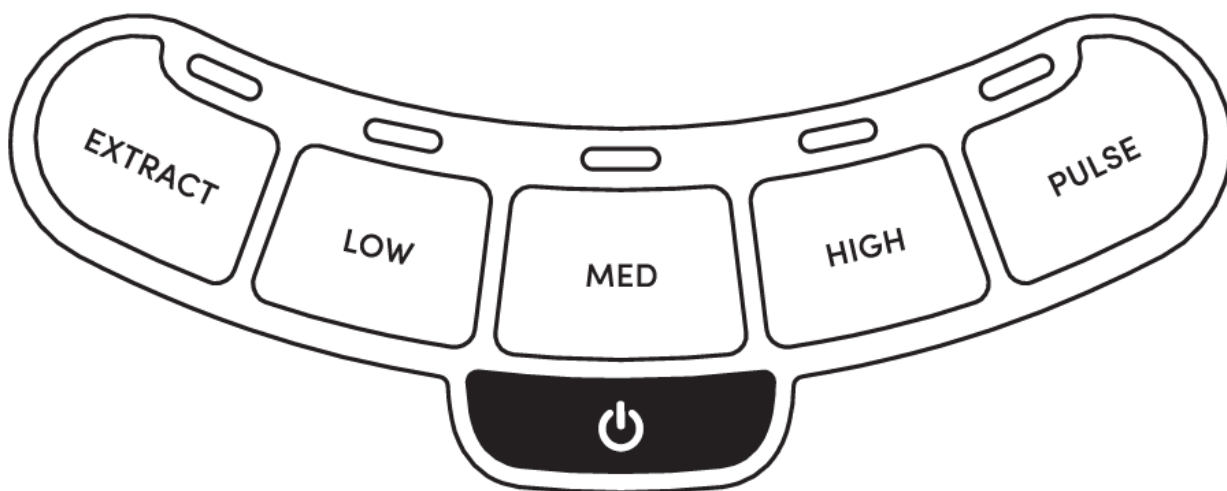

##### THE EXTRACT PROGRAM

Use to break down whole fruits, vegetables, and ice into nutrient-rich smoothies. This button will activate a run

cycle that shuts off automatically.

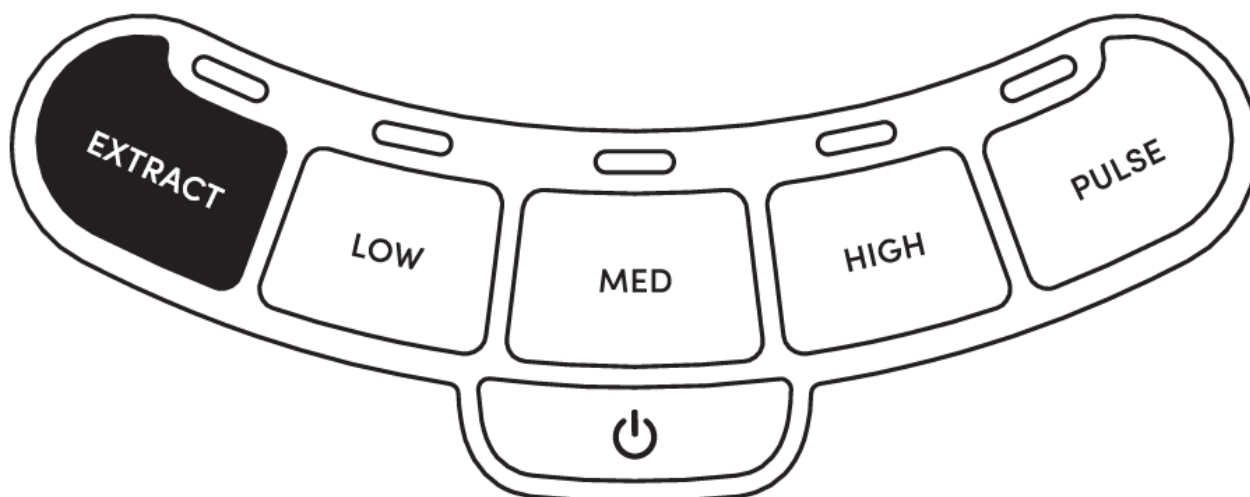

#### LOW SPEED

Use to mix thin batter, gravies, marinades; scramble eggs; process cooked foods and uncooked fruits.

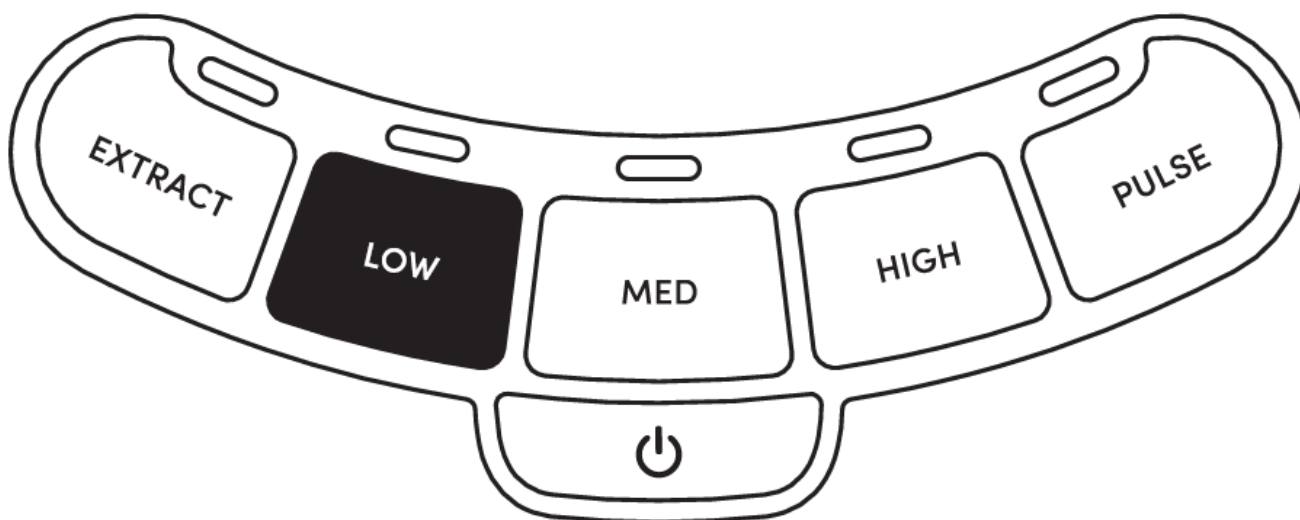

#### MEDIUM SPEED

Use to cream soups, mix dips, grind nuts, and blend sauces, spreads, mixed drinks, powdered drinks, and milkshakes.

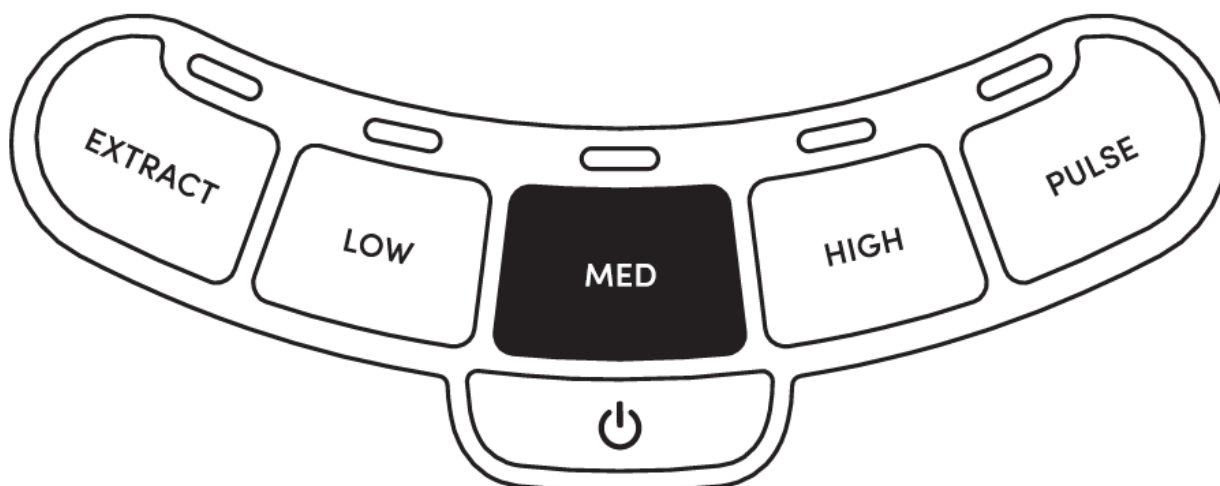

WARNING!

NEVER BLEND HOT LIQUIDS IN ANY SEALED nutribullet® CUP. Doing so may cause excessive pressure buildup, resulting in risk of personal injury or property damage. Hot items should only be blended in the pitcher using proper safeguards.

#### HIGH SPEED

Use to liquefy thick mixtures and blend frozen fruits and vegetables.

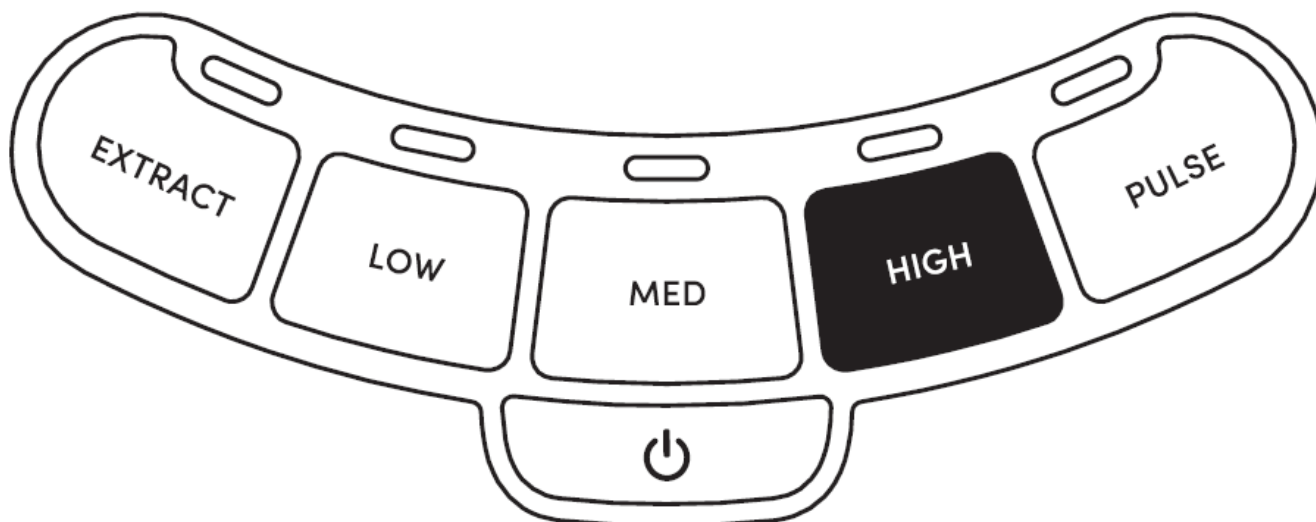

#### PULSE\*

Use to control chopping and processing.

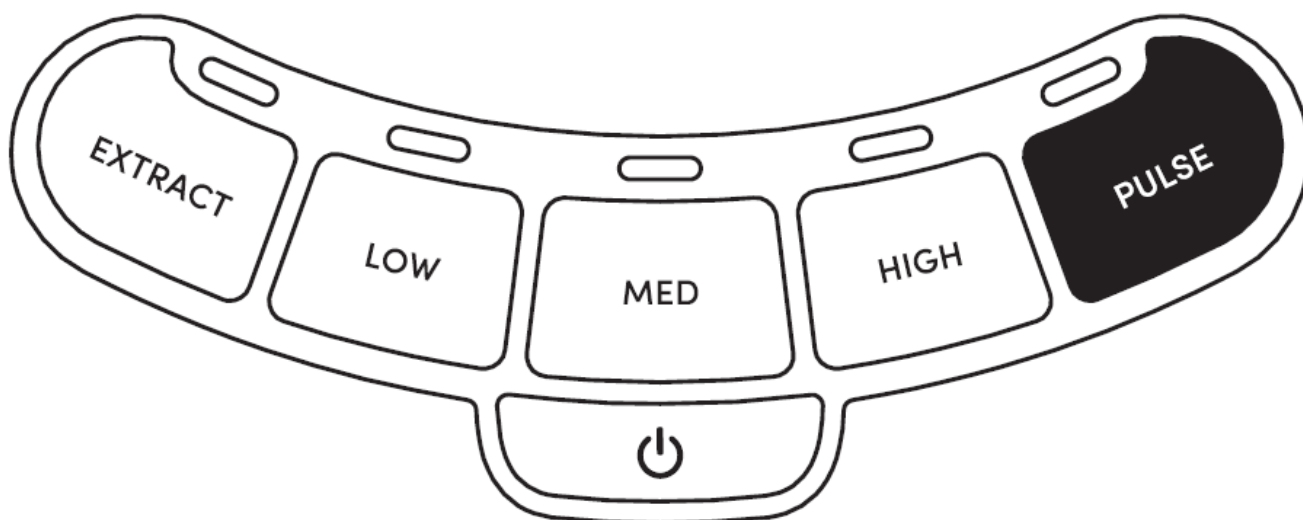

**WARNING:** DO NOT use this setting with hot ingredients!

#### How to use the blending control panel

##### LOW, MEDIUM OR HIGH

Select a speed and press once to turn on. The button will illuminate. To pause/stop the unit, press the button a second time — it will de-illuminate — or press POWER. While in the idle-mode, the POWER button will remain lit. To fully power down after pausing, press POWER and unplug the unit.

**NOTE:** If using the pitcher, speeds will run until paused/stopped. If using the nutribullet® cups, speeds will automatically shut off after 60 seconds.

#### THE EXTRACT PROGRAM

Press the EXTRACT button and the nutribullet® Blender Combo will do the work for you. This program automatically stops at the end of its cycle. To pause or stop the blender, press EXTRACT again or POWER .

## **PULSE**

Press and release the PULSE button to chop ingredients. If you hold this button down, it will continue to run until you release it.

## **Care & maintenance**

Cleaning the nutribullet® is easy. The pitcher is dishwasher-safe while the cups and to-go lids are TOP RACK dishwasher-safe. The easy-twist extractor blade and motor base can be quickly hand-washed with soap and water. Read on for best practices.

### **Here's how to clean the nutribullet®:**

Please follow the below cleaning instructions before the first use, and after each use.

- **STEP 1:** The most important thing — ALWAYS POWER OFF THE UNIT and UNPLUG the motor base from the power outlet when it is not in use. Do not attempt to handle the appliance until all parts have stopped moving! This includes during assembly and disassembly, while changing accessories during cleaning, and any time you leave the machine unattended.
- **STEP 2:** Detach the nutribullet® cup / easy-twist extractor blade or pitcher from the motor base.
- **STEP 3:** Clean the individual components (motor base, easy-twist extractor blade, nutribullet® cups) as recommended in the following pages.

### **MOTOR BASE:**

- To avoid risk of injury, NEVER attempt to clean the actuator system on the motor base while the nutribullet® Blender Combo is plugged in.
- Do not attempt to remove any pieces from the motor base.
- Use a sponge or dish cloth dampened with warm soapy water to wipe down the motor base until clean.
- If necessary, you may use a small brush to scrub the actuator system area to ensure it's clean.
- To clean leakage residue from the motor base, wipe with a damp sponge and warm water.
- If necessary, you may use a small brush to scrub the actuator system area to ensure it's clean.

**WARNING:** Never submerge the motor base in water.

### **EASY-TWIST EXTRACTOR BLADE:**

- Blades are sharp! Handle the easy-twist extractor blade with care when cleaning! It is best to clean blades immediately after use to reduce buildup of residue. If food particles get stuck, use a small brush or sponge to target and dislodge them.
- Do not remove any components of the easy-twist extractor blade; this can result in permanent damage to the blade, resulting in leakage when blending. If, over time, the easy-twist extractor blade becomes loose or damaged, you may order a new easy-twist extractor blade at [nutribullet.com](https://www.nutribullet.com) or contact customer service.
- Dry the easy-twist extractor blade completely after every use.
- Regularly check the condition of the bottom of the blade for cracking or breakage. If damaged, replace easy-

twist extractor blade immediately to prevent possible personal injury.

#### **nutribullet® CUPS & TO-GO LIDS:**

These items are TOP RACK dishwasher-safe. We recommend rinsing and briefly scrubbing them with a dish brush to remove any remaining debris before placing in the dishwasher. NEVER use the sanitize cycle to wash the cups — heat this high can warp the plastic.

#### **nutribullet® PITCHER:**

**WARNING:** Blades are sharp! Use caution when cleaning the pitcher.

- The pitcher is dishwasher-safe. We recommend rinsing and briefly scrubbing it with a dish brush to remove any remaining debris before placing in the dishwasher. NEVER use the sanitize cycle to wash the pitcher — heat this high can warp the plastic.
- If preferred, hand-wash the pitcher with soap and water. Stuck-on ingredients might require extra scrubbing from a dish brush or sponge.
- Regularly check the structure of the pitcher and twisting threads for cracking, crazing, or breakage. If damaged, replace immediately to prevent possible personal injury.
- NEVER USE A PITCHER THAT DOES NOT PROPERLY ALIGN WITH THE BLADE. Doing so may cause the pitcher and motor base to separate, exposing the blade assembly and potentially causing severe personal injury.

#### **TAMPER**

- Always hand-wash the tamper with soap and water. Stuck-on ingredients might require extra scrubbing from a dish brush or sponge.

#### **STUBBORN CLEAN UP:**

If ingredients get stuck to the nutribullet® cups, easy-twist extractor blades, or pitcher, here's an easy cleanup solution: fill the vessel with room temperature (21°C/70°F or less) water to its MAX line and add 1-2 drops of dish soap. For cups, twist on the easy-twist extractor blade, and blend on the motor base for 20-30 seconds. For the pitcher, attach lid and blend on the motor base for the same amount of time, 20-30 seconds. This should loosen debris enough to scrub away with soap and water.

#### **How to store:**

Store the nutribullet® Blender Combo pitcher upright with the pitcher lid secured on top. Do not place anything on top of the pitcher lid. Store remaining pieces in a safe place where they will not be damaged and won't cause harm.

**WARNING:** NEVER store the easy-twist extractor blade on the motor base without a nutribullet® cup or the pitcher as the exposed blades pose a serious laceration hazard.

#### **Replacement parts**

To order additional parts and accessories, please visit our website at [nutribullet.com](https://www.nutribullet.com) or feel free to contact customer service.

#### **Explanation of the markings**



■ This marking indicates that this product should not be disposed with other household wastes throughout the EU. To prevent possible harm to the environment or human health from uncontrolled waste disposal; recycle it responsibly to promote the sustainable reuse of material resources. To return your used device, please use the return and collection systems or contact the retailer where the product was purchased. They can take this product for environmental safe recycling.



This product complies with the European regulation no. 1935/2004 on materials and articles intended to come into contact with food.

Capital Brands Distribution, LLC | [www.nutribullet.com](http://www.nutribullet.com) | All rights reserved. nutribullet® and the nutribullet® logo are trademarks of CapBran Holdings, LLC registered in the U.S.A. and worldwide.

Illustrations may differ from the actual product. We are constantly striving to improve our products, therefore the specifications contained herein are subject to change without notice.

230424\_NB Blender Combo AK

## Documents / Resources

 <p>User guide</p>	<p><a href="#">nutribullet NBF500MB-266906 Blender Combo</a> [pdf] User Guide NBF500MB-266906 Blender Combo, NBF500MB-266906, NBF500MB-266906 Blender, Blender Combo, Blender</p>
---	---

## References

- [n nutribullet | Smoothie Recipes, Health Advice & Shop - nutribullet](#)
- [n nutribullet | Smoothie Recipes, Health Advice & Shop - nutribullet](#)