



nutribullet NB-205 Balance with Smart Nutrition Sensor and Bluetooth User Guide

[Home](#) » [nutribullet](#) » nutribullet NB-205 Balance with Smart Nutrition Sensor and Bluetooth User Guide



USER GUIDE



The Evolution of Blending



The NutriBullet just got smarter with **NutriBullet Balance**! Born from a quest for blending excellence, **NutriBullet Balance** features Bluetooth 4.0 Smart Nutrition Sensor technology that sends REAL-TIME nutrition data to your smart device as you blend recipes. View carbs, calories, protein, sugar and more in real time! This provides tighter control over blends by letting you know exactly what you're making as you're making it. Unlike other blenders, with **NutriBullet Balance** nothing is left to chance, you always know exactly what you're getting! Watch recipes come to life and tweak them on the fly to suit your taste. No more sugary treats disguised as healthy smoothies or protein shakes in name only. With **NutriBullet Balance** the smoothie you envision is the smoothie you can make, down to the gram, every time. We hope you'll enjoy this member of the NutriBullet family as much as we do. Say goodbye to measuring cups, eyeballed amounts and wild card results...**with NutriBullet Balance, the only thing you'll be eyeballing is a better YOU!**



Contents [[hide](#)]

- [1 Let's Get Started!](#)
- [2 Connecting with Bluetooth*](#)
- [3 Troubleshooting](#)
- [4 Connecting and Disconnecting Manually](#)
- [5 Disconnecting the Balance Blender](#)
- [6 Start Making Your Recipes](#)
- [7 Manual Mode](#)
- [8 Cleaning the NutriBullet Balance Smart Nutrition Sensor™ and Well](#)
- [9 Documents / Resources](#)
 - [9.1 References](#)
- [10 Related Posts](#)

Let's Get Started!

Download the **NutriBullet Balance** App from NutriBulletBalance.com/app or find it in either:



Connecting with Bluetooth*

The **NutriBullet Balance** Blender uses Bluetooth Smart technology to connect to the **Balance App** on your smartphone or tablet. **To connect the Balance Blender to your device:**

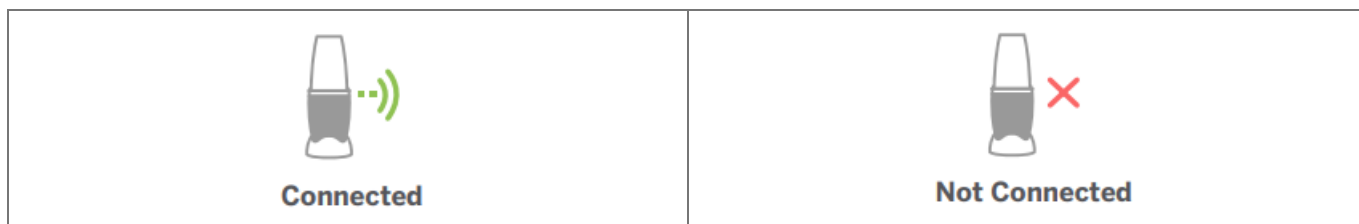

1. Make sure your smart device has Bluetooth **turned on**.
2. Open the **NutriBullet Balance App**.
3. Plug in your **NutriBullet Balance Blender**; the button's blue light will blink three times and go off.
4. The **Balance Blender** will connect to the App automatically, and the **blue light will come on**. See the following section if it does not.

Troubleshooting

Using with Multiple Devices

Your **NutriBullet Balance Blender** can only **connect to one device at a time**. If you are having trouble connecting, make sure the **Balance Blender** is not connected to a different device.

If your **Balance Blender** is still connected to a previously used device, quit the **NutriBullet Balance App** running on that device. The **Balance Blender** will disconnect automatically.

*For phone/tablet compatibility, go to makeitperfectly.com/compatibility.

Connecting and Disconnecting Manually

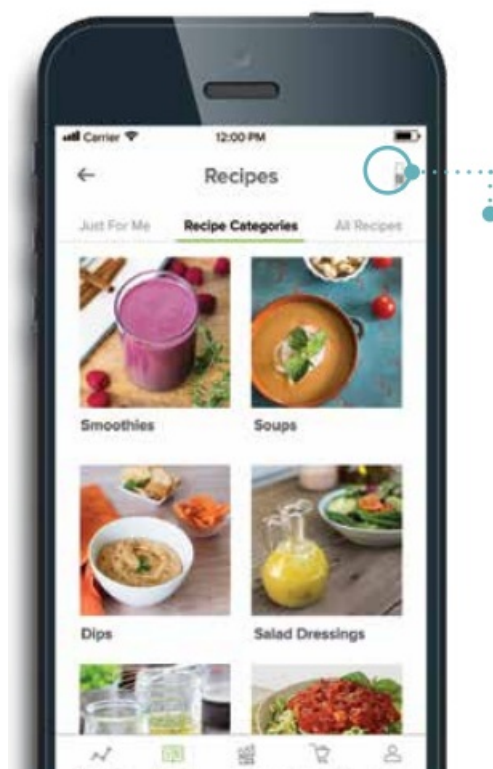

You can connect to or disconnect from the **Balance Blender** manually in the **Balance App**. Touch the **Balance Blender** icon to the right of the search box to open the **Available Blenders** list.

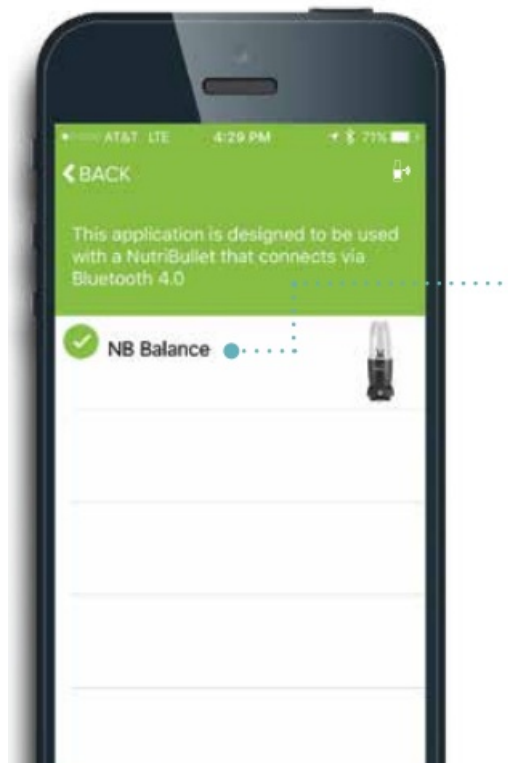

The App will display a checkmark next to the **Balance Blender** it is currently connected to. Touch a **Balance Blender** in the list to connect to it or disconnect from it.

Disconnecting the Balance Blender



You can force the **Balance Blender** to disconnect from the device it is connected to by touching and **holding the button on the blender**. The light will turn off.

Start Making Your Recipes

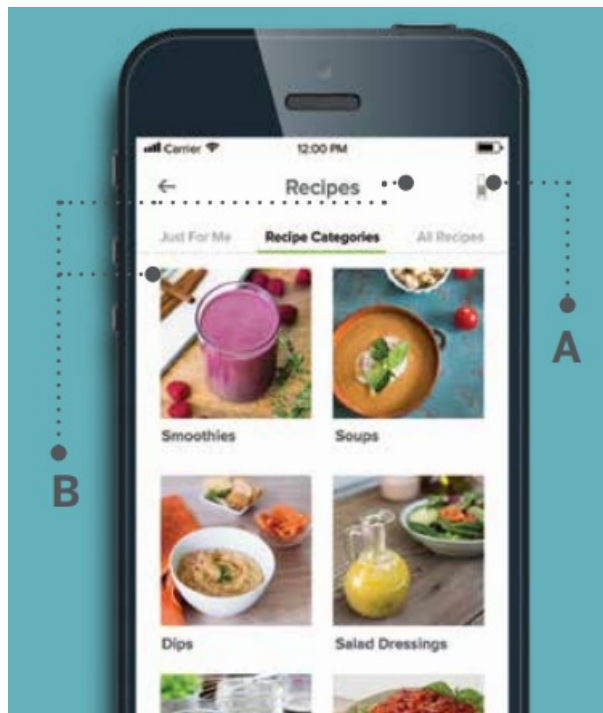

A. Make sure your Balance Blender is connected to the App.

B. Press the  icon and, in the search bar, type in the name of the recipe or choose from our recipe categories.

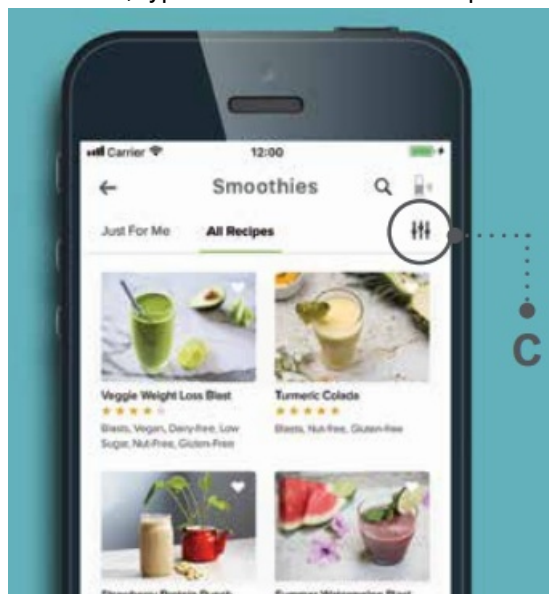

C. View recipes and ratings quickly by using filters. Select your recipe.

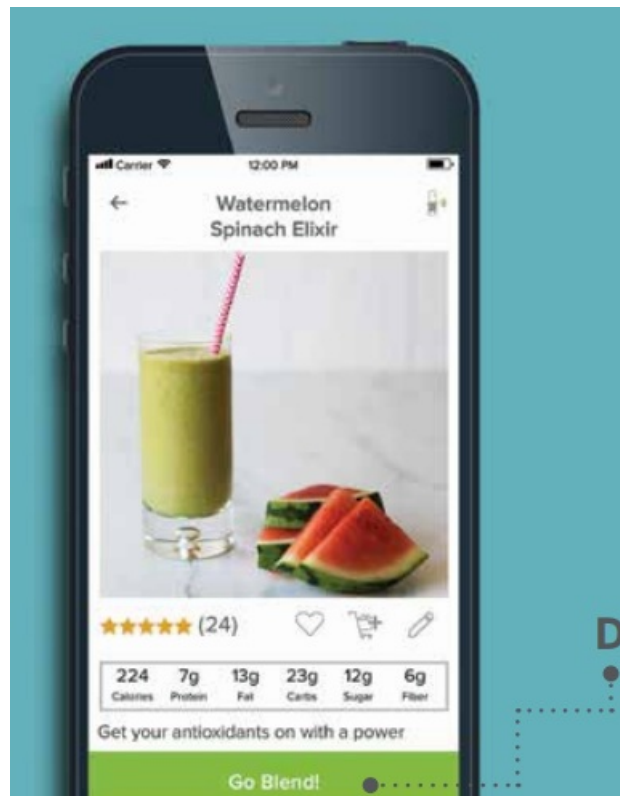

D. Click on the BLEND button. When prompted, remove all items from the Base.
NOTE: Make sure nothing is on top of the Smart Nutrition Sensor.



E. When prompted, place the Balance Cup on the Power Base, open side up.
NOTE: Make sure the Smart Nutrition Sensor is in place.



F. Follow the step-by-step directions in the recipe.

NOTE: To prevent leakage when creating a recipe, ALWAYS make sure that the ingredients do not extend above the MAX line.



G. When prompted, twist the **Blade** onto the cup. Flip over the cup, place it onto the base, then push and twist to the right. The **Balance Blender** will start blending.

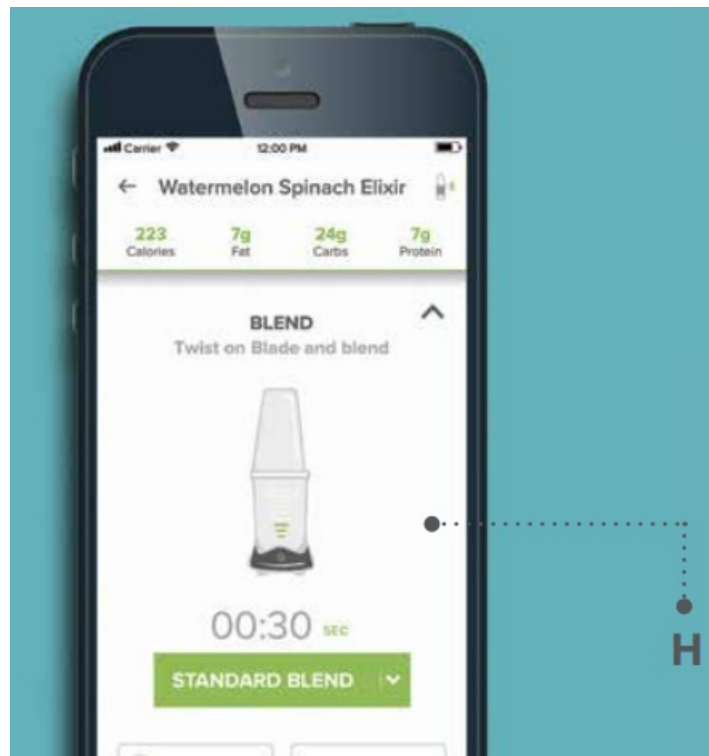

H. Wait until the timer stops.



I. Push and twist the **Cup** and **Blade** to the left to release them from the **Power Base**. Remove the **Blade**. Enjoy!



Manual Mode

You can use the NutriBullet Balance without using the Balance App. This is called Manual Mode. This mode is used for simply blending.

PLEASE NOTE: you will not get any nutritional information or data in Manual Mode.



To Blend:

1. Add ingredients to the **Colossal Cup**.
2. Add the liquid of your choice up to the **MAX** line. (**Liquid is required!** Ingredients **should not exceed** the MAX line!).

NOTE: The NutriBullet **Balance Cup** requires room to properly extract and blend the ingredients completely. Exceeding the **MAX** line may result in leakage.



3. Twist the **Extractor Blade** onto the **Colossal Cup** and hand-tighten to make sure the vessel has been sealed.



4. Fit the vessel **Blade-side** down onto the **Power Base**, aligning the actuator tabs. Press down to begin extraction, gently rotating the **Cup** clockwise to lock the cup in place. Extract for no longer than 1 minute. If more extraction is needed, wait 1 minute, then repeat the extraction process in 1-minute intervals up to three times as needed to achieve the desired consistency. If more than three 1-minute extractions are needed, allow the **Power Base** to cool for 2-3 minutes after the third extraction before beginning the next round.

NOTE: If the unit is not allowed to cool as instructed, a safety feature triggers that will power off the unit and temporarily render it non-functioning. To reset this safety feature, simply unplug the unit for 15 seconds and plug it back in. The unit will resume normal function.



5. To turn off the NutriBullet Balance — simply twist in the opposite direction (counter-clockwise) to release the tabs and stop pressing down on the **Cup**. Once the **Power Base** stops completely, remove the **Cup** from the **Power Base**.

CAUTION:

- Do not run the **Power Base** in excess of 1 minute per interval. Do not run the **Power Base** for more than three 1-minute intervals without allowing it to cool for 2-3 minutes after the third extraction. Running the motor for more than 1 minute consecutively in any interval may result in permanent damage to the **Power Base**.
- Friction from the rotating **Blade** when extracting can cause ingredients to heat and generate internal pressure in the sealed vessel. If the vessel is warm to the touch, allow it to cool before carefully opening is pointed away from your body.

Cleaning the NutriBullet Balance Smart Nutrition Sensor™ and Well

For the most part, the **Power Base** doesn't really get dirty, but if you neglect to twist the **Blade** onto the **Cup** tightly, liquids can leak out and get into the **Base** and actuator tabs. If this happens please use the following cleaning instructions.

Step 1: The most important thing is to **UNPLUG** the **Power Base** before cleaning!

Step 2: Make sure the **Blade** is not attached to the **Power Base**.



Step 3:

Remove the **Smart Nutrition Sensor™** from the Power Base.

**Step 4:**

Wipe the **Smart Nutrition Sensor™** with a damp cloth until clean.

NOTE: The **Smart Nutrition Sensor** is a delicately calibrated scale. Handle with care. If it is dropped or jarred it may damage the calibration causing it not to connect or detect the placement of the Cup. If this occurs, please contact customer service for assistance.

**Step 5:**

Wipe the well in the bottom of the **Power Base** with a damp cloth until clean.



Step 6:

Replace the **Smart Nutrition Sensor™** by lining up the arrow on the Disc to the arrow in the well of the Power Base. Gently press down until the Disc is level.

**Thank you for purchasing your NutriBullet Balance.
Enjoy!**



@nutribullet.NL / .SE / .DK / .NO / .FI / IT



/ nutribullet lifestyle

Imported & distributed by NutriBullet Retail, 1251 NA-11
the Netherlands

info@nutribulletretail.com
service@nutribulletretail.com
www.nuyriliving.shop

Documents / Resources



[nutribullet NB-205 Balance with Smart Nutrition Sensor and Bluetooth](#) [pdf] User Guide
NB-205, Balance with Smart Nutrition Sensor and Bluetooth

References

-  [Perfect Bake - Smart Scale | Perfect Company](#)
-  [nutribullet Personal Blenders: Small & Compact Single Serve Blenders](#)

-  [Perfect Bake - Smart Scale | Perfect Company](#)

[Manuals+](#), [home](#) [privacy](#)