

**Contents** [[hide](#)][1 NuPhy Air75_V3 Low Profile Keyboard](#)[2 Connection Mode Selection](#)[3 Backlight Settings](#)[4 Knob Installation Guide](#)[5 More Information](#)[6 FAQ](#)[6.1 Q. Why is Bluetooth not working for me?](#)[6.2 Q. Why is my Bluetooth connection spotty?](#)[6.3 Q. Why can't I connect with 2.4 GHz?](#)[6.4 Q. Why is my 2.4G connection unstable?](#)[6.5 Q. Some of my keys are not responding to presses/ typing on their own, what now?](#)[6.6 Q. NuPhyIO](#)[6.7 Q. How should I maximize my battery life?](#)[6.8 Q. Can I disable auto sleep mode?](#)[6.9 Q. Something is missing in my package](#)[7 Documents / Resources](#)[7.1 References](#)[8 Related Posts](#)

NuPhy Air75_V3 Low Profile Keyboard

USER GUIDE

Connection Mode Selection

○ Wired mode /

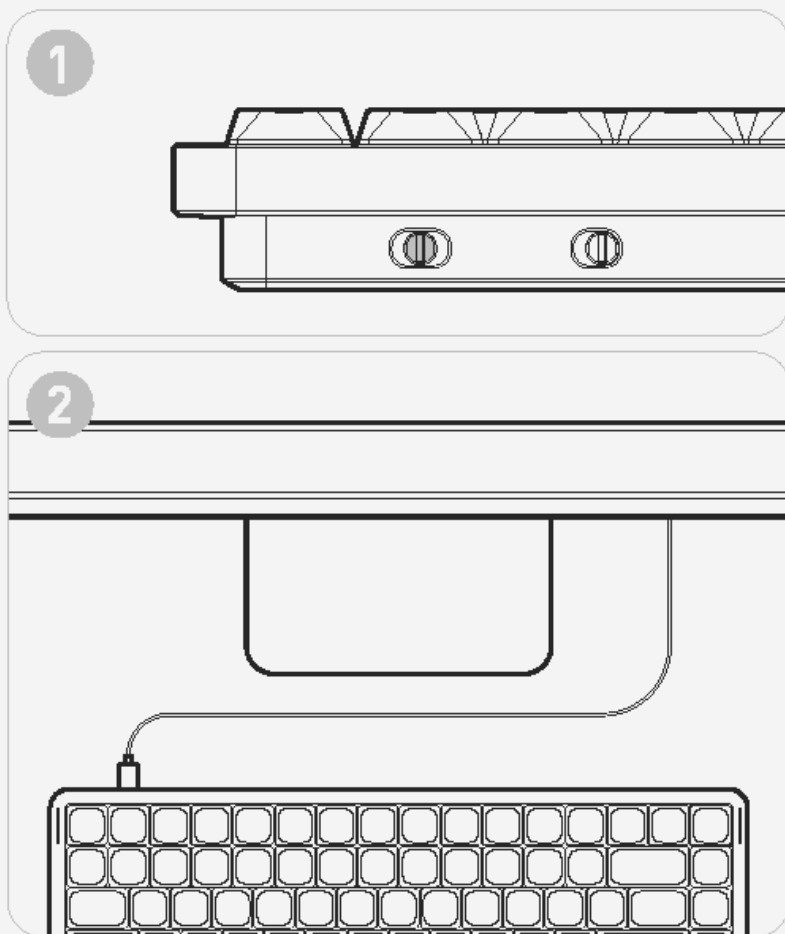

In the wired mode, it is necessary to use a data cable to connect with the device.

○ Bluetooth mode /

1

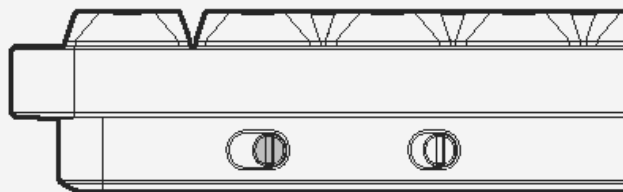

2

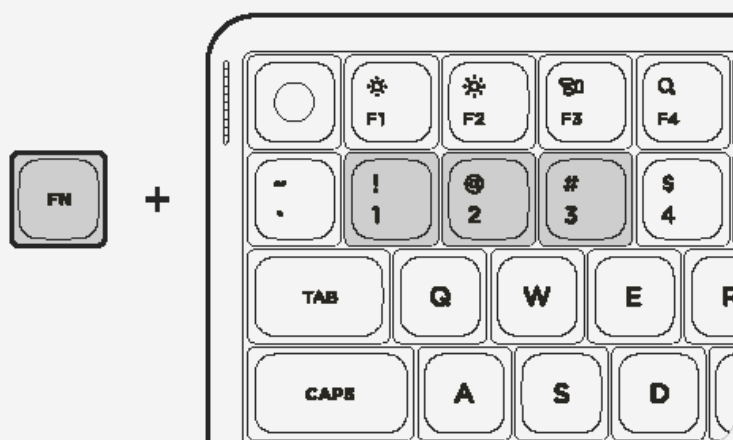

FN + 1 / 2 / 3 =
Bluetooth 1 / Bluetooth 2 / Bluetooth 3

○ 2.4G mode / 2.4G

1

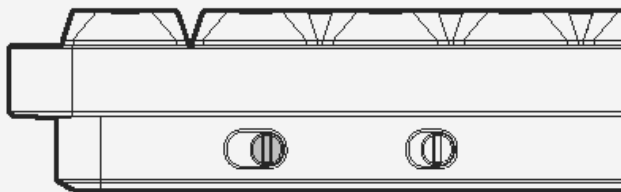

2



+

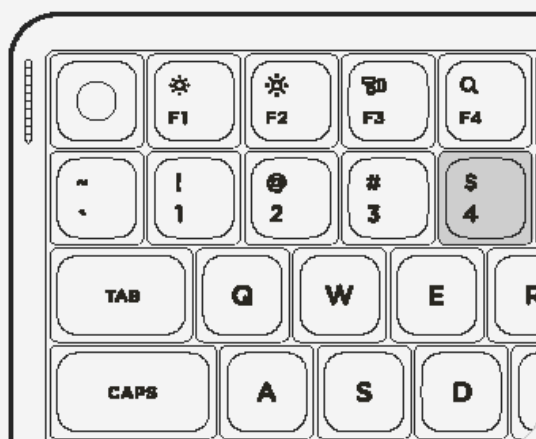

FN + 4

Backlight Settings

○ Brightness + –

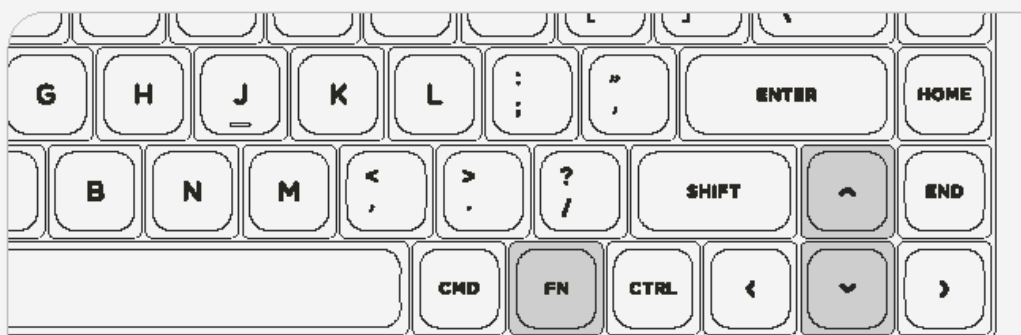

○ Backlight color switching /

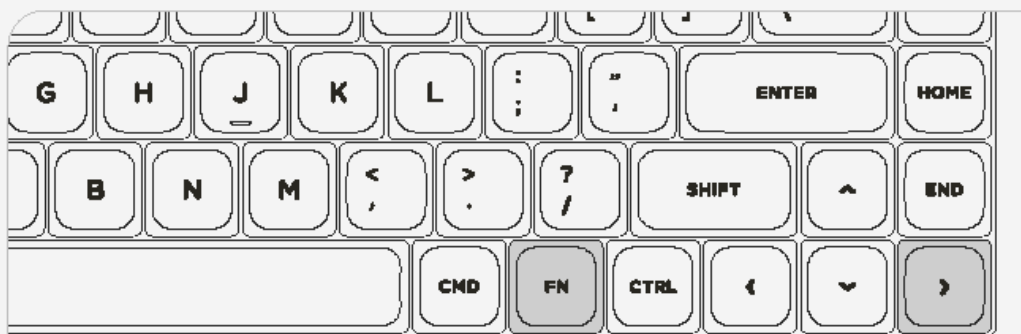

○ Backlight effect switching

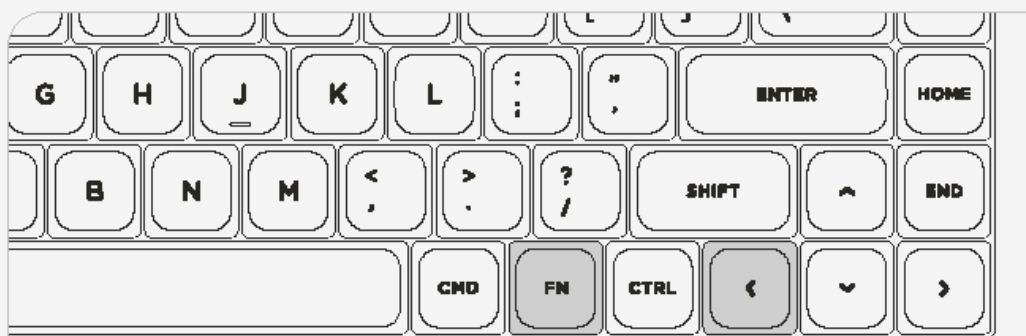

○ Backlight speed – +

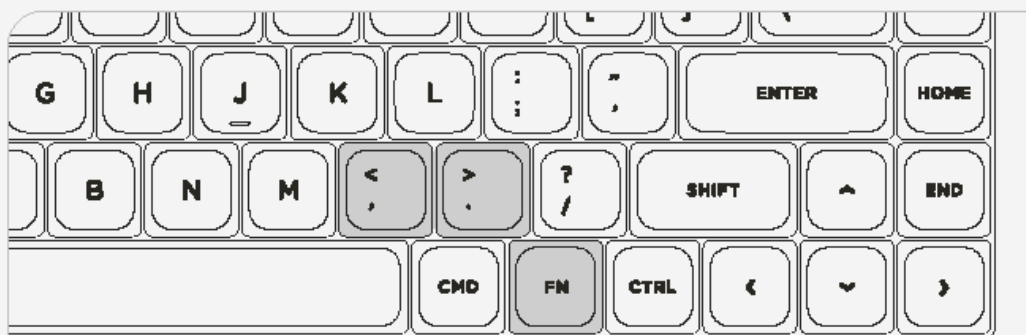

Knob Installation Guide

Accessories & Tools

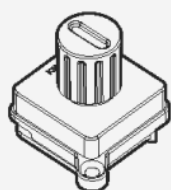

Knob Module x 1

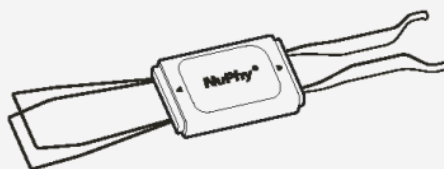

Keycap / Switch Puller x 1

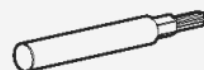

Screwdriver x 1

1

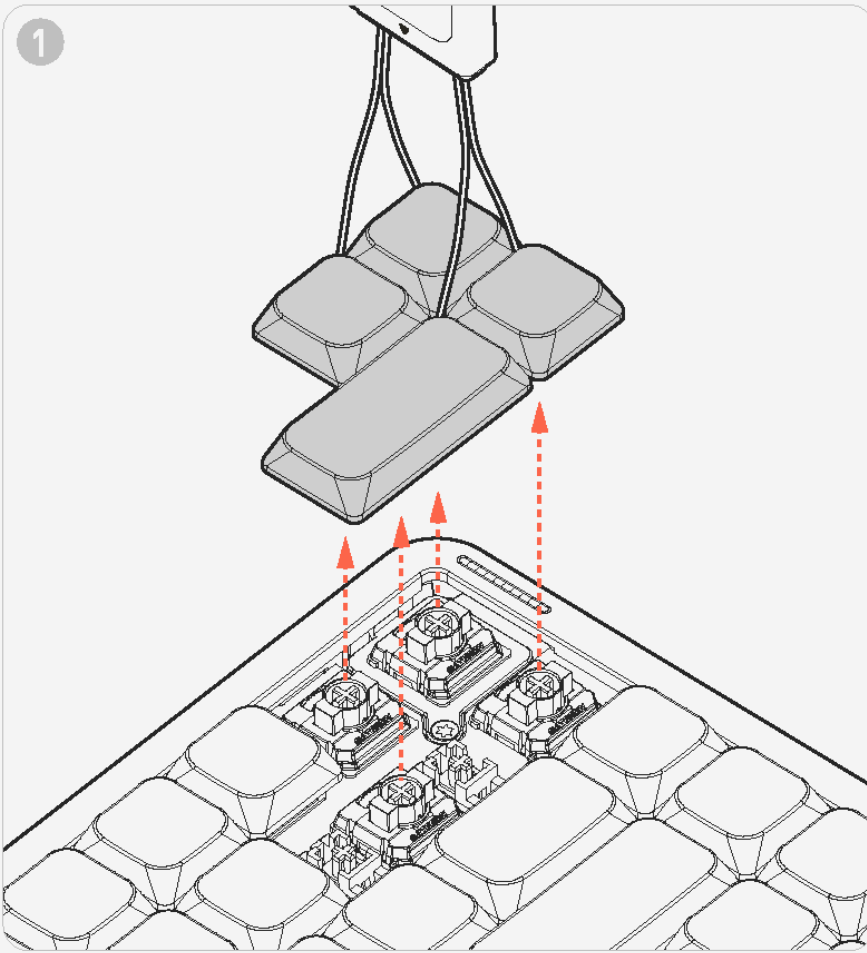

2

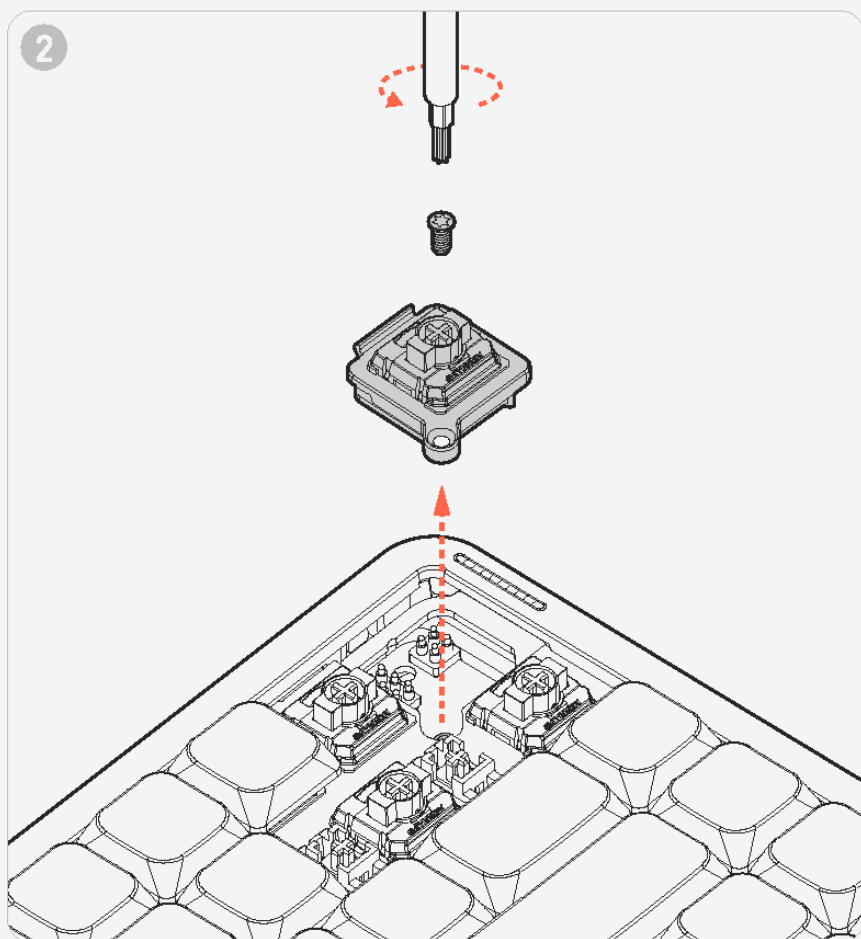

3

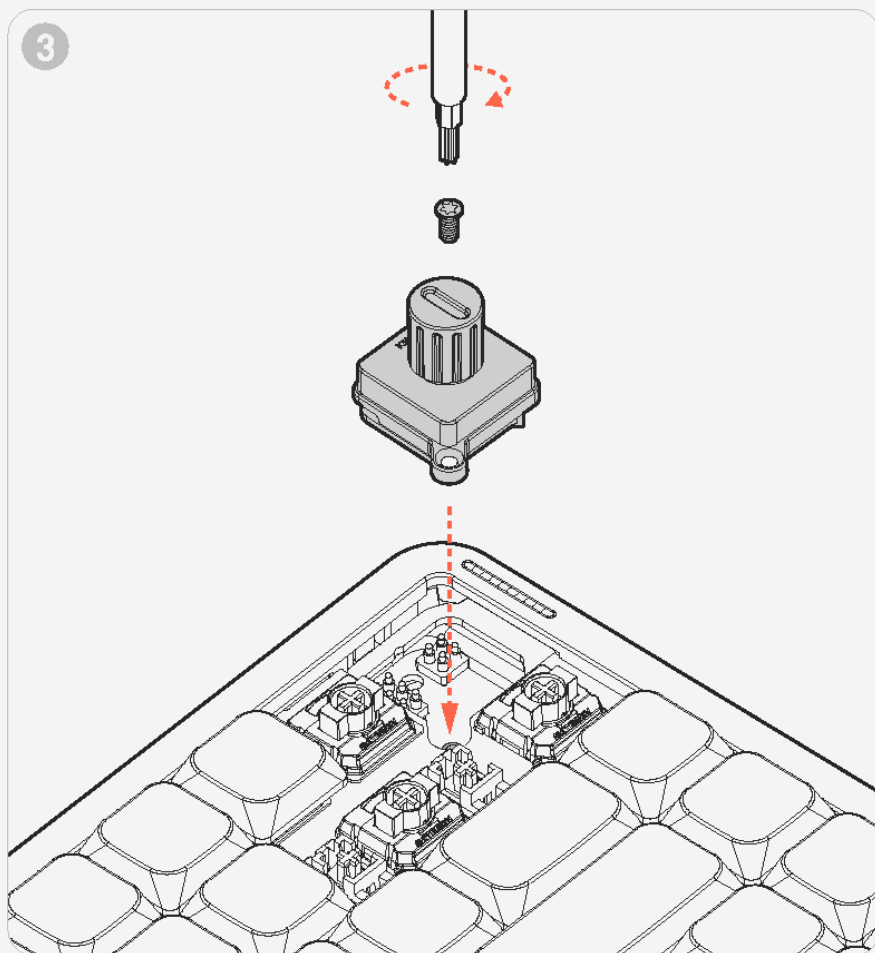

4

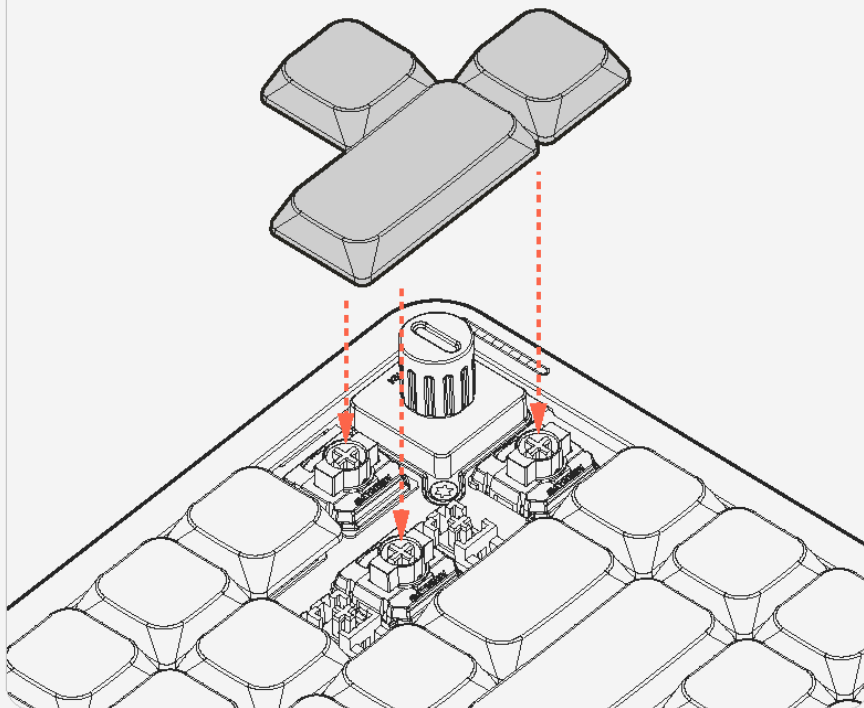

More Information

For more information, please scan the QR code below to see the complete manual.

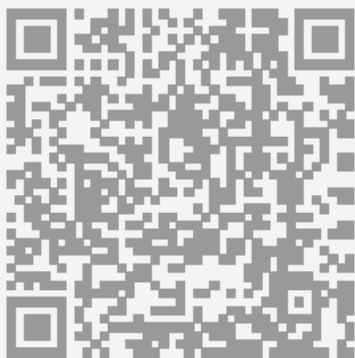

EN/JA/KO Manual

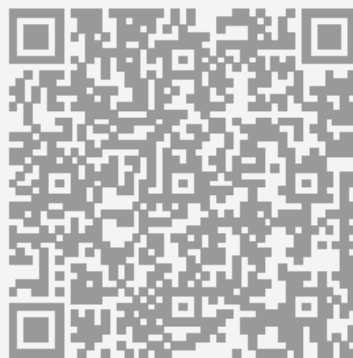

CN Manual

Q. Why is Bluetooth not working for me?

1. Check your history of connected devices to see if your keyboard is in it
2. Refer to the quick guide shipped with the keyboard and follow the relevant steps if it is not in the history.
3. Remove your keyboard from the list if it has been added before.
4. After (3)., turn the Bluetooth connection on your computer/keyboard off then back on, broadcast the device info from your keyboard, and complete the rest of the pairing process on your computer.

Q. Why is my Bluetooth connection spotty?

Try pairing again with the instructions provided in Q.01, if the problem persists, updating to the latest firmware may resolve you issue.

1. Navigate to `!!J.Qt]yjQ`.
2. Perform firmware update in the “Keyboard Settings” section of NuPhyIO.

Q. Why can't I connect with 2.4 GHz?

1. Set the keyboard to wireless mode;
2. Press FN+R (Air60 & Halo65) / FN+4 (Air75 & Air96 & Halo75 & Halo96) to enable the 2.4G channel, the wireless light bar on the upper-left corner should turn green, which will be maintained if the connection has been successfully established. If the green light slowly pulses, it is an indication the connection is being attempted, if the pulsing does not stop after 60 seconds try steps 3 and 4 to reestablish pairing;
3. Long press FN+R (Air60 & Halo65) / FN+4 (Air75 & Air96 & Halo75 & Halo96) for 3 seconds to enter the 2.4G pairing mode, the indicator will start blinking green;
4. Re-plug the 2.4G receiver, if the pairing is successful, the green indicator will remain lit;
5. Repeat step 3 and 4 a few times if you still fail to setup a stable connection.

Q. Why is my 2.4G connection unstable?

1. If possible, keep the 2.4G receiver away from other transmitters/receivers can help minimizing interferences;
2. Do not use the receiver with any hub with a metal case;

3. Try pairing again with the instructions provided in step 3 and 4 of Q.03.

Q. Some of my keys are not responding to presses/ typing on their own, what now?

1. Make sure your battery level hasn't dropped too low.
2. If the battery is well charged, try hot-swapping out the problematic switch, and swap in a replacement switch.

Q. NuPhyIO

Visit [IIIJPb¥jQ](#) to use the product with the web driver/ configurator. If for any reason your keyboard cannot be detected under the wired mode, feel free to contact our technical support.

Q. How should I maximize my battery life?

To maximize battery performance, we recommend turning off all the lighting effects when working under wireless for sustained periods of time, for maximum lifespan make sure you always charge the keyboard with a 5V / 1 A charger.

Q. Can I disable auto sleep mode?

Short press FN+] to enable/disable Auto-sleep.

Q. Something is missing in my package

Please contact us at service@nuphy.com to assist you.

Founded by a small team of passionate dreamers, NuPhy has always been at war with boredom and uninspiring designs.

Documents / Resources

	<p>NuPhy Air75_V3 Low Profile Keyboard [pdf] User Guide</p> <p>Air75_V3, Air75_V3 Low Profile Keyboard, Low Profile Keyboard, Profile Keyboard, Keyboard</p>
---	--

References

- [User Manual](#)

Related Posts



[NuPhy Air75 Mechanical Keyboard User Manual](#)

Air75 V2 KEYBOARD QUICK GUIDE & POSTER System
Selection win mode Mac mode Connection Mode
Selection Power Off...



[A4TECH FX60 Illuminate Low Profile Scissor Switch Keyboard User Guide](#)

A4TECH FX60 Illuminate Low Profile Scissor Switch
Keyboard Product Features Package Including Illuminate
Keyboard User Manual Windows/Mac OS...



[kogan com KAKYBDCPLTA Low Profile Wireless Keyboard User Guide](#)

kogan com KAKYBDCPLTA Low Profile Wireless
Keyboard COMPONENTS Wireless Keyboard USB
Receiver User Guide INSTALLATION Battery: Open the...



[A4TECH FX60H Fstyler Illuminate Low Profile Scissor Switch Keyboard User Guide](#)

A4TECH FX60H Fstyler Illuminate Low Profile Scissor
Switch Keyboard Product Specifications Illuminate Low
Profile Scissor Switch Keyboard Win/Mac...

📌 Air75_V3, Air75_V3 Low Profile Keyboard, Keyboard, Low Profile Keyboard, NuPhy, Profile

📁 NuPhy Keyboard

—

Leave a comment

Your email address will not be published. Required fields are marked *

Comment *

Name

Email

Website

☐ Save my name, email, and website in this browser for the next time I comment.

Post Comment

Search:

e.g. whirlpool wrf535swhz

Search

[Manuals+](#) | [Upload](#) | [Deep Search](#) | [Privacy Policy](#) | [@manuals.plus](#) | [YouTube](#)

This website is an independent publication and is neither affiliated with nor endorsed by any of the trademark owners. The "Bluetooth®" word mark and logos are registered trademarks owned by Bluetooth SIG, Inc. The "Wi-Fi®" word mark and logos are registered trademarks owned by the Wi-Fi Alliance. Any use of these marks on this website does not imply any affiliation with or endorsement.