



Numark PT02 Record Player User Manual

[Home](#) » [Numark](#) » Numark PT02 Record Player User Manual 

Numark

Record Player
PT02 User Manual

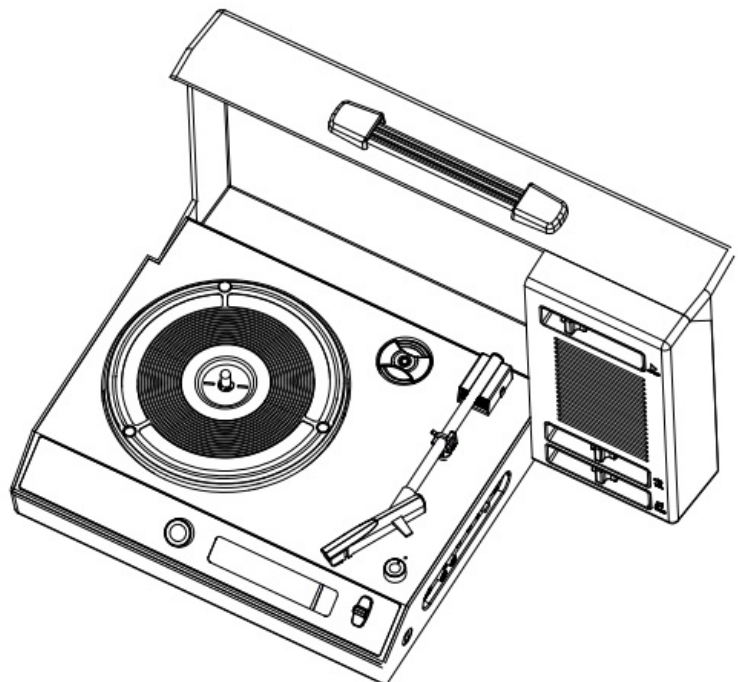
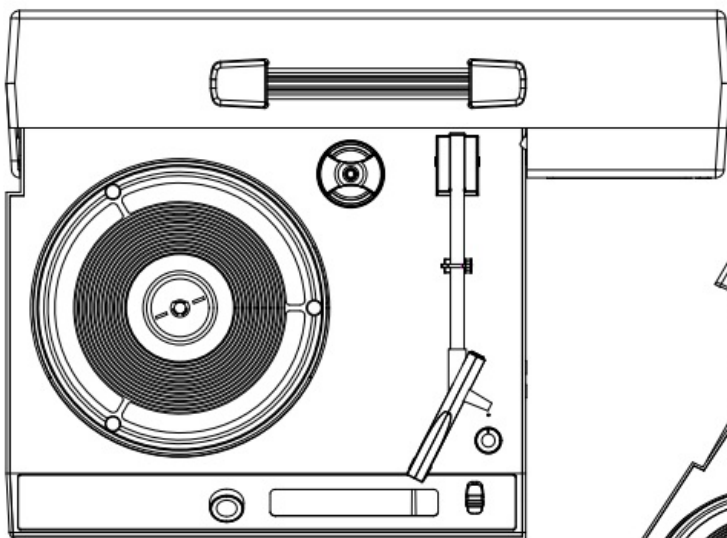

READ INSTRUCTIONS CAREFULLY BEFORE USE AND STORE

IN A SAFE PLACE FOR FUTURE REFERENCE

Contents

1 BASIC OPERATIONS

2 Safety Instructions

3 Initial Setup

4 Radio Operation

**5 Documents /
Resources**

BASIC OPERATIONS

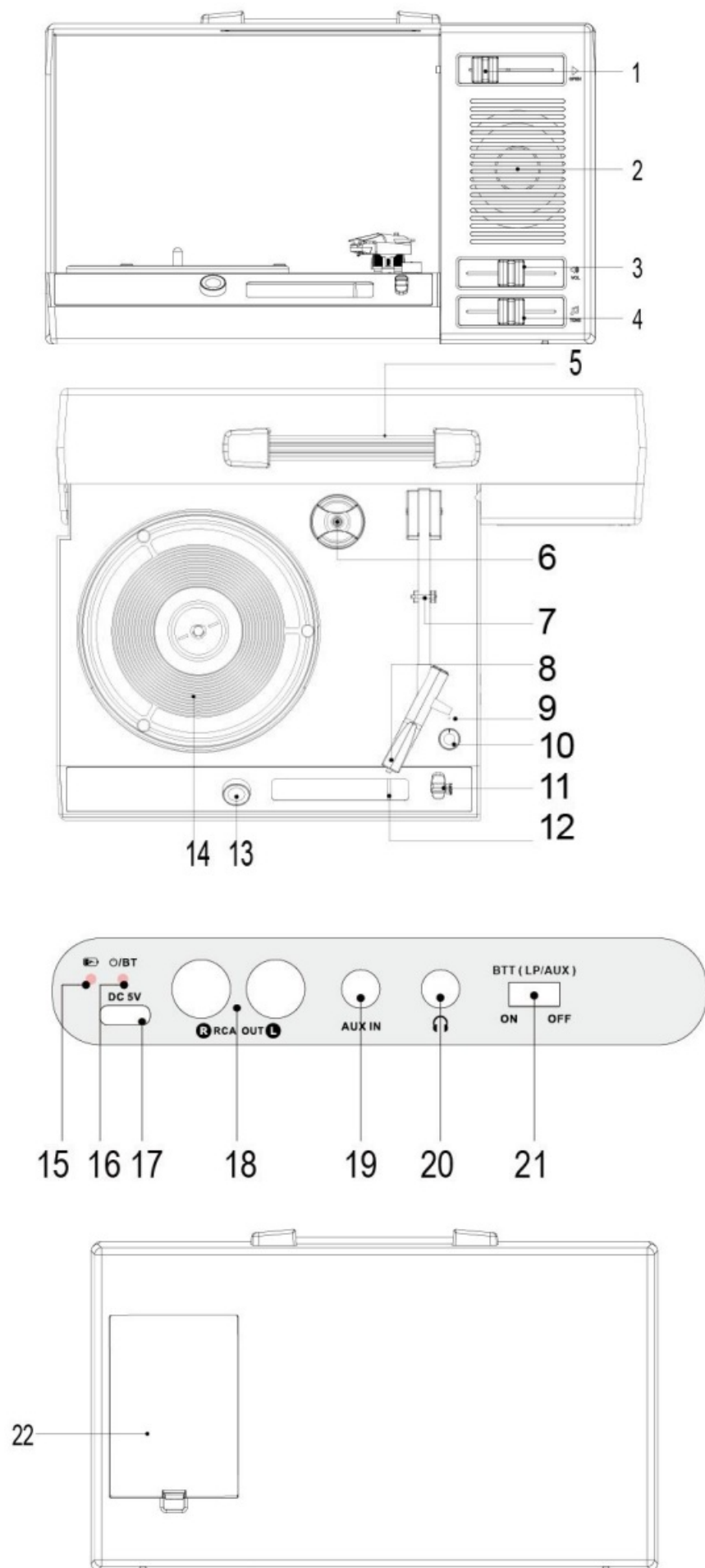

1. Open Slider.
2. Speaker

3. VOL control slider.
4. Tone Control slider
5. Handle
6. 45RPM records adaptor
7. Tone Arm lock clip
8. Stylus Cartridge
9. Speed indication LED
 - 33 RPM: Green Light
 - 45 RPM: Red Light
10. Speed Selector button 33/45rpm
11. Power Off / Function Switch
12. Radio Frequency Band
13. Tuning Knob
14. Turntable platter

Side Panel

15. Charging Indicator
16. Power / Bluetooth Indicator
17. USB-C Type Power Jack
18. RCA Line out jack
19. Aux In Jack
20. Headphone Jack
21. Bluetooth Transmitter (Available in LP and Aux Mode)
22. USB cable storage Cabinet

Safety Instructions

Read and understand this entire manual before using this product. Keep these instructions for future reference.

1. Do not use this product near water.
2. This product should be operated only by the type of power source indicated on the marking label or in this instruction manual.
3. Do not defeat the safety purpose of the polarized plug. A polarized plug has two blades with one blade wider than the other. This plug will fit into the power outlet only one way. If you are unable to insert the plug fully into the outlet try reversing the plug. If the plug should still fail to fit, contact your electrician.
4. Protect the power cord from being walked on or pinched particularly at plugs, convenience receptacles, and the point where they exit from the product.
5. Do not overload wall outlets, extension cords, or integral convenience receptacles as this can result in a risk of fire or electric shock.
6. Never push objects of any kind into this product through openings as they may touch dangerous voltage points or short-out parts that could result in a fire or electric shock. Never spill liquid of any kind on the product.
7. Do not attempt to service this product yourself as opening or removing covers may expose you to dangerous voltage or other hazards. Refer all servicing to qualified service personnel.
8. Changes or modifications to this unit not expressly approved by the party responsible for compliance could void the user's authority to operate the equipment.

9. Do not use attachments not recommended by the product manufacturer as they may cause hazards.
10. A product and cart combination should be moved with care. Quick stops, excessive force, and uneven surfaces may cause the product and cart combination to overturn.
11. Slots and openings in the cabinet are provided for ventilation and to ensure reliable operation of the product and to protect it from overheating. Do not block or cover these openings.
12. Unplug the product during lightning storm or when unused for long periods of time.

Items in this package

Before throwing away any packaging materials, please check thoroughly and make sure you find the following items that come along with this package:

- Turntable
- 45 RPM adapter
- USB Charging cable
- Manual

Initial Setup

Essential Setup

1. Place the unit on a flat and level surface. The selected location should be stable and free from vibration.
2. Remove the tie-wrap that is holding the tonearm.
3. CONNECT TO POWER (Suggest 5V 2A adaptor) This unit comes with built-in rechargeable battery. The battery capacity is 3000 mAh.

Your turntable ships with a partial charge. Before using your turntable for the first time, connect it to an AC (mains) outlet. Your turntable does not need to be fully charged, but it does require the initial connection to activate the battery.

NOTE: If necessary, plug the AC adapter for your region into the AC (mains) outlet. The battery light red. When fully charged, battery indication light glows green.

Note: Before turning the power on, make sure again all the connection settings are correct. Always turn off the power when connecting or disconnecting.

Stereo System Connection

RCA Jacks

- The RCA Jacks output analog line-level signals and could be connected directly with a pair of active/powered speakers or the appropriate input of your stereo system.
- The Red plug connects with the Right channel and the White plug connects with the Left channel.

Note: The RCA Jacks are not designed to be connected directly to the passive/unpowered speakers. If connected to the passive speakers, the volume level will be very low.

Aux Input Connection

You can connect an audio device to this unit and play your music through its speakers. To do this, connect the 3.5mm auxiliary cable between your audio device and the Aux In Jack of this unit and start playing the music.

Note:

The aux in connection will automatically override the other functions. To resume using the turntable or Bluetooth functions, unplug the auxiliary cable from the auxin jack.

Turntable Operation

1. Set the Function Switch to PHONO position.
2. Set the correct Speed button accordingly.
3. Place the record on the turntable. Use the 45 RPM Adapter if necessary.
4. Remove the stylus protector from the stylus assembly.

Note: To avoid stylus damage, make certain the included stylus guard is in place whenever the turntable is being moved or cleaned.

5. Release the tonearm Hold Down Clip.

Note: When the turntable is not in use, remember to lock back hold down clip.

6. Gently move the tonearm over the record where play is desired to begin, put down the tonearm slowly onto the record and begin to playback.
7. When the record is finished playing, raise the tonearm and then return it to the Tonearm Rest..
8. Lock the Hold Down Clip to secure the tonearm.

Pitch Control

The turntable speed can be increased or decreased by approximately 10% by Sliding the Pitch control switch. To increase the speed, turn the Pitch Control to Right side. To decrease the speed, turn the pitch slider to Left side.

Needle Replacement

Removing Needle

1. Gently pull down the front edge of the needle.
2. Pull needle forward.
3. Pull out and remove

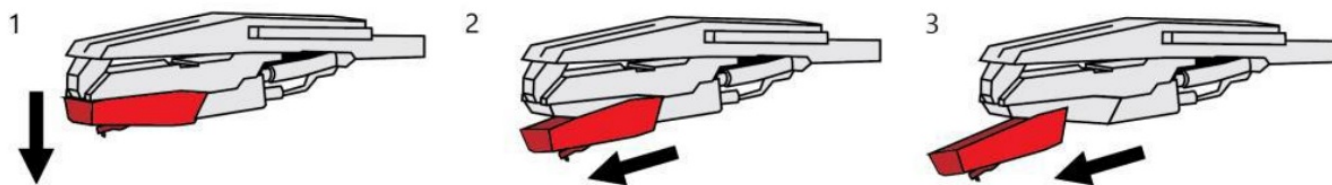

Installing Needle

1. Position the needle with its tip facing down.
2. Line up the back of the needle with the cartridge.
3. Insert the needle with its front end at a downward angle and gently lift the front of the needle upward until it snaps into place.

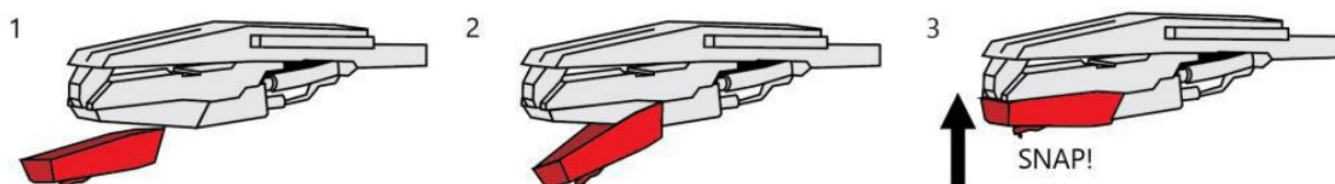

Bluetooth Operation

1. Set the Function Switch to Bluetooth mode .

Note: The function indicator will be flashing blue.

2. Turn on the Bluetooth feature of your audio device, search for “PT02” and pair.
3. Once your device is successfully paired with the unit, you will hear a short confirmation sound from the unit, and the function indicator will be blue.
4. Play and stream music from your device to the unit.

Note: Bluetooth version – 5.0

Bluetooth Output Operation

This turntable features Bluetooth output which is a device that transmits audio from this turntable to another Bluetooth device such as wireless Bluetooth headphones, Bluetooth speakers, or other Bluetooth receiving devices.

1. Place the audio device that supports Bluetooth technology as close to your turntable as possible.
2. Set the turntable's Bluetooth output BTT (at side panel) switch “ON” during playing LP/AUX.
Note: The function indicator will slowly flash blue.
3. Set the device that you would like to connect to pairing mode.
4. Your turntable will connect automatically to your audio device once they are both in pairing mode.
5. When the pairing is complete, the function indicator will be solid blue.

Note: If pairing is unsuccessful, make sure your audio device is not paired/connected to another Bluetooth device.

Radio Operation

1. Set the Function Switch to AM or FM
2. Rotate the Tuning Knob for desired radio station.

Note:

The unit is equipped with a FM wire antenna. To improve FM reception, fully extend and move the wire around until the reception is clear without interferences. Do not connect the wire to any additional antenna.

The AM antenna is built inside the unit. If AM reception is poor, try to rotate the unit for better reception.

FCC Statement

This equipment has been tested and found to comply with the limits for a Class B digital device, pursuant to Part 15 of the FCC Rules. These limits are designed to provide reasonable protection against harmful interference in a residential installation. This equipment generates uses and can radiate radio frequency energy and, if not installed and used in accordance with the instructions, may cause harmful interference to radio communications. However, there is no guarantee that interference will not occur in a particular installation. If this equipment does cause harmful interference to radio or television reception, which can be determined by turning the equipment off and on, the user is encouraged to try to correct the interference by one or more of the following measures:

- Reorient or relocate the receiving antenna.
- Increase the separation between the equipment and receiver.
- Connect the equipment into an outlet on a circuit different from that to which the receiver is connected.
- Consult the dealer or an experienced radio/TV technician for help.

This device complies with part 15 of the FCC Rules. Operation is subject to the following two conditions:

(1) This device may not cause harmful interference, and (2) this device must accept any interference received, including interference that may cause undesired operation.

Changes or modifications not expressly approved by the party responsible for compliance could void the user's authority to operate the equipment

This equipment complies with FCC radiation exposure limits set forth for an uncontrolled environment. This equipment should be installed and operated with minimum distance 20cm between the radiator & your body.
FCC ID:2A6JN-PT02
IC STATEMENT
This device contains licence-exempt transmitter(s)/receiver(s) that comply with Innovation, Science and Economic Development Canada's licence-exempt RSS(s). Operation is subject to the following two conditions :

- 1. This device may not cause interference.
- 2. This device must accept any interference, including interference that may cause undesired

IC:29048-PT02

HVIN PT-02

Numark

Documents / Resources

 <p>Record Player PT02 User Manual</p> <p>READ INSTRUCTIONS CAREFULLY BEFORE USE AND STORE</p>	<p>Numark PT02 Record Player [pdf] User Manual 2A6JN-PT02, 2A6JNPT02, pt02, PT02 Record Player, Record Player, Player</p>
--	---