



# NOUS-A1-1 WiFi Smart Socket Instruction Manual

[Home](#) » [NOUS](#) » NOUS-A1-1 WiFi Smart Socket Instruction Manual 

## NOUS-A1-1 WiFi Smart Socket Instruction Manual



### Contents

- [1 How to add your device to the Nous Smart app](#)
- [2 How to connect your device with Alexa](#)
- [3 How to connect your device with Google Home](#)
- [4 How to disconnect and wipe all data](#)
- [5 Documents / Resources](#)
  - [5.1 References](#)

**How to add your device to the Nous Smart app**

1. Plug in the device
2. Make sure that indicator is blinking rapidly(if not, hold power button for 5 seconds untill it starts blinking fast)
3. Turn on Bluetooth and Location on your phone(temporarily)
4. Open Nous Smart app
5. Press + and Add device
6. Autoscan will appear and it will suggest you to add new device
7. Confirm connection and your WiFi network data
8. Start pairing
9. After pairing is done, you can rename your device if you wish and its ready to be used
10. If autoscan does not see your device, you can pick it manually from the list and proceed to connection from step number 7.

## How to connect your device with Alexa

1. You have to have Alexa app on your smartphone
2. Go to settings and press "Skill and Games"
3. Search for the Nous Smart Home skill
4. Enable it
5. Link your Nous account with Alexa
6. Ask Alexa to discover new devices

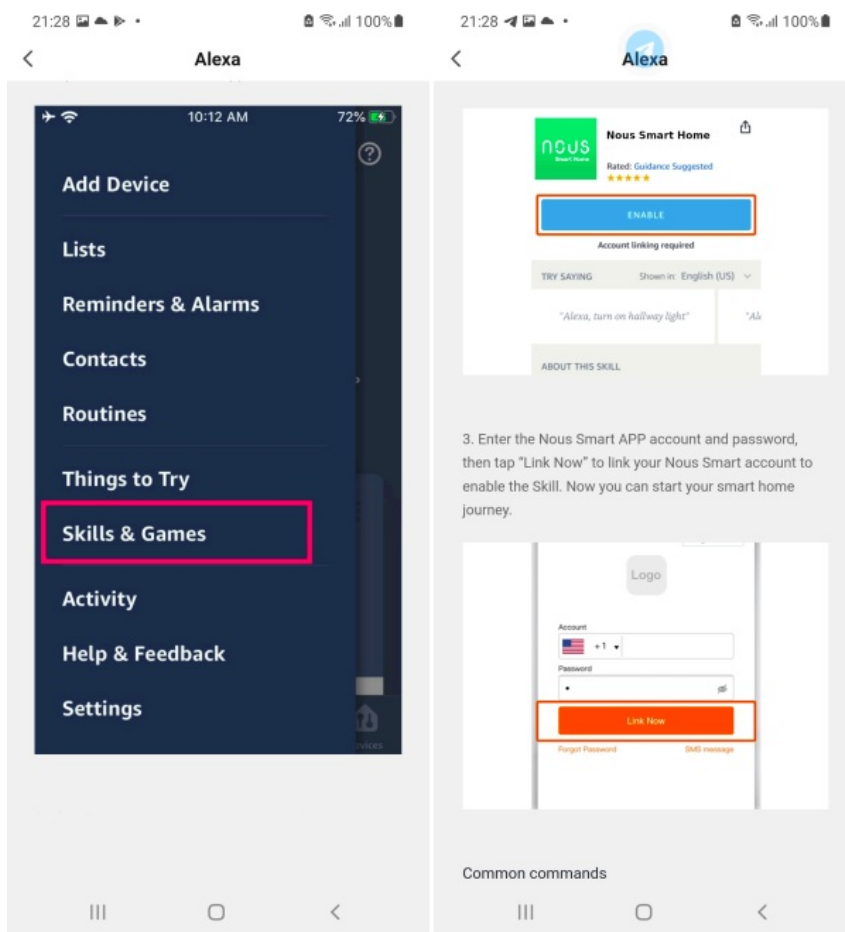

## How to connect your device with Google Home

1. You have to have Google Home app on your smartphone

2. Go to the home settings and press “works with google”
3. Search for the Nous Smart Home
4. Link the account with the Google Home
5. All devices from Nous Smart app will appear in Google Home after synchronization

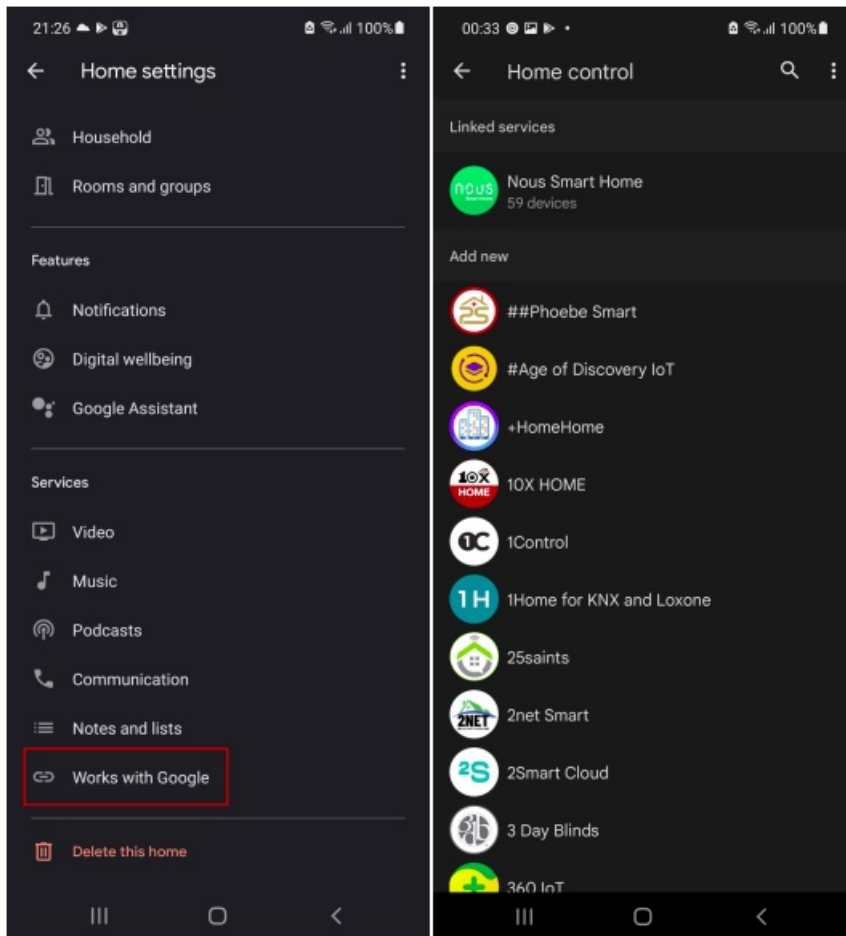

## How to disconnect and wipe all data

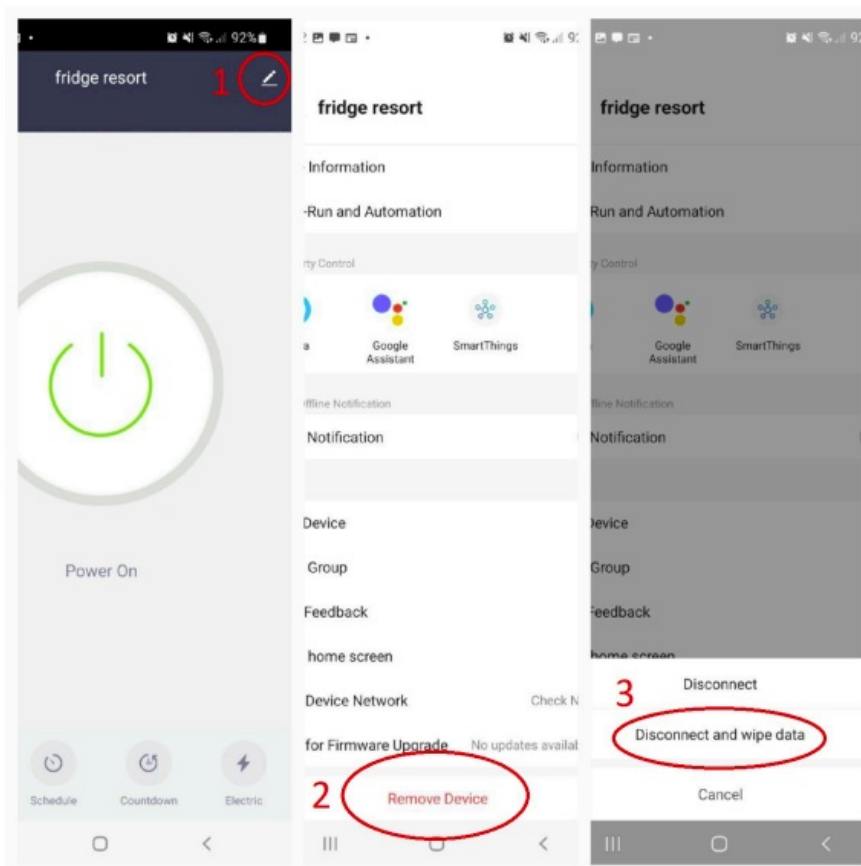

### Instruction manual

#### Smart WiFi Socket Nouis A1

You will need Nouis Smart Home App. Scan the QR code or download it from direct link



# nouis

<div><div>Instruction manual</div><div>Smart WiFi Socket Nouis A1</div><div></div><div>How to add your device to the Nouis Smart app</div><div><div>1. Download the Nouis Smart app from the App Store or Google Play.</div><div>2. Open the app and tap on the plus icon in the bottom right corner.</div><div>3. Tap on the QR code to add the device.</div><div>4. Follow the instructions on the screen to complete the setup.</div><div>5. Once the device is added, you can control it from the app.</div></div><div>How to connect your device with</div></div>	<div><div>Nouis <b>NOUS-A1-1 WiFi Smart Socket</b> [pdf] Instruction Manual</div><div>NOUS-A1-1 WiFi Smart Socket, NOUS-A1-1, WiFi Smart Socket, Smart Socket, Socket</div></div>
---	---

References

-  [Nouis Smart](#)