

# nous L13 Smart WiFi Switch Module Instruction Manual

[Home](#) » [NOUS](#) » nous L13 Smart WiFi Switch Module Instruction Manual 

### Contents

- 1 nous L13 Smart WiFi Switch Module
- 2 Product Information
- 3 Product Usage Instructions
- 4 OVERVIEW
- 5 How to wire
- 6 How to add your device to the Nous Smart app
- 7 Documents / Resources
  - 7.1 References
- 8 Related Posts



## nous L13 Smart WiFi Switch Module

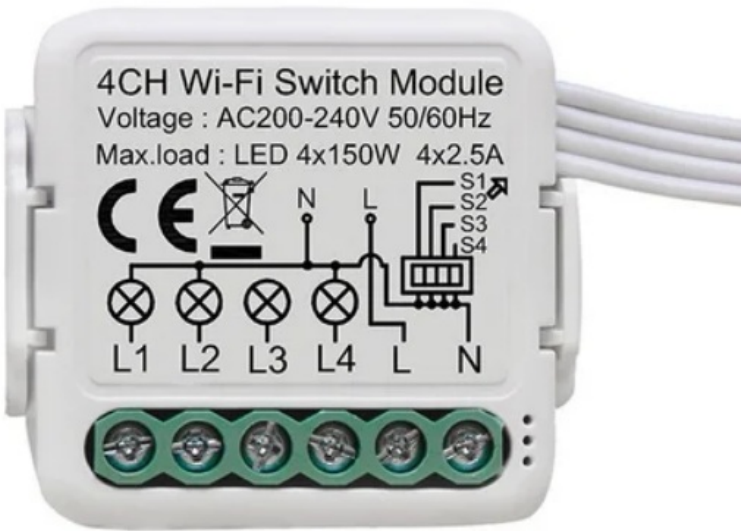

### Product Information

## Specifications

- **Product:** Smart WiFi Switch Module L13
- **Required App:** Nous Smart Home App

## Product Usage Instructions

### How to Wire

1. [Step 1]
2. [Step 2]

### How to Add Your Device to the Nous Smart App

1. Power on the device
2. Make sure that the indicator is blinking rapidly. If not, hold the power button for 5 seconds until it starts blinking fast.
3. Turn on Bluetooth and Location on your phone temporarily.
4. Open the Nous Smart app.
5. Press “+” and select “Add device”.
6. Autoscan will appear and suggest adding a new device.
7. Confirm the connection and enter your WiFi network data.
8. Start pairing.
9. After pairing is done, you can rename your device if you wish. It is now ready to be used.
10. If the auto scan does not detect your device, you can manually select it from the list and proceed with the connection from step number 7.

### How to Connect Your Device with Alexa

1. You need to have the Alexa app on your smartphone.
2. Go to settings and select “Skill and Games”.
3. Search for the “Nous Smart Home” skill.
4. Enable the skill.
5. Link your Nous account with Alexa.
6. Ask Alexa to discover new devices.

### How to Connect Your Device with Google Home

1. You need to have the Google Home app on your smartphone.
2. Go to the home settings and select “Works with Google”.
3. Search for “Nous Smart Home”.
4. Link your account with Google Home.
5. All devices from the Nous Smart app will appear in Google Home after synchronization.

## FAQ

### Q: How do I wire the Smart WiFi Switch Module L13?

- **A:** Please follow the wiring instructions provided in the user manual.

### Q: How do I add my device to the Nous Smart app?

- **A:** Follow the steps outlined in the user manual under the “How to Add your Device to the Nous Smart App” section.

### Q: How do I connect my device with Alexa?

- **A:** Refer to the user manual’s “How to Connect your Device with Alexa” section for detailed instructions.

### Q: Can I connect my device with Google Home?

- **A:** Yes, you can. The user manual provides instructions on how to connect your device with Google Home in the section titled “How to Connect your Device with Google Home”.

## Smart WiFi Switch Module L13

- You will need the Nous Smart Home App. Scan the QR code or download it from direct link



## OVERVIEW

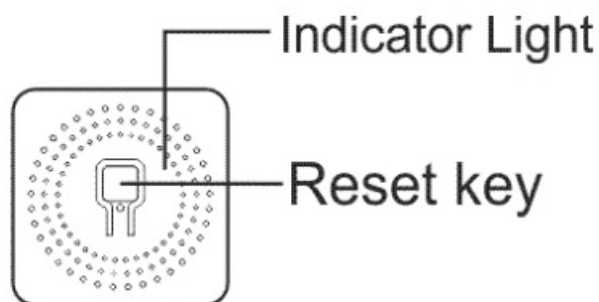

## How to wire

## 1 gang

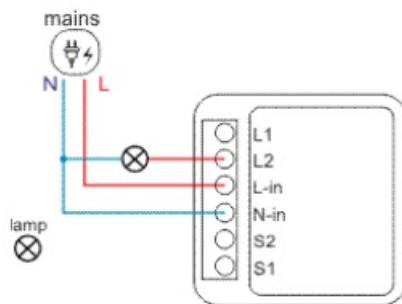

## 2 gang

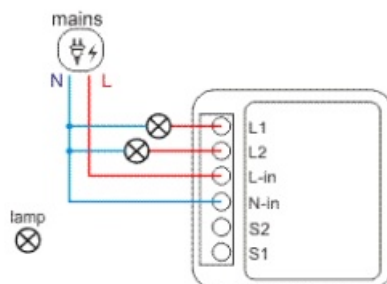

## 2 gang 1 way

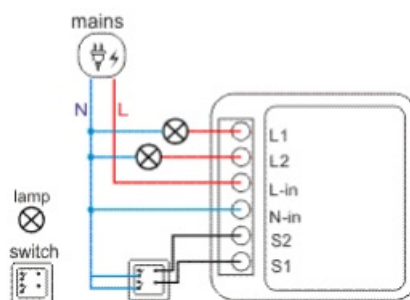

### How to add your device to the Nous Smart app

1. Power on the device
2. Make sure that the indicator is blinking rapidly(if not, hold the power button for 5 seconds until it starts blinking fast)
3. Turn on Bluetooth and Location on your phone(temporarily)
4. Open the Nous Smart app
5. Press + and Add device
6. Autoscan will appear and it will suggest you add the new device
7. Confirm connection and your WiFi network data
8. Start pairing
9. After pairing is done, you can rename your device if you wish and it's ready to be used
10. If autos can not see your device, you can pick it up manually from the list and proceed to connection from step number 7.

### How to connect your device with Alexa

1. You have to have the Alexa app on your smartphone
2. Go to settings and press “Skill and Games”
3. Search for the Nous Smart Home skill
4. Enable it
5. Link your Nous account with Alexa
6. Ask Alexa to discover new devices

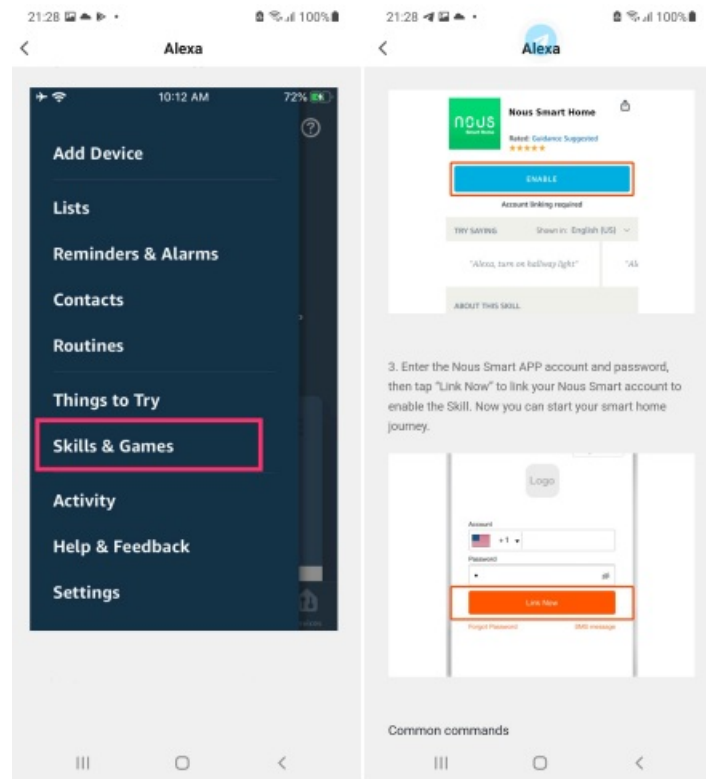

## How to connect your device with Google Home

1. You have to have the Google Home app on your smartphone
2. Go to the home settings and press “works with Google”
3. Search for the Nous Smart Home
4. Link the account with the Google Home
5. All devices from the Nous Smart app will appear in Google Home after synchronization

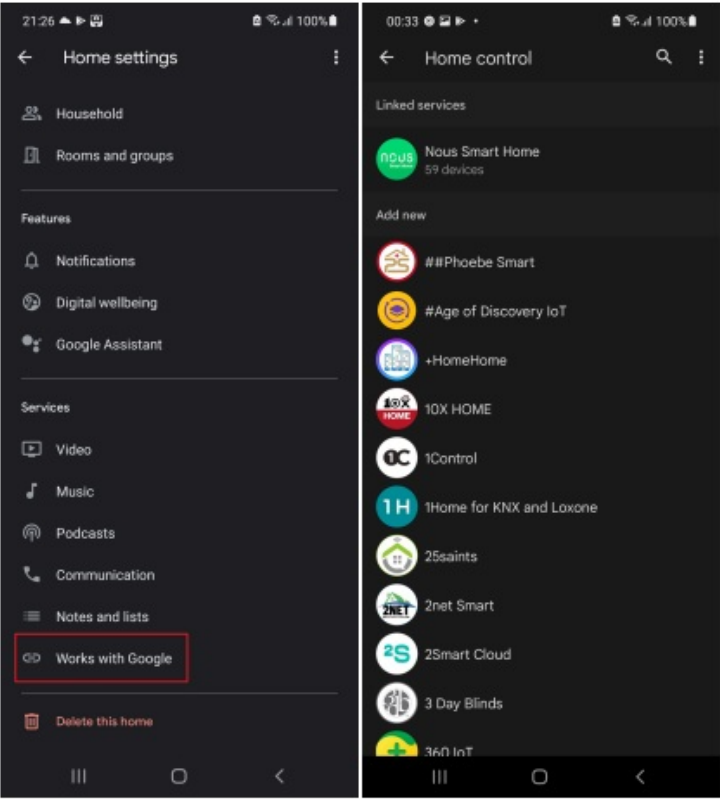

Documents / Resources

<div><div>Instruction manual</div><div>Smart WiFi Switch Module L13</div><div></div><div><div>Indicator Light</div><div>Reset key</div></div><div>How to wire</div></div>	<div><a href="#">nous L13 Smart WiFi Switch Module</a> [pdf] Instruction Manual</div> <div>L13 Smart WiFi Switch Module, L13, Smart WiFi Switch Module, WiFi Switch Module, Switch M odule, Module</div>
<div><div>Instruction manual</div><div>Smart WiFi Switch Module L13</div><div></div><div><div>Indicator Light</div><div>Reset key</div></div><div>How to wire</div></div>	<div><a href="#">nous L13 Smart WiFi Switch Module</a> [pdf] Instruction Manual</div> <div>L13 Smart WiFi Switch Module, L13, Smart WiFi Switch Module, WiFi Switch Module, Switch M odule, Module</div>

References

- [Nous Smart](#)
- [User Manual](#)