



## nous E1 Smart Gateway Instruction Manual

[Home](#) » [NOUS](#) » nous E1 Smart Gateway Instruction Manual 

nous E1 Smart Gateway Instruction Manual

# INSTRUCTION MANUAL

## Wireless Gateway/Hub E1

You will need Nous Smart Home App. Scan the QR code or download it from [direct link](#)



<https://a.smart321.com/noussmart>

## Contents

### 1 Know about the Smart Gateway

#### 1.1 Wi-Fi LED(RED)

#### 1.2 Button

#### 1.3 Zigbee LED(Blue)

### 2 Quick Installation Guide

### 3 Documents / Resources

#### 3.1 References

## Know about the Smart Gateway

This smart gateway, adopting super low power consumption Zigbee technology, can work with kinds of smart sensors and smart home appliances to build a smart home system and the gateway works as the central controller. Built-in Wi-Fi module support direct connection to user's home Wi-Fi network.

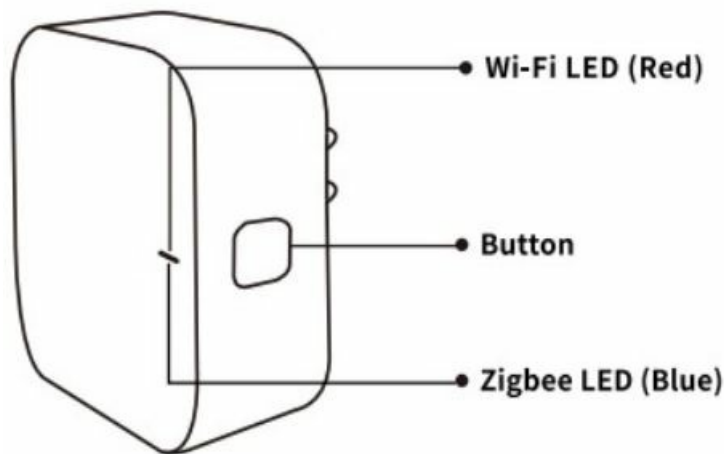

### Wi-Fi LED(RED)

Blinking: The gateway enters wi-fi configuration mode

OFF: No network connection

ON: Connected to the wi-fi network

### Button

Reset or enter Wi-fi configuration mode : Press andhold the button for 5 seconds until the RED LED blinks, the gateway will enter Wi-fi configuration mode

### Zigbee LED(Blue)

Blinking: The gateway enters Zigbee network configuration mode(preparing to add subdevice) OFF: The gateway is under standby status

## Quick Installation Guide

- (If you have installed the NOUS Smart Home on your mobile phone, please go to step 2) Scan QR code or search NOUS Smart Home in APP Store or Google Play to install APP(new user must register account first)
- Connect mobile phone to your 2.4GHz Wi-Fi router (with internet) and plug in the Smart Gateway to outlet. Run

NOUS Smart Home APP, Click"+" at the top right corner (select Gateway and Others-> Wireless Gateway(zigbee))

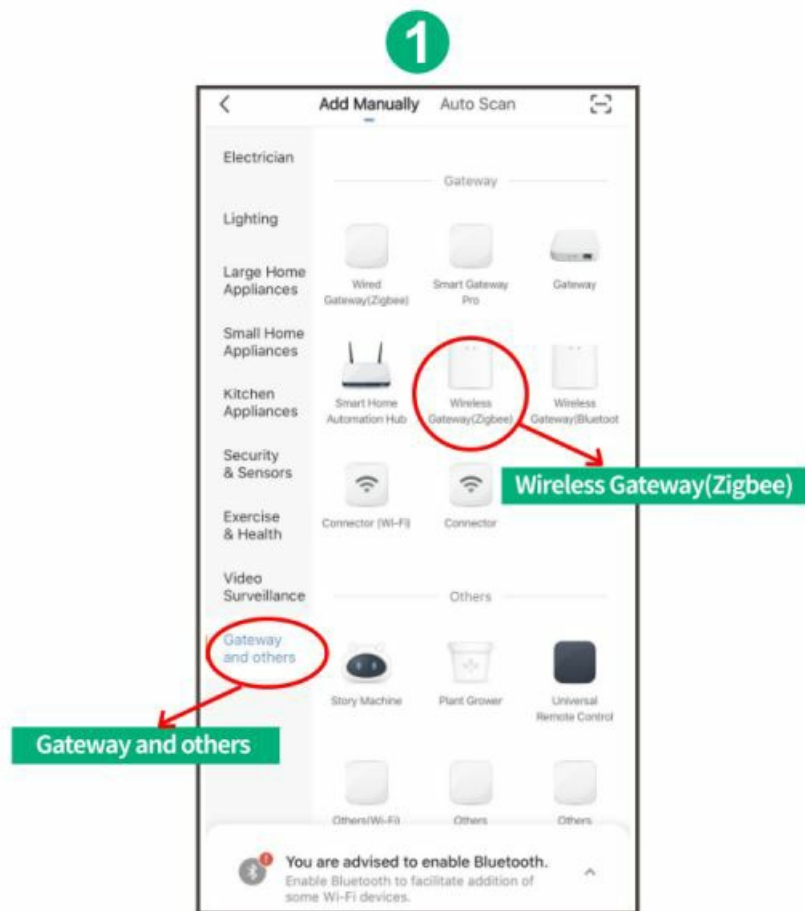

- Pressing the button for 5 seconds until the red LED blinks, then follow the in-app instructions to connect the smart gateway to your network.

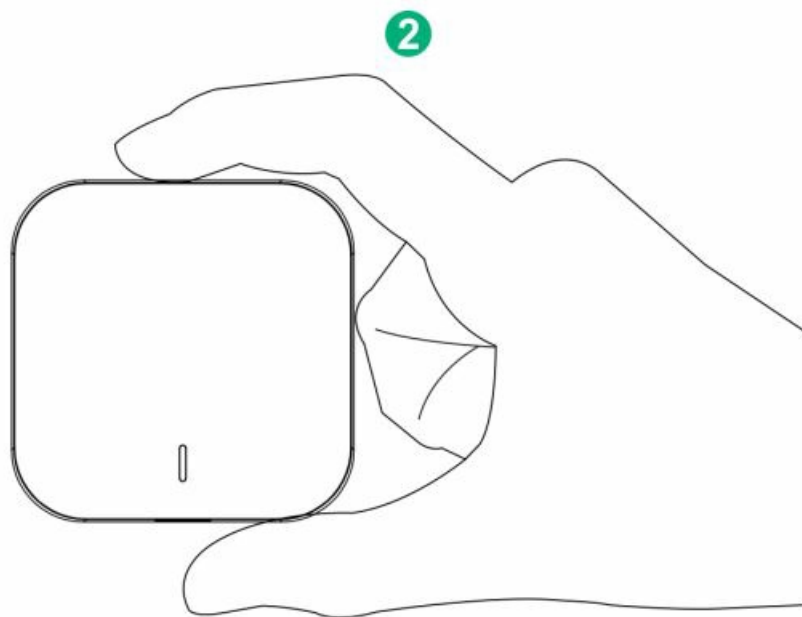

3

Cancel

Other Mode

## Reset the device first.

Power on the device and confirm  
that indicator light rapidly blinks

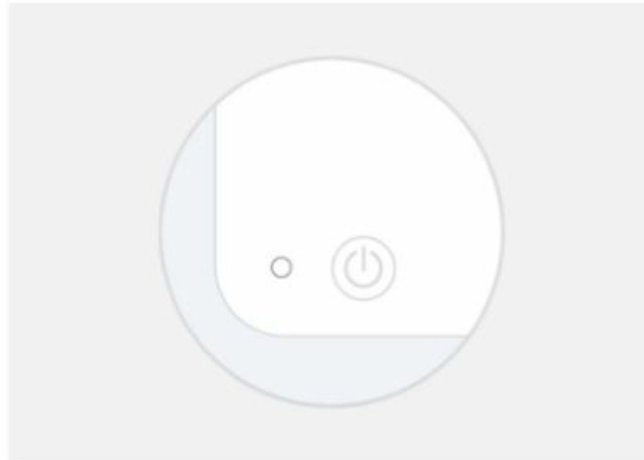

Resetting Devices >

Confirm indicator rapidly blink

4

Cancel

## Enter Wi-Fi Password



2.4GHz



5GHz



Only 2.4G Wi-Fi networks are supported >



Wi-Fi name



Enter Wifi password



Confirm

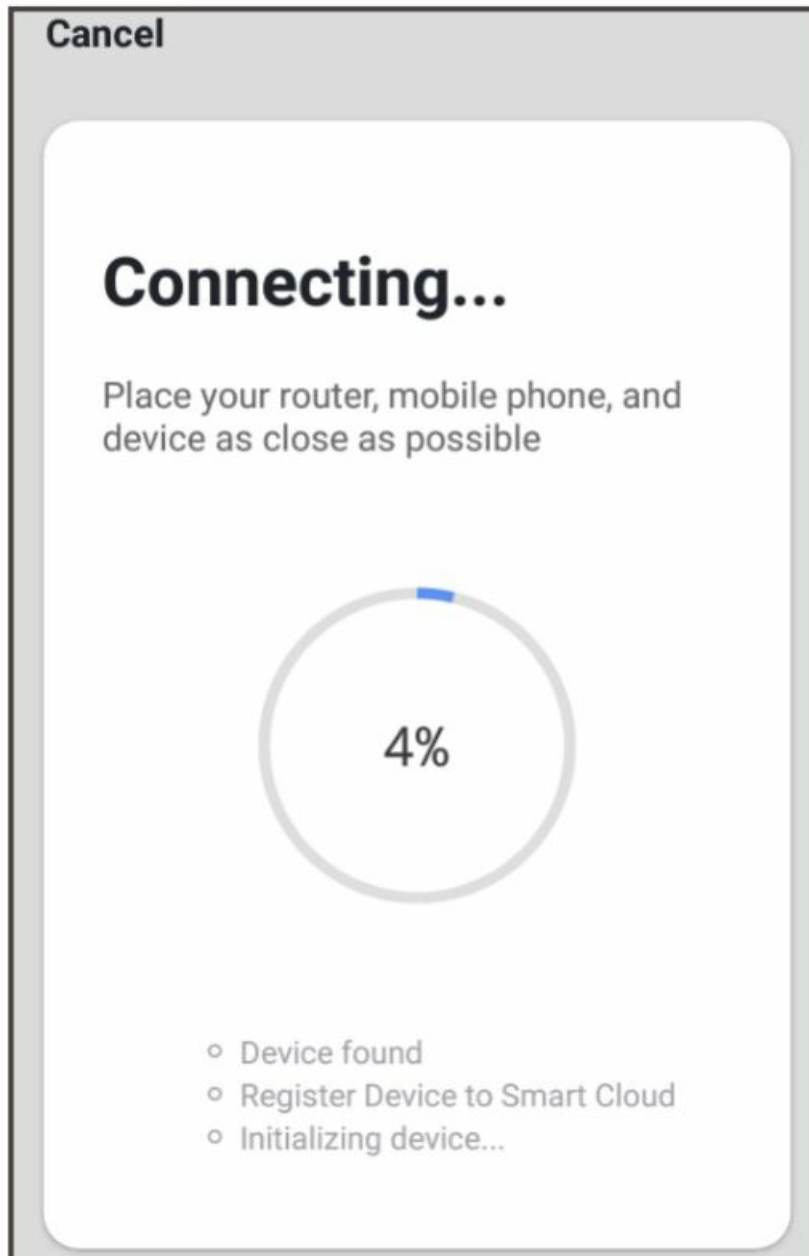

- Waiting for a few seconds ,you can see the gateway is shown and you may rename it

6

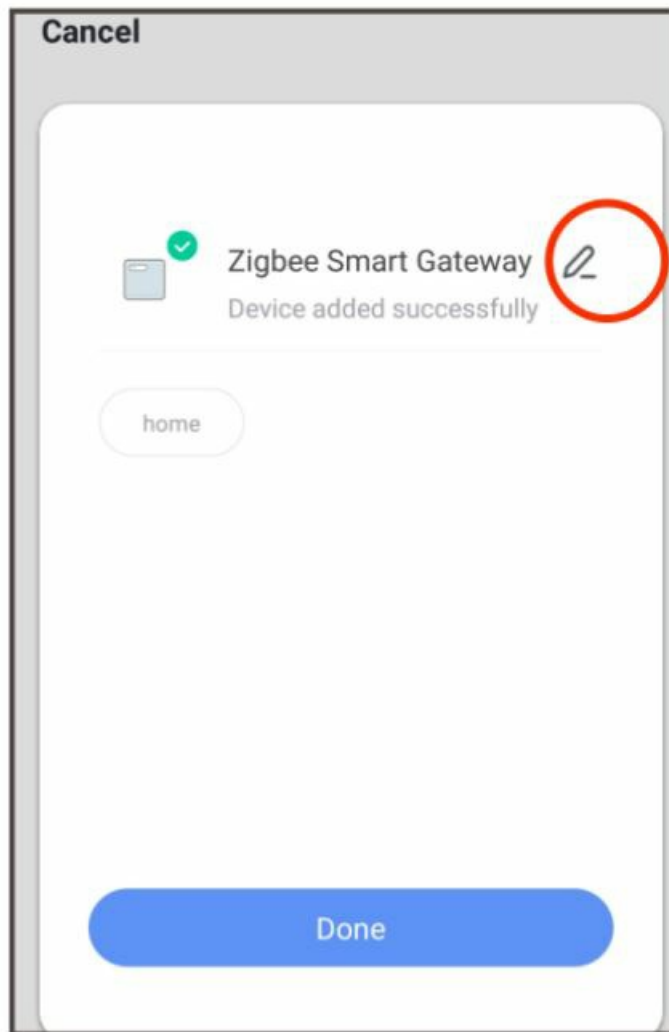

- Press Done to finish the installation of gateway

## Documents / Resources

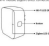
  <small>Instructions for use of the E1 Smart Gateway</small>	<a href="#">E1 Smart Gateway</a> [pdf] Instruction Manual E1 Smart Gateway, E1, Smart Gateway, Gateway
---	---

## References

- [User Manual](#)

