



# A1 Smart WiFi Socket Nous Instruction Manual

[Home](#) » [NOUS](#) » A1 Smart WiFi Socket Nous Instruction Manual

## Contents [ [hide](#) ]

- 1 A1 Smart WiFi Socket Nous
- 2 How to add your device to the Nous Smart app
  - 2.1 How to connect your device with
- 3 How to connect your device with Google Home
- 4 How do disconnect and wipe all data
- 5 Documents / Resources
  - 5.1 References
- 6 Related Posts

nous

## A1 Smart WiFi Socket Nous



### How to add your device to the Nougat Smart app

1. Plug in the device
2. Make sure that indicator is blinking rapidly (if not, hold power button for 5 seconds until it starts blinking fast)
3. Turn on Bluetooth and Location on your phone (temporarily)
4. Open Nougat Smart app
5. Press + and Add device
6. Autoscanner will appear and it will suggest you to add new device
7. Confirm connection and your WiFi network data
8. Start pairing
9. After pairing is done, you can rename your device if you wish and it's ready to be used
10. If autoscanner does not see your device, you can pick it manually from the list and proceed to connection from step number 7.

## How to connect your device with

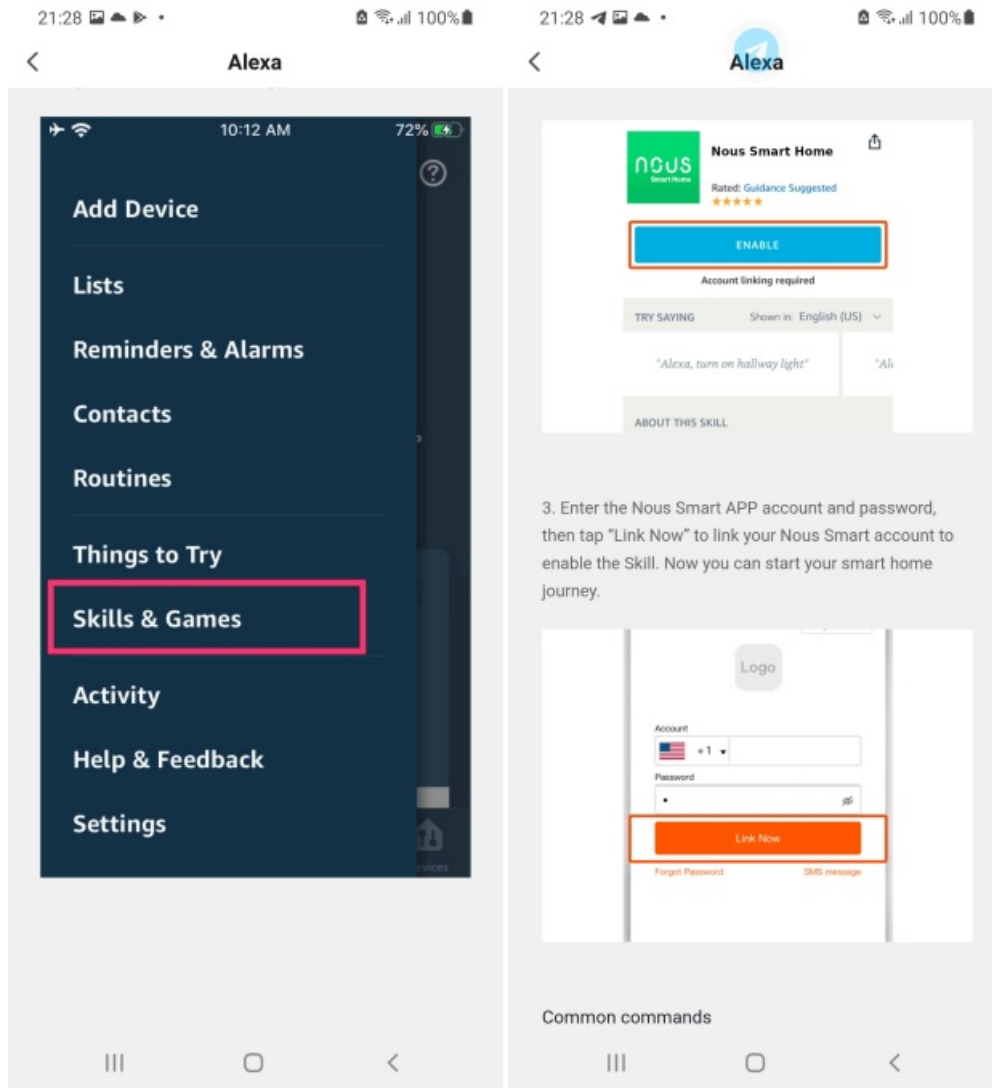

### Alexa

1. You have to have Alexa app on your smartphone
2. Go to settings and press "Skill and Games"
3. Search for the Nous Smart Home skill
4. Enable it
5. Link your Nous account with Alexa
6. Ask Alexa to discover new devices

## How to connect your device with Google Home

1. You have to have Google Home app on your smartphone
2. Go to the home settings and press "works with google"
3. Search for the Nous Smart Home
4. Link the account with the Google Home
5. All devices from Nous Smart app will appear in Google Home after synchronization

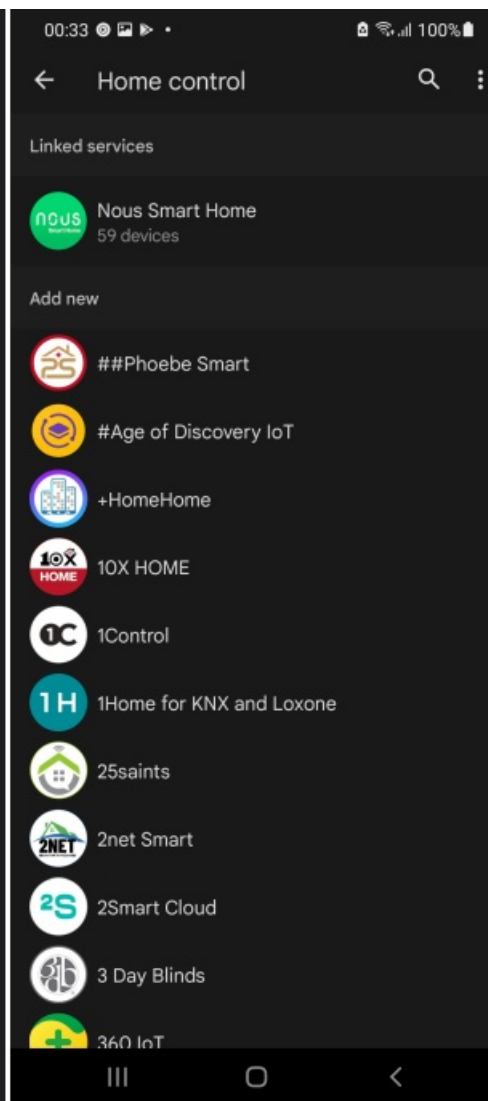
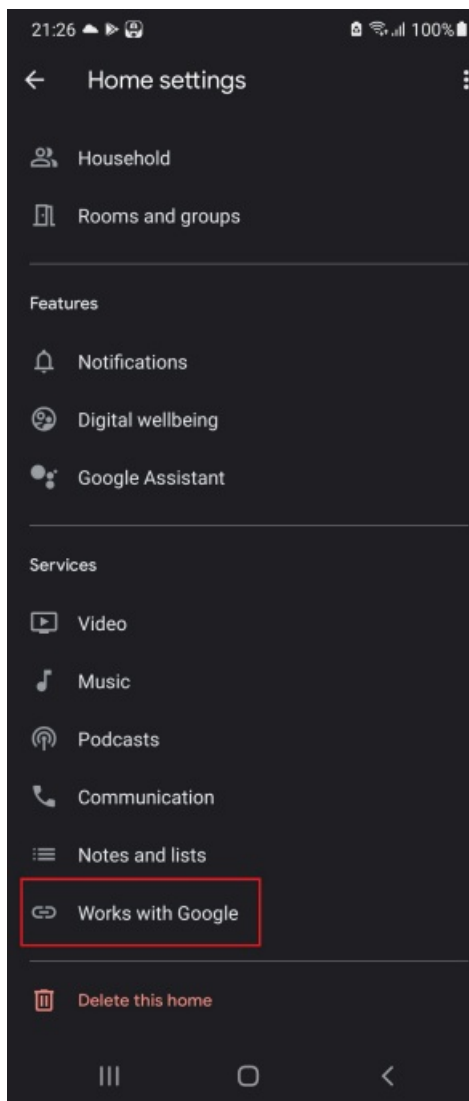

## How do disconnect and wipe all data

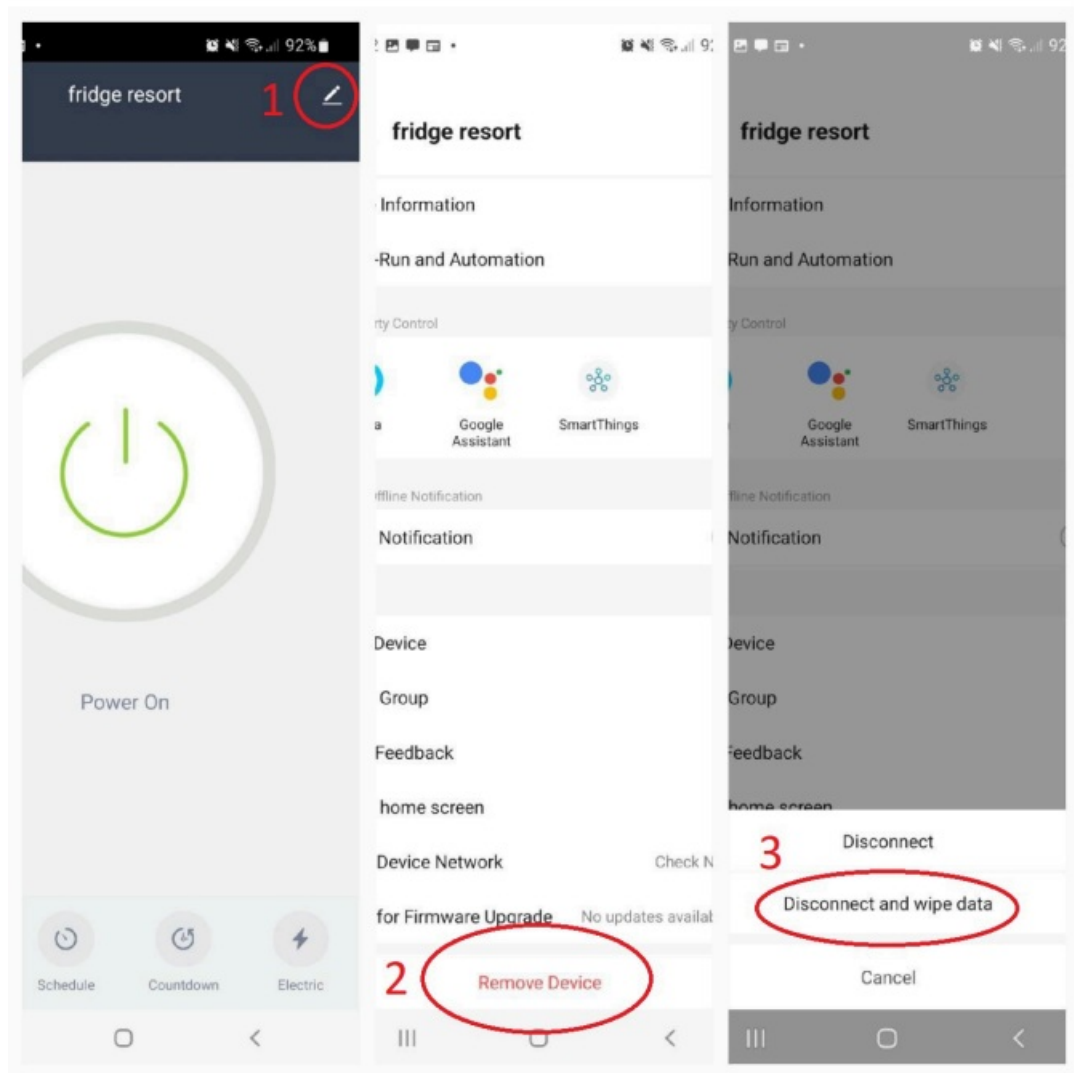

You will need Nouis Smart Home App. Scan the QR code or download it from a direct link



<div><div>Instruction manual</div><div>Smart WiFi Socket Nous A1</div><div></div><div><div>How to add your device to the</div><div>Nous Smart app</div><div><div><div>1. Scan the QR code</div><div>2. Open the app</div><div>3. Tap on the plus icon</div><div>4. Tap on the device name</div><div>5. Tap on the device name</div><div>6. Tap on the device name</div><div>7. Tap on the device name</div><div>8. Tap on the device name</div><div>9. Tap on the device name</div><div>10. Tap on the device name</div></div></div><div>How to connect your device with</div></div></div>	<div><div><a href="#">NOUS A1 Smart WiFi Socket Nous</a> [pdf] Instruction Manual</div><div>A1 Smart WiFi Socket Nous, A1, Smart WiFi Socket Nous, WiFi Socket Nous, Socket Nous</div></div>
---	--

References

-  [Nous Smart](#)