

NOTHING BUT
LEDS DL205T-6 LED
DISK LIGHT



NOTHING BUT LEDS DL205T-6 LED Disk Light Owner's Manual

[Home](#) » [NOTHING BUT LEDS](#) » NOTHING BUT LEDS DL205T-6 LED Disk Light Owner's Manual 

Contents

- 1 NOTHING BUT LEDS DL205T-6 LED Disk Light
- 2 Product Information
- 3 Product Usage Instructions
- 4 Product Features
- 5 Specifications
- 6 Correlated Color Temperature
- 7 Dimensions
- 8 Accessories
- 9 Installation
- 10 Installation Instructions
- 11 Care And Maintenance
- 12 Troubleshooting
- 13 Five-Year Limited Warranty
- 14 Packaging
- 15 Application
- 16 Documents / Resources
 - 16.1 References



NOTHING BUT LEDS DL205T-6 LED Disk Light



Product Information

Specifications:

Parameter	Value
Model #	DL205T-6-15W-5CCTR90-0001
Wattage	15W
Lumens	1500Lm
Color Temperature	2700K/3K/3500K/4K/5K
Input Voltage	120V

Product Usage Instructions

Installation Accessories:

- 6in Round LED Disc
- Mounting Screws
- Wire Nut
- Spring Iron Support
- Mounting Iron
- E26 Base Whip

Safety Information:

WARNING:

These products may represent a possible shock or fire hazard if improperly installed or attached in any way. Products should be installed by these instructions, current electrical codes, and/or the current National Electric Code (NEC). Disconnect power to the unit before installation.

Preparation:

Before beginning assembly, installation, or operation of the product, make sure all parts are present. Compare parts with the package and hardware contents list. If any part is missing or damaged, do not proceed. Contact customer service for replacement parts.

Installation Instructions:

1. Turn off the circuit breaker and light switch.
2. Twist to detach the lamp shade from the mounting plate and set it aside.
3. Install screws into the junction box leaving 1/4 of the screw exposed.

FAQ:

Q: Can I adjust the color temperature of the LED Disk Light?

A: Yes, the color temperature is adjustable with CCT selectable by the dip switch.

Nothing But LED's disk light can be directly wired to a 6" junction box which means they do not need a can and it also comes with the retrofit kit for easy and fast installation. It's surface mounts directly to the ceiling for instant bright light. Perfect for residential or commercial applications with an exceptional color rendering of 90 CRI and available in 5 CCT Adj. 2700K / 3K / 3500K / 4K / 5K color temperatures. With a life rating of at least 50,000 hours, they greatly minimize the cost of ownership through reduced maintenance and lower utility costs. Fixtures are ENERGY STAR certified, rated for wet location and support California Title 24 compliance.

Product Features

- Up to 100 Lumens per watt
- Available in 6"
- 5 CCT Adj. 2700K/3000K/3500K/4000K/5000K (DOB) Driver-on-board technology
- Triac Dimmable down to 5% of total light output
- Suitable for Damp Locations
- Easy Surface Mount or Retrofit installation
- ETL & Energy Star listed
- 5 Year warranty

SKU #	Model #	Wattage	Lumens	CCT Adjustable	Size	Housing	Input Voltage	Dimming	Certifications
1560781	DL205T-6-15W-5CCT-R90-0001	15W	1500Lm	2700K/3K/ 3500K/4K/5K	6"	White	120V	Triac Dimmable	ETL & ES

Specifications

SKU Number 1560781 Specifications

General Performance

- Model # DL205T-6-15W-5CCT-R90-0001
- Wattage 15W
- Lumen 1500LM
- Lumen Efficacy Up to 110LM/W

- Color Temperature 2700K/3000K/3500K/4000K/5000K
- CRI (Ra) >90
- Beam Angle 110° Degree
- Diffuser Type PC

Electrical

- Input Voltage 120Vac
- Frequency 50/60Hz
- Dimming Triac Dimmable
- Power Factor ≥ 0.9
- Driver Surge Protection 2.5KV
- Operating Temperature -20 ± 40

Physical

- Operating Humidity 20% – 90%
- Storage Temperature -30°C – 80°C
- Storage Humidity 10% – 95%
- LED Brand N/A
- LED Type 2835
- LED QTY 66PCS
- Housing White
- Housing Color White

Qualification

- IP Rating IP43
- Warranty 5-Year Warranty

Correlated Color Temperature

Correlated Color Temperature (CCT)

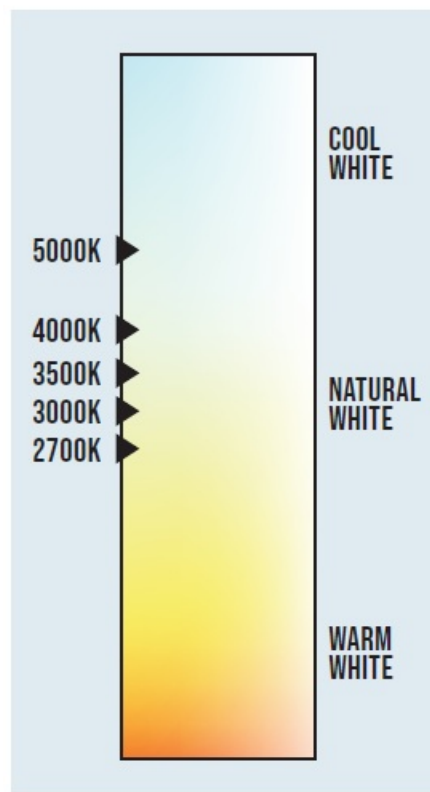

Dimensions

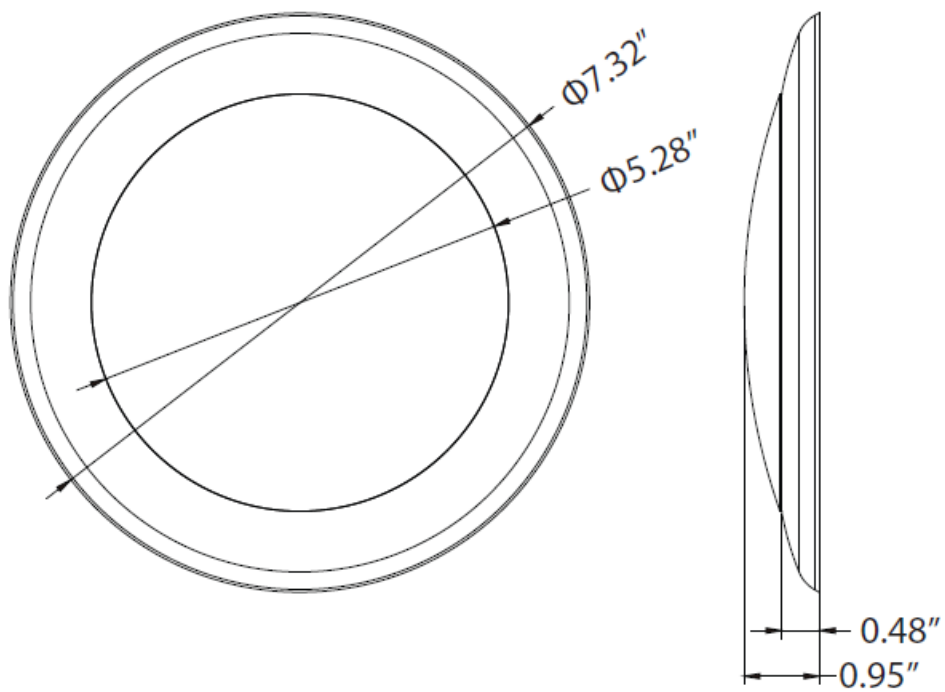

SKU: 156784: Installation Accessories

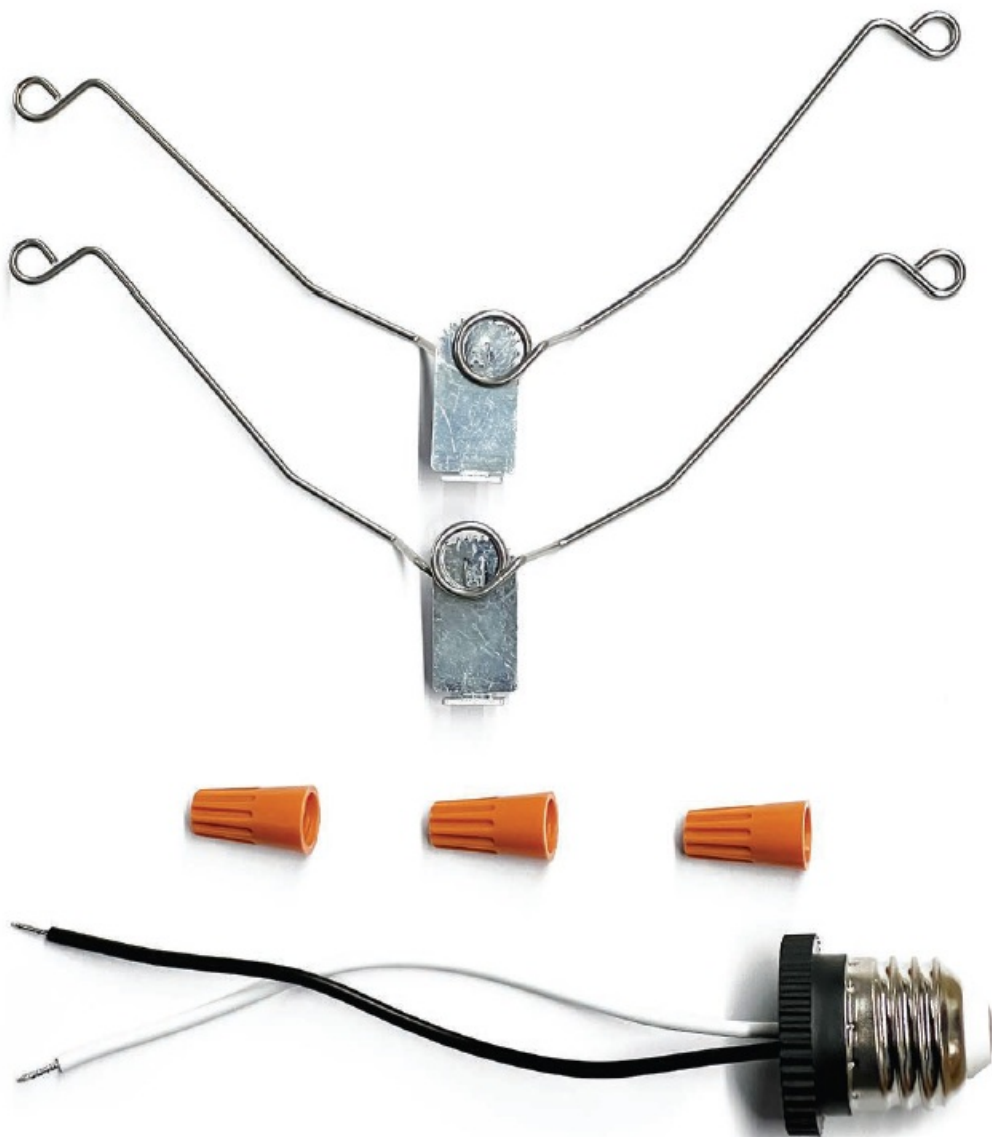

Accessories

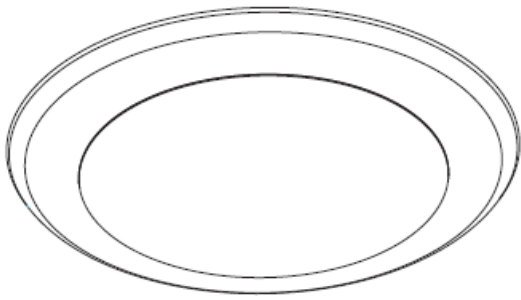

6in Round LED Disc



Mounting Screws

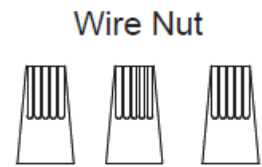

Wire Nut

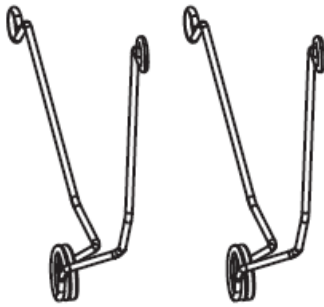

Spring Iron Support

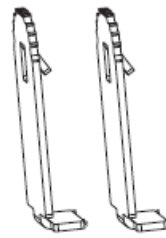

Mounting Iron

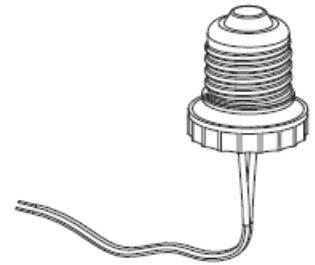

E26 Base Whip

Installation

Safety Information

WARNING:

- These products may represent a possible shock or fire hazard if improperly installed or attached in any way.
- Products should be installed under these instructions, current electrical codes, and/or the current National Electric Code (NEC). Disconnect power to the unit before installation.

WARNING: To reduce risk of fire, electric shock, or injury to persons

Read all installation instructions before beginning. If you have any doubts about how to install this lighting fixture, or if the fixture fails to operate completely, consult a qualified electrician to ensure the correct branch circuit conductor.

- This fixture is designed for use in a circuit protected by a fuse or circuit breaker.
- Always be sure that the power supply is turned off at the fuse box or circuit breaker before installing, cleaning, or servicing the fixture.
- This product must be installed by the applicable installation code by a person familiar with the construction and operation of the product and the hazards involved.
- Supply conductors (Power Wires) Connecting the fixture must be rated a minimum of 90°C. If uncertain, consult an electrician.
- To reduce the risk of fire, electric shock, or injury to persons, do not make or alter any open holes in a wiring enclosure or any electrical components during kit installation.
- To prevent wiring damage or abrasion, do not expose wiring to the edges of sheet metal or other sharp objects.
- There are no serviceable parts inside the fixture.

- Suitable for use in wet locations.
- This fixture is rated TYPE NON-IC and is not suitable for direct contact with insulation.
- The installer must determine that the supply power is 120V AC 60Hz at the luminaire before installation.
- The National Electric Code (NEC) does not permit cords to be concealed where damage to the cord's insulation may go unnoticed. To prevent fire damage, do not run cords behind walls, ceilings, soffits, or cabinets where they may be inaccessible for examination. Cords should be visually examined periodically and immediately replaced when any damage is noted.
- Do not cover the fixture with any heat-insulated materials.
- To avoid electrical shock, do not operate a fixture with a missing or damaged lens.

WARNING: To reduce the risk of cuts

Some metal parts in the fixture may have sharp edges. Wear gloves when handling the part.

SAVE THESE INSTRUCTIONS

For the safest operation, read and become familiar with complete installation instructions prior to use. Pay close attention to this manual and stay within its guidelines when using this product.

CAUTION:

- All parts must be used as indicated in this manual. Do not substitute any parts, leave parts out, or use parts that are worn out or broken. Failure to obey this instruction could invalidate the ETL certification.
- LEDs emit bright light. Avoid looking directly at the light source.
- Accounts for small parts and destroys packing material, as these may be hazardous to children.

Preparation

- Before beginning assembly, installation, or operation of the product, make sure all parts are present.
- Compare parts with the package and hardware contents listed on page 1. If any part is missing or damaged, do not attempt to assemble, install, or operate the product. Contact customer service for replacement parts.
- **Tools Required for Assembly (not included):** Ladder, safety glasses
- **Estimated assembly time:** 15-20 minutes per fixture

Installation Instructions

WARNING

- Turn off electricity at the main fuse box (or circuit breaker box) before beginning installation by removing the fuse (or switching off the circuit breaker).
- Be careful not to damage or cut the wire insulation (covering) during fixture installation. Do not permit the power cord or housing to contact any surface having a sharp edge. To do so may damage or cut the wire insulation, which could cause serious injury or death from electric shock.
- This fixture is rated for 120V AC operation and draws 15W per fixture. The installer must determine whether supply power is appropriate before installation.
- For installation direct to the ceiling via a 6" octagonal junction box, see Steps 1-4. For installation to 5"/6" recessed housing, see Steps 5-7.

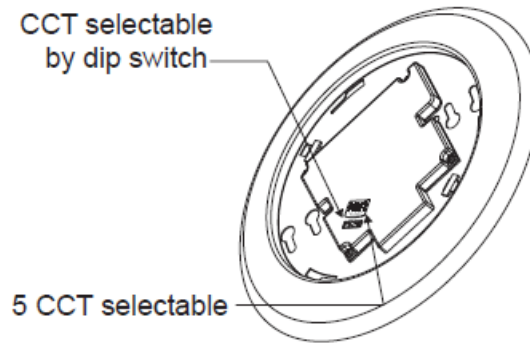

Note

Toggle the dip switch on the back of the disc light (A) to select the correlated color temperature (CCT) before installation.

For surface mounting

1. Turn off the circuit breaker and light switch.;
 - Twist to detach the lamp shade from the mounting plate and set it aside.;
 - Install the two screws into the junction box and leave 1/4" of the screw exposed to accommodate the mounting plate (See Figure 1).

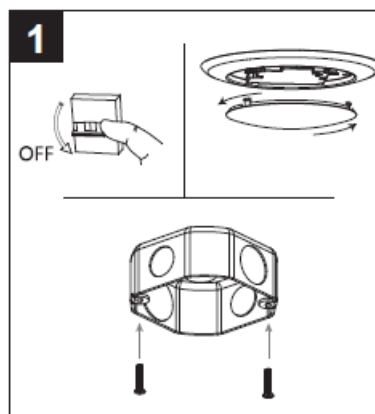

2. Connect the house ground wire, black wire, and white wire to the mounting plate ground wire, black wire, and white wire using the nut.; Attach the mounting plate to the junction box by aligning the holes on the mounting plate with the screws on the junction box.; Turn the mounting plate counterclockwise to lock in place and tighten (See Figure 2).

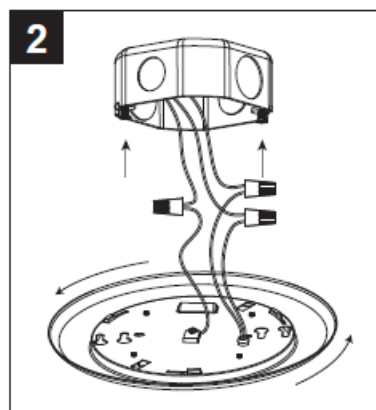

3. Reattach the lamp shade to the mounting plate and twist it to lock it in place (See Figure 3).;

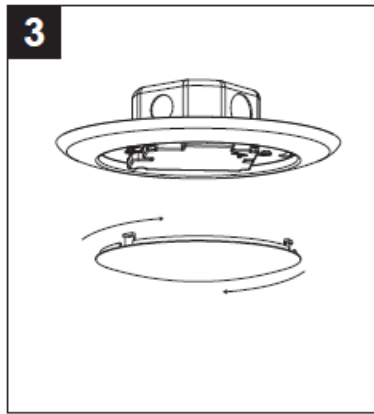

4. Turn on the circuit breaker and light switch, testing the light fixture.

For 5"/6" recessed housing

5. Spring iron bracket (D) and mounting patch (E) inlay stable, mounting patch (E) and 6inch Round LED Disc inlay stable

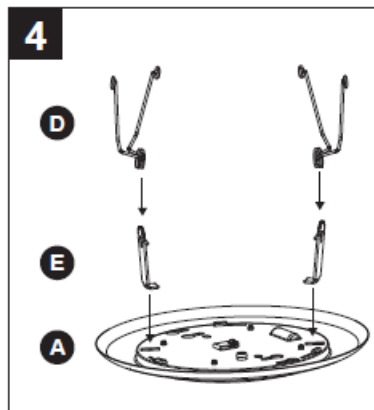

6. Connect the E26 base whip (F) to the fixture (A) by making wire connections using wire nuts (C): black to black and white to white. Tuck the ground wire away. Then connect the E26 base whip (F) to the pocket inside of the recessed.

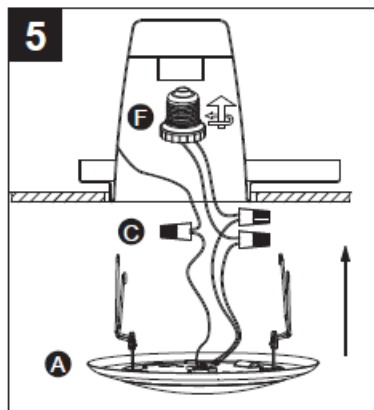

7. Push the disc light (A) up into the recessed housing, being sure not to pinch or nick any of the wires.

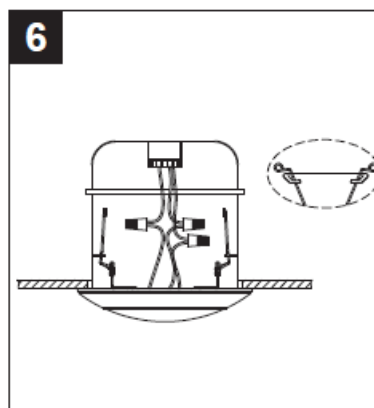

Dimming Information

This product is suitable for use in dimming circuits. For 10-100% light control, use an LED-compatible dimmer (sold separately).

Care And Maintenance

Use only mild soap and/or water with a soft cloth to clean the fixture. Harsh chemicals will damage the fixture. Do not wipe the fixture with a rough cloth that may scratch the finish or the lens.

Troubleshooting

The light does not come on at all:

- With the power supply turned off, ensure all connections are made correctly.
- Make sure the circuit breaker is on and that the switch controlling the branch circuit is on.
- If one of these fixes this issue, please consult a certified electrician.

Five-Year Limited Warranty

If, during normal use, this lighting fixture breaks or fails due to a defect in material and workmanship within five (5) years from the date of original purchase, simply bring this lighting fixture with your original sales receipt back to your nearest retail store. At its discretion, to have the product or any defective part(s) repaired or replaced with the same or similar product free of charge, within the stated warranty period, when returned by the original purchaser with the original sales receipt. This warranty; (1) excludes expendable parts including but not limited to light bulbs; (2) does not cover damage that has resulted from abuse or misuse; and (3) does not cover any losses, labor, or injuries to persons/property or costs.

Packaging

Size	Carton Size (Inches)	Pcs/Carton	Net Weight	Gross Weight
6"	15.74 x 8.07 x 8.27	12 Pcs/Box		

Application

