



NORMAN RC-A01 5 Group Remote Control User Manual

[Home](#) » [NORMAN](#) » NORMAN RC-A01 5 Group Remote Control User Manual 

Contents

- [1 NORMAN RC-A01 5 Group Remote Control](#)
- [2 Button Functions](#)
- [3 Product Specification](#)
- [4 Battery Replacement](#)
- [5 Assigning Shades to Remote Group](#)
- [6 FCC Information](#)
- [7 Documents / Resources](#)
 - [7.1 References](#)
- [8 Related Posts](#)

NORMAN®

NORMAN RC-A01 5 Group Remote Control



Button Functions

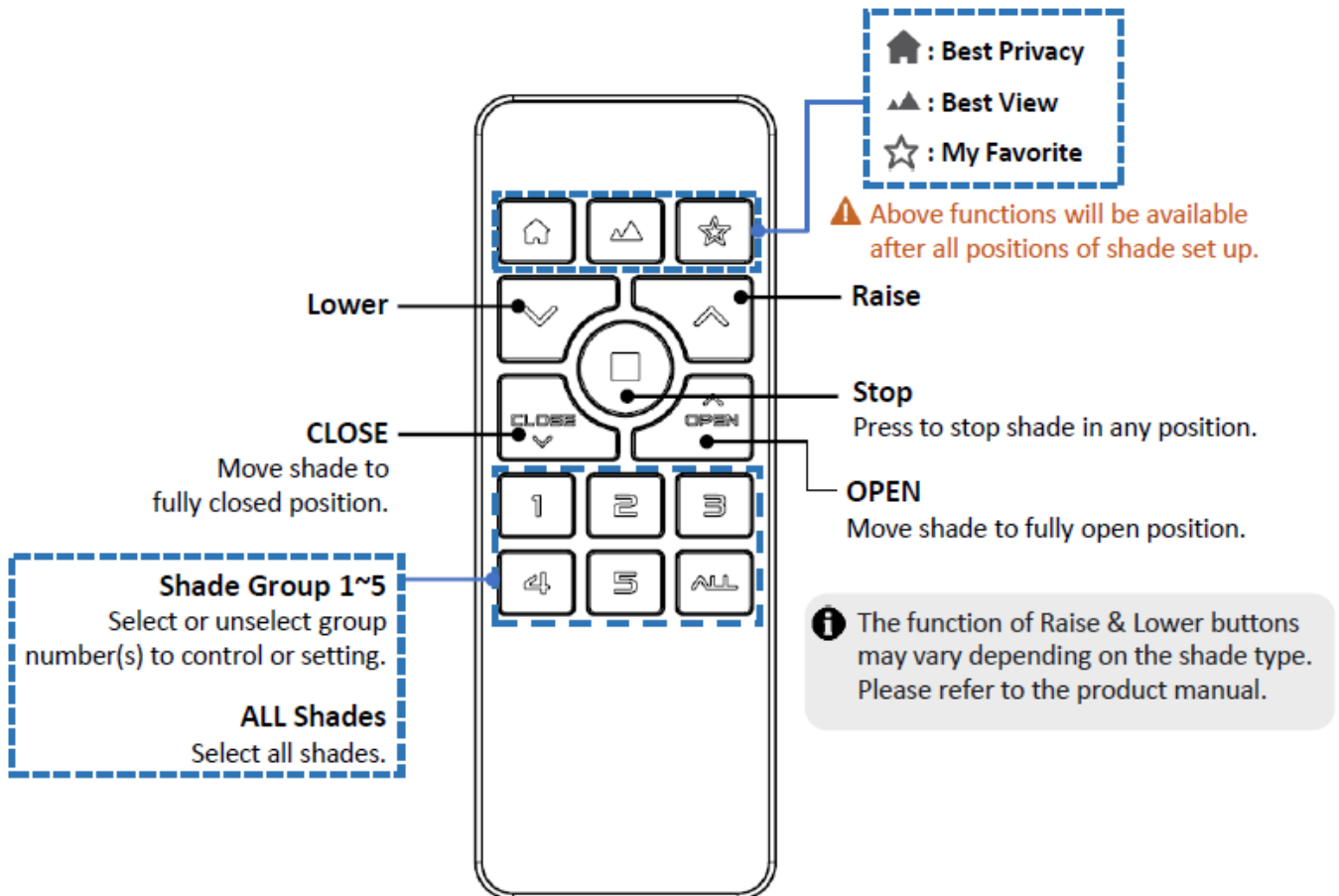

Product Specification

- **Model** RC A01
- **Dimensions** L 135mm x W 50mm x H 9.3mm
- **Weight (including battery)** 62g 5g
- **Battery / Voltage** CR2032 3V (Lithium coin battery)
- **Radio Frequency** 2.4GHz
- **Operation Temperature** : 0 C 50 C / 32 F 122 F

CE Information

Hereby, Nien Made Enterprise Co., Ltd. declares that this RC A01 is in compliance with the essential requirements and other relevant provisions of Radio Equipment Regulations 2017.

- **FCC ID:** Q3V RC A01
- **IC:** 28542 RCA01

Battery Replacement

The group remote control comes with 2 CR2032 batteries included. Please remove the protective film before use.

Back of the remote

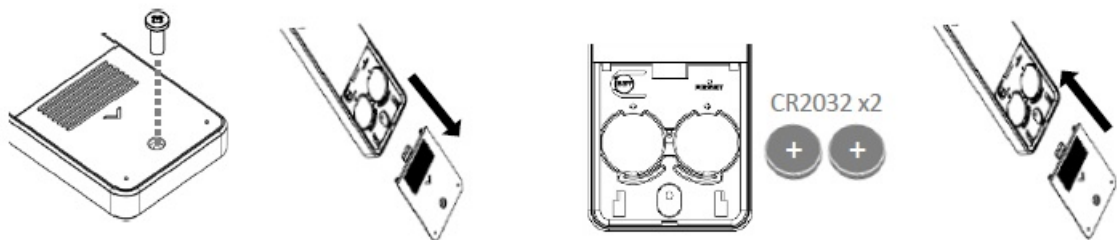

1. Unscrew the battery cover with screwdriver.
2. Press and slide down the cover.
3. Install batteries with positive (+) side facing up.
4. Reinstall the battery cover.

Assigning Shades to Remote Group

IMPORTANT! Please assign only one type of shades in the same group for optimal operation. The example shown below is for cellular honeycomb shades. For other products, please refer to the specific user manual.

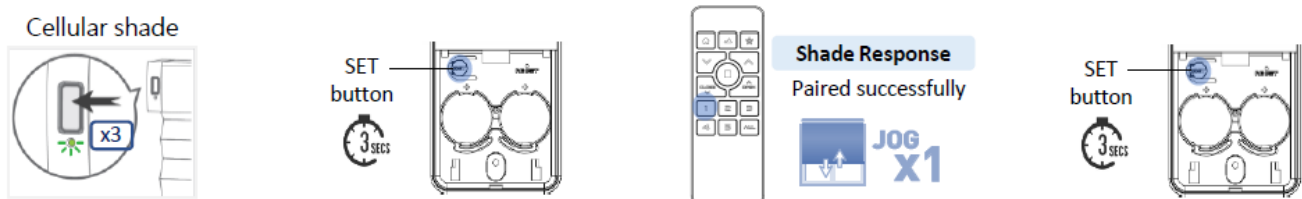

1. Press the shade button 3 times. The green light will start flashing while shade is in Pairing mode.

2. Hold the SET button for 3 seconds The remote will enter the Setup mode and the group light will start blinking.
3. Choose the desired group The selected group number blinks.
4. Hold the SET button for 3 seconds The remote will leave the Setup mode and the group light will stop blinking.

The setting mode will time out after 20 seconds of inactivity.

Removing Group assignments

Repeat the steps under Assigning Shade and assign to the same group again to remove from the group.

Changing Group assignments

Follow the step above to remove the original shade assignment first. Next, repeat the steps under Assigning Shades and choose a different Shade Group number in step 3.

FCC Information

This device complies with Part 15 of the FCC Rules. Operation is subject to the following two conditions:

1. This device may not cause harmful interference
2. this device must accept any interference received, including interference that may cause undesired operation.

This equipment has been tested and found to comply with the limits for a Class B digital device, pursuant to Part 15 of the FCC Rules. These limits are designed to provide reasonable protection against harmful interference in a residential installation. This equipment generates, uses and can radiate radio frequency energy and, if not installed and used in accordance with the instructions, may cause harmful interference to radio communications. However, there is no guarantee that interference will not occur in a particular installation. If this equipment does cause harmful interference to radio or television reception, which can be determined by turning the equipment off and on, the user is encouraged to try to correct the interference by one of the following measures:

- Reorient or relocate the receiving antenna.
- Increase the separation between the equipment and receiver.
- Connect the equipment into an outlet on a circuit different from that to which the receiver is connected.
- Consult the dealer or an experienced radio/TV technician for help.

CAUTION:

Any changes or modifications not expressly approved by the grantee of this device could void the user's authority to operate the equipment.

IC Information

- Innovation, Science and Economic Development Canada (ISED) Notices
- This device contains licence exempt transmitter(s)/receiver(s) that comply with Innovation, Science and Economic Development Canada's licence exempt RSS(s). Operation is subject to the following two conditions:
 - This device may not cause interference.
 - This device must accept any interference, including interference that may cause undesired operation of the device.

CAN ICES 003(B) / NMB 003(B)

RF Exposure Warning

The equipment complies with FCC/ISED RF exposure limits set forth for an uncontrolled environment.
The equipment must not be co-located or operating in conjunction with any other antenna or transmitter.

Group Remote Control / Model: RC A01

This setup guide provides basic instructions for assigning and using 5 Group Remote Control with Norman® motorized shade products.



For complete programing instruction, see: <http://www.normanproductwarranty.com/installation-PDF-SU.asp>

Documents / Resources

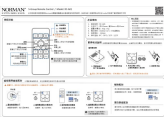
	<p>NORMAN RC-A01 5 Group Remote Control [pdf] User Manual RC-A01, RCA01, Q3V-RC-A01, Q3VRCA01, RC-A01 5 Group Remote Control, RC-A01, RC-A01 Remote Control, 5 Group Remote Control, Group Remote Control, Remote Control, 5 Group Remote</p>
---	---

References

-  [Norman USA](#)