



NORDOST MS01746 Sort Systems Instruction Manual

[Home](#) » [NORDOST](#) » NORDOST MS01746 Sort Systems Instruction Manual 

Contents

- [1 NORDOST MS01746 Sort Systems](#)
- [2 INSTALLATION](#)
- [3 LEVELING](#)
- [4 Documents / Resources](#)



NORDOST MS01746 Sort Systems



INSTALLATION



1. LAY SPEAKERS ON A CLOTH



2. REMOVE ORIGINAL SPIKES OR FEET FROM UNIT

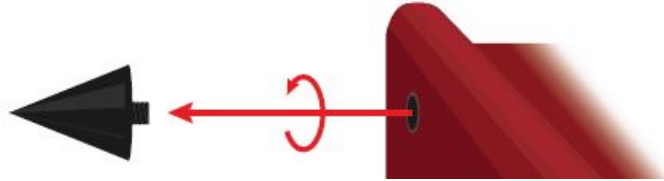

3. CONTACT THE DEALER TO IDENTIFY THE EXISTING THREAD SIZE

INCLUDED THREADED ADAPTER SIZES

1/4-20



6mm



8mm



CONTACT DEALER FOR ADDITIONAL AVAILABLE THREAD SIZES

4. ATTACH THREADED ADAPTER TO FÜT UNTIL THE STUD BOTTOMS IN FÜT

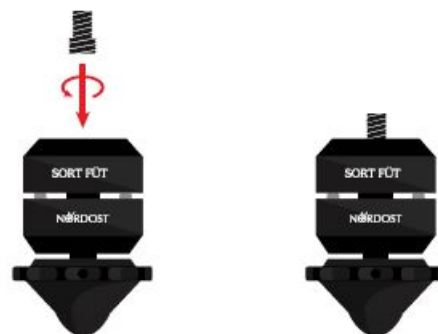

5. WHILE HOLDING THE TOP OF THE SORT FÜT BODY, THREAD ONTO THE SPEAKER UNTIL TIGHT
(DO NOT FORCE: IF THERE IS RESISTANCE, REEVALUATE THREAD SIZE)

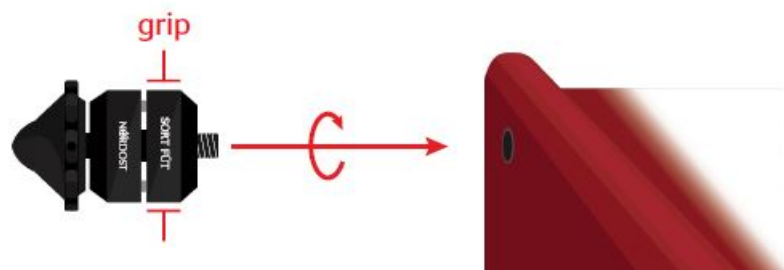

6. LIFT THE SPEAKER UPRIGHT AND PLACE INTO DESIRED POSITION

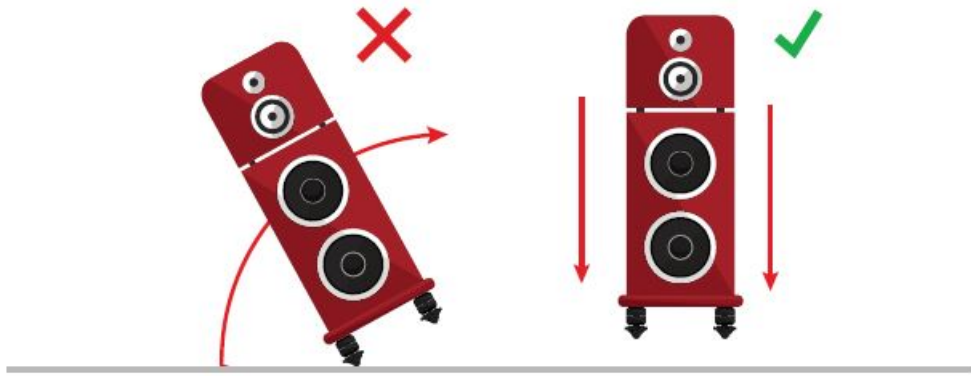

- DO NOT PUT THE FULL WEIGHT OF YOUR SPEAKER ON ONE SORT FÜT.
- GET ASSISTANCE FROM ANOTHER PERSON TO HELP LIFT IF NECESSARY.



LEVELING

1. PLACE UNITS INTO SOUNDSTAGE



2. LEVEL/PLUMB SPEAKERS, MAKING SURE TO MEASURE ON BOTH 'X' AND 'Y'-AXIS



3. PLACE THE TARGET ONTO SPEAKER 'B' ON ANY AVAILABLE HORIZONTAL SURFACE



4. POINT LASER FOUND ON LEVELING SYSTEM FROM SPEAKER 'A' ACROSS TO TARGET ON SPEAKER 'B'



5. USE THE ADJUSTMENT TOOL TO TURN FINIAL DOMES UNTIL THE LASER BEAM MATCHES UP WITH CROSSHAIRS ON TARGET ON SPEAKER 'B'

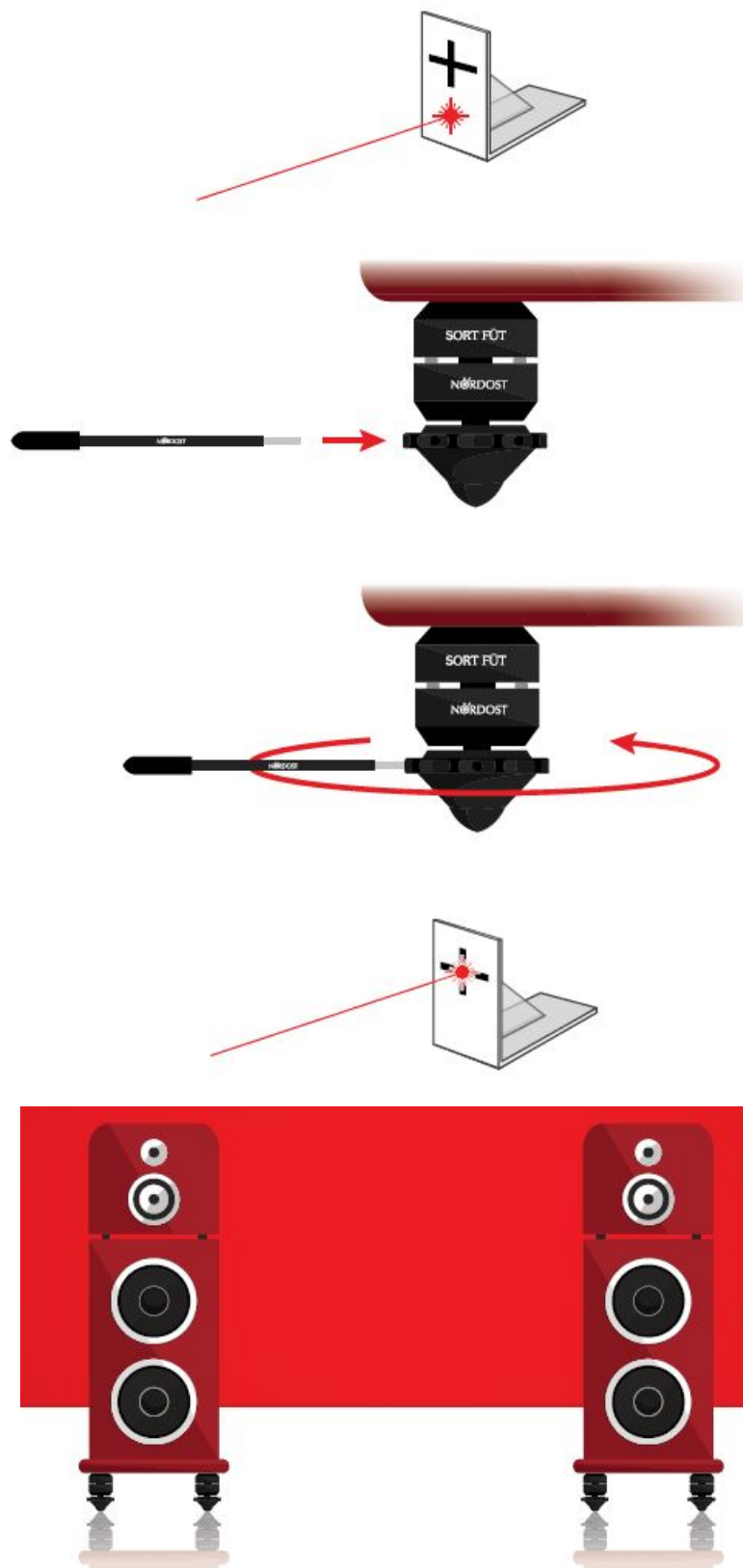

SORT KONE



- Resonance control equipment support
- Mechanically tuned construction
- Use in threes, fours, or even fives
- Three levels of price and performance
- Universal application- these work everywhere!

Nordost 93 Bartzak Drive Holliston MA 01746 USA

Email: info@nordost.com. Website: www.nordost.com.

Documents / Resources



[NORDOST MS01746 Sort Systems](#) [pdf] Instruction Manual
MS01746, MS01746 Sort Systems, Sort Systems, Systems