



NOFRED Oak Mouse Table Instruction Manual

[Home](#) » [Nofred](#) » NOFRED Oak Mouse Table Instruction Manual 

Contents

- [1 NOFRED Oak Mouse Table](#)
- [2 Product Information](#)
- [3 Window Safety](#)
- [4 DISCLAIMER:](#)
- [5 MAINTENANCE AND CLEANING](#)
- [6 Assembly Instructions](#)
- [7 Documents / Resources](#)
 - [7.1 References](#)
- [8 Related Posts](#)



NOFRED Oak Mouse Table



Product Information

Specifications

- Product: Mouse Table
- Recommended Age: 2-5 years

Product Usage Instructions

Safety Precautions

Before using the Mouse Table, please read and follow these safety precautions:

- Ensure adult supervision at all times.
- Check the stability of the table before each use.
- Avoid placing heavy objects on the table.
- Do not allow children to climb on the table.
- Keep small parts away from young children to prevent choking hazards.

Assembly Instructions

1. Identify the components labeled A, B, C, and D according to the assembly manual.
2. Use the provided screws M6 x 30mm and M6 x 50mm to assemble the table as per the instructions.
3. Follow the step-by-step guide to complete the assembly process.
4. Ensure all parts are securely tightened to avoid any instability.

FAQ

Q: What is the recommended age for using the Mouse Table?

A: The Mouse Table is designed for children aged 2 to 5 years.

WARNING

IMPORTANT! PLEASE RETAIN FOR FUTURE REFERENCE

Window Safety

Avoid positioning this product near win-dows, as it may serve as a potential step for a child, increasing the risk of falling out. Ensure a safe distance between the furniture and windows to prevent accidents.

Fire Hazard

Exercise caution regarding open flames or other sources of intense heat, such as electric bar fires or gas fires, in close proximity to the furniture item. Maintain a safe distance to minimize the risk of fire-re-lated incidents.

Cord Safety

Do not place this product near windows with blinds or curtains containing cords that could pose a strangulation hazard to a child. Ensure cords are securely fastened or kept out of reach.

DISCLAIMER:

Before allowing your child to interact with the product, thoroughly inspect it for any faults or damages. Prioritize safety at all times when using furniture around children. All assembly fittings should always be tightened properly. Do not over tighten, Never use the product should it be damaged or missing a part. Use only spare parts approved by the manufacturer.

MAINTENANCE AND CLEANING

Wipe the product with a clean damp cloth; all excess water should be wiped off.

Detergents are not recommended. Please note – Exposure to direct sunlight may cause slight changes of color to the.

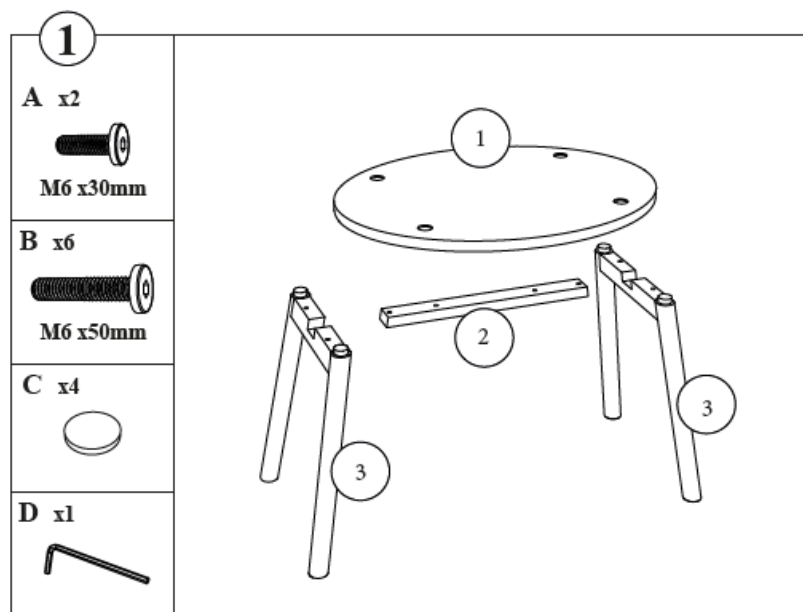

Assembly Instructions

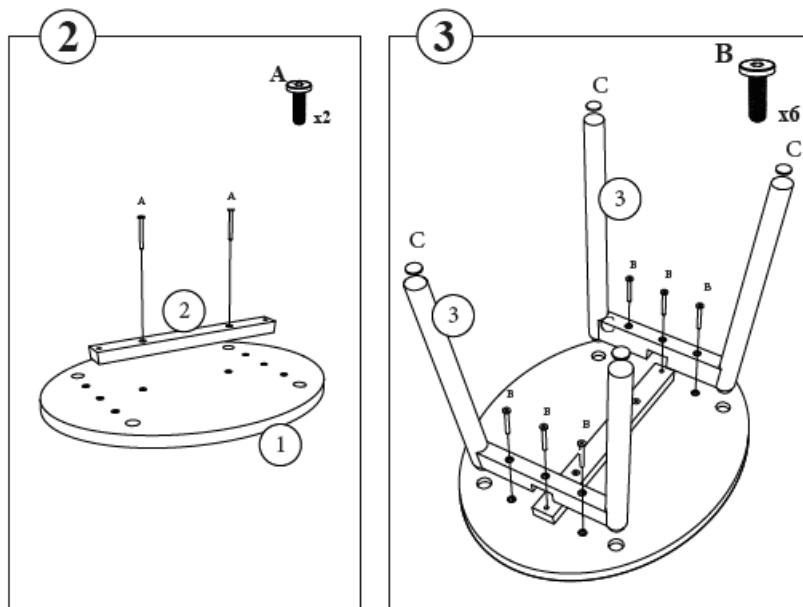



NOFRED APS. 7B, 2ND FLOOR, DK-2100
 COPENHAGEN PHONE +45 25605055 EMAIL INFO@NOFRED.COM
NOFRED.COM

Documents / Resources

 	<p>NOFRED Oak Mouse Table [pdf] Instruction Manual Oak Mouse Table, Oak, Mouse Table, Table</p>
--	--

References

- [Danish Design | Kids Furniture | Sustainable Craftsmanship from Nofred](#)
- [User Manual](#)

[Manuals+](#). [Privacy Policy](#)

This website is an independent publication and is neither affiliated with nor endorsed by any of the trademark owners. The "Bluetooth®" word mark and logos are registered trademarks owned by Bluetooth SIG, Inc. The "Wi-Fi®" word mark and logos are registered trademarks owned by the Wi-Fi Alliance. Any use of these marks on this website does not imply any affiliation with or endorsement.