



Nofred Mouse Table Instruction Manual

[Home](#) » [Nofred](#) » Nofred Mouse Table Instruction Manual 

Nofred Mouse Table Instruction Manual



Contents

1

Safety precautions

2

DISCLAIMER:

3

MAINTENANCE AND
CLEANING:

4

Documents / Resources

4.1

References

Safety precautions

WARNING:

1. Window Safety

Avoid positioning this product near windows, as it may serve as a potential step for a child, increasing the risk of falling out.

Ensure a safe distance between the furniture and windows to prevent accidents.

2. Fire Hazard

Exercise caution regarding open flames or other sources of intense heat, such as electric bar fires or gas fires, in close proximity to the furniture item. Maintain a safe distance to minimize the risk of fire-related incidents.

3. Cord Safety

Do not place this product near windows with blinds or curtains containing cords that could pose a strangulation hazard to a child. Ensure cords are securely fastened or kept out of reach.

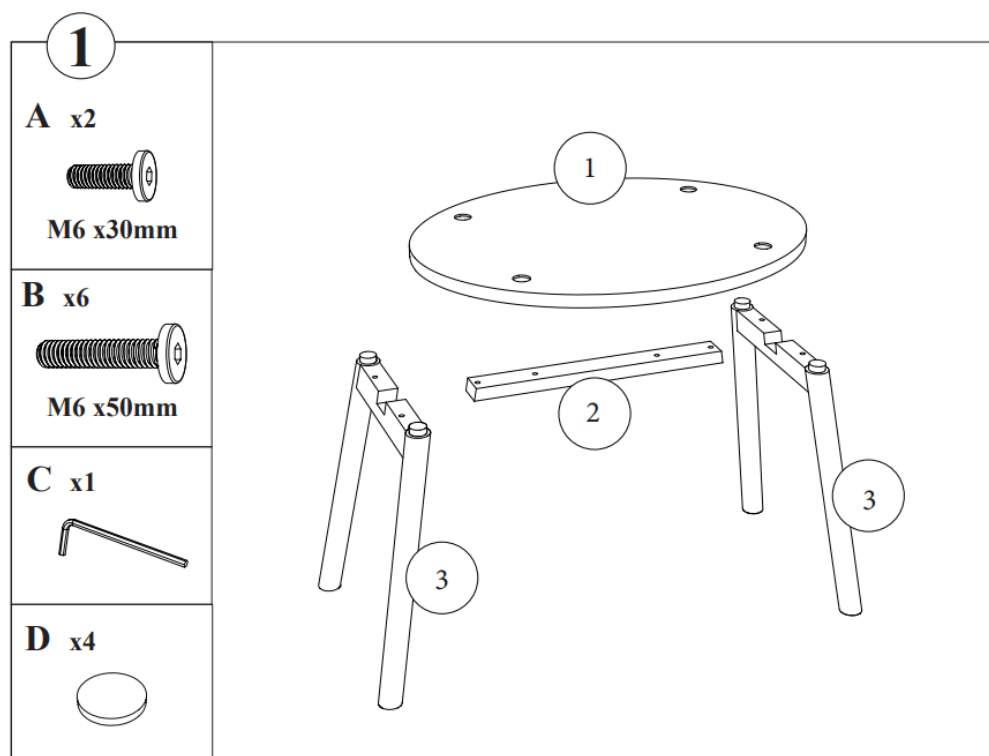

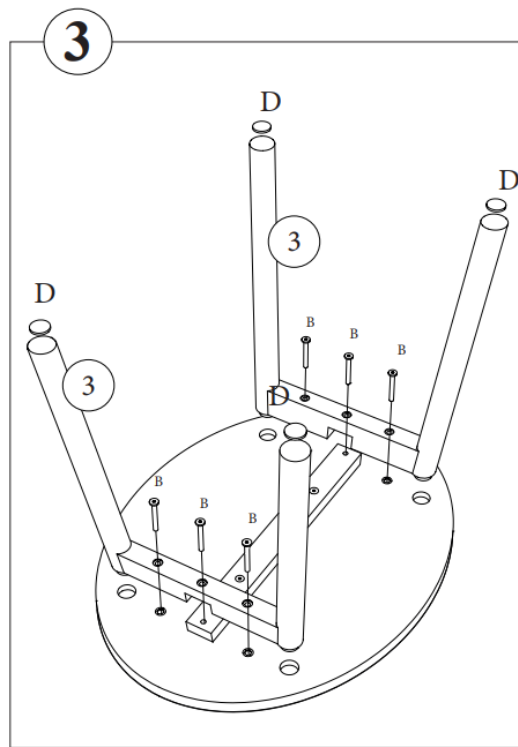
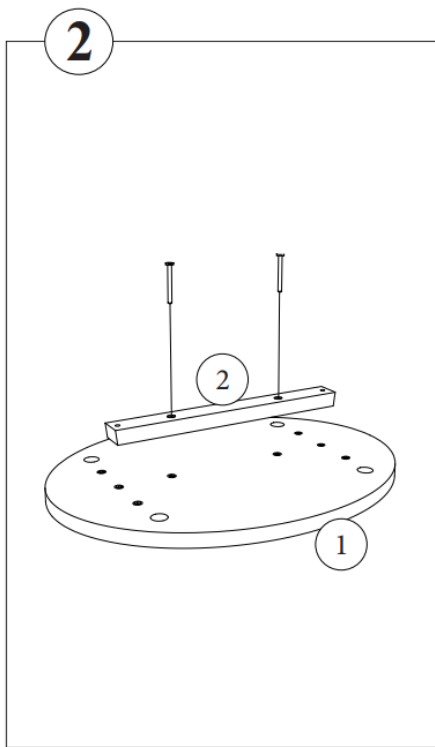

DISCLAIMER:

Before allowing your child to interact with the product, thoroughly inspect it for any faults or damages. Prioritize safety at all times when using furniture around children.

All assembly fittings should always be tightened properly. Do not over tighten, Never use the product should it be damaged or missing a part. Use only spare parts approved by the manufacturer.

MAINTENANCE AND CLEANING:

Wipe the product with a clean damp cloth; all excess water should be wiped off.

Detergents are not recommended.



Please note – Exposure to direct sunlight may cause slight changes of color to the

NOFRED APS. ROSENVÆNGETS ALLÉ 7B, 2ND FLOOR, DK-2100
COPENHAGEN **PHONE** : +45 25605055 **EMAIL** : INFO@NOFRED.COM

NOFRED.COM



Documents / Resources

 	Nofred Mouse Table [pdf] Instruction Manual Mouse Table, Table
--	---

References

-  [Danish Design | Kids Furniture | Sustainable Craftsmanship from Nofred](#)
- [User Manual](#)

Manuals+. Privacy Policy

This website is an independent publication and is neither affiliated with nor endorsed by any of the trademark owners. The "Bluetooth®" word mark and logos are registered trademarks owned by Bluetooth SIG, Inc. The "Wi-Fi®" word mark and logos are registered trademarks owned by the Wi-Fi Alliance. Any use of these marks on this website does not imply any affiliation with or endorsement.