



NodOn ZIGBEE ON/OFF LIGHTING RELAY SWITCH User Manual

[Home](#) » [NODON](#) » NodOn ZIGBEE ON/OFF LIGHTING RELAY SWITCH User Manual 

Contents

- [1 NodOn ZIGBEE ON/OFF LIGHTING RELAY SWITCH](#)
- [2 Specification](#)
- [3 APPROVALS AND CERTIFICATIONS](#)
- [4 INSTALLATION](#)
- [5 ADDING TO A ZIGBEE NETWORK](#)
- [6 UNPAIRING PROCEDURE](#)
- [7 RESET PROCEDURE](#)
- [8 Documents / Resources](#)
 - [8.1 References](#)
- [9 Related Posts](#)



NodOn ZIGBEE ON/OFF LIGHTING RELAY SWITCH



Specification

- **Reference:** SIN-4-2-20
- **Power supply:** 230V AC ~ 50Hz
- **Switching capabilities:** 230V AC – 2 x 3A
- **Consumption:** <1W
- **Maximum output power:** 2 x 690W – Integrated zero crossing RF Protocol: Zigbee 3.0
- **Radio frequency range:** 2.4Ghz
- **RF power max:** +10dBm
- **Range:** up to 40m indoor
- **Operational temperature:** -20°C to 60°C
- **Protection rating:** IP 20
- **Dimensions:** 40 mm (l) x 44 mm (L) x 16.9 mm (h)
- **Weight:** 34 g
- **Warranty:** 2 years

USE CAUTIONS

- Never use the device if it is not correctly installed and placed inside a connecting box in conformity with the current norms.
- Keep the product far away from liquids.

DETAILED USER GUIDE

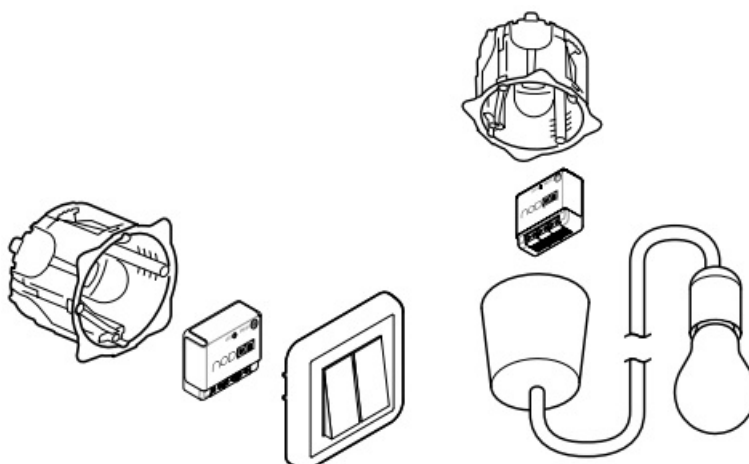

Thanks to its small size, the Zigbee ON/OFF Lighting Relay Switch can be installed anywhere in the wall or the ceiling (behind an existing wall switch, in a false ceiling, etc...)

TIP

Add the Zigbee ON/OFF Lighting Relay Switch to the electric panel with NodOn DIN Rail Box*. *Optional accessory

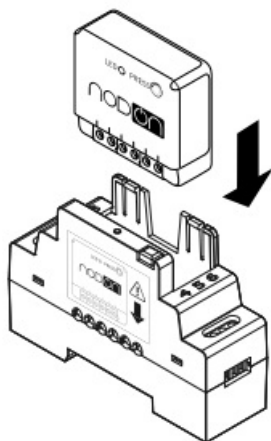

RELAY SWITCH INPUT/OUTPUT



N Terminal for the Neutral

L Terminal for the Line

1/1 Input terminal for the wired switch 1*

1/2 Input terminal for the wired switch 2*

1 Output 1 (controlled by 1/1)

2 Output 2 (controlled by 1/2)

Each terminal should be installed with a cable from 1.5mm² to 4mm² maximum, stripped of 8mm. Wired switch optional.

INSTALLATION DIAGRAM FOR ONE OR TWO LIGHTS

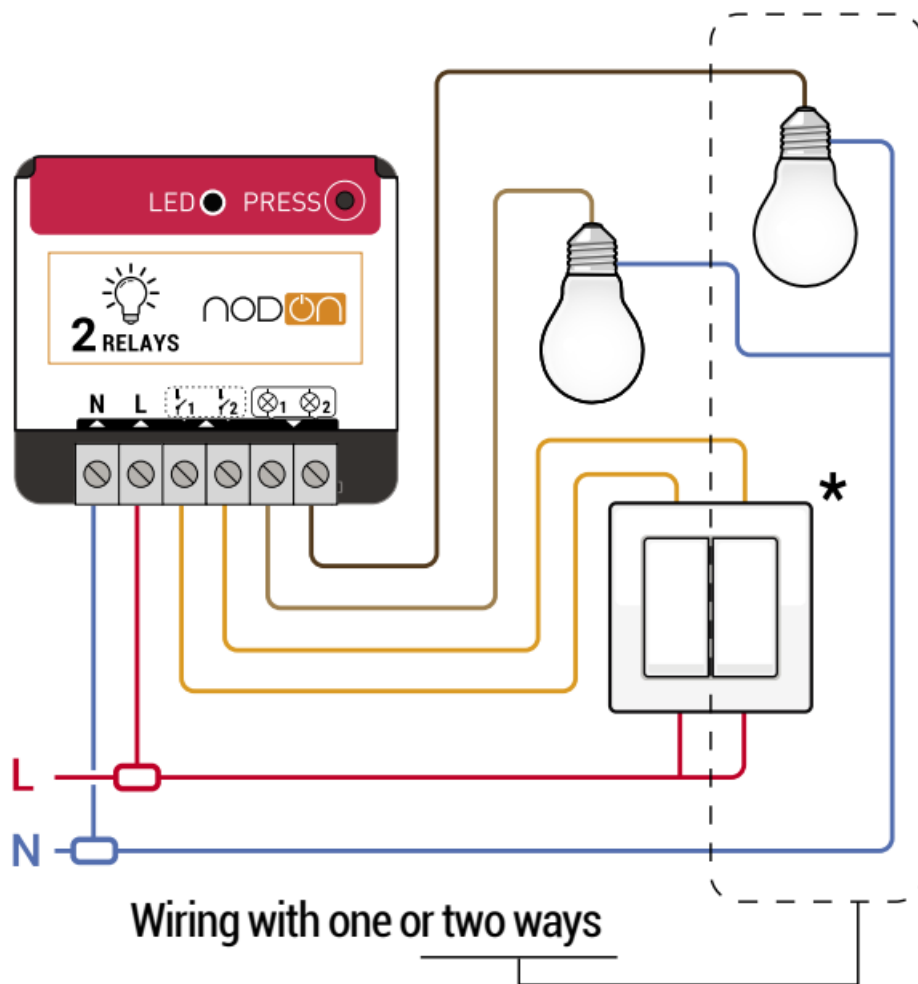

Wired switch is optional.

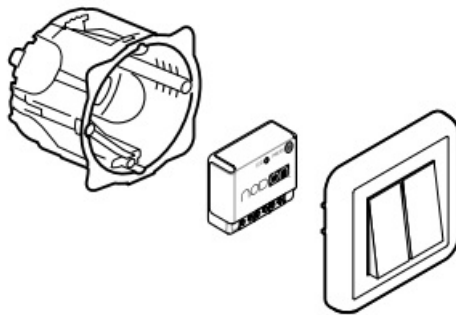

1. Cut the power supply
2. Dismantle the wired switch controlling the light(s) you want to connect.
3. Install the ON/OFF Lighting Relay Switch according to diagram figure 1.
4. Reinstall the wired switch.
5. Turn the power supply back ON.

AUTO-DETECTION OF SWITCH TYPE

When you turn the power supply ON (via the electrical box for example) once the relay switch is installed, it is necessary to perform a simple action (single press on the button) on the wired switch(es). Automatic detection of the type of switch (monostable or bistable) will then be performed.

INSTALLATION DIAGRAMS

Find all the installation diagrams in the “Support” section on nodon.fr/en/

ADDING TO A ZIGBEE NETWORK

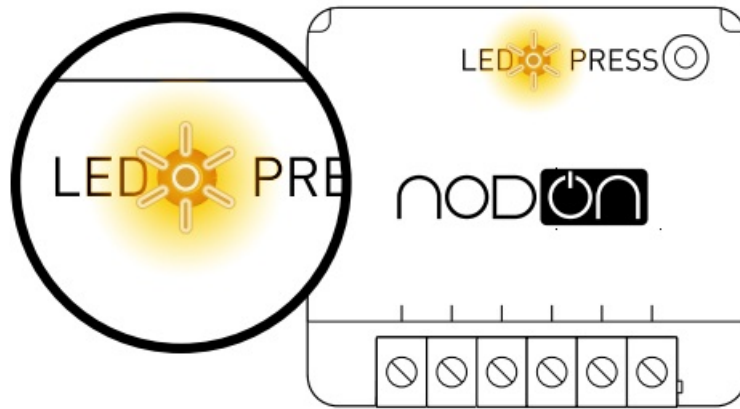

When power is turned ON, the relay switch Led will blink orange, looking to join a Zigbee network. Go to your Zigbee gateway app to activate the relay switch detection. See the compatible home automation gateways on nodon.fr/en/support/

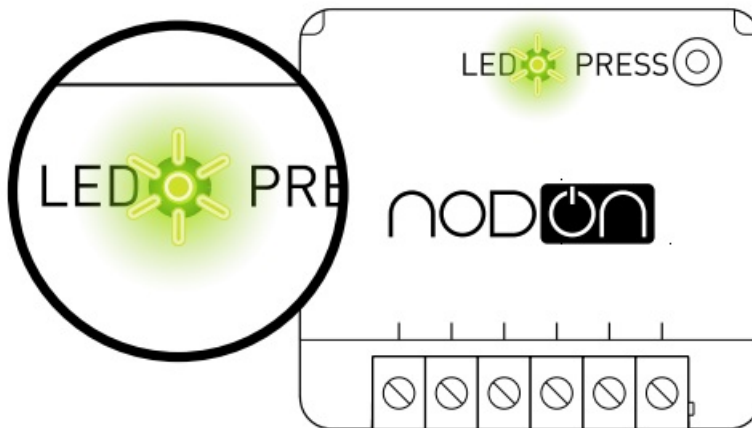

If the relay switch has correctly joined the network, the Led becomes green. The relay switch is ready for use.

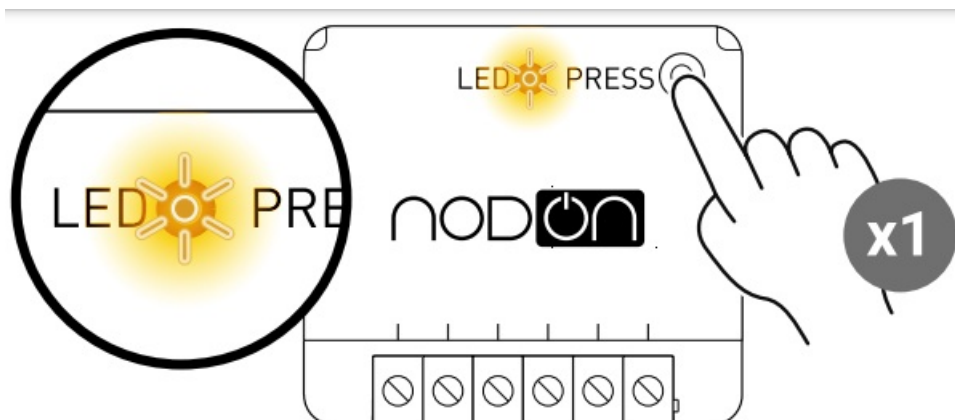

If the relay switch hasn't joined a network within 15 minutes, the Led becomes orange. Do a brief press on the relay switch button and start again.

UNPAIRING PROCEDURE

To remove the module from its network, perform a Module Reset (see "Reset Procedure").

RESET PROCEDURE

The relay switch must be power supplied.

1. Press more than 5 seconds on your module's button. The Led blinks orange.
2. Press the button again (short press) to validate the reset. If the reset is successful, the Led flashes red and green alternately, then flashes orange. Repeat if necessary.
3. Your module has returned to its original configuration and is ready to join a new Zigbee network.

Documents / Resources



[NodOn ZIGBEE ON/OFF LIGHTING RELAY SWITCH](#) [pdf] User Manual
ZIGBEE, ON LIGHTING RELAY SWITCH, OFF LIGHTING RELAY SWITCH, LIGHTING RELAY SWITCH, RELAY SWITCH

References

- [🔌 Fabricant domotique OBL - OEM - ODM pour la Maison Connectée](#)
- [🔌 Smart Home & Building - OEM ODM OBL solutions for IoT products](#)
- [🔌 Technical Support NodOn | Product documentation, tutorial, use cases](#)
- [🔌 Fabricante domótico OBL - OEM - ODM para el Hogar Conectado](#)
- [🔌 Soporte técnico NodOn | Documentación del producto, tutorial, caso de uso](#)