

# NIX E01 Hydration Biosensor POD Instruction Manual

[Home](#) » [NIX](#) » NIX E01 Hydration Biosensor POD Instruction Manual 

Hydration Biosensor  
NIX POD Manual

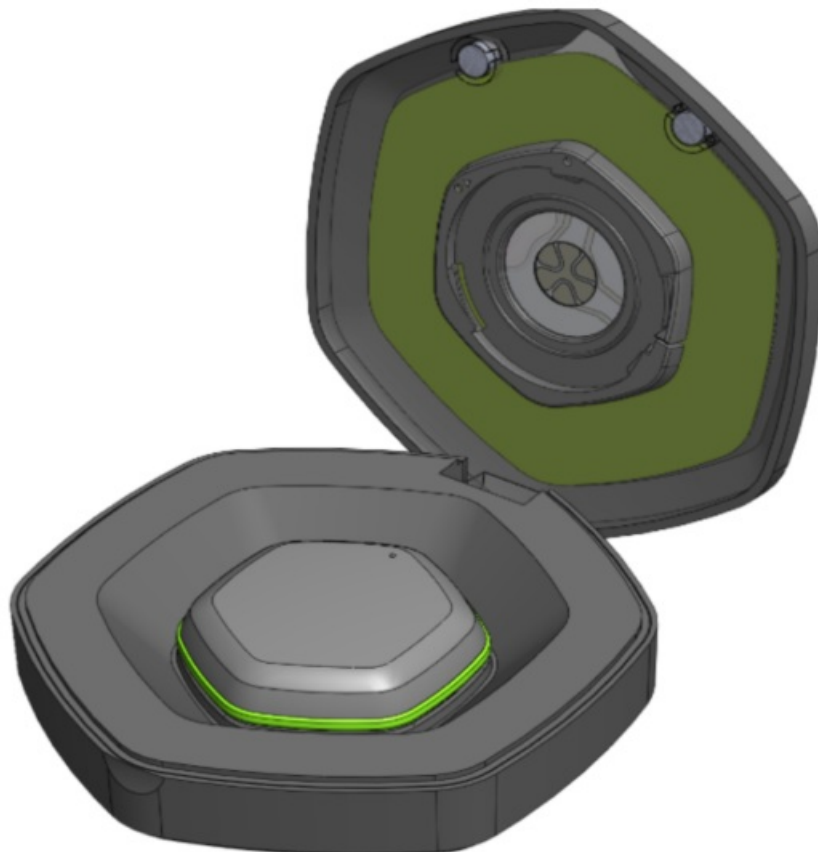

IC28464-E01 FCC ID: 2A6N9E01  
P R O J E C T N I X  
January 2022  
modelE01  
NIX POD Manual

## Contents

- [1 Revision History](#)
- [2 Control and visualization elements](#)
- [3 Create account](#)
- [4 Log in](#)
- [5 Get Started](#)
- [6 Documents / Resources](#)
- [7 Related Posts](#)

## Revision History

Title	Date	Revision By	Approval
Initial Release	20220105		

## Control and visualization elements



1. RGB LED
2. Tactile switch

## Create account

The first step when opening the app for the first time is to create a user account:

No SIM 1:07 PM 74 %

# Register

Already have an account? [Log In](#)

Email



Password

First Name

Last Name

Create Account

Or sign up with

 Google  Facebook

## Log in

Once the user account is created or if one already exists, you must log in.

No SIM 1:07 PM 74 %

# Log In

Don't have an account? [Register](#)

Email

Password

[Forgot Password?](#)

Log In

Or log in with

G Google f Facebook

## Get Started

### 1. Create your profile

Some personal information must be entered in order to create personalized results:

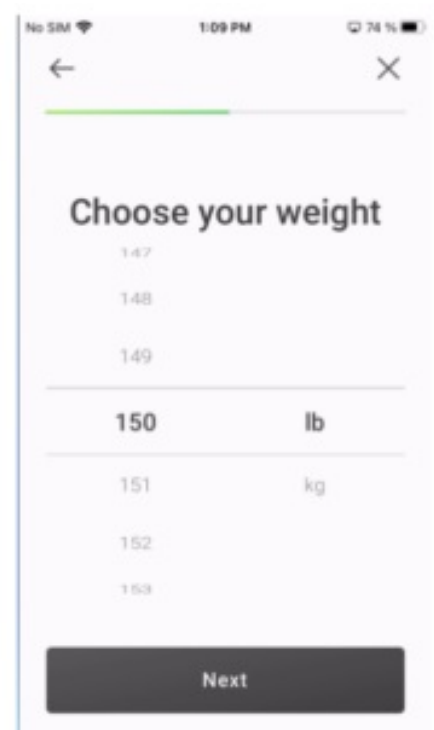
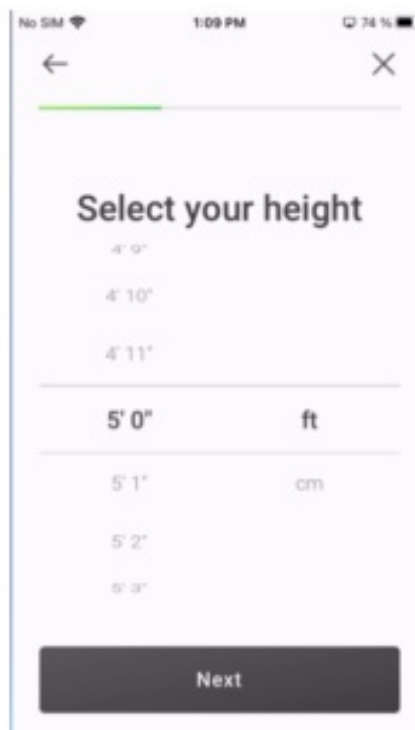
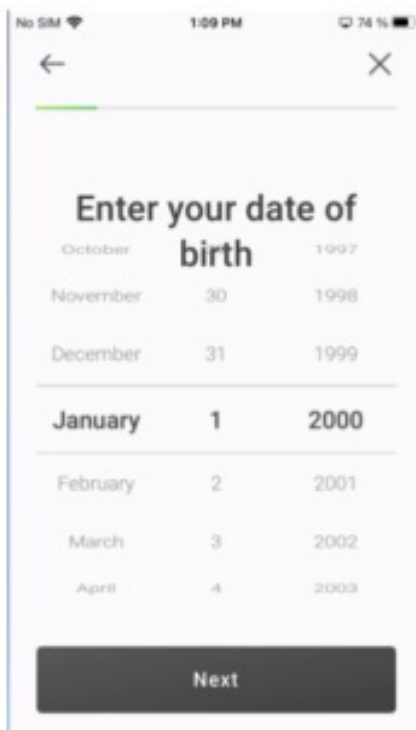
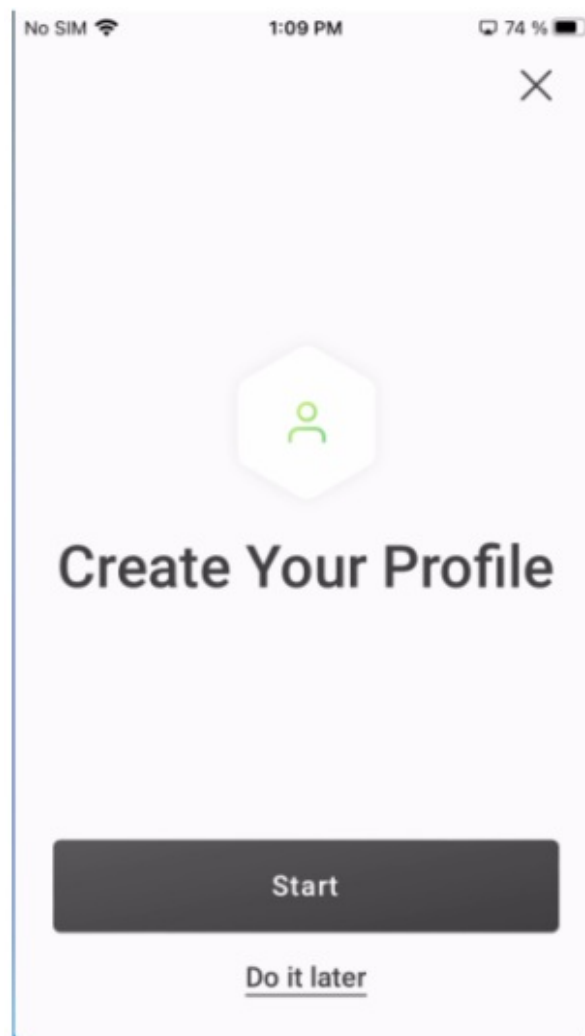

Information that may be sensitive to some users can be omitted

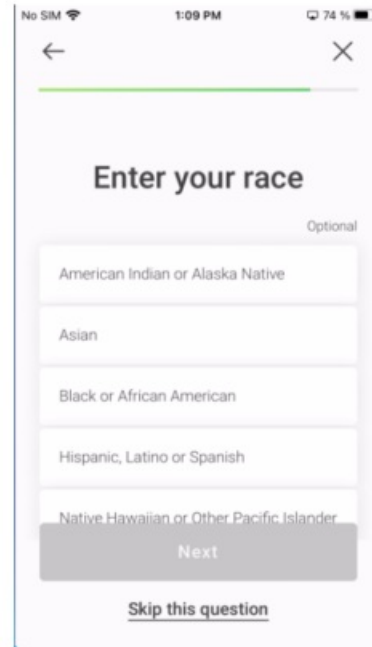
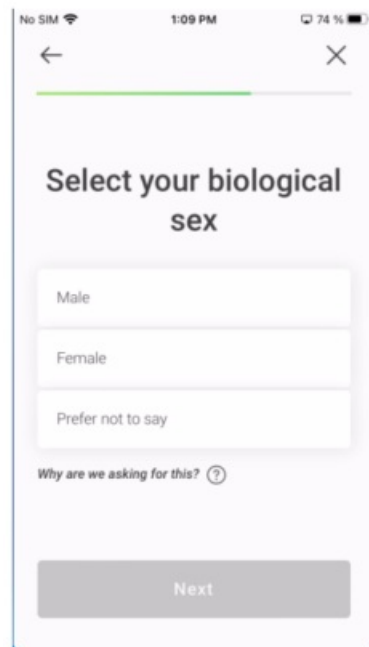

## 2. Pairing

After creating your profile, it is necessary to perform the pairing process with the pod, for this must be pressed and hold the tactile switch for 5 seconds until LED turns blue, then release the button and wait until the app completes the process.

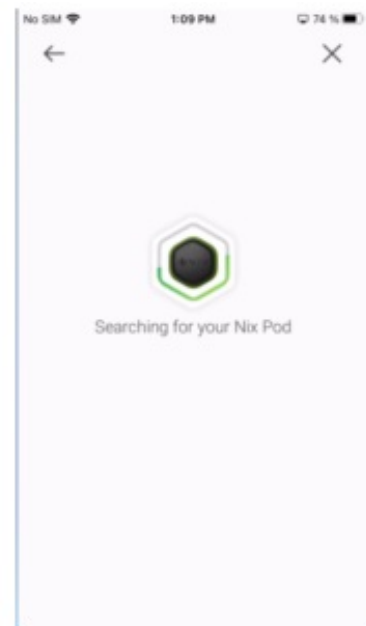
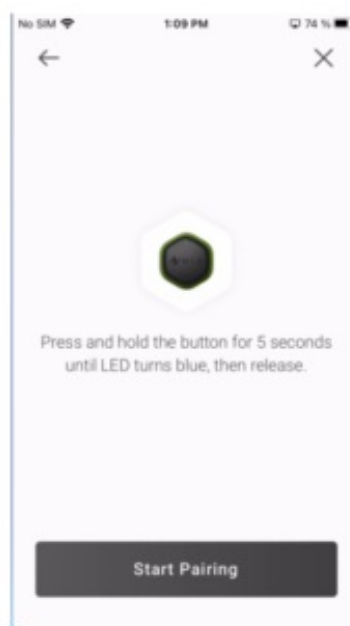
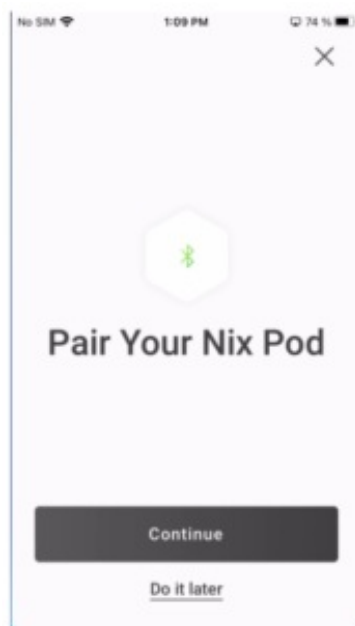

## 3. Start a Workout

To start a workout, touch the play button and follow the instructions.

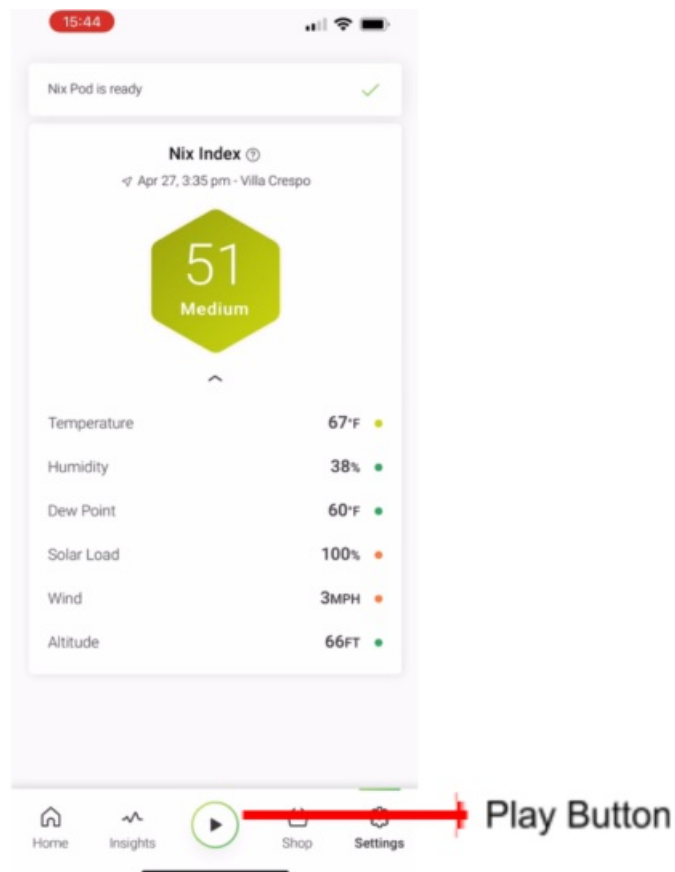

If the pod has a patch installed, the LED shows green with a slow blinking (once per second) and jumps to workout configuration; otherwise, the LED indicates green with a fast blinking (five times per second) and shows a message asking to insert the pod in the patch.

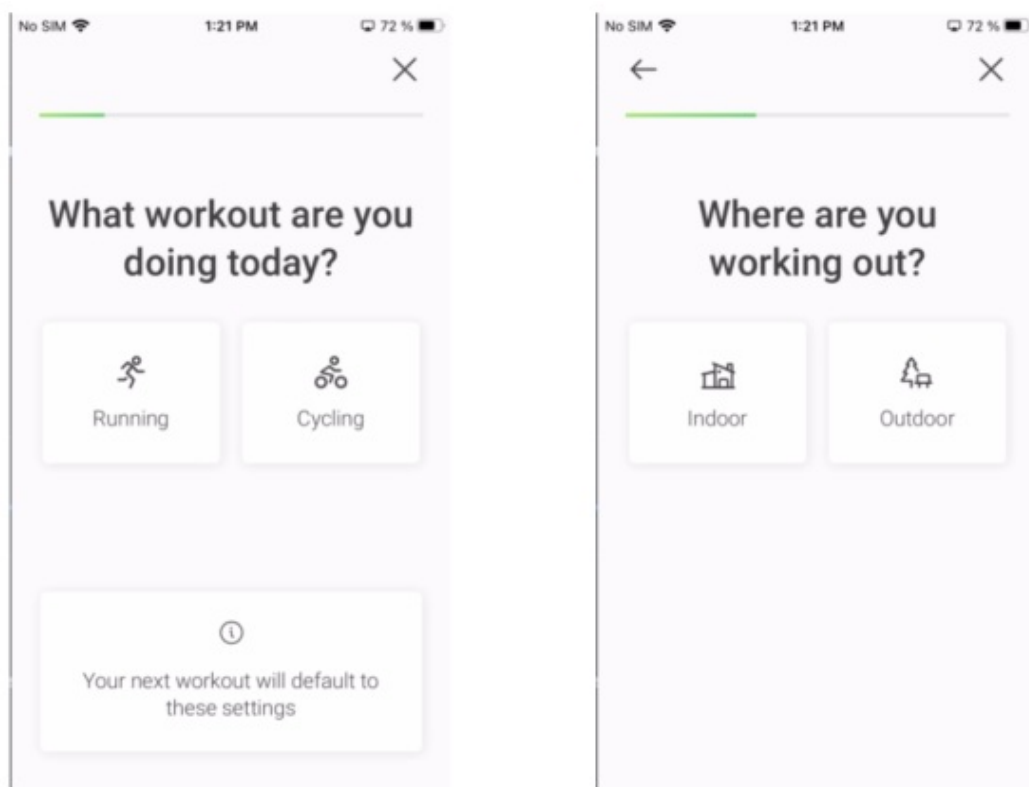

You can choose the type of drink or continue with the process

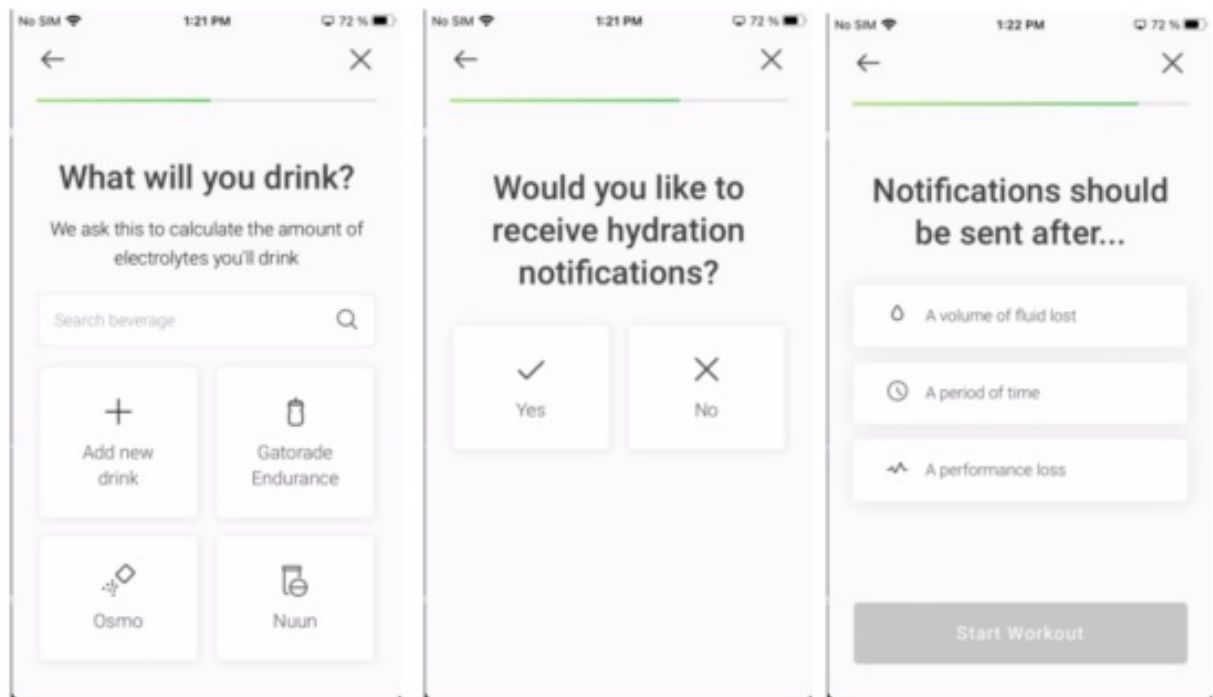

Once the workout configuration is finished, you must press the **start workout** button

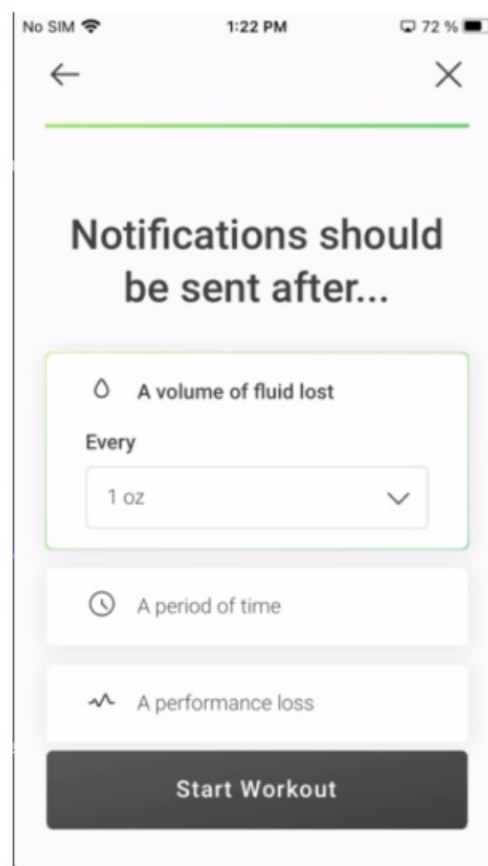

The workout is run (LED shows no color)



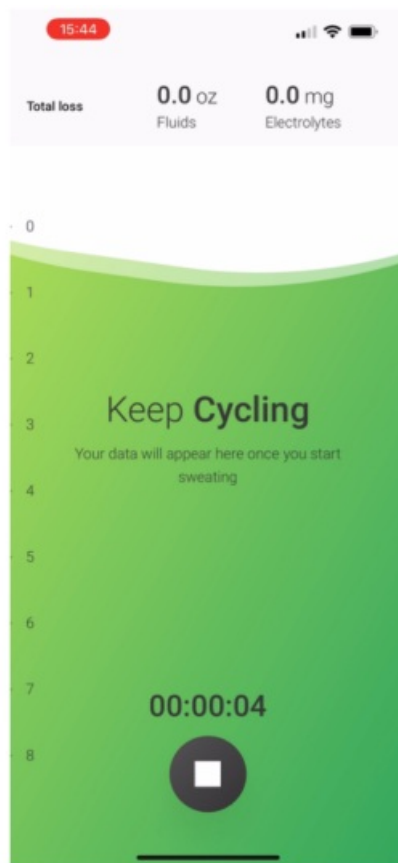

#### 4. End the workout

To end a workout, you must press the stop button located at the bottom center of the screen.

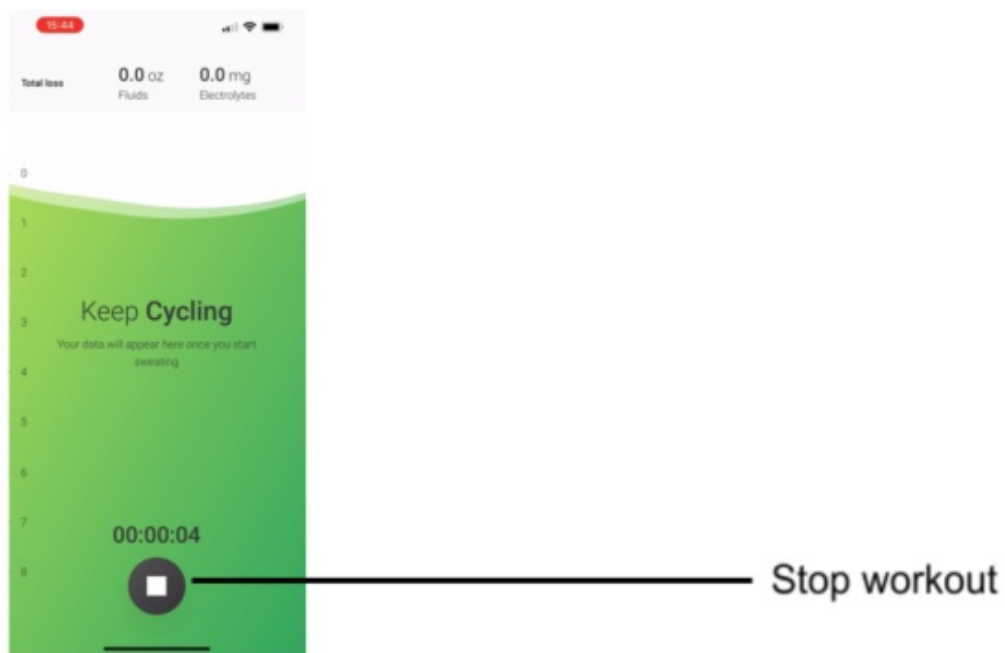

A confirmation message appears before stopping the workout.

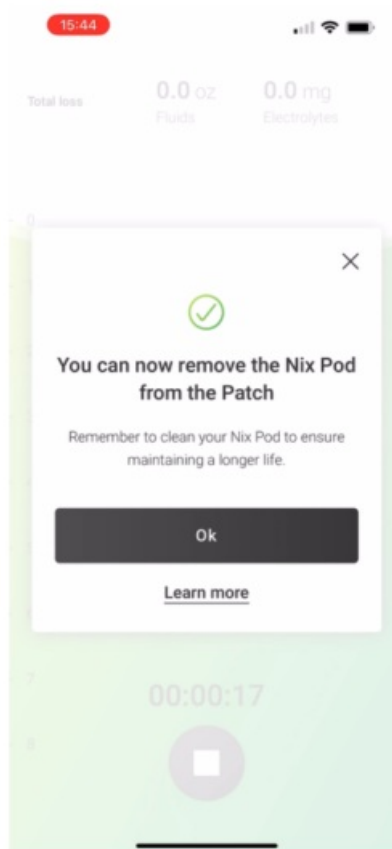

To end the workout the pod must be removed from the patch

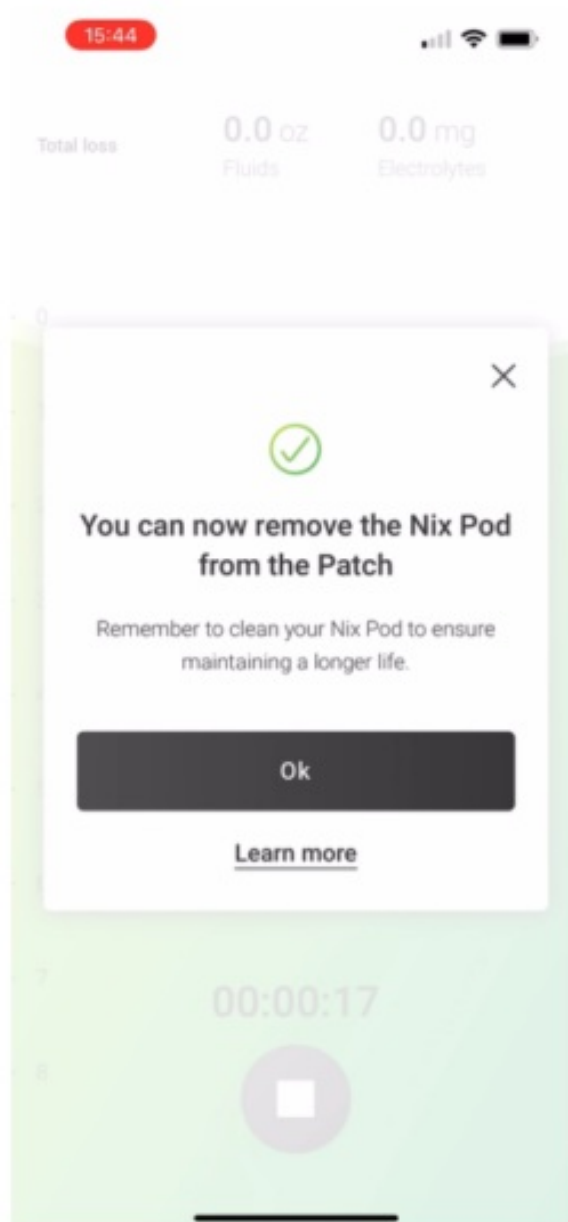

The data of the last workout is available

1.

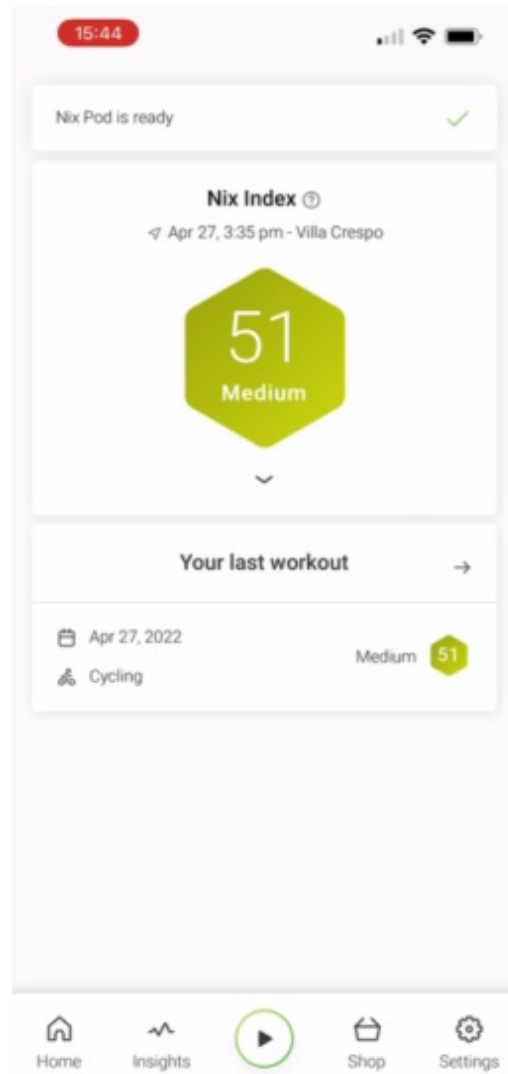

5. Meaning of the RGB LED

MODE AND STATE	LED COLOR	BLINK	COMMENTS
Pairing Bluetooth	BLUE	5Hz	the pairing between POD and host APP
Wait to start			
Ready with patch	GREEN	1Hz	No charger
Idle no patch	GREEN	Hz	No patch and No charger
Charger	AMBER	1Hz	Charging device blink – full charge solid amber
Exercise			
Active with patch	NO COLOR		
Interrupt	RED	5Hz	No patch and no charger
Interrupt + Charger	AMBER	1Hz	Charging device blink – full charge solid amber
Wait to finish			
Have data or patch			
Out of charger	RED	1Hz	No charger – pod is not connected to the charger
Have data + Charger	AMBER	1Hz	Charging device blink – full charge solid amber

- **Blue**

Pairing between Nix Pod and App.

- **Green**

Your Nix Pod is ready for use.

- **Amber**

Blinking – charging.

Solid – fully charged.

- **Red**

In workout – No patch detected or low battery.

Post-workout – No Battery.

## FCC CERTIFICATE STATEMENT

**NOTE:** This equipment has been tested and found to comply with the limits for a Class B digital device, pursuant to part 15 of the FCC Rules. These limits are designed to provide reasonable protection against harmful interference in a residential installation. This equipment generates uses and can radiate radio frequency energy and, if not installed and used in accordance with the instructions, may cause harmful interference to radio communications. However, there is no guarantee that interference will not occur in a particular installation. If this equipment does cause harmful interference to radio or television reception, which can be determined by turning the equipment off and on, the user is encouraged to try to correct the interference by one or more of the following measures:

- Reorient or relocate the receiving antenna.
- Increase the separation between the equipment and receiver.
- Connect the equipment into an outlet on a circuit different from that to which the receiver is connected.
- Consult the dealer or an experienced radio/TV technician for help

Changes or modifications not expressly approved by the party responsible for compliance could void the user’s authority to operate the equipment.

This device complies with Part 15 of the FCC Rules. Operation is subject to the following two conditions:

1. This device may not cause harmful interference, and
2. This device must accept any interference received, including interference that may cause undesired operation.

### IC-ID CERTIFICATE STATEMENT

This device contains license-exempt transmitter(s)/receiver(s) that comply with Innovation, Science, and Economic Development Canada’s license-exempt RSS(s). Operation is subject to the following two conditions:

1. This device may not cause interference.
2. This device must accept any interference, including interference that may cause undesired operation of the device.

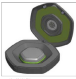

### Documents / Resources

	<p><a href="#">NIX E01 Hydration Biosensor POD</a> [pdf] Instruction Manual E01, 2A6N9E01, Hydration Biosensor POD, E01 Hydration Biosensor POD</p>
---	---