



NIVIAN NVS-IPC-0S4-L-MINI Smart Home WiFi Camera User Guide

[Home](#) » [NIVIAN](#) » NIVIAN NVS-IPC-0S4-L-MINI Smart Home WiFi Camera User Guide 



NVS-IPC-0S4-L-MINI | v20230920



Add information about your installation here to remember it later.

Scheme

Contents

- 1 WELCOME TO THE NIVIAN UNIVERSE
- 2 ACCESS THE MOST COMPLETE INFORMATION
- 3 PERSONALISED SUPPORT AND CUSTOMER SERVICE
- 4 ADD YOUR CAMERA TO THE MOBILE APP
- 5 RISK INFORMATION
- 6 DECLARATION OF CONFORMITY
- 7 LIMITED WARRANTY
- 8 USER RESPONSIBILITY
- 9 Documents / Resources
 - 9.1 References

WELCOME TO THE NIVIAN UNIVERSE

Thank you for your confidence in our products.

Founded more than 10 years ago, Nivian was born from the experience of a leading group of companies in the professional security market throughout Europe.



Our goal is to help you achieve a more peaceful life by ensuring the security and supervision of your home or business, in an easy and simple way.

We dedicate our full commitment and passion into ensuring this product meets your needs. We hope you enjoy it.

ACCESS THE MOST COMPLETE INFORMATION

Become a real expert in Surveillance and Smart home!



Scan the QR codes with your mobile phone to access the contents:

USER MANUAL Detailed information on settings, features and usage of your new device. https://www.nivianhome.com/es/downloads/guides/NVS-IPC-0S4-L-MINI	NIVIAN HC The place to find https://www.nivianhome.com/es/downloads/guides/NVS-IPC-0S4-L-MINI
 	

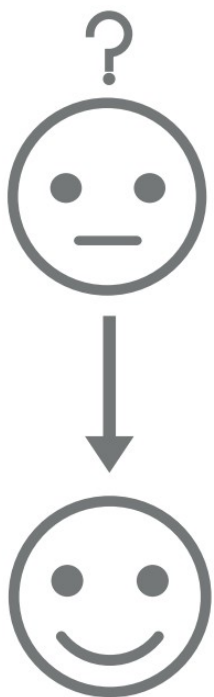
PERSONALISED SUPPORT AND CUSTOMER SERVICE

	<p>DO YOU HAVE ANY QUESTIONS? We look forward to hearing from you!</p> <ul style="list-style-type: none"> · Get in touch through the Contact section on our website · You can also email us at support@nivianhome.com
	<p>IF YOU LIKE OUR PRODUCT, share your experience. Help other users by leaving a review on your sales channel.</p>

Follow us on **SOCIAL NETWORKS** for video tutorials, tips and more.

 	 
https://linkedin.com/company/nivian-home	https://www.instagram.com/nivianhome
 	 
https://www.facebook.com/NivianHomeES/	https://www.youtube.com/nivianhome

ADD YOUR CAMERA TO THE MOBILE APP

We recommend reading the user manual completely, but if you wish to add your new device directly to the app, please follow the steps below:



PRO TIP!

Before installing the camera on its final location, first, perform this setup near your Wi-Fi router and connect your mobile phone to the 2.4GHz Wi-Fi network to which you are going to connect the camera.

1. Download one of the two compatible apps, TUYA SMART or SMART LIFE on your app store, or scan the corresponding QR code:



<https://smartapp.tuya.com/tuyasmart/>



<https://smartapp.smart321.com/smartlife/>

2. Sign up for a new account or log in if you already have one.
3. Click on the  icon and select "Add device".
4. On the left column, select "Camera & Lock" and then "Smart Security Camera (Wi-Fi)".
5. Connect the camera to its power supply and wait a few seconds until you see the camera's LED flash and you hear a continuous "beep" sound. You may need to press the Reset button on the camera for more than 5 seconds for it to reboot and activate its "Connection Mode" again.
6. Follow the steps on the app.

If you have any questions, download the FULL MANUAL for more details.

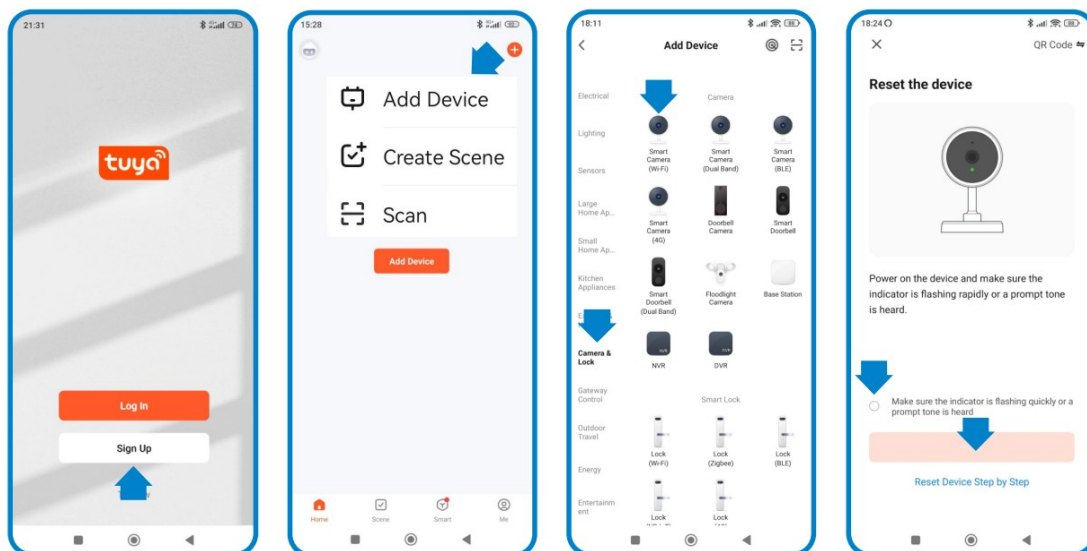

RISK INFORMATION



Keep the product away from heat sources and flammable products. Do not cover the product during operation. Do not apply aggressive or corrosive products on the product.



Check that your electrical installation complies with current regulations. A deficient installation can cause faults and even fires. Do not use power supplies or cables that are in poor condition.



Do not tamper with, apply pressure to, or disassemble the product. This will void the warranty, and there is a risk of electric shock. If the product does not work properly, smoke, suspicious odour or noise appears, disconnect the power supply and contact customer service.



This product, its accessories and packaging are not a toy. Keep them away from children, people or animals to whom they may pose a risk.

DECLARATION OF CONFORMITY



Product manufactured in P.R.C.



This product and the supplied accessories COMPLY WITH THE applicable harmonised EUROPEAN STANDARDS as listed in the following Directives: 2014/53/EU for radio equipment, 2014/30/EU for CE, 2011/65/EU for RoHS, 2012/19/EU for WEEE and 2006/66/EC for batteries (where applicable), as well as the other directives listed in the product's DECLARATION OF CONFORMITY.



All company, brand and product names are registered trademarks of their respective companies.



© 2018 Long Xian Import Export S.L. All rights reserved.



Products marked with this WEEE symbol cannot be disposed of as unsorted municipal waste in the European Union. For PROPER RECYCLING, please dispose of the product and any batteries at designated collection points.

LIMITED WARRANTY

For a period of 24 months from the date of the first purchase of the product, Long Xian Import Export S.L., as responsible for the Nivian brand, shall be held accountable for any lack of conformity that exists at the time of delivery of the product, under the terms and conditions established in local, state and/or community legislation.

THIS WARRANTY IS BASED ON THE SPECIFIC LEGAL REGULATIONS, AND ADDITIONAL RIGHTS MAY EXIST DEPENDING ON THE COUNTRY OR REGION, APPLICABLE EXCLUSIVELY IN THAT PLACE, WITHOUT BEING EXTENDED TO OTHERS.

You can also exercise this guarantee by going to the place where you bought the product, according to the conditions set by the sales centre.

In the event that the goods are not in conformity with the contract, and upon presentation of the purchase receipt or invoice, you may claim the right to have the goods repaired or replaced, in accordance with the specific consumer regulations of the region.

This warranty shall not apply if the defect has been caused by the purchaser and/or any third party, due to misuse, negligence or application of the good for a use other than that for which it was intended. The warranty claim shall be recognised when exercised within the warranty period and proof of purchase is provided. This warranty does not cover shipping costs, insurance or any other ancillary costs.

The warranty is valid for the European Union. For other countries, please consult the applicable legislation or your local distributor.

USER RESPONSIBILITY

Proper configuration of all passwords and other security settings of both the device and the network itself are important. Please note that in this case, we cannot be held responsible for possible damage.

This security system is offered as a complement that provides limited reliability in the detection of events. Under no circumstances does it constitute a guarantee of protection, which cannot be claimed for this purpose.

To the extent permitted by law, our company is not liable for damages or losses related to the use of the product or its accessories. We simply guarantee its functionalities. Likewise, we are not responsible for any illegitimate or inappropriate use.

Product specifications, as well as the contents of the manual and accessories, are subject to change without notice.



Documents / Resources

	<p>NIVIAN NVS-IPC-0S4-L-MINI Smart Home WiFi Camera [pdf] User Guide</p> <p>NVS-IPC-0S4-L-MINI Smart Home WiFi Camera, NVS-IPC-0S4-L-MINI, Smart Home WiFi Camera, Home WiFi Camera, WiFi Camera, Camera</p>
--	--

References

- [Nivian Home - Cámaras IP WiFi al mejor precio](#)
- [User Manual](#)

This website is an independent publication and is neither affiliated with nor endorsed by any of the trademark owners. The "Bluetooth®" word mark and logos are registered trademarks owned by Bluetooth SIG, Inc. The "Wi-Fi®" word mark and logos are registered trademarks owned by the Wi-Fi Alliance. Any use of these marks on this website does not imply any affiliation with or endorsement.