

NIVIAN NVS-IPC-04-BAT WIFI Battery Camera User Manual

Contents

- [1 NIVIAN NVS-IPC-04-BAT WIFI Battery Camera](#)
- [2 Product Usage Instructions](#)
- [3 DAILY USE OF THE CAMERA FROM THE APP TUYA SMART](#)
- [4 FEATURES](#)
- [5 CAMERA SETTINGS FROM THE TUYA SMART APP](#)
- [6 RISK INFORMATION](#)
- [7 DECLARATION OF CONFORMITY](#)
- [8 LIMITED WARRANTY](#)
- [9 USER RESPONSIBILITY](#)
- [10 Documents / Resources](#)
 - [10.1 References](#)
- [11 Related Posts](#)

NIVIAN NVS-IPC-04-BAT WIFI Battery Camera



Specifications

- Model: NVS-IPC-04-BAT
- Version: v20241007

Product Usage Instructions

Daily Use of the Camera from the App TUYA SMART

- Playback: Play detected video events.
- Gallery: View captured photos and videos.
- Color Theme: Change app theme between light and dark modes.
- Private Mode: Turn off camera recording.
- Night Mode, Infrared Mode.
- Device Volume control.
- Motion Detection: Enable or disable motion detection.
- PIR: Activate or deactivate presence detection sensor.
- Siren: Activate or deactivate deterrent siren.

Camera Settings from the TUYA SMART App

- Change device name.
- Voice Assistant Settings.
- Display device information in the cloud.
- Assign scenes to the device.
- Show Wi-Fi connection status.
- Share the device with registered users.

Frequently Asked Questions (FAQ)

Q: Can I use the camera without a Wi-Fi connection?

A: The camera requires a Wi-Fi connection for setup and regular operation. It does not work offline.

ADD YOUR CAMERA TO THE MOBILE APP

PRO TIP!

Before installing the camera on its final location, first, perform this setup near your Wi-Fi router and connect your mobile phone to the 2.4GHz Wi-Fi network to which you are going to connect the camera.

1. Download one of the two compatible apps, TUYA SMART or SMART LIFE on your app store, or scan the corresponding QR code:



2. Sign up for a new account or log in if you already have one.
3. Click on the + icon and select "Add device".
4. On the left column, select "Camera & Lock" and then "Smart Security Camera (Wi-Fi)".
5. Connect the camera to its power supply and wait a few seconds until you see the camera's LED flash and you hear a continuous "beep" sound. You may need to press the Reset button on the camera for more than 5

seconds for it to reboot and activate its “Connection Mode” again.

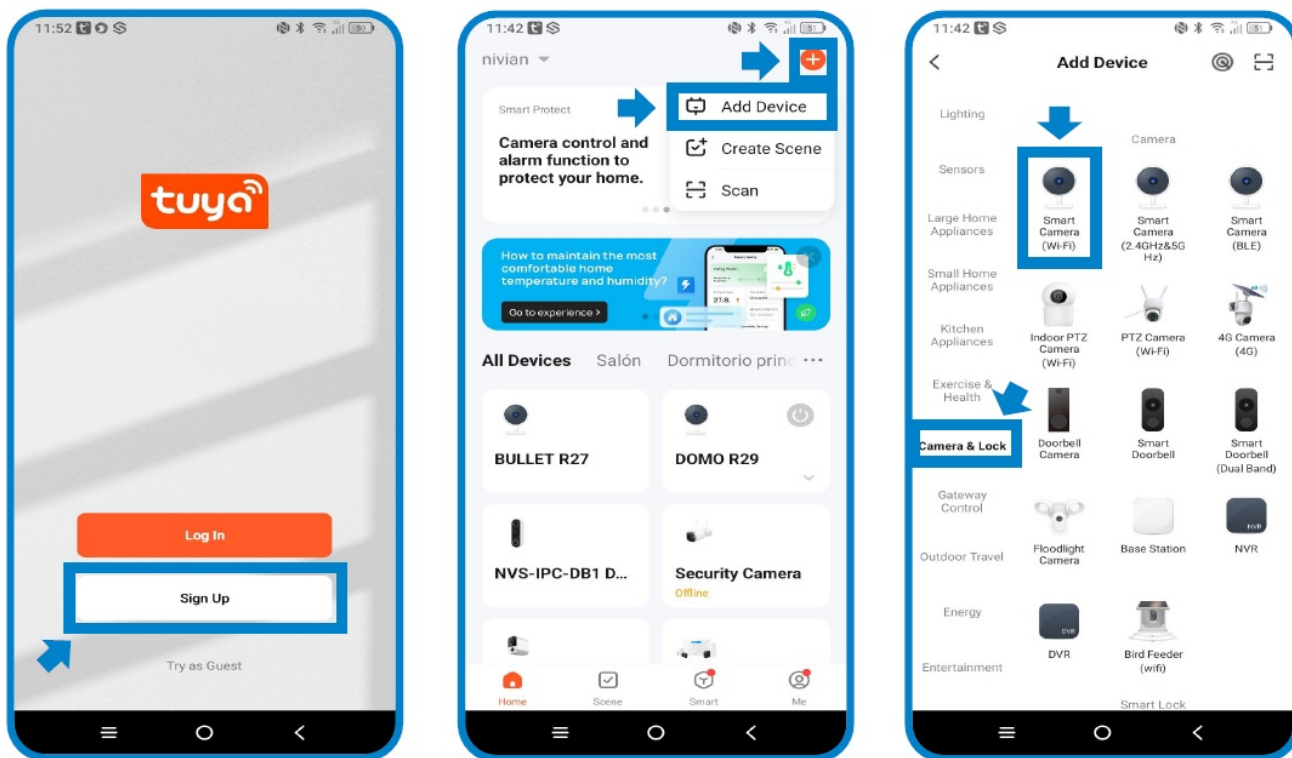

6. The cell phone must be connected to a 2.4Ghz wifi network.

1. Remove the lens protector.
2. Press the reset button on the camera.

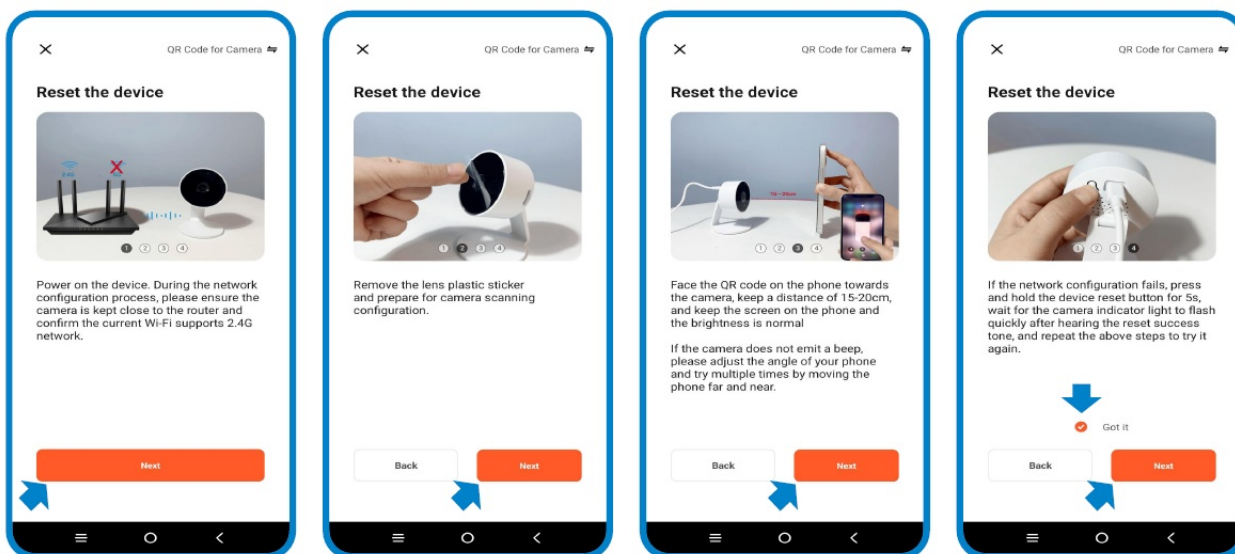

7. Enter the password for your Wi-Fi network.

1. Place the QR code that has been generated in front of the camera so that the camera can read it and connect to the Wi-Fi network.
2. Once you've heard the double tone, press the “I heard the warning” button.
3. A two-minute on-screen countdown will begin, during which time the app will search for the camera and add it to the app.

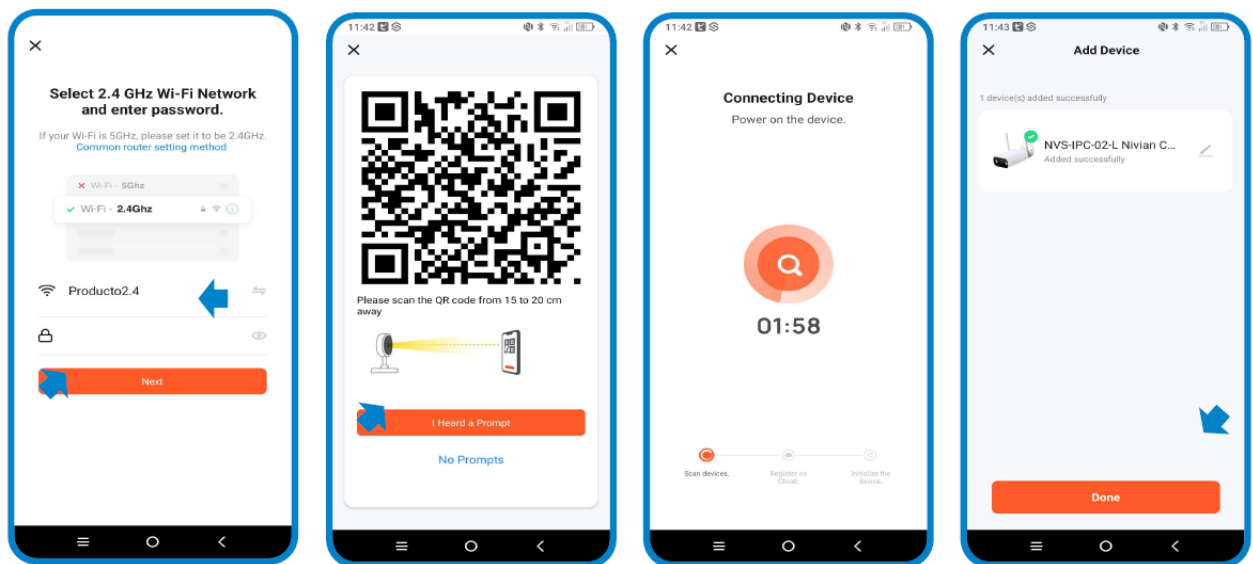

DAILY USE OF THE CAMERA FROM THE APP TUYA SMART

PRO TIP!

You must have a MicroSD memory installed in the camera or have a contracted cloud service to be able to view the video events.

FEATURES

1. Playback > Allows you to play the detected video events.
2. Gallery > Shows the captures of photos and videos recorded from the app on the mobile.
3. Color Theme > Allows you to change the color theme of the app in light mode and dark mode.
4. Private Mode > When activated, the camera will be turned off and will not record video
5. Nightmode, Infraredmode.
6. Devicevolumen.
7. Motion Detection > Enables or disables this function.
8. PIR > Activates or deactivates the presence detection sensor.
9. Siren > Activates or deactivates the deterrent siren

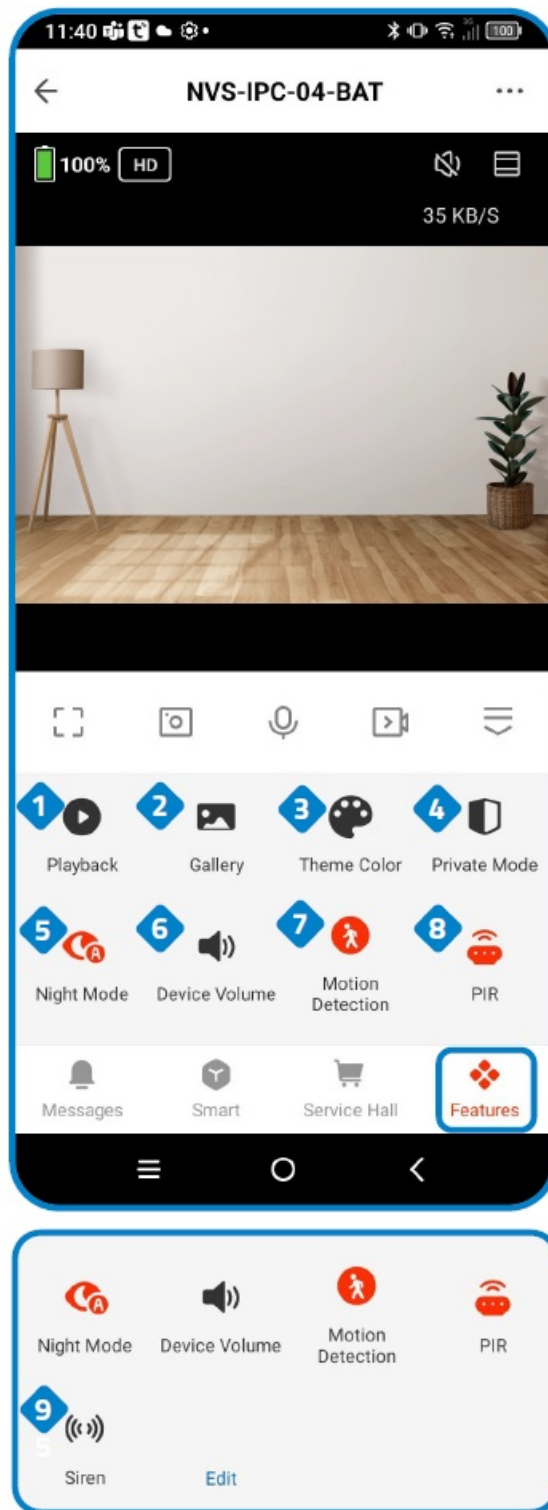

SERVICE HALL

1. It is a function under paid subscription, which allows you to monitor and supervise the operation of the camera in the event of the loss of the video or if the device has been turned off, if it detects any of these events the Tuya Smart app will notify the error that the camera presents so that the user can check the status of the camera.

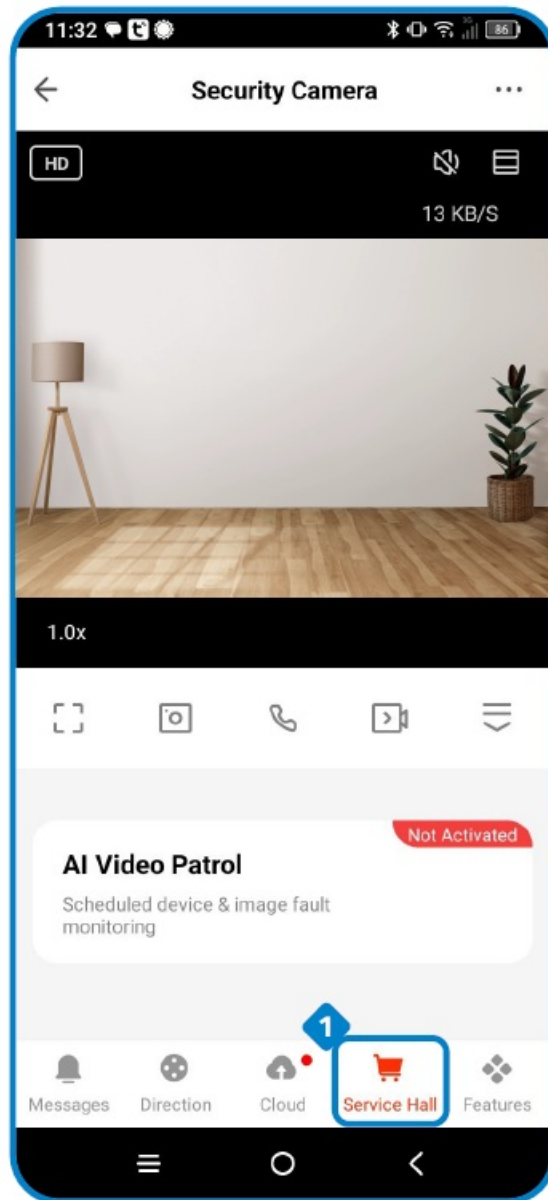

CLOUD

1. It is a service under subscription of monthly or annual payment and allows you to store events or video recordings in the cloud, these recordings will always be accessible to the customer from the Tuya Smart App.

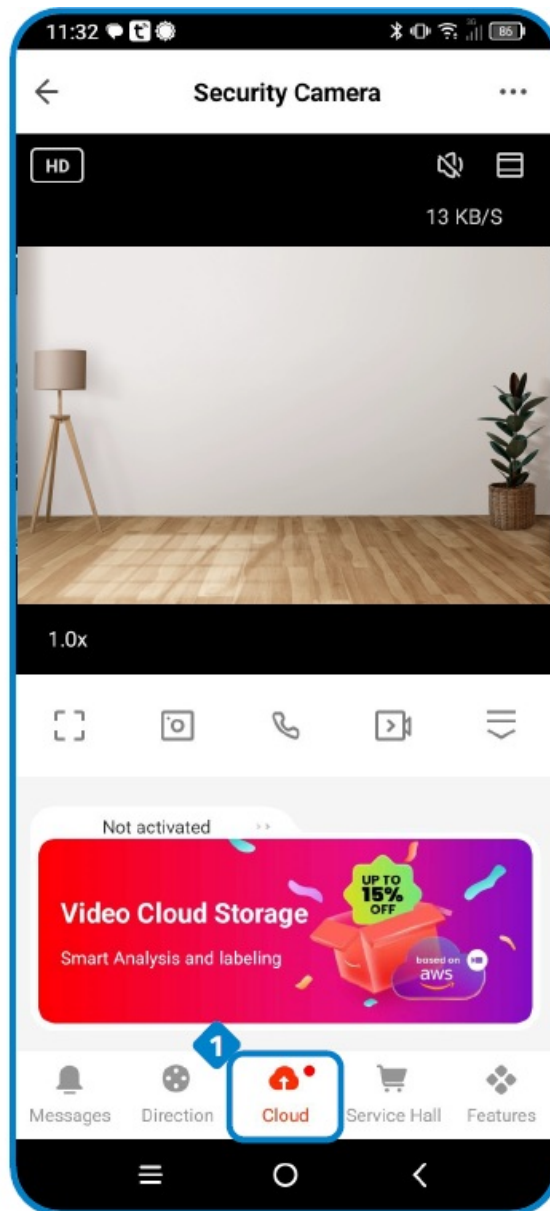

MESSAGES

1. Shows the detections that the camera has made.
2. Settings.

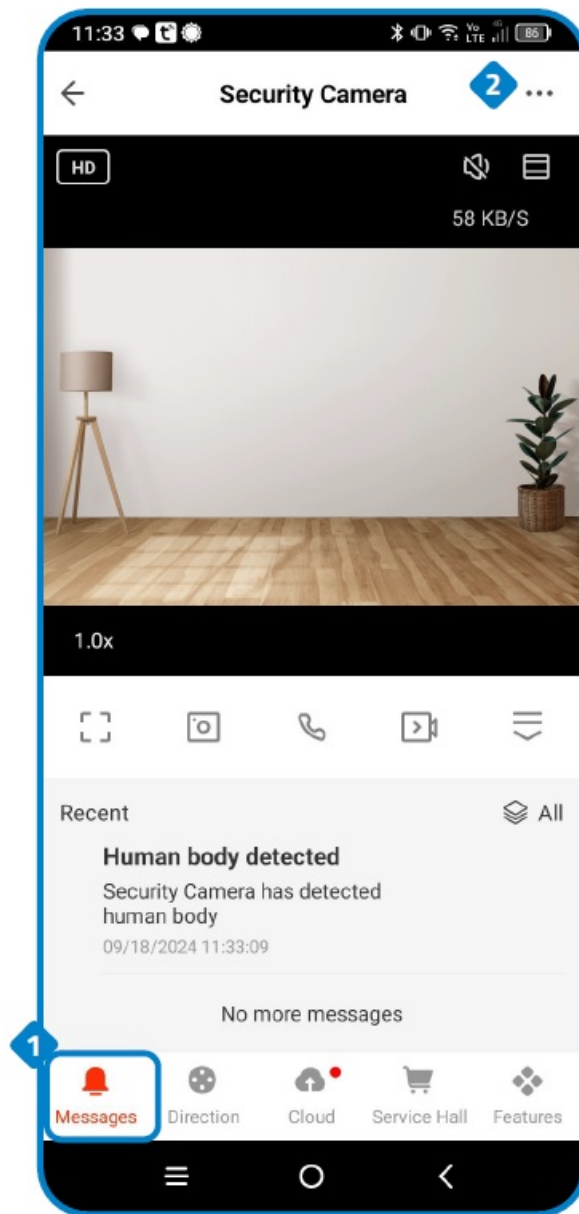

CAMERA SETTINGS FROM THE TUYA SMART APP

PRO TIP!

You must have a MicroSD memory installed in the camera or have a contracted cloud service to be able to view the video events.

SETTINGS

1. Allows you to change the name of the device.
2. Voice Assistant Settings.
3. Display device information in the cloud.
4. Allows you to assign previously created scenes.
5. Shows the connection status of the device on the Wi-Fi network, whether signal strength with the camera is weak or strong.
6. It allows you to share the device with third parties, the person must be previously registered in the Smart app to be able to share the device.
7. It is a paid service and allows you to create personalized notifications through calls and SMS messages about the status of the device and detections.

8. Private Mode > When activated, the camera will be turned off and will not record video.
9. It allows you to configure image rotation, watermark, two-way audio mode and camera calibration.

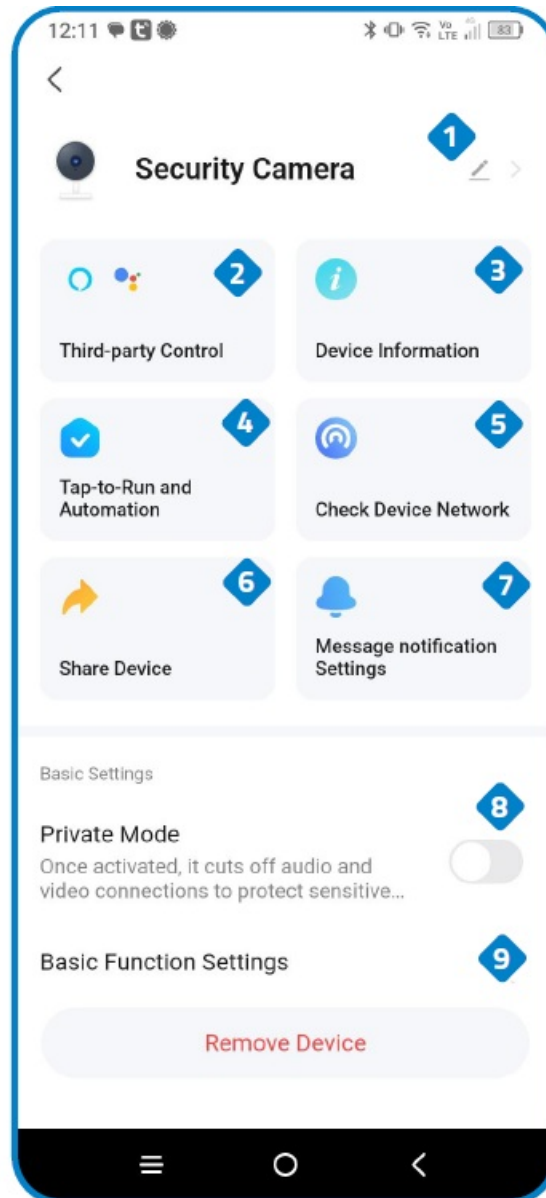

SETTINGS

1. Enable or disable night mode in infrared only or color mode, automatic mode is active.
2. Image configuration
3. Adjust the volume of the device.
4. Enables the activation of event detection, automatic tracking, area.
5. Motion detection sensor sensitivity settings.
6. Displays the battery status.
7. Displays the storage capacity of the microSD card, also allows you to format the memory.
8. Delete device.

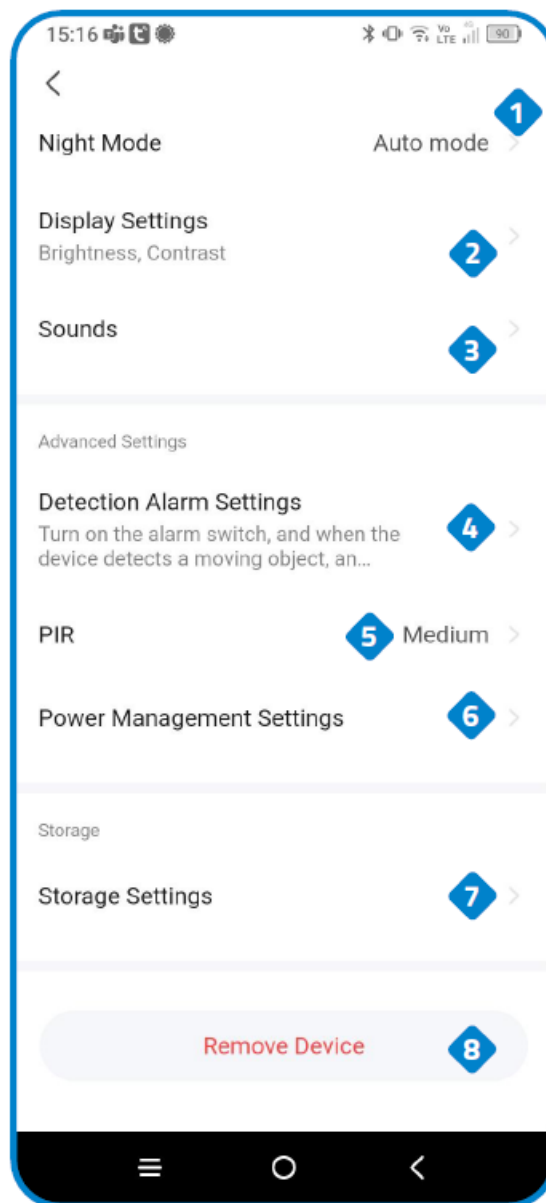

SETTINGS

1. It allows you to contract cloud storage services.
2. Review the product.
3. Enabling this option will notify you if your device is turned off.
4. HelpCenter.
5. Add a shortcut to the home screen on mobile.
6. Displays the firmware version and whether updates are available.
7. Configuration of access of the cameras via web on a computer. <https://protect-eu.ismartlife.me>

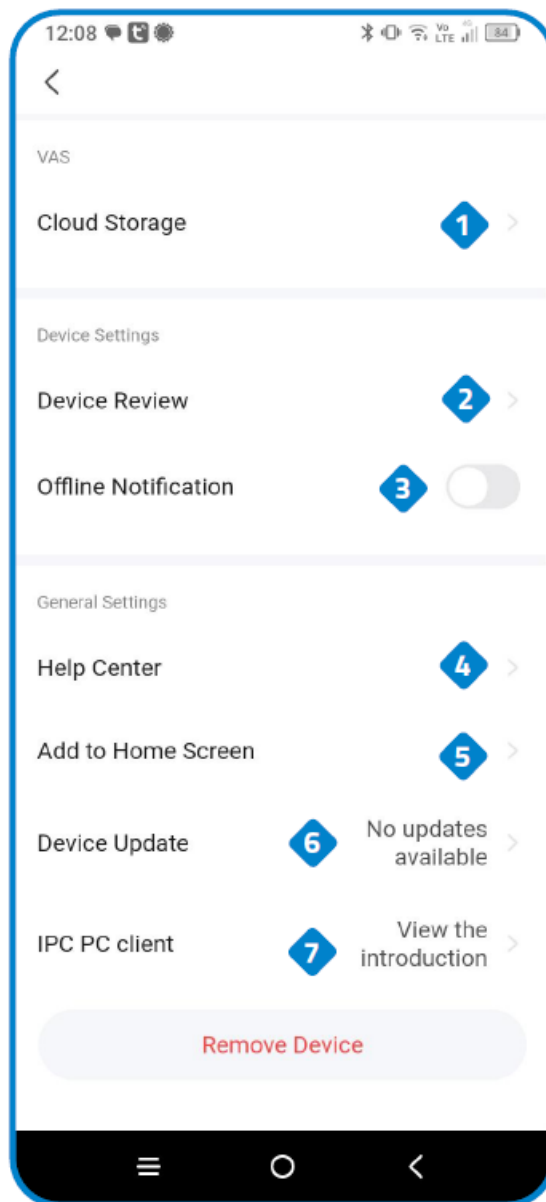

RISK INFORMATION



Keep the product away from heat sources and flammable products. Do not cover the product during operation. Do not apply aggressive or corrosive products on the product.



Check that your electrical installation complies with current regulations. A deficient installation can cause faults and even fires. Do not use power supplies or cables that are in poor condition.



Do not tamper with, apply pressure to, or disassemble the product. This will void the warranty, and there is a risk of electric shock. If the product does not work properly, smoke, suspicious odour or noise appears, disconnect the power supply and contact customer service.



This product, its accessories and packaging are not a toy. Keep them away from children, people or animals to whom they may pose a risk.

DECLARATION OF CONFORMITY



- Product manufactured in P.R.C.



- This product and the supplied accessories COMPLY WITH THE applicable harmonized EUROPEAN STANDARDS as listed in the following Directives:



- 2014/53/EU for radio equipment, 2014/30/EU for CE, 2011/65/EU for RoHS, 2012/19/EU for WEEE and 2006/66/EC for batteries (where applicable), as well as the other directives listed in the product's DECLARATION OF CONFORMITY.



- All company, brand and product names are registered trademarks of their respective companies.
©2018 Long Xian Import Export S.L. All rights reserved.

•



- Products marked with this WEEE symbol cannot be disposed of as unsorted municipal waste in the European Union. For PROPER RECYCLING, please dispose of the product and any batteries at designated collection points.

LIMITED WARRANTY

- For a period of 24 months from the date of the first purchase of the product, Long Xian Import Export S.L., as responsible for the Nivian brand, shall be held accountable for any lack of conformity that exists at the time of delivery of the product, under the terms and conditions established in local, state and/or community legislation.
- THIS WARRANTY IS BASED ON THE SPECIFIC LEGAL REGULATIONS, AND ADDITIONAL RIGHTS MAY EXIST DEPENDING ON THE COUNTRY OR REGION, APPLICABLE EXCLUSIVELY IN THAT PLACE, WITHOUT BEING EXTENDED TO OTHERS.
- You can also exercise this guarantee by going to the place where you bought the product, according to the conditions set by the sales centre.
- In the event that the goods are not in conformity with the contract, and upon presentation of the purchase receipt or invoice, you may claim the right to have the goods repaired or replaced, in accordance with the specific consumer regulations of the region.
- This warranty shall not apply if the defect has been caused by the purchaser and/or any third party, due to misuse, negligence or application of the good for a use other than that for which it was intended. The warranty claim shall be recognised when exercised within the warranty period and proof of purchase is provided. This warranty does not cover shipping costs, insurance or any other ancillary costs.
- The warranty is valid for the European Union. For other countries, please consult the applicable legislation or your local distributor.

USER RESPONSIBILITY

- Proper configuration of all passwords and other security settings of both the device and the network itself are important. Please note that in this case, we cannot be held responsible for possible damage.

- This security system is offered as a complement that provides limited reliability in the detection of events. Under no circumstances does it constitute a guarantee of protection, which cannot be claimed for this purpose.
- To the extent permitted by law, our company is not liable for damages or losses related to the use of the product or its accessories. We simply guarantee its functionalities. Likewise, we are not responsible for any illegitimate or inappropriate use.
- Product specifications, as well as the contents of the manual and accessories, are subject to change without notice.

Documents / Resources

	<p>NIVIAN NVS-IPC-04-BAT WIFI Battery Camera [pdf] User Manual</p> <p>NVS-IPC-04-BAT WIFI Battery Camera, NVS-IPC-04-BAT, WIFI Battery Camera, Battery Camera, Camera</p>
---	--

References

-  [protect-eu.ismartlife.me](https://t.me/protect-eu.ismartlife.me)
- [User Manual](#)

Manuals+, Privacy Policy

This website is an independent publication and is neither affiliated with nor endorsed by any of the trademark owners. The "Bluetooth®" word mark and logos are registered trademarks owned by Bluetooth SIG, Inc. The "Wi-Fi®" word mark and logos are registered trademarks owned by the Wi-Fi Alliance. Any use of these marks on this website does not imply any affiliation with or endorsement.