



NINJA Nutri-Blender Pro Personal Blender with Auto-iQ Owner's Manual

[Home](#) » [Ninja](#) » NINJA Nutri-Blender Pro Personal Blender with Auto-iQ Owner's Manual 

NINJA[®]

**BN400
Series
OWNER'S GUIDE
NUTRI-BLENDER PRO**





ninjakitchen.com

**THANK YOU FOR PURCHASING
The Ninja® Nutri-Blender Pro**



<http://registeryourninja.com>

REGISTER YOUR PURCHASE

	registeryourninja.com
	1-877-646-5288
	Scan QR code using a mobile device

RECORD THIS INFORMATION

Model Number:

Serial Number:

Date of Purchase:

(Keep receipt)

Store of Purchase:

TECHNICAL SPECIFICATIONS

Voltage: 120V~ 60Hz

Power: 1000 Watts

**PLEASE READ CAREFULLY AND
KEEP FOR FUTURE REFERENCE.**



TIP: You can find the model and serial numbers on the QR code label on the back of the unit by the power cord.

Contents

- 1 IMPORTANT SAFEGUARDS
- 2 GETTING TO KNOW YOUR NINJA®
- 3 USING THE CONTROL PANEL
- 4 USING THE SINGLE-SERVE CUP
- 5 CARE & MAINTENANCE
- 6 TROUBLESHOOTING GUIDE
- 7 REPLACEMENT PARTS
- 8 PRODUCT REGISTRATION
- 9 What is covered by this warranty?
- 10 Documents / Resources
 - 10.1 References
- 11 Related Posts

IMPORTANT SAFEGUARDS

HOUSEHOLD USE ONLY • READ ALL INSTRUCTIONS BEFORE USE

	Read and review instructions for operation and use.
	Indicates the presence of a hazard that can cause personal injury, death, or substantial property damage if the warning included with this symbol is ignored.
	For indoor and household use only.
When using electrical appliances, basic safety precautions should always be followed, including the following:	



WARNING

To reduce the risk of fire, electric shock, serious injury, death, or damage when using this appliance, follow these basic safety precautions.

General Precautions

1. Read all instructions prior to using the appliance and its accessories.
2. Carefully observe and follow all warnings and instructions. This unit contains electrical connections and moving parts that potentially present a risk to the user.
3. **ALWAYS** exercise care when handling the Pro Extractor Blades® Assembly. The blades are sharp, handle carefully. **ONLY** grasp the Pro Extractor Blades Assembly by the outer perimeter of the blade assembly base. Failure to use care when handling the blade assembly will result in a risk of laceration.
4. Take your time and exercise care during unpacking and appliance setup. This appliance contains sharp, loose blades that can cause injury if mishandled.
5. Take inventory of all contents to ensure you have all parts needed to properly and safely operate your appliance.
6. Blades are sharp. Handle carefully.
7. Unplug the appliance from the outlet when not in use, before assembling or disassembling parts, and before cleaning. To unplug, grasp the plug by the body and pull from the outlet. **NEVER** unplug by grasping and pulling the flexible cord.
8. Before use, wash all parts that may contact food. Follow the washing instructions covered in this instruction manual.
9. To protect against the risk of electric shock, **DO NOT** submerge the appliance or allow the power cord to contact any form of liquid.
10. **DO NOT** use this appliance outdoors. It is designed for indoor household use only.
11. This appliance has important markings on the plug blade. The attachment plug or entire cord set (if the plug is molded onto the cord) is not suitable for replacement. If damaged, the appliance shall be replaced.
12. This appliance has a polarized plug (one prong is wider than the other). To reduce the risk of electric shock, this plug will fit in a polarized outlet only one way. If the plug does not fit fully in the outlet, reverse the plug. If it still does not fit, contact a qualified electrician. **DO NOT** modify the plug in any way.
13. **DO NOT** operate any appliance with a damaged cord or plug, or after the appliance malfunctions or is dropped or damaged in any manner. This appliance has no user-serviceable parts. If damaged, contact SharkNinja for servicing.

14. Extension cords should **NOT** be used with this appliance.
15. **DO NOT** allow children to operate this appliance or use it as a toy. Close supervision is necessary when any appliance is used near children.
16. This appliance is **NOT** intended to be used by people with reduced physical, sensory, or mental capabilities, or lack of experience and knowledge unless they have been given supervision or instruction concerning the use of the appliance by a person responsible for their safety.
17. Before each use, inspect blade assembly for damage. If a blade is bent or damage is suspected, contact SharkNinja to arrange for a replacement.
18. **DO NOT** attempt to sharpen blades.
19. **DO NOT** allow the unit or the cord to hang over the edges of tables or counters. The cord may become snagged and pull the appliance off the work surface.
20. **DO NOT** allow any part of the unit to contact hot surfaces, including stoves and other heating appliances.
21. **ALWAYS** use the appliance on a dry and level surface.
22. **NEVER** place a blade assembly on the motor base without it first being attached to the cup.
23. Keep hands, hair, and clothing out of the container when loading and operating
24. **Only** use attachments and accessories that are provided with the product or are recommended by SharkNinja. The use of attachments not recommended or sold by SharkNinja may cause fire, electric shock, or injury.
25. During operation and handling of the appliance, avoid contact with moving parts.
26. **DO NOT** operate the appliance with an empty container.
27. **DO NOT** fill containers past the MAX FILL or MAX LIQUID lines.
28. **DO NOT** microwave any containers or accessories provided with the appliance.
29. **DO NOT** perform grinding operations.
30. Before operation, ensure all utensils are removed from containers. Failure to remove utensils can cause containers to shatter and potentially result in personal injury and property damage.
31. **NEVER** operate the appliance without lids and caps in place. **DO NOT** attempt to defeat the interlock mechanism. Ensure the container and lid are properly installed before operation.
32. **DO NOT** expose the containers and accessories to extreme temperature changes. They may experience damage.
33. **NEVER** leave the appliance unattended while in use.
34. **DO NOT** blend hot liquids. Doing so may result in pressure buildup and steam exposure that can pose a risk of the user being burned.
35. If you find unmixed ingredients sticking to the sides of the cup, stop the appliance, remove the blade assembly, and use a scraper to dislodge ingredients.
36. **DO NOT** attempt to remove the container and lids from the motor base while the blade assembly is still spinning. Allow the appliance to come to a complete stop before removing lid and container.
37. Remove the Pro Extractor Blades® Assembly from the Single-Serve Cup upon completion of blending. **DO NOT** store ingredients before or after blending them in the cup with the blade assembly attached. Some foods may contain active ingredients or release gases that will expand if left in a sealed container, resulting in excessive pressure buildup that can pose a risk of injury. For ingredient storage in the cup, use only Spout Lid to cover.
38. If the appliance overheats, a thermal switch will activate and temporarily disable the motor. To reset, unplug the appliance and allow it to cool for approximately 15 minutes before using it again.
39. The maximum wattage rating for this appliance is based on the configuration of the Pro Extractor Blades

Assembly and Single-Serve Cup. Other configurations may draw less power or current.

40. **DO NOT** process dry ingredients without adding liquid to the Single-Serve Cup. They are not intended for dry blending.
41. To protect against risk of electrical shock, **DO NOT** immerse the motor base in water or other liquid. Unplug the motor base before cleaning.

SAVE THESE INSTRUCTIONS

GETTING TO KNOW YOUR NINJA®

PARTS

A (2) Spout Lids

B (2) Single-Serve Cups

C Pro Extractor Blades® Assembly

D Motor Base (attached power cord not shown)

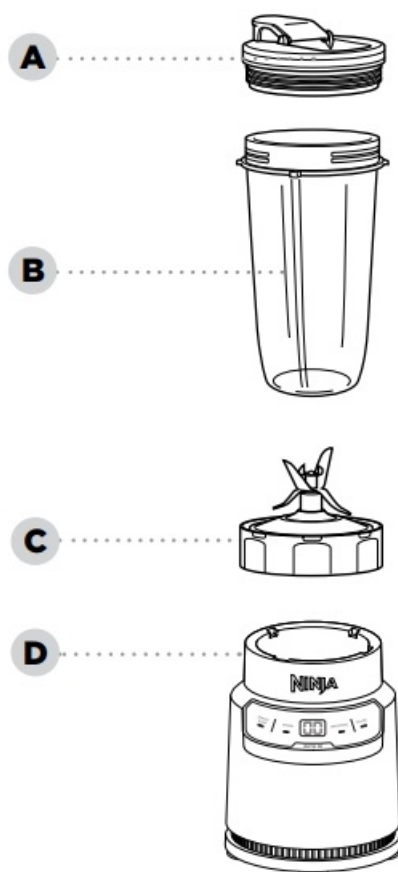

NOTE: Number and size of Single-Serve Cups/Spout Lids vary by model.

BEFORE FIRST USE

IMPORTANT: Review all warnings on pages 4–5 before proceeding.

NOTE: Handle the Pro Extractor Blades Assembly by grasping around the perimeter of the blade assembly base.

NOTE: All attachments are BPA-free and dishwasher safe. Ensure blade assembly and lid are removed from the container before placing it in the dishwasher. Exercise care when handling blade assembly.

1. Remove all packaging materials from the unit. Exercise care when unpacking blade assembly, as the blades are sharp.

2. Wash containers, lids, and blade assembly in warm, soapy water using a dishwashing utensil with a handle to avoid direct contact with the blades. Exercise care when handling blade assembly, as the blades are sharp.
3. Thoroughly rinse and air-dry all parts.

USING THE CONTROL PANEL

AUTO-IQ® PROGRAMS

Intelligent preset programs combine unique blending and pausing patterns that do the work for you. Once a preset program is selected, it will start immediately and automatically stop when blending is complete. To stop blending before the end of the program, press START/STOP or the currently active button again.

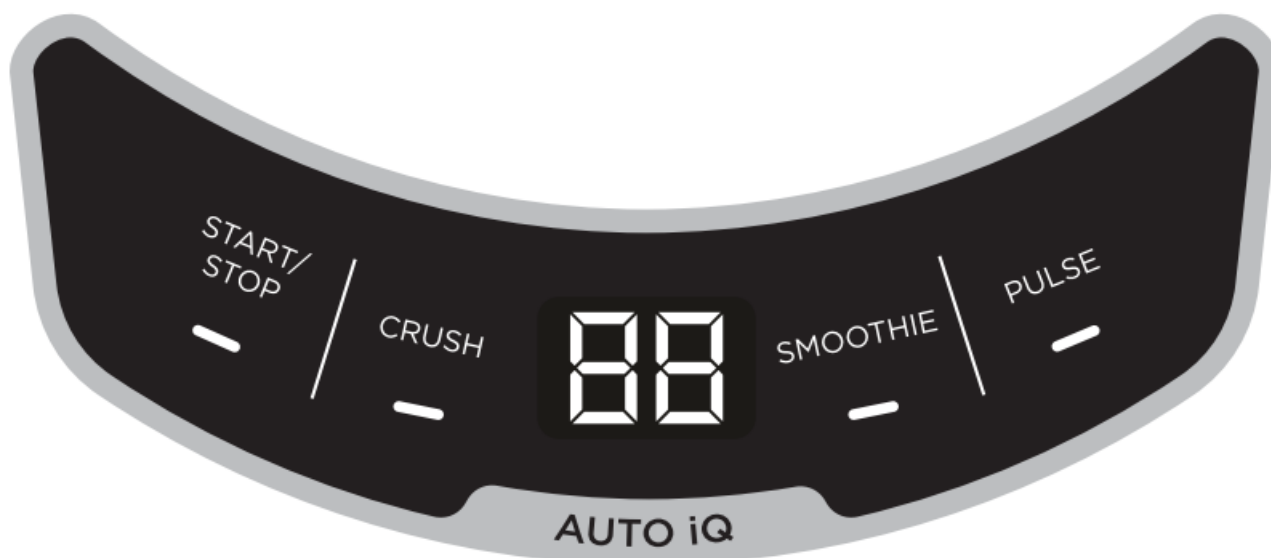

AUTO-IQ PROGRAMS:

CRUSH

Turn ice, juices, and fruit into expertly blended frozen drinks.

SMOOTHIE

Combine your favorite fresh or frozen ingredients, liquids, and powders to create smoothies and protein shakes.

MANUAL PROGRAMS:

NOTE: Manual programs cannot be used in conjunction with any Auto-iQ programs.

START/STOP

Press once to start continuous running for up to 60 seconds; press again to stop. Can also be pressed to stop a running Auto-iQ program.

PULSE

Offers greater control of pulsing and blending. Operates only when PULSE is pressed. Use short presses for short pulses and long presses for long pulses.

USING THE SINGLE-SERVE CUP

IMPORTANT: Review all warnings on pages 4–5 before proceeding.

1. Plug in motor base and place on a clean, dry, level surface such as a countertop or table.



2. Add ingredients to the Single-Serve Cup. **DO NOT** add ingredients past the **MAX LIQUID** line.

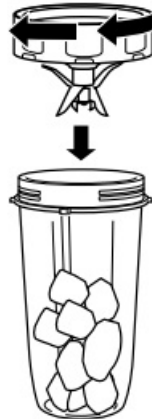

3. Place the Pro Extractor Blades® Assembly on the top of the cup and turn clockwise to seal.

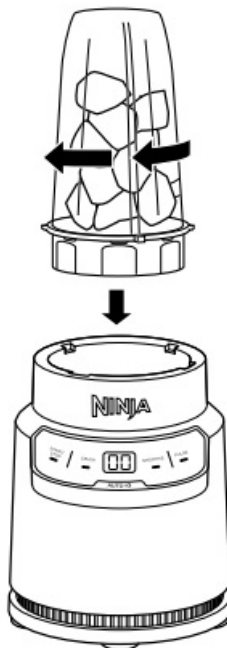

4. Turn the cup upside down and install it on the motor base by aligning the tabs on the cup with the slots on the base. Then, rotate the cup clockwise until it clicks. Once locked in place, the programs will illuminate and the unit will be ready for use.

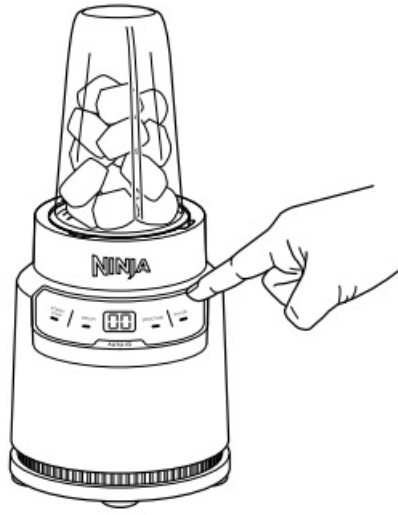

5. **a** If using an Auto-iQ® program, select the program that best suits your desired output. The preset feature will automatically stop at the end of the program. To stop the unit at any time, press the currently active program again
- 5b** If using START/STOP, once the ingredients have reached your desired consistency, press START/STOP again, and wait for the unit to come to a complete stop.

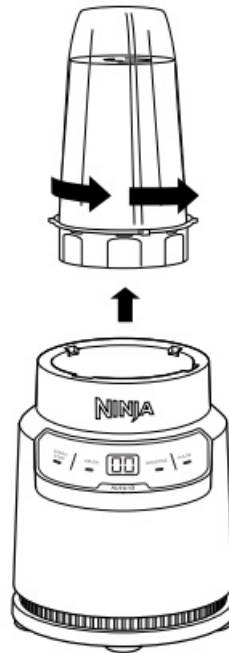

6. Remove the cap from the motor base by turning it counterclockwise and then lifting it up.



7. Remove the blade assembly by twisting counterclockwise. **DO NOT** store blended contents with the blade assembly attached. Only use the Spout Lid to cover. Exercise care when handling the blade assembly, as the blades are sharp.



8. To enjoy on the go, place the Spout Lid onto the cup and twist the lid clockwise until firmly sealed.



9. Unplug the unit when finished. Refer to the Care & Maintenance section for cleaning and storage instructions.

CARE & MAINTENANCE

CLEANING

Hand-Washing

Wash containers, lids, and blade assembly in warm, soapy water. Use a dishwashing utensil with a handle to avoid direct contact with the blades. Exercise care when handling the blade assembly as the blades are sharp. Thoroughly rinse and air-dry all parts.

Dishwasher

Containers, lids, and blade assembly are dishwasher safe. Ensure the blade assembly and lid are removed from the container before placing them in the dishwasher.

Motor Base

Unplug the unit before cleaning. Wipe motor base with a clean, damp cloth.

STORING

Wrap the power cord around the cord wrap on the underside of the motor base. Store the unit upright and with the blade assembly attached to the single-serve cup.

DO NOT store blended or unblended ingredients in the cup with the blade assembly attached. Use only the spout lid when storing blended or unblended ingredients in the containers.

DO NOT stack items on top of the containers. Store any remaining attachments alongside the unit or in a cabinet where they will not be damaged or create a hazard.

RESETTING THE

MOTOR THERMOSTAT

This unit features a unique safety system that prevents damage to the motor and drive system should you inadvertently overload it. If the unit is overloaded, the motor will be temporarily disabled. Should this occur, follow the reset procedure below.

1. Unplug the unit from the electrical outlet.

2. Allow the unit to cool for approximately 15 minutes.
3. Remove the blade assembly from the container. Empty the container and ensure no ingredients are jamming the blade assembly.

IMPORTANT: Ensure that maximum capacities are not exceeded. This is the most typical cause of appliance overload. If your unit needs service, call Customer Service at 1-877-646-5288. So we may better assist you, please register your product online at registeryourninja.com and have the product on hand when you call.

TROUBLESHOOTING GUIDE

WARNING: To reduce the risk of shock and unintended operation, unplug unit before troubleshooting.

Control panel does not illuminate.

- Make sure unit is plugged in. If the unit is powered on and no container is installed, the unit will display ‘- -’. The available programs will illuminate after placing a container on base and rotate it clockwise until it clicks into place.

Control panel doesn’t turn off.

- Remove the container from the base by rotating it counterclockwise and lifting it up. The display will flash ‘- -’. Unplug the power cord from the outlet. If the unit remains plugged in, the display will time out after 3 minutes of inactivity. Press any button to wake the unit.

Display reads “Er”.

- If the display reads “Er”, unplug the unit from the electrical outlet and allow it to cool for 15 minutes. Remove the blade assembly and empty the contents to ensure no ingredients are jamming the blade assembly.

Doesn’t mix well; ingredients get stuck.

- Using the Auto-iQ® programs is the easiest way to achieve great results. The pulses and pauses allow the ingredients to settle toward the blade assembly. If ingredients are routinely getting stuck, adding some liquid will usually help.
- When filling the cup, start with fresh fruit or veggies, then leafy greens or herbs. Next, add liquids or yogurt, then seeds, powders, or nut butter. Finally, add ice or frozen ingredients.

Unit moves on counter while blending.

- Make sure the counter and feet of the unit are clean and dry.

Lid or Pro Extractor Blades® Assembly is hard to install on the container.

- Set the container on a level surface. Carefully place the lid or blade assembly on the top of the container and align the threads so the lid/blade assembly sits flat. Twist clockwise until you have a tight seal.

REPLACEMENT PARTS

To order additional parts and attachments, visit ninjaaccessories.com.

PRODUCT REGISTRATION

Please visit registeryourninja.com to register your new Ninja® product within ten (10) days of purchase. You will be asked to provide the store name, date of purchase, and model number along with your name and address. The registration will enable us to contact you in the unlikely event of a product safety notification. By registering, you acknowledge you have read and understood the instructions for use and warnings set forth in the accompanying instructions.



ONE (1) YEAR LIMITED WARRANTY

The One (1) Year Limited Warranty applies to purchases made from authorized retailers of **SharkNinja Operating LLC**. Warranty coverage applies to the original owner and to the original product only and is not transferable. SharkNinja warrants that the unit shall be free from defects in material and workmanship for a period of one (1) year from the date of purchase when it is used under normal household conditions and maintained according to the requirements outlined in the Owner's Guide, subject to the following conditions and exclusions:

What is covered by this warranty?

1. The original unit and/or non-wearable parts deemed defective, in SharkNinja's sole discretion, will be repaired or replaced up to one (1) year from the original purchase date.
2. In the event a replacement unit is issued, the warranty coverage ends six (6) months following the receipt date of the replacement unit or the remainder of the existing warranty, whichever is later. SharkNinja reserves the right to replace the unit with one of equal or greater value.

What is not covered by this warranty?

1. Normal wear and tear of wearable parts (such as blending vessels, lids, blades, blender bases, etc.), which require regular maintenance and/or replacement to ensure the proper functioning of your unit, are not covered by this warranty. Replacement parts are available for purchase at ninjaaccessories.com.
2. Any unit that has been tampered with or used for commercial purposes
3. Damage caused by misuse, abuse, negligent handling, failure to perform required maintenance (e.g., failure to keep the well of the motor base clear of food spills and other debris), or damage due to mishandling in transit.
4. Consequential and incidental damages.
5. Defects caused by repair persons not authorized by SharkNinja. These defects include damages caused in the process of shipping, altering, or repairing the SharkNinja product (or any of its parts) when the repair is performed by a repair person not authorized by SharkNinja.
6. Products purchased, used, or operated outside North America.

How to get service

If your appliance fails to operate properly while in use under normal household conditions within the warranty

period, visit ninjakitchen.com/support for product care and maintenance self-help. Our Customer Service Specialists are also available at **1-877-646-5288** to assist with product support and warranty service options, including the possibility of upgrading to our VIP warranty service options for select product categories. So we may better assist you, please register your product online at registeryourninja.com and have the product on hand when you call.

SharkNinja will cover the cost for the customer to send in the unit to us for repair or replacement. A fee of \$20.95 (subject to change) will be charged when SharkNinja ships the repaired or replacement unit.

How to initiate a warranty claim

You must call 1-877-646-5288 to initiate a warranty claim. You will need the receipt as proof of purchase. We also ask that you register your product online at registeryourninja.com and have the product on hand when you call, so we may better assist you. A Customer Service Specialist will provide you with return and packing instruction information.

How state law applies

This warranty gives you specific legal rights, and you also may have other rights that vary from state to state. Some states do not permit the exclusion or limitation of incidental or consequential damages, so the above may not apply to you.

NOTES

SharkNinja Operating LLC
US: Needham, MA 02494
1-877-646-5288
ninjakitchen.com

Illustrations may differ from the actual product. We are constantly striving to improve our products; therefore the specifications contained herein are subject to change without notice.

AUTO-IQ, NINJA, and PRO EXTRACTOR BLADES are registered trademarks of SharkNinja Operating LLC.

This product may be covered by one or more U.S. patents.

See sharkninja.com/patents for more information.

© 2022 SharkNinja Operating LLC

BN400Series_IB_E_REV_Mv1



@ninjakitchen
ninjakitchen.com

Documents / Resources

	<p>NINJA Nutri-Blender Pro Personal Blender with Auto-iQ [pdf] Owner's Manual BN400 Series, Nutri-Blender Pro Personal Blender with Auto-iQ, Nutri-Blender Pro, Personal Blender with Auto-iQ</p>
---	---

References

-  [Blenders, Air Fryers, Indoor Grills, Cookware & More – Ninja](#)
-  [Sign In](#)
-  sharkninja.com/patents

Manuals+.