



NINJA CB100UK Power Nutri Blender 2-in-1 User Guide

[Home](#) » [Ninja](#) » NINJA CB100UK Power Nutri Blender 2-in-1 User Guide 

NINJA[®]

Foodi[®]

Contents

- [1 What's in the Box](#)
- [2 Using the Unit](#)
- [3 Blend & Enjoy](#)
- [4 Cleaning](#)
- [5 Documents / Resources](#)
 - [5.1 References](#)
- [6 Related Posts](#)

What's in the Box



Base



Power Nutri[™] Cup
with Spout Lid



Power Nutri[™] Bowl
with Storage Lid



Hybrid Edge[™] Blades
Assembly

Using the Unit

START/STOP

Press once to start continuous running up to 60 seconds; press again to stop.

PULSE

Use short presses for short pulses and long presses for long pulses.

Use the **POWER NUTRI™ CUP** with the drinks programs

BLEND

Fruit Smoothie
Milkshake

CRUSH

Ice Drink
Green Smoothie



Use the **POWER NUTRI™ BOWL** with these programs to create thicker outputs

MIX

Smoothie Bowl
Frozen Yogurt

POWERMIX

Houmous
Pâté

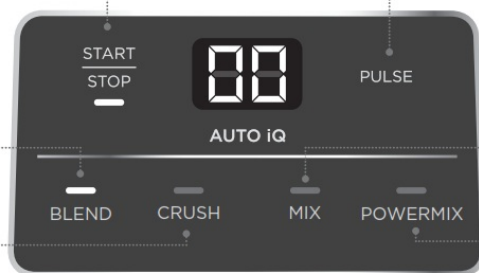

Auto-iQ® Programs

Intelligent preset programs combine unique blending and pausing patterns that do the work for you.

Tips

START/STOP and PULSE cannot be used in conjunction with any Auto-iQ programs. To stop running an Auto-iQ program before it's done, press the currently active button again.



Fill container with desired contents. Screw on the blade assembly until you have a tight seal.



Flip container upside down and install on base. Rotate clockwise until it clicks into place.

Blend & Enjoy



1. Select any program to begin blending.
2. If using the Power Nutri™ Bowl, twist the Power Paddle anti-clockwise continuously while processing.
3. When blending is complete, remove the container from base. Then, remove the blade assembly from container.

Taking It To Go?

Place the Storage Lid or Spout Lid on top of the bowl or cup and turn clockwise to seal.

NOTE: DO NOT microwave or freeze the Power Nutri™ Bowl or Power Nutri™ Cup.



WARNING: Handle the blade assembly with care, as the blades are sharp.

DID YOU KNOW?

Smoothie bowls are thicker & spoonable, compared to smoothies which are thinner & drinkable.



SMOOTHIE BOWL BASICS USING THE POWER NUTRI™ BOWL



1.

Add milk or a milk alternative such as soy, coconut, almond, or oat milk, up to the LIQUID FILL line.
ALWAYS DO THIS FIRST.

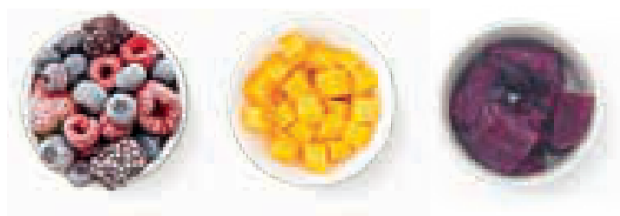

2.

Add frozen fruits, directly from freezer and/or açai, up to the MAX FILL line.
Cut larger fruit like bananas, in quarters.
If using açai, thaw slightly and cut in quarters.



3. (Optional)

Amplify your base by adding 1 scoop of yogurt, flavour powder, protein powder, and/or nut butter.

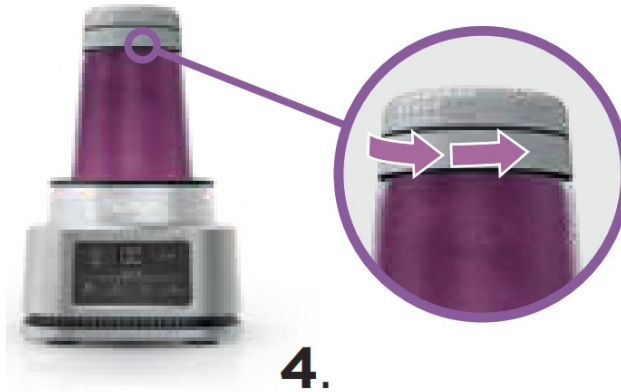

4.

Screw on the blade assembly and install the bowl on the motor base.
Select MIX and twist the Power Paddle anti-clockwise continuously while processing.



5.

After blending is complete, add your favorite toppings such as coconut flakes, granola, fresh bananas, berries, and agave nectar.

Cleaning

STUCK-ON INGREDIENTS IN THE POWER NUTRI™ BOWL?



1. Rinse the bowl and blade assembly under WARM WATER after processing.
2. Fill the bowl with warm water up to the top of the paddle and add 1–2 SMALL DROPS of washing-up liquid.
3. Screw on the blade assembly and press MIX. Twist the Power Paddle anti-clockwise continuously while cleaning.
4. Once complete, empty contents and rinse under warm water.

NOTE: The Power Paddle in the Power Nutri™ Bowl is not removable.



Dishwasher

Containers, lids, and blade assembly are ONLY dishwasher safe on the top rack.



Hand-Washing

Wash containers, lids, and blade assembly in warm, soapy water. When washing the blade assembly, use a dishwashing utensil with a handle.



WARNING: Handle the blade assembly with care when washing, as the blades are sharp. Contact with the blades' edges can result in a laceration.

For questions or to register your product, visit us online at ninjakitchen.co.uk



@ninjakitchenuk

© 2020 SharkNinja Operating LLC.

AUTO-IQ, FOODI, and NINJA are registered trademarks of SharkNinja Operating LLC.

HYBRID EDGE is a trademark of SharkNinja Operating LLC.

CB100UK_QSG_MP_200914_Mv3

Documents / Resources

	NINJA CB100UK Power Nutri Blender 2-in-1 [pdf] User Guide CB100UK, Power Nutri Blender 2-in-1
--	--

References

- [N Ninja UK - Kitchen Appliances | Blenders, Air Fryers, Grills & More](#)