



NINJA Blender Instructions

[Home](#) » [Ninja](#) » NINJA Blender Instructions 

NINJA®

INSTRUCTIONS
BLENDER
BN495UK



**THANK YOU FOR PURCHASING
your Ninja® Blender**



<https://ninjakitchen.co.uk/register-guarantee/>

REGISTER YOUR PURCHASE



ninjakitchen.co.uk/register-guarantee/



Scan QR code using mobile device

RECORD THIS INFORMATION

Model Number:

Serial Number:

Date of Purchase:.....

(Keep receipt)

Store of Purchase:

TECHNICAL SPECIFICATIONS

Voltage: 220-240V~, 50-60Hz

Power: 1000 Watts

CUP CAPACITY: 700ml

PLEASE READ CAREFULLY AND KEEP IT FOR FUTURE REFERENCE.

TIP: You can find the model and serial numbers on the QR code label located on the back of the unit by the power cord.

GUARANTEE: This product is unconditionally guaranteed for one year against all defects of workmanship and materials. This guarantee does not affect your statutory rights. If this product proves unsatisfactory please contact our customer service department.

PRODUCT REGISTRATION

Please visit ninjakitchen.co.uk to register your new Ninja® product within 28 days of purchase. You will be asked to provide the store name, date of purchase, and model number along with your name and address.

The registration will enable us to contact you in the unlikely event of a product safety notification. By registering, you acknowledge you have read and understood the instructions for use and warnings set forth in the accompanying instructions.

Contents

- 1 IMPORTANT SAFEGUARDS
- 2 GETTING TO KNOW YOUR NINJA® PERSONAL BLENDER
- 3 BEFORE FIRST USE
- 4 FEATURES
- 5 BLENDING INSTRUCTIONS
- 6 CARE & MAINTENANCE
 - 6.1 CLEANING
 - 6.2 RESETTING THE MOTOR THERMOSTAT
- 7 TROUBLESHOOTING GUIDE
- 8 Documents / Resources
 - 8.1 References
- 9 Related Posts

IMPORTANT SAFEGUARDS

HOUSEHOLD USE ONLY • READ ALL INSTRUCTIONS BEFORE USE

Read all instructions before using your NINJA® PERSONAL BLENDER

When using electrical appliances, basic safety precautions should always be followed, including the following:



WARNING

To reduce the risk of fire, electric shock, serious injury, death, or damage when using this appliance, follow these basic safety precautions. General Precautions

1. Read all instructions prior to using the appliance and its accessories.
2. Carefully observe and follow all warnings and instructions. This unit contains electrical connections and moving parts that potentially present risk to the user.
3. **ALWAYS** exercise care when handling the Pro Extractor Blades® Assembly. The blades are sharp. **ONLY** grasp the Pro Extractor Blades® Assembly by the outer perimeter of the blade assembly base. Failure to use care when handling the blade assembly will result in a risk of laceration.

4. Take your time and exercise care during unpacking and appliance setup. This appliance contains sharp, loose blades that can cause injury if mishandled.
5. Take inventory of all contents to ensure you have all parts needed to properly and safely operate your appliance.
6. Turn the appliance OFF, then unplug the appliance from the socket when not in use, before assembling or disassembling parts, and before cleaning. To unplug, grasp the plug by the body and pull from the socket. **NEVER** unplug by grasping and pulling the flexible cord.
7. Before use, wash all parts that may contact food. Follow the washing instructions covered in this instruction manual.
8. Blades are sharp. Handle carefully.
9. To protect against the risk of electric shock, **DO NOT** submerge the appliance or allow the power cord to contact any form of liquid.
10. **DO NOT** use this appliance outdoors. It is designed for indoor household use only.
11. **DO NOT** operate any appliance with a damaged cord or plug, or after the appliance malfunctions or is dropped or damaged in any manner. This appliance has no user-serviceable parts. If damaged, contact SharkNinja for servicing.
12. **DO NOT** abuse the power cord. Never carry the appliance by the power cord or yank it to disconnect from the electrical socket; instead, grasp the plug and pull to disconnect.
13. Extension cords should NOT be used with this appliance.
14. **DO NOT** allow children to operate this appliance, to play with it, or use as a toy. Keep the appliance and its cord out of reach of children.
15. This appliance is NOT intended to be used by people (including children) with reduced physical, sensory, or mental capabilities, or lack of experience and knowledge, unless they are given supervision or instruction concerning use of the appliance by a person responsible for their safety.
16. Before each use, inspect blade assemblies for damage. If a blade is bent or damage is suspected, contact SharkNinja to arrange for a replacement.
17. **DO NOT** attempt to sharpen blades.
18. Keep the appliance and its cord out of reach of children.
19. **DO NOT** allow the unit or the cord to hang over the edges of tables or worktops. The cord may become snagged and pull the appliance off the work surface.
20. **DO NOT** allow any part of the unit to contact hot surfaces, including stoves and other heating appliances.
21. ALWAYS use the appliance on a dry and level surface.
22. **NEVER** place a blade assembly on the motor base without it first being attached to its corresponding container (bowl, pitcher, cup) and lid.
23. **Only** use attachments and accessories that are provided with the product or are recommended by SharkNinja. The use of attachments not recommended or sold by SharkNinja may cause fire, electric shock, or injury.
24. The use of attachments, including canning jars, not recommended by the manufacturer may cause a risk of injury to persons. **DO NOT** use stainless steel cup accessory model XSKDWSS24 with a blender.
25. During operation and handling of the appliance, avoid contact with moving parts.
26. **DO NOT** operate the appliance with an empty container.
27. **DO NOT** fill containers past the MAX FILL or MAX LIQUID lines.
28. **DO NOT** microwave any containers or accessories provided with the appliance.

29. **DO NOT** perform grinding operations with the Single-Serve Cup and Pro Extractor Blades® Assembly.
30. Before the operation, ensure all utensils are removed from containers. Failure to remove utensils can cause containers to shatter and potentially result in personal injury and property damage.
31. Keep hands, hair, clothing, as well as utensils out of containers while processing to reduce the risk of severe injury to persons or damage to the appliance. A scraper maybe used but only when the appliance is not running.

SAVE THESE INSTRUCTIONS



WARNING

To reduce the risk of fire, electric shock, serious injury, death, or damage when using this appliance, follow these basic safety precautions.

GENERAL PRECAUTIONS

32. **NEVER** operate the appliance without lids and caps in place.
DO NOT attempt to defeat the interlock mechanism. Ensure the container and lid are properly installed before operation.
33. **DO NOT** expose the containers and accessories to extreme temperature changes. They may experience damage.
34. **NEVER** leave the appliance unattended while in use.
35. **DO NOT** blend hot liquids. Doing so may result in pressure buildup and steam exposure that can pose a risk of the user being burned.
36. **DO NOT** remove the cap from the motor base while the appliance is running.
37. Remove the Pro Extractor Blades® Assembly from the Single-Serve Cup upon completion of blending. **DO NOT** store ingredients before or after blending them in the up with the blade assembly attached. Some foods may contain active ingredients or release gases that will expand if left in a sealed container, resulting in excessive pressure buildup that can pose a risk of injury. For ingredient storage in the cup, use only Spout Lid to cover.
38. The maximum wattage rating for this appliance is based on the configuration of the Pro Extractor Blades® Assembly and SingleServe Cup. Other configurations may draw less power or current.
39. Max ON time is 1 minute under 900W load. If the appliance overheats, a thermal switch will become activated and shut off the motor. To reset, unplug the appliance and Let it cool down for approximately 30 minutes before using it again.
40. **DO NOT** process dry ingredients without adding liquid to the SingleServe Cup. The Single-Serve Cup is not intended for dry blending.
41. To protect against risk of electrical shock, **DO NOT** immerse the motor base in water or other liquid.
42. **DO NOT** spray the motor base with any liquids. Turn off and unplug the motor base before cleaning.

SAVE THESE INSTRUCTIONS

GETTING TO KNOW YOUR NINJA® PERSONAL BLENDER

MAIN UNIT

- A. 700ml Single Serve Cups (x 2)*
- B. Pro Extractor Blades® Assembly
- C. Motor Base with Power Cord
- D. Spout Lid (x2)

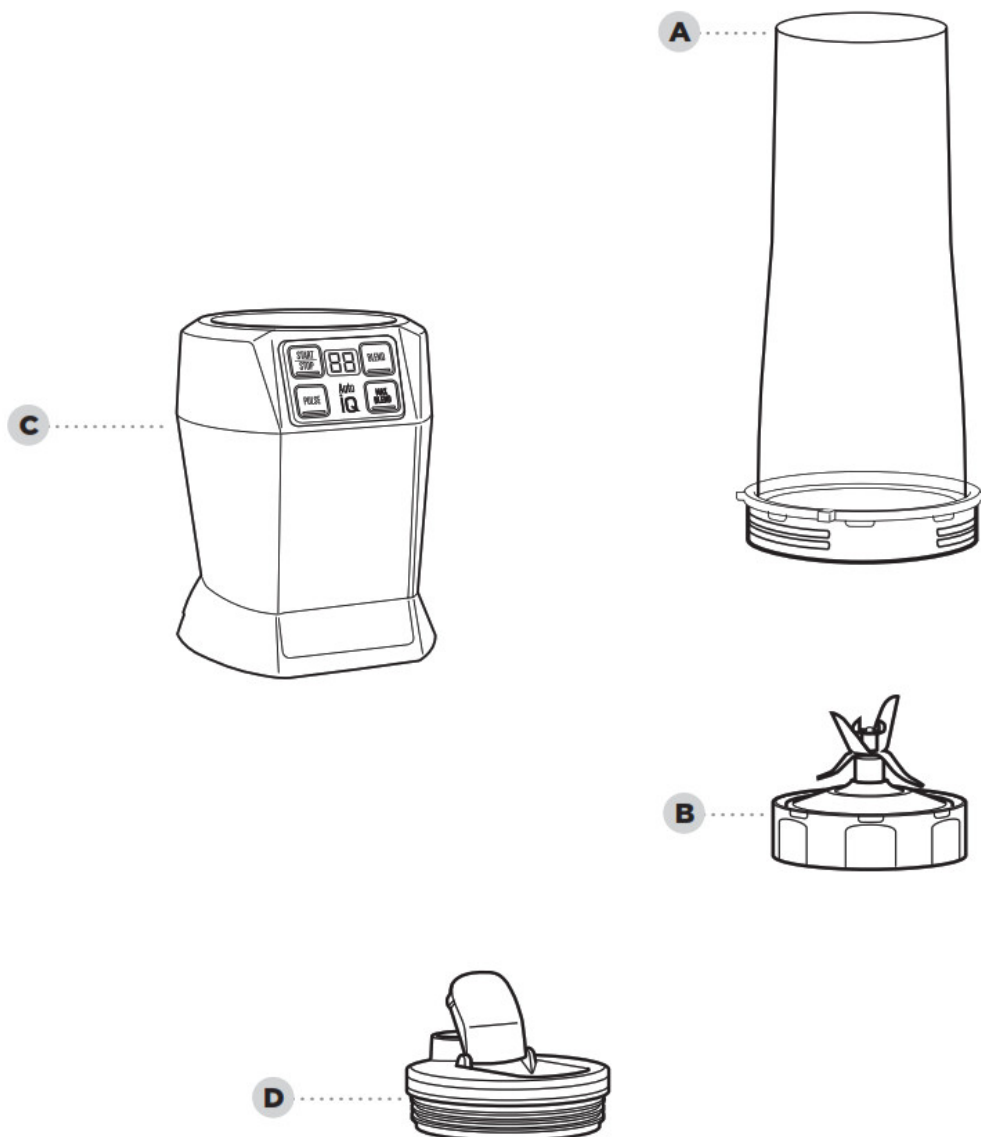

To order additional parts and accessories, visit ninjakitchen.co.uk
 *600ml. max liquid capacity.

BEFORE FIRST USE

DID YOU KNOW?

- You can take your drinks on the go using the Spout Lids.
- The containers, blade assemblies, and lids are BPA-free and dishwasher safe.

NOTE: Handle the Pro Extractor Blades® Assembly by grasping around the perimeter of the blade assembly base.

NOTE: All attachments are dishwasher safe. It is recommended that the lids, containers, and blade assemblies be placed on the top rack of the dishwasher. Ensure blade assemblies and lids are removed from their containers before placing in the dishwasher. Exercise care when handling blade assemblies. Overflow reservoir is hand wash only.

1. Remove all packaging materials from the appliance. Exercise care when unpacking blade assemblies. All blade assemblies are sharp.
2. Wash containers, lids, and blade assemblies in warm, soapy, water using a dishwashing utensil with a handle to avoid direct contact with the blades. Exercise care when handling blade assemblies, as the blades are sharp.

3. Thoroughly rinse and air-dry all parts.
4. Wipe screen with a soft, damp cloth. Allow it to dry completely before using.

FEATURES

AUTO-IQ® PROGRAMS

Intelligent pre-set programs combine unique blending and pausing patterns that do the work for you. Once a pre-set program is selected, it will start immediately. Press the selected program again to pause it.

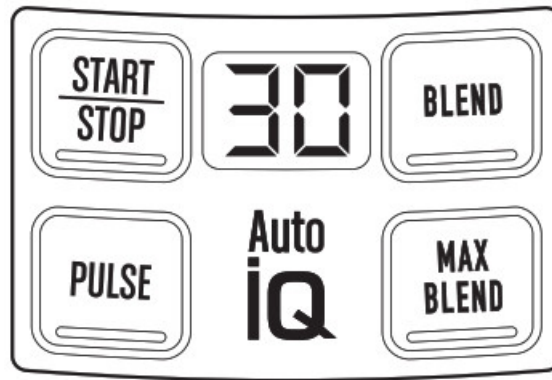

MANUAL SETTINGS:

START | STOP

Press once to start continuous running; press again to stop. The timer counts up by seconds, up to 60 seconds.

PULSE

Runs only while pressed down. Short presses create short pulses. The timer counts up by seconds as long as the button is pressed down.

AUTO-IQ® PROGRAMS:

BLEND

Make drinks containing fresh or frozen fruit, liquids, and ice, or blend together purees and more. The program lasts for 45 seconds.

MAX BLEND

Ideal for tougher ingredients including skins, seeds, and stems. The program lasts for 60 seconds.

BLENDING INSTRUCTIONS

1. Add ingredients to the Single-Serve Cup. **DO NOT** add ingredients past the **MAX LIQUID** line on the cup.



2. Place the Pro Extractor Blades® Assembly on the top of the cup and turn clockwise to seal.
3. Turn cup upside down so the bottom of the blade assembly is flat on the worktop.

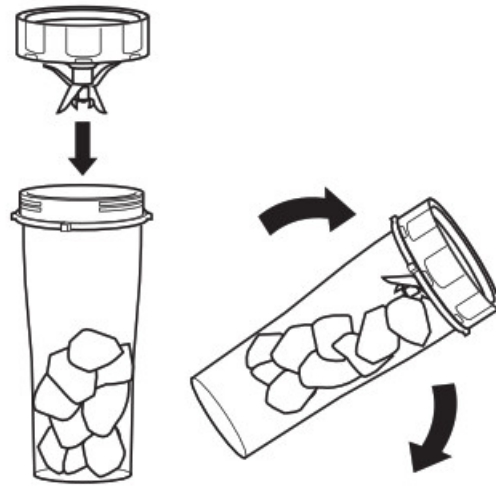

4. Install the cup onto the motor base and turn clockwise to lock into place. Once correctly locked in, the programs will illuminate.

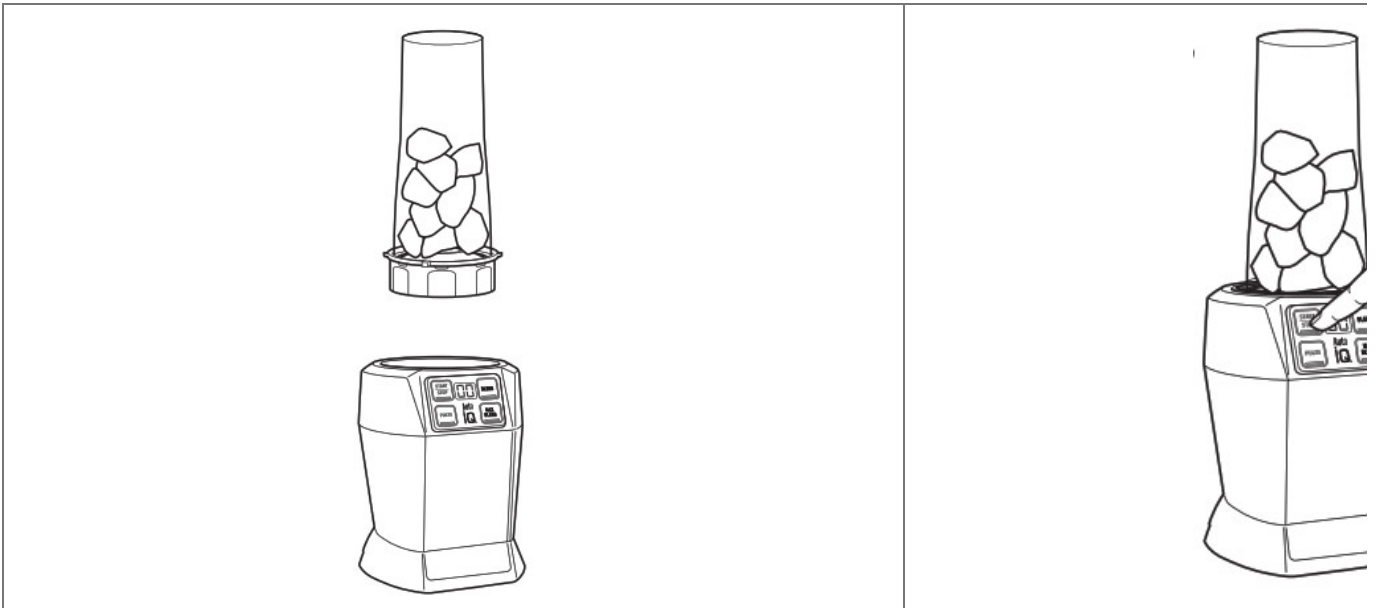

5. Choose your program (see page 9 for reference). The preset programs will automatically stop the unit at the end of the program. To pause the unit at any time, press the active program a second time.
6. When blending is complete, twist the cup anti-clockwise and lift up. DO NOT store contents in the cup with the Pro Extractor Blades® Assembly is attached.

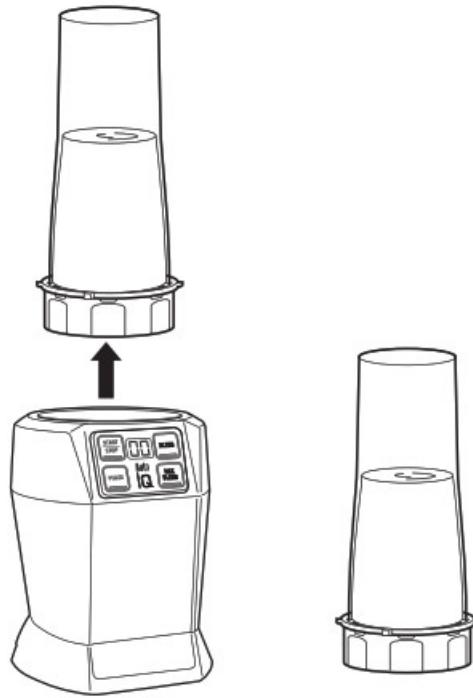

7. Turn cup over so blade assembly is on top. Twist blade assembly anti-clockwise to remove. To take your blended contents on the go, place the spout lid on cup and turn clockwise to seal.

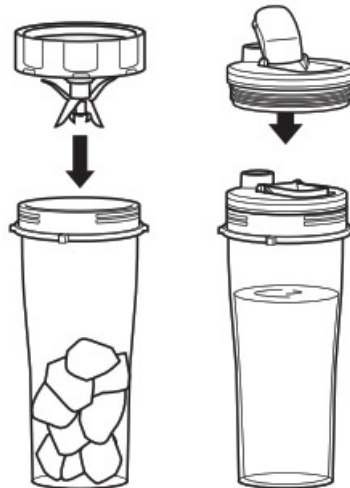

8. nplug the unit when finished. To lift the motor base, place your hands underneath both sides of it and gently pull the unit up and toward you. Refer to the Care & Maintenance section for storing instructions.



CARE & MAINTENANCE

CLEANING

1. Separate all parts.

2. Wash all containers in warm, soapy water with a soft cloth.

3. Hand-Washing

Wash cups, lids, and blade assembly in warm, soapy water. Use a dishwashing utensil with a handle to avoid direct contact with the blades. Exercise care when handling the blade assembly as the blades are sharp.

Thoroughly rinse and air-dry all parts.

Dishwasher

Cups, lids, and blade assembly are dishwasher safe. Place the cups, lids, and blade assembly on the top rack of the dishwasher **ONLY**. Ensure the blade assembly and lid are removed from the cup before placing in the dishwasher.

Motor Base

Turn off the unit and unplug the motor base before cleaning. Wipe motor base with a clean, damp cloth.

NEVER directly spray the base with water or other liquids.

DO NOT use abrasive cloths/pads/ brushes to clean the base, as this can dull or scratch the surface.

RESETTING THE MOTOR THERMOSTAT

This unit features a unique safety system that prevents damage to the motor and drive system should you inadvertently overload it. If the unit is overloaded, the motor will be temporarily disabled. Should this occur, follow the reset procedure below.

1. Unplug the unit from the socket.
2. Allow the unit to cool for approximately 30 minutes.
3. Remove the container's lid and blade assembly. Empty the container and ensure no ingredients are jamming the blade assemblies.

IMPORTANT: Ensure that maximum capacities are not exceeded. This is the most typical cause of appliance overload.

TROUBLESHOOTING GUIDE



WARNING: To reduce the risk of shock and unintended operation, turn the power off and unplug the unit before troubleshooting

Unit doesn't turn on

Make sure unit is plugged in.

- Place cup on base and rotate it clockwise until it clicks into place.

Unit doesn't turn off

- Remove the cup from the base by rotating it anti-clockwise and lifting it. Unplug the power cord from the socket.

Lid/blade assembly hard to assemble

- Place the cup on a level surface with the lid or blade assembly on the top of the cup and align the threads so that the lid/blades sit flat on the cup. Twist clockwise so that the lid/blades evenly align to the cup until you have a tight seal.

Doesn't mix well; ingredients get stuck

- Using the pre-set programs is the easiest way to achieve great results. The pulses and pauses allow the ingredients to settle toward the blade assembly. If ingredients are routinely getting stuck, adding some liquid

will usually help.

- When filling the cup, start with fresh fruit or veggies, then leafy greens or herbs. Next, add liquids or yogurt, then seeds, powders, or nut butter. Finally, add ice or frozen ingredients.

Motor base won't stick to worktop or tabletop

- Make sure surface and suction feet are wiped clean. Suction feet will only stick to smooth surfaces.
- Suction feet will not stick on some surfaces such as wood, tile, and non-polished finishes.
- **DO NOT** attempt to use the unit when the motor base is stuck to a surface that is not secure (cutting board, platter, plates, etc.).
- Unit is difficult to remove from worktop for storage
- Place your hands underneath both sides of the motor base and gently pull the unit up and toward you.

NOTES.....

VISIT US ONLINE AT:

ninjakitchen.co.uk

Or follow us on any of our social media pages:



[@ninjakitchen.uk](https://www.instagram.com/ninjakitchen.uk)



This marking indicates that this product should not be disposed of with other household wastes throughout the EU. To prevent possible harm to the environment or human health from uncontrolled waste disposal, recycle it responsibly to promote the sustainable reuse of material sources. To return your used device, please use the return and collection systems or contact the retailer where this product was purchased. They can take this product for environmentally safe recycling.

Euro-Pro Europe Limited
3150 Century Way, Thorpe Park,
Leeds, LS15 8ZB, UK

ninjakitchen.co.uk

Illustrations may differ from the actual products. We are constantly striving to improve our products; therefore the specifications contained herein are subject to change without notice.

AUTO-IQ, NINJA and PRO EXTRACTOR BLADES are registered trademarks of SharkNinja Operating LLC.

© 2020 SharkNinja Operating LLC.

BN495UK.30.IB.MP.200324.Mv1

PRINTED IN CHINA



Documents / Resources

 The image shows the front cover of the Ninja BN495UK Blender instruction manual. It features the 'NINJA' logo at the top left, the model number 'BN495UK' and 'INSTRUCTIONS' at the top right, and a photograph of the blender unit in the center. The word 'BLENDER' is printed below the logo.	<p>NINJA Blender [pdf] Instructions Blender, BN495UK</p>
---	--

References

- N [Ninja UK - Kitchen Appliances | Blenders, Air Fryers, Grills & More](#)