

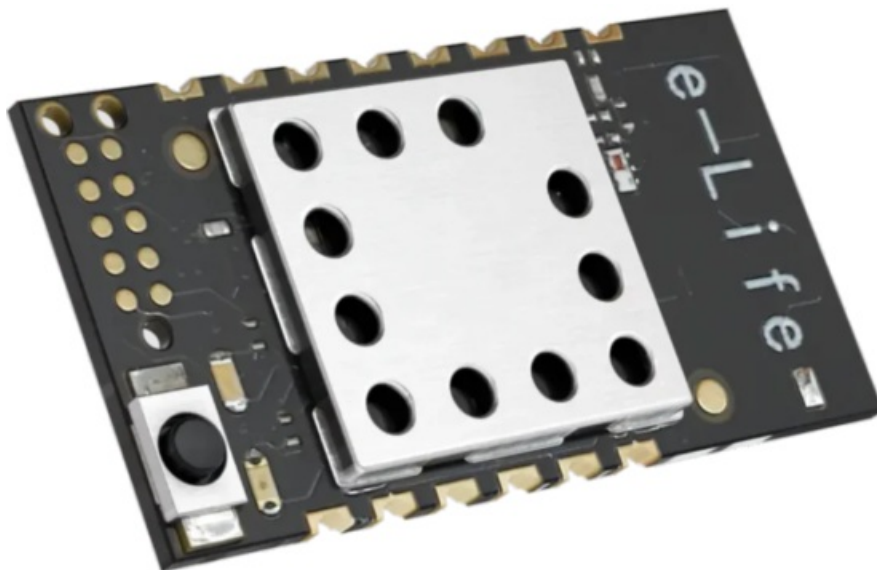

nimly 231024 Connect Module Installation Guide

[Home](#) » [nimly](#) » nimly 231024 Connect Module Installation Guide 

nimly 231024 Connect Module



Contents

- [1 Before You Start](#)
- [2 Documents / Resources](#)
 - [2.1 References](#)
- [3 Related Posts](#)

Before You Start



You need a compatible nimly device to use this module.
The module communicates wirelessly (Zigbee 3.0) with our Connect Gateway/Bridge (sold separately) or connect to other smart home system with support (Athom Homey, Futurehome, Homely and others).

Works with unloc Do you want to create and share digital keys? No gateway required.
Connect with the unloc-app (BLE). Please visit unloc.app for instructions on how to connect.
Bluetooth is only available on the newer versions of the module.

Find your favorite app

Download our nimly connect app (requires gateway/bridge) or use your preferred smart home app with support. If needed, read more about supported smart home systems and requirements on our website <https://nimly.io/>

Follow the pairing instructions provided in each app.

	
bluetooth app iOS & Android	nimly connect iOS & Android

1. Prepare your inside unit for the installation. On most models, there are two (large) screws in the battery holder and one on the underside. If you are unsure how to do this, refer to the installation instructions for your specific model.

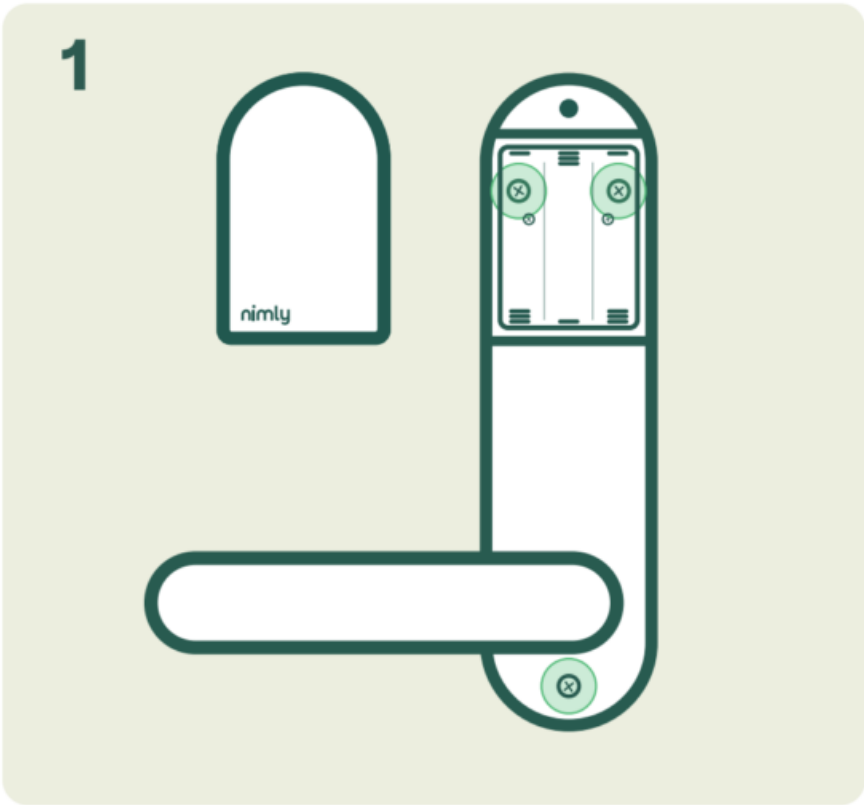

2. **Carefully** install the module in its slot on the inside unit. The batteries should be removed during installation. After installing the module, insert all batteries and verify that the cable between the inside and outside unit is connected.

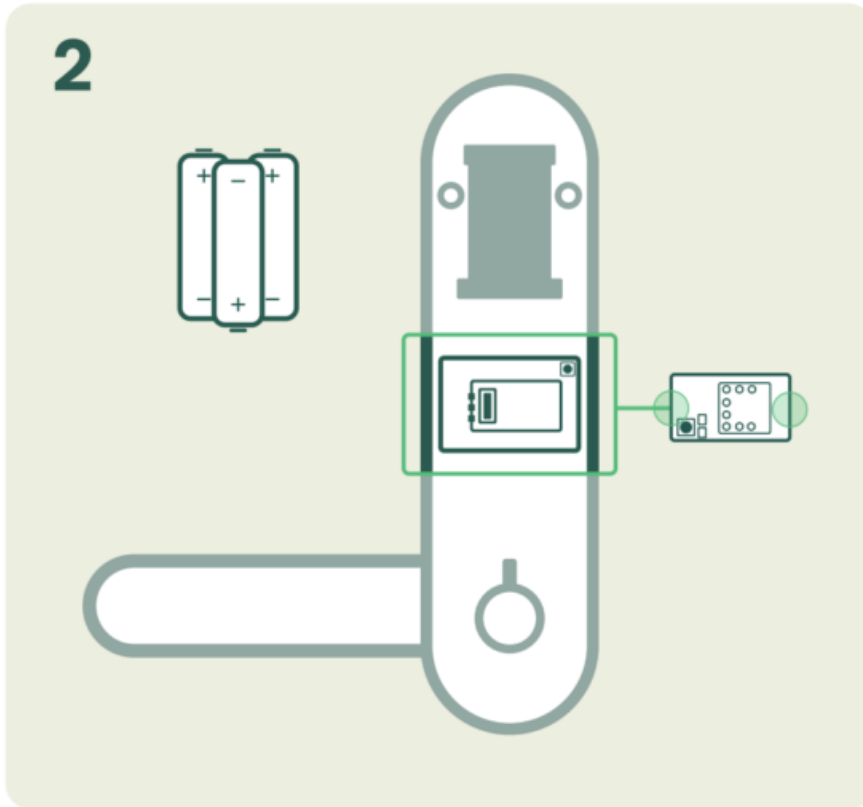

3. The module enters pairing mode automatically for four minutes, indicated by orange (zigbee) and blue (bluetooth) flashing from the module.

Did you use too long to connect?

To re-enter pairing mode, remove and reinsert the batteries/power while the units are connected.

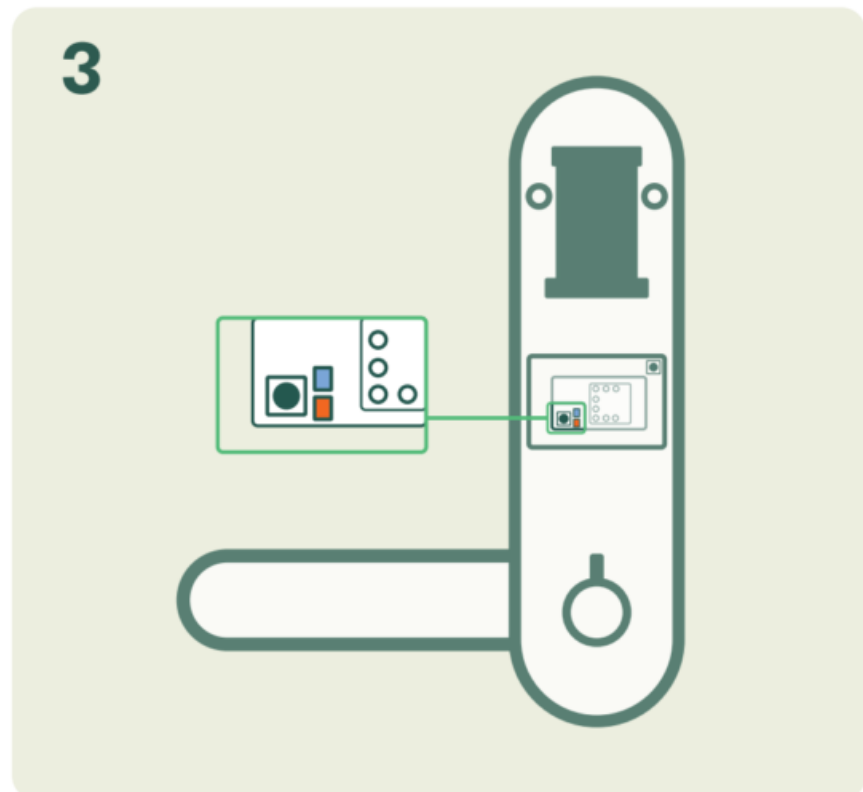



How to reset: hold down the reset button on the module until the orange indicator blinks rapidly (about 15 seconds). Release the button immediately.
On certain modules, you may need to wait four minutes (until pairing mode have ended) before performing the reset.



Documents / Resources

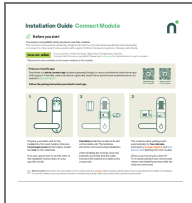

[nimly 231024 Connect Module](#) [pdf] Installation Guide
231024 Connect Module, 231024, Connect Module, 231024 Module

References

- [n Elektroniska lås | Smarta digitala dörrlås | Nimly.se](#)
- [User Manual](#)

[Manuals](#), [Privacy Policy](#)

This website is an independent publication and is neither affiliated with nor endorsed by any of the trademark owners. The "Bluetooth®" word mark and logos are registered trademarks owned by Bluetooth SIG, Inc. The "Wi-Fi®" word mark and logos are registered trademarks owned by the Wi-Fi Alliance. Any use of these marks on this website does not imply any affiliation with or endorsement.