

niko 552-723X1 Zigbee Connected Motor Control User Manual

[Home](#) » [niko](#) » niko 552-723X1 Zigbee Connected Motor Control User Manual 

Contents

- 1 niko 552-723X1 Zigbee Connected Motor Control
- 2 Product Information
- 3 Dimensions
- 4 Product Installation
- 5 Product Usage
- 6 Product Connected use
- 7 Niko Home app
- 8 Dimensions
- 9 Wiring
- 10 Zigbee® network
- 11 Installation
- 12 Dismantling
- 13 Stand-alone use
- 14 Connected use
- 15 Control
- 16 Online guide
- 17 Troubleshooting
- 18 LED behaviour
- 19 Reset
- 20 Specifications
- 21 Support & contact
- 22 Documents / Resources
 - 22.1 References
- 23 Related Posts

niko

niko 552-723X1 Zigbee Connected Motor Control



Product Information

The Niko Home Control is a wireless smart hub designed for home automation. It is a versatile device that allows users to control their home's lighting, heating, and other electrical appliances using a smartphone or tablet. It can be connected to a wireless bridge (550-00640) to extend its range up to 30 meters. The device must be secured with a Miniature Circuit Breaker (MCB) of max. 16 A in the electrical cabinet. The device has a maximum range of 10 meters and requires a minimum of 2 meters when connected to a 230 V device.

Dimensions

- **552-723X1:** 71mm x 39.2mm
- **552-72301:** 29.5mm x 31.75mm
- **552-72321:** 73mm x 39.7mm
- **552-72311:** 73mm x 39.1mm
- **552-72331:** 73mm x 39.7mm

Product Installation

The Niko Home Control can be installed by following the instructions provided in the user manual. The device can be used in standalone mode until it is connected to a smart hub or wireless bridge. To connect the device to a wireless hub or bridge, consult the guide provided on the website guide.niko.eu for more information about the installation and connected use.

Pairing mode

To pair the device with a hub or bridge, press the button on the device three times within four seconds. The LED lights on the device will start flashing to signal that it is in pairing mode. The device has a maximum range of 5 meters in pairing mode.

Product Usage

Product Stand-alone use

The Niko Home Control can be used in stand-alone mode until it is connected to a smart hub or wireless bridge. In stand-alone mode, the device can switch its own contact and operate within a maximum range of 10 meters.

Product Connected use

When connected to a Niko Home Control installation, more advanced functionalities become available. To connect the device to a wireless smart hub or bridge using the Niko Home Control programming software or Niko Home app, consult the guide provided on the website guide.niko.eu for more information about the installation and connected use.

Niko Home Control programming software

The Niko Home Control programming software allows users to control their devices using a computer. It is available for both Windows and Mac operating systems. To download the software, visit www.niko.eu/article/550-99102 for Windows or www.niko.eu/article/550-99202 for Mac.

Niko Home app

The Niko Home app allows users to control their devices using a smartphone or tablet. The app is available for both iOS and Android devices and can be downloaded from the App Store or Google Play.

- Connected motor control, Zigbee®

Dimensions

552-72301

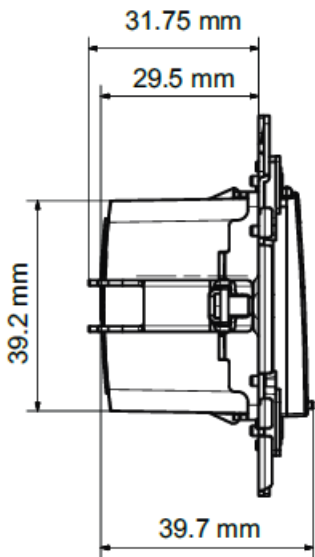
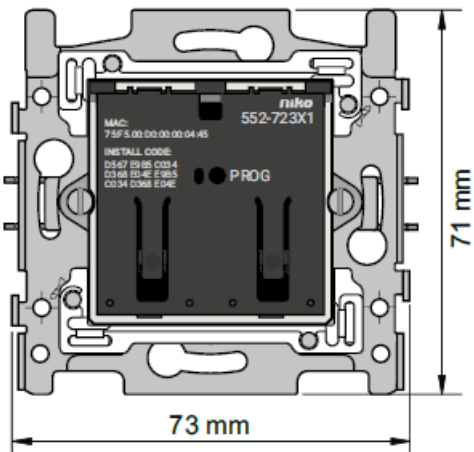

552-72321

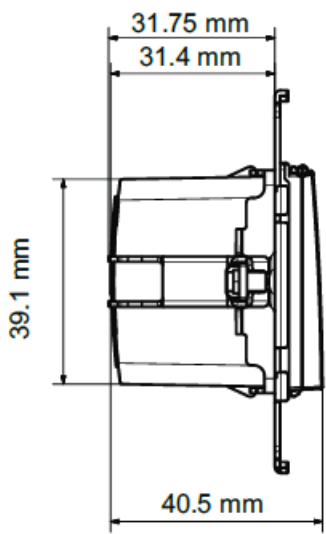
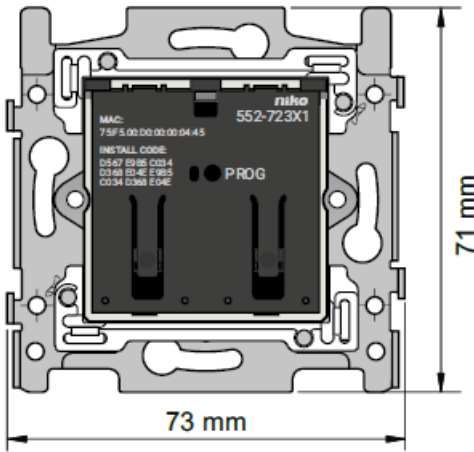

552-72311

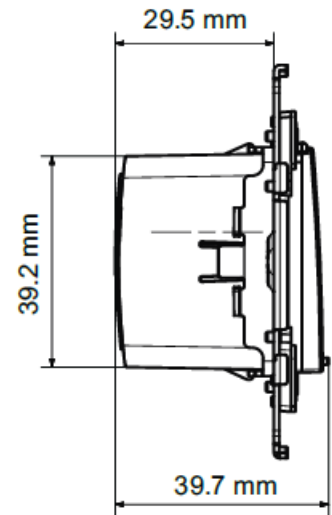
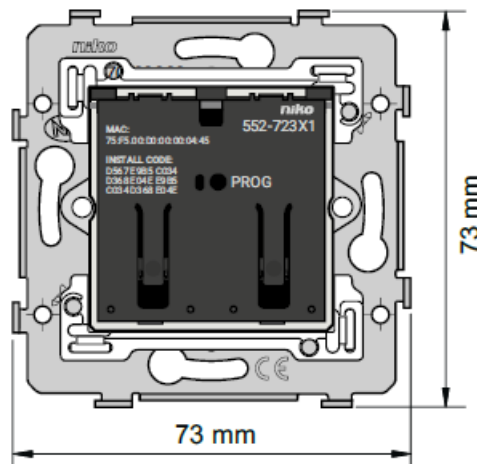

552-72331

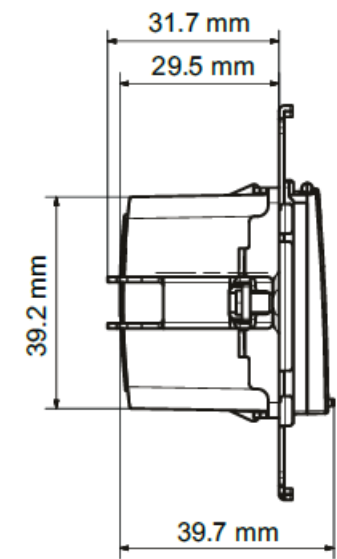
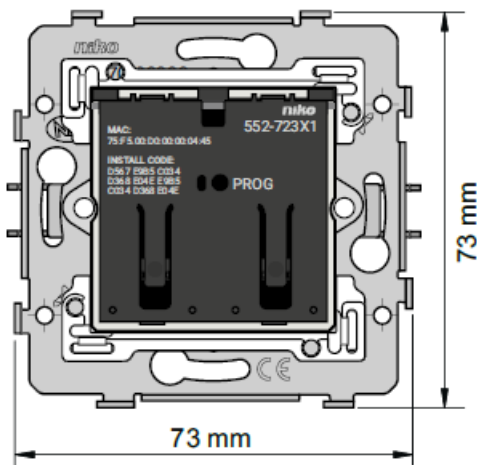

Wiring

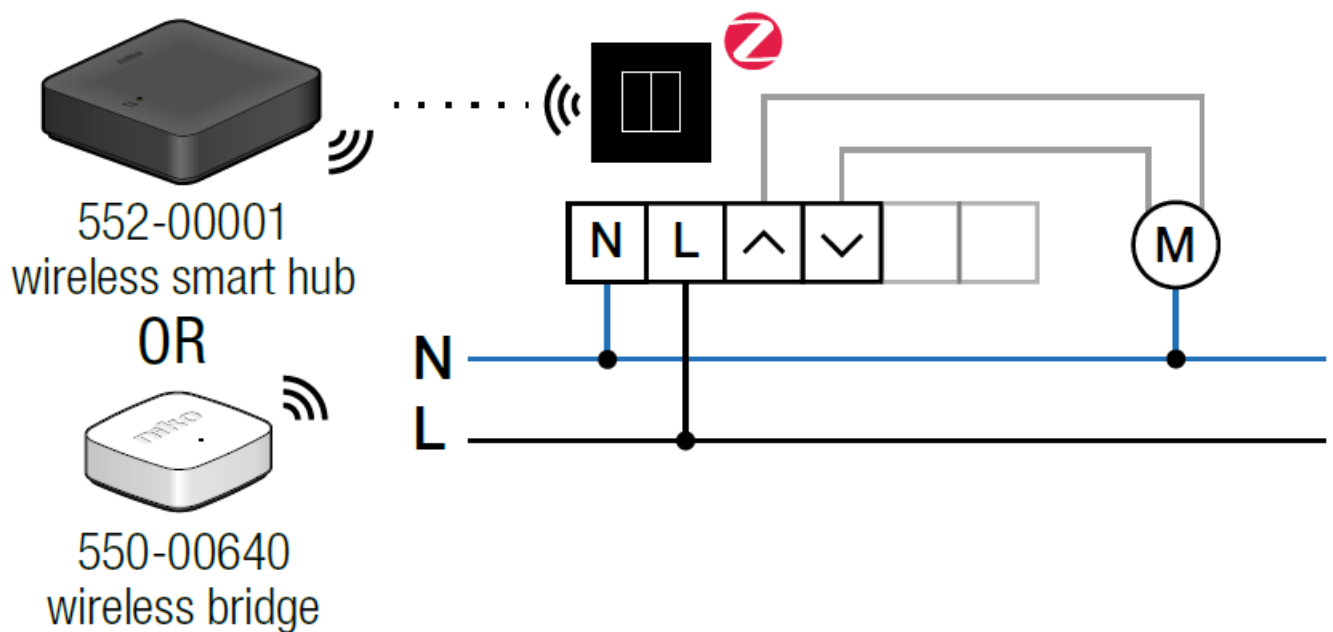

- This product must be secured with a Miniature Circuit Breaker (MCB) of max. 16 A in the electrical cabinet.

Zigbee® network

Network setup

Follow the Zigbee® network setup advice below to guarantee the meshing of the devices before you install the switch on the wall. More information on Zigbee® network principles: guide.niko.eu.

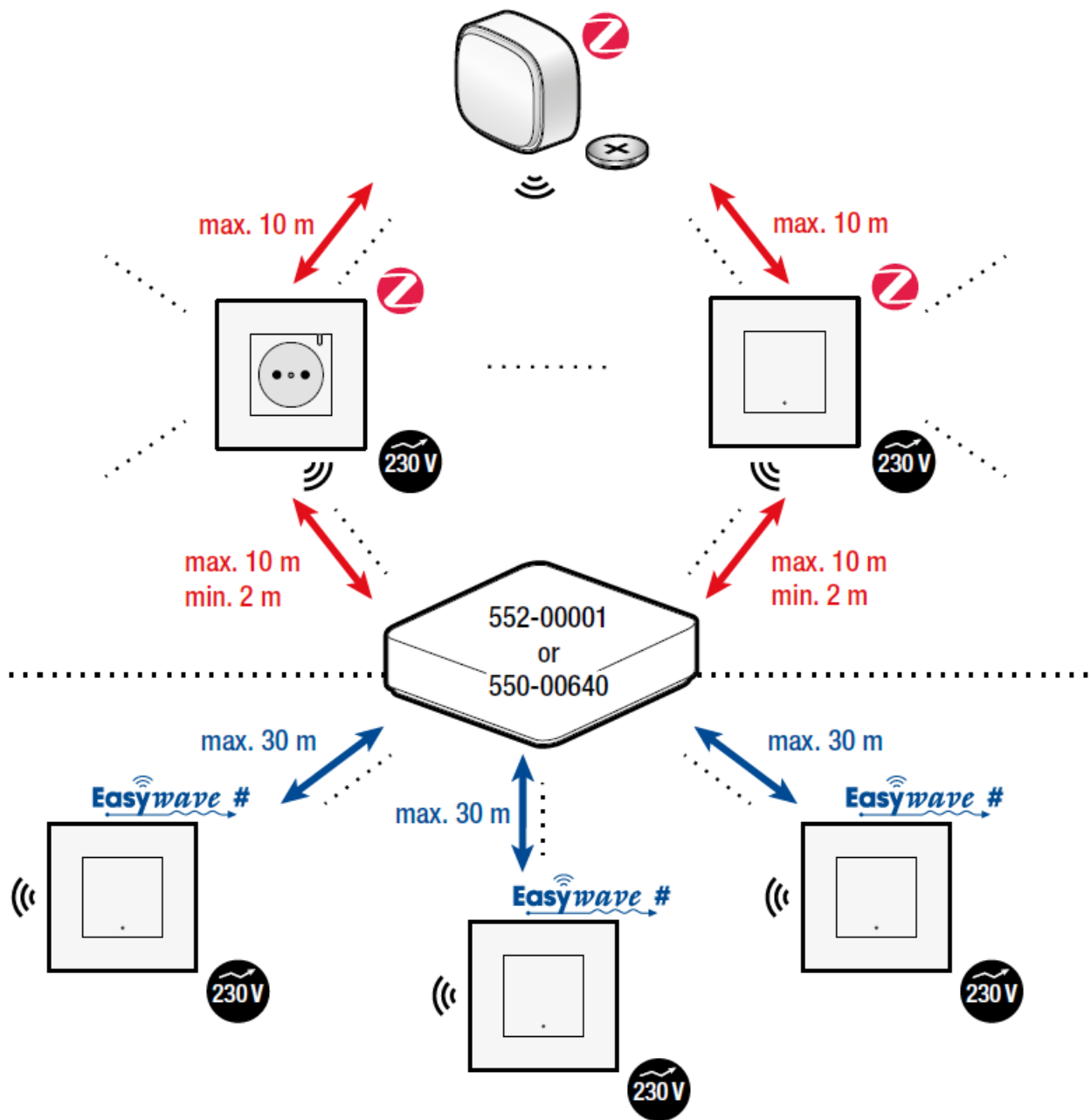

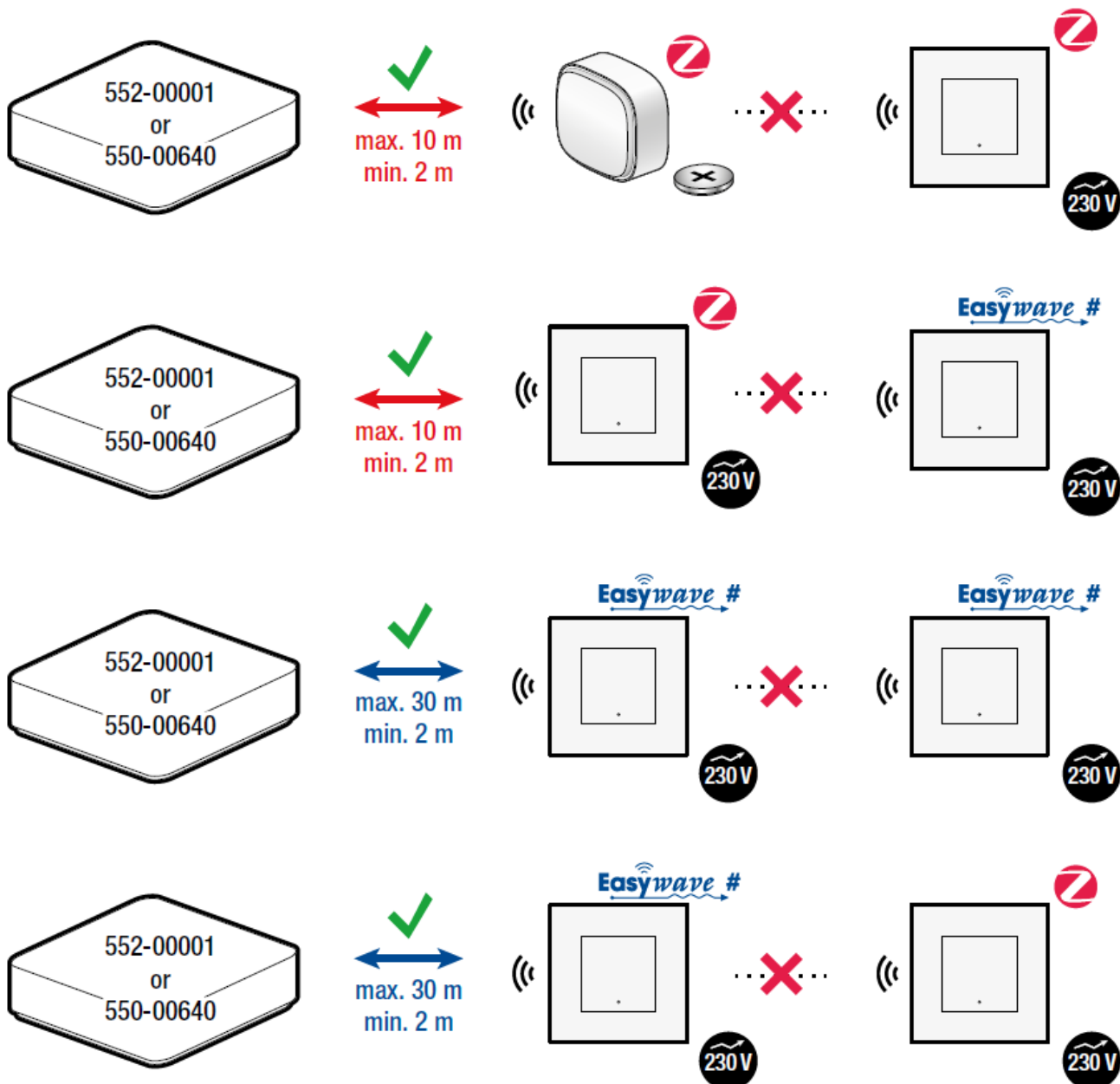

Installation

8 - 10 mm Ø 1.5 - 2.5 mm²

a

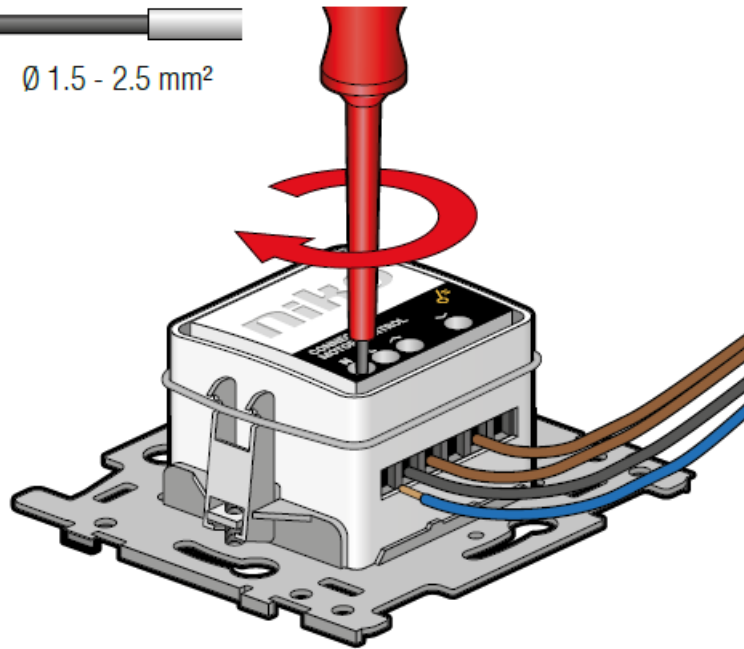

b

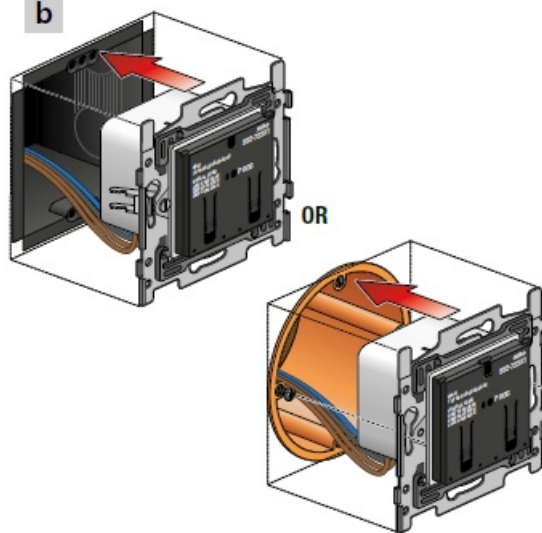

c

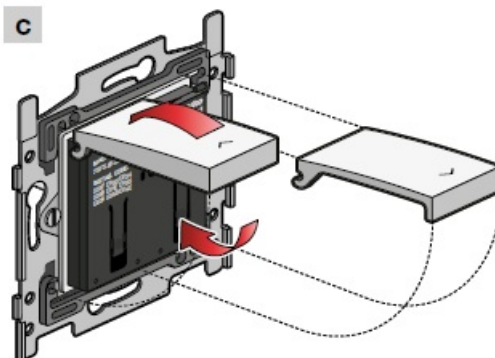

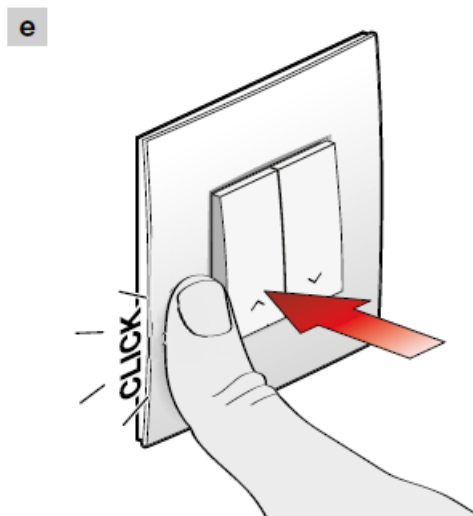
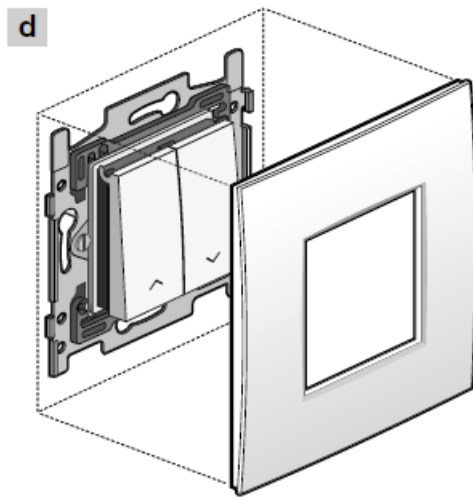

Dismantling

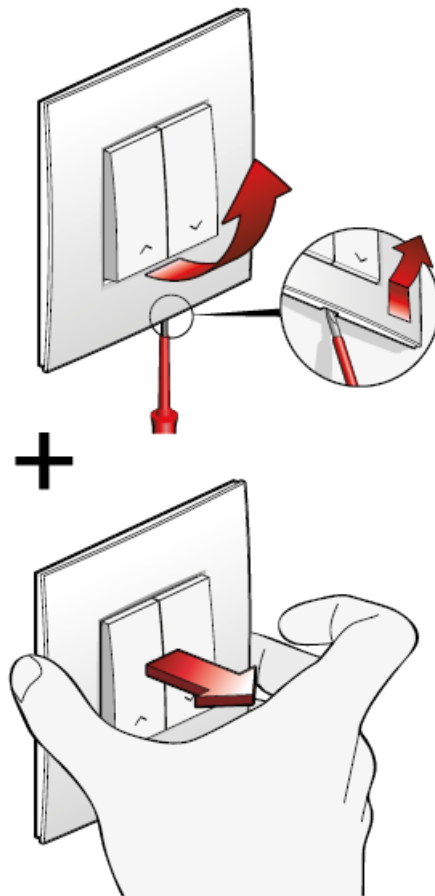

Stand-alone use

- All 230 V-connected devices for Niko Home Control can be used in standalone mode until they are connected to a smart hub or wireless bridge. In stand-alone mode they switch their own contact.

Connected use

Connected to a Niko Home Control installation More advanced functionalities become available if you connect this device to your wireless smart hub (552-00001) or wireless bridge (550-00640) using the Niko Home Control programming software or Niko Home app. Consult [guide.niko.eu](https://www.niko.eu/guide) for more information about the installation and the connected use.

Download the Niko Home Control programming software

- www.niko.eu/article/550-99102 (Windows)
- www.niko.eu/article/550-99202 (Mac)





Niko Home Control
programming
software

Control your device with the Niko Home app

How to connect the Niko device to Niko Home Control network

1. Reset the Niko device when it is already connected to a Zigbee® network. See § Reset.
2. Follow the onboarding procedure in the Niko Home Control programming software or the Niko Home app to add new Niko Zigbee® devices.
3. Set the Niko Zigbee® device in pairing mode by pressing the switch button 3 x within a period of 6 seconds > See image § Pairing mode. The blue LEDs start blinking for max. 5 minutes.
4. The connected motor control is successfully added to the Zigbee® network when the blue LEDs are ON for 4 seconds.

Connected to a third-party Zigbee® network

Niko connected Zigbee® devices behave like standard Zigbee® devices in third-party networks that allow this operation. Consult the manufacturer's manual for more information on the possibility to use third-party Zigbee® devices in their network. Specific Niko Home Control functions will not be enabled with Niko Zigbee® devices that are connected to a third-party Zigbee® controller/ gateway. Consult the details on [guide.niko.eu](https://www.niko.eu/guide). See also the disclaimer on www.niko.eu/zigbee.

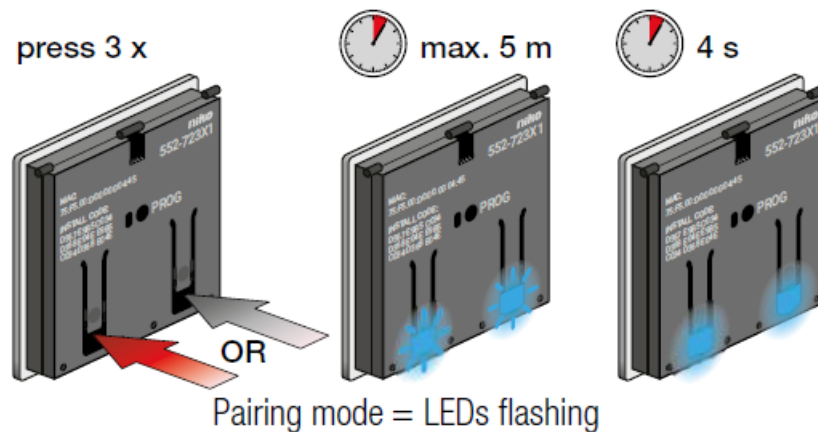

Control



Home



Online guide

- Consult guide.niko.eu for more information about the installation, the onboarding, the use and troubleshooting.







Troubleshooting

Problem	Cause	Action
I want to use the connect- ed motor control but I don't yet have a smart hub or wireless bridge to connect it with	<p>All 230 V connected devices for Niko Home Control can be used in stand-alone mode until they are connected to a smart hub or wireless bridge. In this mode, they only switch their own contacts. The</p> <p>motor control includes an internal switch-over delay of 0.5 seconds when changing the run direction in stand-alone and in connected mode. This switch- over delay allows the motor capacitor to discharge its energy and protects the motor against current peaks and sudden torque changes</p>	

My smart hub or wireless bridge doesn't work any more	Consult the manuals of the wireless smart hub (552-00001) or the wireless bridge (550-00640) at www.niko.eu	If the power of the smart hub or wireless bridge switches off, all 230 V connected devices will continue to operate in stand-alone mode. They will only switch on or dim their own contacts. Consult the respective product manuals to resolve the issue
	The power supply is off	Switch on the power supply
The connected motor control can't be found in the Niko Home app or programming software	The distance between the connected motor control and the smart hub or wireless bridge is too close	Make sure there is a distance of at least 2 meters between the device and the smart hub or wireless bridge
	The distance between the connected motor control and the smart hub, wireless bridge or another connected device is too far	Make sure there is a distance of maximum 10 meters between the device and the smart hub, wireless bridge or a subsequent 230 V connected Zigbee® device. To increase the range, add, for example, an additional smart socket outlet or Zigbee® extender to the network
	There is no connection between the Niko Home app or laptop/pc and the smart hub or wireless bridge	Check the connection to the smart hub or wireless bridge. Consult the respective product manuals to resolve the issue
The load does not switch on	The motor is not suitable for this motor control	The two contacts of the connected motor control can handle a motor load of max. 1.5 A
	The connected motor control is defective.	Replace the connected motor control
	The motor is defective	Replace the motor

LED behaviour

Each channel (up and down) has its own LED that provides feedback when in normal operation. In case of a special status (blue or red feedback), the LEDs from both channels will light up			
LED off		Normal operation when:	Enable/disable the white LEDs:
		<ul style="list-style-type: none"> the connected motor control is used with Niko Home Control or in stand-alone mode with the LED feedback disabled the LED feedback is enabled and the motor is switched OFF 	<ul style="list-style-type: none"> in stand-alone mode by pressing the PROG button for 10 seconds in connected mode via the Niko Home Control programming software
		The connected motor control is not powered	Check the wiring and the miniature circuit breaker (MCB) in the electrical cabinet
		The connected motor control is malfunctioning	Replace the connected motor control if the actions recommended above did not resolve the issue
White LED continuously on		Normal operation when the connected motor control is switched on and is used with LED feedback	The connected motor control is working fine
Red LED is flashing		The connection to the smart hub or wireless bridge is temporarily interrupted	The connection will restore automatically. If it doesn't, please try to power cycle your smart hub or wireless bridge and check if the connected motor control is still within the range of the smart hub or wireless bridge. Check guide.niko.eu for more information
Blue LED is flashing		The connected motor control is trying to connect to the Zigbee® network	Wait until the LED stops flashing
Blue LED on for 4 seconds		The connected motor control is connected to the Zigbee® network	The blue LED will turn OFF after 4 seconds. The connected motor control is ready to be used

Reset

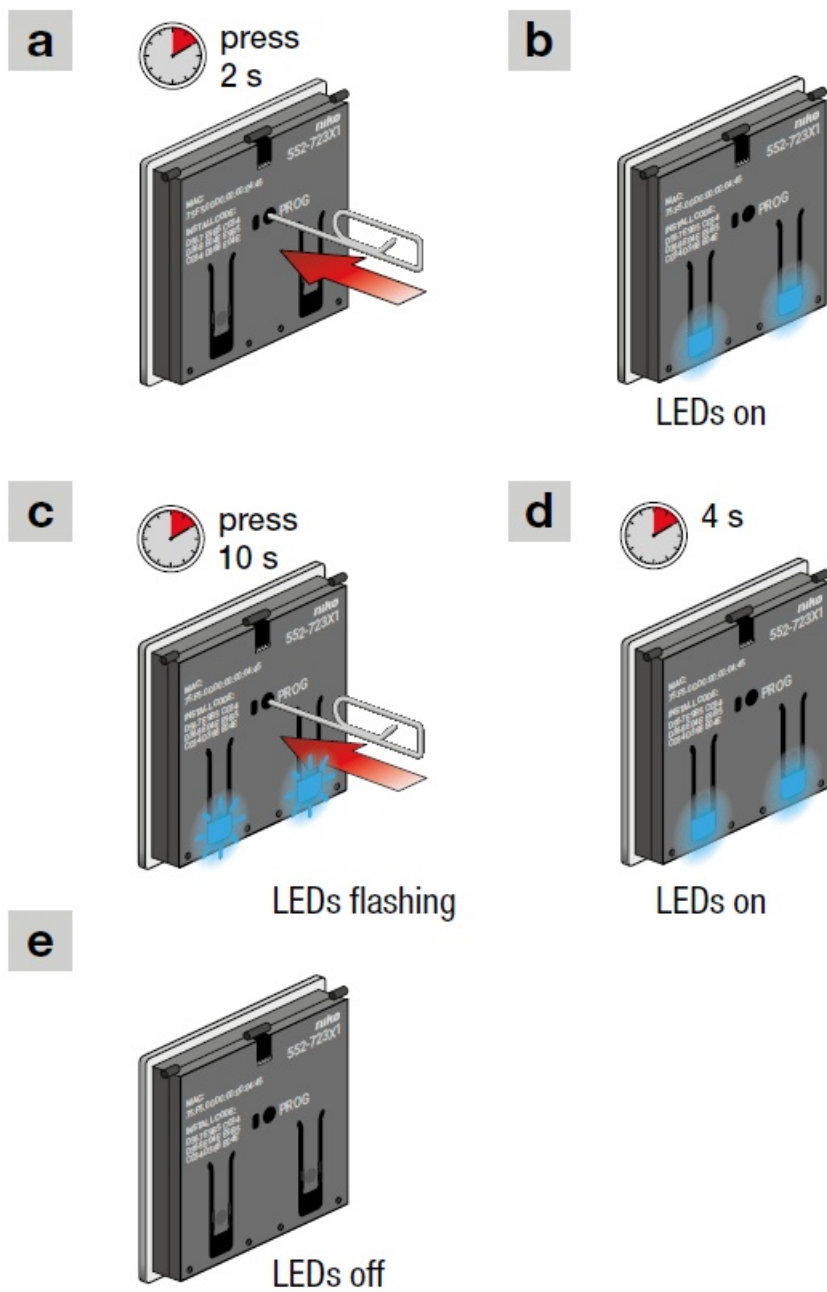

Specifications

Article number	552-723X1
Maximum load	3 A
Power supply	230 Vac \pm 10%, 50 Hz
Circuit Breaker*	Maximum MCB rating C16
Wire capacity	2 x 2.5 mm ²
Protocol	Zigbee® 3.0, 2.4 GHz
Mounting method	Flush-mounting box min. depth 50 mm (10 mm cabling space included)
Flush-mounting box specifications	Depth = min. 40 mm (cabling space included) Claw/screw fixing = 60 mm Inner diameter box = 60 mm Multiple boxes centre distance horizontal = 71 mm Multiple boxes centre distance vertical = 71 mm Multiple boxes centre distance vertical = 60 mm for BE and FR
Mounting height	110 - 120 cm
Modification of settings	Stand-alone mode: Buttons on front panel, behind the central plate Connected mode: Niko Home Control programming software Niko Home app
Maximum range (between switch and smart hub or wireless bridge)	10 m (Longer ranges are possible with the meshing capability of 230 V connected Zigbee® devices)
Maximum per installation	Max. 50 connected Zigbee® devices
Operating frequency	2.4 GHz
Maximum RF power	10 dBm
Protection degree	IP20
Ambient temperature	0 – 40 °C
Dimensions (HxWxD)	(552-72301, 551-72321) 71 x 73 x 39.7 mm
Dimensions (HxWxD)	(552-72311, 552-72331) 73 x 73 x 39.7 mm
Weight	70 g

- To be installed in accordance with the national regulations

Warnings regarding installation

The installation of products that will permanently be part of the electrical installation and which include dangerous voltages, should be carried out by a qualified installer and in accordance with the applicable regulations. This user manual must be presented to the user. It should be included in the electrical installation file and it should be passed on to any new owners. Additional copies are available on the Niko website or via Niko customer services.

Support & contact

nv Niko sa Industriepark West 40 9100 Sint-Niklaas, Belgium

- www.niko.eu
- +32 3 778 90 80 support@niko.eu

Documents / Resources

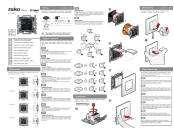

[niko 552-723X1 Zigbee Connected Motor Control](#) [pdf] User Manual
552-723X1, 552-00001, 550-00640, 170-00000, 552-721x1, 552-723X1 Zigbee Connected Motor Control, Zigbee Connected Motor Control, Connected Motor Control

References

- [✕ Confluence Mobile - Niko Guide](#)
- [n Niko - home automation, switches, socket outlets and detector](#)
- [n Zigbee](#)
- [n Niko - home automation, switches, socket outlets and detector](#)
- [n Niko Home Control II programming software for Windows](#)
- [n Niko Home Control II programming software for Mac](#)
- [n Zigbee](#)