

**niko**  
niko 552-721X1 Simple  
Connected Switch

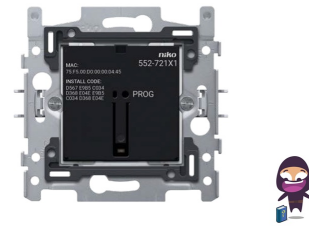

## niko 552-721X1 Simple Connected Switch Instruction Manual

[Home](#) » [niko](#) » niko 552-721X1 Simple Connected Switch Instruction Manual 

### Contents

- 1 [niko 552-721X1 Simple Connected Switch](#)
- 2 [Product Usage Instructions](#)
- 3 [Wiring](#)
- 4 [Dimensions](#)
- 5 [Zigbee® network](#)
- 6 [Installation](#)
- 7 [Connected use](#)
- 8 [Troubleshooting](#)
- 9 [LED behaviour](#)
- 10 [Reset](#)
- 11 [Specifications](#)
- 12 [Documents / Resources](#)
  - 12.1 [References](#)
- 13 [Related Posts](#)

# niko

**niko 552-721X1 Simple Connected Switch**



## Specifications

- Model: 552-721X1
- Product Name: Niko Home Control
- Wireless Smart Hub: 552-00001
- Wireless Bridge: 550-00640
- Max. Miniature Circuit Breaker (MCB) Rating: 16 A
- Operating Voltage: 230 V
- Wireless Range: Up to 30 m

## Product Usage Instructions

### Stand-alone Mode

All 230 V connected devices for Niko Home Control can be used in stand-alone mode until they are connected to a wireless smart hub (552-00001) or wireless bridge (550-00640). In stand-alone mode, they switch their own contact. Mechanical push-button extensions that are wired to the extension terminal can also be used in stand-alone mode.

### Connected Use

1. Connected to a Niko Home Control installation:

- More advanced functionalities become available when you connect the device to the wireless smart hub or wireless bridge using the Niko Home Control programming software or Niko Home app.
- Consult [guide.niko.eu](http://guide.niko.eu) for detailed installation instructions and information on connected use.
- Download the Niko Home Control programming software from:
  - [Windows](#)
  - [Mac](#)

## FAQ

- Q: What is the maximum operating voltage for the product?

A: The product operates at 230 V.

• **Q: What is the wireless range of the device?**

A: The wireless range is up to 30 meters.

## Wiring

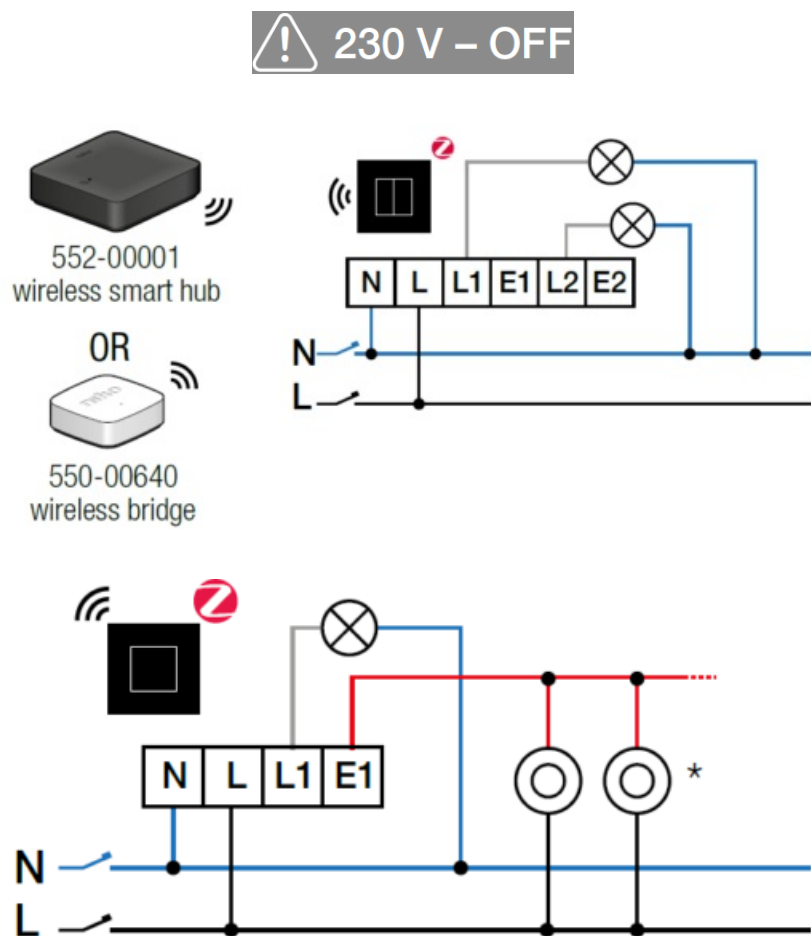

This product must be secured with a miniature circuit breaker (MCB) of max. 16 A in the electrical cabinet. The MCB rating is limited by national installation rules.

\* Classical push buttons (e.g. 170-0000x) can be connected to the extension terminals. All mechanical push-button extensions wired to the same terminal, will show the same behaviour (either the standard behaviour of the actor or a programmed behaviour). It is not possible to configure the behaviour of these extension switches separately. The maximum total wire length for all extension buttons connected to the Zigbee® dimmer is 50 m. It is not possible to add a LED lighting unit to the extension buttons.

## Dimensions

552-72101

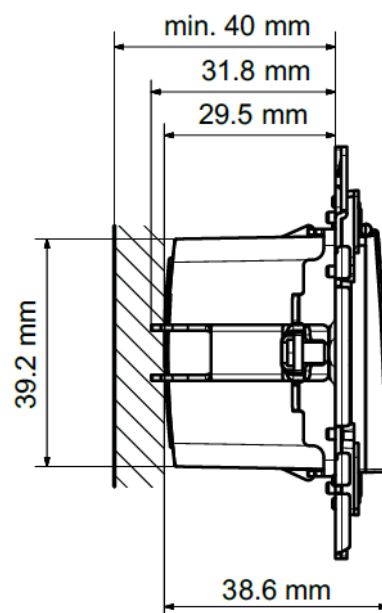
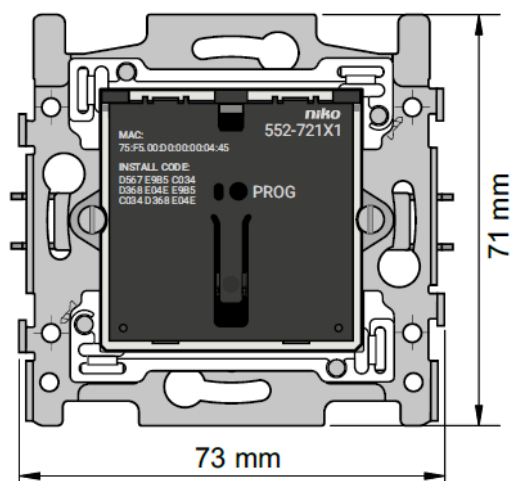

552-72121

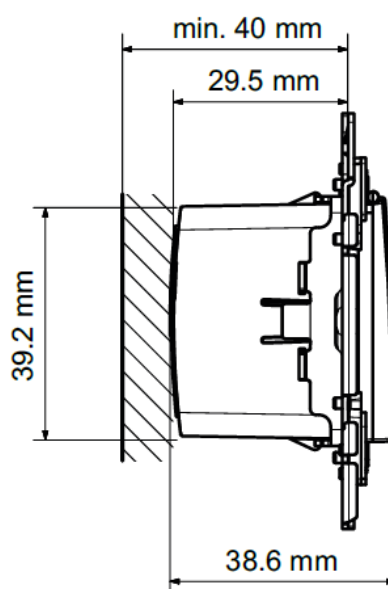
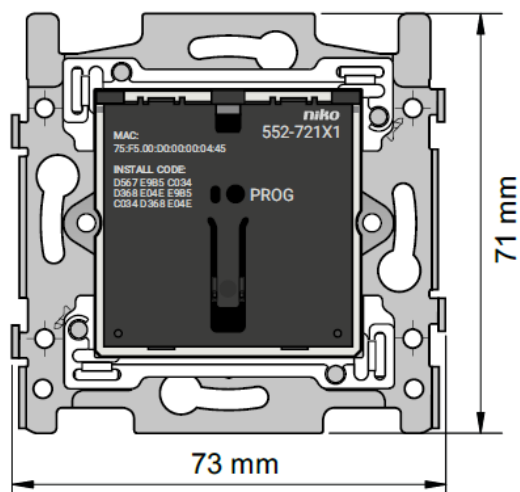

552-72111

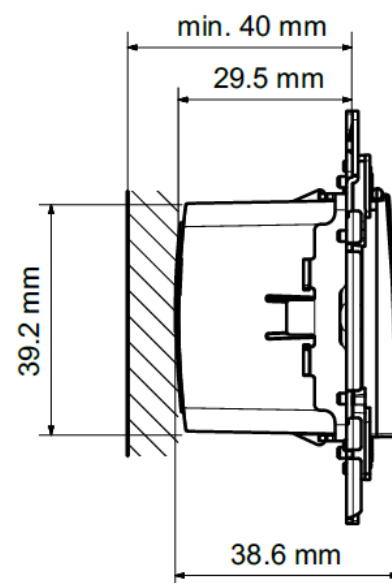
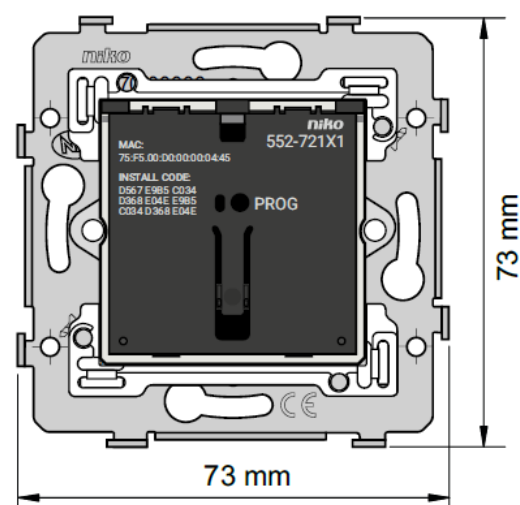

552-72131

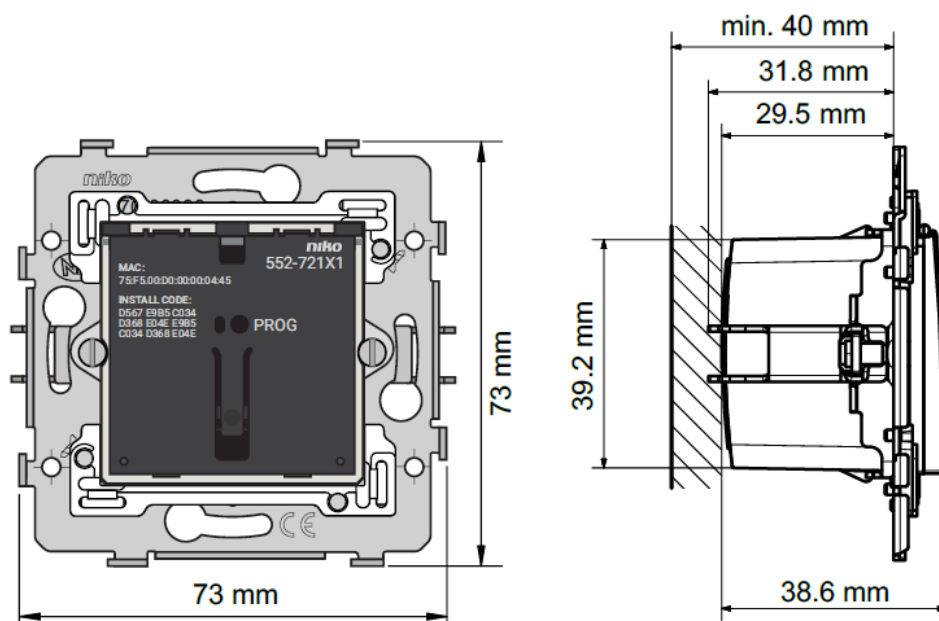

## Zigbee® network

### Network setup

Follow the Zigbee® network setup advice below to guarantee the meshing of the devices before installing the switch on the wall.

More information on Zigbee® network principles: [guide.niko.eu](http://guide.niko.eu).

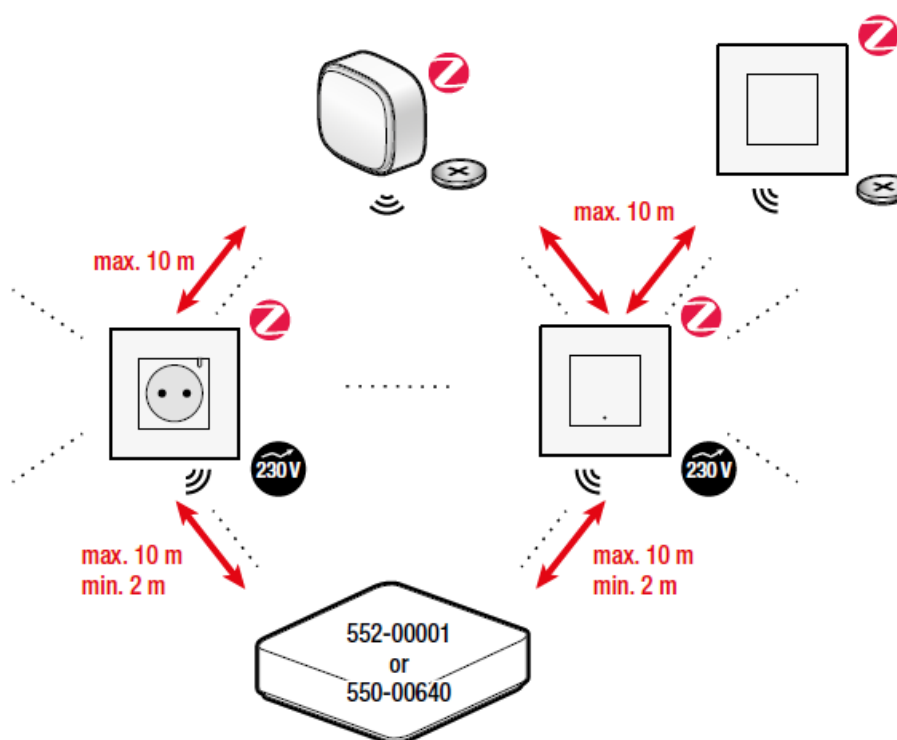

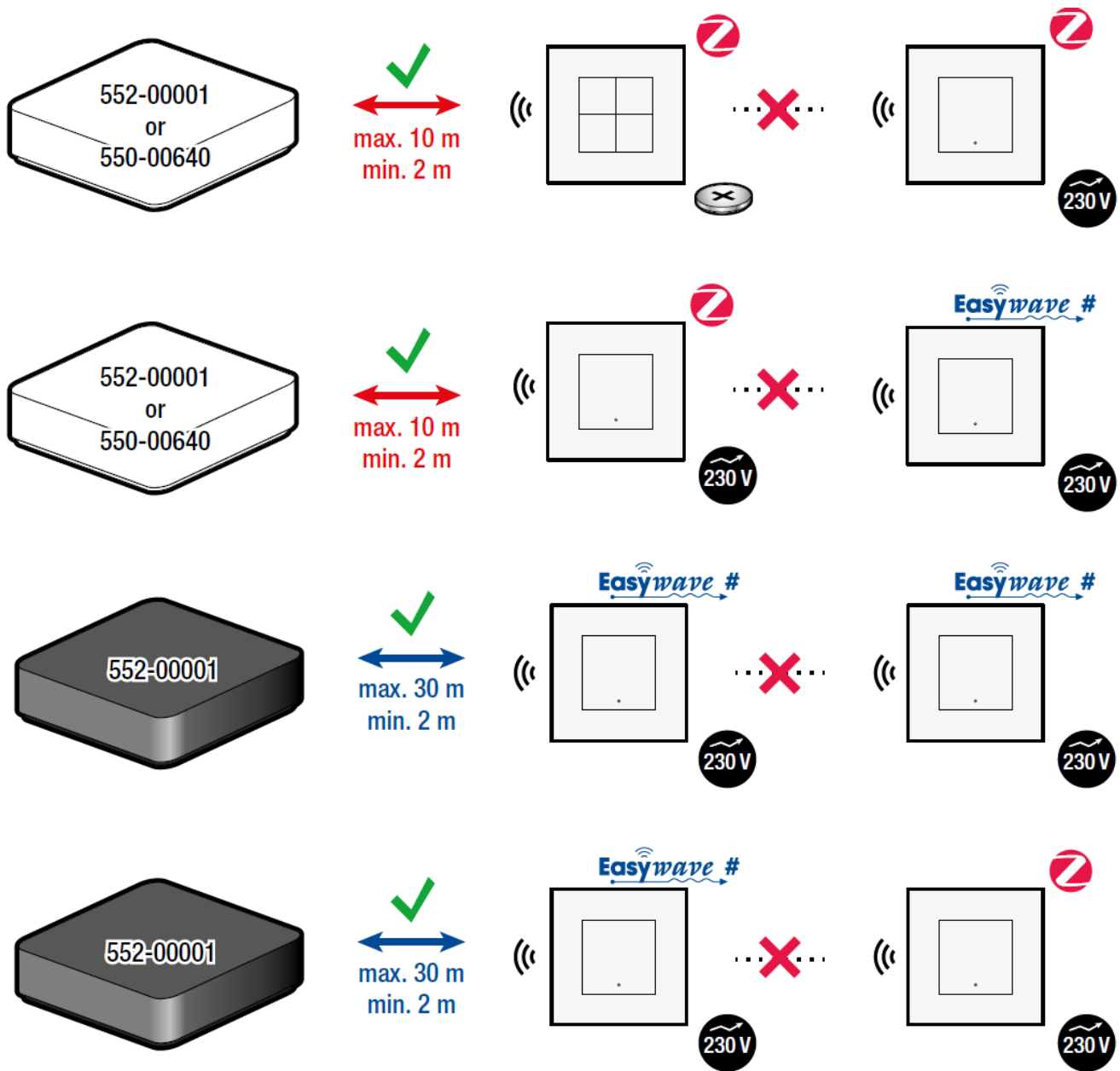

\* Also, respect a minimum distance of 2 m between a Zigbee® device (including the smart hub) and another RF transmitter (for example a Wi-Fi device) or devices such as motors, pumps, electronic LED transformers, solar panel inverters, home battery storage ...

## Installation



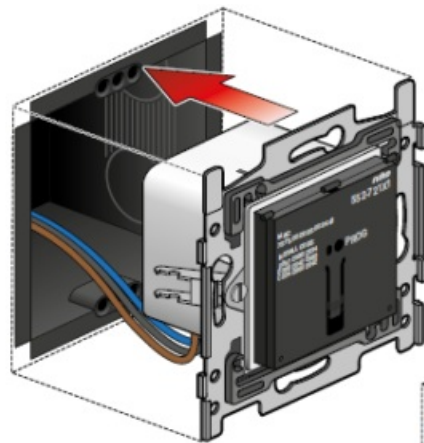
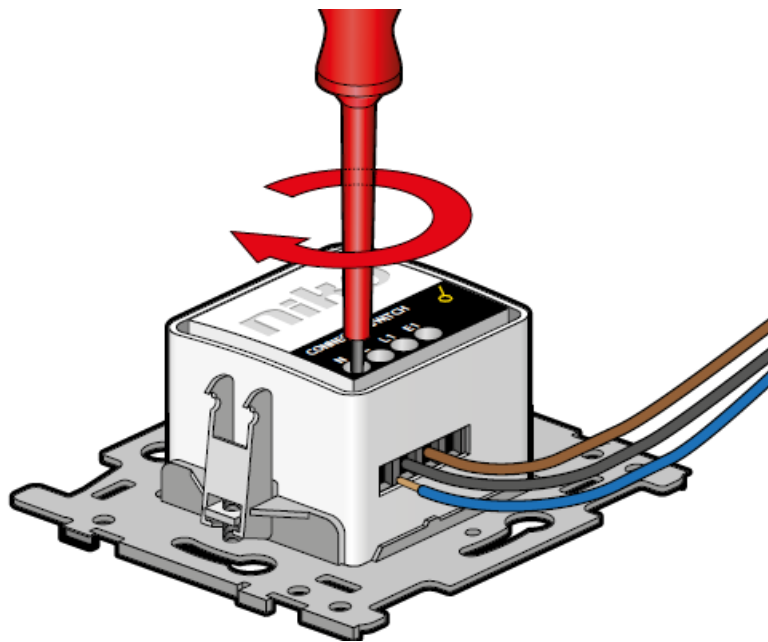

OR

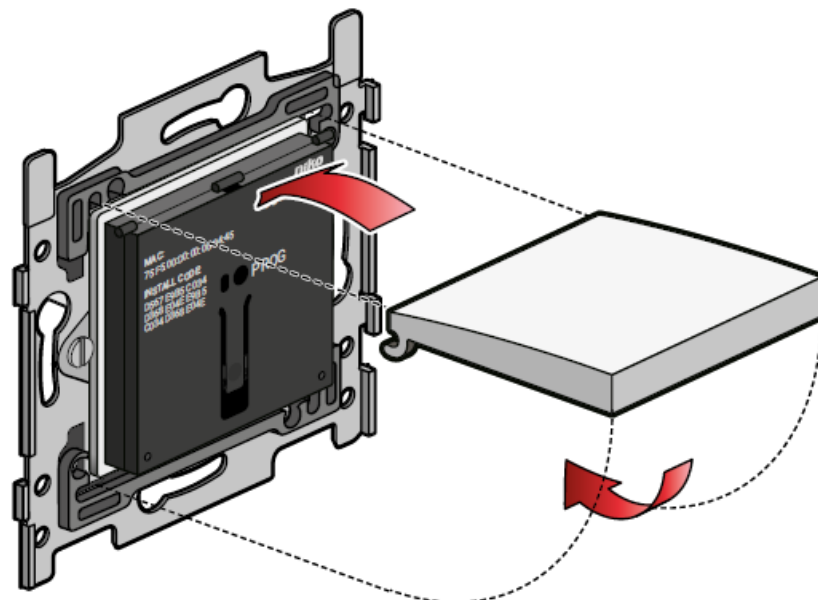
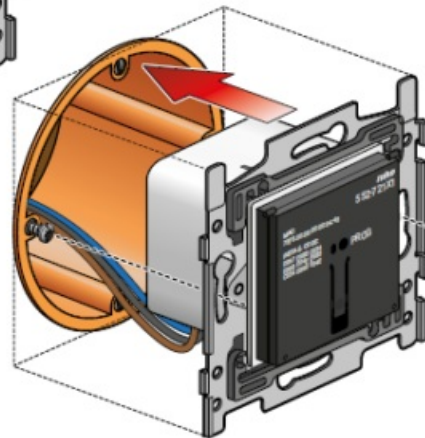

4

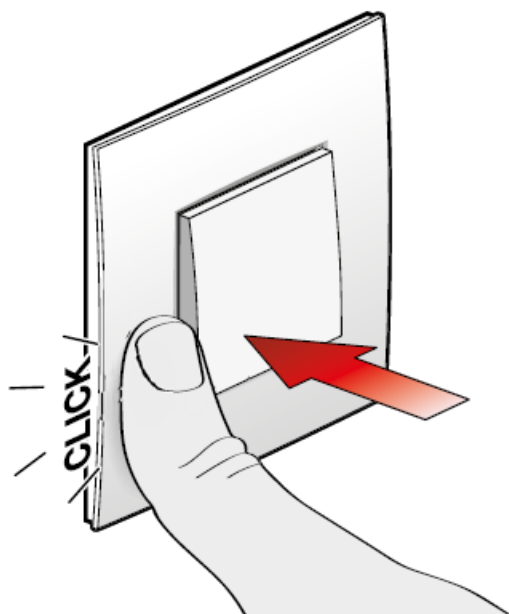
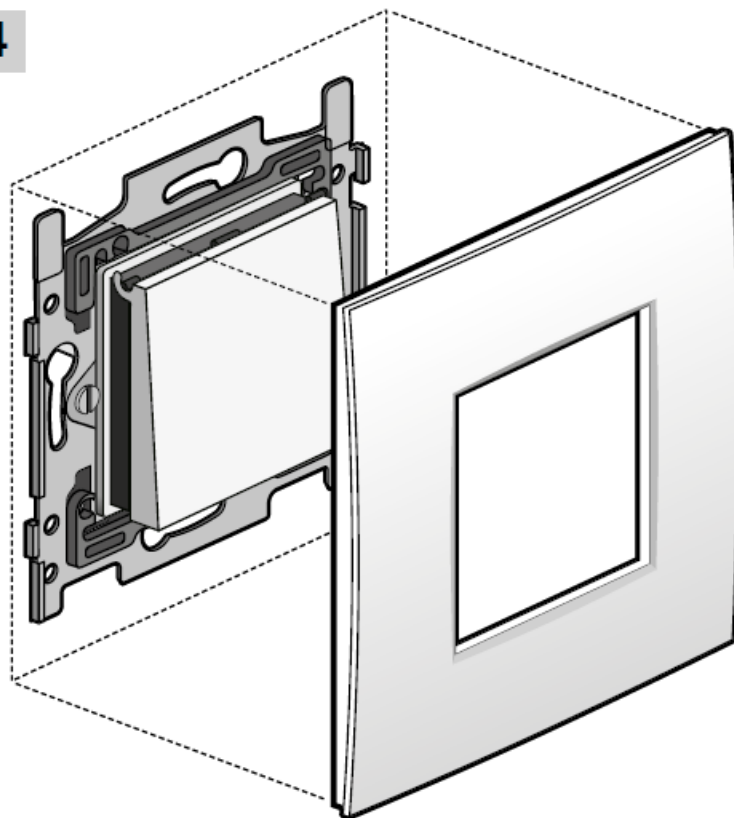

Dismantling

! 230 V – OFF



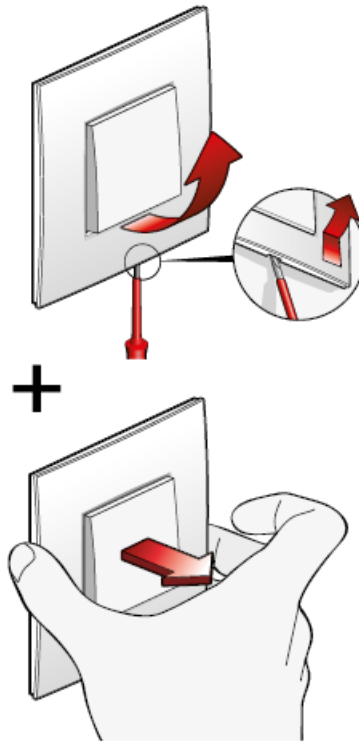

### **Stand-alone use**

All 230 V connected devices for Niko Home Control for traditional wiring can be used in stand-alone mode until they are connected to a wireless smart hub (552-00001) or wireless bridge (550-00640). In stand-alone mode, they switch their own contact. Mechanical push-button extensions that are wired to the extension terminal can also be used in stand-alone mode.

### **Connected use**

#### **Connected to a Niko Home Control installation**

More advanced functionalities become available if you connect this device to your wireless smart hub (552-00001) or wireless bridge (550-00640) using the Niko Home Control programming software or Niko Home app. Consult [guide.niko.eu](http://guide.niko.eu) for more information about the installation and the connected use.

### **Download the Niko Home Control programming software**

[www.niko.eu/article/550-99102](http://www.niko.eu/article/550-99102) (Windows)

[www.niko.eu/article/550-99202](http://www.niko.eu/article/550-99202) (Mac)



## Niko Home Control programming software



**Control your device with the Niko Home app**

### **How to connect the Niko device to the Niko Home Control network**

1. Reset the Niko Zigbee® device when it is already connected to another network. See § Reset.
2. Follow the onboarding procedure in the Niko Home Control programming software or the Niko Home app to add new Niko Zigbee® devices.
3. Set the Niko Zigbee® device in pairing mode by pressing the switch button 3 x within a period of 6 seconds > See image § Pairing mode. The blue LED starts blinking for max. 5 minutes.
4. The connected single switch is successfully added to the Zigbee® network when the blue LED is ON for 4 seconds.

### **Connected to a third-party Zigbee® network**

Niko connected Zigbee® devices behave like standard Zigbee® devices in third-party networks that allow this operation. Consult the manufacturer's manual for more information on the possibility to use third-party Zigbee® devices in their network. Specific Niko Home Control functions will not be enabled with Niko Zigbee® devices connected to a third-party Zigbee® controller/gateway. Consult the details on [guide.niko.eu](http://guide.niko.eu). See also the disclaimer on [www.niko.eu/zigbee](http://www.niko.eu/zigbee).

### **Pairing mode**

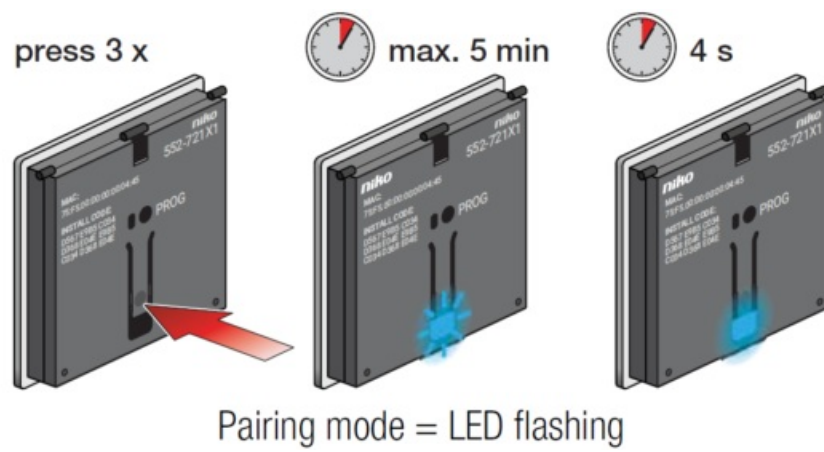

## Control



## Online guide

Consult [guide.niko.eu](https://guide.niko.eu) for more information about the installation, onboarding, the stand-alone/connected use and troubleshooting.







[guide.niko.eu](https://guide.niko.eu)

## Troubleshooting

Problem	Cause	Action
I want to use the connected switch, but I don't yet have a smart hub or wireless bridge to connect it with	All 230 V connected devices for Niko Home Control can be used in stand-alone mode until they are connected to a smart hub or wireless bridge. In this mode, they only switch their own contact. Extension switches that are wired to the connected switch can also be used in stand-alone mode	
My smart hub or wireless bridge doesn't work anymore	Consult the manuals of the wireless smart hub (552-00001) or wireless bridge 550-00640) at <a href="http://www.niko.eu">www.niko.eu</a>	If the power of the smart hub or wireless bridge switches off, all 230 V connected devices will continue to operate in stand-alone mode. They will only switch or dim their own contact. Consult the respective product manuals to resolve the issue
The connected switch cannot be found in the Niko Home app or programming software	The power supply is off	Switch on the power supply
	The distance between the connected switch and the smart hub or wireless bridge is too small	Make sure there is a distance of at least 2 meters between the device and the smart hub or wireless bridge
	The distance between the connected switch and the smart hub, wireless bridge or another connected device is too big	Make sure there is a distance of maximum 10 meters between the device and the smart hub, wireless bridge or a subsequent 230 V connected Zigbee® device. To increase the range, add, for example, an additional smart socket outlet or Zigbee® extender to the network
	There is no connection between the Niko Home app or laptop/pc and the smart hub or wireless bridge	Check the connection to the smart hub or wireless bridge. Consult the respective product manuals to resolve the issue
	The miniature circuit breaker (MCB) of the lighting circuit is disabled or there is a short circuit	Check whether the lamp complies with the load specifications described in this manual

<b>The load does not switch on</b>	The switch is defective	Replace the switch
	The lamp is defective	Replace the lamp
<b>The lamp does not switch off completely and displays an afterglow</b>	The cabling is too long, which creates capacitive effects with leakage currents. Or you're switching a low wattage lamp that is sensitive to leakage currents	Install one or more LED compensators (310-05001) over the switched phase and the neutral wire

## LED behaviour

<b>LED off</b>		<p>Normal operation when:</p> <ul style="list-style-type: none"> <li>the connected single switch is used with Niko Home Control or in stand-alone mode with the LED feedback disabled</li> <li>the LED feedback is enabled and the lamp is switched OFF</li> </ul>	<p>Enable/disable the white LED:</p> <ul style="list-style-type: none"> <li>in stand-alone mode by pressing the PROGRAM button for 10 seconds</li> <li>in connected mode via the Niko Home Control programming software</li> </ul>
		The connected single switch is not powered	Check the wiring and the miniature circuit breaker (MCB) in the electrical cabinet
		The connected single switch is malfunctioning	Replace the connected single switch if the actions recommended above did not resolve the issue
<b>White LED continuously on</b>		Normal operation when the connected single switch is switched ON and is used with LED feedback	The connected single switch is working fine
<b>Red LED is flashing</b>		The connection to the smart hub or wireless bridge is temporarily interrupted	The connection will restore automatically. If it doesn't, please try power cycling your smart hub or wireless bridge and check if the connected single switch is still within range of the smart hub or wireless bridge. Check <a href="http://guide.niko.eu">guide.niko.eu</a> for more information
<b>Blue LED is flashing</b>		The connected single switch is trying to connect to the Zigbee® network	Wait until the LED stops flashing
<b>Blue LED on for 4 seconds</b>		The connected single switch is connected to the Zigbee® network	The blue LED will turn OFF after 4 seconds. The connected single switch is ready to be used
			

## Reset

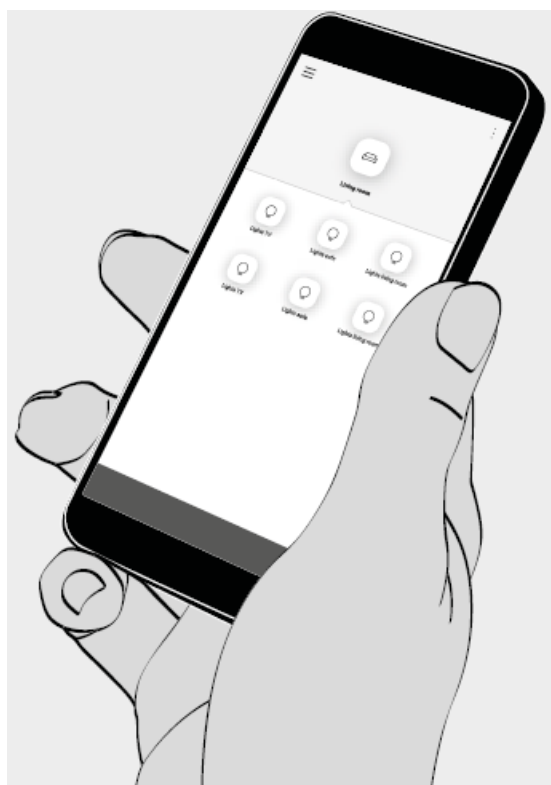
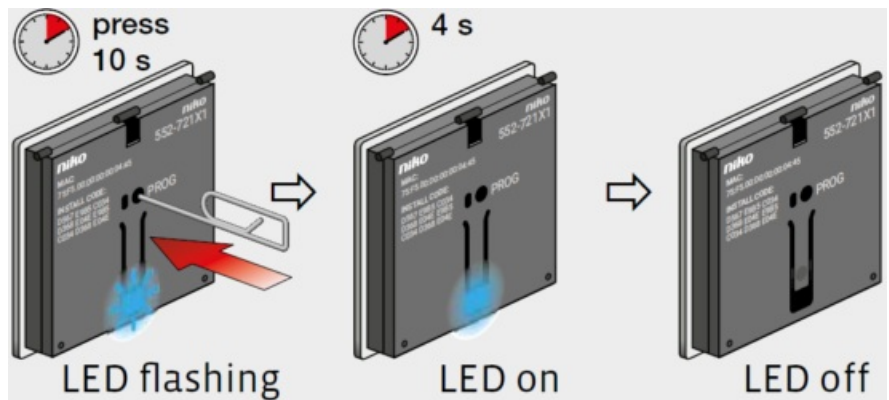
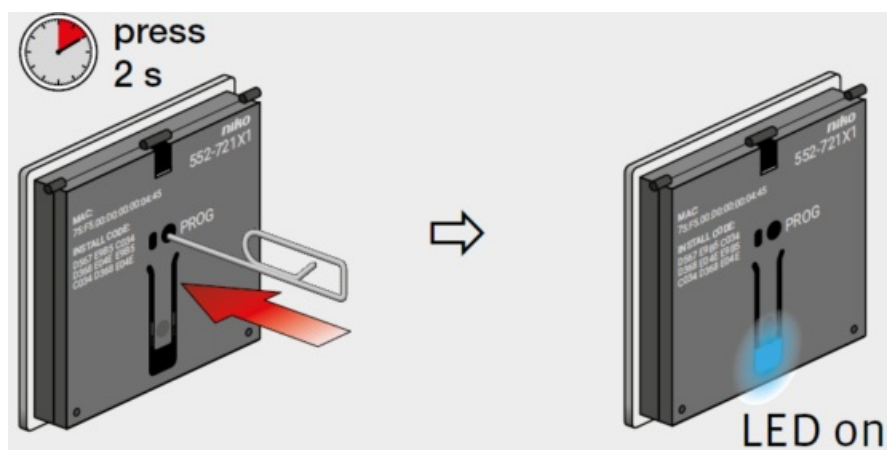

## Specifications

- Article number 552-721X1
- Maximum load 1 x 10 A
- Power supply 230 Vac  $\pm$  10%, 50 Hz
- Circuit Breaker maximum MCB rating 16 A\*
- Max. inrush current 100 A







- Wire capacity 1 x 2.5 mm<sup>2</sup>
- Protocol Zigbee® 3.0, 2.4 GHz
- Mounting method flush-mounting box
- Flush-mounting box specifications depth = min. 40 mm  
(cabling space included)  
claw/screw fixing = 60 mm  
inner diameter box = 60 mm  
multiple boxes centre distance horizontal = 71 mm  
multiple boxes centre distance vertical = 71 mm  
multiple boxes centre distance vertical = 60 mm for BE and FR
- Mounting height 110 – 120 cm
- Modification of settings stand-alone mode:  
buttons on front panel, behind the central plate  
connected mode:  
Niko Home Control programming software  
Niko Home app
- Max. cable length extension switches 50 m  
Maximum range (between switch and smart hub or wireless bridge) 10 m (longer ranges possible with meshing capability of 230 V connected Zigbee® devices)
- Maximum per installation max. 50 connected Zigbee® devices
- Operating frequency 2.4 GHz
- Maximum RF power 10 dBm
- Protection degree IP20
- Ambient temperature 0 – 40 °C
- Dimensions (HxWxD) (552-72101, 552-72121) 71 x 73 x 38.6 mm
- Dimensions (HxWxD) (552-72111, 552-72131) 73 x 73 x 38.6 mm
- Weight 70 g
- System compatibility talks with Homey
- Marking CE, Zigbee®

\* The MCB rating is limited by national installation rules

### **Load table**

Below table gives an overview of the permitted loads at an ambient temperature of 40 °C

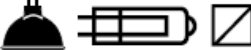
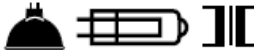

<b>Load</b>		<b>LED</b>			
					
	Resistive	LED/CFLi	Fluorescent lamp	Electronic transformer	Ferro-magnetic transformer
<b>Max.</b>	2300 W	100 W	600 W	600 VA	600 VA



#### Warnings regarding installation

The installation of products that will permanently be part of the electrical installation and which include dangerous voltages, should be carried out by a qualified installer and in accordance with the applicable regulations. This user manual must be presented to the user. It should be included in the electrical installation file and it should be passed on to any new owners. Additional copies are available on the Niko website or via Niko customer services.



#### CE marking

This product complies with all of the relevant European guidelines and regulations. For radio equipment Niko llc declares that the radio equipment in this manual conforms with the 2014/53/EU directive. The full text of the EU declaration of conformity is available at [www.niko.eu](http://www.niko.eu) under the product reference, if applicable.



#### Environment

This product and/or the batteries provided cannot be disposed of in non-recyclable waste. Take your discarded product to a recognised collection point. Just like producers and importers, you too play an important role in the promotion of sorting, recycling and reuse of discarded electrical and electronic equipment. To finance the rubbish collection and waste treatment, the government levies recycling charges in certain cases (included in the price of this product).

#### Support & contact

nv Niko sa  
Industriepark West 40  
9100 Sint-Niklaas, Belgium  
[www.niko.eu](http://www.niko.eu)

- +32 3 778 90 80
- [support@niko.eu](mailto:support@niko.eu)

Niko prepares its manuals with the greatest care and strives to make them as complete, correct and up-to-date as possible. Nevertheless, some deficiencies may subsist. Niko cannot be held responsible for this, other than within the legal limits. Please inform us of any deficiencies in the manuals by contacting Niko customer services at

## Documents / Resources

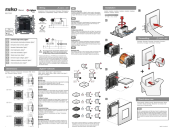

[niko 552-721X1 Simple Connected Switch](#) [pdf] Instruction Manual  
552-721X1, 552-00001, 550-00640, 552-721X1 Simple Connected Switch, 552-721X1, Simple Connected Switch, Connected Switch, Switch

## References

- [n Guide](#)
- [n Niko - home automation, switches, socket outlets and detector](#)
- [n Zigbee](#)
- [n Niko - home automation, switches, socket outlets and detector](#)
- [n Niko Home Control II programming software for Windows](#)
- [n Niko Home Control II programming software for Mac](#)
- [n Zigbee](#)
- [User Manual](#)

[Manuals+](#), [Privacy Policy](#)

This website is an independent publication and is neither affiliated with nor endorsed by any of the trademark owners. The "Bluetooth®" word mark and logos are registered trademarks owned by Bluetooth SIG, Inc. The "Wi-Fi®" word mark and logos are registered trademarks owned by the Wi-Fi Alliance. Any use of these marks on this website does not imply any affiliation with or endorsement.