

NICOR XPL1AEM Hazardous Location Led Linear Luminaire



# NICOR XPL1AEM Hazardous Location Led Linear Luminaire User Guide

[Home](#) » [NICOR](#) » NICOR XPL1AEM Hazardous Location Led Linear Luminaire User Guide 

## Contents

- [1 NICOR XPL1AEM Hazardous Location Led Linear Luminaire](#)
- [2 Product Information](#)
- [3 Product Usage Instructions](#)
- [4 FAQs](#)
- [5 GENERAL SAFETY](#)
- [6 What's In The Box](#)
- [7 Tools & Materials Needed](#)
- [8 LIMITED WARRANTY](#)
- [9 CONTACT](#)
- [10 Documents / Resources](#)
  - [10.1 References](#)



## NICOR XPL1AEM Hazardous Location Led Linear Luminaire



## Product Information

- **Specifications**
  - **Product Name:** Proteus XPL1A\_EM Hazardous Location Linear

- **Operating Characteristics:** Hazardous Locations Class I, Division 1, Groups C, D
- **Environmental Ratings:** Suitable for wet location IP66 Rating
- **Compliances:** UL 844, UL 924

## Product Usage Instructions

### • What's In The Box

- **For Emergency Luminaire:**
  - One (1) XPL1A\*\*\*EM (and associated hardware)
  - One (1) 3/4 NPT plug

### • Tools & Materials Needed

- This fixture requires very few tools for installation: A drill, a pair of wire cutters/strippers, Allen wrenches, and appropriate mounting hardware.

### • General Installation Instructions

- **For all mounting methods:**
  - Carefully unpack the fixture from its packaging. Inspect product for defects due to shipping.
  - Turn off power to the appropriate circuit at the breaker panel.
  - Pull a 3-wire pigtail through the selected conduit port and install the conduit connector on the enclosure.
  - Identify the mounting location and the appropriate mounting method below. Continue to Step 5 after the luminaire is mounted with properly rated hardware (not included).

### • Surface Mount

- Drill mounting holes on the surface and mount the trunnion bracket (sold separately) to the surface using appropriate fasteners.
- Attach the fixture to the mounting bracket using two (2) 6mm drive hex bolts and lock washers (provided).
- Adjust the fixture to the desired angle. Insert and tighten two (2) 3mm drive hex set bolts (provided). Tighten the 6mm drive mounting bolts to set the angle.

### • Pendant Mount

- Route wiring from the pendant (top) port (3/4 NPT) through the pendant to the desired location and route wiring through the pendant.

- Thread the fixture onto the pendant.

### • General Installation Instructions (Continuation)

- Connect the desired conduit and seal the unused conduit port with a conduit plug (3/4 NPT provided), following all NEC and local codes.
- Connect wiring as shown in a wiring diagram, following all NEC and local codes.
- Turn on power to the appropriate circuit and verify the fixture's operation.

## FAQs

### • Q: What are the environmental ratings for this fixture?

- **A:** This fixture is suitable for wet locations with an IP66 Rating.

## GENERAL SAFETY

- To reduce the risk of death, personal injury or property damage from fire, electric shock, falling parts, cuts/abrasions, and other hazards, read all warnings and instructions included with and on the fixture box and all fixture labels.
- Before installing, servicing, or performing routine maintenance on this equipment, follow these general precautions.
- Commercial installation, service and maintenance of luminaires should be performed by a qualified licensed electrician.
- **DO NOT INSTALL DAMAGED PRODUCT!**
- This fixture is intended to be connected to a properly installed and grounded UL-listed junction box.
- Make sure that the supply voltage is the same as the luminaire voltage.
- Do not install where the marked operating temperatures exceed the ignition temperatures of the hazardous atmosphere.
- Do not operate in ambient temperatures above those indicated on the luminaire nameplate
- All gasket seals must be clean and undamaged
- To ensure safety, a safety rope can be used to fix the luminaire before installation

#### **WARNING: RISK OF ELECTRIC SHOCK**

- Turn off electrical power at the fuse or circuit breaker box before wiring the fixture to the power supply.
- Turn off the power when you perform any maintenance.
- Verify that the supply voltage is correct by comparing it with luminaire label information.
- Make all electrical and grounded connections following the NEC and any applicable local code requirements.
- All wiring connections should be capped with UL-approved wire connectors.
- Luminaire must be supplied by a wiring system with an equipment grounding conductor.

#### **CAUTION: RISK OF INJURY**

- Wear gloves and safety glasses at all times when removing luminaire from cartons, installing servicing or performing maintenance.
- Avoid direct eye exposure to the light source while it is on
- Account for small parts and destroy packing material as these may be hazardous to children.

#### **RISK OF FIRE**

- Keep combustible and other materials that can burn away from luminaires and lamps/lenses.
- MIN 90°C CONDUCTORS

#### **OPERATING CHARACTERISTICS:**

- **Rated Voltage:** 120-277 Vac, 50/60Hz
- **Ambient Temperature Range:** -20°C (-4°F) ~ +45 °C (113 °F)
- **A 24-hour charging period is required:** 90 minutes of illumination period with a 6w

#### **ENVIRONMENTAL RATINGS:**

- Suitable for wet location
- IP66 Rating

This fixture is suitable for use in the following hazardous (classified) areas as defined by the National Electrical Code (NEC) and Canadian Electrical Code (CEC):

- **Hazardous Locations**
  - Class I, Division 1, Groups C, D
- **Compliances**
  - UL 844
  - UL 924

Refer to the luminaire nameplate for specific classification information, maximum ambient temperature suitability and corresponding operating temperature (T-Code).

## What's In The Box

### FOR EMERGENCY LUMINAIRE

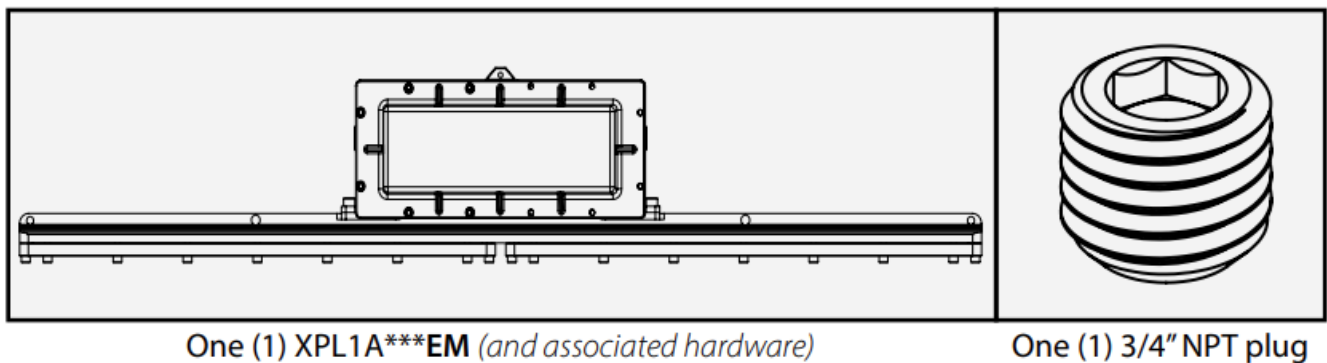

## Tools & Materials Needed

**This fixture requires very few tools for installation:** A drill a pair of wire cutters/strippers, Allen wrenches, and appropriate mounting hardware.



## GENERAL INSTALLATION INSTRUCTION

For all mounting methods.

1. Carefully unpack the fixture from its packaging. Inspect product for defects due to shipping.
2. Turn off power to the appropriate circuit at the breaker panel.
3. Pull a 3-wire pigtail through the selected conduit port and install a conduit connector on the enclosure.

- Identify the mounting location and the appropriate mounting method below. Continue to Step 5 after the luminaire is mounted with properly rated hardware (not included).

### Trunnion Bracket Pattern (N.T.S.)

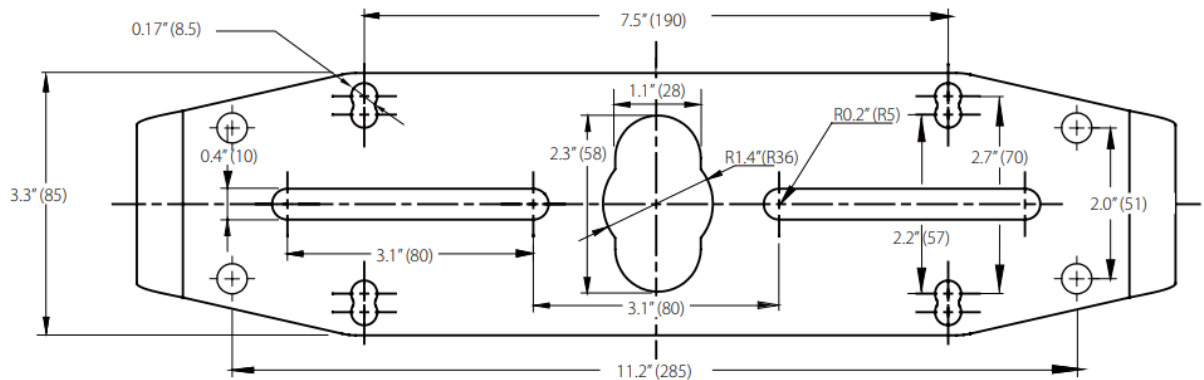

### SURFACE MOUNT

- Drill mounting holes on the surface and mount the trunnion bracket (sold separately) to the surface using appropriate fasteners.
- Attach the fixture to the mounting bracket using two (2) 6mm drive hex bolts and lock washers (provided).
- Adjust the fixture to the desired angle. Insert and tighten two (2) 3mm drive hex set bolts (provided). Tighten the 6mm drive mounting bolts to set the angle.

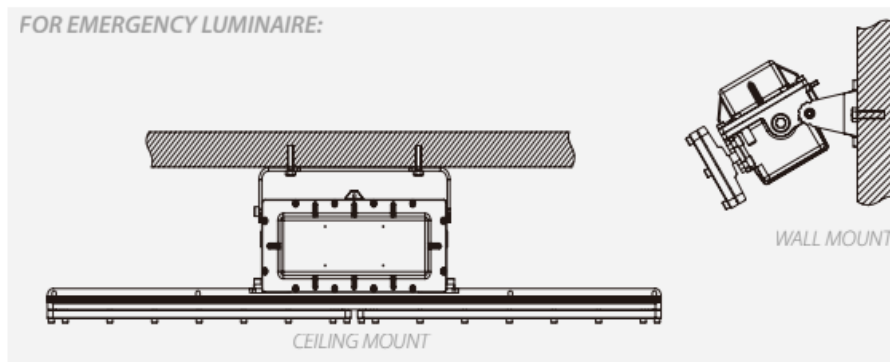

### PENDANT MOUNT (Pendant stem by others)

- Route wiring from the pendant (top) port (3/4" NPT) through the pendant to the desired location and route wiring through the pendant.
- Thread the fixture onto the pendant.

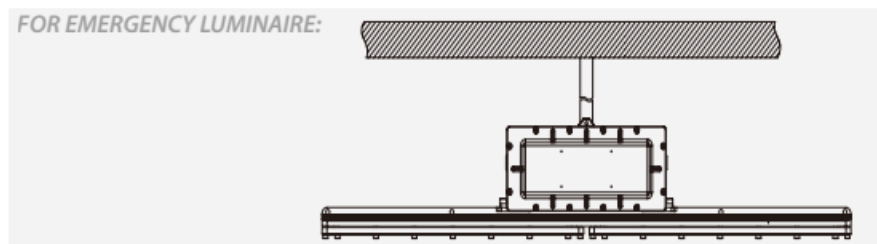

### STANCHION MOUNT (kit sold separately for pipe diameters of 2 in. or 2.5 in.)

1. Attach the pipe mount kit trunnion bracket to the stanchion using the appropriately sized U-bolts from the kit
2. Attach the fixture to the trunnion bracket using two (2) 6mm drive hex bolts and lock washers (provided).
3. Adjust the fixture to the desired angle. Insert and tighten two (2) 3mm drive hex set bolts (provided). Tighten the M6 mounting bolts to set the angle.

FOR EMERGENCY LUMINAIRE:

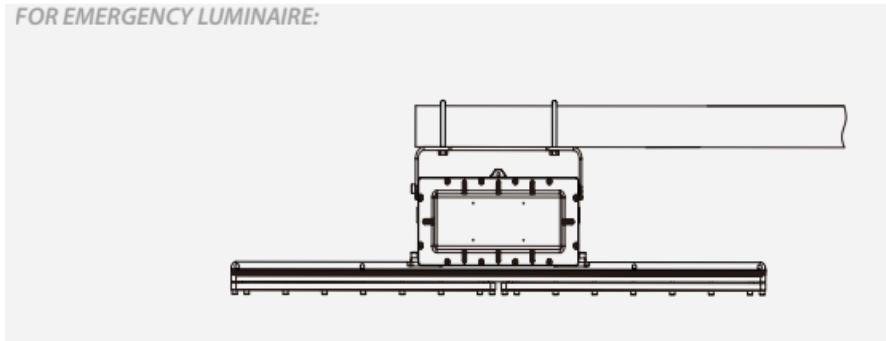

#### GENERAL INSTALLATION INSTRUCTION (continuation)

4. Connect the desired conduit and seal the unused conduit port with a conduit plug (3/4" NPT provided), following all NEC and local codes.
5. Connect wiring as shown in the wiring diagram, following all NEC and local codes.
6. Turn on power to the appropriate circuit and verify the fixture's operation.

#### SECONDARY RETENTION (kits sold separately)

1. Install a Secondary Retention Cable to secure the location, using appropriate fasteners.
2. Clip the carabiner through thru-holes on top of the fixture.

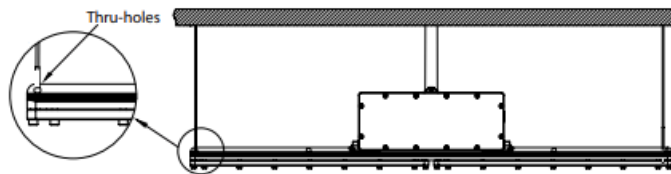

#### FOR EMERGENCY LIGHTING AND POWER EQUIPMENT EMERGENCY WIRING INSTRUCTIONS

**Caution:** Turn off electrical power at the fuse or circuit breaker panel before wiring fixture to the power supply.

**Connect wiring at the terminal block in the fixture as follows:**

- **Black** = Line
- **White** = Common/Neutral
- **Green** = Ground
- **ORN/BLK** = Line

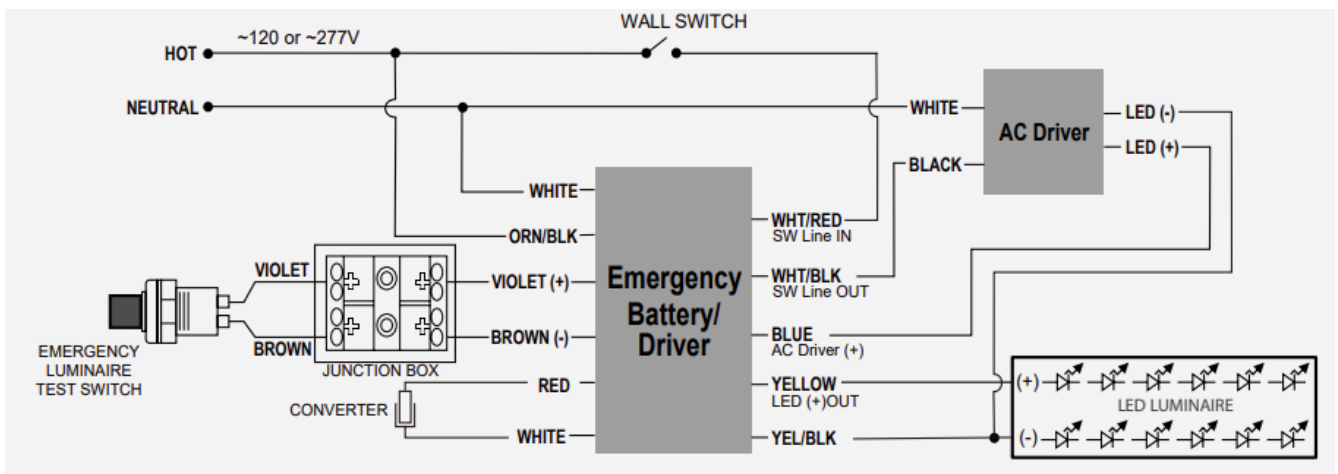

## THROUGH-WIRING

(NICOR has provided quick-connect wire connectors internal to the luminaire for through-wiring applications.)

1. After the unit is properly mounted, remove the power supply enclosure cover by loosening the twelve (12) 5mm drive hex retention bolts of the Tank Cover at torque value 7N-m.
2. Route wiring between luminaires with appropriate wire and conduit.
3. Locate the three (3) quick-connect wire connectors inside the driver housing.
4. Connect each wire to the corresponding quick-connect inside the driver housing (see EMERGENCY WIRING INSTRUCTIONS). There is at least one open connector on each quick-connect.
5. Reattach enclosure cover and torque bolts to 3 Nm/27 in lbs.

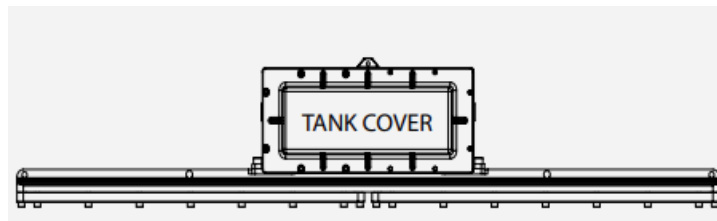

## SERVICING:

- To avoid personal injury, disconnect the power to the fixture and allow the fixture to cool before performing maintenance.
- Perform electrical, mechanical, and visual inspections regularly. The frequency of these inspections is dependent upon the installation environment and frequency of use; it is recommended that these checks be made annually at a bare minimum.
- The external glass should be cleaned periodically to maintain consistent light output and fixture performance. Clean the glass with a clean, damp, non-abrasive, lint-free cloth.
- If this is not sufficient, a mild soap may be used, but do not use any cleaning agent that is abrasive, strong alkaline, or acidic, as these may damage the fixture.
- Inspect the cooling fins regularly to ensure that they are free of any dust or other contaminants. If necessary, clean with a non-abrasive cloth.
- Check that all mechanical parts are properly assembled and secured.
- Check that all electrical connections are clean, tight, and secure.

## LIMITED WARRANTY

## LED EXPRESS LIMITED WARRANTY

Subject to the exclusions below, each NICOR LED product, including the LED electronics and components of a property-installed NICOR LED product, will be free from defects in materials and workmanship for five (5) years from the original date of purchase. The product shall be considered defective only if 10% or more of the product's LED components fail. NICOR LED product warranty covers the following performance criteria: LED Light Output will

be maintained above 70% of initial output; the LED colour temperature will not shift more than 200K in CCT; the LED driver will operate within NICOR specifications; and the fixture finish, excluding natural aluminium or brass products, will not exhibit cracking, peeling excessive fading, or corrosion during the warranty period. Exceptions apply as defined in NICOR's product specification sheets, which are incorporated by reference herein. This limited warranty is provided to you, the purchaser of the product identified on Seller's invoice, as your exclusive remedy and applies only to NICOR products that have been purchased from an authorized NICOR Distributor; the product was new and in an unopened NICOR package at the time of installation, and the NICOR product was installed by a licensed electrician or under the supervision of a licensed electrician and used by consumers in the United States or Canada when accompanied with this warranty. This warranty extends only to the first consumer purchaser and is not transferable. A consumer wishing to invoke the terms of this limited warranty must first obtain a RGA number within 30 days of discovery of the defect, and return the product to NICOR for inspection. Once verified to be covered by this limited warranty, NICOR will, at its sole discretion, repair, replace, or refund the purchase price of any product that does not conform to this limited warranty. If NICOR, at its sole discretion, determines that the product should be repaired or replaced, this warranty is limited to the reasonable, customary, and necessary costs and expenses associated with the repair/replacement. This warranty requires that all repair/replacement estimates and costs, including but not limited to equipment rental (if any), and any other cost or expense to be incurred in the repair/replacement of the product, be approved in advance and in writing by NICOR. FAILURE TO OBTAIN NICOR'S ADVANCE WRITTEN APPROVAL OF ALL REPAIR/REPLACEMENT COSTS AND EXPENSES IN WRITING SHALL VOID THIS LIMITED WARRANTY

### THIS LIMITED WARRANTY DOES NOT COVER THE FOLLOWING:

- Defects or damages resulting from improper installation, operation, storage, misuse or abuse, accident, or neglect;
- Defects or damages resulting from improper service, testing, adjustment, installation, maintenance, alteration, connection to out-of-specification electrical service, corrosive or damp environments, or connection to incompatible equipment or devices (e.g., connecting non-dimmable lighting products to dimmers);
- Damage which occurs in transit; and
- Power surges or overheating due to external conditions;
- Acts of nature including but not limited to lightning strikes

ANY IMPLIED WARRANTIES, INCLUDING WITHOUT LIMITATION, THE IMPLIED WARRANTIES OF MERCHANTABILITY AND FITNESS FOR A PARTICULAR PURPOSE SHALL BE LIMITED TO THE DURATION OF THIS LIMITED WARRANTY, OTHERWISE THE REPAIR, REPLACEMENT, OR REFUND AS PROVIDED UNDER THIS EXPRESS LIMITED WARRANTY IS THE EXCLUSIVE REMEDY OF THE CONSUMER, AND IS PROVIDED INSTEAD OF ALL OTHER WARRANTIES, EXPRESS OR IMPLIED. IN NO EVENT SHALL NICOR BE LIABLE, WHETHER IN CONTRACT OR TORT (INCLUDING NEGLIGENCE) FOR DAMAGES OVER THE PURCHASE PRICE OF THE PRODUCT, OR FOR ANY INDIRECT, INCIDENTAL, SPECIAL OR CONSEQUENTIAL DAMAGES OF ANY KIND, OR LOSS OF REVENUE OR PROFITS, LOSS OF BUSINESS OR OTHER FINANCIAL LOSS ARISING OUT OF OR IN CONNECTION WITH THE ABILITY OR INABILITY TO USE THE PRODUCT TO THE FULL EXTENT THESE DAMAGES MAY BE DISCLAIMED BY LAW.

- Copyright 2014, NICOR, Inc.
- Revised October 2017

This device complies with part 15 of the FCC Rules.



## Operation is subject to the following two conditions:

1. This device may not cause harmful interference, and
2. this device must accept any interference received, including interference that may cause undesired operation.

**NOTE:** This equipment has been tested and found to comply with the limits for a Class A digital device, according to part 15 of the FCC Rules. These limits are designed to provide reasonable protection against harmful interference when the equipment is operated in a commercial environment. This equipment generates, uses, and can radiate radio frequency energy and, if not installed and used per the instruction manual, may cause harmful interference to radio communications. Operation of this equipment in a residential area is likely to cause harmful interference in which case the user will be required to correct the interference at his own expense.

## CONTACT

- NICOR, Inc. 2200 Midtown Place NE, Albuquerque,
  - NM 87107
  - **P:** 800.821.6283
  - **F:** 800.892.8393
  - [www.nicorlighting.com](http://www.nicorlighting.com).
  - April 26, 2023 10:01 AM
- 

## Documents / Resources

	<p><a href="#">NICOR XPL1AEM Hazardous Location Led Linear Luminaire [pdf] User Guide</a> XPL1AEM Hazardous Location Led Linear Luminaire, XPL1AEM, Hazardous Location Led Linear Luminaire, Location Led Linear Luminaire, Led Linear Luminaire, Linear Luminaire, Luminaires</p>
---	--

## References

-  [NICOR Lighting](#)
- [User Manual](#)

### [Manuals+](#), [Privacy Policy](#)

This website is an independent publication and is neither affiliated with nor endorsed by any of the trademark owners. The "Bluetooth®" word mark and logos are registered trademarks owned by Bluetooth SIG, Inc. The "Wi-Fi®" word mark and logos are registered trademarks owned by the Wi-Fi Alliance. Any use of these marks on this website does not imply any affiliation with or endorsement.